

1333 M Street SE - WASHINGTON, DC
Site-specific and Landscape Plant Schedule

Code	Plant Name	Quantity	Plant Size	Notes
01 AS	Asplenium adnigrum	8	12 in	Substrate
05 QP	Quercus prinus	13	4' - 2' cal	B&S
56 LMB	Lamb's Ear	24	14-16 in	B&S
363 SAX	Saxifraga	12	14-16 in	B&S
239 ACP	Asplenium platyneuron	43	4' - 2' cal	B&S
106 ATG	Asplenium thalictroides	42	7-8 in	B&S
16 TM	Thymus	13	4' - 2' cal	B&S
TM 13	Thymus	13	4' - 2' cal	B&S
04 IV	Asplenium adnigrum	18	14-16 in	B&S
10 CS	Asplenium adnigrum	18	14-16 in	B&S
58 ACP	Asplenium platyneuron	43	4' - 2' cal	B&S
50 ATG	Asplenium thalictroides	42	7-8 in	B&S
32 CAB	Asplenium adnigrum	18	14-16 in	B&S
117 AQC	Asplenium adnigrum	18	14-16 in	B&S
117 EPP	Asplenium adnigrum	18	14-16 in	B&S
69 SHO	Asplenium adnigrum	18	14-16 in	B&S
136 POW	Asplenium adnigrum	18	14-16 in	B&S
75 HEA	Asplenium adnigrum	18	14-16 in	B&S
78 COL	Asplenium adnigrum	18	14-16 in	B&S
18 TM	Thymus	13	4' - 2' cal	B&S
110 CAP	Asplenium adnigrum	18	14-16 in	B&S
232 ACP	Asplenium platyneuron	43	4' - 2' cal	B&S
103 ATG	Asplenium thalictroides	42	7-8 in	B&S
55 CF	Asplenium adnigrum	18	14-16 in	B&S
403 AQC	Asplenium adnigrum	18	14-16 in	B&S
403 EPP	Asplenium adnigrum	18	14-16 in	B&S
14 CHL	Chlorophytum	18	14-16 in	B&S
3,218 SF FSA	Fescue	3,218	sq ft	
175 CHL	Chlorophytum	175	14-16 in	B&S
03 BN	Berberis	3	14-16 in	B&S
01 AC	Asplenium adnigrum	18	14-16 in	B&S
01 CK	Asplenium adnigrum	18	14-16 in	B&S
30 CHL	Chlorophytum	30	14-16 in	B&S
130 SCS	Scilla	130	14-16 in	B&S
53 CHL	Chlorophytum	53	14-16 in	B&S
49 SCS	Scilla	49	14-16 in	B&S
90 SCS	Scilla	90	14-16 in	B&S
03 BN	Berberis	3	14-16 in	B&S
43 IV	Asplenium adnigrum	18	14-16 in	B&S
73 COV	Cover	73	14-16 in	B&S
24 CF	Cover	24	14-16 in	B&S
67 ECP	Echinops	67	14-16 in	B&S
130 SEA	Sea	130	14-16 in	B&S
14 BPA	BPA	14	14-16 in	B&S
54 ASL	ASL	54	14-16 in	B&S
17 IMUC	IMUC	17	14-16 in	B&S
99 LIS	LIS	99	14-16 in	B&S
34 CF	CF	34	14-16 in	B&S
50 SON	SON	50	14-16 in	B&S
17 BPA	BPA	17	14-16 in	B&S
65 ASL	ASL	65	14-16 in	B&S
29 IMUC	IMUC	29	14-16 in	B&S
20 CS	CS	20	14-16 in	B&S
133 ECP	Echinops	133	14-16 in	B&S
66 COV	Cover	66	14-16 in	B&S
123 SON	SON	123	14-16 in	B&S
45 CF	CF	45	14-16 in	B&S
49 TM	TM	49	14-16 in	B&S
11 BPA	BPA	11	14-16 in	B&S
44 ASL	ASL	44	14-16 in	B&S
260 CAK	CAK	260	14-16 in	B&S
46 CS	CS	46	14-16 in	B&S
145 ECP	Echinops	145	14-16 in	B&S
05 BN	Berberis	5	14-16 in	B&S
15,547 SF FSA	Fescue	15,547	sq ft	
9,548 SF FSA	Fescue	9,548	sq ft	
58,754 SF PWW	PWW	58,754	sq ft	
02 CK	Asplenium adnigrum	18	14-16 in	B&S
110 ECP	Echinops	110	14-16 in	B&S
04 AM	AM	4	14-16 in	B&S
74 COV	Cover	74	14-16 in	B&S
04 BN	Berberis	4	14-16 in	B&S
01 QP	Quercus prinus	1	14-16 in	B&S
01 AS	Asplenium adnigrum	18	14-16 in	B&S

Notes:

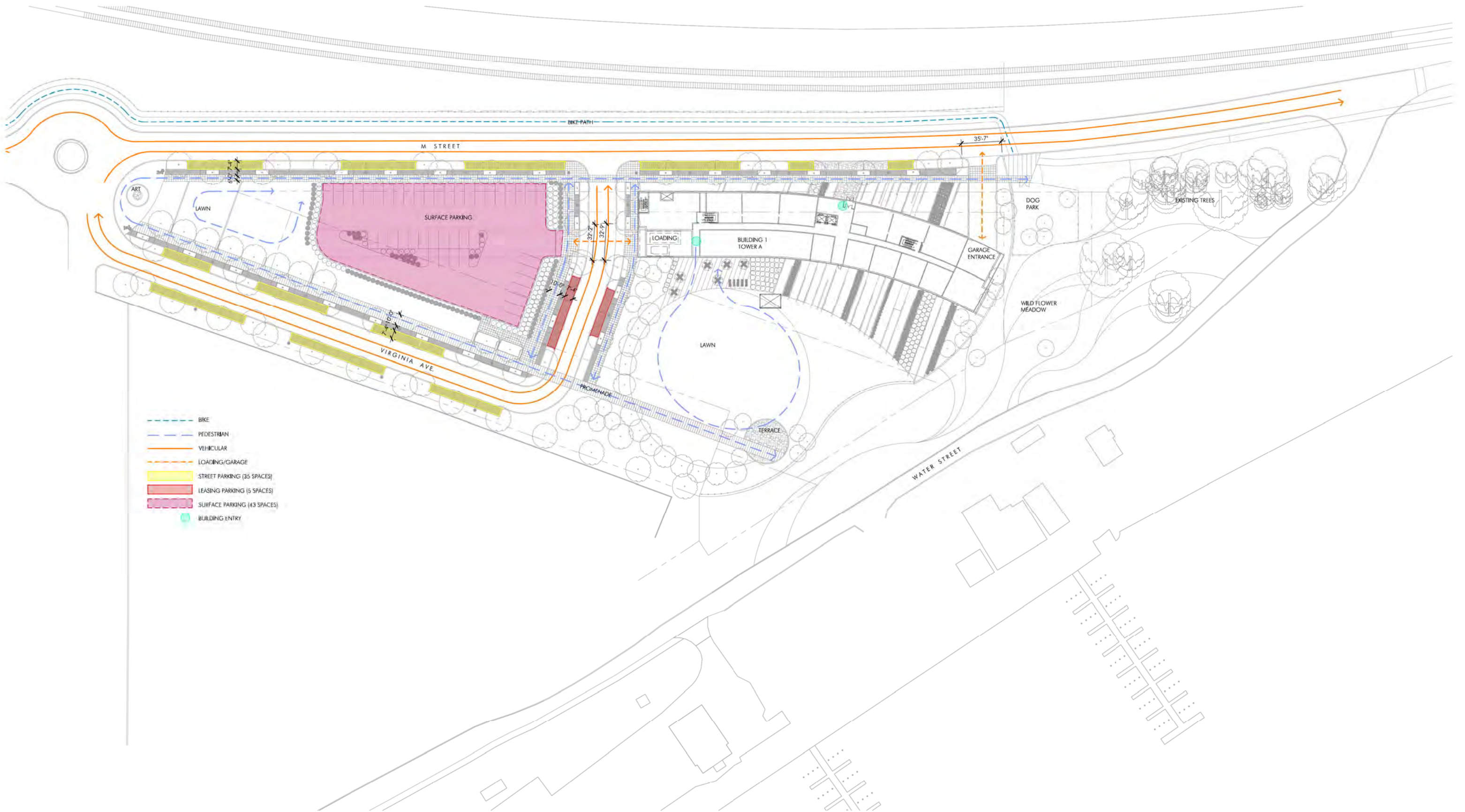



- BIKE
- PEDESTRIAN
- VEHICULAR
- LOADING/GARAGE
- STREET PARKING (35 SPACES)
- LEASING PARKING (5 SPACES)
- SURFACE PARKING (43 SPACES)
- BUILDING ENTRY



PHASE I - PARKING DATA	
LEVEL	# SPACES
P1 LEVEL	27
P2 LEVEL	24
SURFACE	44
TOTAL	95
BICYCLE PARKING DATA	
P1 LEVEL	73
P2 LEVEL	0
TOTAL	73

1 PHASE I - BELOW GRADE PLAN, P2 LEVEL



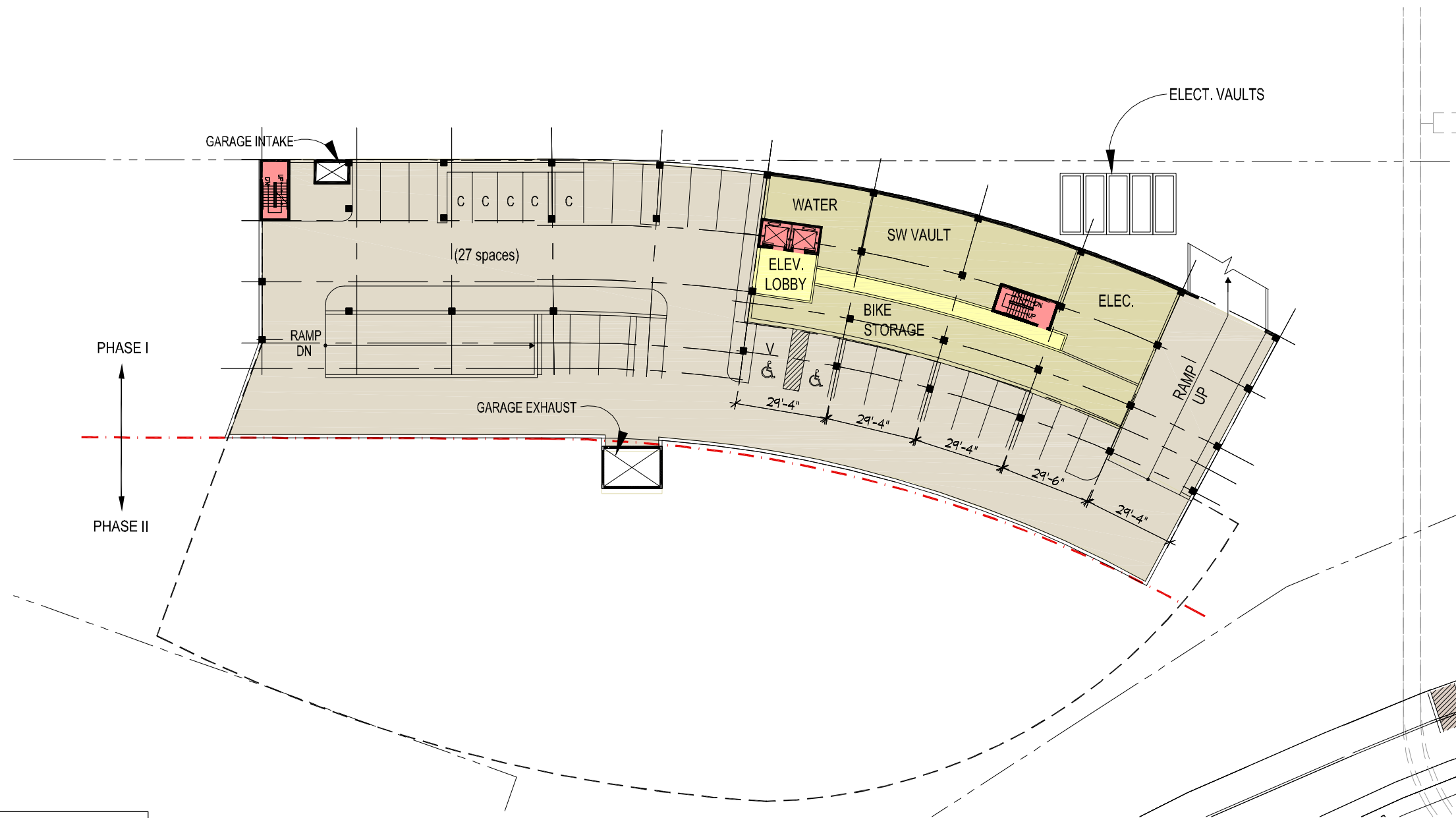

PHASE I - PARKING DATA	
LEVEL	# SPACES
P1 LEVEL	27
P2 LEVEL	24
SURFACE	44
TOTAL	95
BICYCLE PARKING DATA	
P1 LEVEL	73
P2 LEVEL	0
TOTAL	73

1 P1 LEVEL FLOOR PLAN

10' 5' 0' 10' 20' 40'
1:40 (11x17 size sheet)