

NOTES: (1) FLEXIBILITY IS REQUESTED TO VARY THE FINAL SELECTION OF THE EXTERIOR MATERIALS WITHIN THE COLOR RANGES AND GENERAL MATERIAL TYPES PROPOSED, BASED ON AVAILABILITY AT THE TIME OF CONSTRUCTION WITHOUT REDUCING THE QUALITY OF MATERIALS. (2) FLEXIBILITY IS REQUESTED TO MAKE MINOR REFINEMENTS TO EXTERIOR DETAILS AND DIMENSIONS, INCLUDING SILLS, BASES, CORNICES, RAILINGS AND TRIM, AND ANY OTHER CHANGES TO COMPLY WITH THE BUILDING CODES OR THAT OTHERWISE NECESSARY TO OBTAIN FINAL BUILDING PERMIT.

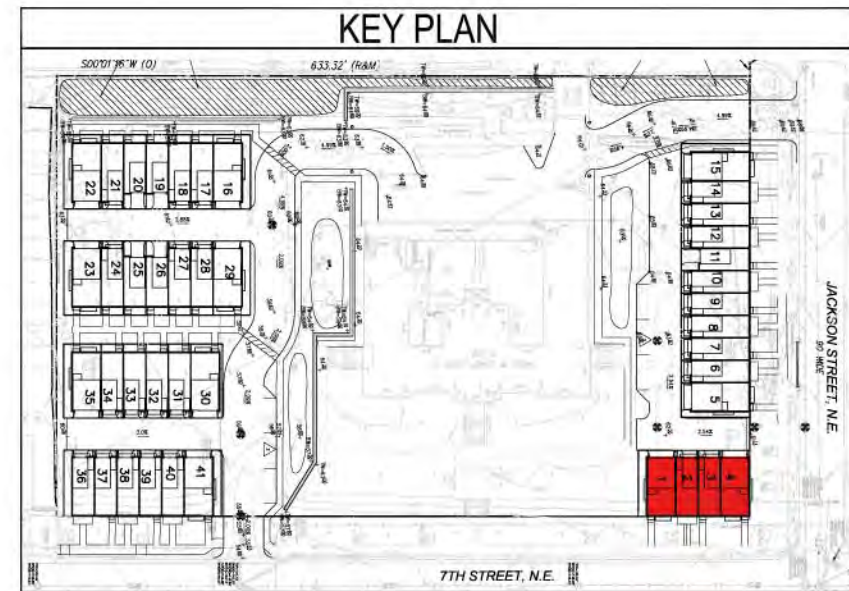

CONCEPTUAL ELEVATIONS

BROOKLAND TOWNHOMES
Washington, DC

A.100

BUILDING 1 - LOTS 1-4
PUD APPLICATION

MADISON HOMES



8521 Leesburg Pike Suite 700 Vienna, VA 22182
P: 571.830.1800 | F: 571.830.1801 | www.lessarddesign.com

© 2013 Lessard Design Inc. expressly reserves its common law copyright and other property rights in these plans. These plans are not to be changed or copied in any form or matter whatsoever, nor are they to be assigned to any third party without the express written permission and consent of Lessard Design, Inc.

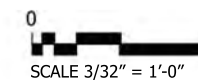

ZONING COMMISSION
District of Columbia
01/22/15
MHI.009A.00D
CASE NO.15-02
EXHIBIT NO.2B3

NOTES: (1) FLEXIBILITY IS REQUESTED TO VARY THE FINAL SELECTION OF THE EXTERIOR MATERIALS WITHIN THE COLOR RANGES AND GENERAL MATERIAL TYPES PROPOSED, BASED ON AVAILABILITY AT THE TIME OF CONSTRUCTION WITHOUT REDUCING THE QUALITY OF MATERIALS. (2) FLEXIBILITY IS REQUESTED TO MAKE MINOR REFINEMENTS TO EXTERIOR DETAILS AND DIMENSIONS, INCLUDING SILLS, BASES, CORNICES, RAILINGS AND TRIM, AND ANY OTHER CHANGES TO COMPLY WITH THE BUILDING CODES OR THAT OTHERWISE NECESSARY TO OBTAIN FINAL BUILDING PERMIT.

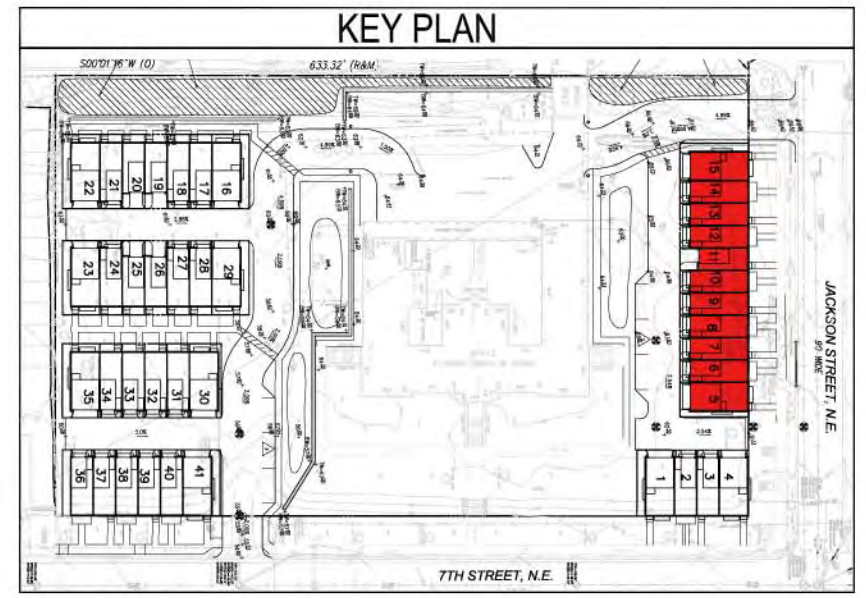

LOT 05 18' UNIT H.P.	LOT 06 14' UNIT	LOT 07 14' UNIT	LOT 08 14' UNIT	LOT 09 14' UNIT	LOT 10 14' A.D.U. UNIT	LOT 11 14' UNIT	LOT 12 14' UNIT	LOT 13 14' UNIT	LOT 14 14' UNIT	LOT 15 18' UNIT H.P.
----------------------------	--------------------	--------------------	--------------------	--------------------	---------------------------	--------------------	--------------------	--------------------	--------------------	----------------------------



8521 Leesburg Pike Suite 700 Vienna, VA 22182
P: 571.830.1800 | F: 571.830.1801 | www.lessarddesign.com

© 2013 Lessard Design Inc. expressly reserves its common law copyright and other property rights in these plans. These plans are not to be changed or copied in any form or matter whatsoever, nor are they to be assigned to any third party without the express written permission and consent of Lessard Design, Inc.

CONCEPTUAL ELEVATIONS

BUILDING 2 - LOTS 5-15
PUD APPLICATION

BROOKLAND TOWNHOMES
Washington, DC
MADISON HOMES

A.101

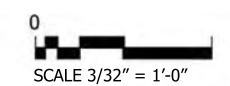

01/22/15
MHI.009A.00D

NOTES: (1) FLEXIBILITY IS REQUESTED TO VARY THE FINAL SELECTION OF THE EXTERIOR MATERIALS WITHIN THE COLOR RANGES AND GENERAL MATERIAL TYPES PROPOSED, BASED ON AVAILABILITY AT THE TIME OF CONSTRUCTION WITHOUT REDUCING THE QUALITY OF MATERIALS. (2) FLEXIBILITY IS REQUESTED TO MAKE MINOR REFINEMENTS TO EXTERIOR DETAILS AND DIMENSIONS, INCLUDING SILLS, BASES, CORNICES, RAILINGS AND TRIM, AND ANY OTHER CHANGES TO COMPLY WITH THE BUILDING CODES OR THAT OTHERWISE NECESSARY TO OBTAIN FINAL BUILDING PERMIT.

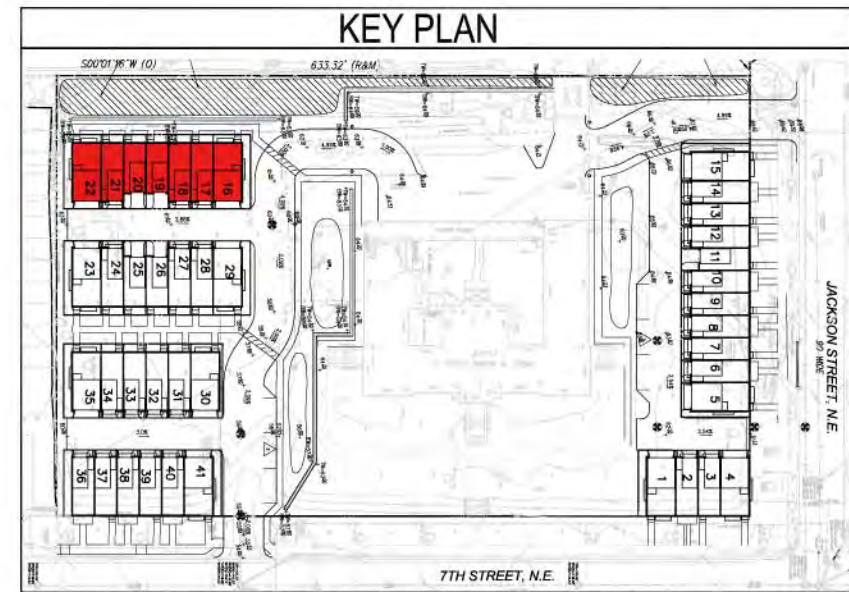

8521 Leesburg Pike Suite 700 Vienna, VA 22182
 P: 571.830.1800 | F: 571.830.1801 | www.lessarddesign.com

© 2013 Lessard Design Inc. expressly reserves its common law copyright and other property rights in these plans. These plans are not to be changed or copied in any form or matter whatsoever, nor are they to be assigned to any third party without the express written permission and consent of Lessard Design, Inc.

CONCEPTUAL ELEVATIONS

BROOKLAND TOWNHOMES
 Washington, DC

A.102

BUILDING 3 - LOTS 16-22
 PUD APPLICATION

MADISON HOMES

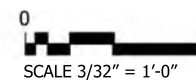

01/22/15
 MHI.009A.00D