

APPROVED

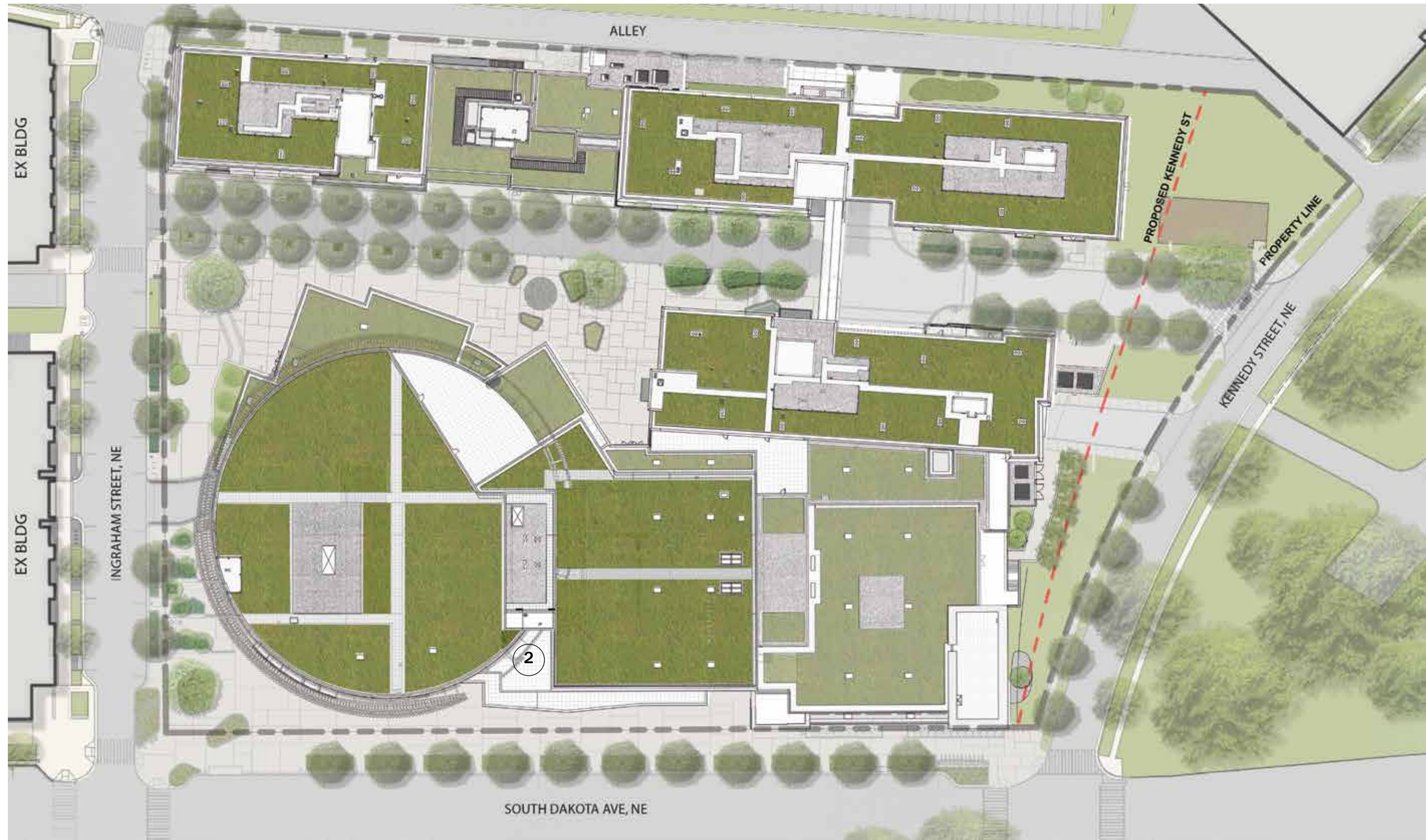



PROPOSED





1. Metal Paneling



2. Wood Paneling



3. Iron Spot Brick



4. Stone masonry

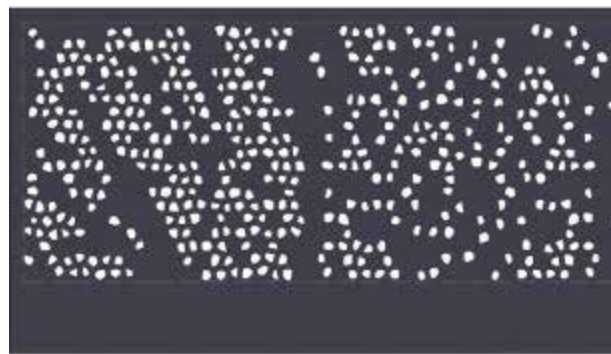

5. Screened enclosure for switch-Gear



APPROVED



PROPOSED

KENNEDY STREET ELEVATION DETAIL

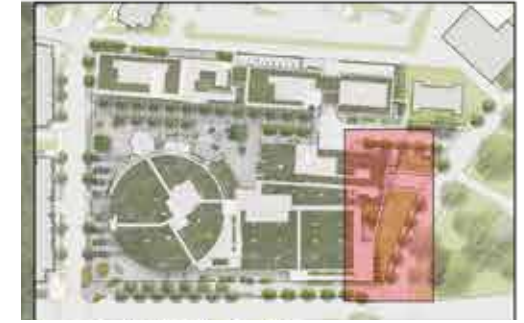

PROPOSED

PROPOSED KENNEDY ST NE STREET SCAPE

INTENTIONALLY BLANK



APPROVED

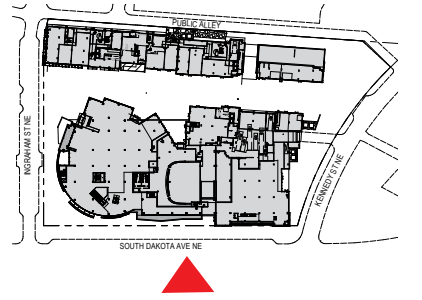

PROPOSED

Reduce height of "FEZ" by two stories and introduce terraces on 4th Street plaza

Revise massing on South Dakota to add terrace.

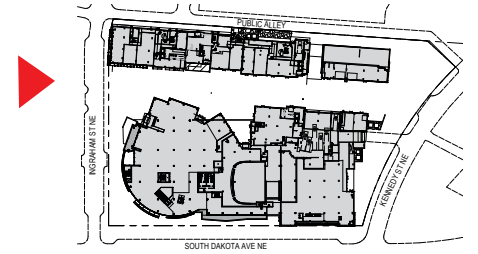

← Revise palette based on more neutral colors

← Reduce height of “FEZ” by two stories and introduce terraces on 4th Street plaza

← Eliminate stone “fort” on corner of Ingraham and 4th Street



APPROVED

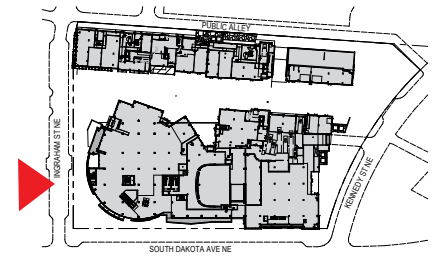

PROPOSED

Reduce height of "FEZ" by two stories and introduce terraces on 4th Street plaza

Eliminate stone "fort" on corner of Ingraham and 4th Street

INTENTIONALLY BLANK



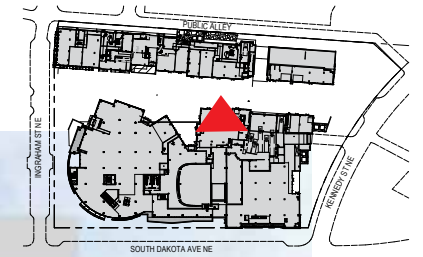

APPROVED



T.O. ROOF - WEST
217' - 6"
 LEVEL 07 WEST
206' - 8"
 LEVEL 06 WEST
197' - 0"
 LEVEL 05 WEST
187' - 4"
 LEVEL 04 WEST
177' - 8"
 LEVEL 03 WEST
168' - 0"
 LEVEL 02 WEST
158' - 4"
 LEVEL 01 WEST
148' - 8"
 BHMP - KENNEDY WEST
137' - 6"
 LEVEL 00 - LOBBY

PROPOSED

1. Extend North residential tower 35' for additional 19 residential units
2. Revised main lobby entrance & eliminate amenity terrace
3. Revise palette based on more neutral colors

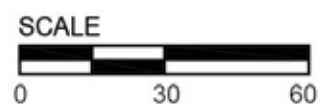

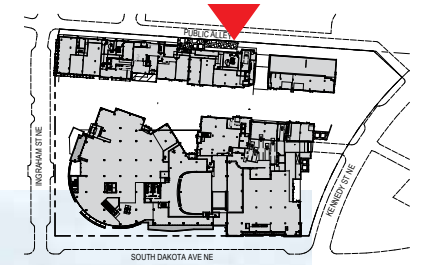

APPROVED



PROPOSED

1. Reduce parking garage by 223 spaces and eliminate third garage entrance.
2. Extend North residential tower 35' for additional 19 residential units
3. Revised main lobby entrance & eliminate amenity terrace
4. Revise palette based on more neutral colors





SOUTH TOWER



1. BRK-01



2. BRK-02



3. STONE 02A
HONED LIMESTONE



4. STONE 02B
BELTSAWN LIMESTONE



NORTH TOWER



5. COLORED METAL
PANELS- LIGHT GREY



6. TEXTURED COLOR
PANELS - LIGHT GREY



7. STUCCO 01 DARK GREY



EAST TOWER



8. ALUMINUM WINDOWS



9. RETAIL STOREFRONT
BY TENANTS



10. STUDIO MAKER-SPACES WITH
GARAGE DOORS

INTENTIONALLY BLANK

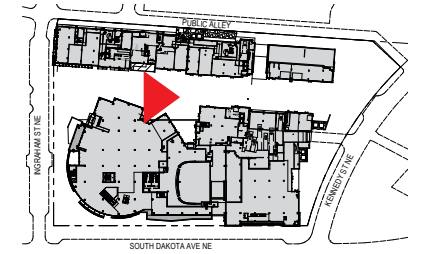

— Revise palette based on more neutral colors

— Revised main lobby entrance & eliminate amenity terrace



APPROVED

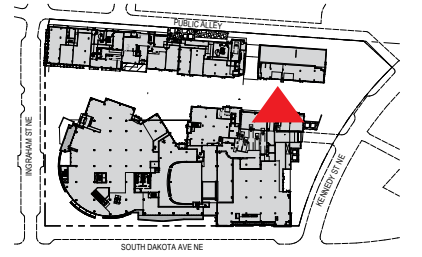

PROPOSED

Provide additional 40ft loading berth on 4th Street

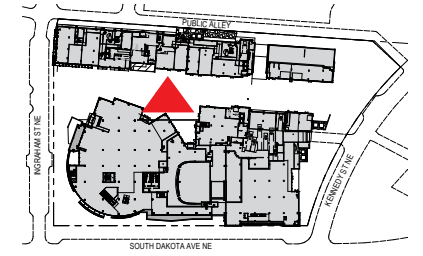

← Revised main lobby entrance & eliminate amenity terrace



APPROVED

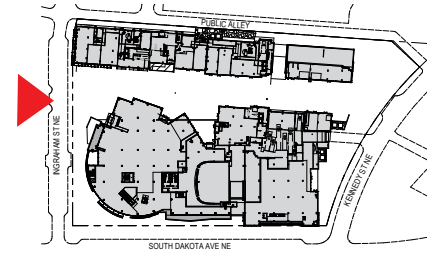

PROPOSED

- Revise palette based on more neutral colors
- Reduce height of “FEZ” by two stories and introduce terraces on 4th Street plaza
- Eliminate stone “fort” on conrer of Ingraham and 4th Street



INTENTIONALLY BLANK