

EROSION AND SEDIMENT CONTROL NARRATIVE:  
(PER PROJECT SPECIFIC)

DESCRIPTION OF PREDOMINANT SOIL TYPE:  
(PLEASE PROVIDE THIS INFORMATION)

UNDERGROUND UTILITY WORK

1. WHEN CONDUCTING UNDERGROUND UTILITY WORK DO NOT OPEN MORE THAN FIVE HUNDRED LINEAR FEET (500 FT) OF TRENCH AT ANY ONE TIME.
2. FILTER WATER PUMPED OUT OF TRENCH EXCAVATIONS PRIOR TO DISCHARGING TO THE STORM SEWER SYSTEM.
3. PLACE EXCAVATED MATERIAL FOR UTILITY WORK ON THE UPHILL SIDE OF A TRENCH.
4. INSTALL, INTERIOR OR PERMANENT STABILIZATION IMMEDIATELY AFTER A UTILITY TRENCH IS REPLED.
5. USE MULCH AND MATING ON EXCAVATED MATERIAL TO MINIMIZE EROSION WHEN NATURAL OR ARTIFICIAL GRASS FILTER STRIPS ARE INSTALLED TO REDUCE STORMWATER RUNOFF FROM THE EXCAVATED MATERIAL.

DUST CONTROL NOTES:

1. THE CONTRACTOR SHALL CONDUCT OPERATIONS AND MAINTAIN THE PROJECT SITE AS TO MINIMIZE THE CREATION AND DISPERSION OF DUST. DUST CONTROL SHALL BE USED THROUGHOUT THE WORK AT THE SITE.
2. THE CONTRACTOR MUST PROVIDE CLEAN WATER, FREE FROM SALT, OIL AND OTHER DELETERIOUS MATERIAL TO BE USED FOR ON-SITE DUST CONTROL.
3. THE CONTRACTOR SHALL SUPPLY WATER SPRAYING EQUIPMENT CAPABLE OF ACCESSING ALL WORK AREAS.
4. THE CONTRACTOR SHALL IMPLEMENT STRICT DUST CONTROL MEASURES DURING ACTIVE CONSTRUCTION PHASES ON-SITE. THESE CONTROL MEASURES WILL GENERALLY CONSIST OF WATER APPLICATIONS THAT SHALL BE APPLIED A MINIMUM OF ONCE PER DAY DURING DRY WEATHER OR MORE OFTEN AS REQUIRED TO PREVENT DUST EMISSIONS.
5. FOR WATER APPLICATION TO UNDISTURBED SOIL SURFACES, THE CONTRACTOR SHALL:
  - A. APPLY WATER WITH EQUIPMENT CONSISTING OF TANK, SPRAY BAR, PUMP WITH DISCHARGE PRESSURE GAUGE.
  - B. ARRANGE SPRAY BAR HEIGHT, NOZZLE SPACING AND SPRAY PATTERN TO PROVIDE COMPLETE COVERAGE OF GROUND WITH WATER.
  - C. DISPERSE WATER THROUGH NOZZLES ON SPRAY BAR AT 20 PSI (13.8 K PA) MINIMUM. KEEP AREAS DAMP WITHOUT CREATING NUISANCE CONDITIONS SUCH AS FLOODING.
6. FOR WATER APPLICATION TO SOIL SURFACES DURING DEMOLITION AND/OR EXCAVATION, THE CONTRACTOR SHALL:
  - A. APPLY WATER WITH EQUIPMENT CONSISTING OF A TANK, PUMP WITH DISCHARGE GAUGE, HOSES AND MIST NOZZLES.
  - B. LOCATE TANK AND SPRAYING EQUIPMENT SO THAT THE ENTIRE EXCAVATION AREA CAN BE WETTED WITHOUT INTERFERING WITH DEMOLITION AND/OR EXCAVATION EQUIPMENT OR OPERATIONS. KEEP AREAS DAMP WITHOUT CREATING NUISANCE CONDITIONS SUCH AS FLOODING.
  - C. APPLY WATER SPRAY IN A MANNER TO PREVENT MOVEMENT OF SPRAY BEYOND SITE BOUNDARIES.
  - D. APPLY WATER WITH EQUIPMENT CONSISTING OF A TANK, PUMP WITH DISCHARGE GAUGE, HOSES AND MIST NOZZLES.
  - E. LOCATE TANK AND SPRAYING EQUIPMENT SO THAT THE ENTIRE EXCAVATION AREA CAN BE WETTED WITHOUT INTERFERING WITH DEMOLITION AND/OR EXCAVATION EQUIPMENT OR OPERATIONS. KEEP AREAS DAMP WITHOUT CREATING NUISANCE CONDITIONS SUCH AS FLOODING.
  - F. APPLY WATER SPRAY IN A MANNER TO PREVENT MOVEMENT OF SPRAY BEYOND SITE BOUNDARIES.

CONSTRUCTION AND STABILIZATION SEQUENCE:

1. INSTALL SEDIMENT AND EROSION CONTROL MEASURES INCLUDING STRAW BALE DITCH, INLET PROTECTION, SUMP PITS, PORTABLE SEDIMENT TANK, STABILIZED CONSTRUCTION ENTRANCE WITH WASH RACK, TREE PROTECTION, AND SILT FENCE AS INDICATED ON SHEET.
2. THE CONTRACTOR SHALL MAINTAIN THE PROPOSED CONSTRUCTION ENTRANCE WITH WASH RACK, TREE PROTECTION, AND SILT FENCE AS INDICATED ON SHEET.
3. THE CONTRACTOR SHALL MAINTAIN THE PROPOSED CONSTRUCTION ENTRANCE WITH WASH RACK, TREE PROTECTION, AND SILT FENCE AS INDICATED ON SHEET.
4. THE CONTRACTOR SHALL MAINTAIN THE PROPOSED CONSTRUCTION ENTRANCE WITH WASH RACK, TREE PROTECTION, AND SILT FENCE AS INDICATED ON SHEET.
5. THE CONTRACTOR SHALL MAINTAIN THE PROPOSED CONSTRUCTION ENTRANCE WITH WASH RACK, TREE PROTECTION, AND SILT FENCE AS INDICATED ON SHEET.
6. THE CONTRACTOR SHALL MAINTAIN THE PROPOSED CONSTRUCTION ENTRANCE WITH WASH RACK, TREE PROTECTION, AND SILT FENCE AS INDICATED ON SHEET.
7. THE CONTRACTOR SHALL MAINTAIN THE PROPOSED CONSTRUCTION ENTRANCE WITH WASH RACK, TREE PROTECTION, AND SILT FENCE AS INDICATED ON SHEET.
8. THE CONTRACTOR SHALL MAINTAIN THE PROPOSED CONSTRUCTION ENTRANCE WITH WASH RACK, TREE PROTECTION, AND SILT FENCE AS INDICATED ON SHEET.
9. THE CONTRACTOR SHALL MAINTAIN THE PROPOSED CONSTRUCTION ENTRANCE WITH WASH RACK, TREE PROTECTION, AND SILT FENCE AS INDICATED ON SHEET.
10. THE CONTRACTOR SHALL MAINTAIN THE PROPOSED CONSTRUCTION ENTRANCE WITH WASH RACK, TREE PROTECTION, AND SILT FENCE AS INDICATED ON SHEET.

TOTAL SITE AREA:  
TOTAL SITE AREA: 180,170 SF / 4.136 AC

TOTAL VOLUME OF CUT OF BELOW GRADE EXCAVATION:  
TOTAL AREA OF EXCAVATION: \_\_\_\_\_ SF / \_\_\_\_\_ AC  
VOLUME OF CUT: ( ) CYL (AREA) X ( ) FEET (DEPTH)  
VOLUME OF CUT: ( ) CY +/-

TOTAL VOLUME OF CUT / FILL FOR UTILITIES:  
TOTAL AREA OF EXCAVATION: \_\_\_\_\_ SF / \_\_\_\_\_ AC  
VOLUME OF CUT: ( ) CYL (AREA) X ( ) FEET (DEPTH)  
VOLUME OF CUT: ( ) CY +/-

TOTAL AREA OF DISTURBANCE:  
TOTAL AREA OF DISTURBANCE: 474,374 SQUARE FEET OR 10.889 AC

CONSTRUCTION DATES:  
THE PROPOSED WORK DUE TO COMMENCE \_\_\_\_\_ 20\_\_\_\_ AND IS ANTICIPATED TO TAKE APPROXIMATELY \_\_\_\_\_ MONTHS.  
EXACT BEGINNING AND END OF CONSTRUCTION IS TO BE ESTABLISHED BY THE OWNER.

LEGEND	PROPOSED
TEMP CONSTRUCTION ENTRANCE	
WASH RACK	
SILT FENCE	
SUPER SILT FENCE	
INLET PROTECTION	
APPROXIMATE LIMIT OF BELOW GRADE EXCAVATION	
APPROXIMATE LIMIT OF DISTURBANCE	
TREE PROTECTION	
SUMP PUMP	
SEDIMENT TANK	

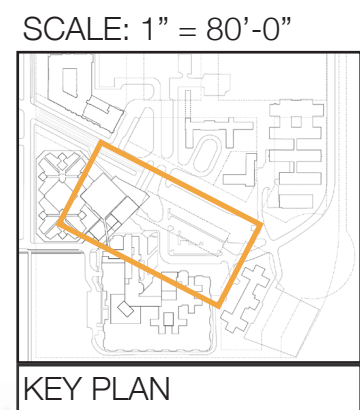
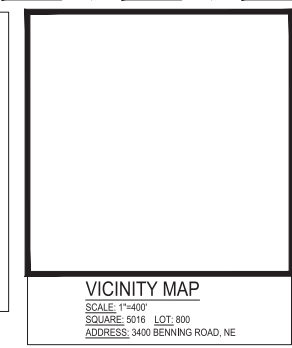



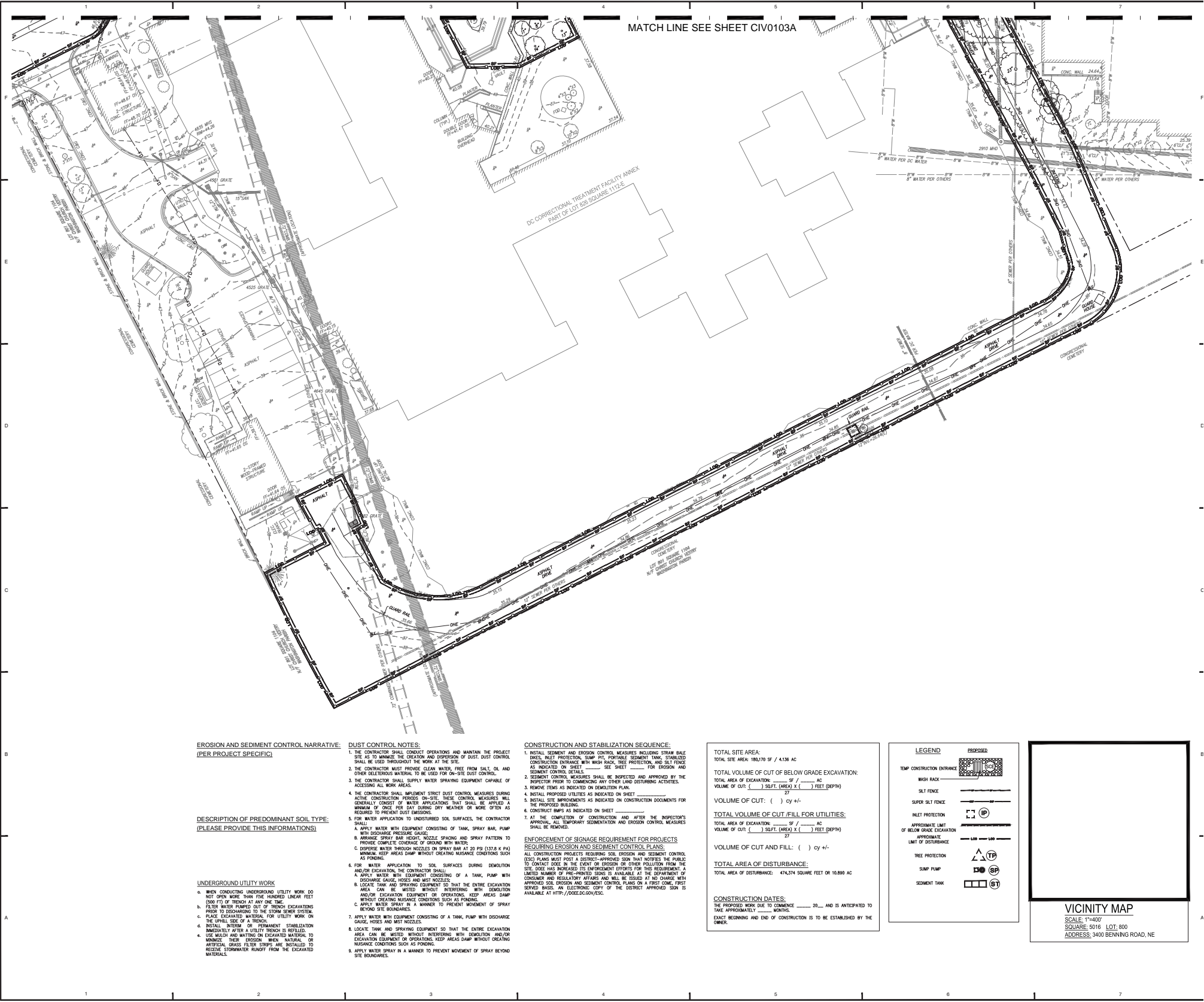

SCALE: 1" = 80'-0"

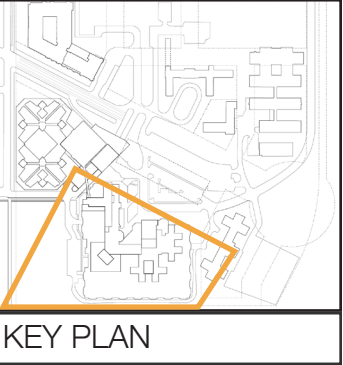



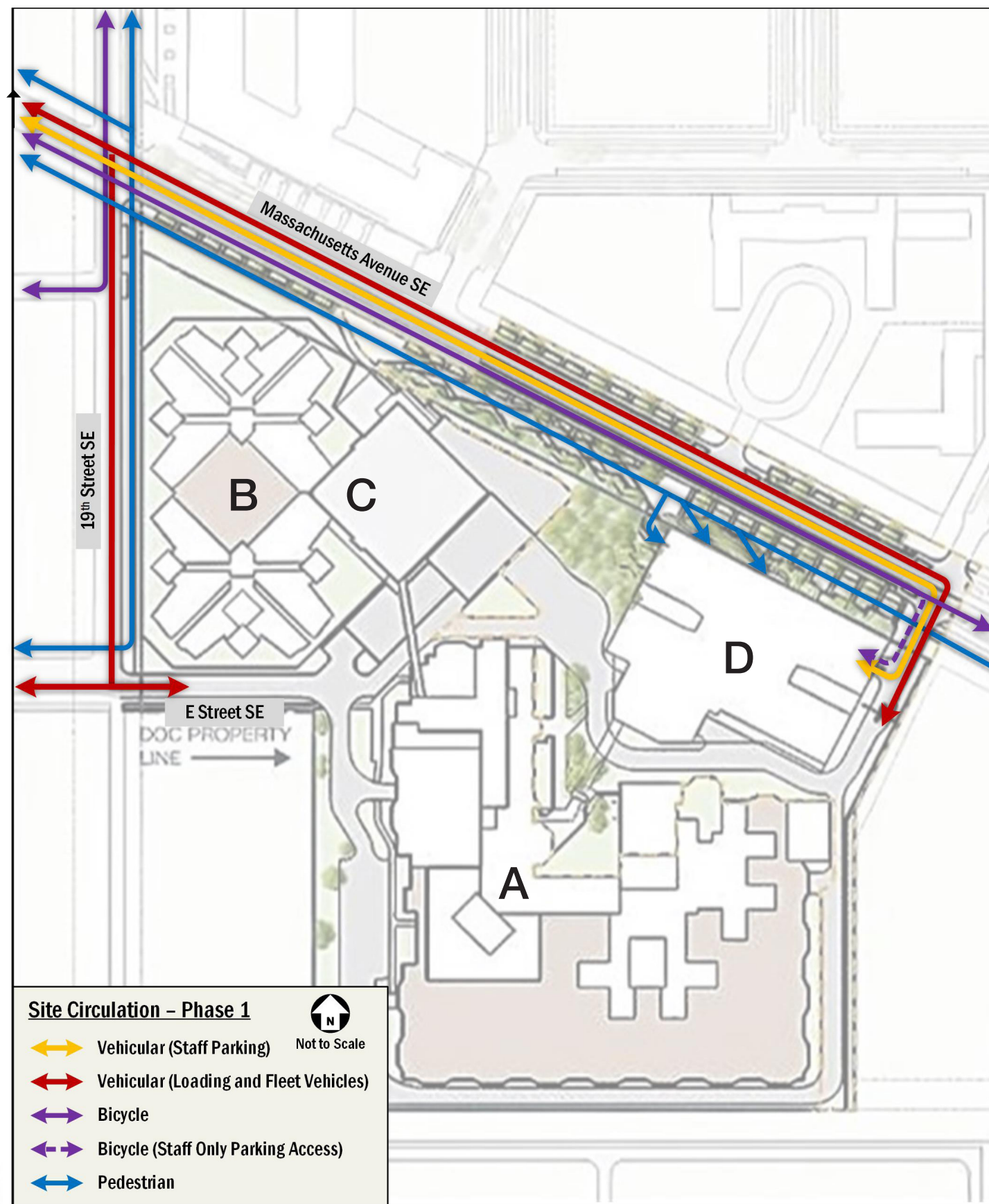

## KEY

- A. Existing Correctional Treatment Facility (CTF)
- B. Existing Central Detention Facility (CDF) (to be discontinued from use in separate scope)
- C. (Not Pictured - Previously Demolished)
- D. New Building 1

- Orange square: Vehicular (Staff Parking)
- Red square: Vehicular (Loading and Fleeting Vehicles)
- Purple square: Bicycle
- Blue square: Pedestrian

NOT TO SCALE

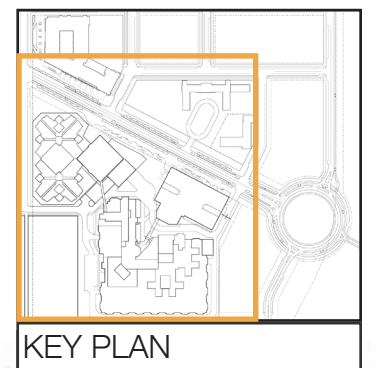



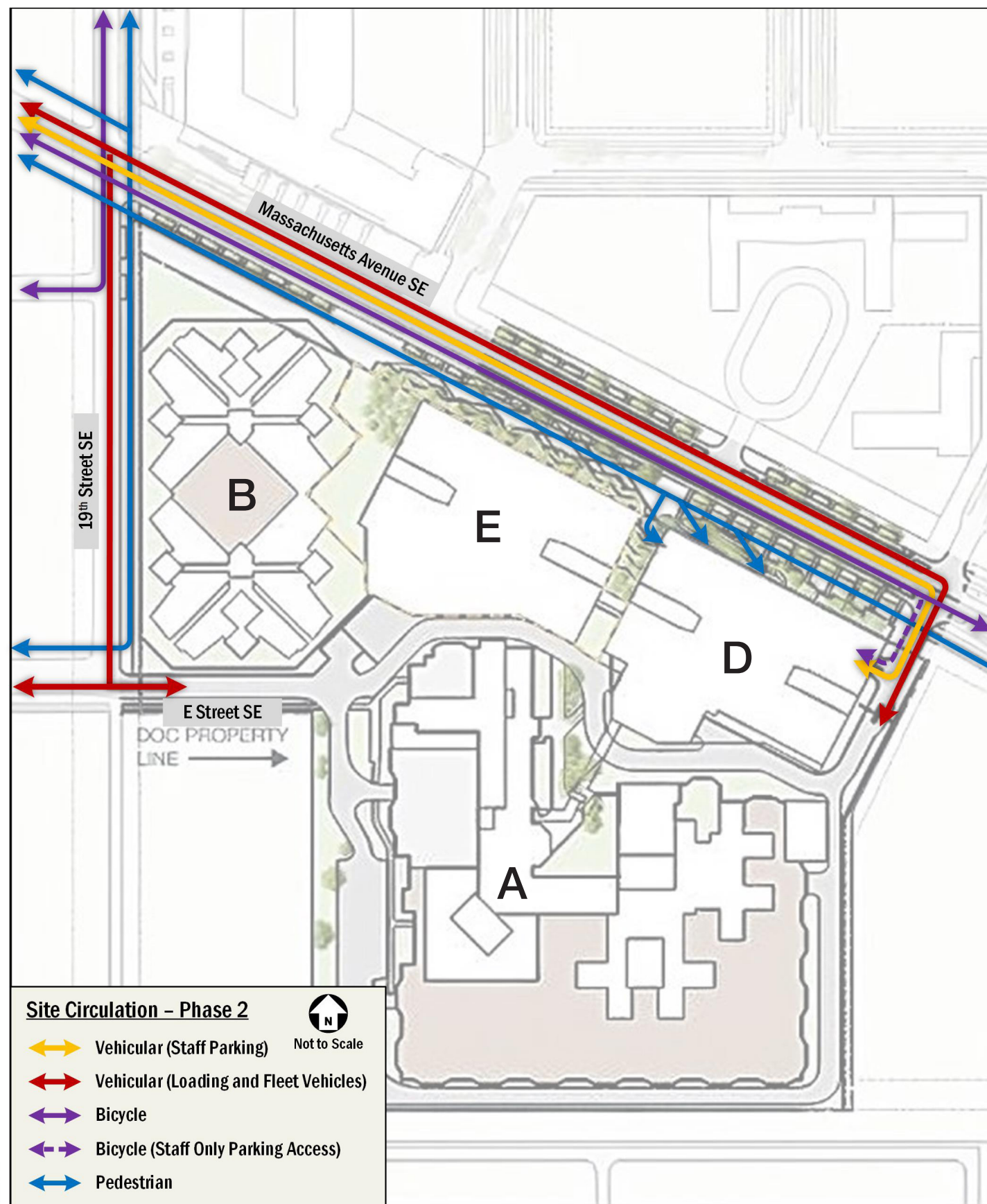

## KEY

- A. Existing Correctional Treatment Facility (CTF)
- B. Existing Central Detention Facility (CDF) (to be discontinued from use in separate scope)
- C. (Not Pictured - Previously Demolished)
- D. New Building 1
- E. New Building 2

- Orange line: Vehicular (Staff Parking)
- Red line: Vehicular (Loading and Fleeting Vehicles)
- Purple line: Bicycle
- Blue line: Pedestrian

NOT TO SCALE

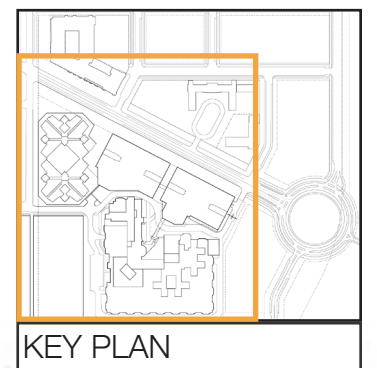



Right Turn from Massachusetts Ave into Site  
SU-40 Truck

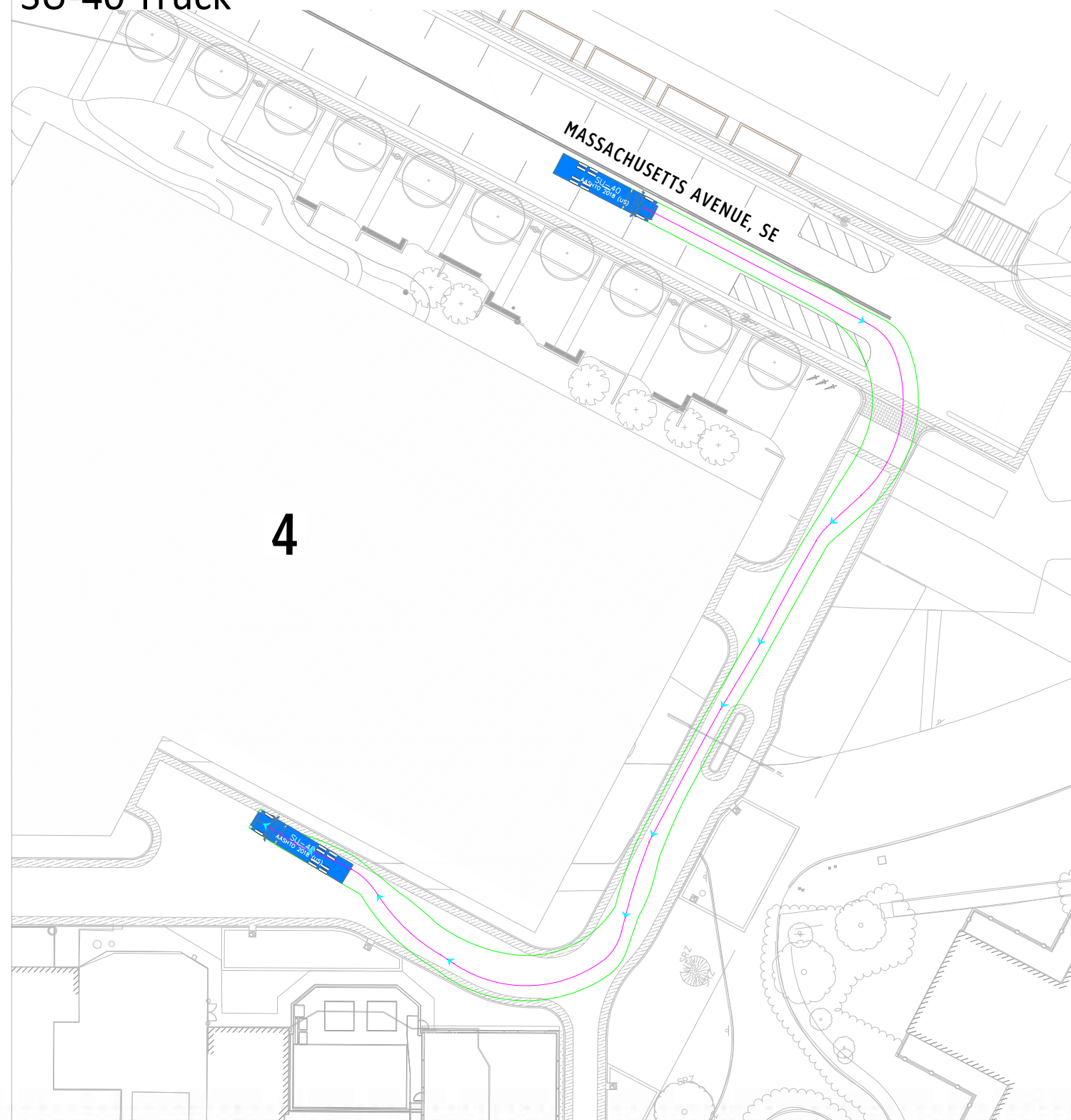

Right Turn from Massachusetts Ave into Site  
S-BUS-36

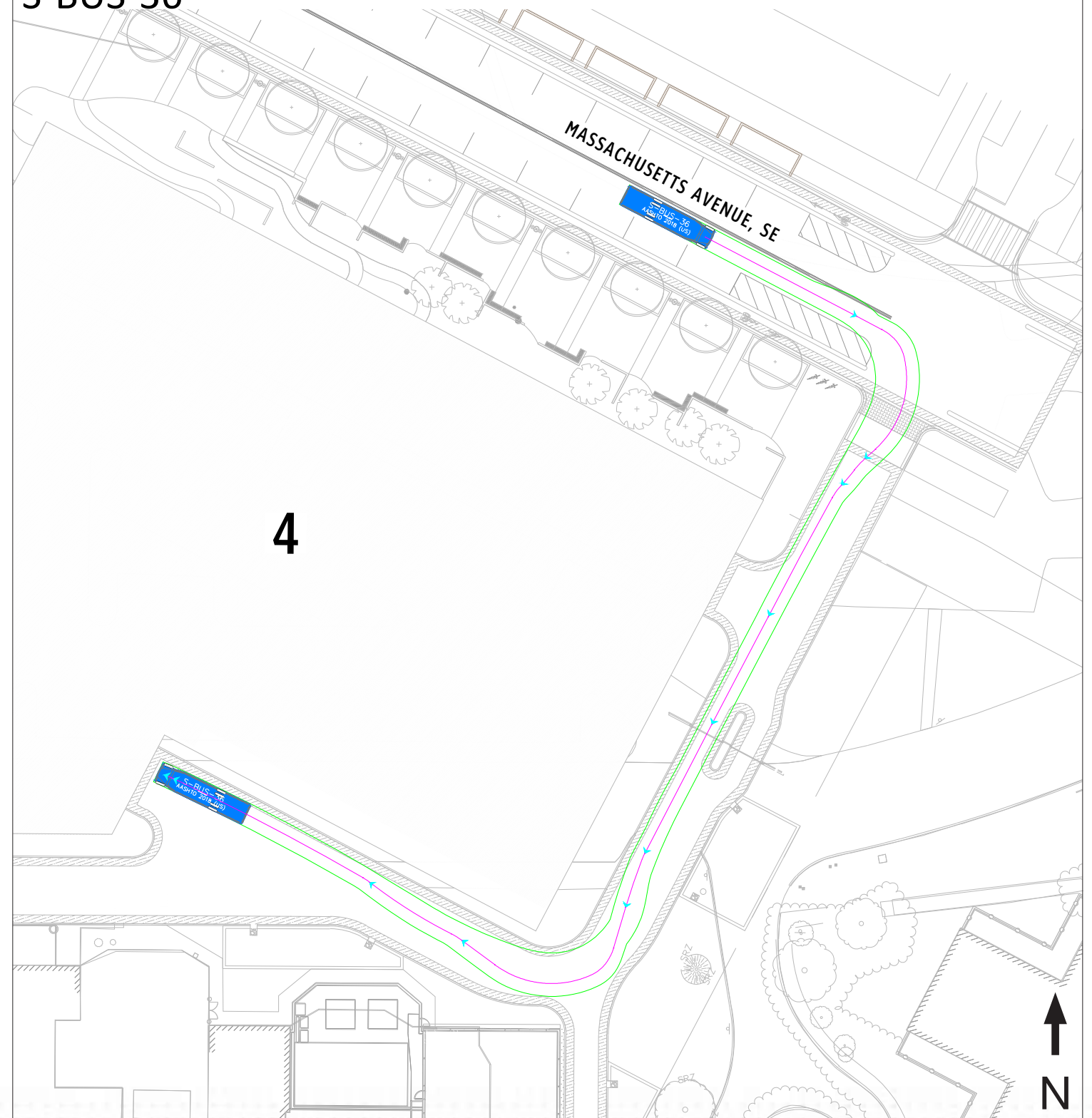



Right Turn from Massachusetts Ave into Site  
Fire Truck (Pumper)

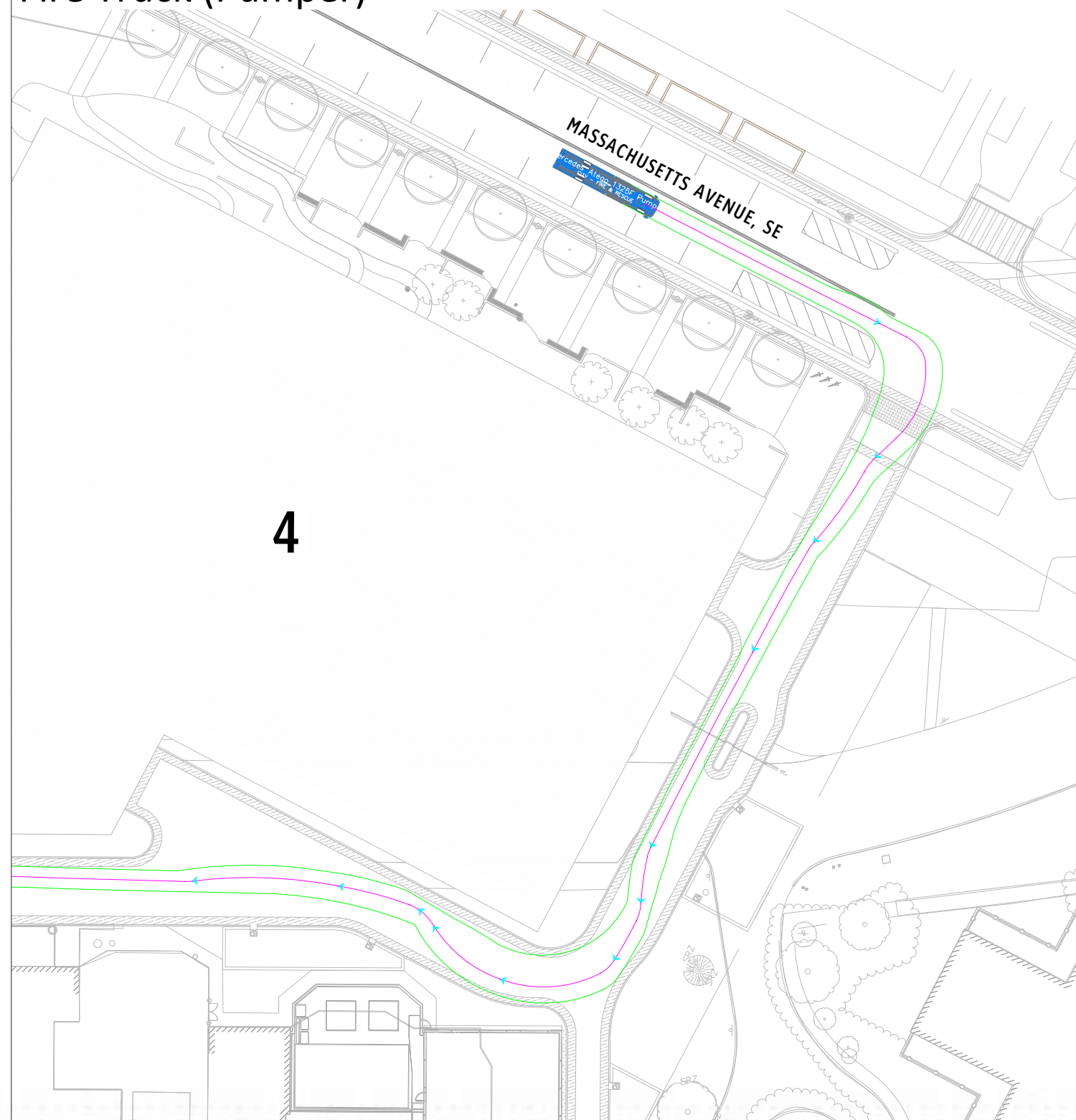

Right Turn from Massachusetts Ave into Site  
Fire Truck (Aerial)

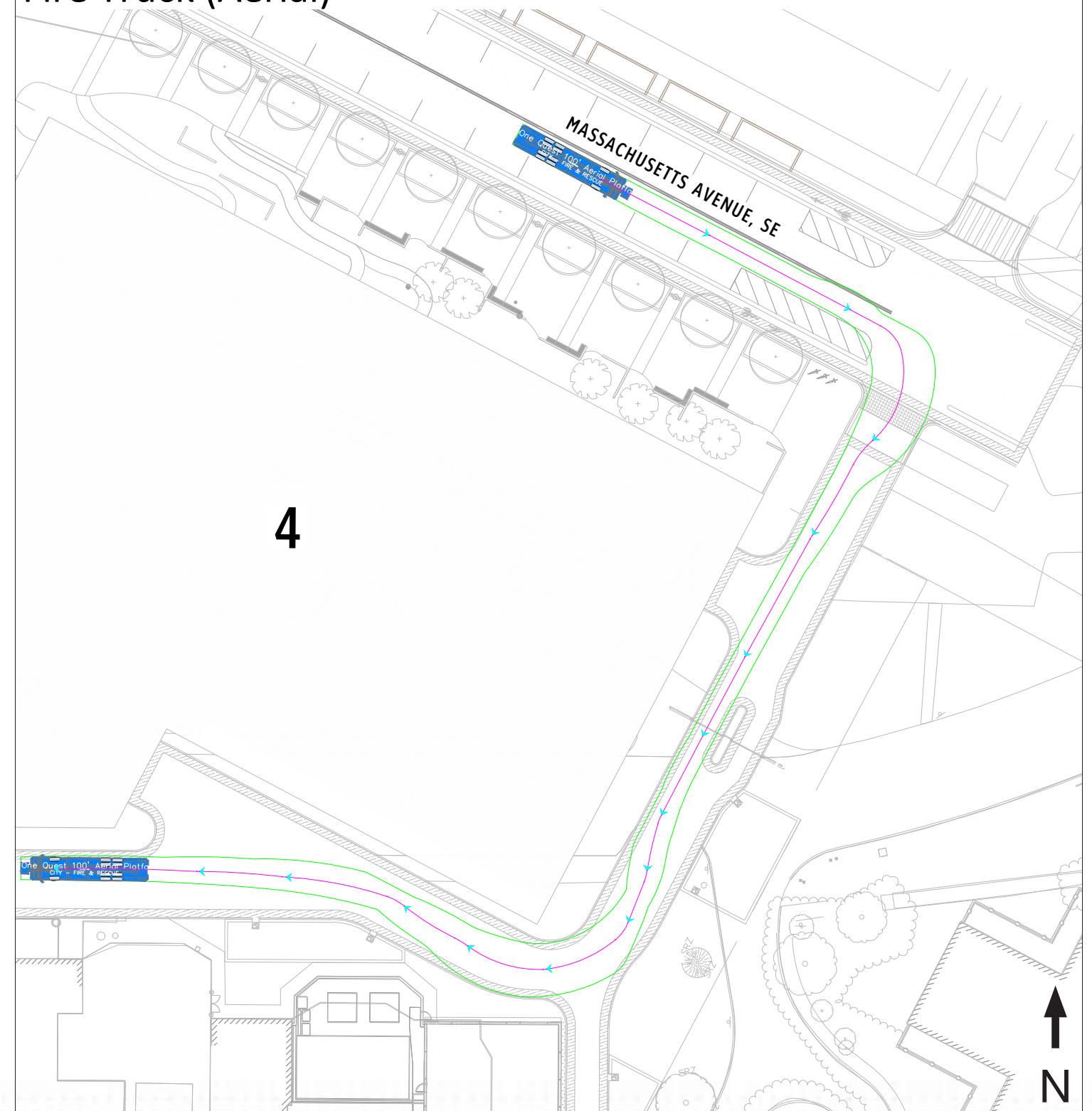

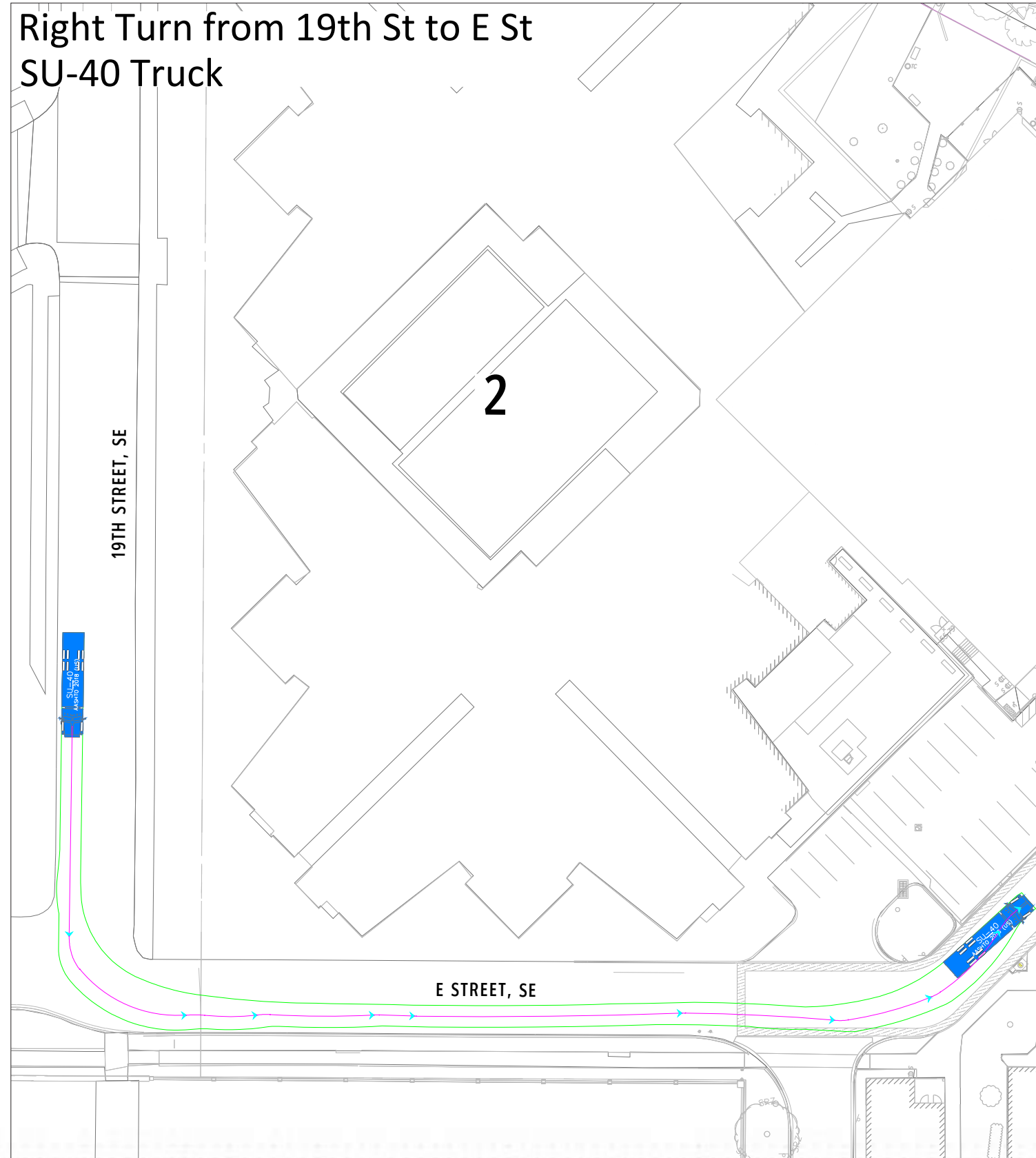



Right Turn from 19th St to E St  
Fire Truck (Pumper)

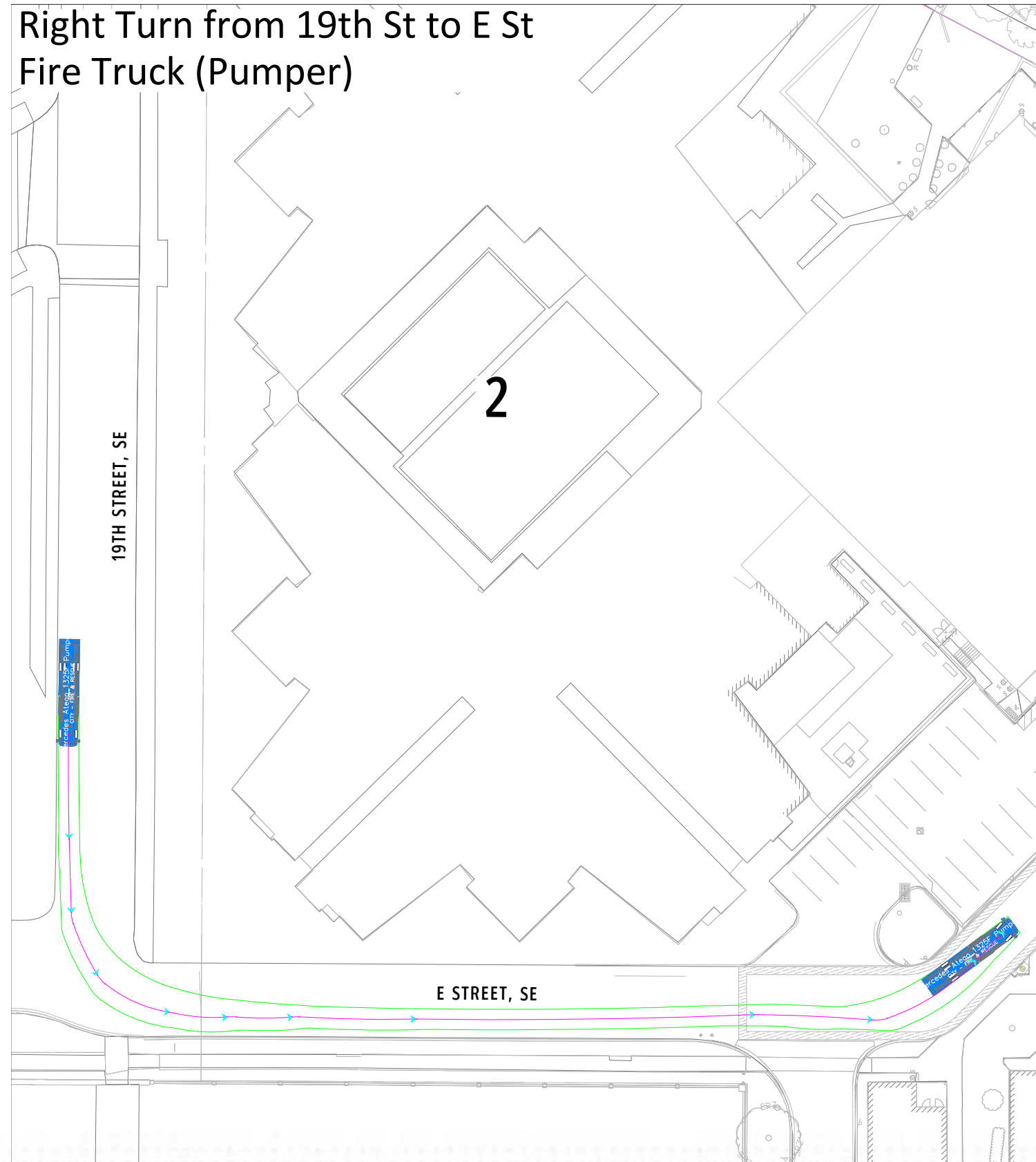

Right Turn from 19th St to E St  
Fire Truck (Aerial)

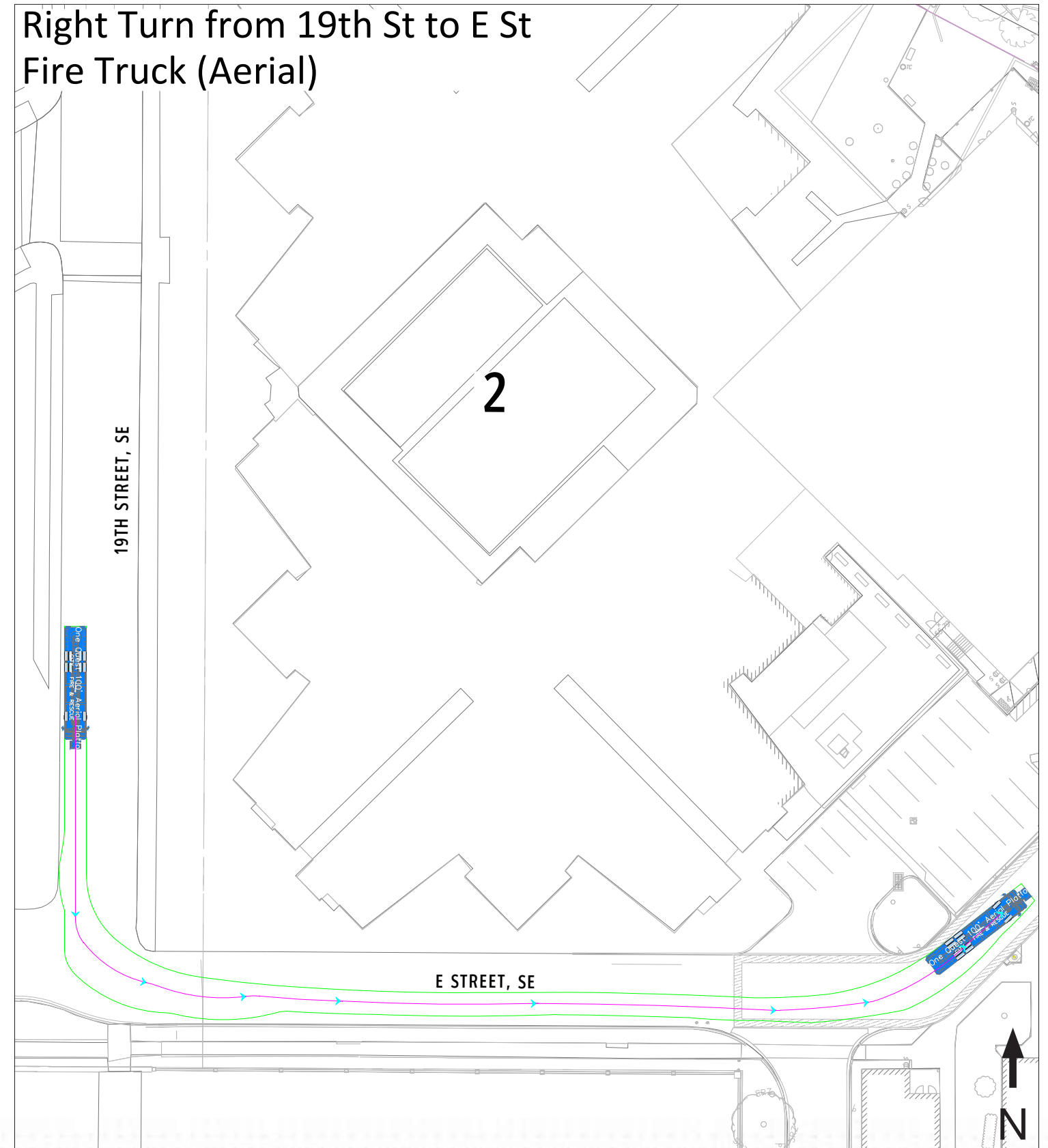



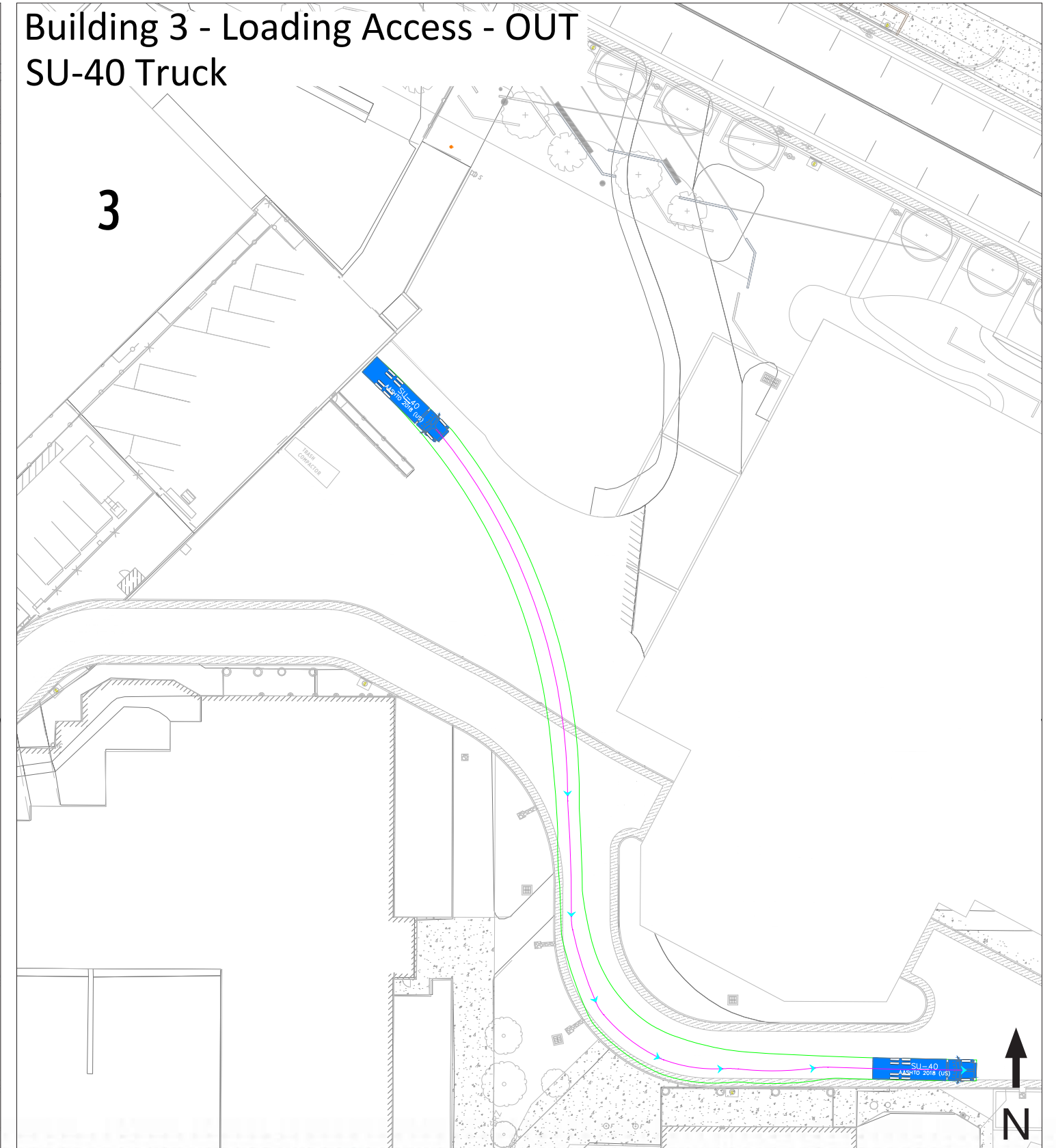
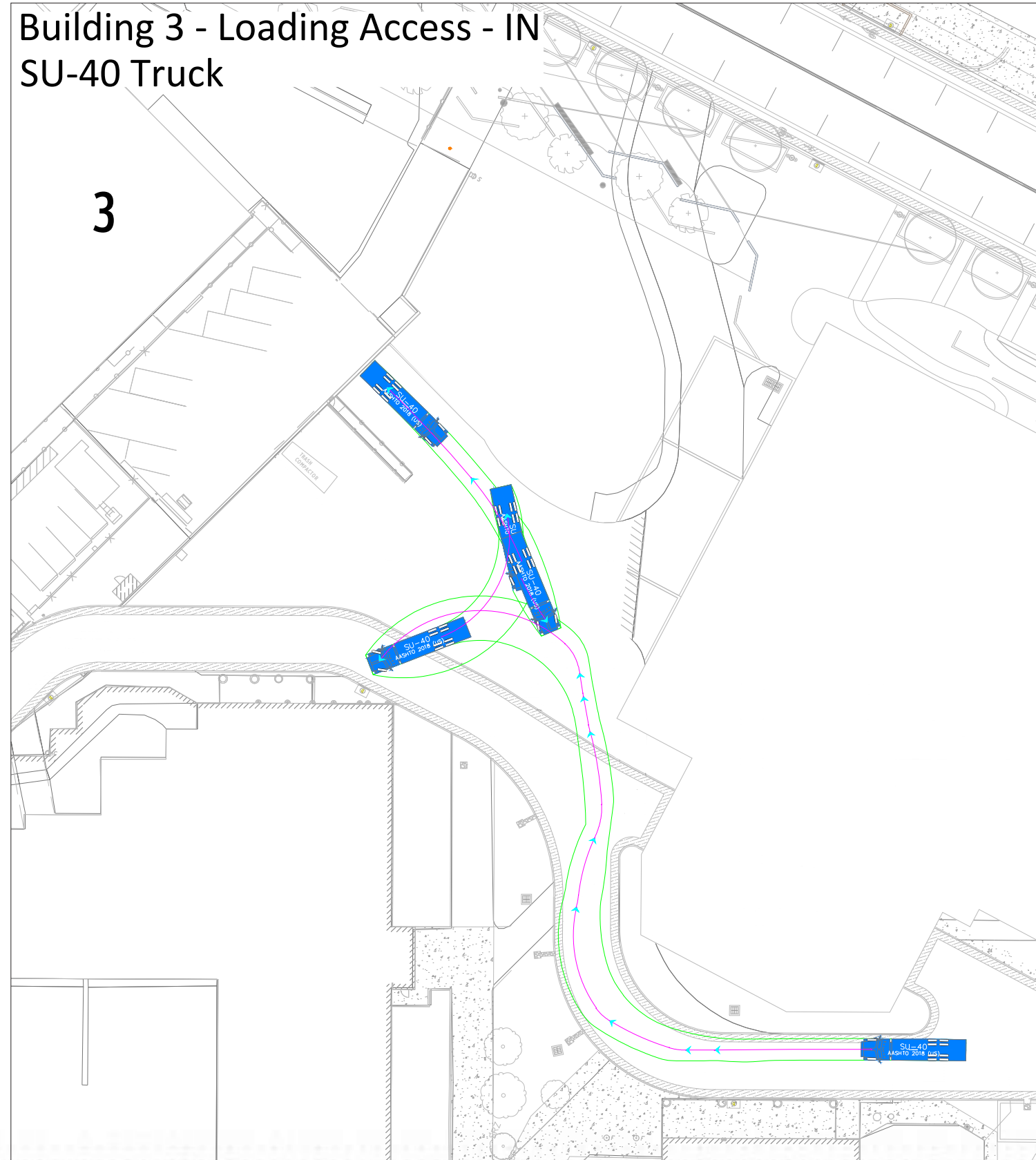



# Left Turn from 19th St to E St to Loading Area 1 SU-40 Truck

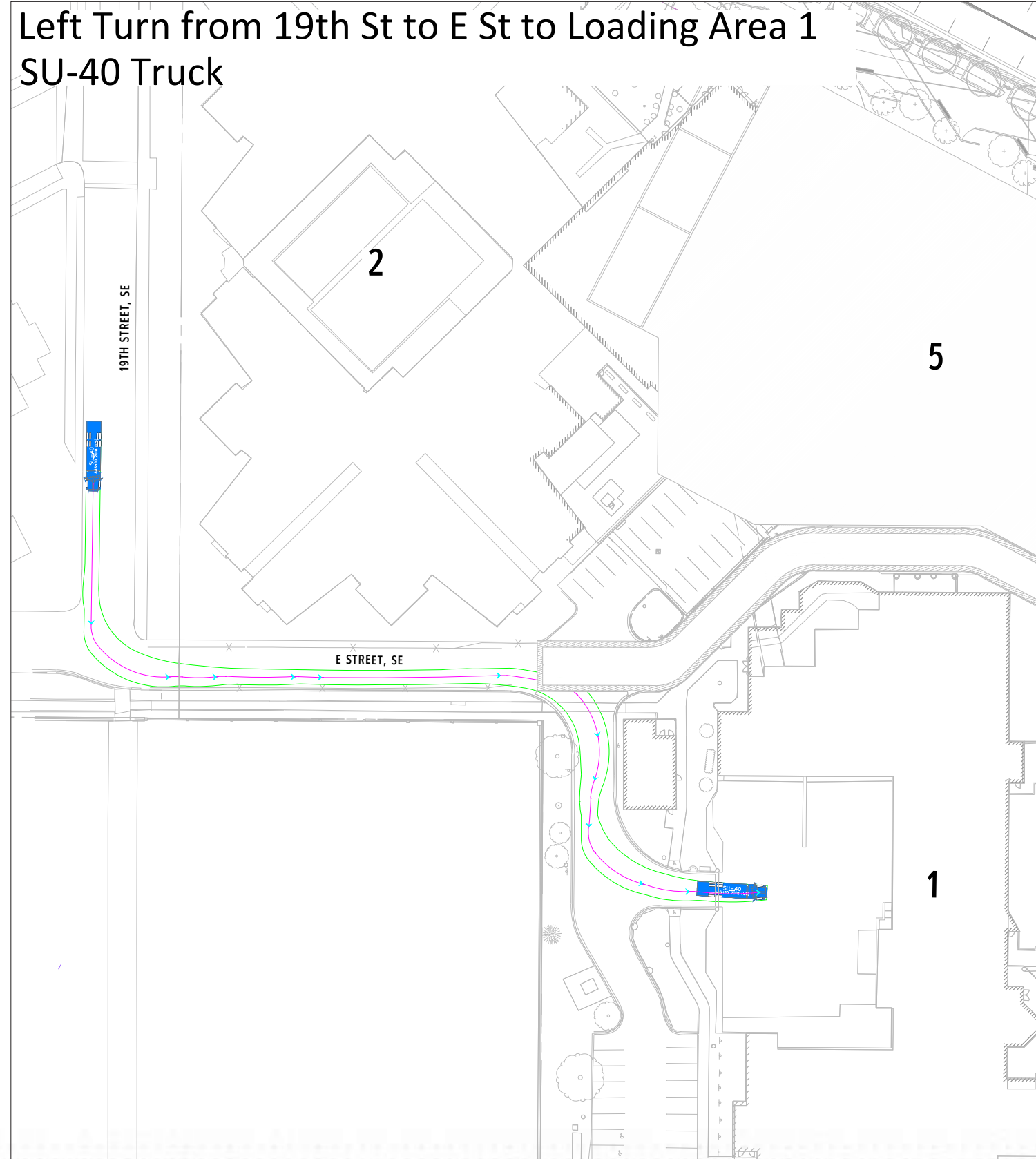



Left Turn from 19th St to E St to Loading Area 1  
Fire Truck (Pumper)

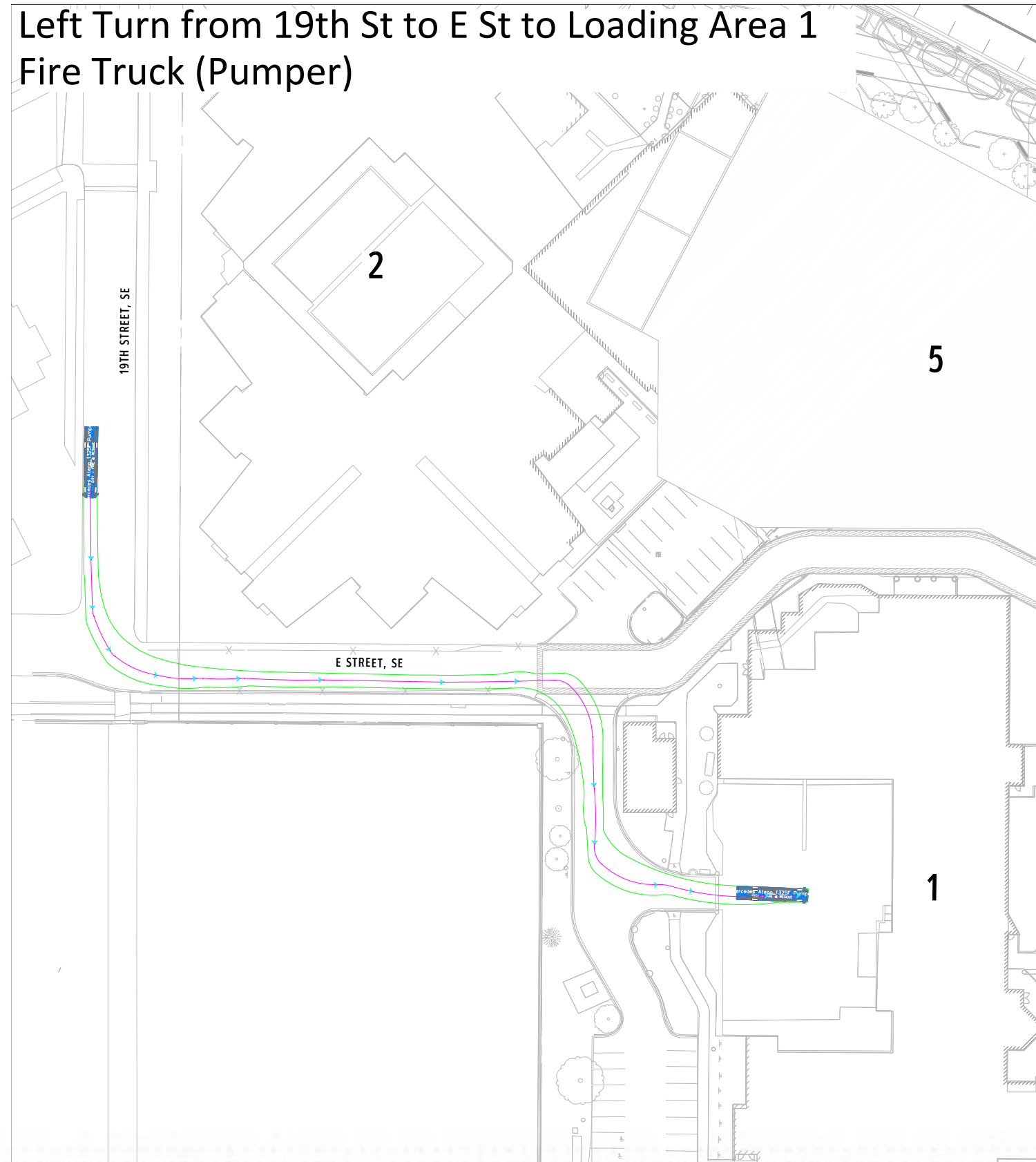

Left Turn from 19th St to E St to Loading Area 1  
Fire Truck (Aerial)

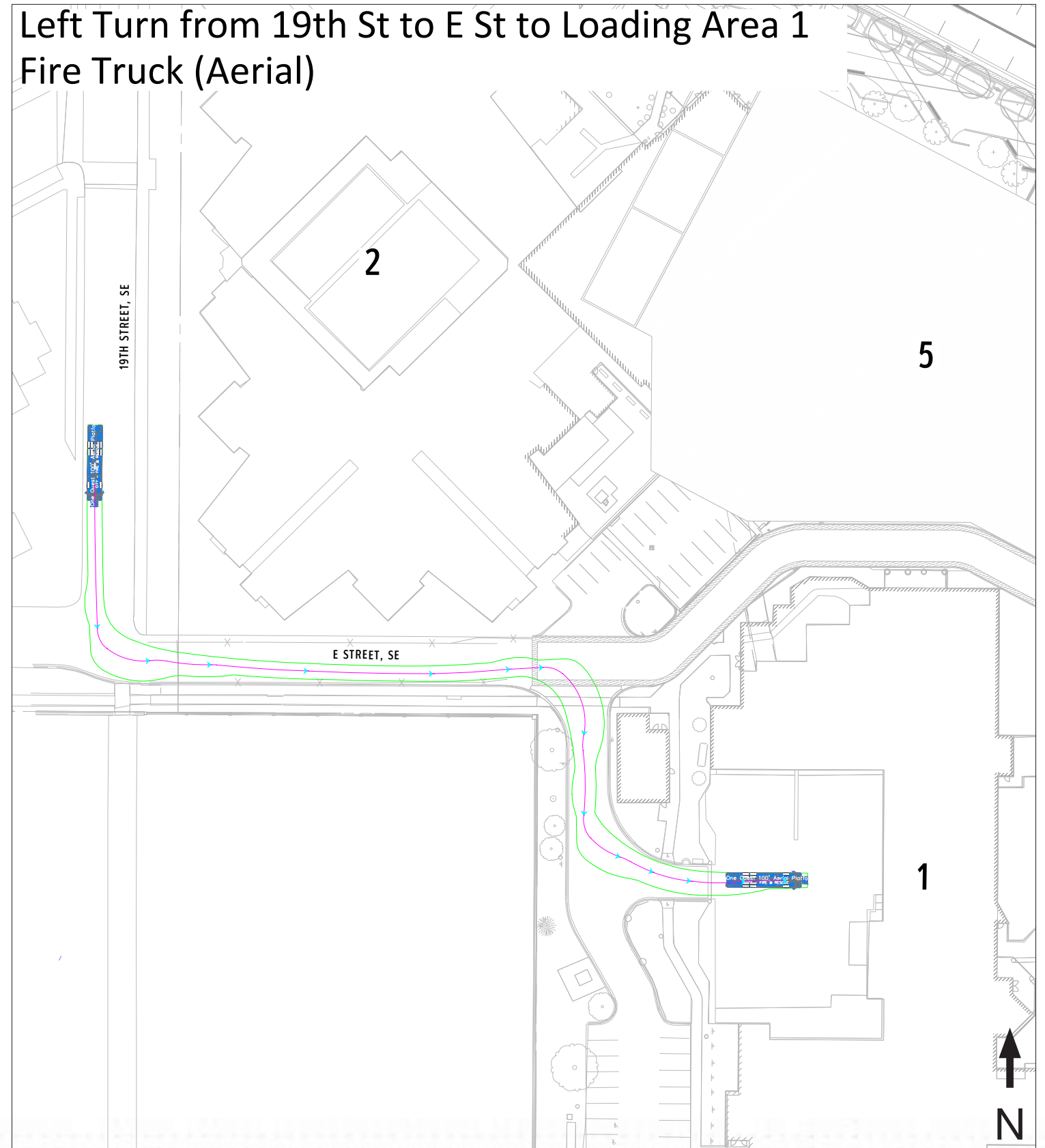



## Building 1 - Loading Access - IN SU-40 Truck

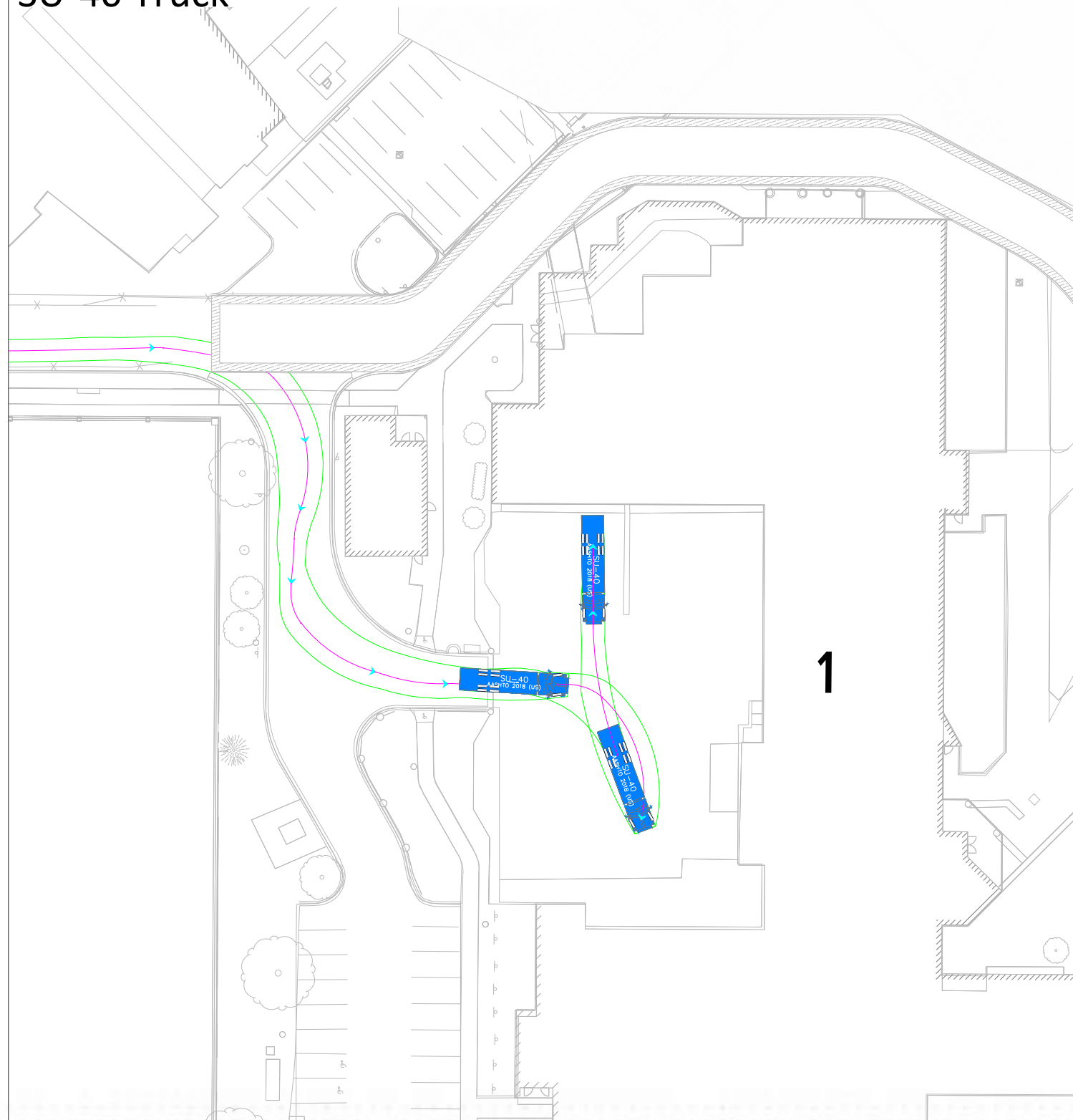

## Building 1 - Loading Access - OUT SU-40 Truck

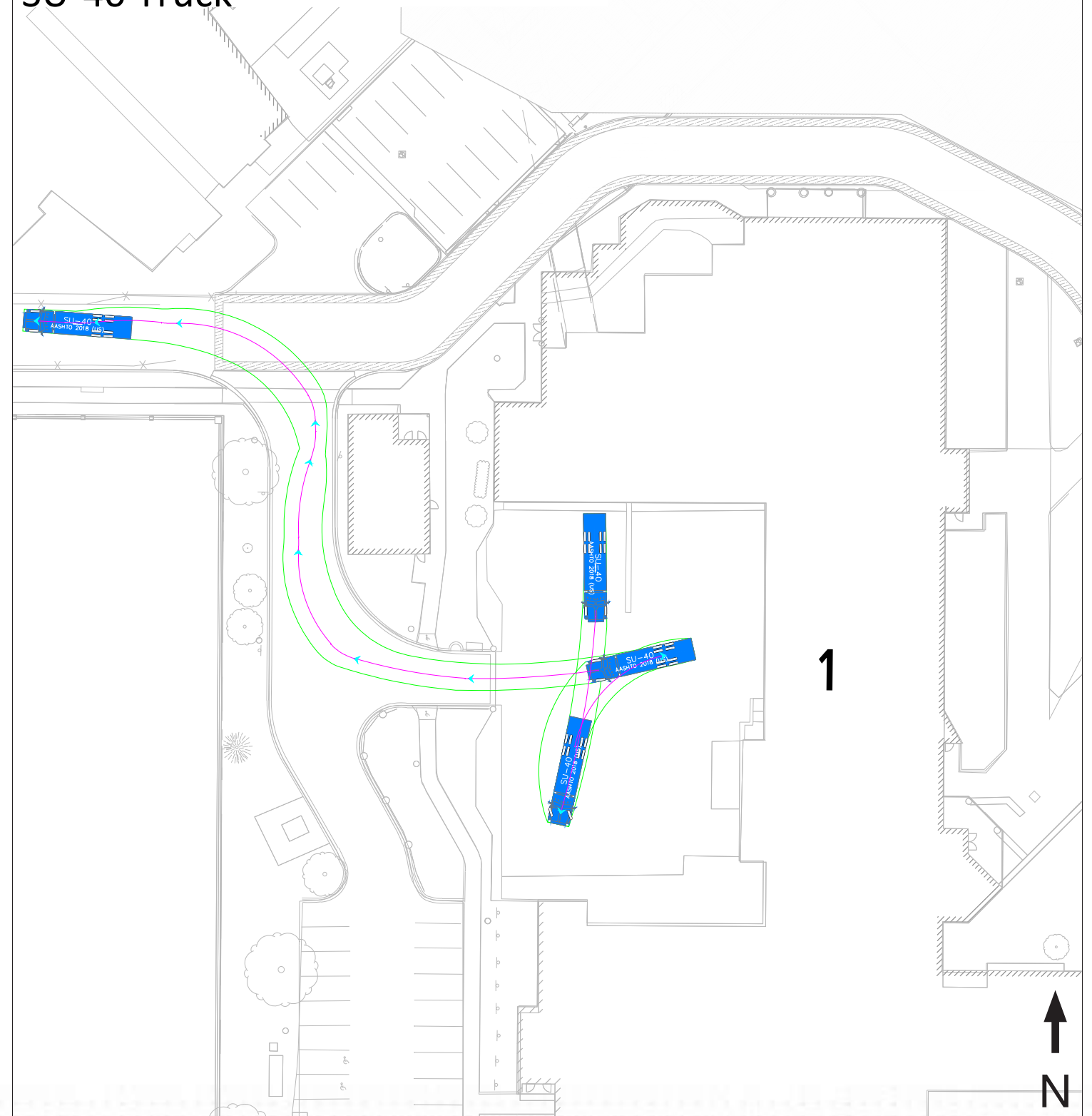



## Building 1 - Loading Access - IN Fire Truck (Pumper)

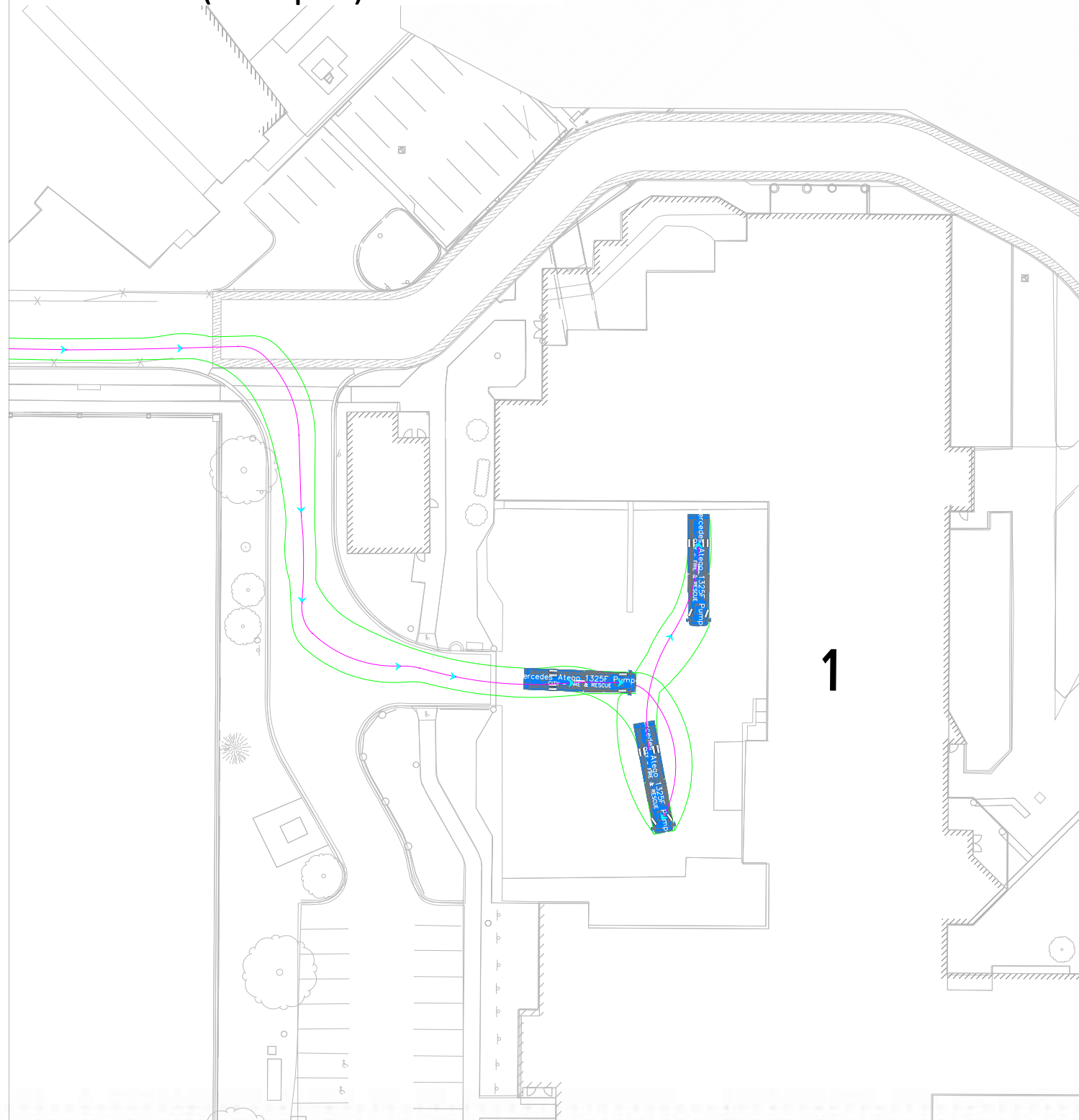

## Building 1 - Loading Access - OUT Fire Truck (Pumper)

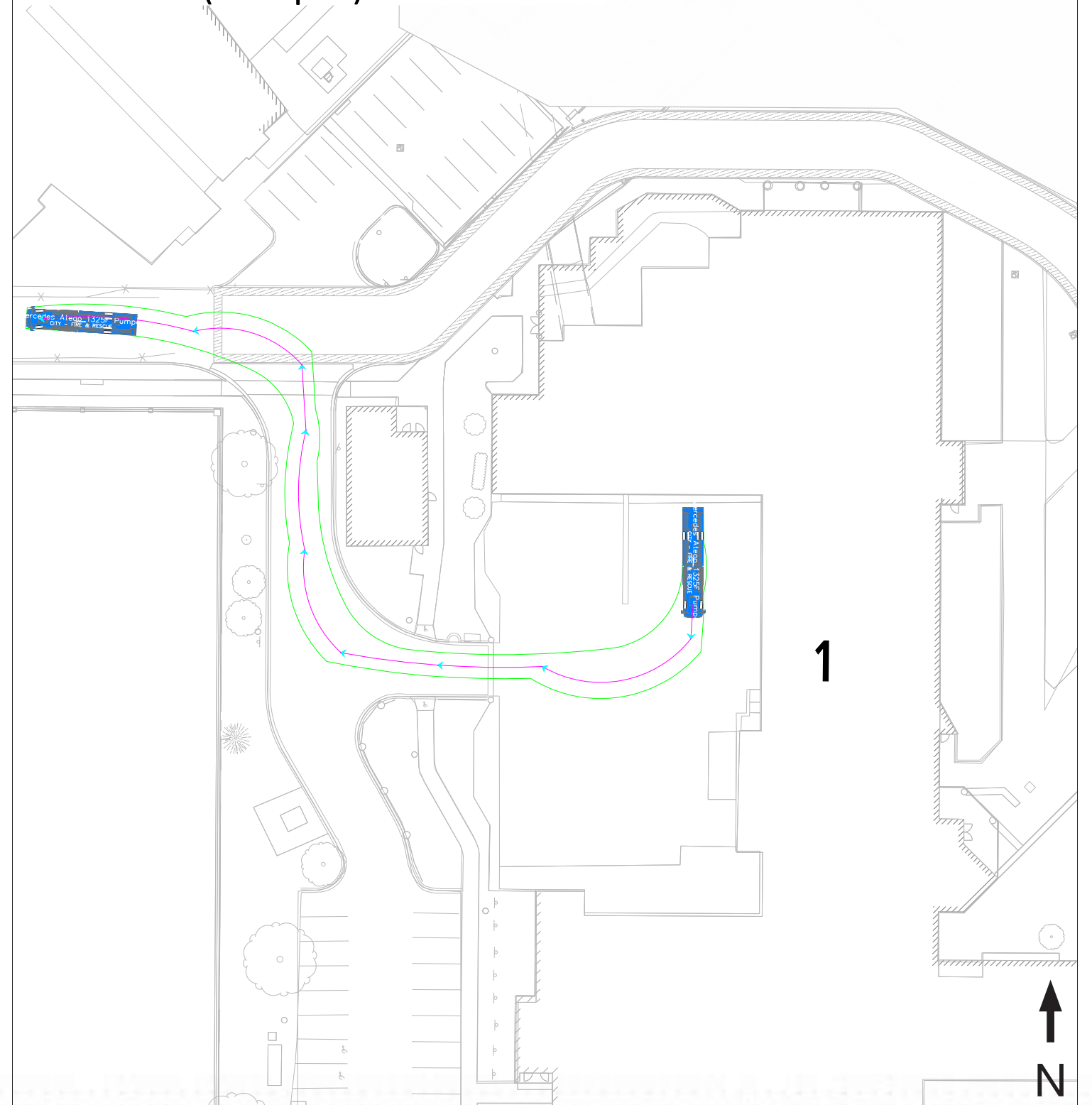



## Building 1 - Loading Access - IN Fire Truck (Aerial)

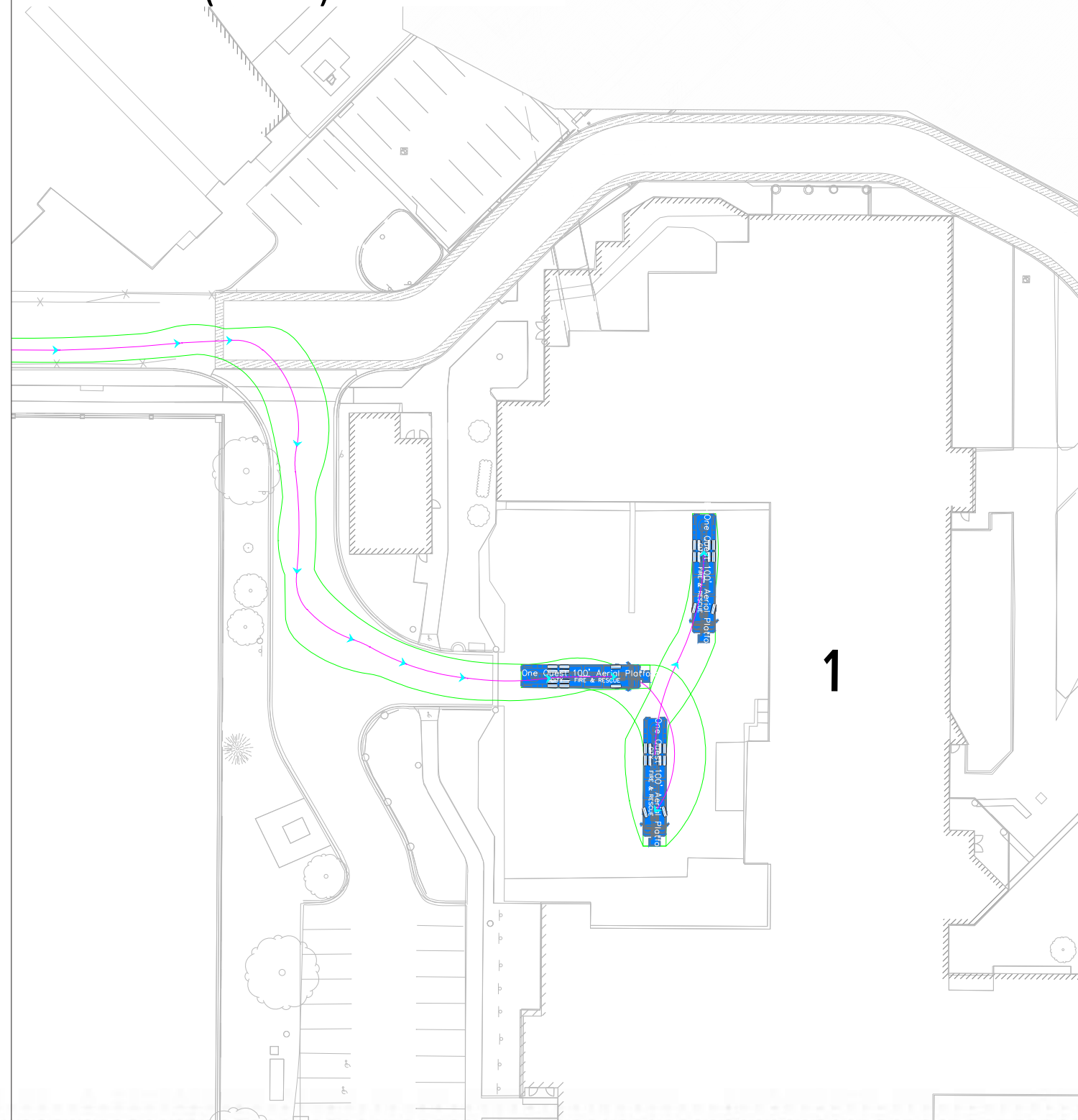

## Building 1 - Loading Access - OUT Fire Truck (Aerial)

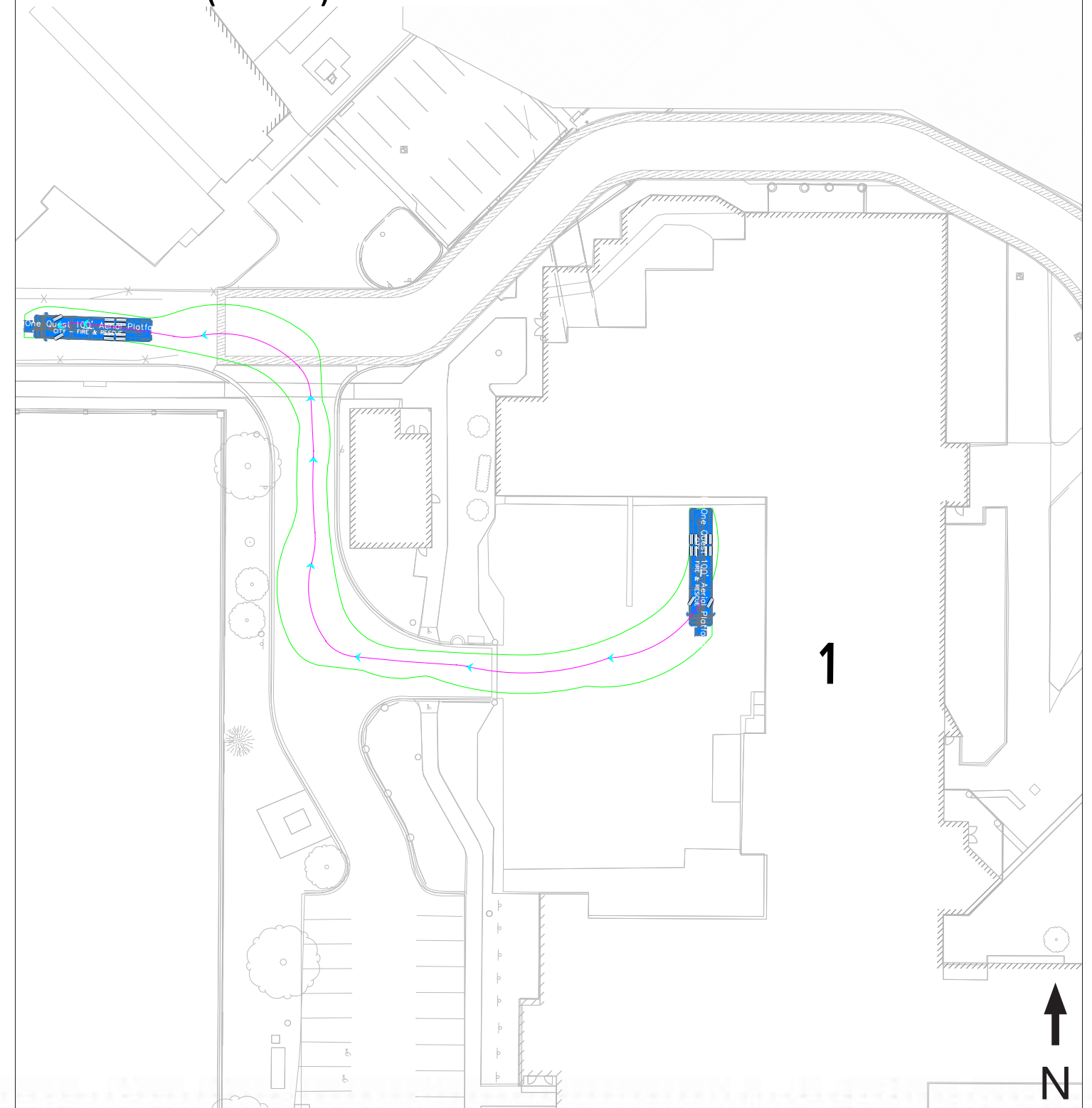

# Fire Truck Internal Circulation Fire Truck (Pumper)

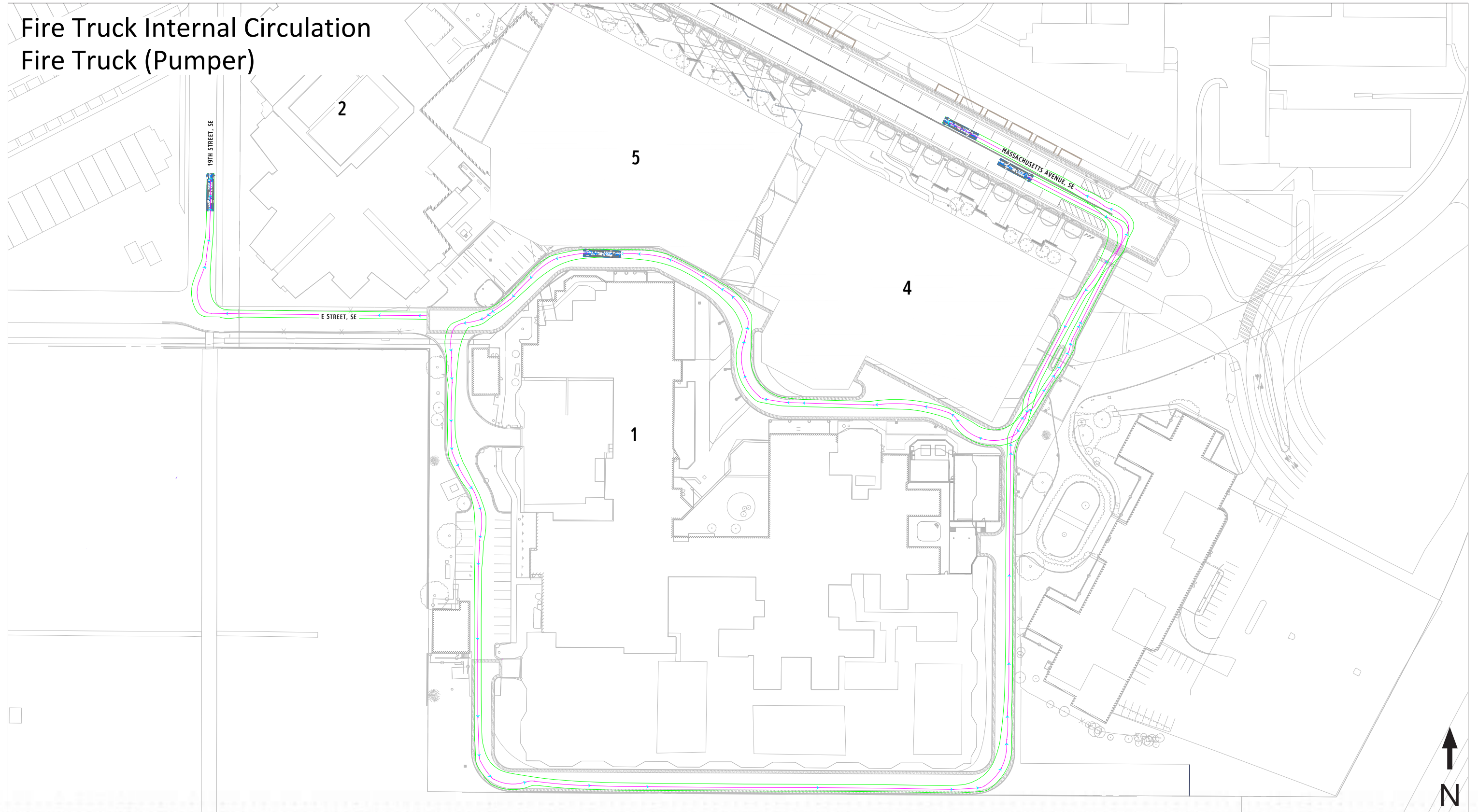



# Fire Truck Internal Circulation Fire Truck (Aerial)

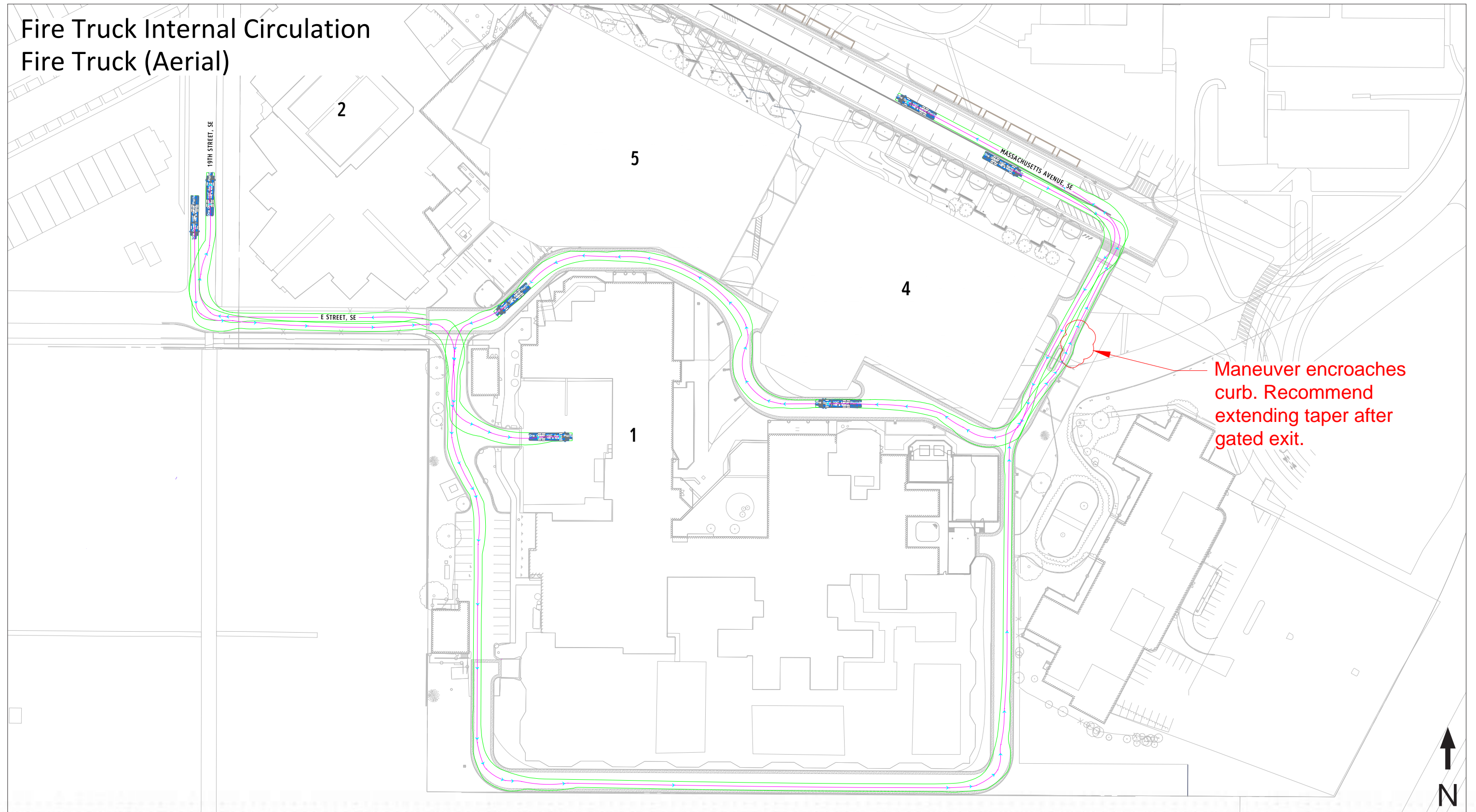

# Fuel Truck Internal Circulation

## Fuel Truck

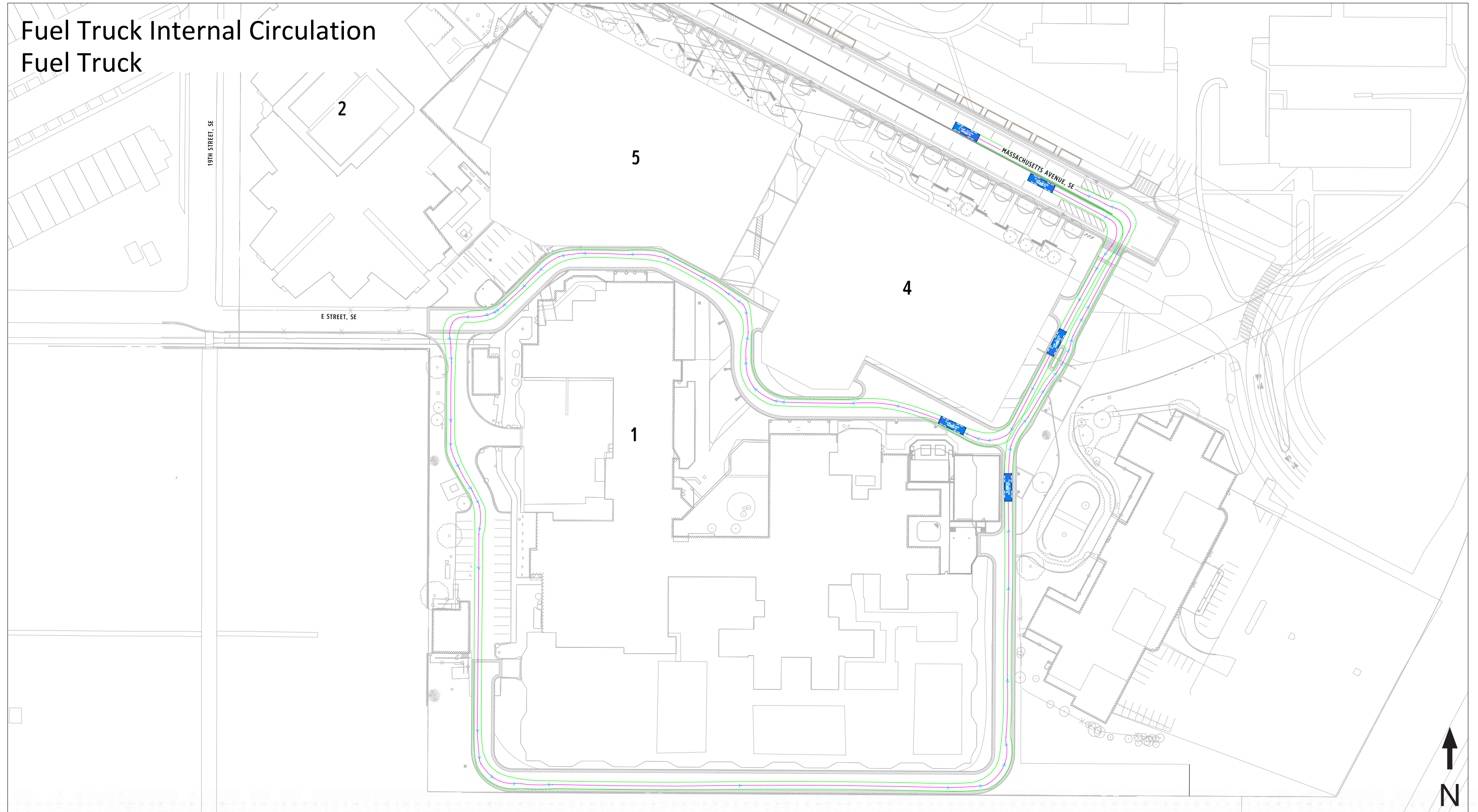



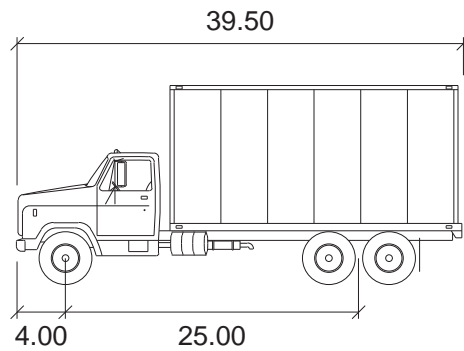

SU-40

	feet
Width	: 8.00
Track	: 8.00
Lock to Lock Time	: 6.0
Steering Angle	: 31.8

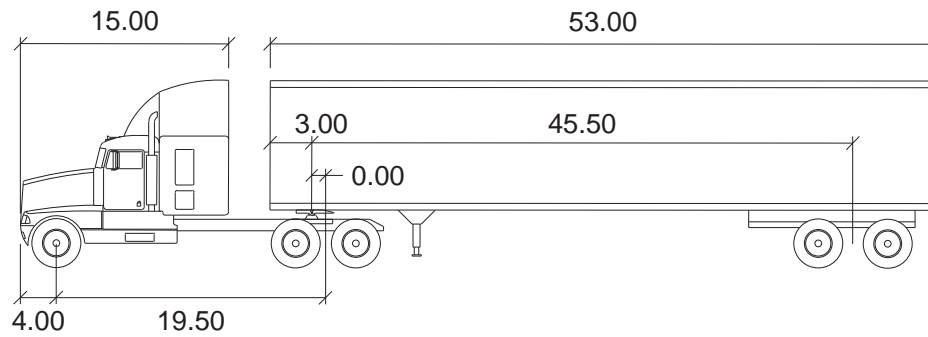

WB-67

	feet		feet
Tractor Width	: 8.00	Lock to Lock Time	: 6.0
Trailer Width	: 8.50	Steering Angle	: 28.4
Tractor Track	: 8.00	Articulating Angle	: 75.0
Trailer Track	: 8.50		

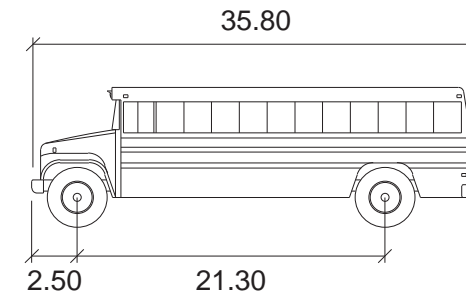

S-BUS-36

	feet
Width	: 8.00
Track	: 8.00
Lock to Lock Time	: 6.0
Steering Angle	: 37.6

#### AutoTurn Notes:

- AutoTurn is a kinematic model and does not account for inertia
- AutoTurn does not account for weather and/or pavement conditions
- AutoTurn cannot compensate for driver error or experience
- Other drivable paths may achieve the same result(s) shown
- AutoTurn is a conservative model but is not a guarantee of exact real time results
- Successful simulation in AutoTurn does not guarantee that a specific driver can achieve the same pathway
- Vehicle dimensions are for standard sized vehicles, actual vehicle dimensions may vary
- Future changes to the design may impact and/or invalidate the results depicted in this exhibit
- Unless noted, AutoTurn does not account for vertical clearance or grade change.

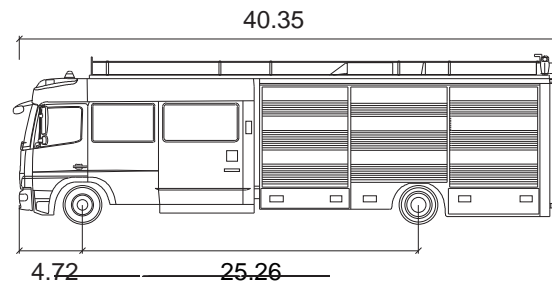

Mercedes Atego 1325F Pumper

	feet
Width	: 7.55
Track	: 7.55
Lock to Lock Time	: 6.0
Steering Angle	: 48.4

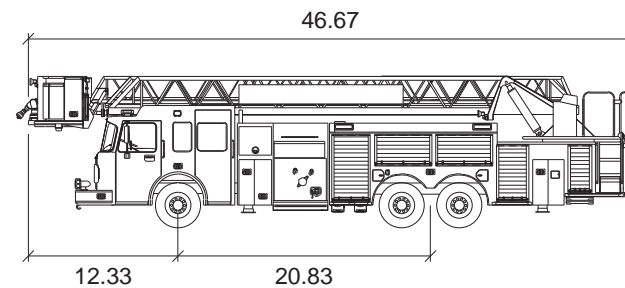

E-One Quest 100' Aerial Platform

	feet
Width	: 8.33
Track	: 8.33
Lock to Lock Time	: 6.0
Steering Angle	: 38.3

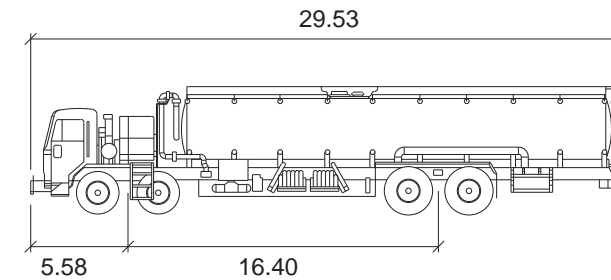

Fuel Truck

	feet
Width	: 8.20
Track	: 8.20
Lock To Lock Time	: 6.0
Steering Angle	: 39.5



#### VEHICLE PROFILES

ZONING COMMISSION | DESIGN REVIEW

D.C. CORRECTIONAL TREATMENT FACILITY ANNEX

D.C. Department of Corrections

Department of General Services

CGL Companies | CORE architecture + design