

KEY MAP

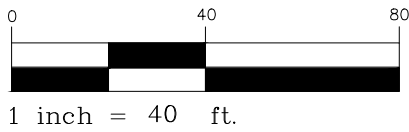

GRAPHIC SCALE



DECEMBER 19, 2023

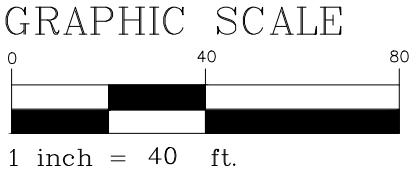
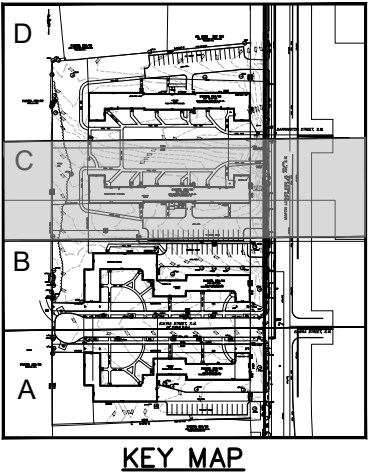
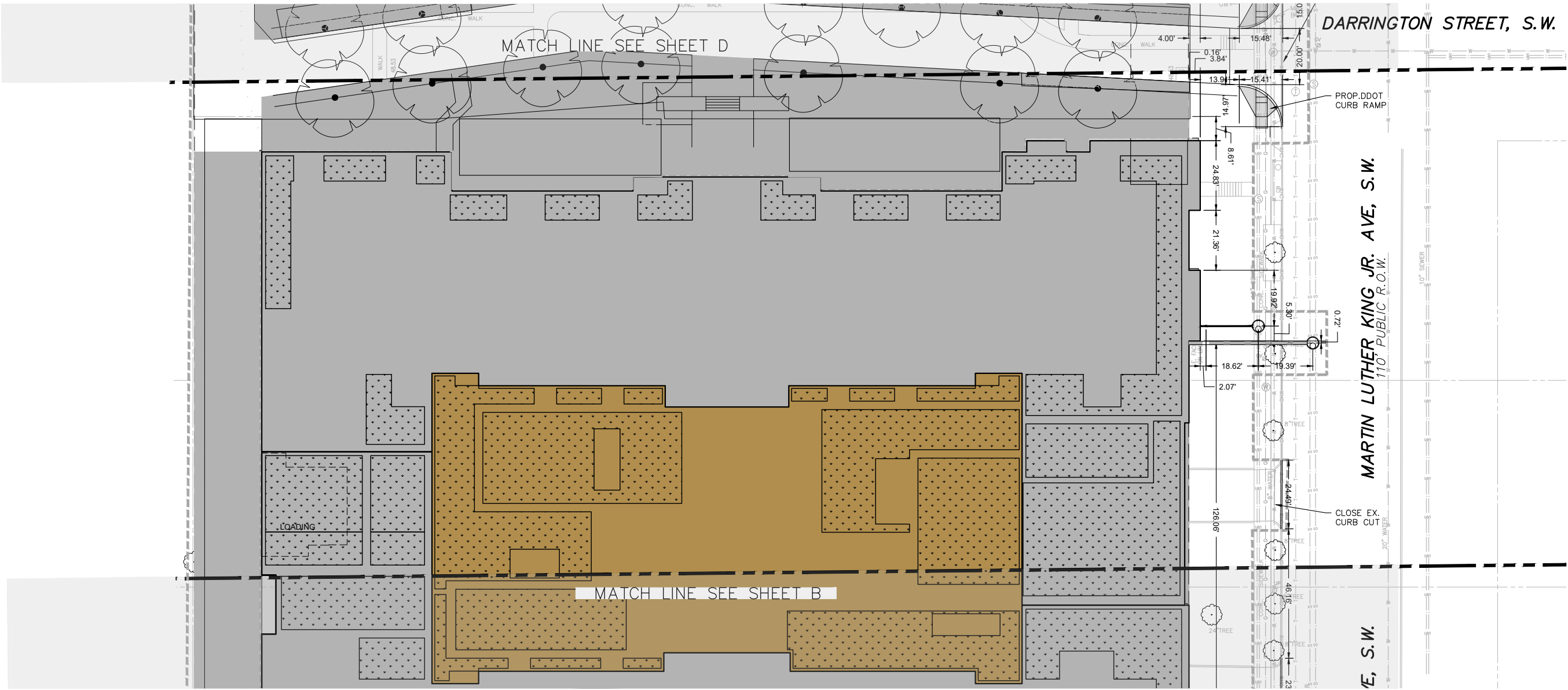



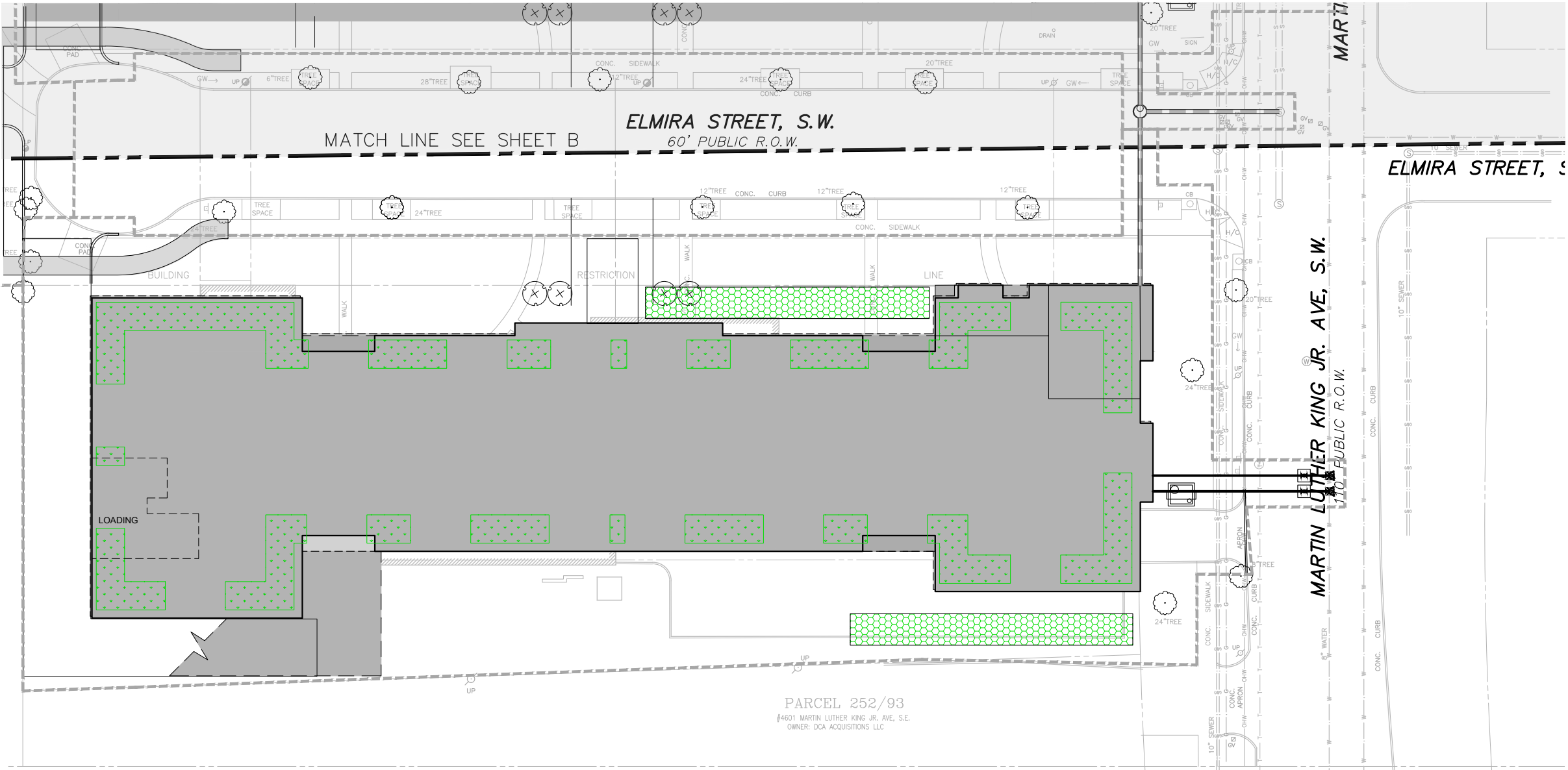

STORMWATER MANAGEMENT LEGEND

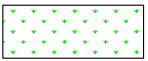

GREEN ROOF

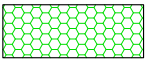

BIORETENTION AREA

NOTE: STORMWATER MANAGEMENT (SWM) FACILITIES AND COMPUTATIONS ARE PRELIMINARY AND SUBJECT TO CHANGE. DURING THE PRODUCTION OF FINAL ENGINEERING CONSTRUCTION DOCUMENTS, THESE FACILITY TYPES AND COMPUTATIONS MAY BE ADJUSTED OR CHANGED BASED ON SITE CONDITIONS. FINAL SWM DESIGN SHALL MEET DOEE REQUIREMENTS.

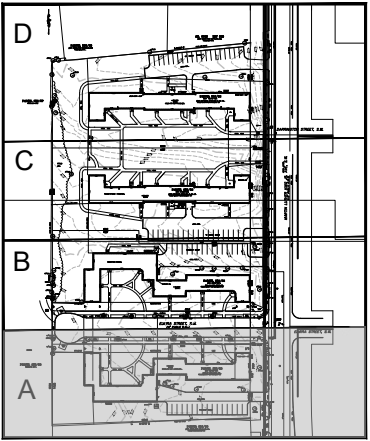

KEY MAP



GRAPHIC SCALE

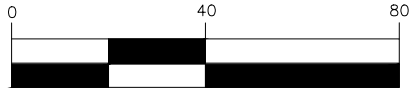

1 inch = 40 ft.

LAYOUT: 0605 SWM A, Plotted By: ruhi

S:\0001-1000\0758A - Martin Luther King Jr. Ave. & Elmira St. SW - PUD Design Package\cadd\preliminary\0758A_100.dwg, ~ Nov 13, 2023 AT 2:51:08 PM

DECEMBER 19, 2023

STORMWATER MANAGEMENT PLAN A

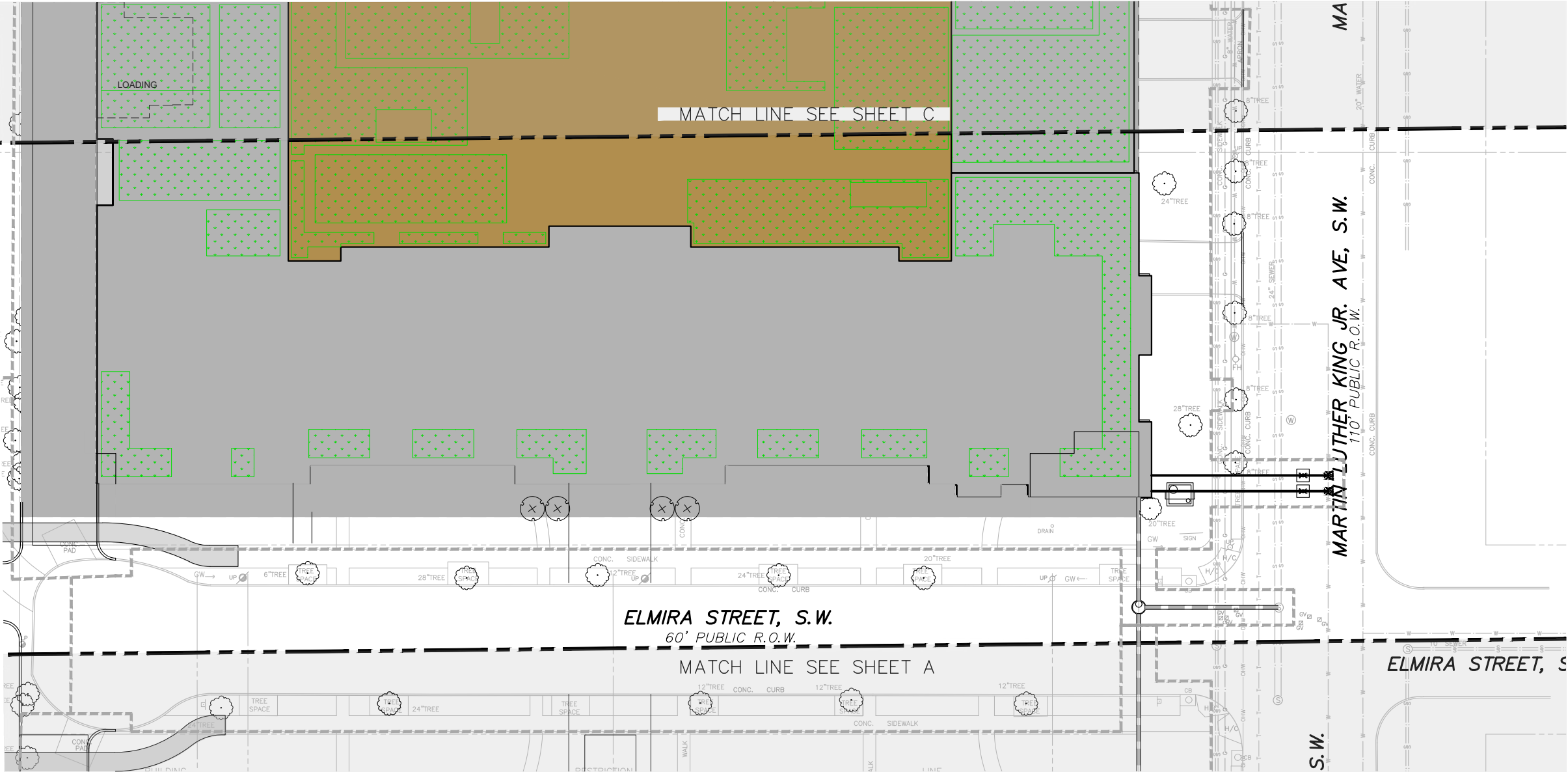

STORMWATER MANAGEMENT LEGEND

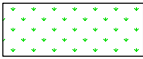

GREEN ROOF

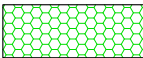

BIORETENTION AREA

NOTE: STORMWATER MANAGEMENT (SWM) FACILITIES AND COMPUTATIONS ARE PRELIMINARY AND SUBJECT TO CHANGE. DURING THE PRODUCTION OF FINAL ENGINEERING CONSTRUCTION DOCUMENTS, THESE FACILITY TYPES AND COMPUTATIONS MAY BE ADJUSTED OR CHANGED BASED ON SITE CONDITIONS. FINAL SWM DESIGN SHALL MEET DOEE REQUIREMENTS.

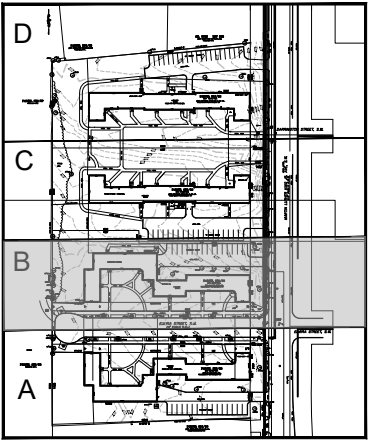

KEY MAP



GRAPHIC SCALE

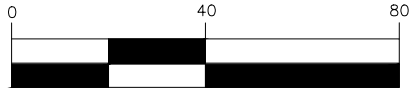

1 inch = 40 ft.

LAYOUT: 0610 SWM B, Plotted By: ruhl

S:\0001-1000\0758A - Martin Luther King Jr. Ave. & Elmira St. SW - PUD Design Package\cadd\preliminary\0758A_100.dwg, ~ Nov 13, 2023 AT 2:50:34 PM

STORMWATER MANAGEMENT PLAN B

C23

DECEMBER 19, 2023

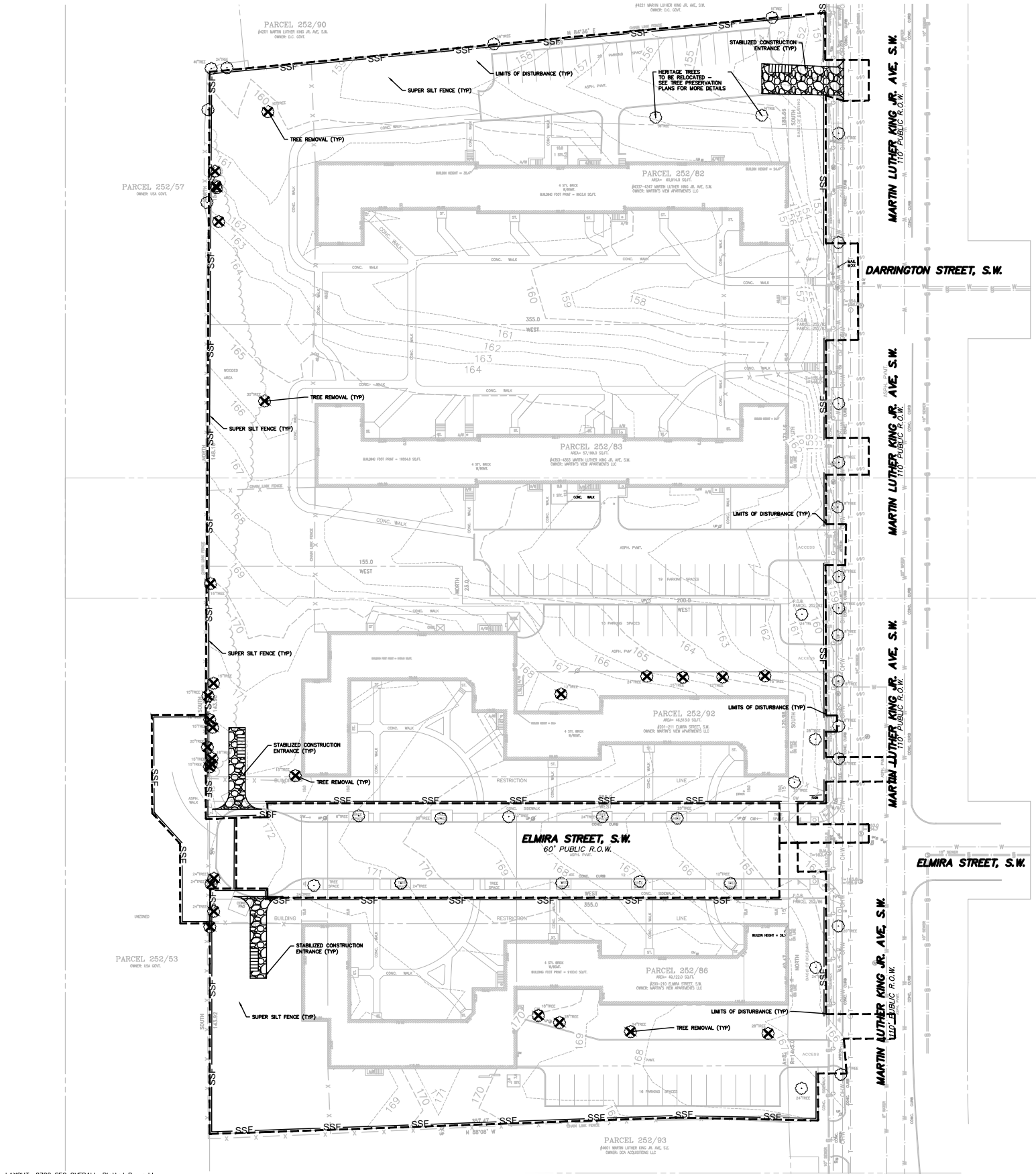

LAYOUT: 0700 SEC OVERALL, Plotted By: ruh

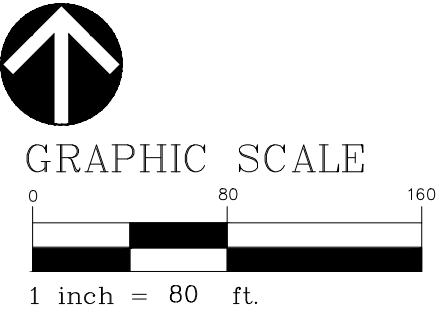
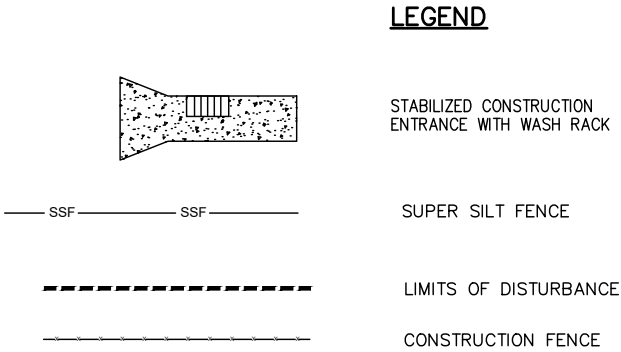

DECEMBER 19, 2023

SEDIMENT AND EROSION CONTROL PLAN OVERALL

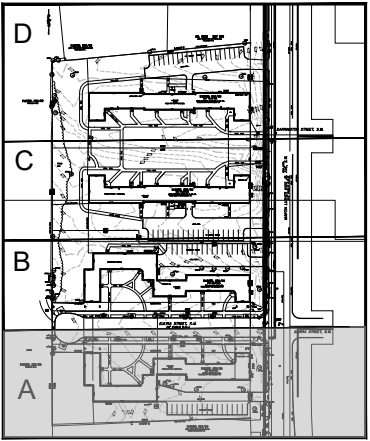
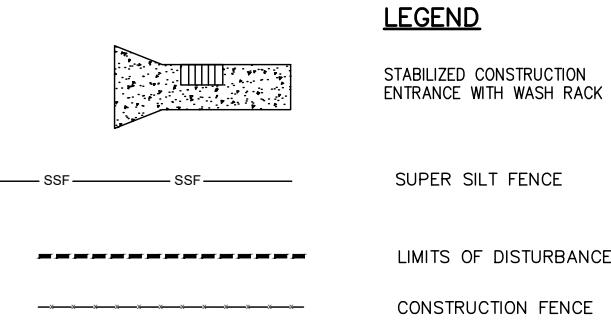
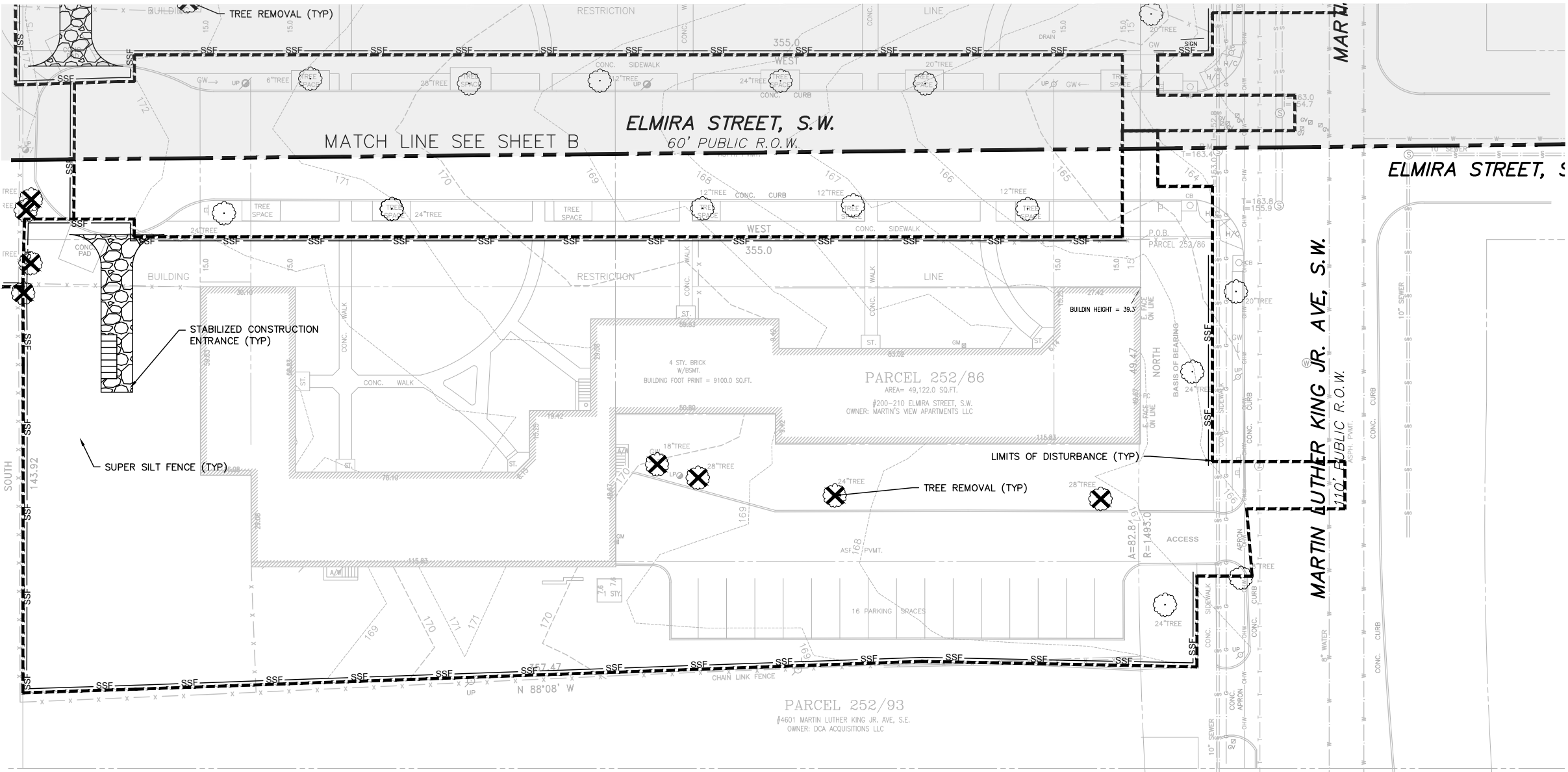

KEY MAP



GRAPHIC SCALE

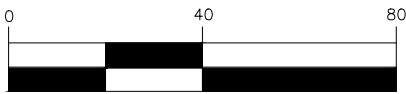

1 inch = 40 ft.

SEDIMENT AND EROSION CONTROL PLAN A

C27

DECEMBER 19, 2023

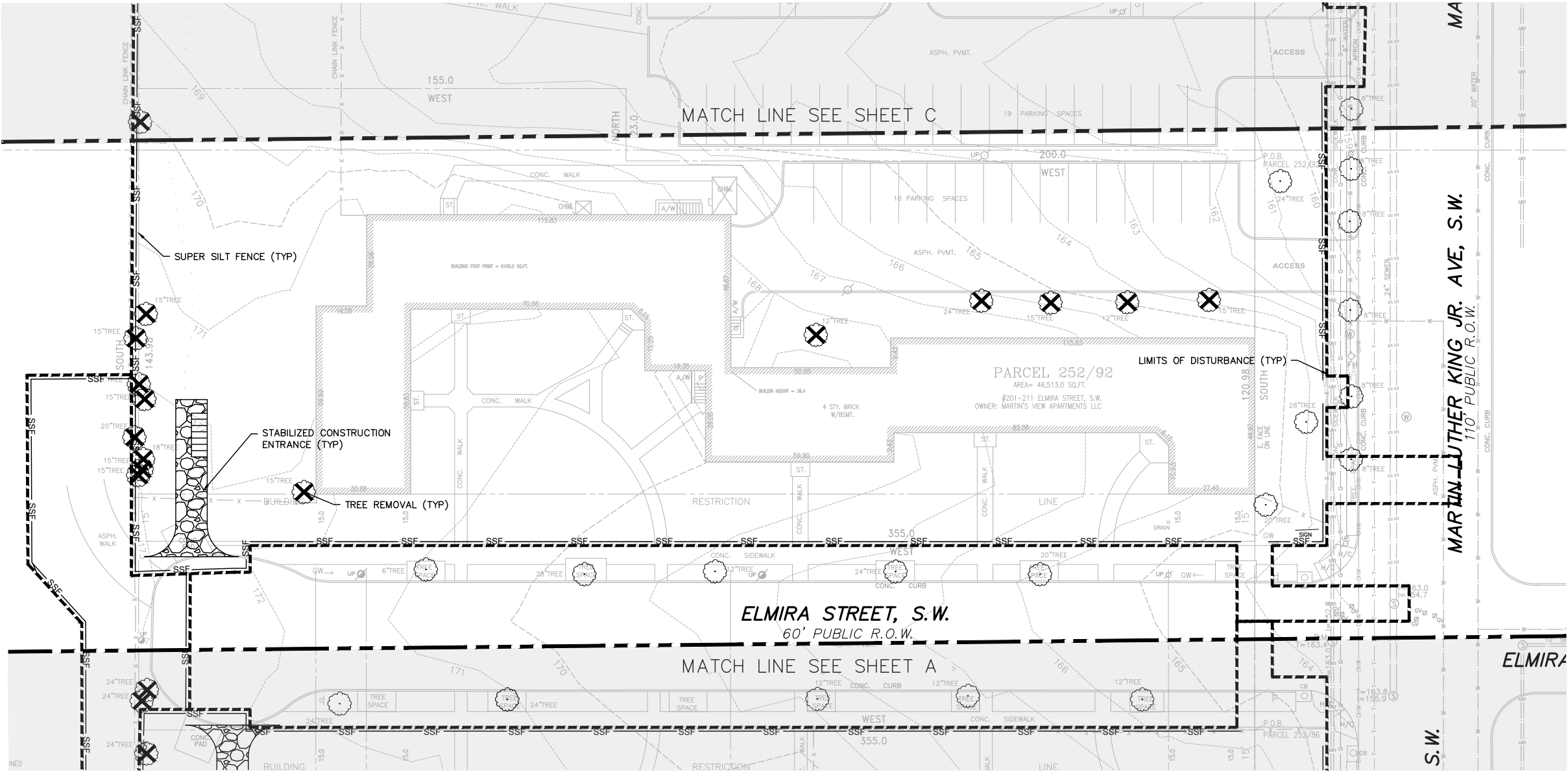

STABILIZED CONSTRUCTION ENTRANCE WITH WASH RACK

SUPER SILT FENCE

LIMITS OF DISTURBANCE

CONSTRUCTION FENCE

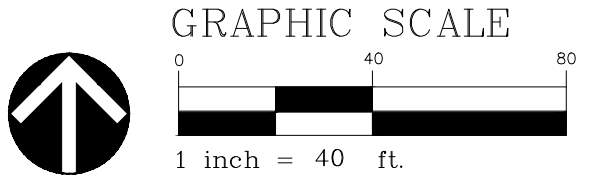
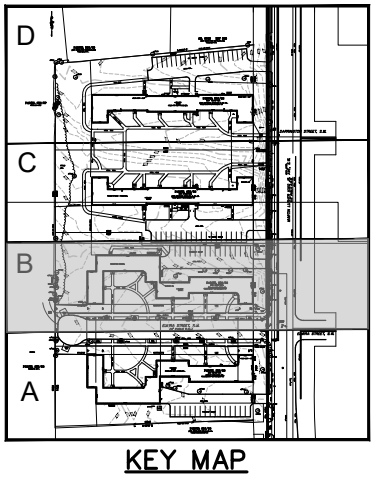

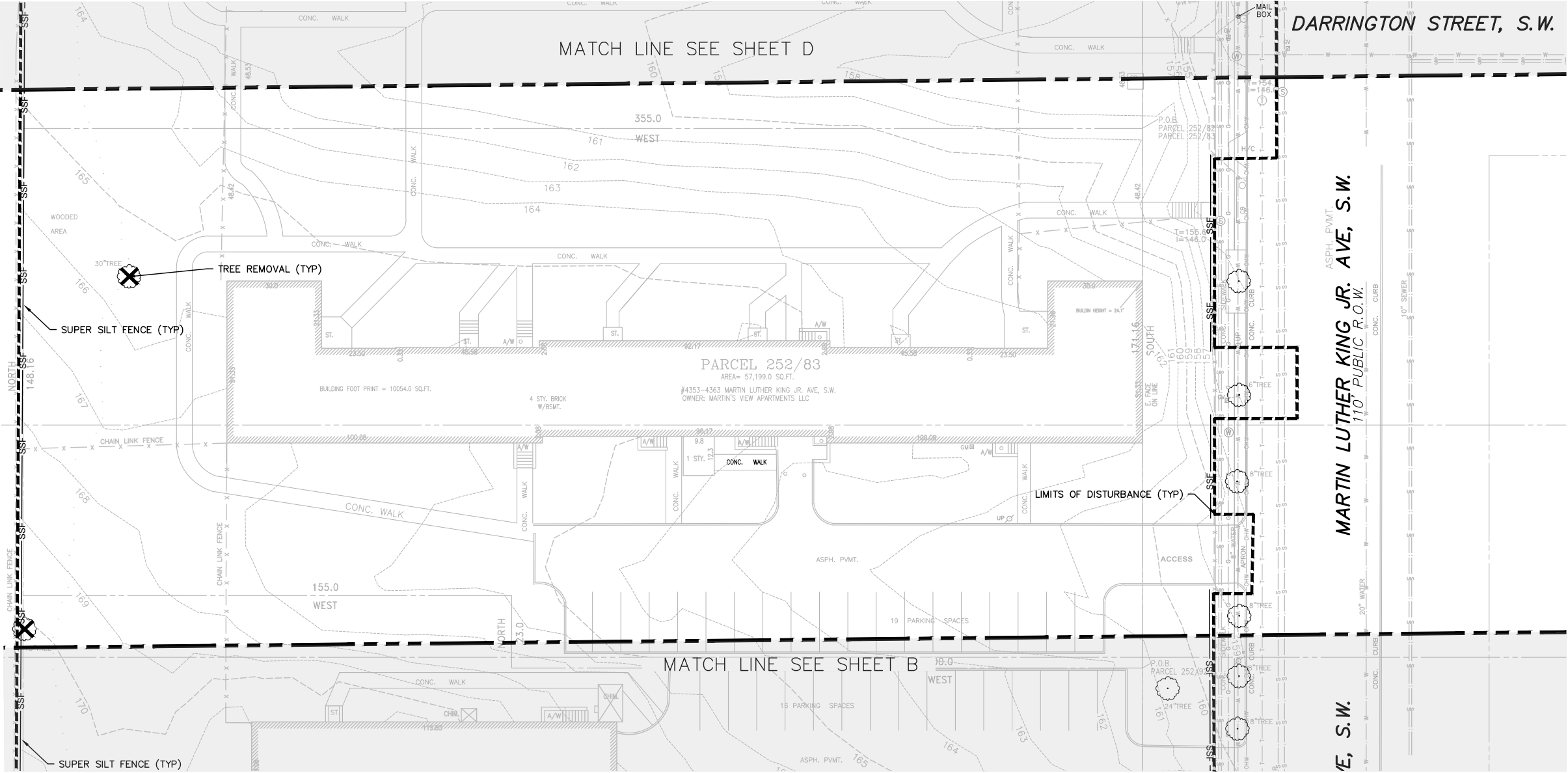

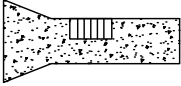



STABILIZED CONSTRUCTION
ENTRANCE WITH WASH RACK



SUPER SILT FENCE



LIMITS OF DISTURBANCE



CONSTRUCTION FENCE

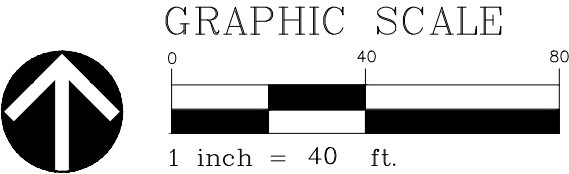
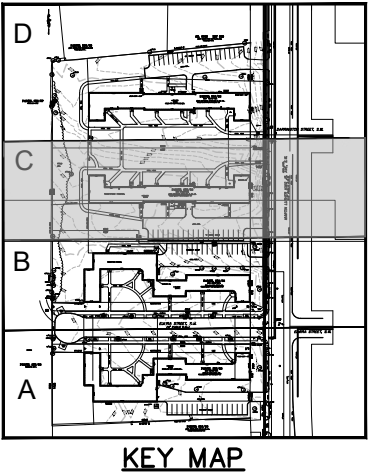

LAYOUT: 0715 SEC C, Plotted By: ruhi

SEDIMENT AND EROSION CONTROL PLAN C

C29

DECEMBER 19, 2023

S:\0001-1000\0758A - Martin Luther King Jr. Ave. & Emira St. SW - PUD Design Package\code\preliminary\0758A_100.dwg, ~ Nov 13, 2023 AT 2:45:20 PM

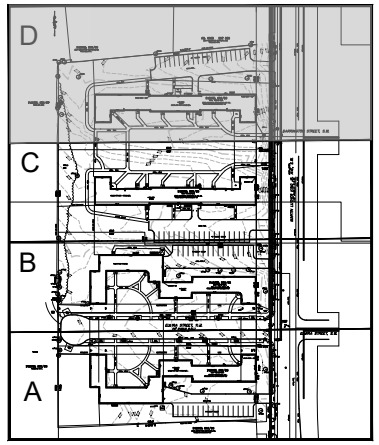
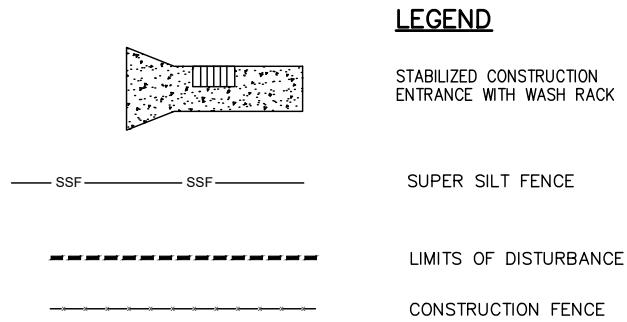
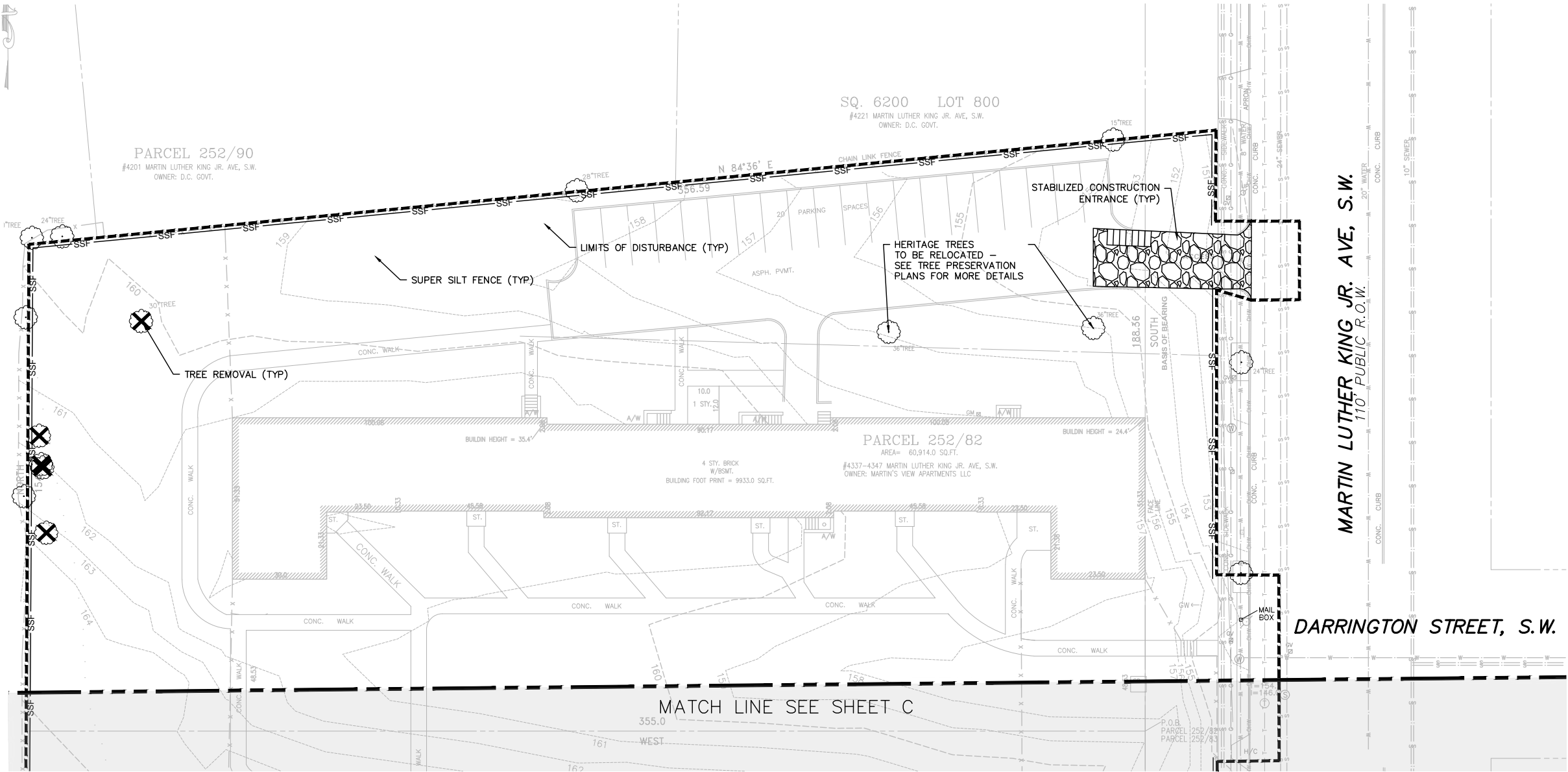

KEY MAP

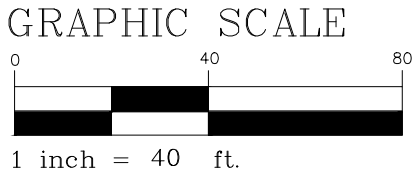

LAYOUT: 0720 SEC D, Plotted By: ruhl

S:\0001-1000\0758A - Martin Luther King Jr. Ave. & Elmira St. SW - PUD Design Package\cadd\preliminary\0758A_100.dwg, ~ Nov 13, 2023 AT 2:44:29 PM

DECEMBER 19, 2023

SEDIMENT AND EROSION CONTROL PLAN D

Diagram illustrating a cross-section of a roof assembly for a vegetation-free zone, showing the following components and installation details:

- GARDENEDGE METAL EDGING - INSTALL OVER INSULATION
- SYSTEMFILTER STRIP - 12 - 18 INCHES WIDE
INSTALL OVER ROCK WOOL AND UP INSIDE EDGE OF GARDENEDGE METAL EDGING
- VEGETATION-FREE ZONE
STONE OR PAVER BALLAST
(SEE PLANS FOR WIDTH)
- 3/4"
- INSTAGREEN CARPET
- LITETOP GROWING MEDIA
 - MEDIA TYPE AS SPECIFIED
 - KEEP TOP OF MEDIA 3/4" BELOW TOP OF GARDENEDGE METAL EDGING
- ROCK WOOL
 - NUMBER OF LAYERS AS SPECIFIED
 - STAGGER JOINTS IN MULTIPLE LAYER ASSEMBLIES
- HYDRODRAIN MAX AIR LAYER
- DOW STYROFOAM - DEPTH AS SPECIFIED
- ROOT STOP
- HYDROFLEX 30
- MM 6125EV-FR
- EXPEND SYSTEMFILTER 6" - 6" OVER ROCK WOOL

NOTES:

- INSTAGREEN CARPET IS RECOMMENDED BY HYDROTECH IN ROCK WOOL ASSEMBLIES.
- ANYWHERE ROCK WOOL IS USED OVER DOW STYROFOAM INSULATION, AN AIRLAYER MUST BE USED.
- ROOT STOP IS LOOSE-LAID OVER THE HYDROFLEX 30 AND LAPPED A MINIMUM OF 5 FEET OR 2-1/2 FEET WITH LAPS TAPED USING ROOT STOP TAPE.
- THE VEGETATION FREE ZONE (VFZ) MAY BE COMPOSED OF TYPICAL STONE BALLAST OR CONCRETE PAVERS. CONTACT HYDROTECH FOR BALLAST DESIGN REQUIREMENTS. VFZs ARE REQUIRED AT ALL ROOF PERIMETERS AND ALL PENETRATIONS (PIPES, SKYLIGHTS, ETC.). GARDENEDGE METAL EDGE RESTRAINT, CONCRETE CURBS, LANDSCAPE TIMBERS, ETC. MAY BE USED AT VFZ/GROWING MEDIA TRANSITIONS.
- CONTACT HYDROTECH FOR VEGETATION FREE ZONE WIDTH AND MATERIAL REQUIREMENTS FOR WIND WARRANTY.

BUILDING 4 – SWM CALCULATIONS

BUILDING 1 – SWM CALCULATIONS

LAYOUT: 0900 SITE SWM DETS, Plotted By: ruhl

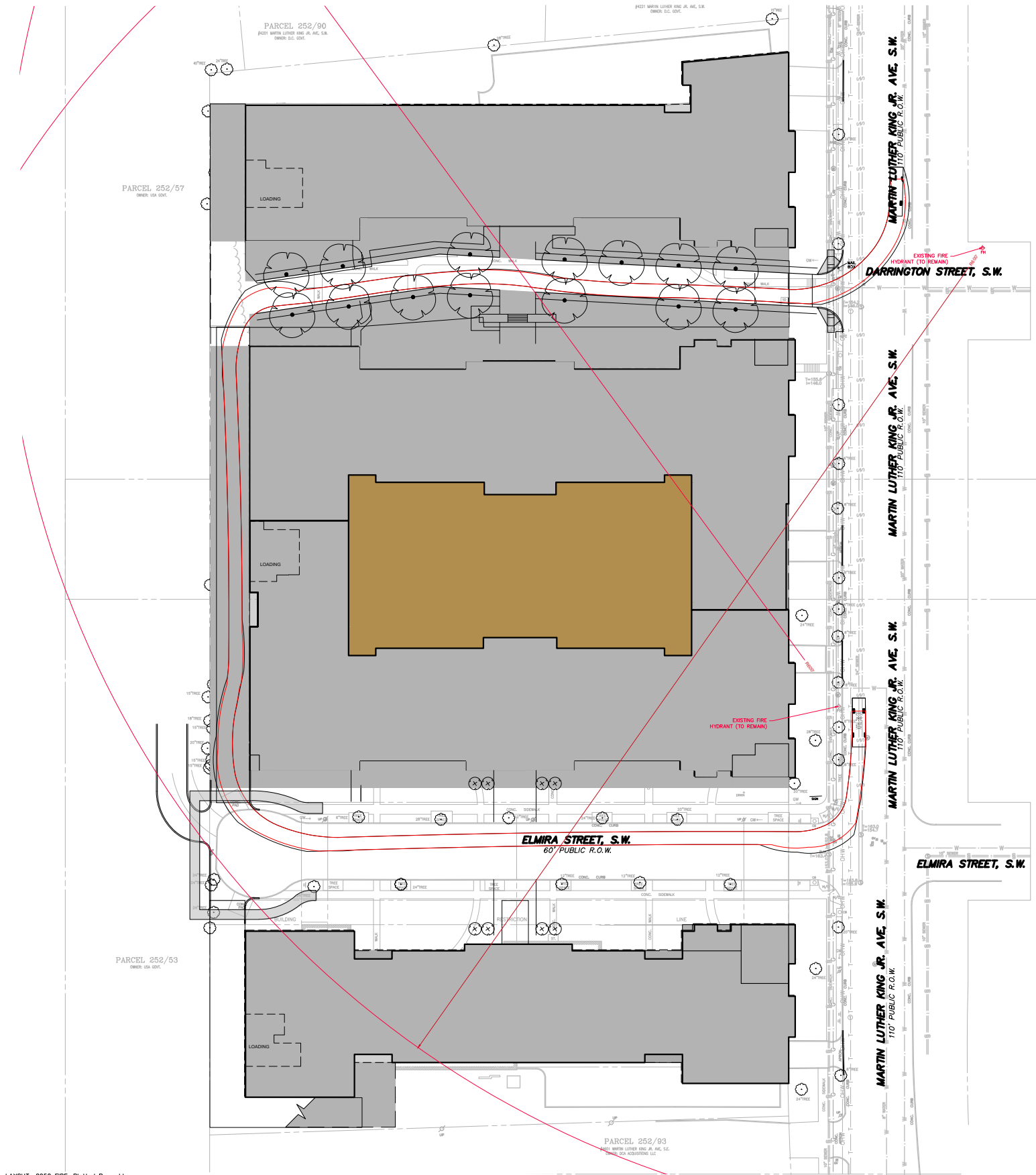

LAYOUT: 0950 FIRE, Plotted By: ruhl

LEGEND

FIRE VEHICLE TURNING MOVEMENTS

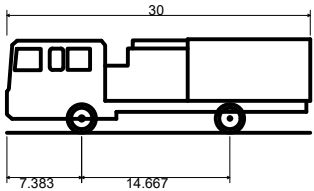

DC FIRE TRUCK
Overall Length 30.000ft
Overall Width 8.000ft
Overall Body Height 9.250ft
Min Body Ground Clearance 1.367ft
Track Width 8.000ft
Lock-to-lock time 5.00s
Wall to Wall Turning Radius 31.833ft



DC FIRE & EMS DEPARTMENT
ENGINE SPECIFICATIONS



360.25" (30' 0.25") Bumper to Bumper Length
176.5" (14' 8.5") Wheelbase
88.25" (7' 4.25") Front Bumper to Front Axle
95.5" (7' 11.49") Rear Axle to Rear Bumper
112" (9' 4") Overall Height (Estimate)
96" (8' 0") Overall Width (Outside Body Rub Rails to Outside Body Rub Rails)

Angle of Approach is 14°
Angle of Departure is 15°

Turning Radius

164" (13' 8") Inner Curb Clearance
333" (27' 3") Curb Clearance
382" (31' 10") Wall Clearance

Weight

40,000 LBS. (Approximate total vehicle weight)

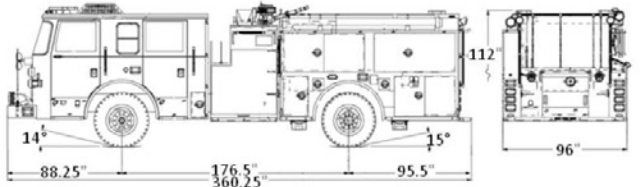

GRAPHIC SCALE

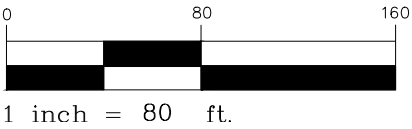

DECEMBER 19, 2023

FIRE MARSHALL SITE PLAN/FIRE HYDRANT EXHIBIT