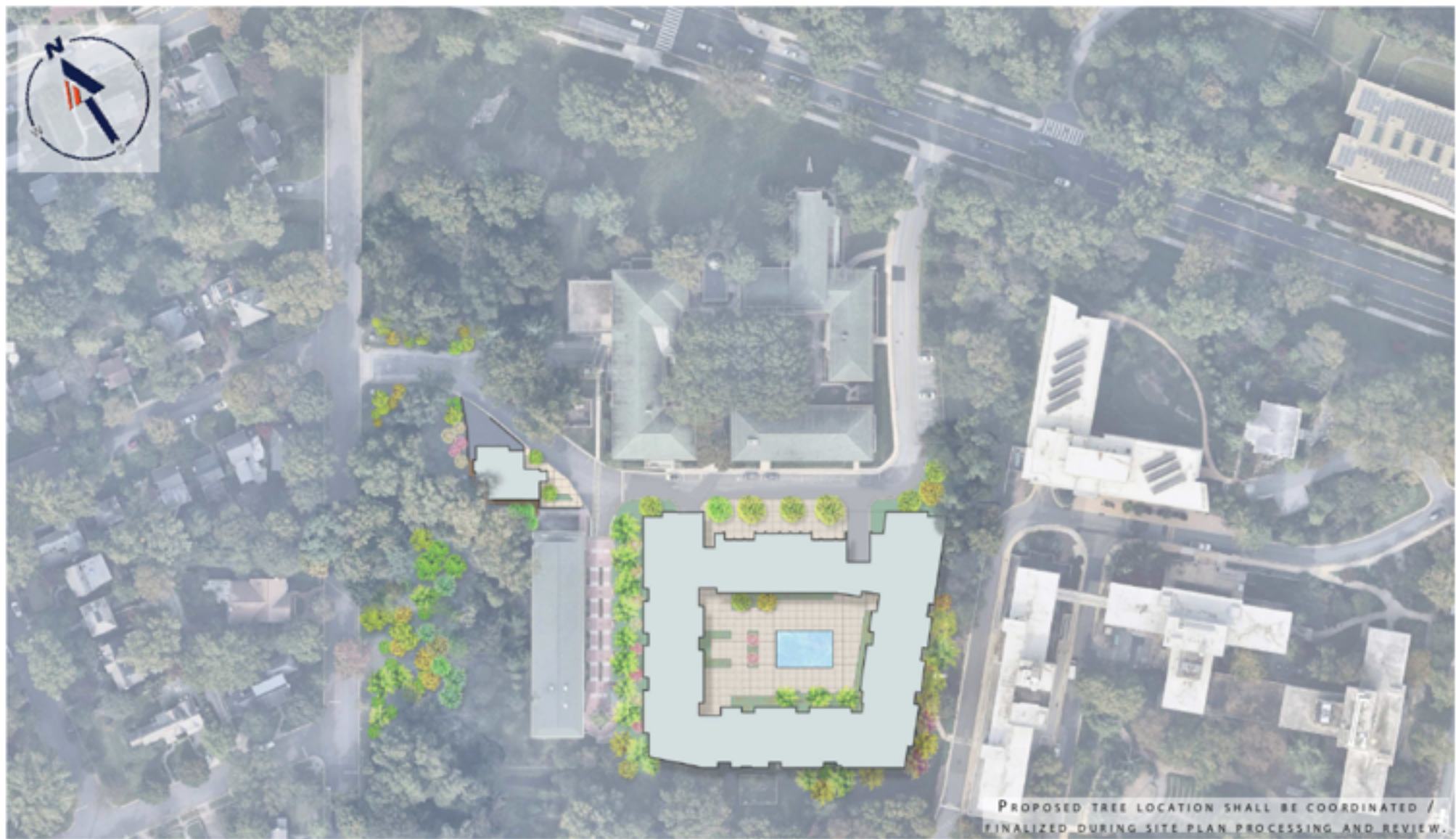

EXHIBIT H



PROPOSED TREE LOCATION SHALL BE COORDINATED /
FINALIZED DURING SITE PLAN PROCESSING AND REVIEW.

THE STANDARD AT WESLEY THEOLOGICAL SEMINARY - PROPOSED

4500 MASSACHUSETTS AVE NW
WASHINGTON, DC

DC1821572



16/11/2021

BOHLER //

WESLEY SEMINARY CAMPUS PLAN
EXHIBIT H1 - LANDSCAPE PLAN

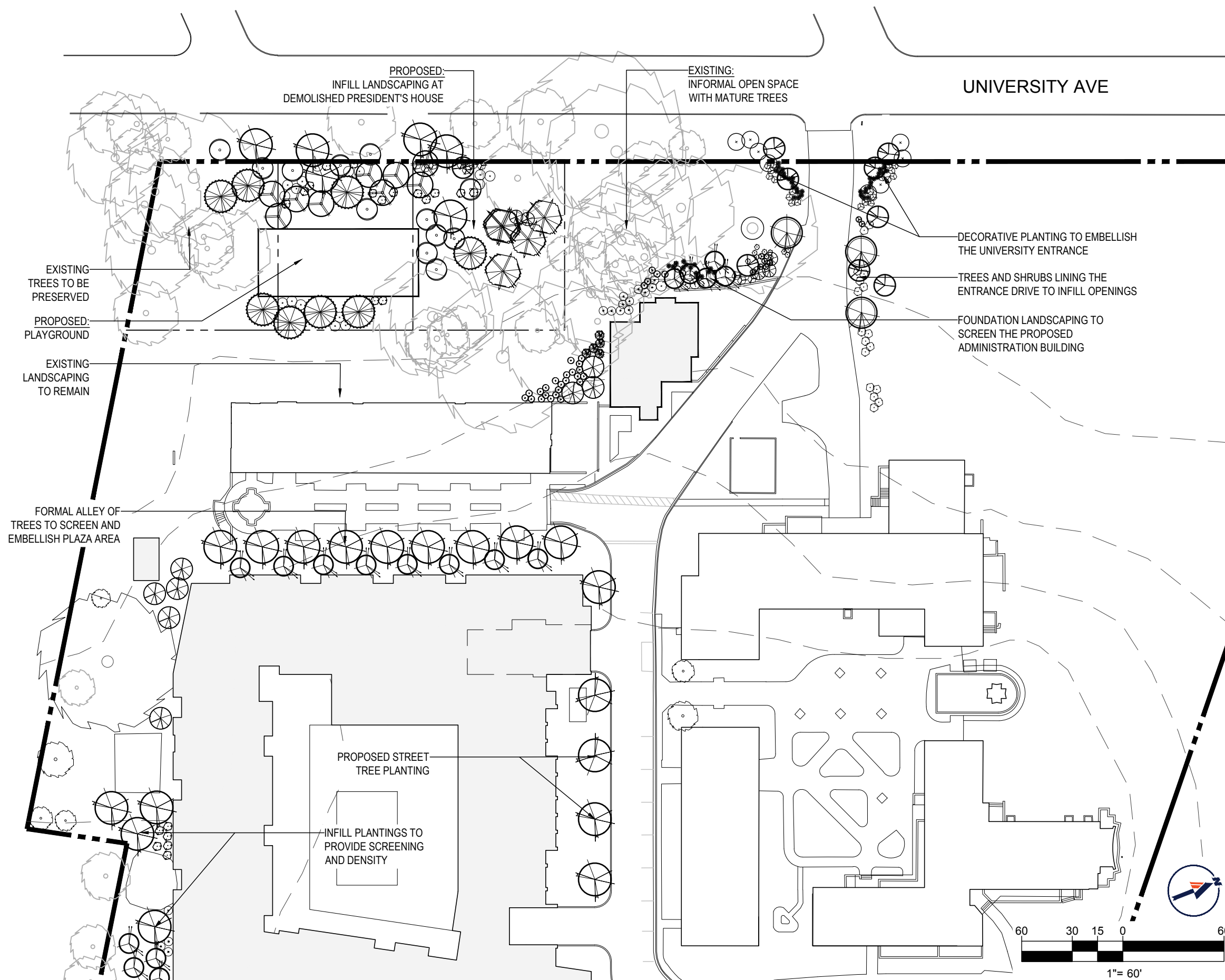

LANDSCAPE SCHEDULE

SYM.	KEY	QTY.	BOTANICAL NAME	COMMON NAME	CAL.	CONT.
SHADE TREES						
	AR	31	ACER RUBRUM	RED MAPLE	2 1/2-3' CAL. / 12-14'	B+B
	BN	9	BETULA NIGRA	MULTI STEM RIVER BIRCH	2 1/2-3' CAL. / 12-14'	B+B
	PLO	4	PLATANUS OCCIDENTALIS	AMERICAN SYCAMORE	2 1/2-3' CAL. / 12-14'	B+B
	QP2	5	QUERCUS PALUSTRIS	PIN OAK	2 1/2-3' CAL. / 12-14'	B+B
SUBTOTAL:		49				
ORNAMENTAL TREES						
	AL	12	AMELANCHIER LAEVIS	ALLEGHANY SERVICEBERRY	1-1 1/2' CAL. / 8-10'	B+B
	CF	21	CORNUS FLORIDA	WHITE FLOWERING DOGWOOD	1-1 1/2' CAL. / 8-10'	B+B
	LI	10	LAGERSTROEMIA INDICA	COMMON CRAPEMYRTLE	1-1 1/2' CAL. / 8-10'	B+B
SUBTOTAL:		43				
EVERGREEN TREES						
	IO	3	ILEX OPACA	AMERICAN HOLLY	6-8'	B+B
	IXF2	8	ILEX X FOSTERI	FOSTER'S HOLLY	6-8'	B+B
	MGSM	8	MAGNOLIA GRANDIFLORA	SOUTHERN MAGNOLIA	6-7'	B+B
SUBTOTAL:		19				
DECIDUOUS SHRUBS						
	AAB	13	ARONIA ARBUTIFOLIA 'BRILLIANTISSIMA'	RED CHOKEBERRY	24-30"	#3 CAN
	CFL	23	CALYCANTHUS FLORIDUS	COMMON SWEET SHRUB	24-30"	#3 CAN
	HAA	41	HYDRANGEA ARBORESCENS 'ANNABELLE'	ANNABELLE HYDRANGEA	24-30"	#3 CAN
	HYC	56	HYPERICUM CALYCNINUM	AARON'S BEARD	24-30"	#3 CAN
	IV	19	ITEA VIRGINICA 'HENRY'S GARNET'	GARNET SWEETSPIRE	24-30"	#3 CAN
	VCAC	24	VIBURNUM CARLESII 'COMPACTUM'	COMPACT KOREANSPICE VIBURNUM	24-30"	#3 CAN
	VD	17	VIBURNUM DENTATUM	ARROWWOOD VIBURNUM	24-30"	#3 CAN
	VP	25	VIBURNUM PRUNIFOLIUM	BLACKHAW	24-30"	#3 CAN
SUBTOTAL:		218				
EVERGREEN SHRUBS						
	IGC	20	ILEX GLABRA 'COMPACTA'	DWARF INKBERRY HOLLY	24-30"	#3 CAN
	IXN2	6	ILEX X 'NELLIE R. STEVEN'	NELLIE R. STEVENS' HOLLY	5-6'	B&B
	RM	5	RHOODODENDRON MAXIMUM 'ROSEBAY'	ROSEBAY RHODODENDRON	24-30"	#3 CAN
	VR	20	VIBURNUM X RHYTIDOPHYLLUM	LEATHERLEAF VIBURNUM	24-30"	#3 CAN
SUBTOTAL:		51				

WESLEY SEMINARY CAMPUS PLAN
EXHIBIT H2 - LANDSCAPE PLAN

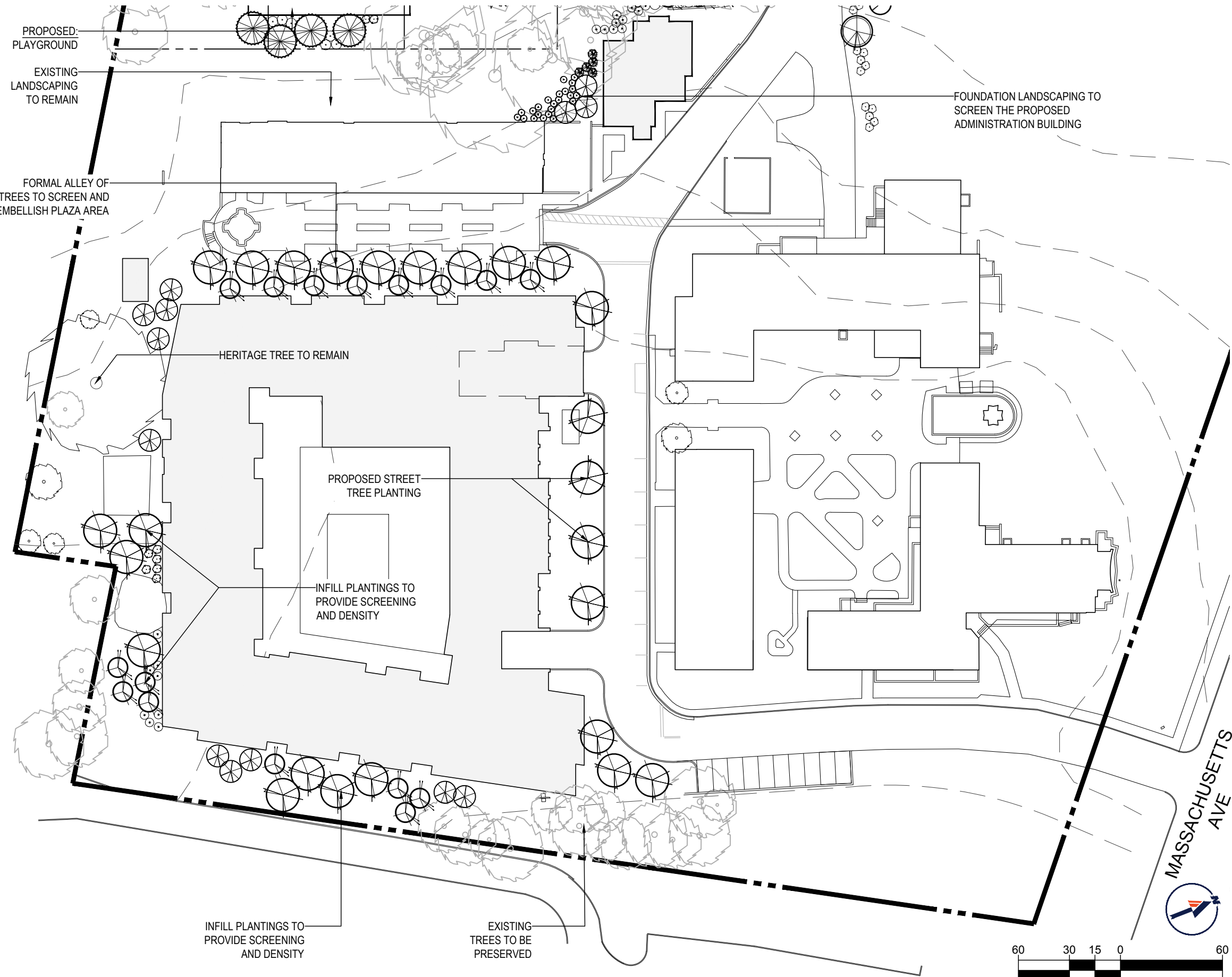

LANDSCAPE SCHEDULE

SYM.	KEY	QTY.	BOTANICAL NAME	COMMON NAME	CAL.	CONT.
SHADE TREES						
	AR	31	ACER RUBRUM	RED MAPLE	2 1/2-3" CAL. / 12-14'	B+B
	BN	9	BETULA NIGRA	MULTI STEM RIVER BIRCH	2 1/2-3" CAL. / 12-14'	B+B
	PLO	4	PLATANUS OCCIDENTALIS	AMERICAN SYCAMORE	2 1/2-3" CAL. / 12-14'	B+B
	QP2	5	QUERCUS PALUSTRIS	PIN OAK	2 1/2-3" CAL. / 12-14'	B+B
SUBTOTAL:		49				
ORNAMENTAL TREES						
	AL	12	AMELANCHIER LAEVIS	ALLEGHANY SERVICEBERRY	1-1 1/2" CAL. / 8-10'	B+B
	CF	21	CORNUS FLORIDA	WHITE FLOWERING DOGWOOD	1-1 1/2" CAL. / 8-10'	B+B
	LI	10	LAGERSTROEMIA INDICA	COMMON CRAWPEMYRTLE	1-1 1/2" CAL. / 8-10'	B+B
SUBTOTAL:		43				
EVERGREEN TREES						
	IO	3	ILEX OPACA	AMERICAN HOLLY	6-8'	B+B
	IXF2	8	ILEX X FOSTERI	FOSTER'S HOLLY	6-8'	B+B
	MGSM	8	MAGNOLIA GRANDIFLORA	SOUTHERN MAGNOLIA	6-7'	B+B
SUBTOTAL:		19				
DECIDUOUS SHRUBS						
	AAB	13	ARONIA ARBUTIFOLIA 'BRILLIANTISSIMA'	RED CHOKEBERRY	24-30"	#3 CAN
	CFL	23	CALYCANTHUS FLORIDUS	COMMON SWEET SHRUB	24-30"	#3 CAN
	HAA	41	HYDRANGEA ARBORESCENS 'ANNABELLE'	ANNABELLE HYDRANGEA	24-30"	#3 CAN
	HYC	56	HYPERICUM CALYCNINUM	AARON'S BEARD	24-30"	#3 CAN
	IV	19	ITEA VIRGINICA 'HENRY'S GARNET'	GARNET SWEETSPIRE	24-30"	#3 CAN
	VCAC	24	VIBURNUM CARLESII 'COMPACTUM'	COMPACT KOREANSPICE VIBURNUM	24-30"	#3 CAN
	VD	17	VIBURNUM DENTATUM	ARROWWOOD VIBURNUM	24-30"	#3 CAN
	VP	25	VIBURNUM PRUNIFOLIUM	BLACKHAW	24-30"	#3 CAN
SUBTOTAL:		218				
EVERGREEN SHRUBS						
	IGC	20	ILEX GLABRA 'COMPACTA'	DWARF INKBERRY HOLLY	24-30"	#3 CAN
	IXN2	6	ILEX X 'NELLIE R. STEVEN'	NELLIE R. STEVENS' HOLLY	5-6'	B&B
	RM	5	RHOODODENDRON MAXIMUM 'ROSEBAY'	ROSEBAY RHODODENDRON	24-30"	#3 CAN
	VR	20	VIBURNUM X RHYTIDOPHYLLUM	LEATHERLEAF VIBURNUM	24-30"	#3 CAN
SUBTOTAL:		51				

MASSACHUSETTS
AVE

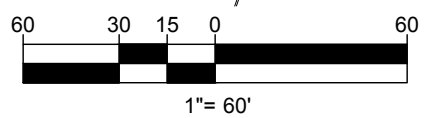
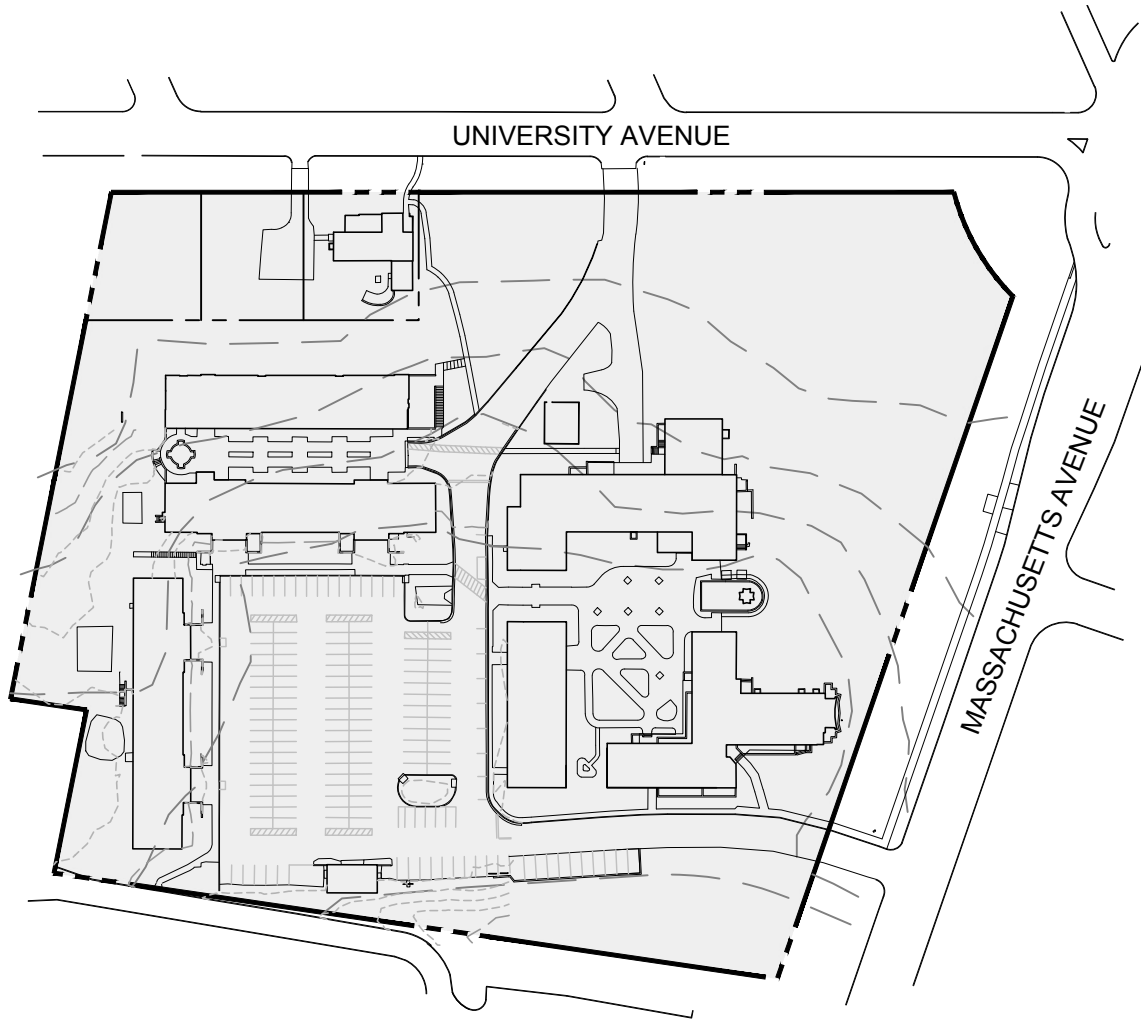

EXHIBIT I

EXHIBIT J

WESLEY SEMINARY CAMPUS PLAN

EXHIBIT J - EXISTING AND PROPOSED PROPERTY BOUNDARY



KEY



PROPERTY OWNED BY WESLEY THEOLOGICAL SEMINARY



CAMPUS BOUNDARY

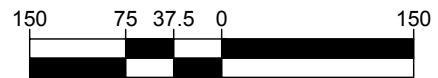

1"=150'

NOTE

PROPERTY BOUNDARY SHOWN REFLECTS EXISTING AND PROPOSED, AS NO CHANGES ARE INTENDED. SITE AMENITIES ARE SHOWN AS THEY ARE PROPOSED.

BOHLER DC//

1331 PENNSYLVANIA AVE., NW,
STE. 1250 NORTH
WASHINGTON, DC 20004
Phone: (202) 524-5700







EXHIBIT K

WESLEY SEMINARY CAMPUS PLAN

EXHIBIT K - EXISTING ZONING



KEY

-  RESIDENTIAL APARTMENT ZONE
-  RESIDENTIAL ZONE
-  CAMPUS PLANS
-  MIXED-USE ZONE
-  NEIGHBORHOOD MIXED-USE ZONE
-  PUD



BOHLER DC

1331 PENNSYLVANIA AVE., NW,
 STE. 1250 NORTH
 WASHINGTON, DC 20004
 Phone: (202) 524-5700







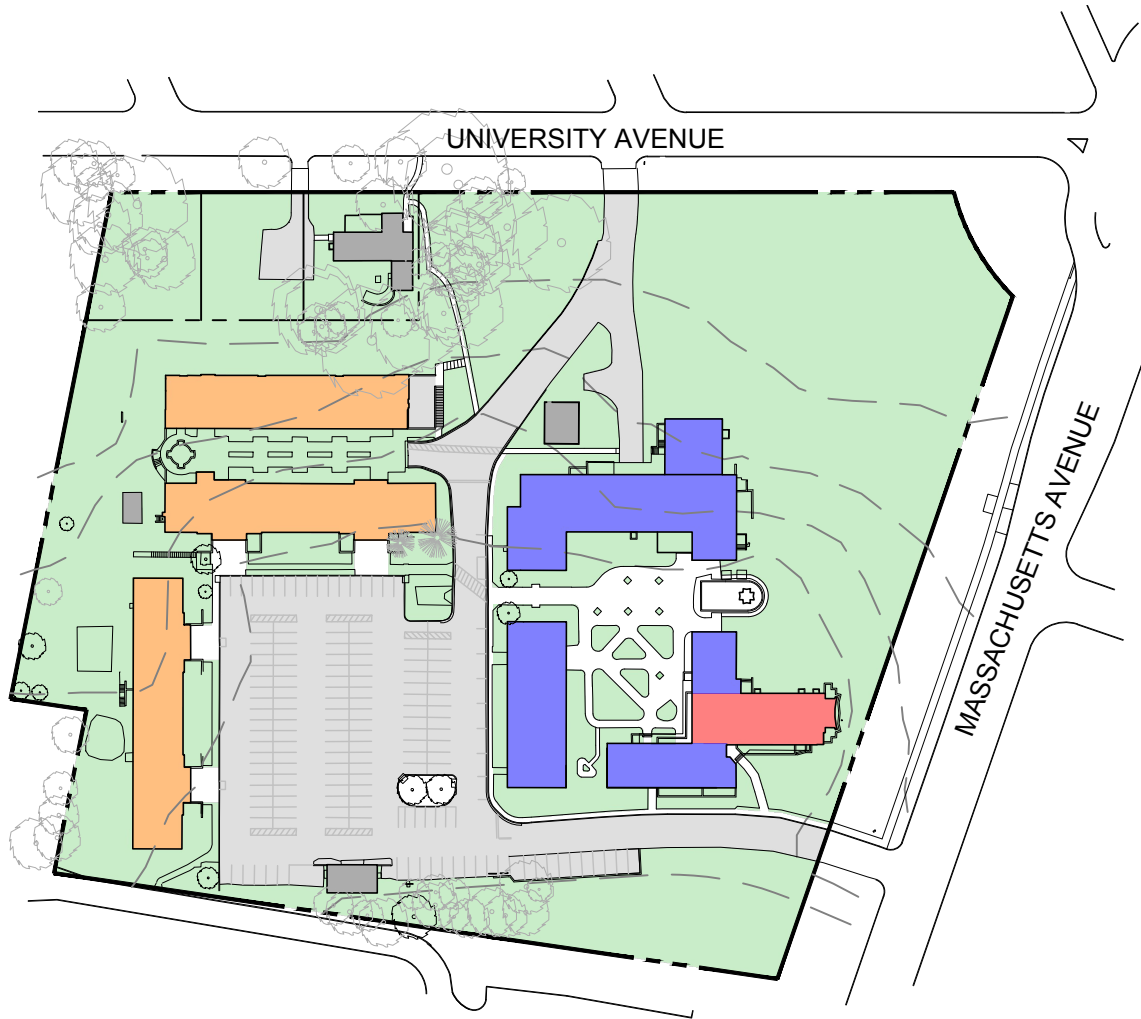

EXHIBIT L

WESLEY SEMINARY CAMPUS PLAN

EXHIBIT L - EXISTING LAND USE



KEY

	RESIDENTIAL
	ACADEMIC/ ADMINISTRATIVE
	CHAPEL
	SUPPORT STRUCTURES
	OPEN SPACE
	SUPPORT PARKING/ OPEN AREA
	CAMPUS BOUNDARY
	TREE

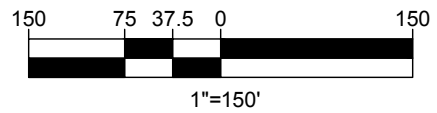

BOHLER DC//

1331 PENNSYLVANIA AVE., NW,
 STE. 1250 NORTH
 WASHINGTON, DC 20004
 Phone: (202) 524-5700

EXHIBIT M

WESLEY SEMINARY CAMPUS PLAN

EXHIBIT M - EXISTING BUILDING USE AND INFRASTRUCTURE

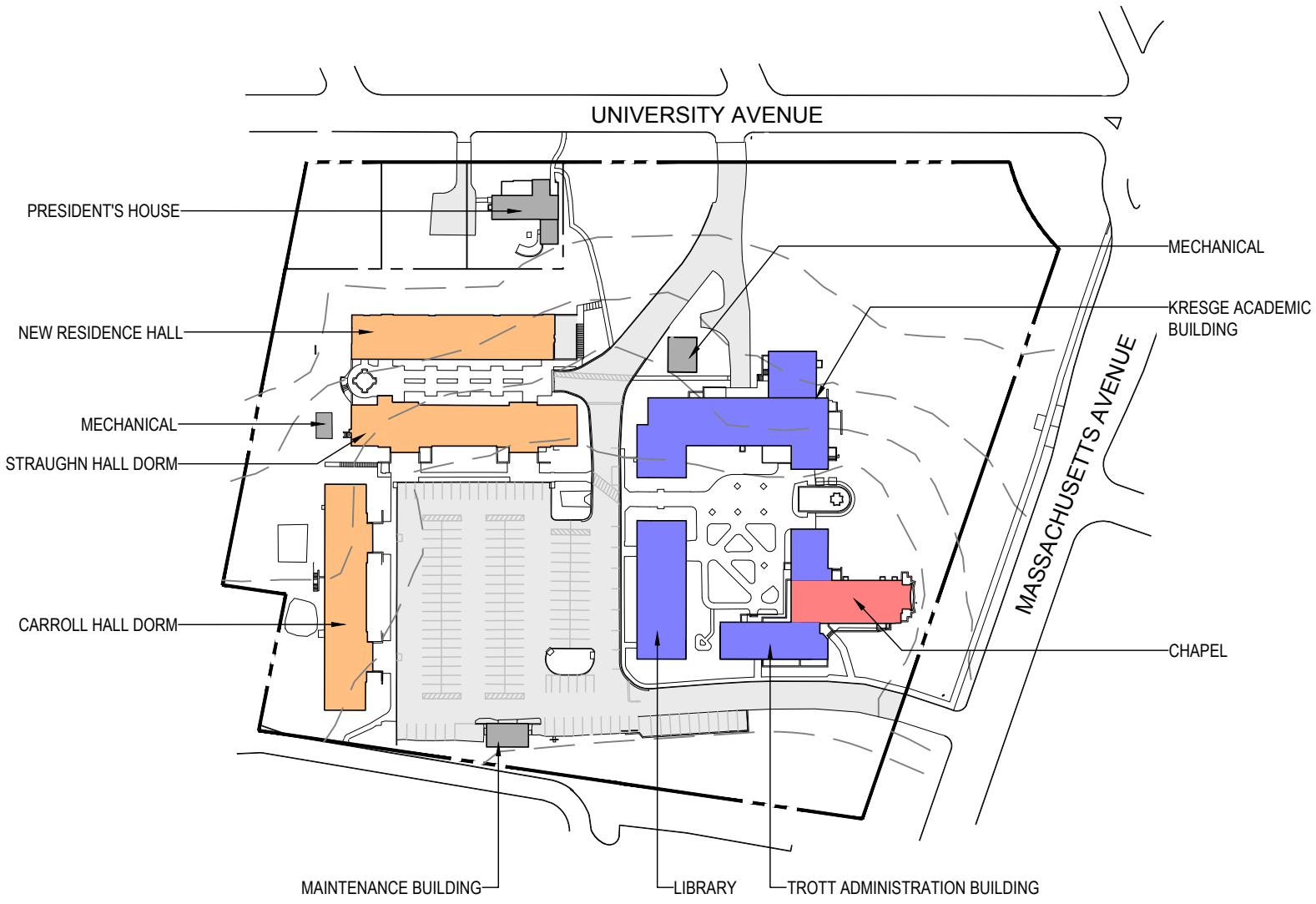

KEY

- RESIDENTIAL
- ACADEMIC/ ADMINISTRATIVE
- CHAPEL
- SUPPORT STRUCTURES
- SUPPORT PARKING/ OPEN AREA
- CAMPUS BOUNDARY

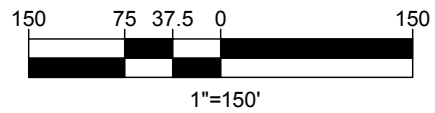

BOHLER DC//

1331 PENNSYLVANIA AVE., NW,
 STE. 1250 NORTH
 WASHINGTON, DC 20004
 Phone: (202) 524-5700



EXHIBIT N

WESLEY SEMINARY CAMPUS PLAN

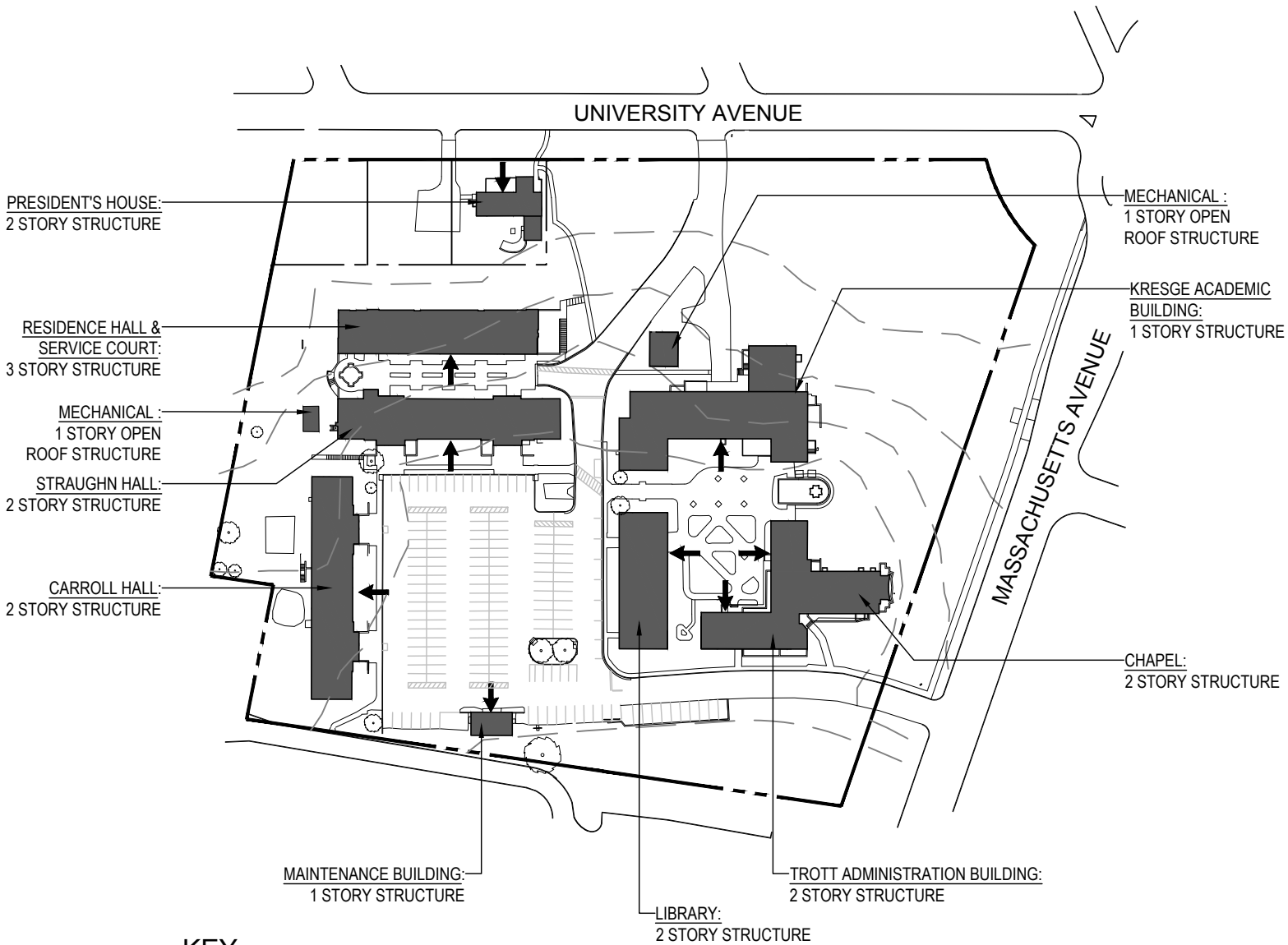
EXHIBIT N - EXISTING BUILDING HEIGHTS



KEY

-  FRONT OF BUILDING
-  CAMPUS BOUNDARY
-  EXISTING BUILDINGS

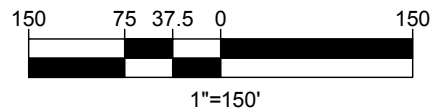

BOHLER DC//

1331 PENNSYLVANIA AVE., NW,
 STE. 1250 NORTH
 WASHINGTON, DC 20004
 Phone: (202) 524-5700

EXHIBIT O

WESLEY SEMINARY CAMPUS PLAN

EXHIBIT O - EXISTING OPEN SPACE AND PEDESTRIAN SYSTEM

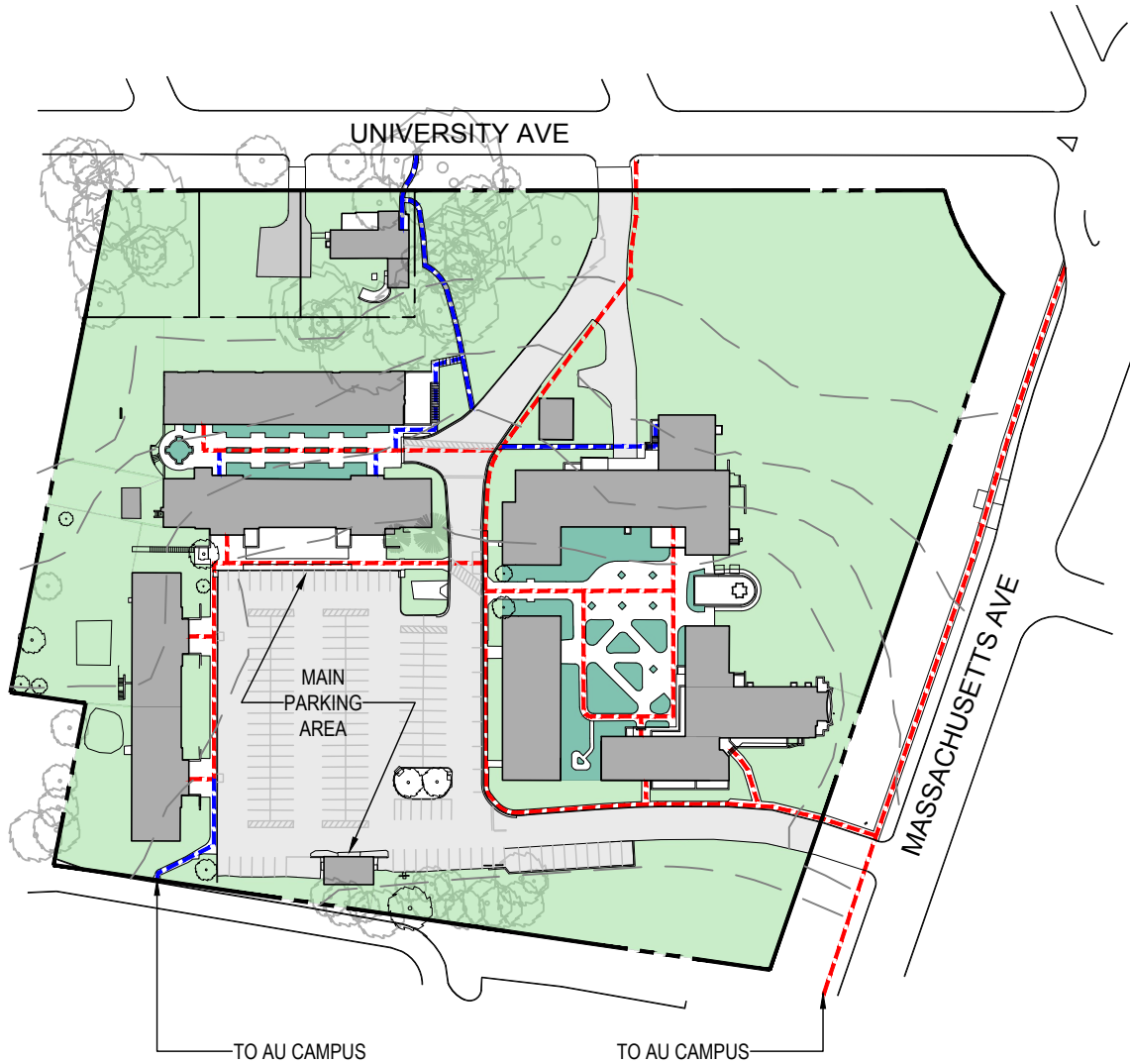

KEY

- INFORMAL LANDSCAPE/ OPEN SPACE
- FORMAL LANDSCAPE/ PLAZA
- PARKING AREAS AND DRIVEWAYS
- BUILDINGS
- PRIMARY PEDESTRIAN PATH
- SECONDARY PEDESTRIAN PATH
- CAMPUS BOUNDARY

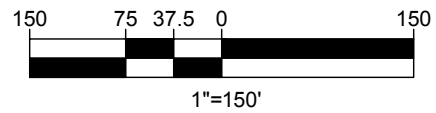

BOHLER DC//

1331 PENNSYLVANIA AVE., NW,
 STE. 1250 NORTH
 WASHINGTON, DC 20004
 Phone: (202) 524-5700







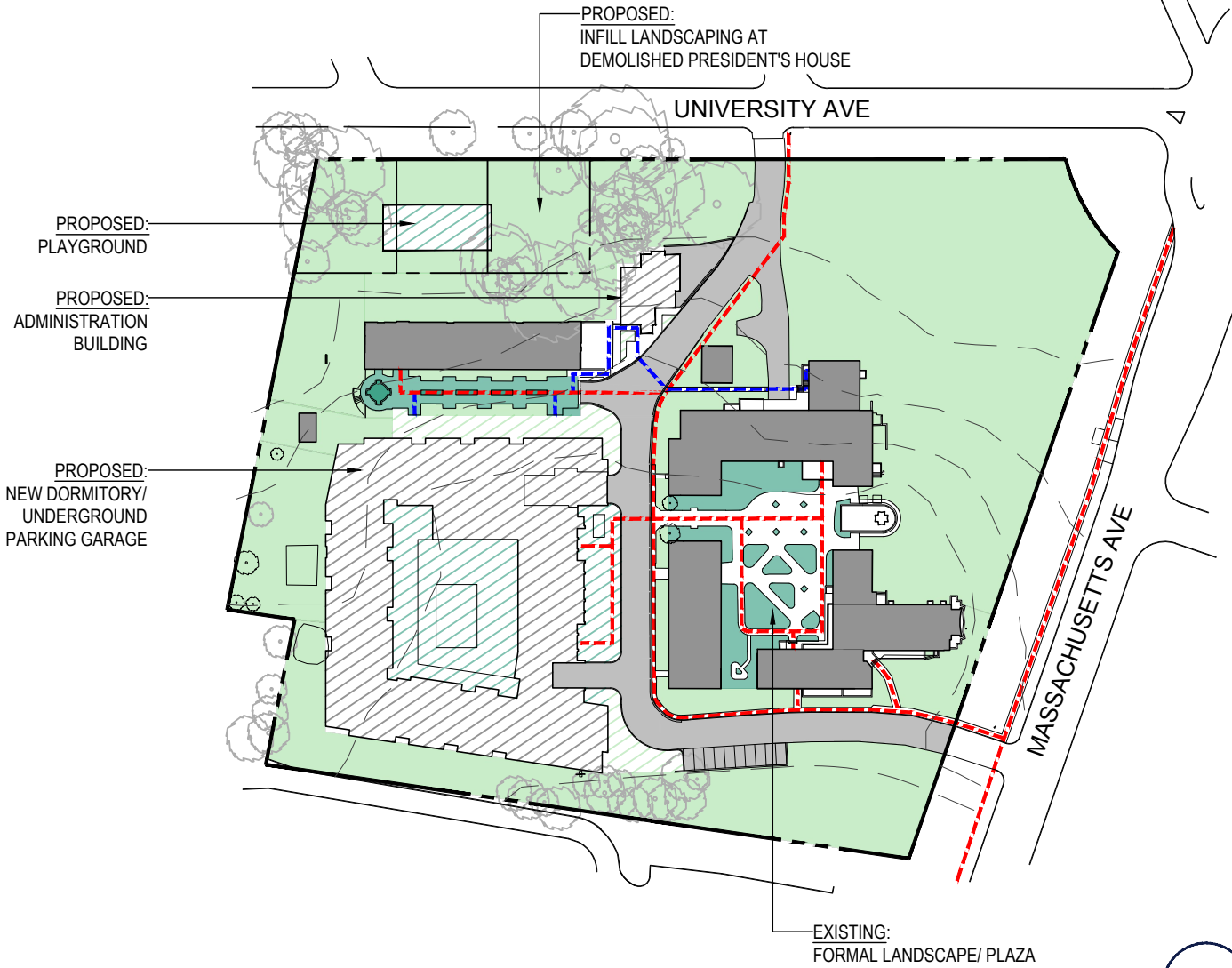



EXHIBIT P

WESLEY SEMINARY CAMPUS PLAN

EXHIBIT P - PROPOSED OPEN SPACE AND PEDESTRIAN SYSTEM



KEY

-  INFORMAL LANDSCAPE/ OPEN SPACE
-  FORMAL LANDSCAPE/ PLAZA
-  PROPOSED INFORMAL LANDSCAPE/ OPEN SPACE
-  PROPOSED FORMAL LANDSCAPE/ PLAZA
-  PROPOSED BUILDING
-  PARKING AREAS AND DRIVEWAYS
-  BUILDINGS
-  PRIMARY PEDESTRIAN PATH
-  SECONDARY PEDESTRIAN PATH
-  CAMPUS BOUNDARY

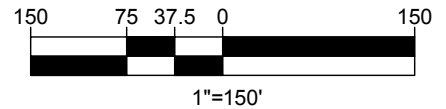

BOHLER DC

1331 PENNSYLVANIA AVE., NW,
STE. 1250 NORTH
WASHINGTON, DC 20004
Phone: (202) 524-5700