

ZONING COMMISSION FOR THE DISTRICT OF COLUMBIA
NOTICE OF PROPOSED RULEMAKING
Z.C. Case No. 17-24
(Zoning Map Amendment @ U.S. Reservation 412 from Unzoned to RA-1)

The Zoning Commission for the District of Columbia (Zoning Commission), pursuant to its authority under § 1 of the Zoning Act of 1938, approved June 20, 1938 (52 Stat. 797; D.C. Official Code § 6-641.01 (2012 Repl.)), hereby gives notice of its intent to amend the Zoning Map of the District of Columbia to rezone from unzoned to the RA-1 zone for the area described in the attached metes and bounds description entitled “Description Fort Greble Playground Part of US Reservation 421.”

Final rulemaking action shall be taken in not less than thirty (30) days from the date of publication of this notice in the *D.C. Register*.

All persons desiring to comment on the subject matter of this proposed rulemaking action should file comments in writing no later than thirty (30) days after the date of publication of this notice in the *D.C. Register*. Comments should be filed with Sharon Schellin, Secretary to the Zoning Commission, Office of Zoning, through the Interactive Zoning Information System (IZIS) at <https://app.dcoz.dc.gov/Login.aspx>; however, written statements may also be submitted by mail to 441 4th Street, N.W., Suite 200-S, Washington, D.C. 20001; by e-mail to zcsubmissions@dc.gov; or by fax to (202) 727-6072. Ms. Schellin may be contacted by telephone at (202) 727-6311 or by email at Sharon.Schellin@dc.gov. Copies of this proposed rulemaking action may be obtained at cost by writing to the above address.

Description
Fort Greble Playground
Part of US Reservation 421
November 30, 2017

Being land know as Fort Greble Playground, as part of U.S. Reservation 421, District of Columbia, as shown on a Transfer of Jurisdiction, per plat thereof December 7, 1972, among the Records of the Office of the Surveyor of the District of Columbia in Recorded Book 158 at Page 140 said land being more particularly described as follow:

Commencing at the northwest corner of US Reservation 421, said point also being the intersection of the east line of Anacostia Freeway, SW (156' wide public street) and the south line of Chesapeake Street, SW (90' wide public street); thence on the south line of said Chesapeake Street, SW **N 81°36'55" E 349.14 feet** to the **Point of Beginning**; thence continuing on said south line

N 81°36'55" E 378.25 feet; thence departing south said line running in, through and over said US Reservation 421 the following courses and distances.

S 5°24'00" E 185.09 feet; thence

S 84°36'00" E 69.03 feet; thence

S 5°24'00" E 201.00 feet; thence

S 84°36'00" E 21.93 feet; thence

S 00°00'00" E 412.94 feet; thence

N 90°00'00" W 320.00 feet; thence

N 00°00'00" W 750.71 feet to the **Point of Beginning**.

Containing a recorded area of **6.01221 acres** or **261,892 square feet**.

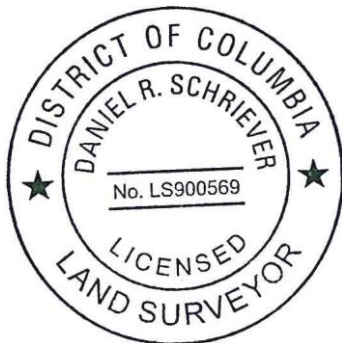

Daniel R. Schriever
License Surveyor
District of Columbia License No. LS 905059
For AMT, LLC