

4. Total contribution to housing trust fund (if applicable):

$C = PHS * ((AV/LA) / FAR) * 50\%$

ZA confirmation of contribution calculation: \_\_\_\_\_ (official use only)

C = Contribution

PHS = Penthouse Habitable Space: \_\_\_\_\_ sq. ft.

Total contribution required: \$ \_\_\_\_\_

AV = Assessed Value of the property (land): \$ \_\_\_\_\_

Amount paid at time of building permit: \$ \_\_\_\_\_

LA = Square feet of land area of property: \_\_\_\_\_ sq. ft.

Amount remaining to be paid no later than CofO: \$ \_\_\_\_\_

FAR = Max permitted non-residential FAR: \_\_\_\_\_

**SECTION D – PROJECT ARCHITECT’S OR PROJECT ENGINEER’S CERTIFICATION**

1. Name: Shalom Baranes Associates PC	2. D.C. Lic. No DC2858	3. Address (include ZIP code) 1010 Wisconsin Ave NW, Suite 900, Washington DC 20007	4. Phone # and Email 202-461-2529, jfischel@sbaranes.com
--	---------------------------	--	---

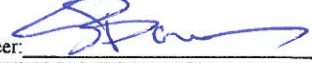
Signature of Project Architect/Engineer:  Shalom Baranes Date: 2/5/20

**SECTION E - APPLICANT’S SIGNATURES**

Owner: I hereby certify that I am the owner of the property, that the application and plans are complete and correct to the best of my knowledge, that if a permit (or permits) is issued, construction will conform to the D.C. construction codes, the Zoning Regulations, and other applicable laws and regulations of the District of Columbia.

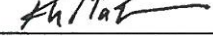
Signature:  Address: 1055 Thomas Jefferson St NW, Suite 600, Washington DC 20007 Date: 1/30/20

Agent: I hereby certify that I have the authority of the owner to make this application. I declare that the application and plans are complete and correct to the best of my knowledge, that if a permit (or permits) is issued, construction will conform to the D.C. construction codes, the Zoning Regulations, and other applicable laws and regulations of the District of Columbia

Signature: Janice Marut Address: 1055 Thomas Jefferson St NW, Suite 600, Washington DC 20007 Date: 2-18-20

**SECTION F - ZONING ADMINISTRATOR CHECKLIST (OFFICIAL USE ONLY)**

	Yes	No	N/A	Comments
<b>Information: Is the application complete?</b>				
1. Penthouse floor plans and elevations	1. <input type="checkbox"/>	1. <input type="checkbox"/>	1. <input type="checkbox"/>	
2. Penthouse financial contribution to a housing trust fund (at least 50% of the amount owed must be paid at the time of permit)	2. <input type="checkbox"/>	2. <input type="checkbox"/>	2. <input type="checkbox"/>	
3. Remaining balance of financial contribution to a housing trust fund must be listed on building permit for payment prior to C of O	3. <input type="checkbox"/>	3. <input type="checkbox"/>	3. <input type="checkbox"/>	
4. Off-site assistance documentation	4. <input type="checkbox"/>	4. <input type="checkbox"/>	4. <input type="checkbox"/>	
5. Are all signatures present?	5. <input type="checkbox"/>	5. <input type="checkbox"/>	5. <input type="checkbox"/>	
<b>Analysis: Does the application demonstrate compliance?</b>				
1. Is the penthouse generated IZ square feet set aside, contribution, or affordable housing production sufficient?	1. <input type="checkbox"/>	1. <input type="checkbox"/>	1. <input type="checkbox"/>	

ZONING ADMINISTRATOR – This certifies that the Addendum is hereby:  Approved  Denied due to the items checked above

Signed \_\_\_\_\_ Date: \_\_\_\_\_

# Armature Works

## Retail Tenant Prospects (Interested in Project or Contacted by Owner)

Tenant Name	Potential Maker Use?
<b>&amp; Pizza</b> Restaurant (Fast Casual)	
<b>Aaron Silverman</b>	
<b>Amazing Lash</b> Health & Beauty	
<b>Antonio Bachour</b> Restaurant (Fast Casual)	
<b>Anxo</b>	Yes
<b>Anytime Fitness</b> Fitness	
<b>Art Soiree</b>	Yes
<b>Artehouse</b> Entertainment & Leisure	
<b>Astro Donuts and Fried Chicken</b> Restaurant (Fast Casual)	
<b>Atlas Brewery Limited</b> Food & Beverage	Yes
<b>Atwater Brewery</b>	Yes
<b>Aviator Nation</b> Apparel & Accessories	
<b>Baked &amp; Wired</b> Restaurant (Fast Casual)	Yes
<b>Barry's Bootcamp Ltd</b> Consumer Services	
<b>BASH Boxing</b> Fitness	
<b>Bethesda Bagels</b> Restaurant (Fast Casual)	
<b>Better Hospitality Group</b> Restaurant (Full Service)	

**BicyckeSPACE**

Yes

---

**Bishops Barbershop****BK lobster**

Restaurant (Fast Casual)

**Black Lion Cafe**

Coffee

**Blank Street Coffee**

Coffee

**Bluestone Lane**

Restaurant (Fast Casual)

**Boka Group**

Restaurant (Full Service)

**Bond Vet**

Healthcare (General)

**Bottega Louie**

Yes

Restaurant (Full Service)

**Bump n Grind**

Restaurant (Fast Casual)

**Burrow**

Home Improvement / Furnishings

**Call Your Mother**

---

**Candid****Caruso's Grocery**

Restaurant (Full Service)

**Catch**

Restaurant (Full Service)

**Chotto Matte**

Restaurant (Full Service)

**Cielo Rojo**

Restaurant (Full Service)

**City State Brewery**

Yes

---

**CityDog! Club****Compass Coffee**

Coffee

**Conte Bikes**

Yes

---

**Condado**

Restaurant (Full Service)

---

**Cookology**

Entertainment &amp; Leisure

---

**Culture Coffee**

Coffee

---

**Culture**

---

**Cut Seven**

Fitness

---

**Das Ethiopian**

Restaurant (Full Service)

---

**Double Zero**

---

**Earth Trex**

---

**Eastern Point Collective (Duck and the Peach, The Wells, La Collina)**

Restaurant (Full Service)

---

**El Sol/Las Gemelas**

Restaurant (Full Service)

---

**Equinox Fitness**

Hospitality

---

**etta**

Restaurant (Full Service)

---

**European Wax Center**

Consumer Services

---

**Everybody Fights**

Fitness

---

**F1 Racing Arcade Concept**

Entertainment &amp; Leisure

---

**Fabio Trabocchi (Fiola Mare, Fiola, Casa Luca)**

Restaurant (Full Service)

---

**Five Iron Golf**

Entertainment &amp; Leisure

---

**Flight Club**

Entertainment &amp; Leisure

---

**Foxtrot**

Grocery

**Franklin Hall**

Restaurant (Full Service)

**Fridge No More Inc.**

Transportation

**Geoffrey Zakarian**

Restaurant (Full Service)

**Ghostburger**

Restaurant (Fast Casual)

**Grace Street Coffee**

Coffee

**Harper Macaw**

Yes

**High Road Cycling**

Sporting Goods

**Hilton Brothers****HI-Wire Brewing**

Restaurant (Other)

Yes

**Indigo Physiotherapy**

Healthcare (General)

**Inspire Nail Bar**

Health &amp; Beauty

**Intown Golf Club LLC**

Hospitality

**Iron Rooster**

Restaurant (Full Service)

**Jaco Juice & Taco Bar**

Restaurant (Fast Casual)

**Jose Garces**

Restaurant (Full Service)

**K9 Resorts**

Other

**La Fin Kitchen**

Restaurant (Full Service)

**LDV Hospitality - John Meadow****Lettuce Entertain You**

Restaurant (Full Service)

**Level99**

Entertainment &amp; Leisure

**Little Coco's**

Restaurant (Full Service)

**Little Food Studio**

Restaurant (Fast Casual)

**Lost Sock Roaster**

Yes

Coffee

**Mah Ze Dahr Bakery, LLC**

Restaurant (Fast Casual)

**Maman**

Restaurant (Fast Casual)

**Manifest**

Yes

Retail (Specialty)

**Mario Batali****Matt Baker**

Yes

Restaurant (Full Service)

**Mayweather Boxing**

Fitness

**Mensch's Market**

Grocery

**Mi Vida**

Restaurant (Full Service)

**Michael Mina**

Restaurant (Full Service)

**Michael Schwartz****Mike Isabella**

Restaurant (Full Service)

**Mission**

Restaurant (Full Service)

**MOIC Museum of Ice Cream**

Entertainment &amp; Leisure

**Nail Saloon**

Health &amp; Beauty

**Nest Salon Suites**

Health &amp; Beauty

**New Realm Brewing Company**

Yes

Food &amp; Beverage

**Nighthawk Pizza**

Restaurant (Full Service)

**NoHo Hospitality**

Restaurant (Full Service)

**One Vet Inc**

Retail (Specialty)

**Organic Krush**

Restaurant (Fast Casual)

**Parker & Ace**

Retail (Specialty)

**Patrick's Pet Care**

Retail (Specialty)

**Peachy**

Health &amp; Beauty

**Philz Coffee**

Coffee

**Plant Based FS Restaurant**

Restaurant (Full Service)

**Playful Pack**

Retail (Specialty)

**Pure Barre**

Fitness

**PureGym****Rad Power Bikes LLC**

Sporting Goods

Yes

**Radio Social**

Entertainment &amp; Leisure

**Rako Coffee**

Coffee

**Ruby's Cafe**

Restaurant (Full Service)

**Salt Line/Mex Concept**

Restaurant (Full Service)

**Salvaje**

Restaurant (Full Service)

**Sandbox VR**

Entertainment &amp; Leisure

**Smoky Barrels**

Entertainment &amp; Leisure

**Spokes**

**Taco Bamba**

Restaurant (Fast Casual)

**The Glossary (Nail Salon)****The UPS Store**

Retail (Specialty)

**Think Food Group**

Yes

Hospitality

**Three Notch'd Brewing Company**

Yes

Retail (Specialty)

**Thrive Vet**

Retail (Specialty)

**Tiger Fork/Calico****Tiki TNT**

Restaurant (Full Service)

**TMPL**

Fitness

**Tom's Watch Bar**

Entertainment &amp; Leisure

**Total Wine****Trek**

Retail (General)

**Tryst Trading Co**

Restaurant (Fast Casual)

**Tynan Coffee and Tea**

Restaurant (Fast Casual)

**Union Kitchen Grocery**

Grocery

**Urban Athletic Club****Urban District Realty**

Real Estate

**Urban Playground**

Retail (General)

**Urbano**

Restaurant (Full Service)

**Victory Brewing**

Yes

Food &amp; Beverage



EXHIBIT G

**Vigilante Coffee**

Coffee

---

**Vin Sur Vingt**

Restaurant (Full Service)

---

**Wagshal's Delicatessen**

Yes

---

Grocery

---

**We the Pizza/Good Stuff**

Restaurant (Fast Casual)

---

**Wilson Hardware**

Restaurant (Full Service)

---

**Yoga 6**

Fitness

---

**Zeke's Coffee**

Coffee

---

EXHIBIT H

# Glassitorium

Armature Works  
Final Proposal

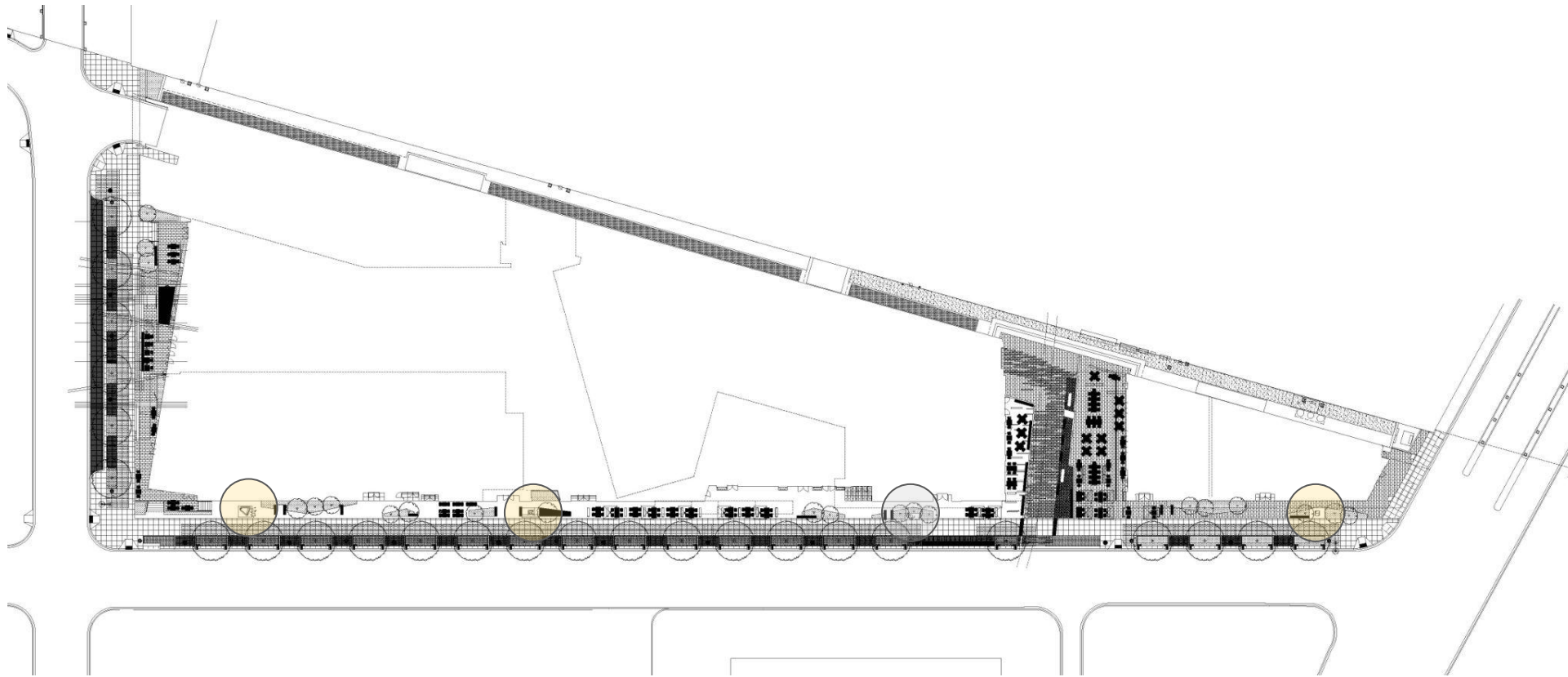

Site A:  
Camera Obscura

Site B:  
Periscope

Site C:  
n/a

Site D:  
Kaleidoscope

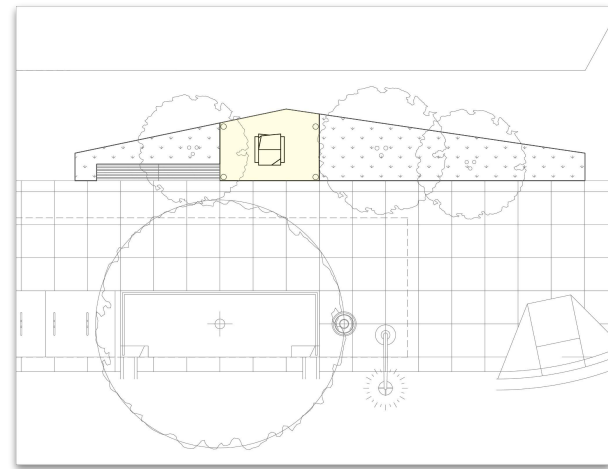
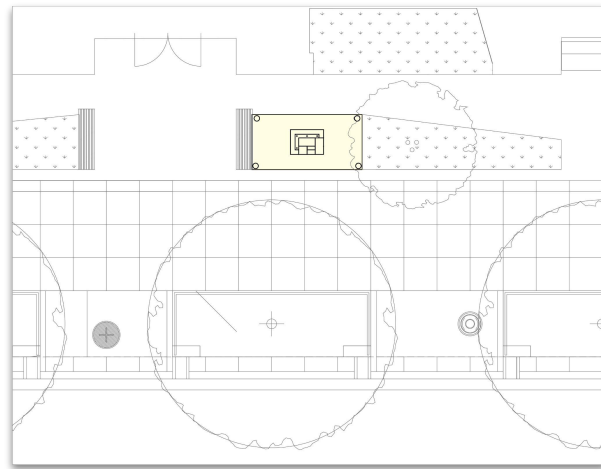
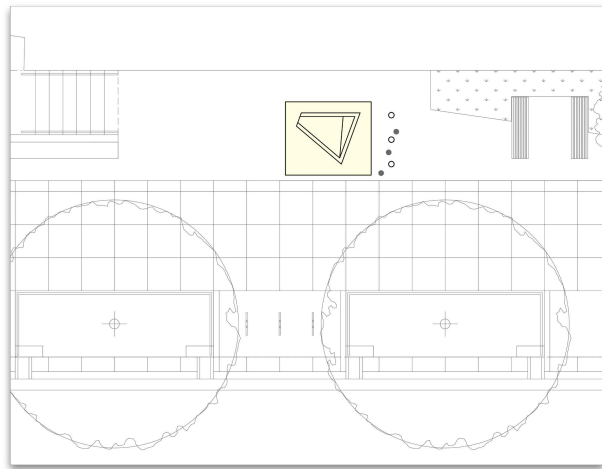

Site A: Camera Obscura

Site B: Periscope

Site D: Kaleidoscope

A black and white photograph featuring a person's silhouette in profile, facing left. The person's hands are raised, with fingers spread, against a background of a grid of light. The light passes through a dark grid, creating a pattern of bright, circular spots. The overall mood is artistic and somewhat mysterious.

# Pixelated Camera Obscura

Site A:  
Camera Obscura



# Site A: Camera Obscura

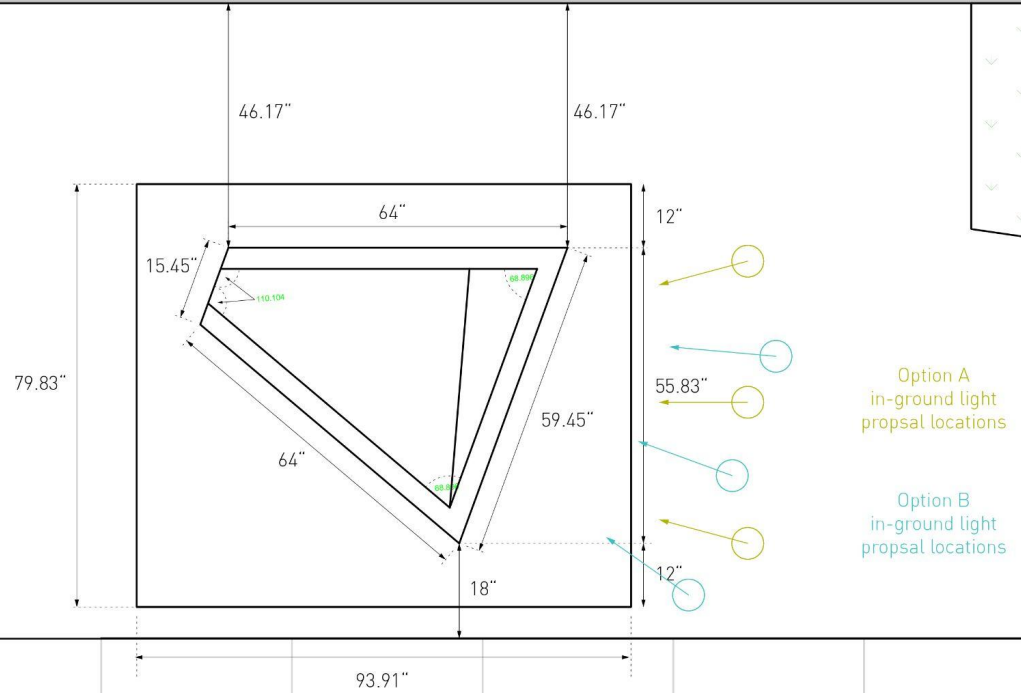

object

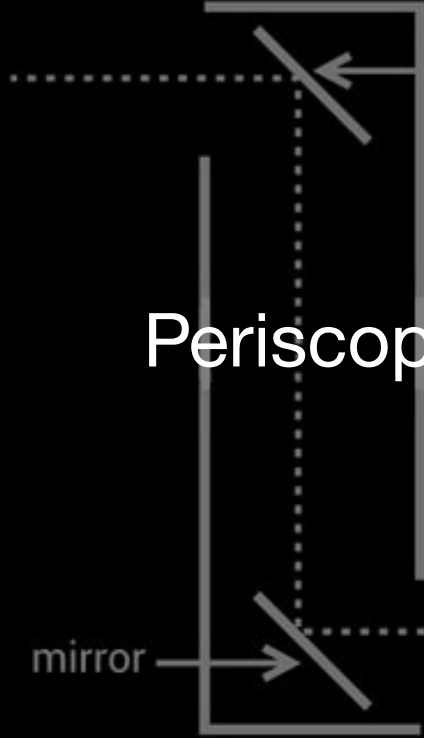

mirror

# Periscope

mirror

eye





Site B:  
Periscope



Site B:  
Periscope



in-ground light  
proposal locations

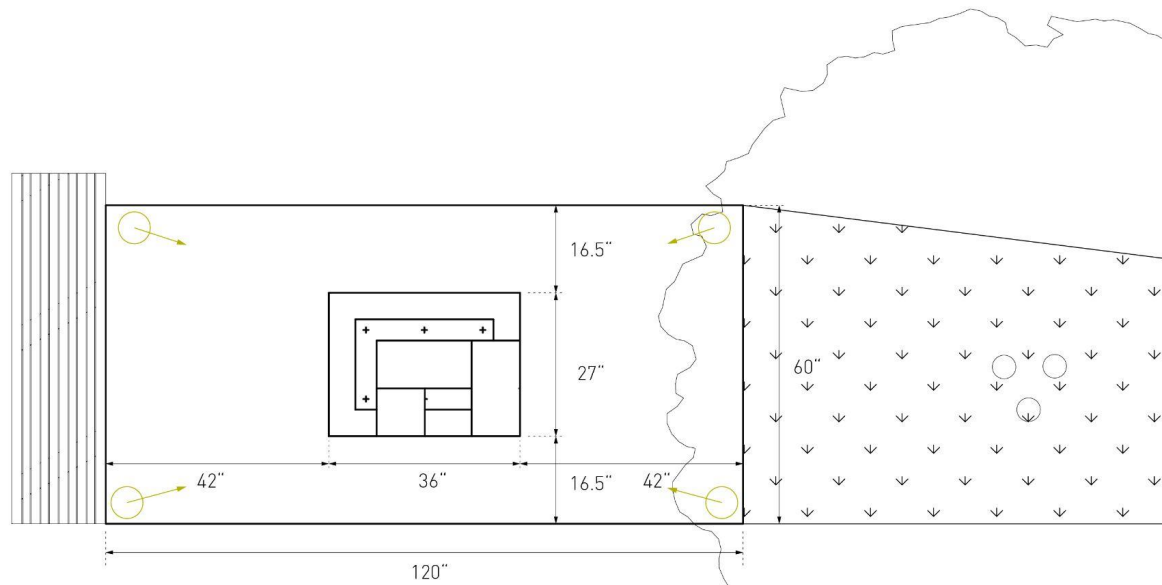

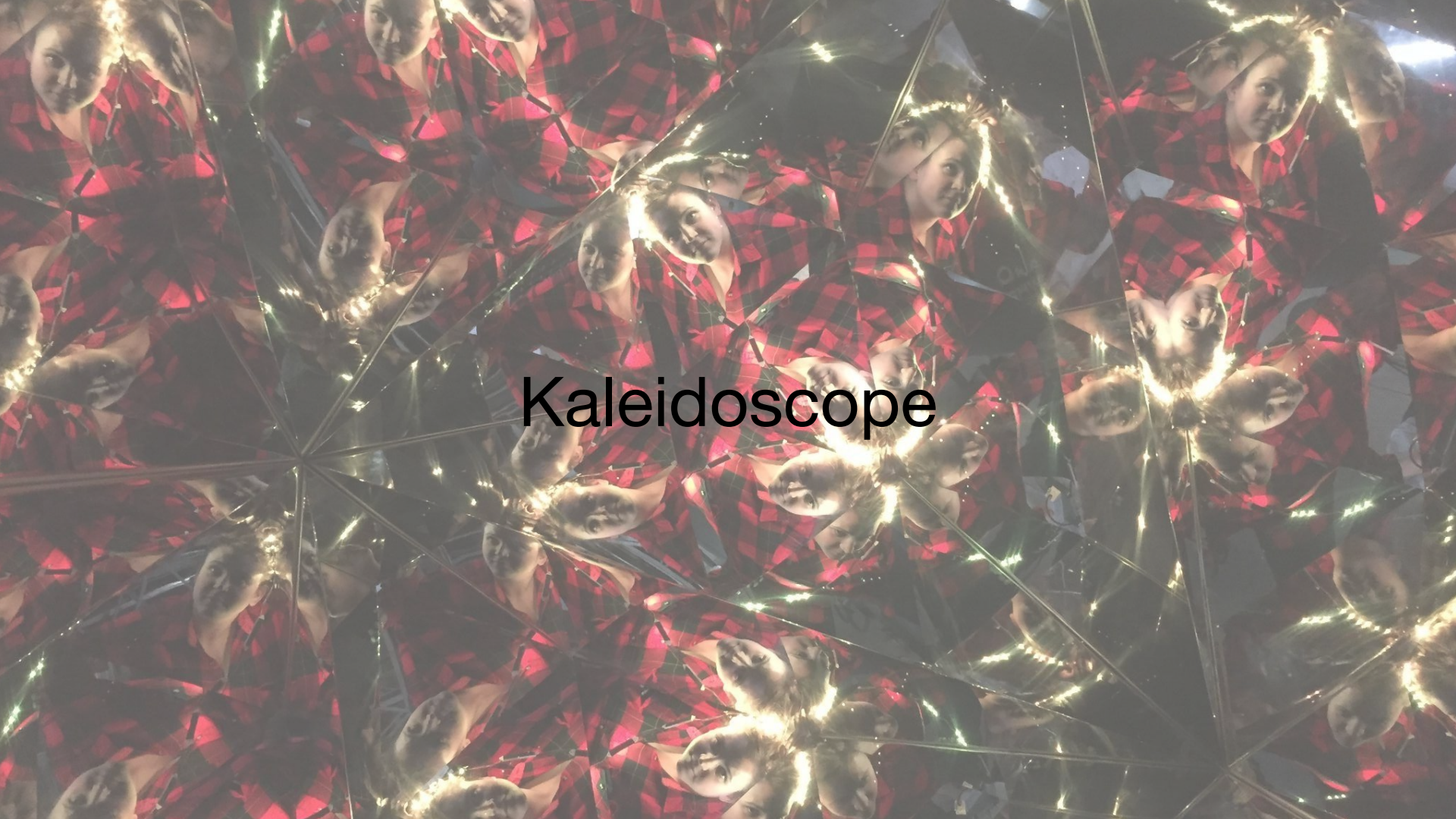

Kaleidoscope

Site D:  
Kaleidoscope (Single - most likely going with single version)

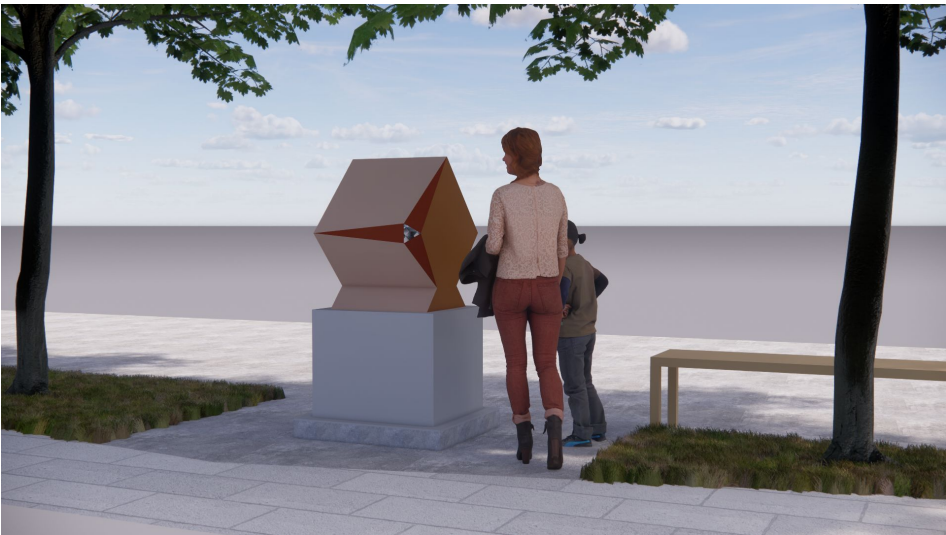

Site D:  
Kaleidoscope (Double)



Site D:  
Kaleidoscope (double)

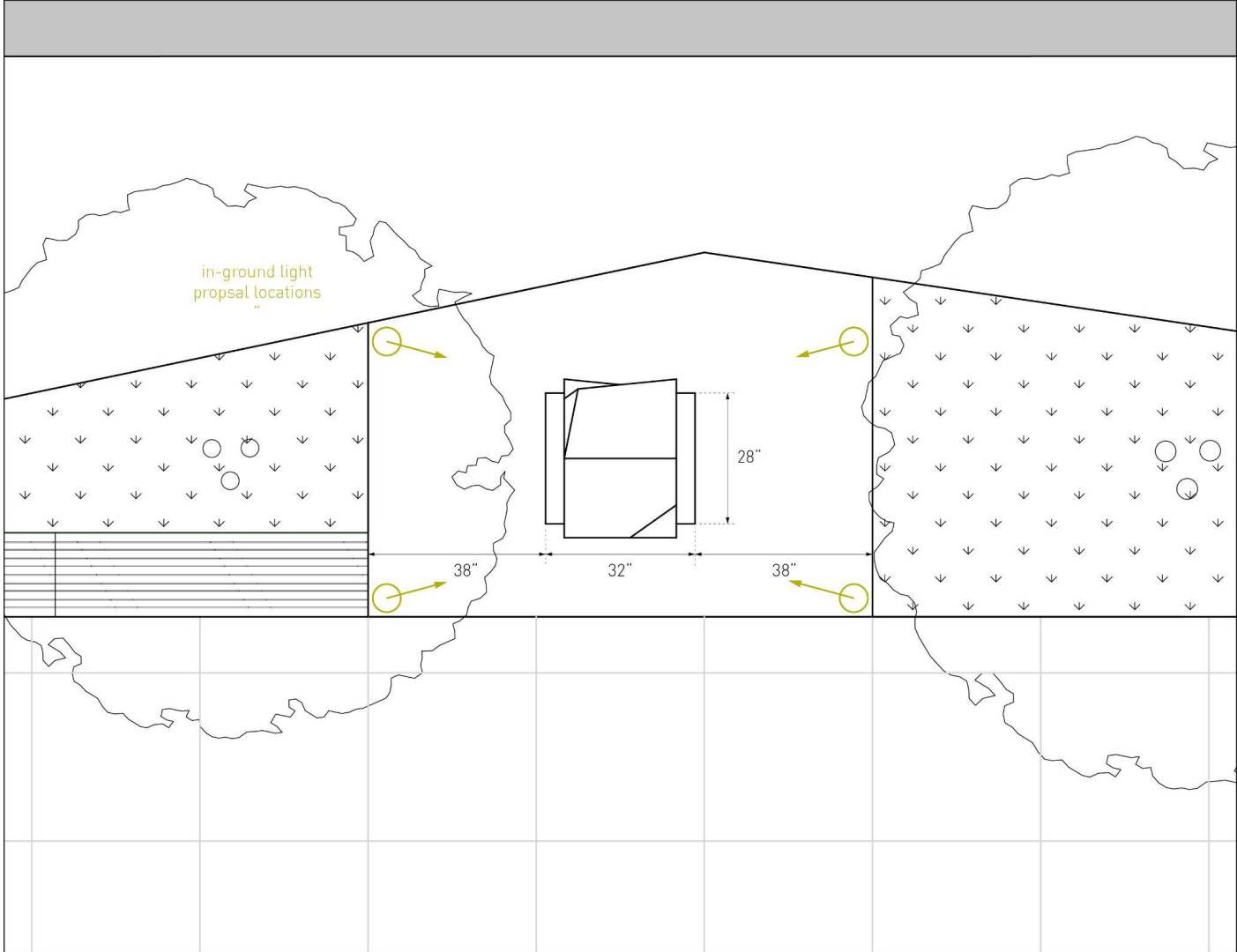

Site D:  
Kaleidoscope (single)

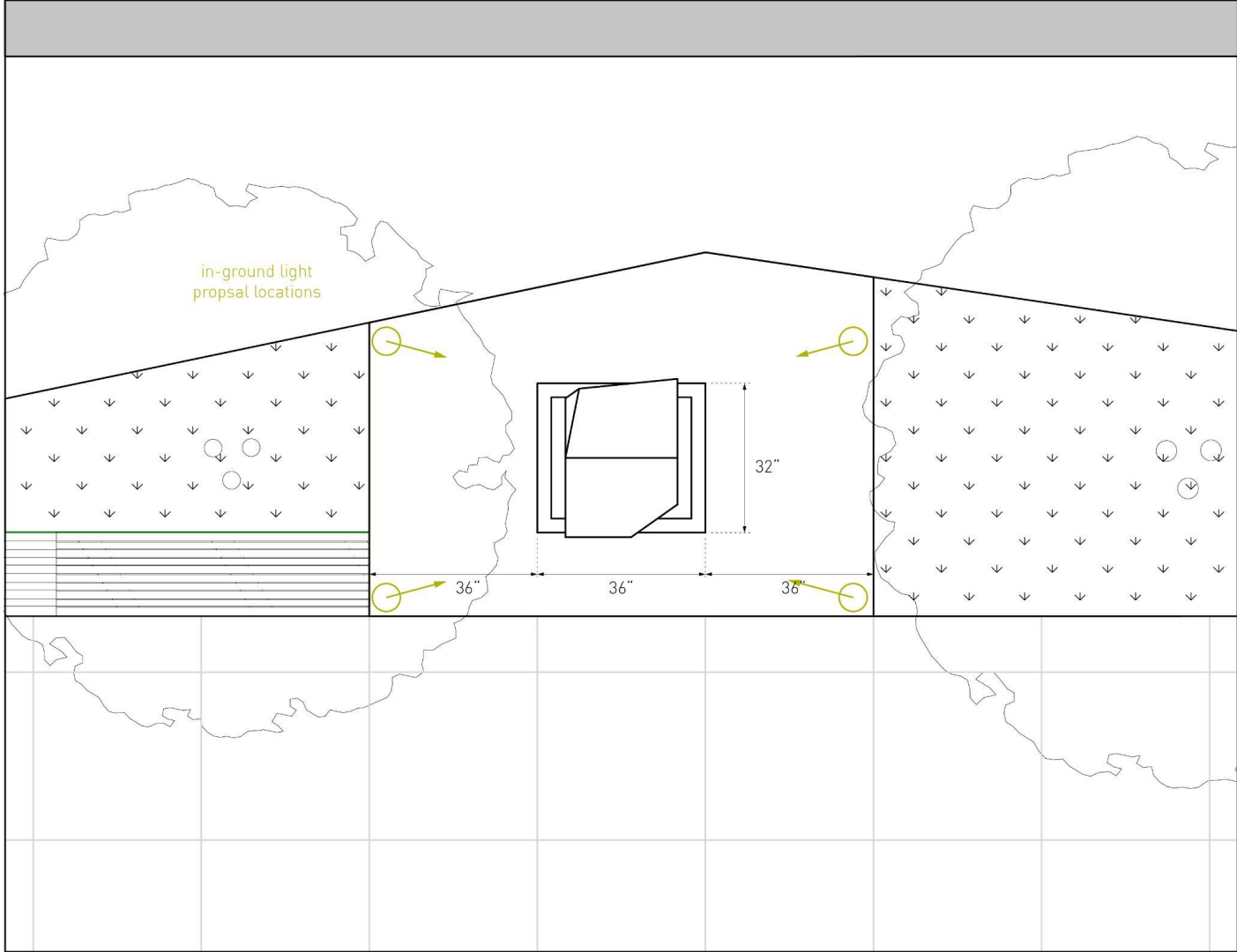

## Proposed Color Palette:

- Used in a variety on all three sculptures
- Paint type: Automotive Paint with protective clear coat or epoxy primer base paint)
- Final palette TBD with fabricators and samples

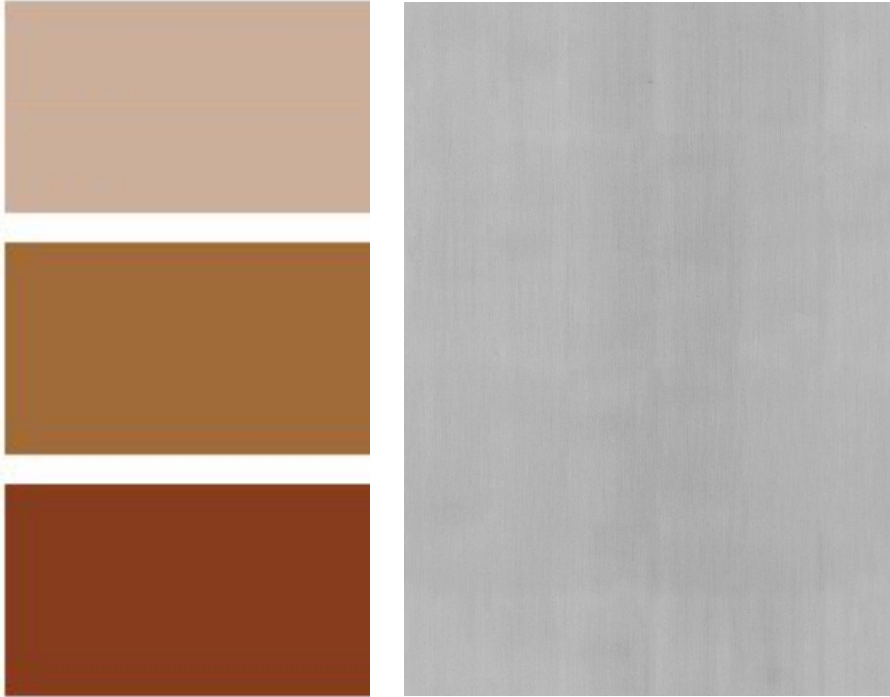

Pale Pink, Camel, Sienna, and Aluminium (the material)



## Examples: In Ground Lighting Considerations

(flush with ground, angle capabilities, and preferred with color options for camera obscura)

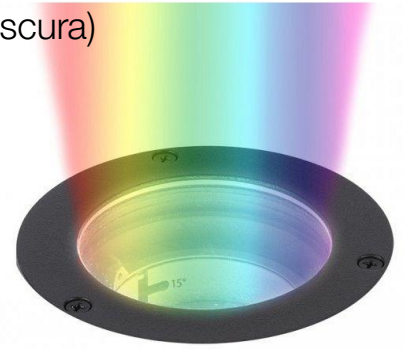
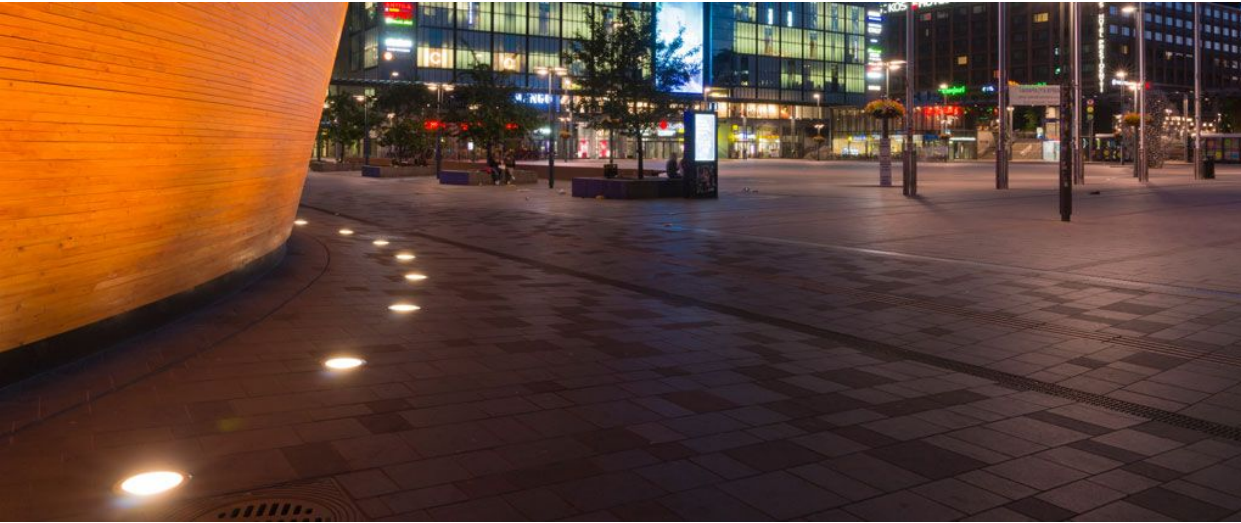

THANK YOU!

