

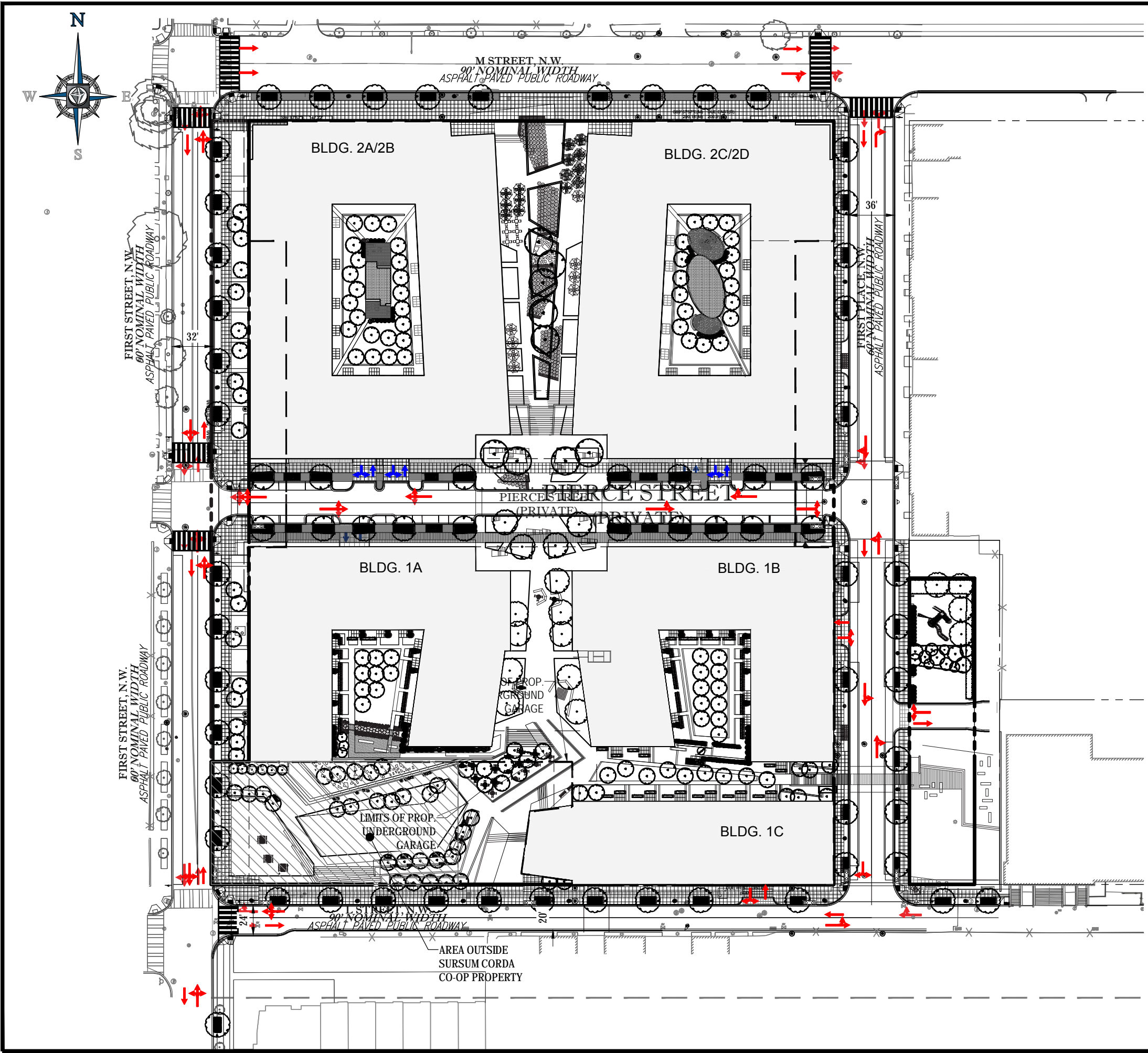

Note: The building massing is shown for illustrative purposes. The design of the buildings will be subject to a future second stage planned unit development design review and approval.

Proposed Modification - Aerial View from North A.37a



# LEGEND

- VEHICULAR CIRCULATION
- LOADING/SERVICE CIRCULATION
- AREA OUTSIDE SURSUM CORDA CO-OP PROPERTY

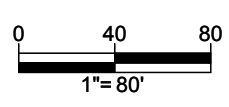

**BOHLER DC**  
 SITE CIVIL AND CONSULTING ENGINEERING  
 PROGRAM MANAGEMENT LANDSCAPE ARCHITECTURE  
 LAND SURVEYING PERMITTING SERVICES TRANSPORTATION SERVICES  
 SUSTAINABLE DESIGN

REVISIONS			
REV	DATE	COMMENT	BY
3	02/25/16	REV. PER AGENCY COMMENTS	SL
4	04/15/16	PHASE 1 PUD	SL

**NOT APPROVED FOR CONSTRUCTION**

THE FOLLOWING STATES REQUIRE NOTIFICATION BY EXCAVATORS, DESIGNERS, OR ANY PERSON PREPARING TO DISTURB THE EARTH'S SURFACE ANYWHERE IN THE STATE IN VIRGINIA, MARYLAND, THE DISTRICT OF COLUMBIA, AND DELAWARE CALL - 811  
 WV 1-800-245-4848 (PA 1-800-245-1778) DC 1-800-257-7777 VA 1-800-552-7001 (MD 1-800-257-7777) (DE 1-800-282-8555)

PROJECT No.:	DC142200
DRAWN BY:	KC
CHECKED BY:	KC
DATE:	07/04/15
SCALE:	1" = 80'
CAD I.D.:	SSB

PROJECT:  
**PUD SET**  
 FOR  
**SURSUM CORDA CO-OP**  
 LOCATION OF SITE  
 FIRST STREET, NW &  
 L STREET, NW  
 WASHINGTON, DC

**BOHLER DC**  
 1301 PENNSYLVANIA AVE., NW, STE. 825  
 WASHINGTON, DC 20004  
 Phone: (202) 524-5700  
 Fax: (202) 524-5701  
 DC@BohlerEng.com

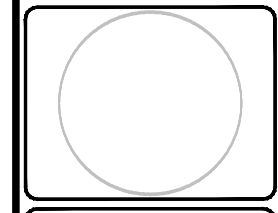



SHEET TITLE:  
**CIRCULATION PLAN (ORIGINAL)**

SHEET NUMBER:  
**C 800**

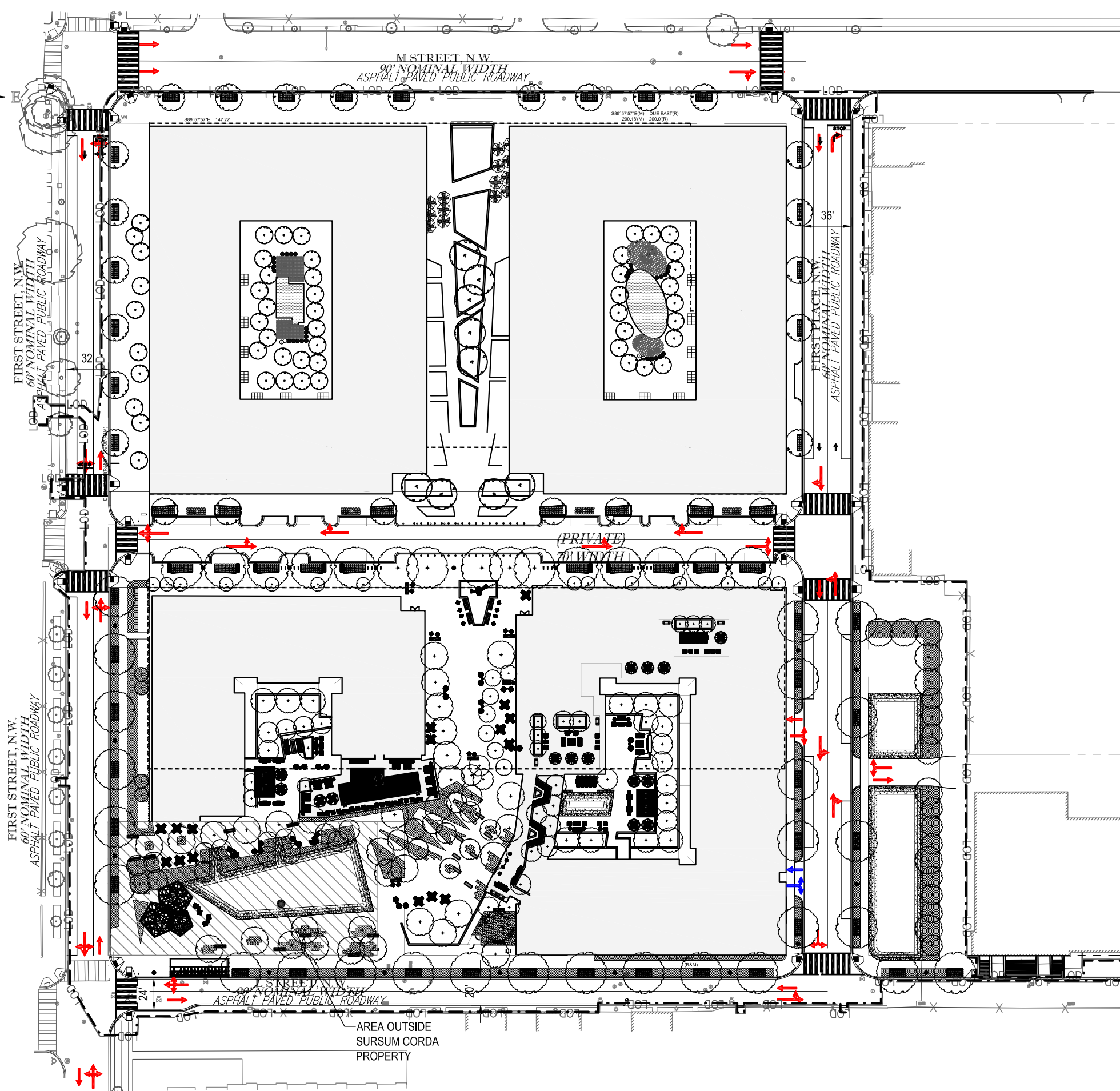
ZONING COMMISSION  
 District of Columbia  
 CASE NO. 15-20  
 EXHIBIT NO. 00000

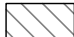

### LEGEND

-  VEHICULAR CIRCULATION
-  LOADING/SERVICE CIRCULATION
-  AREA OUTSIDE SURSUM CORDA PROPERTY

