

LEGEND

- VEHICULAR CIRCULATION
- LOADING/SERVICE CIRCULATION
- AREA OUTSIDE SURSUM CORDA CO-OP PROPERTY

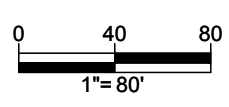

BOHLER DC
 SITE CIVIL AND CONSULTING ENGINEERING
 PROGRAM MANAGEMENT LANDSCAPE ARCHITECTURE
 LAND SURVEYING PERMITTING SERVICES TRANSPORTATION SERVICES
 SUSTAINABLE DESIGN

REVISIONS			
REV	DATE	COMMENT	BY
3	02/25/16	REV. PER AGENCY COMMENTS	SL
4	04/15/16	PHASE 1 PUD	SL

NOT APPROVED FOR CONSTRUCTION

THE FOLLOWING STATES REQUIRE NOTIFICATION BY EXCAVATORS, DESIGNERS, OR ANY PERSON PREPARING TO DISTURB THE EARTH'S SURFACE ANYWHERE IN THE STATE IN VIRGINIA, MARYLAND, THE DISTRICT OF COLUMBIA, AND DELAWARE CALL - 811
 WV 1-800-245-4848 (PA 1-800-245-1778) DC 1-800-257-7777 VA 1-800-552-7001 (MD 1-800-257-7777) (DE 1-800-282-8555)

PROJECT No.:	DC142200
DRAWN BY:	KC
CHECKED BY:	KC
DATE:	07/04/15
SCALE:	1" = 80'
CAD I.D.:	SSB

PUD SET
 FOR
SURSUM CORDA CO-OP
 LOCATION OF SITE
 FIRST STREET, NW &
 L STREET, NW
 WASHINGTON, DC

BOHLER DC
 1301 PENNSYLVANIA AVE., NW, STE. 825
 WASHINGTON, DC 20004
 Phone: (202) 524-5700
 Fax: (202) 524-5701
 DC@BohlerEng.com

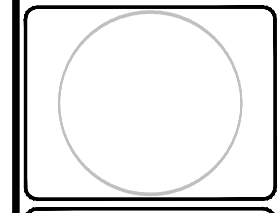

SHEET TITLE:
CIRCULATION PLAN (ORIGINAL)

SHEET NUMBER:
C 800

ZONING COMMISSION
 District of Columbia
 CASE NO. 155200
 (202) 697-3000

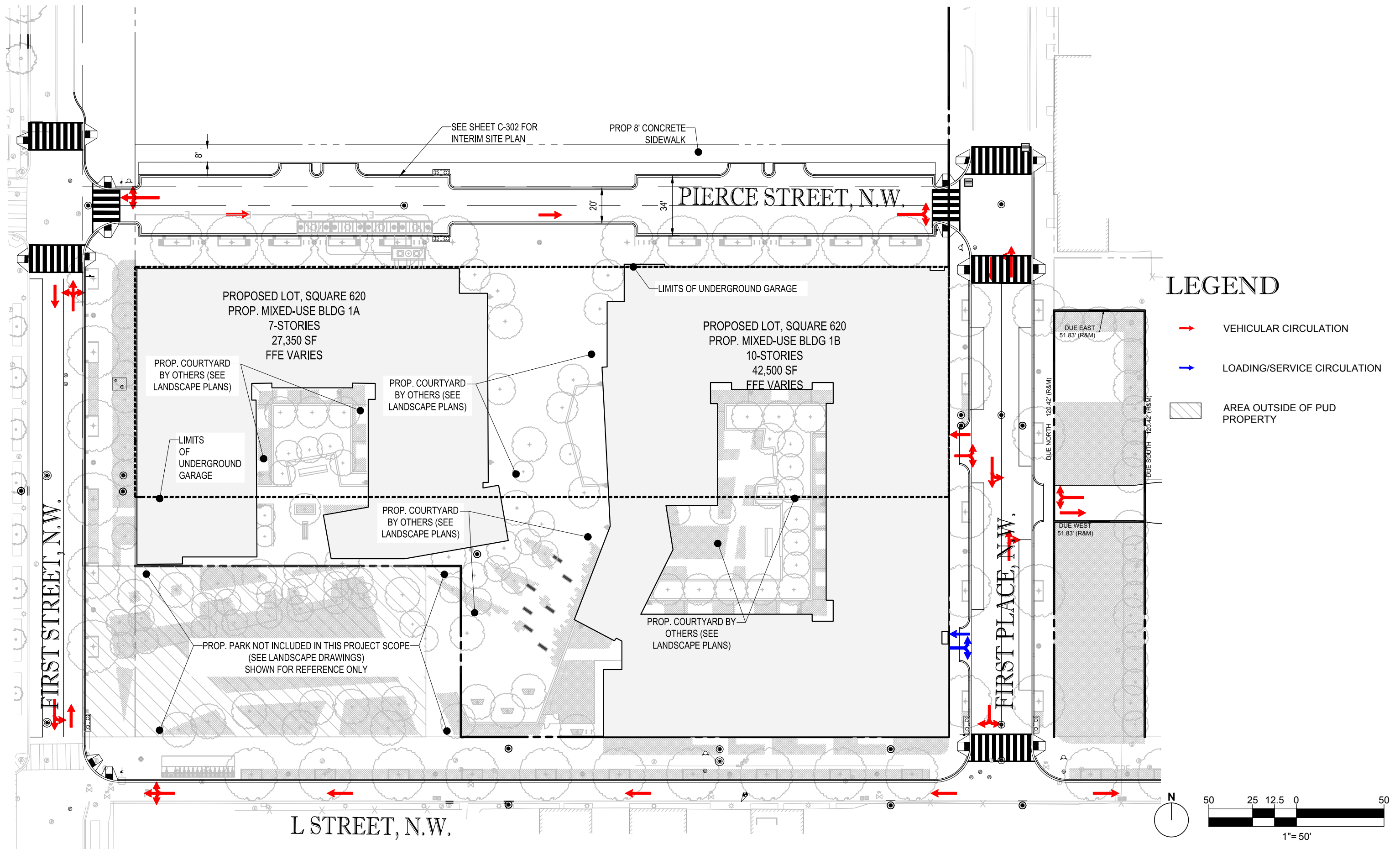

Circulation Plan (Approved Pursuant to ZC ORDER 15-20) C.800a