

EROSION AND SEDIMENT CONTROL LEGEND		
TITLE	KEY	SYMBOL
SAFETY FENCE	SAF	
SILT FENCE	SF	
TEMPORARY STONE CONSTRUCTION ENTRANCE WITH WASH RACK	SCE	
CURB INLET PROTECTION	CIP	
AT GRADE INLET PROTECTION	AGIP	
TREE PROTECTION	TP	

## EROSION & SEDIMENT CONTROL NARRATIVE

EROSION AND SEDIMENT CONTROL AND RUNOFF PROTECTION SHALL BE PROVIDED THROUGH DOEE APPROVED PRACTICES DURING ALL PHASES OF CONSTRUCTION. THE CONDITIONS SHOWN ON THIS PLAN ARE FOR THE PHASE OF DEMOLITION OF THE OVERALL PROJECT SITE. IT IS ANTICIPATED AT THIS TIME THAT EXISTING DRAINAGE DIVIDES SHALL BE UTILIZED FOLLOWING DEMOLITION OF EXISTING SITE FEATURES. CURB INLET PROTECTION, AT GRADE INLET PROTECTION, TEMPORARY STONE CONSTRUCTION ENTRANCE, TREE PROTECTION, SAFETY FENCE AND SILT FENCE SHALL BE USED FOR EACH DRAINAGE AREA TO MITIGATE SEDIMENT LADEN RUNOFF FROM LEAVING THE SITE. IT IS ANTICIPATED THAT DETAILS OF THIS PLAN SHALL BE DESIGNED AS CONSTRUCTION PHASING FOR THIS PROJECT IS FINALIZED.

### C-700 EROSION AND SEDIMENT CONTROL PLAN

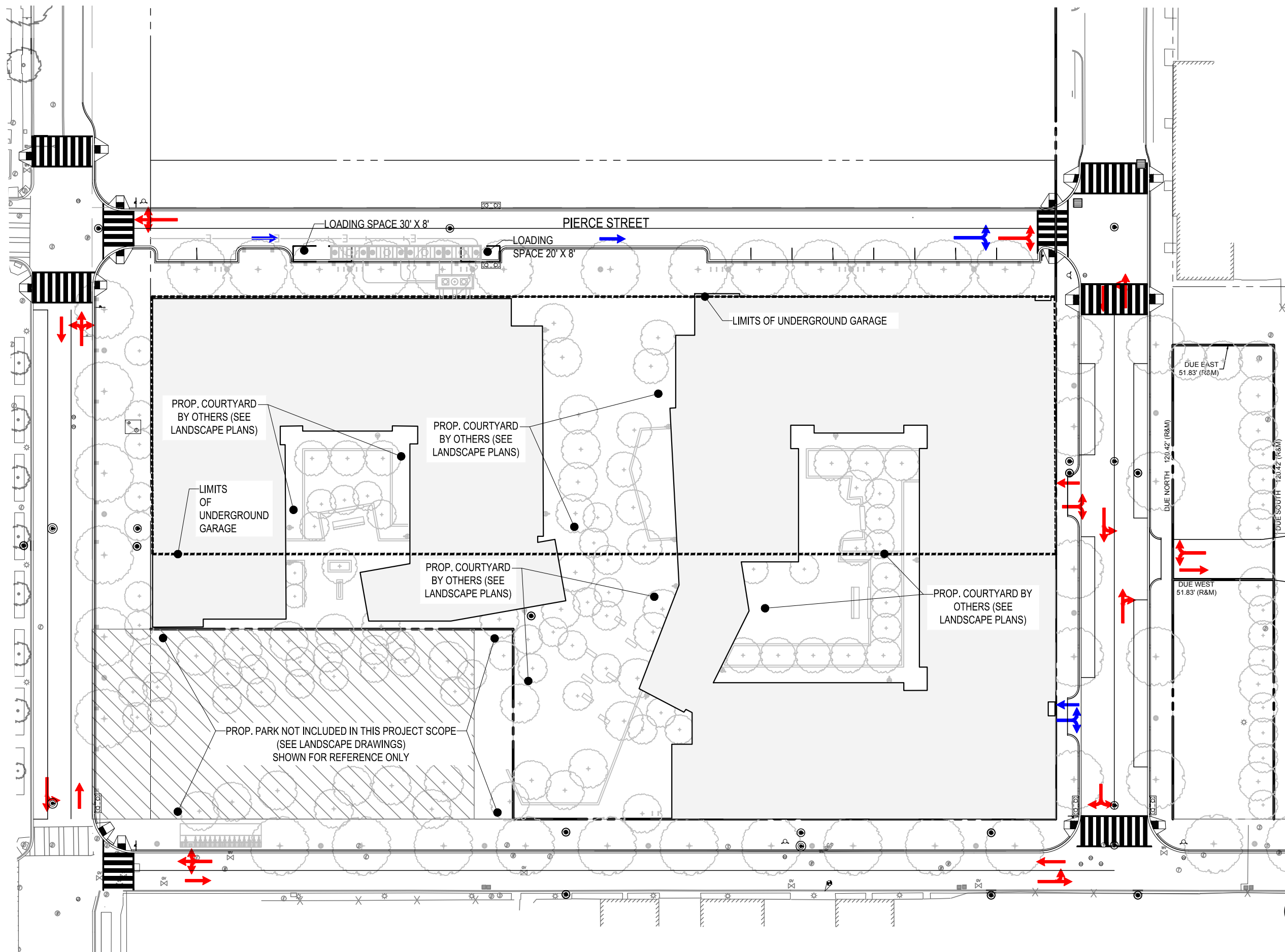

### LEGEND

- VEHICULAR CIRCULATION
- LOADING/SERVICE CIRCULATION
- AREA OUTSIDE OF PUD PROPERTY

