

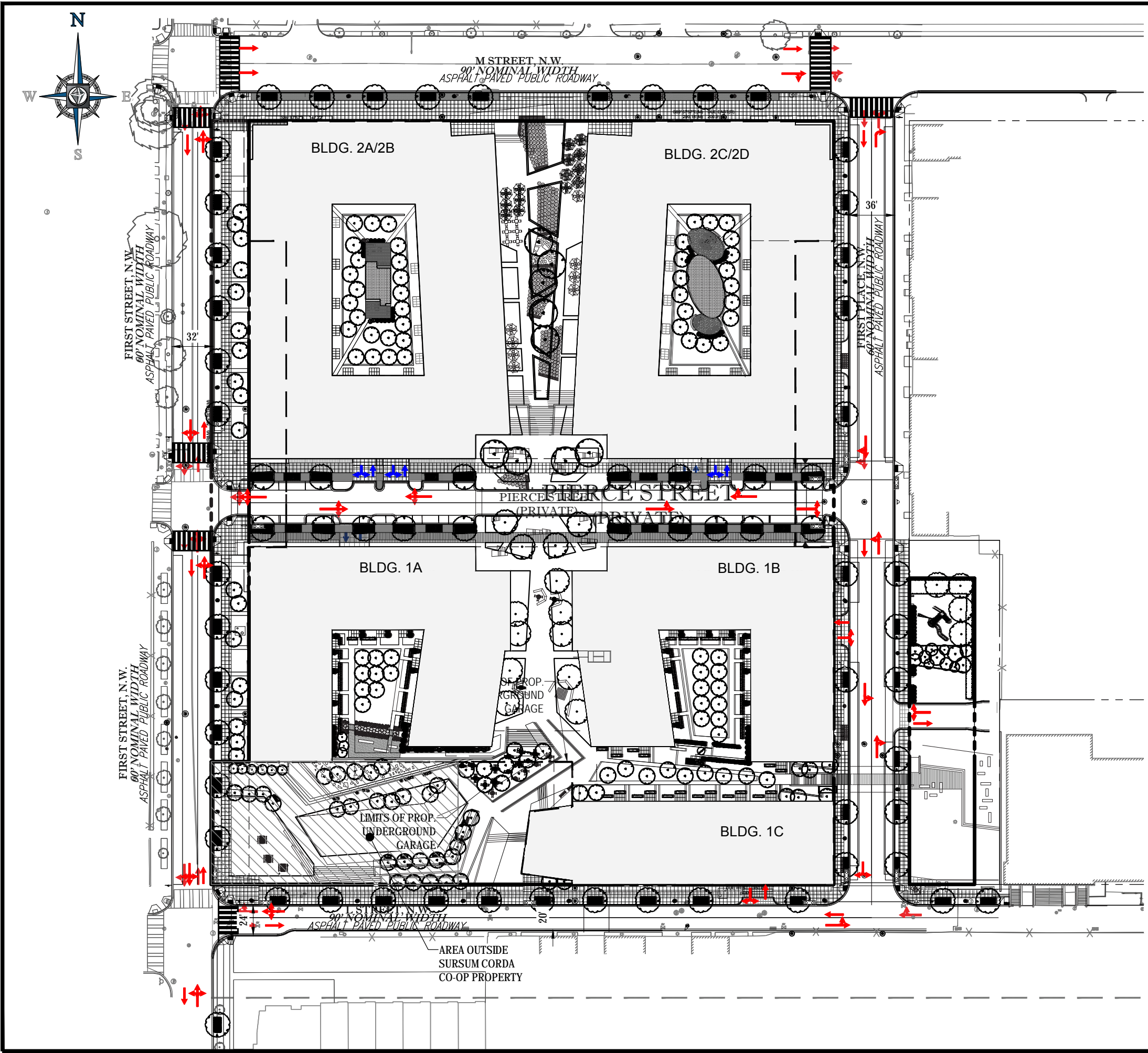

Note: The building massing is shown for illustrative purposes. The design of the building will be subject to a future second stage planned unit development design review and approval.

Proposed Modification - Aerial View from North A.37a



LEGEND

- VEHICULAR CIRCULATION
- LOADING/SERVICE CIRCULATION
- AREA OUTSIDE SURSUM CORDA CO-OP PROPERTY

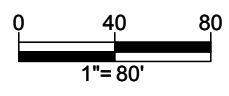

BOHLER DC

SITE CIVIL AND CONSULTING ENGINEERING
PROGRAM MANAGEMENT LANDSCAPE ARCHITECTURE
LAND SURVEYING PERMITTING SERVICES TRANSPORTATION SERVICES
SUSTAINABLE DESIGN

REVISIONS			
REV	DATE	COMMENT	BY
3	02/25/16	REV. PER AGENCY COMMENTS	SL
4	04/15/16	PHASE 1 PUD	SL

NOT APPROVED FOR CONSTRUCTION

THE FOLLOWING STATES REQUIRE NOTIFICATION BY EXCAVATORS, DESIGNERS, OR ANY PERSON PREPARING TO DISTURB THE EARTH'S SURFACE ANYWHERE IN THE STATE IN VIRGINIA, MARYLAND, THE DISTRICT OF COLUMBIA, AND DELAWARE CALL - 811
 WV 1-800-245-4848 (PA 1-800-245-1778) DC 1-800-257-7777 VA 1-800-552-7001 (MD 1-800-257-7777) (DE 1-800-282-8555)

PROJECT No.:	DC142200
DRAWN BY:	KC
CHECKED BY:	KC
DATE:	07/04/15
SCALE:	1" = 80'
CAD I.D.:	SSB

PROJECT:

PUD SET

FOR

SURSUM CORDA CO-OP

LOCATION OF SITE
FIRST STREET, NW &
L STREET, NW
WASHINGTON, DC

BOHLER DC

1301 PENNSYLVANIA AVE., NW, STE. 825
WASHINGTON, DC 20004
Phone: (202) 524-5700
Fax: (202) 524-5701
DC@BohlerEng.com

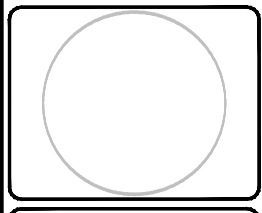

SHEET TITLE:

CIRCULATION PLAN (ORIGINAL)



SHEET NUMBER:

C 800

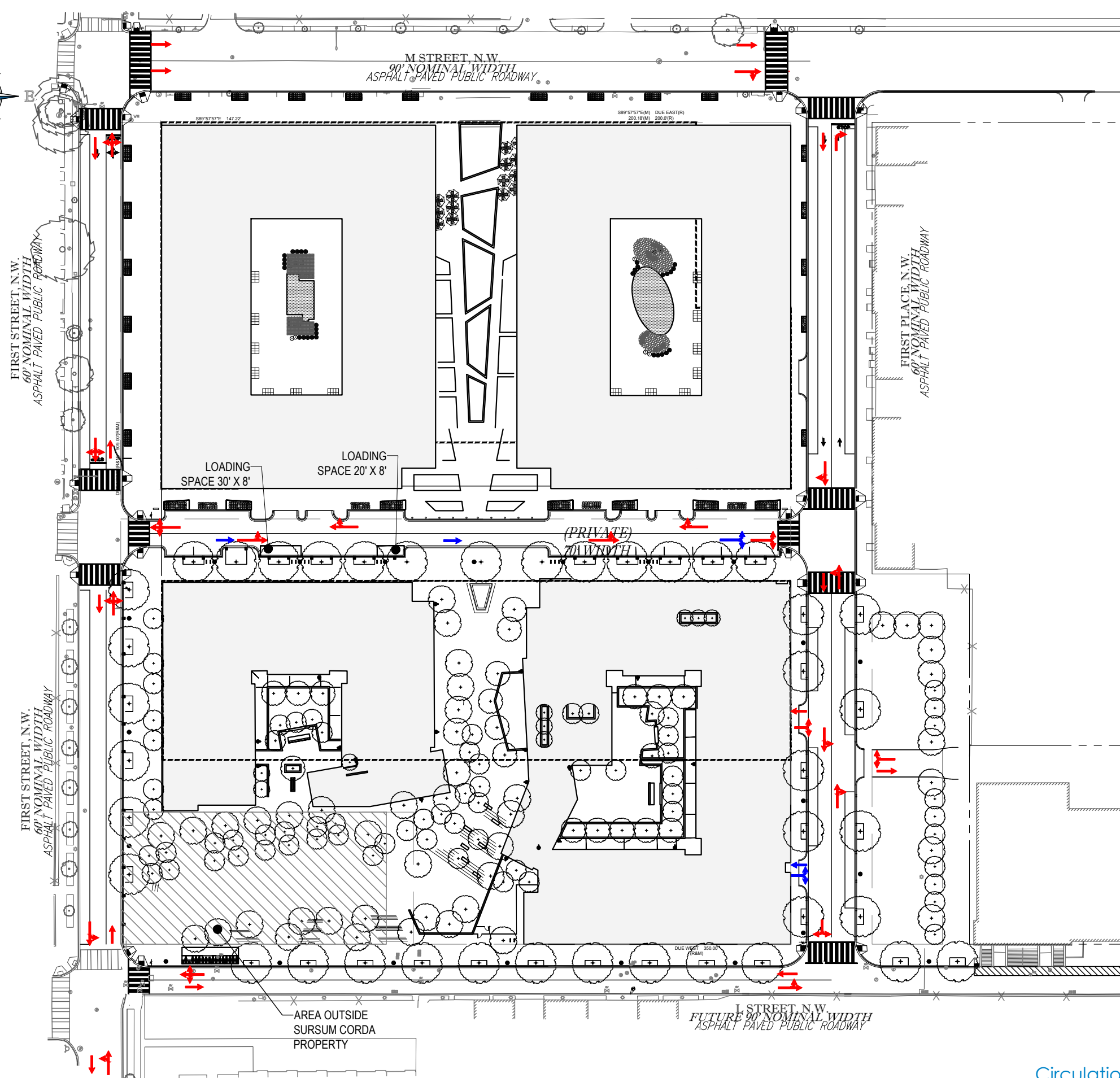
ZONING COMMISSION
District of Columbia
CASE NO. 15-20
EXHIBIT NO. 00000

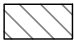

LEGEND

-  VEHICULAR CIRCULATION
-  LOADING/SERVICE CIRCULATION
-  AREA OUTSIDE SURSUM CORDA PROPERTY

