

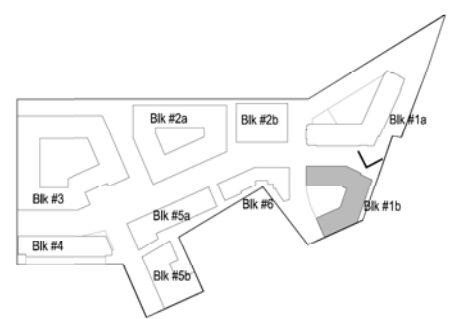

**MATERIALS**

- 1. Brick 1
  - 2. Brick 2
  - 3. Brick 3
  - 4. Metal Balcony
  - 5. Metal Channel
  - 6. Metal Panel 1
  - 7. Metal Panel 2
  - 8. Metal Railing
  - 9. Metal Window 1
  - 10. Metal Window 2
  - 11. Precast Stone 1
  - 12. Precast Stone 2
  - 13. Precast Stone 3
  - 14. Stone
- See Sheets 1.501 to 1.506 for material locations

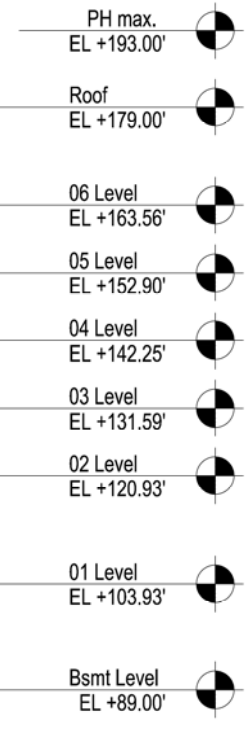

**KEY PLAN**

MRP | REALTY

**680 Rhode Island Ave.** | Washington, DC

**February 26, 2016** | **1.230**



North East Location

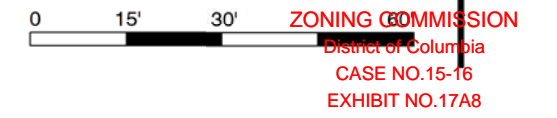





**MATERIALS**

- 1. Brick 1
  - 2. Brick 2
  - 3. Brick 3
  - 4. Metal Balcony
  - 5. Metal Channel
  - 6. Metal Panel 1
  - 7. Metal Panel 2
  - 8. Metal Railing
  - 9. Metal Window 1
  - 10. Metal Window 2
  - 11. Precast Stone 1
  - 12. Precast Stone 2
  - 13. Precast Stone 3
  - 14. Stone
- See Sheets 1.501 to 1.506 for material locations

PH max. EL +193.00'	
Roof EL +179.00'	
06 Level EL +163.56'	
05 Level EL +152.90'	
04 Level EL +142.25'	
03 Level EL +131.59'	
02 Level EL +120.93'	
01 Level EL +103.93'	
Bsmt Level EL +89.00'	

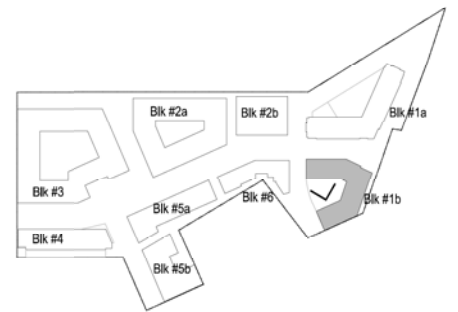

**KEY PLAN**





**MATERIALS**

- 1. Brick 1
  - 2. Brick 2
  - 3. Brick 3
  - 4. Metal Balcony
  - 5. Metal Channel
  - 6. Metal Panel 1
  - 7. Metal Panel 2
  - 8. Metal Railing
  - 9. Metal Window 1
  - 10. Metal Window 2
  - 11. Precast Stone 1
  - 12. Precast Stone 2
  - 13. Precast Stone 3
  - 14. Stone
- See Sheets 1.501 to 1.506 for material locations

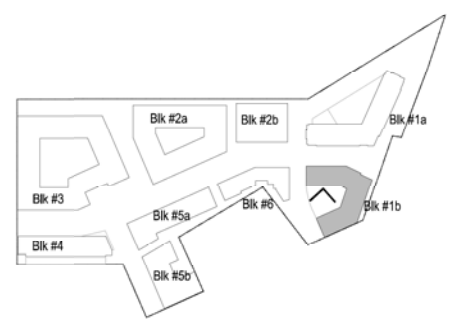
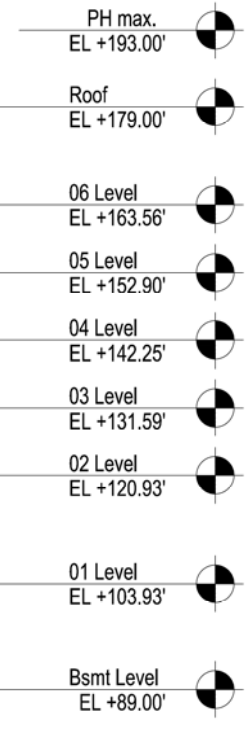

**KEY PLAN**



Signage Canopy Area

- MATERIALS**
1. Brick 1
  2. Brick 2
  3. Brick 3
  4. Metal Balcony
  5. Metal Channel
  6. Metal Panel 1
  7. Metal Panel 2
  8. Metal Railing
  9. Metal Window 1
  10. Metal Window 2
  11. Precast Stone 1
  12. Precast Stone 2
  13. Precast Stone 3
  14. Stone
- See Sheets 1.501 to 1.506 for material locations
- PH max. EL +199.00'
  - Roof EL +185.00'
  - 07 Level EL +169.10'
  - 06 Level EL +158.45'
  - 05 Level EL +147.80'
  - 04 Level EL +137.15'
  - 03 Level EL +126.50'
  - 02 Level EL +113.50'
  - Measuring EL +95.61'
  - 01 Level EL +95.50'

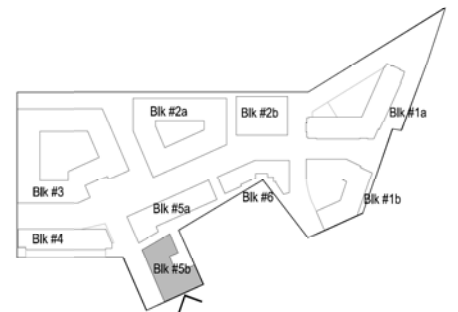

**KEY PLAN**



- MATERIALS**
1. Brick 1
  2. Brick 2
  3. Brick 3
  4. Metal Balcony
  5. Metal Channel
  6. Metal Panel 1
  7. Metal Panel 2
  8. Metal Railing
  9. Metal Window 1
  10. Metal Window 2
  11. Precast Stone 1
  12. Precast Stone 2
  13. Precast Stone 3
  14. Stone
- See Sheets 1.501 to 1.506 for material locations
- PH max.  
EL +199.00'
- Roof  
EL +185.00'
- 07 Level  
EL +169.10'
- 06 Level  
EL +158.45'
- 05 Level  
EL +147.80'
- 04 Level  
EL +137.15'
- 03 Level  
EL +126.50'
- 02 Level  
EL +113.50'
- Measuring  
EL +95.61
- 01 Level  
EL +95.50'

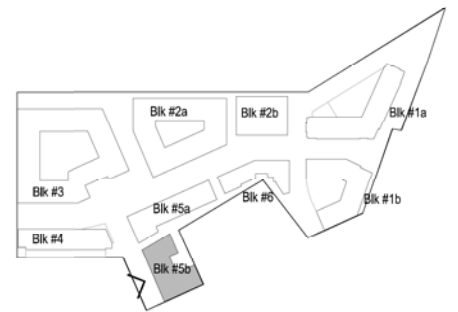

**KEY PLAN**





- MATERIALS**
1. Brick 1
  2. Brick 2
  3. Brick 3
  4. Metal Balcony
  5. Metal Channel
  6. Metal Panel 1
  7. Metal Panel 2
  8. Metal Railing
  9. Metal Window 1
  10. Metal Window 2
  11. Precast Stone 1
  12. Precast Stone 2
  13. Precast Stone 3
  14. Stone
- See Sheets 1.501 to 1.506 for material locations
- PH max. EL +199.00'
  - Roof EL +185.00'
  - 07 Level EL +169.10'
  - 06 Level EL +158.45'
  - 05 Level EL +147.80'
  - 04 Level EL +137.15'
  - 03 Level EL +126.50'
  - 02 Level EL +113.50'
  - Measuring EL +95.61'
  - 01 Level EL +95.50'



**KEY PLAN**







MATERIALS

- 1. Brick 1
  - 2. Brick 2
  - 3. Brick 3
  - 4. Metal Balcony
  - 5. Metal Channel
  - 6. Metal Panel 1
  - 7. Metal Panel 2
  - 8. Metal Railing
  - 9. Metal Window 1
  - 10. Metal Window 2
  - 11. Precast Stone 1
  - 12. Precast Stone 2
  - 13. Precast Stone 3
  - 14. Stone
- See Sheets 1.501 to 1.506 for material locations

- PH max. EL +199.00'
- Roof EL +185.00'
- 07 Level EL +169.10'
- 06 Level EL +158.45'
- 05 Level EL +147.80'
- 04 Level EL +137.15'
- 03 Level EL +126.50'
- 02 Level EL +113.50'
- Measuring EL +95.6l
- 01 Level EL +95.50'



KEY PLAN

