

5 Everts Street Enlargement

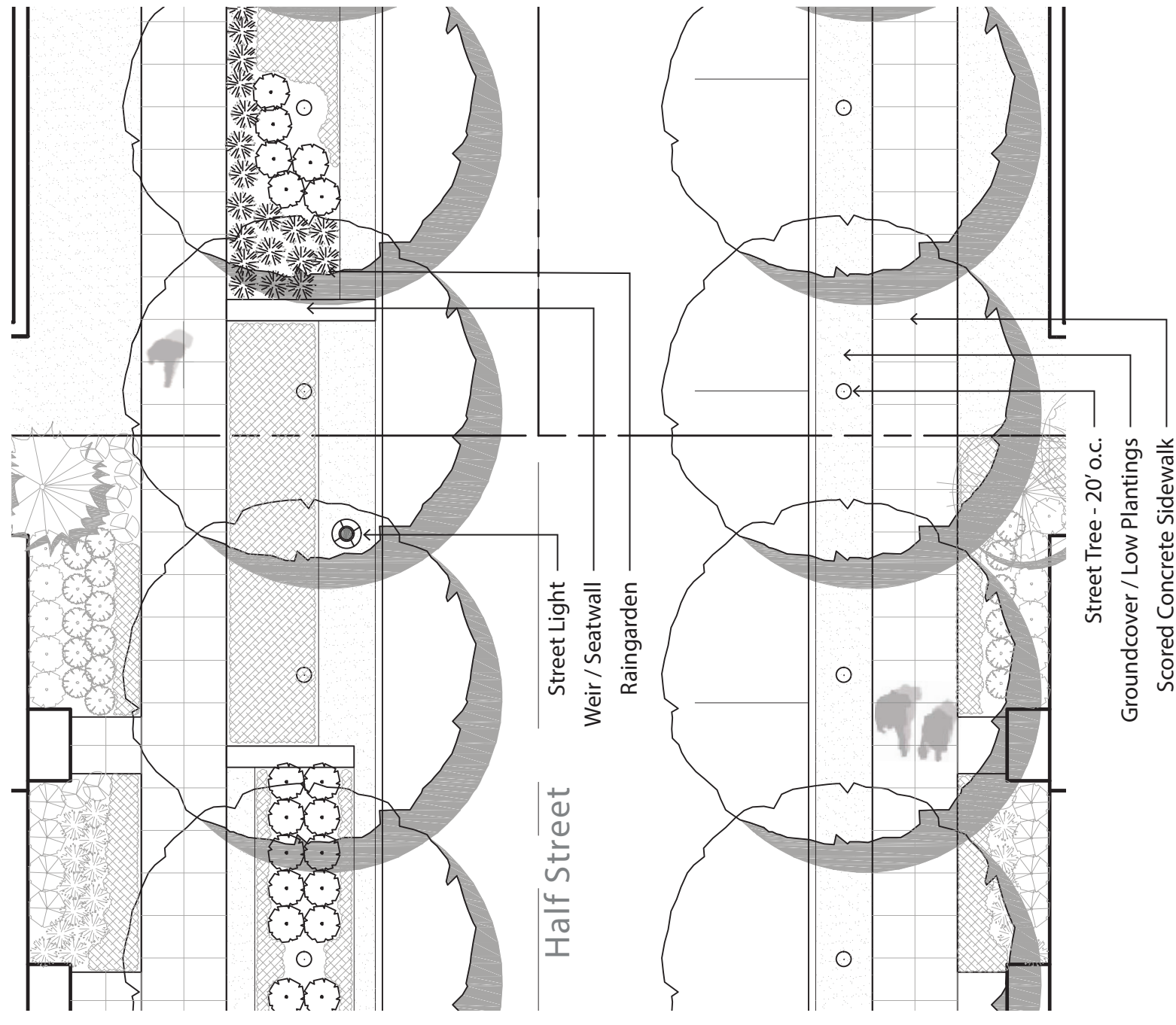





Scale: 1"=10'-0"



6 Half Street Enlargement



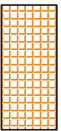

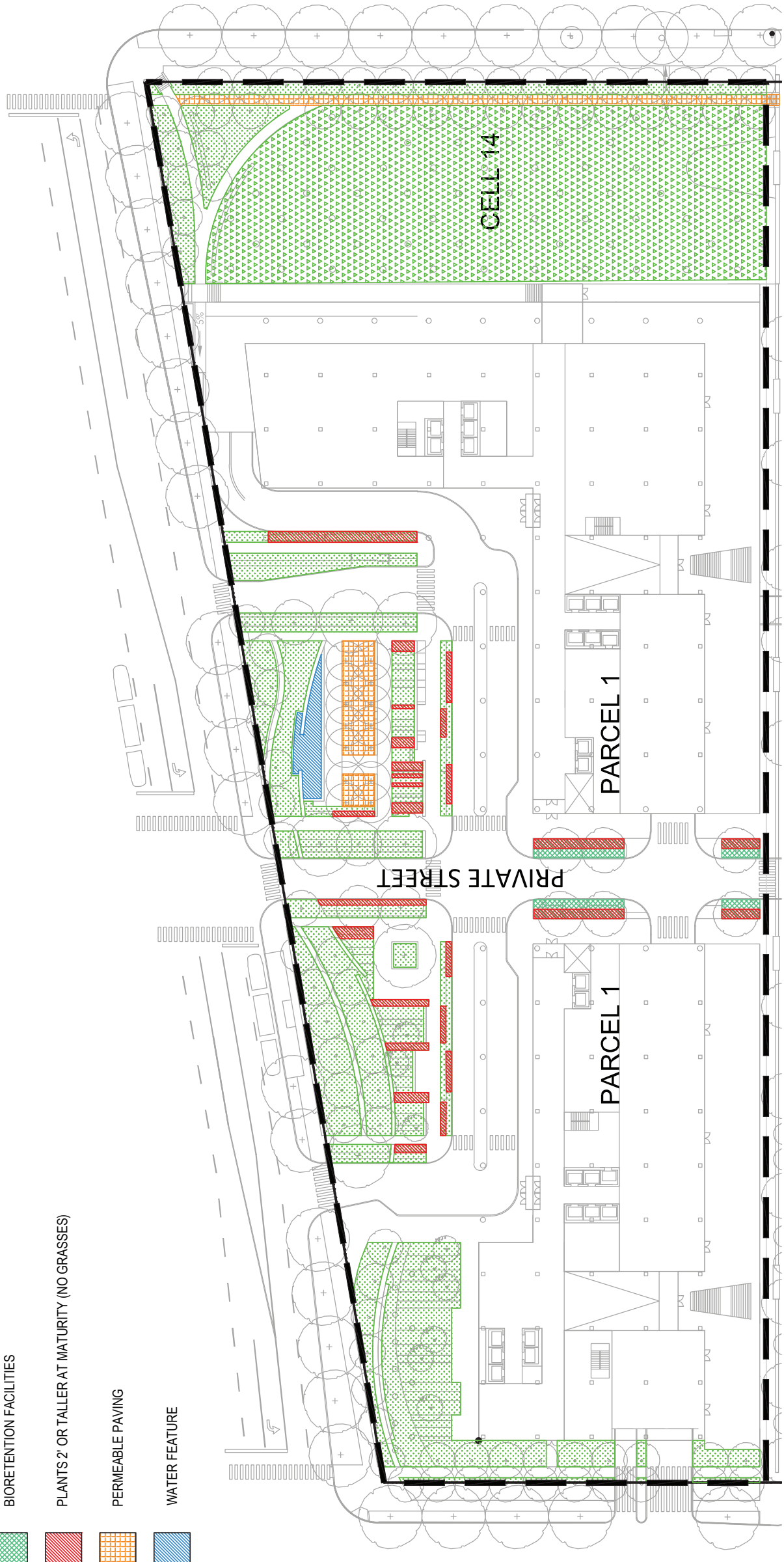

Scale: 1"=10'-0"

GAR LEGEND

-  LANDSCAPED AREA WITH SOIL DEPTH LESS THAN 24"
-  LANDSCAPED AREA WITH SOIL DEPTH GREATER THAN 24"
-  BIORETENTION FACILITIES
-  PLANTS 2' OR TALLER AT MATURITY (NO GRASSES)
-  PERMEABLE PAVING
-  WATER FEATURE



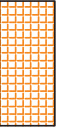



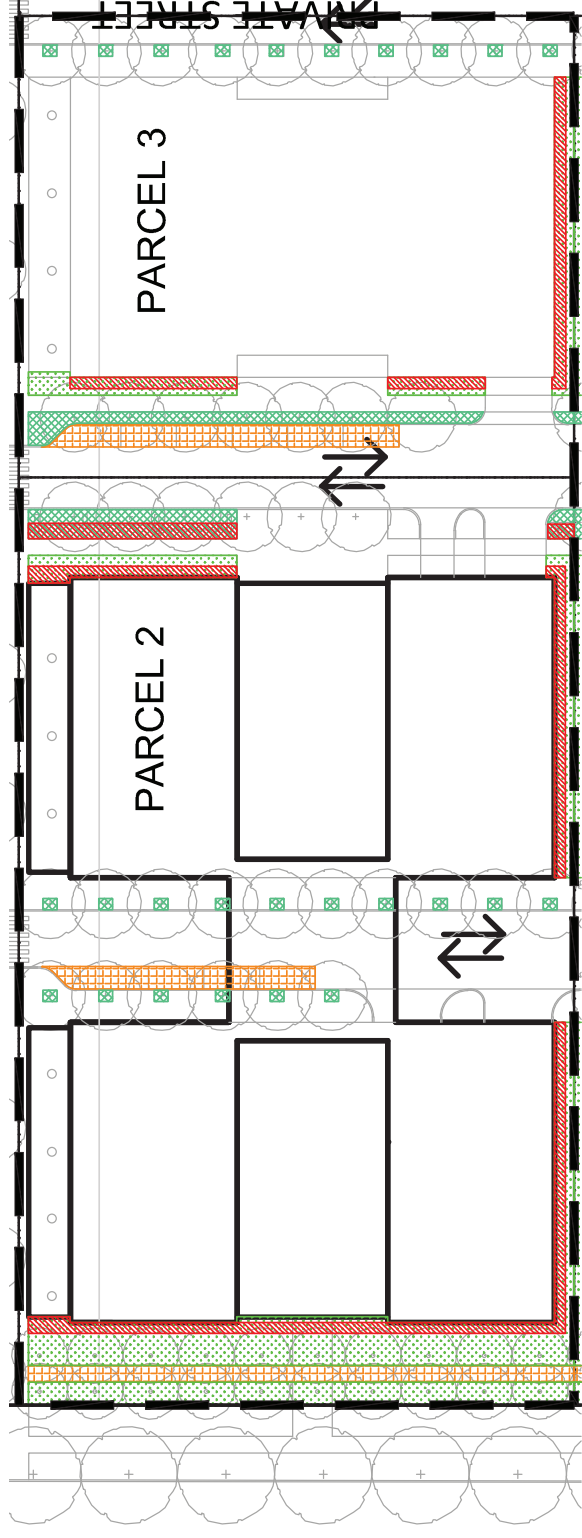

GAR LEGEND

-  LANDSCAPED AREA WITH SOIL DEPTH LESS THAN 24"
-  LANDSCAPED AREA WITH SOIL DEPTH GREATER THAN 24"
-  BIORETENTION FACILITIES
-  PLANTS 2' OR TALLER AT MATURITY (NO GRASSES)
-  PERMEABLE PAVING
-  WATER FEATURE



GAR LEGEND

-  LANDSCAPED AREA WITH SOIL DEPTH LESS THAN 24"
-  LANDSCAPED AREA WITH SOIL DEPTH GREATER THAN 24"
-  BIORETENTION FACILITIES
-  PLANTS 2' OR TALLER AT MATURITY (NO GRASSES)
-  PERMEABLE PAVING
-  WATER FEATURE

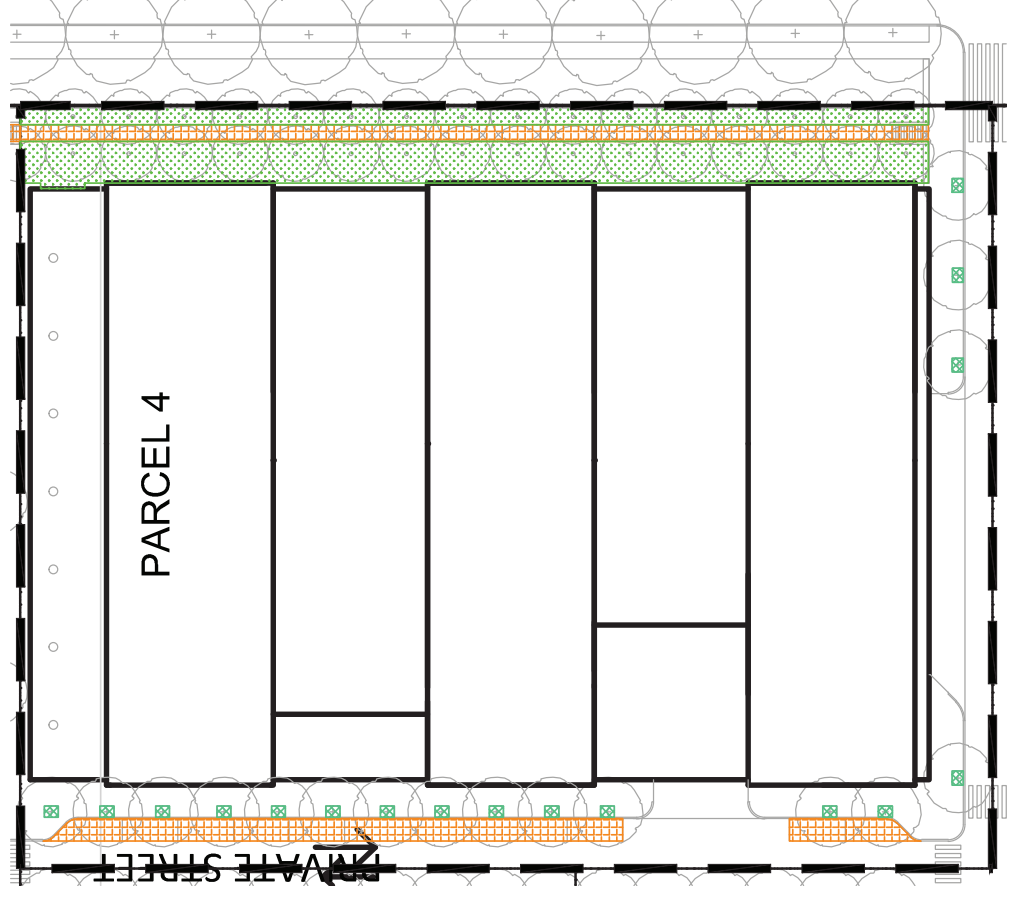





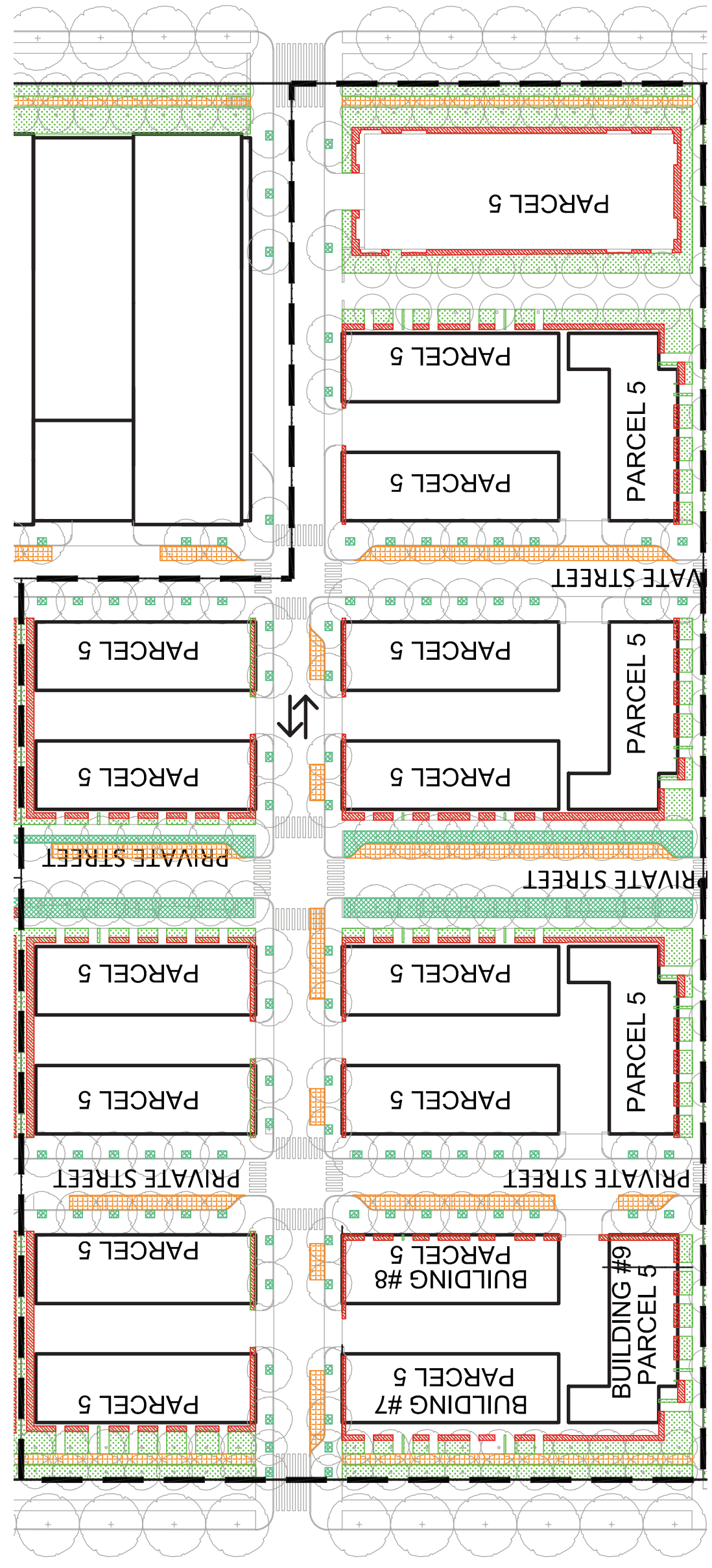

GAR LEGEND

-  LANDSCAPED AREA WITH SOIL DEPTH LESS THAN 24"
-  LANDSCAPED AREA WITH SOIL DEPTH GREATER THAN 24"
-  BIORETENTION FACILITIES
-  PLANTS 2' OR TALLER AT MATURITY (NO GRASSES)
-  PERMEABLE PAVING
-  WATER FEATURE







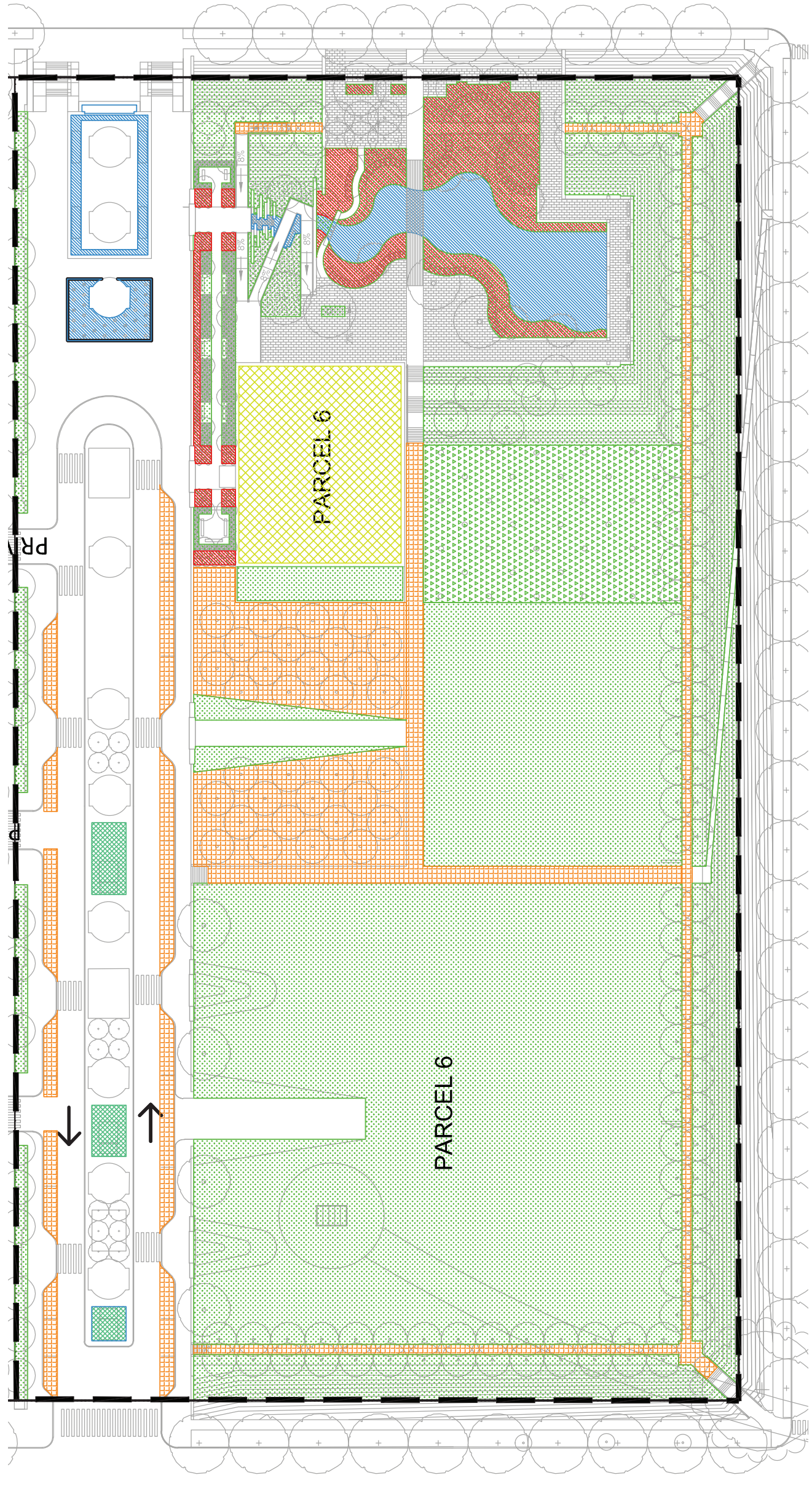

GAR LEGEND

-  LANDSCAPED AREA WITH SOIL DEPTH LESS THAN 24"
-  LANDSCAPED AREA WITH SOIL DEPTH GREATER THAN 24"
-  BIORETENTION FACILITIES
-  VEGETATED ROOF (OVER 2" BUT LESS THAN 8")
-  PLANTS 2' OR TALLER AT MATURITY (NO GRASSES)
-  PERMEABLE PAVING
-  WATER FEATURE

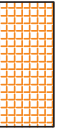

GAR LEGEND

-  LANDSCAPED AREA WITH SOIL DEPTH LESS THAN 24"
-  LANDSCAPED AREA WITH SOIL DEPTH GREATER THAN 24"
-  BIORETENTION FACILITIES
-  PLANTS 2' OR TALLER AT MATURITY (NO GRASSES)
-  PERMEABLE PAVING
-  WATER FEATURE

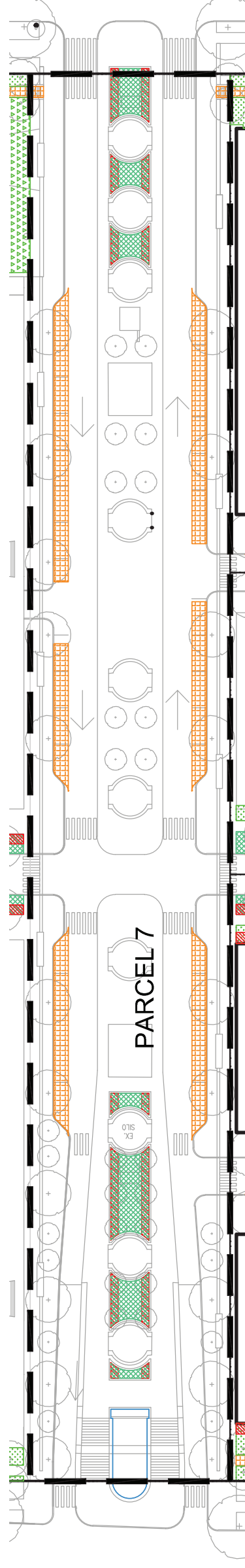

Green Area Ratio Scoresheet		Ward	Lot	Square	Zoning District
Address					
Other / BZA Order					
		enter sq ft of lot 1,075,358 SCORE 0.254 multiplier			
Landscape Elements (select one of the following for each area)					
A	Landscaped areas with a soil depth of less than 24"	16,043.4	0.3	53,478	enter sq ft
2	Landscaped areas with a soil depth of 24" or greater	141,100.2	0.6	235,167	enter sq ft
3	Bioretention facilities	5,128.8	0.4	12,822	enter sq ft
B	Plantings (credit for plants in landscaped areas from Section A)	48,861.4	0.2	244,307	enter sq ft
1	Groundcovers, or other plants less than 2' tall at maturity				
2	Plants, not including grasses, 2' or taller at maturity - calculated at 9 sq ft per plant (typically planted no closer than 18" on center)	6,941.7	0.3	2,571	enter number of plants
3	Tree canopy for all new trees 2.5" to 6" in diameter or equivalent - calculated at 50 sq ft per tree	17,275.0	0.5	691	enter number of trees
4	Tree canopy for new trees 6" diameter or larger or equivalent - calculated at 250 sq ft per tree		0	0	enter number of trees
5	Tree canopy for preservation of existing tree 6" to 12" in diameter or larger or equivalent - calculated at 250 sq ft per tree		0	0	enter number of trees
6	Tree canopy for preservation of existing tree 12" to 18" in diameter or larger or equivalent - calculated at 600 sq ft per tree		0	0	enter number of trees
7	Tree canopy for preservation of all existing trees 18" to 24" in diameter or equivalent - calculated at 1300 sq ft per tree		0	0	enter number of trees
8	Tree canopy for preservation of all existing trees 24" in diameter or larger or equivalent - calculated at 2000 sq ft per tree		0	0	enter number of trees
9	Vegetated wall, plantings on a vertical surface		0.6	0	enter sq ft
C	Vegetated or "green" roofs	6,600.0	0.6	11,000	enter sq ft
1	Over at least 2" and less than 8" of growth medium				
2	Over at least 8" of growth medium		0.8	0	enter sq ft
D	Permeable Paving***	23,489.6	0.4	58,724	enter sq ft
1	Permeable paving over at least 6" and less than 24" of soil or gravel				
2	Permeable paving over at least 24" of soil or gravel		0.5	0	enter sq ft
E	Other				
1	Enhanced tree growth systems***		0.4	0	enter sq ft
2	Renewable energy generation		0.5	0	enter sq ft
3	Approved water features	2,028.0	0.2	10,140	enter sq ft
H	Bonuses	5,694.8	0.1	56,948	enter sq ft
1	Native plant species				
2	Landscaping in food cultivation		0.1	0	enter sq ft
3	Harvested stormwater irrigation		0.1	0	enter sq ft
sub-total of sq ft = 683,327 Green Area Ratio numerator = 273,163 Total square footage of all permeable paving and enhanced tree growth = 23,490 *** Permeable paving and structural soil together may not qualify for more than one third of the Green Area Ratio score.					

(INTENTIONALLY BLANK)

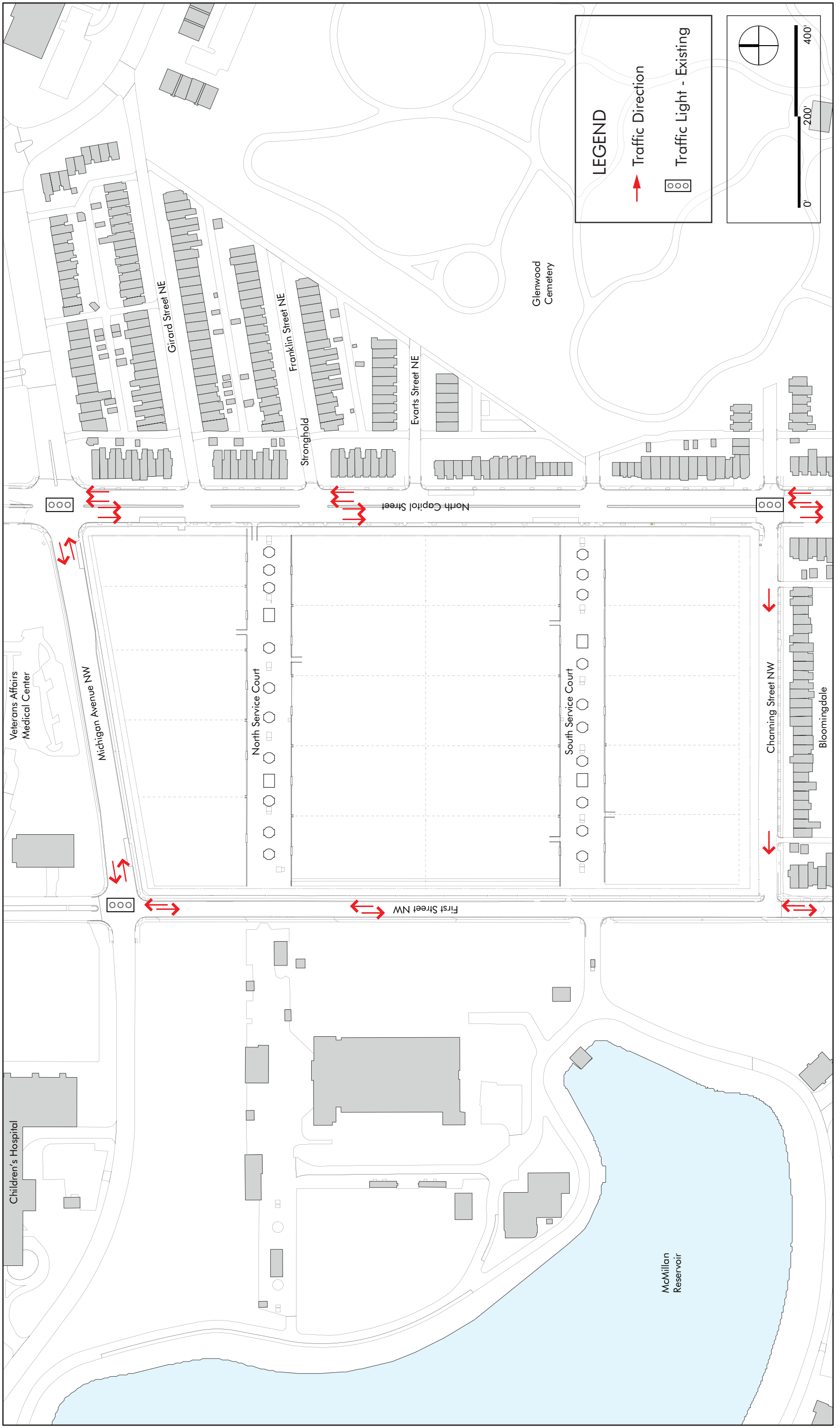



EE&K a Perkins Eastman company

VEHICULAR CIRCULATION - PROPOSED

MASTER PLAN

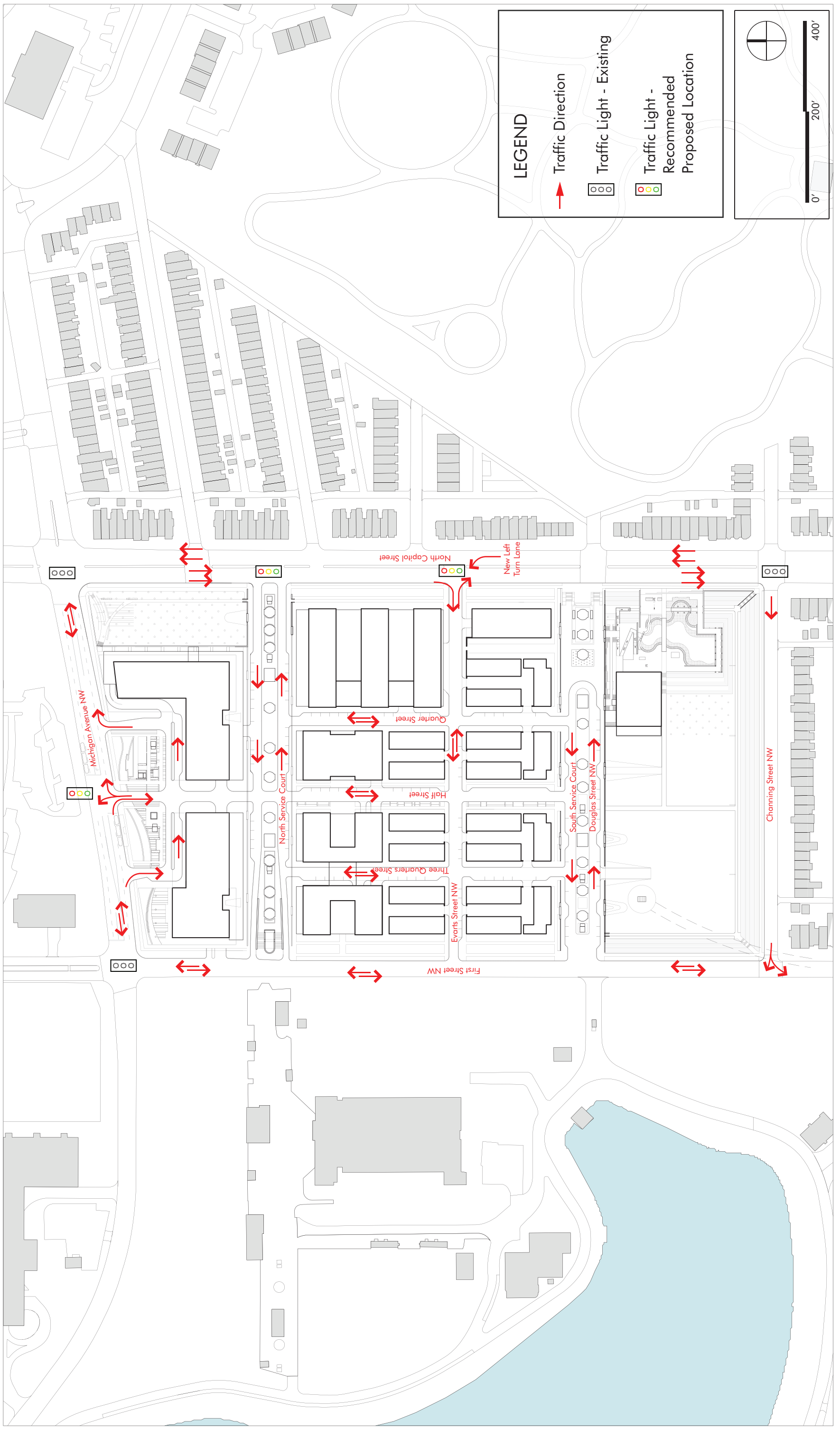

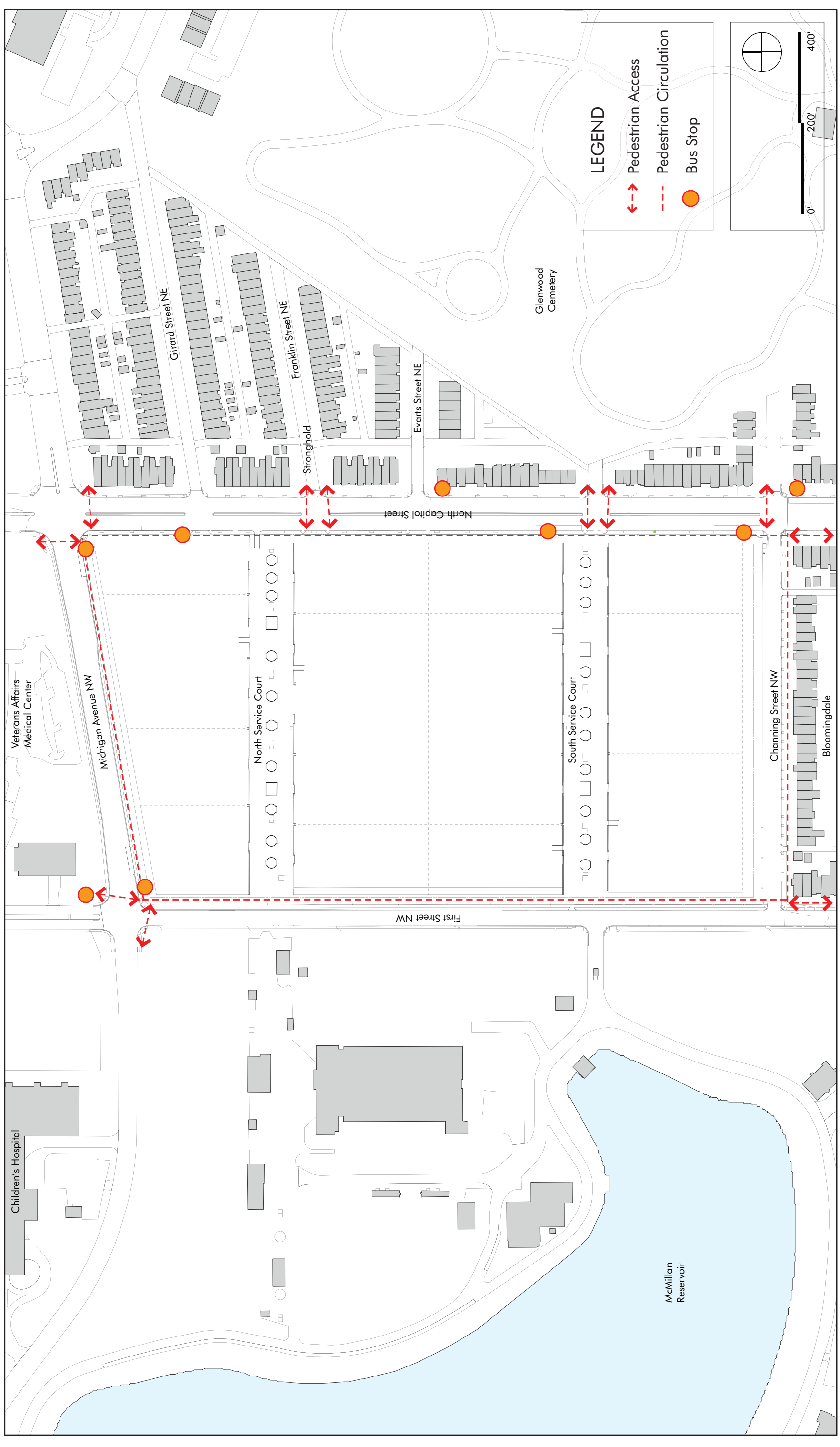



EE&K a Perkins Eastman company

PEDESTRIAN AND BICYCLE CIRCULATION - PROPOSED

MASTER PLAN

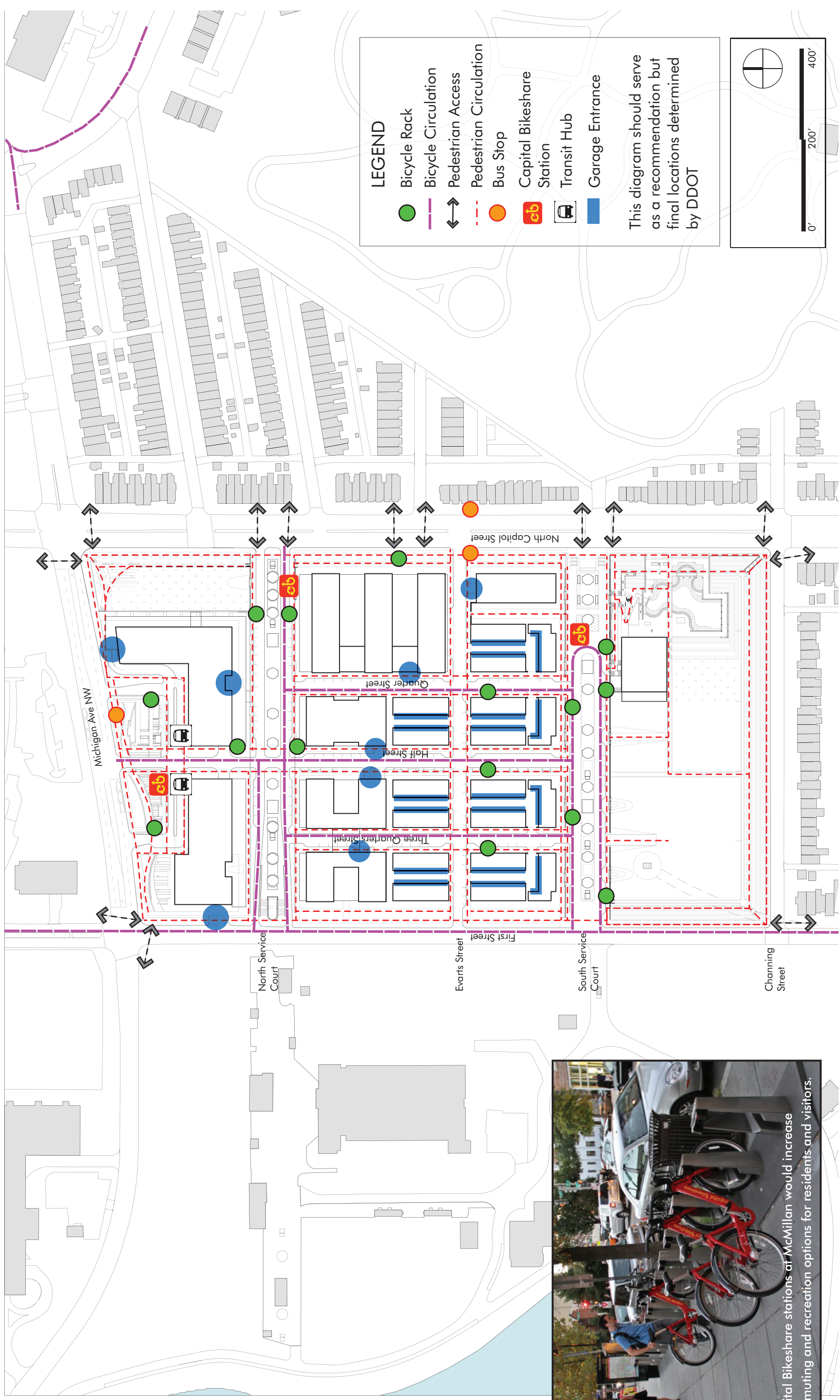

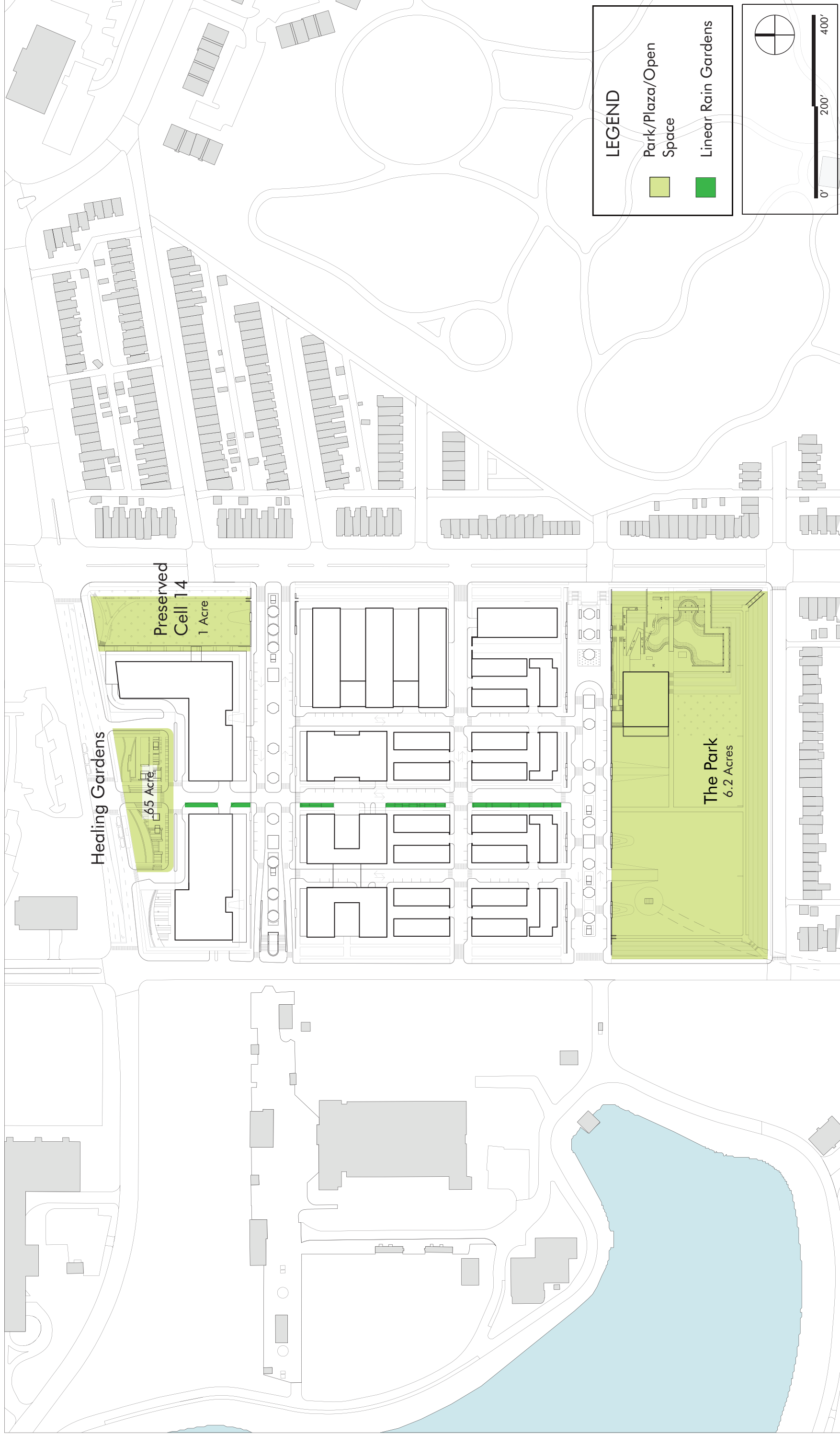



EE&K a Perkins Eastman company

BUILDING HEIGHTS - PROPOSED

MASTER PLAN

