

### Public Streetscape Elements

- Street Trees (35' on-center)
- DDOT Standard Street Lights
  - Twin 20 on N. Capitol Street
  - #16 Washington Globe on all other streets
  - Teardrop / Pendant at intersections
- Benches
- Trash Receptacles
- Bicycle Racks
- Scored Concrete Paving
- Multi-Space Parking Meters

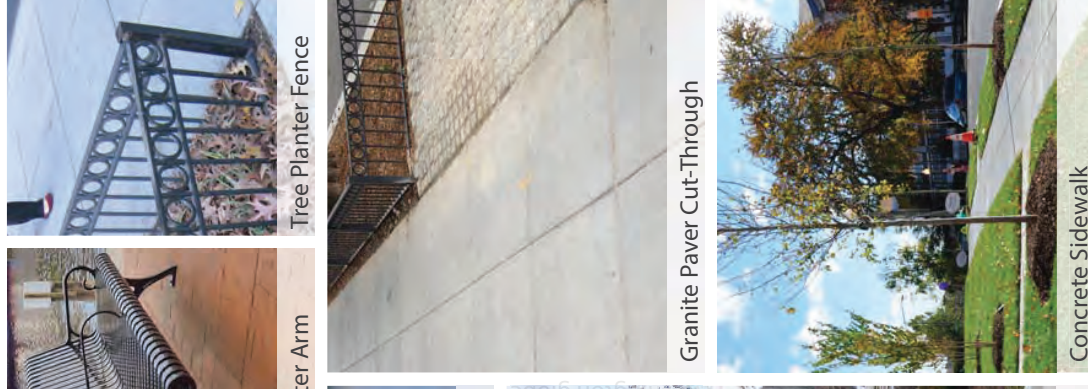

Streetscape images are for illustrative purposes only. Final materials will be developed during the detailed design phase of work.

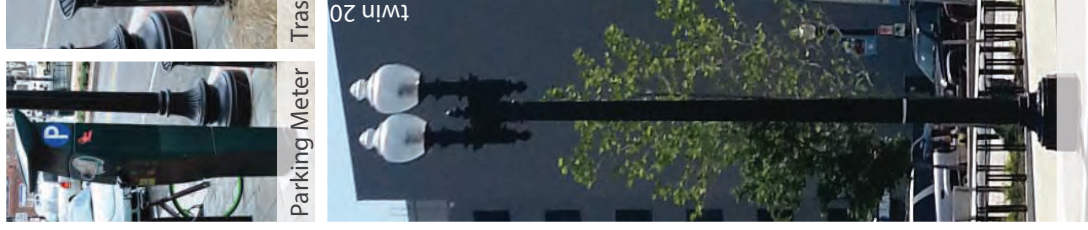
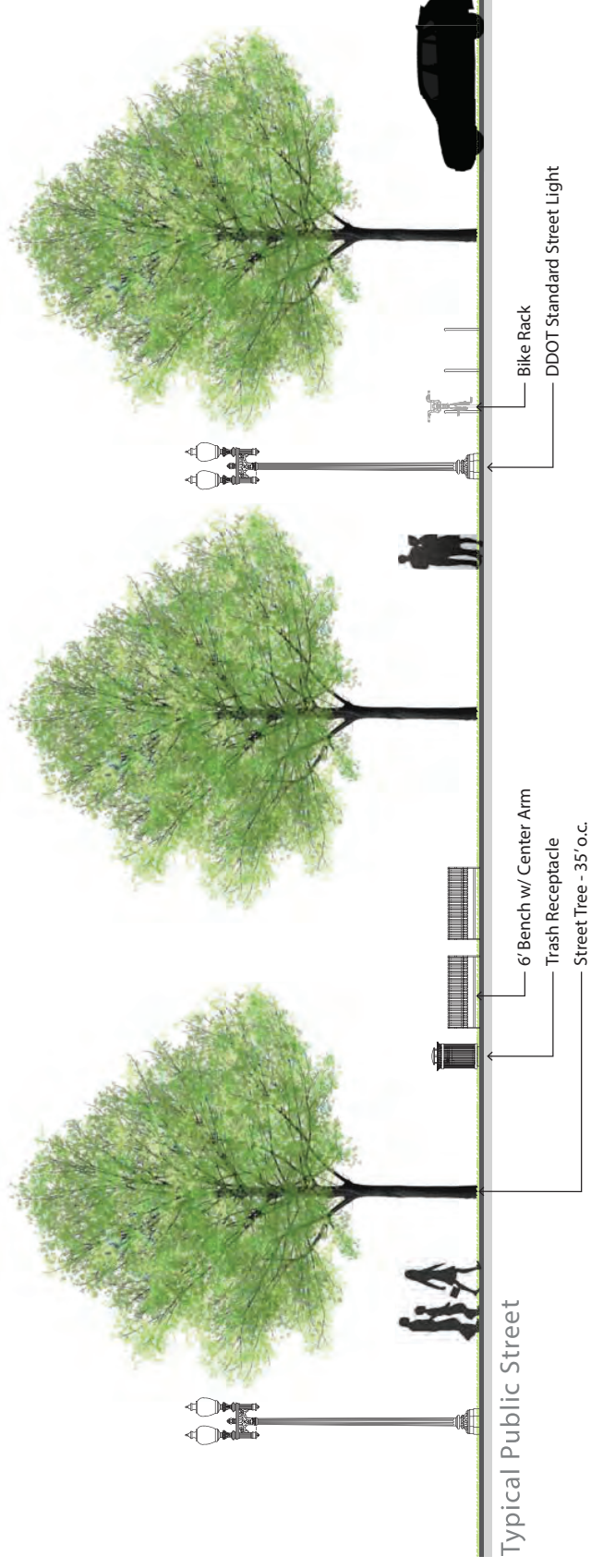



## Plant Pallet

### Perennials/ Grasses

- A. Lobelia cardinalis
- B. Carex flaccasperma
- C. Onoclea sensibilis
- D. Carex stricta
- E. Juncus effusus
- F. Iris versicolor
- G. Chelone obliqua

### Trees

- H. Nissa sylvatica
- I. Betula nigra
- J. Quercus bicolor
- K. Acer rubrum
- L. Amelanchier arborea

Notes:  
 Plant species are intended to illustrate the design intent only. Final selection of all plant material will be developed during the detailed design phases of work.

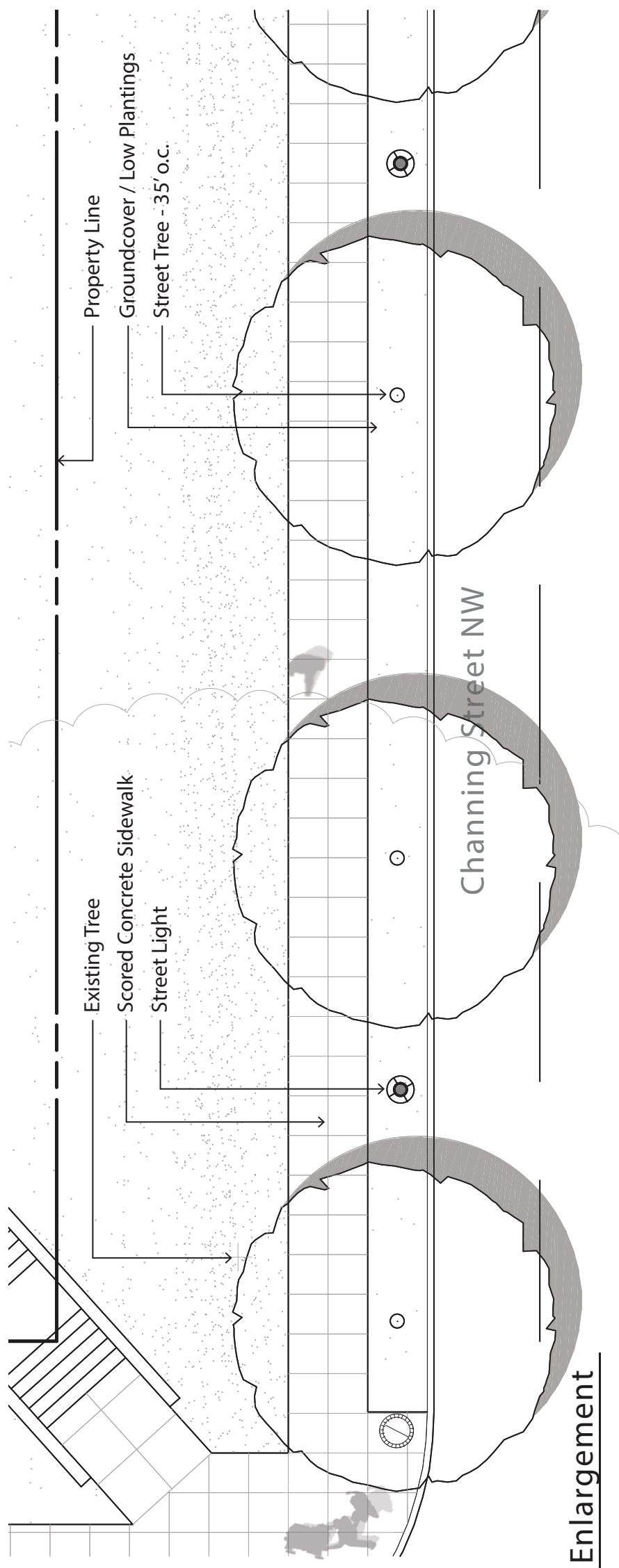

**1** Channing Street Enlargement

Scale: 1"=10'-0"

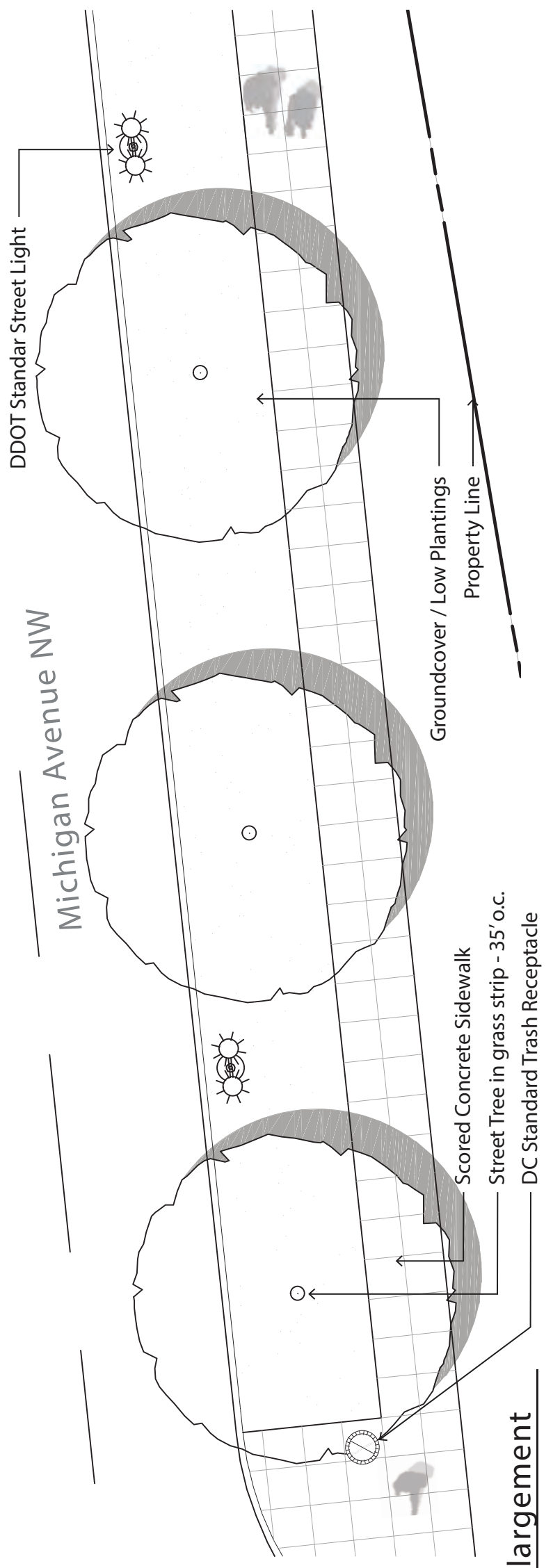

**2** Michigan Ave Enlargement

Scale: 1"=10'-0"

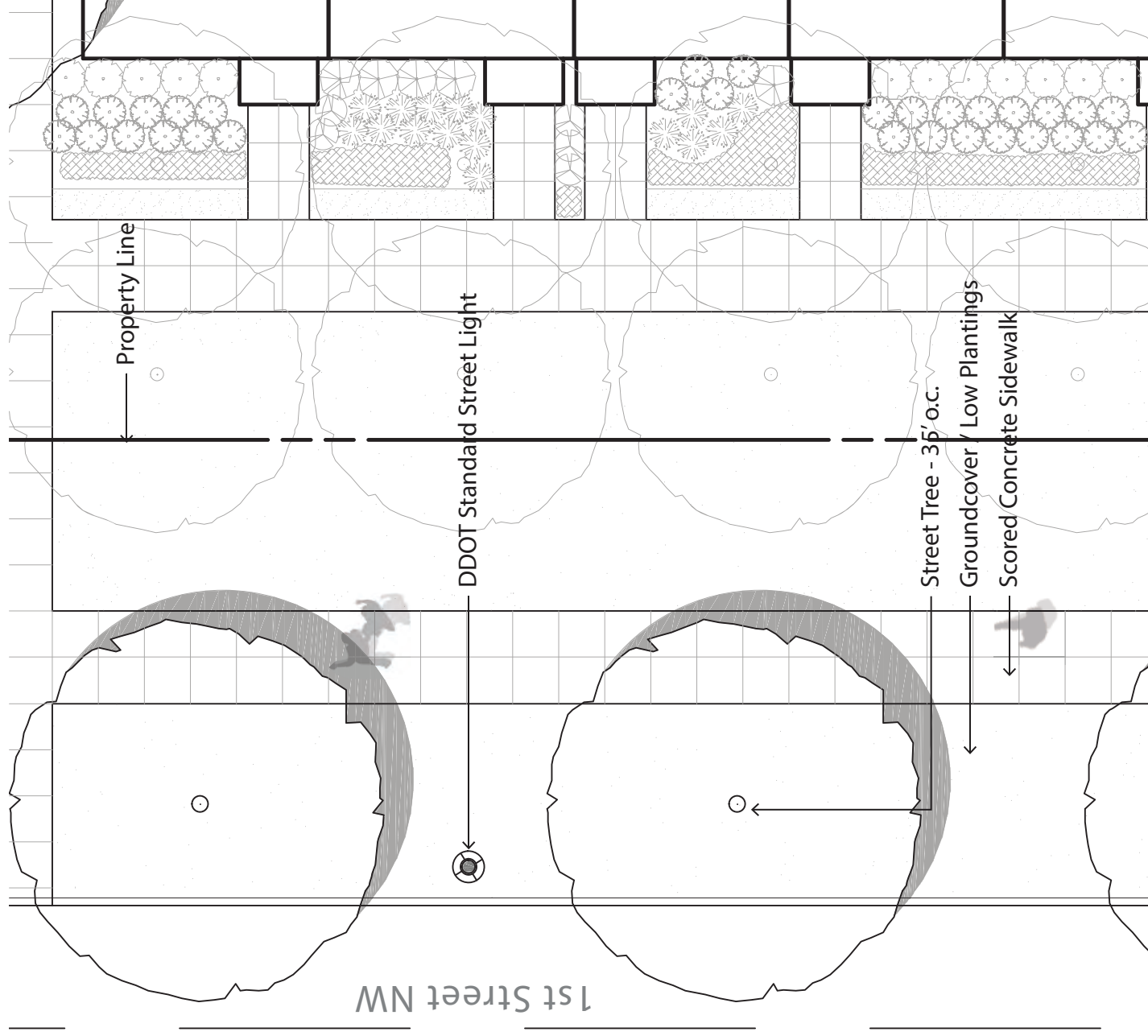

**3** 1st Street Enlargement

Scale: 1"=10'-0"

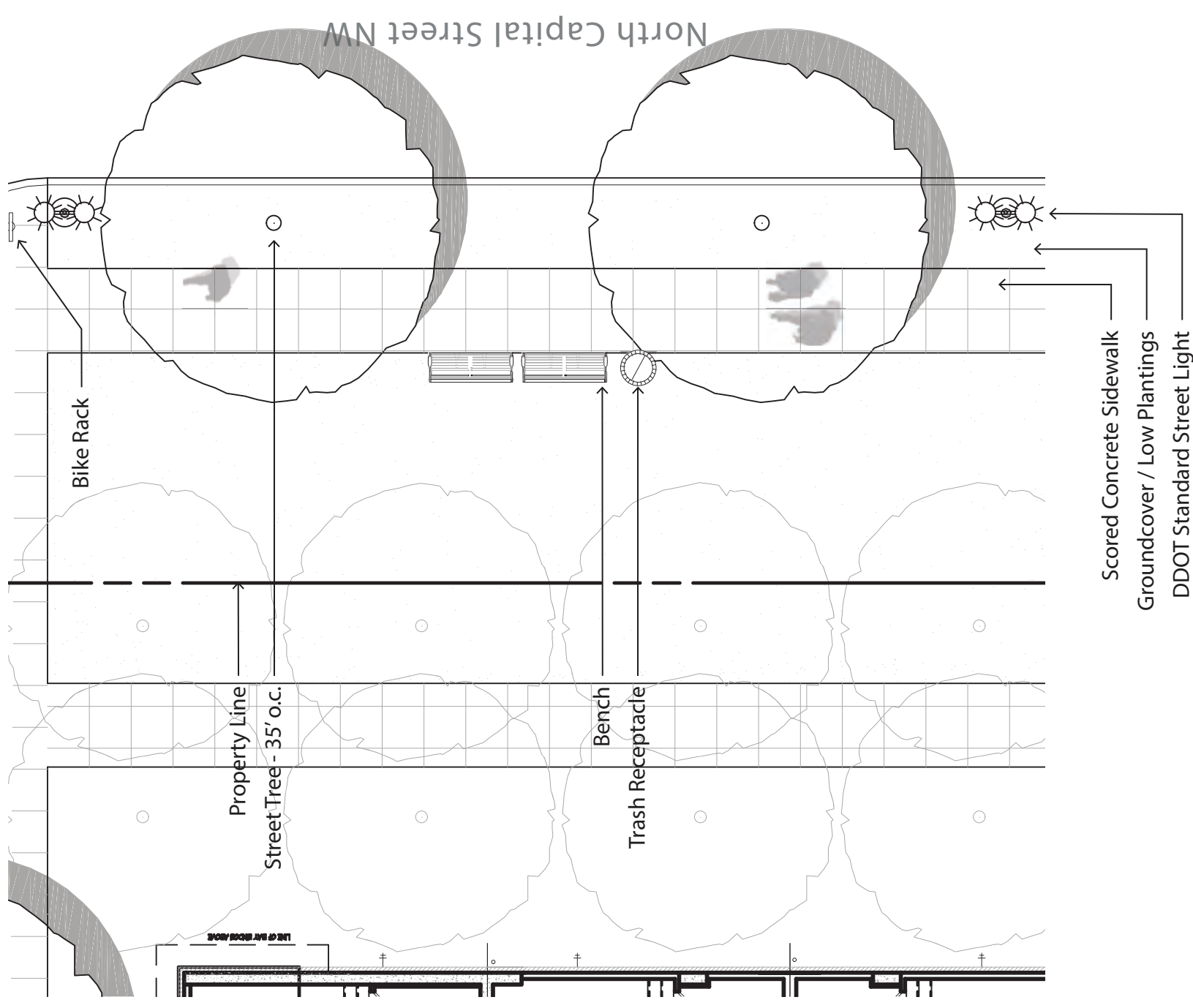

**4** N Capital Street Enlargement

Scale: 1"=10'-0"

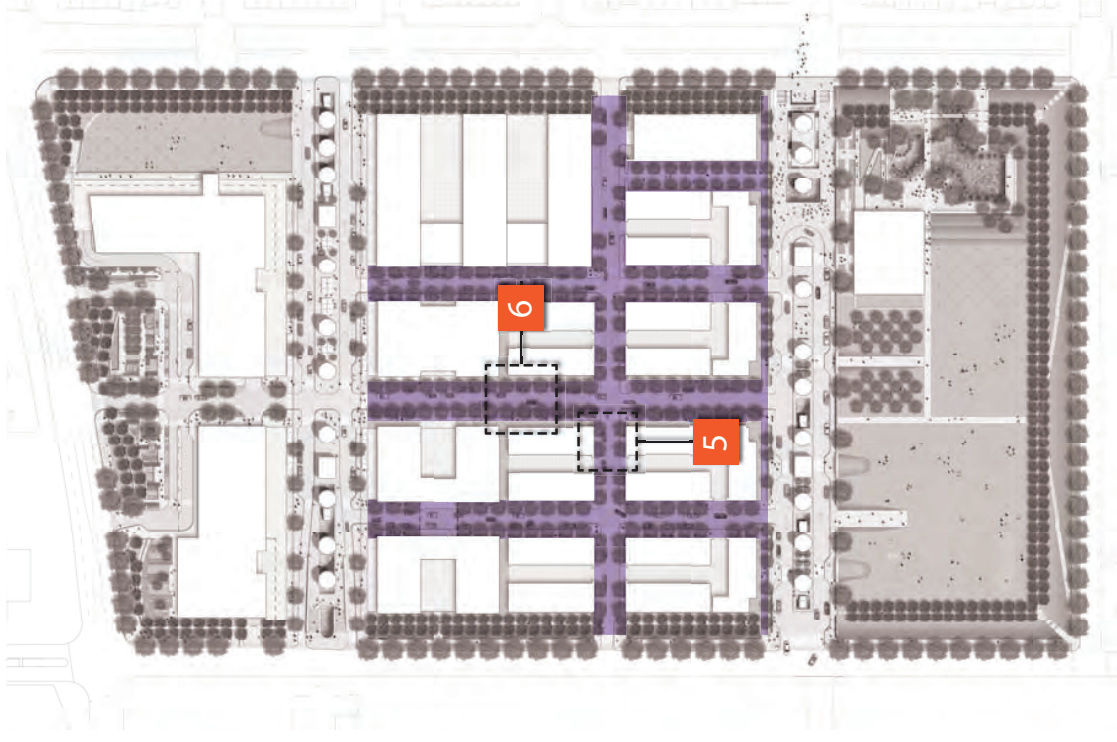

Bio-filtration planting strip

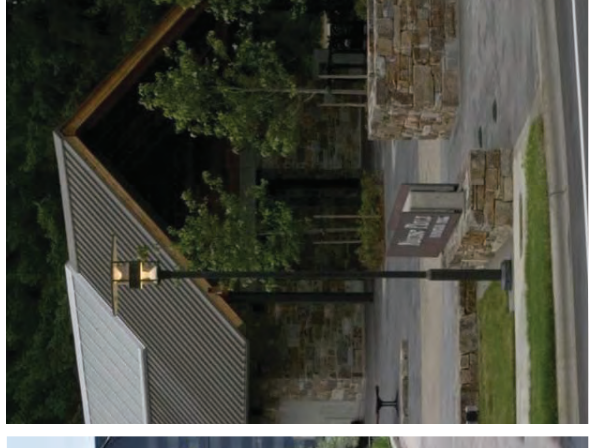

Street lighting

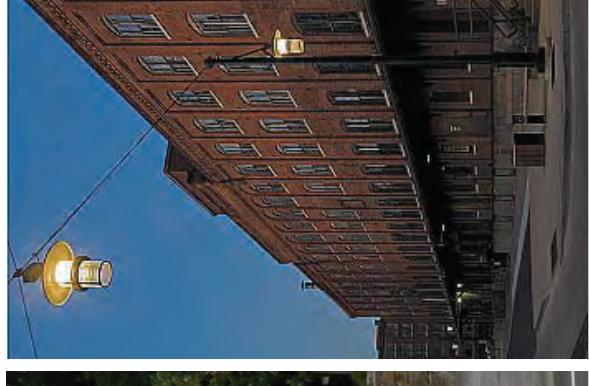

Weir / Seawall



Concrete



Furnishings

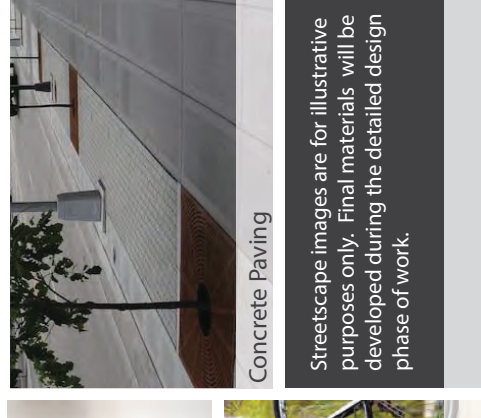

Concrete Paving

Streetscape images are for illustrative purposes only. Final materials will be developed during the detailed design phase of work.

### Private Streetscape Elements

- Raingarden / Bio-filtration planting strip (Half Street)
- Street Trees (20' - 30' on-center)
- Street Lights
- Benches
- Trash Receptacles
- Bicycle Racks
- Scored Concrete Paving

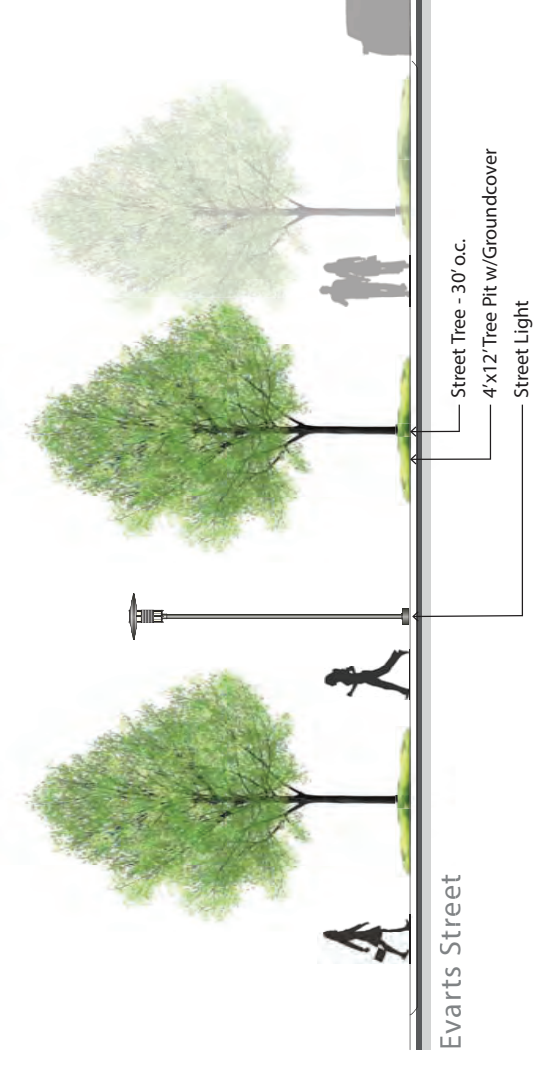
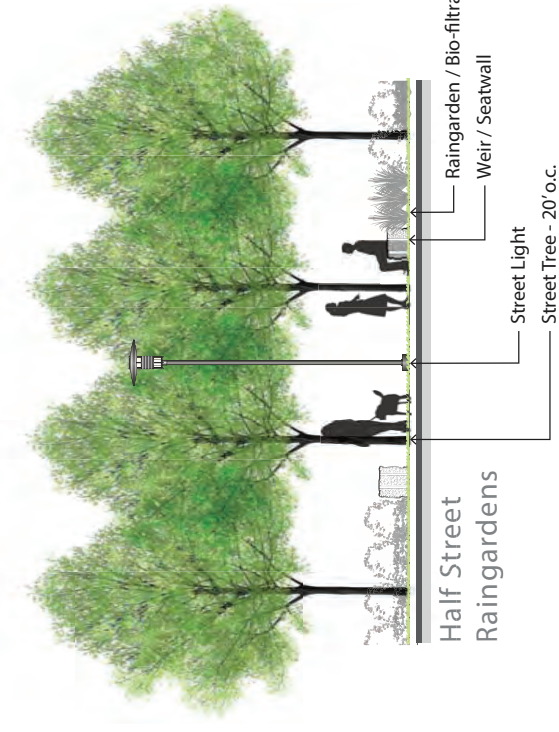



**Plant Pallet**

**Trees**

- A. Quercus phellos
- B. Quercus coccinea
- C. Ulmus americana hybrids
- D. Acer saccharum
- E. Acer rubrum

**Perennials/ Grasses**

- F. Ilex glabra 'Nigra'
- G. Fothergilla gardenii
- H. Panicum virgatum
- I. Muhlenbergia capillaris
- J. Rudbeckia fulgida
- K. Fothergilla gardenii
- L. Calamagrostis x acutiflora
- M. Rhus aromatic 'Grow Low'
- N. Carex pensylvanica
- O. Sedum telephium

**Notes:**

Plant species are intended to illustrate the design intent only. Final selection of all plant material will be developed during the detailed design phases of work.