

SITE DATA

EXISTING SITE AREA:

LOT 802 (SQUARE 1025-E)	= 5,107 SF
LOT 1 (SQUARE 1048-S)	= 40,580 SF
LOT 801 (SQUARE 1048-S)	= 16,183 SF
LOT 802 (SQUARE 1048-S)	= 42,424 SF
RES 129	= 15,269 SF
RES 299	= 7,936 SF
TOTAL	127,499 SF

ZONE:

EXISTING: M (GENERAL INDUSTRY)
 PROPOSED: C-3-C PUD

SQUARE FOOTAGE CALCUATIONS				
	RESIDENTIAL GSF	RESIDENTIAL UNITS	RETAIL GSF	TOTAL GSF ALL USES
BUILDING 1 (BLDG 1A) (BLDG 1B)	267,216 (151,584) (85,305)	351 (218) (133)	7,200 (n/a) (7,200)	274,416 (181,911) (92,505)
BUILDING 2	181,209	234	3,170	184,379
BUILDING 3	69,066	88	--	69,066
TOTAL	517,491	673	10,370	527,861

PROPOSED THEORETICAL SITE AREA: (NOTE: SEE PAGE 13 FOR MORE INFORMATION)

THEORETICAL LOT 1	= 80,128 SF
THEORETICAL LOT 2	= 38,297 SF
THEORETICAL LOT 3	= 9,074 SF
TOTAL	127,499 SF

EXISTING ZONING: M
 PROPOSED ZONING: C-3-C PUD

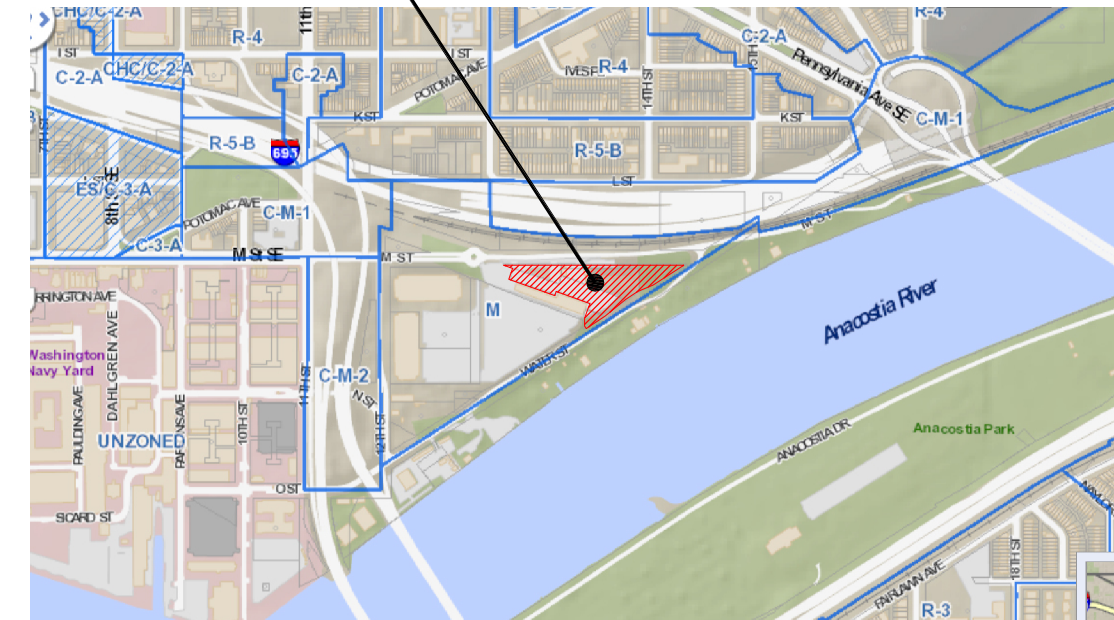

1 ZONING PLAN
 SCALE: NTS

PROJECT DESCRIPTION

673 UNITS; 3 RESIDENTIAL BUILDINGS WITH
 GROUND LEVEL RETAIL

ZONING TABULATIONS

	FAR:* (calculated over total lot)		LOT OCCUPANCY: (calculated over total lot)		BUILDING HEIGHT:		PENTHOUSE HEIGHT:		PARKING:		LOADING:	
	REQUIRED /ALLOWED	PUD PROPOSED	REQUIRED /ALLOWED	PUD PROPOSED	REQUIRED /ALLOWED	PUD PROPOSED	REQUIRED /ALLOWED	PUD PROPOSED	REQUIRED /ALLOWED	PUD PROPOSED	REQUIRED /ALLOWED	PUD PROPOSED
BUILDING 1	8.0	2.15	100%	24.7%	100'-0"	Tower A: 100'-0" and 10 stories from m.p. 35.0 on Virginia Ave Tower B: 90'-0" and 9 stories from m.p. 35.0 on Virginia Ave	18'-6"	18'-6"	Residential: 351 units/4 = 88 Retail: 6 Spaces	Residential: 106 Spaces Retail: 6 Spaces	Residential: 1 Loading Berth @ 55' deep 1 Loading Platform @ 100 sf 1 Service Space @ 20' deep Retail: none	Residential: 1 Loading Berth @ 30' deep 1 Loading Platform @ 200 sf 1 Service Space @ 20' deep Retail: none
BUILDING 2	8.0	1.45	100%	14.3%	130'-0"	110'-0" and 11 stories from m.p. 35.0 on Virginia Ave	18'-6"	18'-6"	Residential: 234 units/4 = 59 Retail: 1 Spaces	Residential: 108 Spaces Retail: 1 Spaces	Residential: 1 Loading Berth @ 55' deep 1 Loading Platform @ 100 sf 1 Service Space @ 20' deep Retail: none	Residential: 1 Loading Berth @ 30' deep 1 Loading Platform @ 200 sf 1 Service Space @ 20' deep Retail: none
BUILDING 3	8.0	.54	100%	6.0%	92'-0"	91'-0" and 9 stories from m.p. 32.0 on M St	18'-6"	18'-6"	Residential: 88 units/4 = 22	Residential: NONE	Residential: 1 Loading Berth @ 55' deep 1 Loading Platform @ 100 sf 1 Service Space @ 20' deep	Residential: none
TOTAL SITE	8.0	4.14	100%	45.0%					176	221		

* FOR PURPOSES OF COUNTING F.A.R.: GROSS FLOOR AREA DOES NOT INCLUDE: 1) PARKING AND ACCESS RAMPS, 2) BAYS PROJECTING OVER AREA LINES, AND 2) SPACES WITH STRUCTURAL HEADROOM CLEARANCE LESS THAN 4'-0" ABOVE GRADE LEVEL



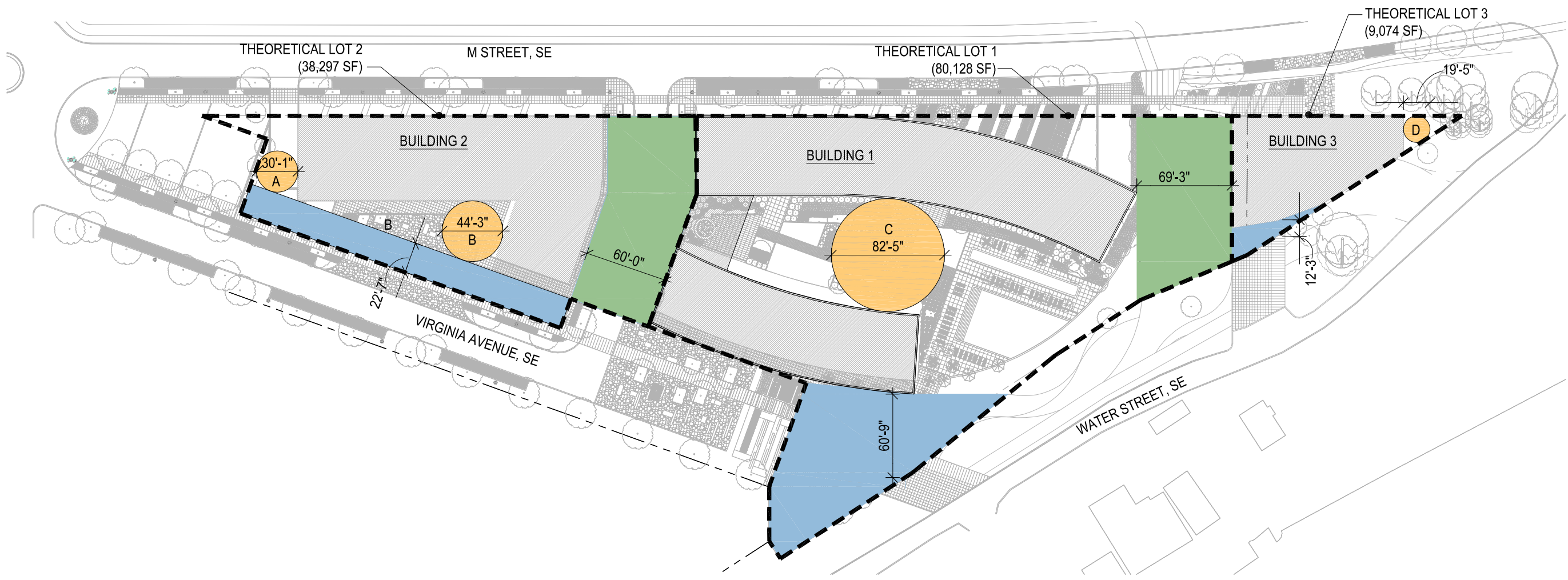

1 ZONING DIAGRAM
SCALE: 1:80

	REAR YARD		SIDE YARD		OPEN COURT		AREA
	REQUIRED /ALLOWED	PUD PROPOSED	REQUIRED /ALLOWED	PUD PROPOSED	REQUIRED /ALLOWED	PUD PROPOSED	
BUILDING 1	NONE; IF PROVIDED: 2-1/2" per 100'-0" = 20'-10"	60'-9"	NONE; IF PROVIDED: 2" per 100'-0" = 16'-8"	69'-3"	COURT C: (RES. USE)	15'-0" MIN., 99'-10" HT X 4" = 33'-3" MIN.	82'-5"
BUILDING 2	NONE; IF PROVIDED: 2-1/2" per 110'-0" = 22'-1"	22'-7"	NONE; IF PROVIDED: 2" per 110'-0" = 18'-4"	60'-0"	COURT A: (RES. USE)	15'-0" MIN., 110'-0" HT X 4" = 36'-8" MIN.	30'-1"
BUILDING 3	NONE; IF PROVIDED: 2-1/2" per 111'-0" = 23'-0"	12'-3"	NONE	N/A	COURT D: (RES. USE)	12'-0" MIN., 91'-0" HT X 4" = 23'-0" MIN.	19'-5"

NOTE: THEORETICAL LOTS HAVE BEEN ESTABLISHED FOR THE PURPOSE OF DETERMINING CONFORMANCE TO REAR AND SIDE YARD REQUIREMENTS

LEGEND

- OPEN COURT
- SIDE YARD
- REAR YARD
- THEORETICAL LOT LINE

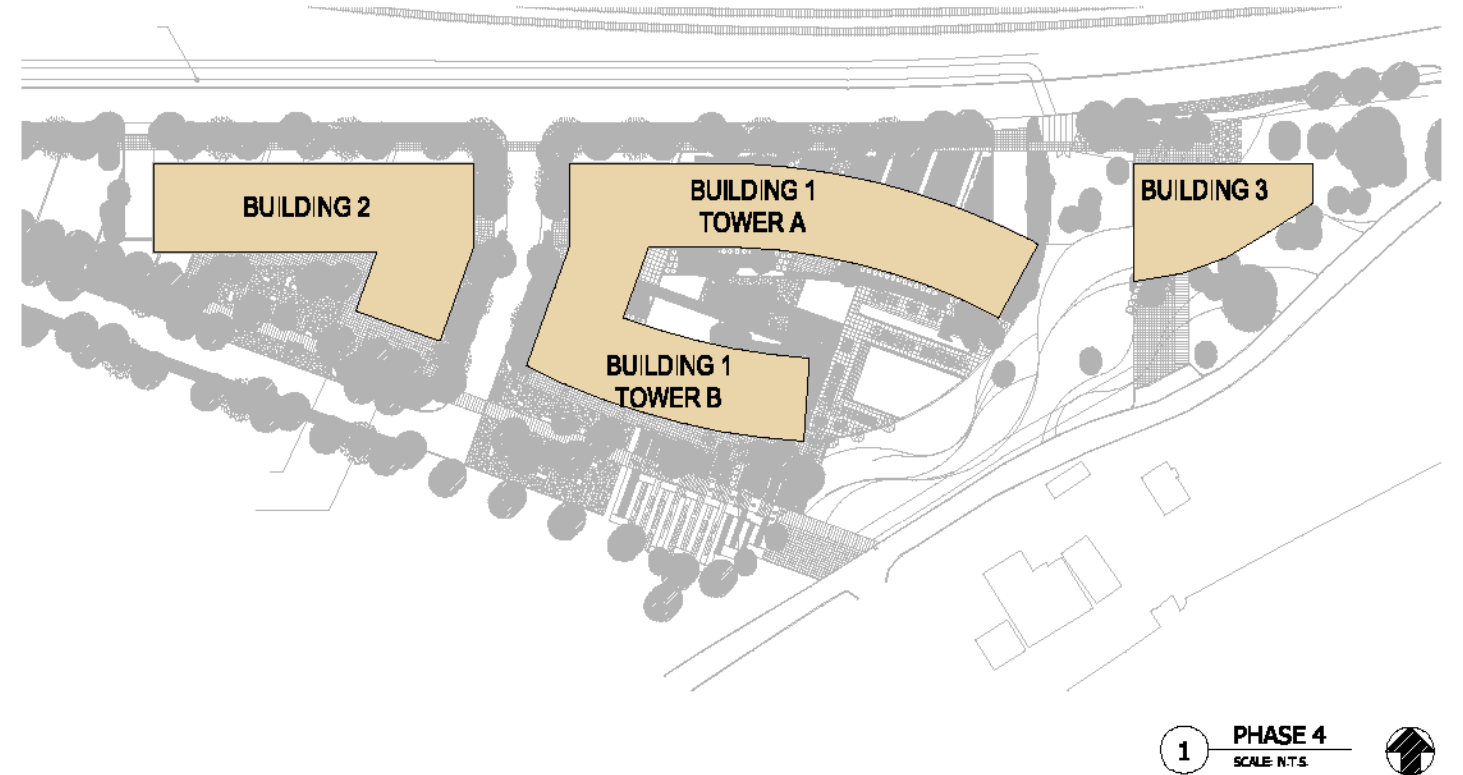
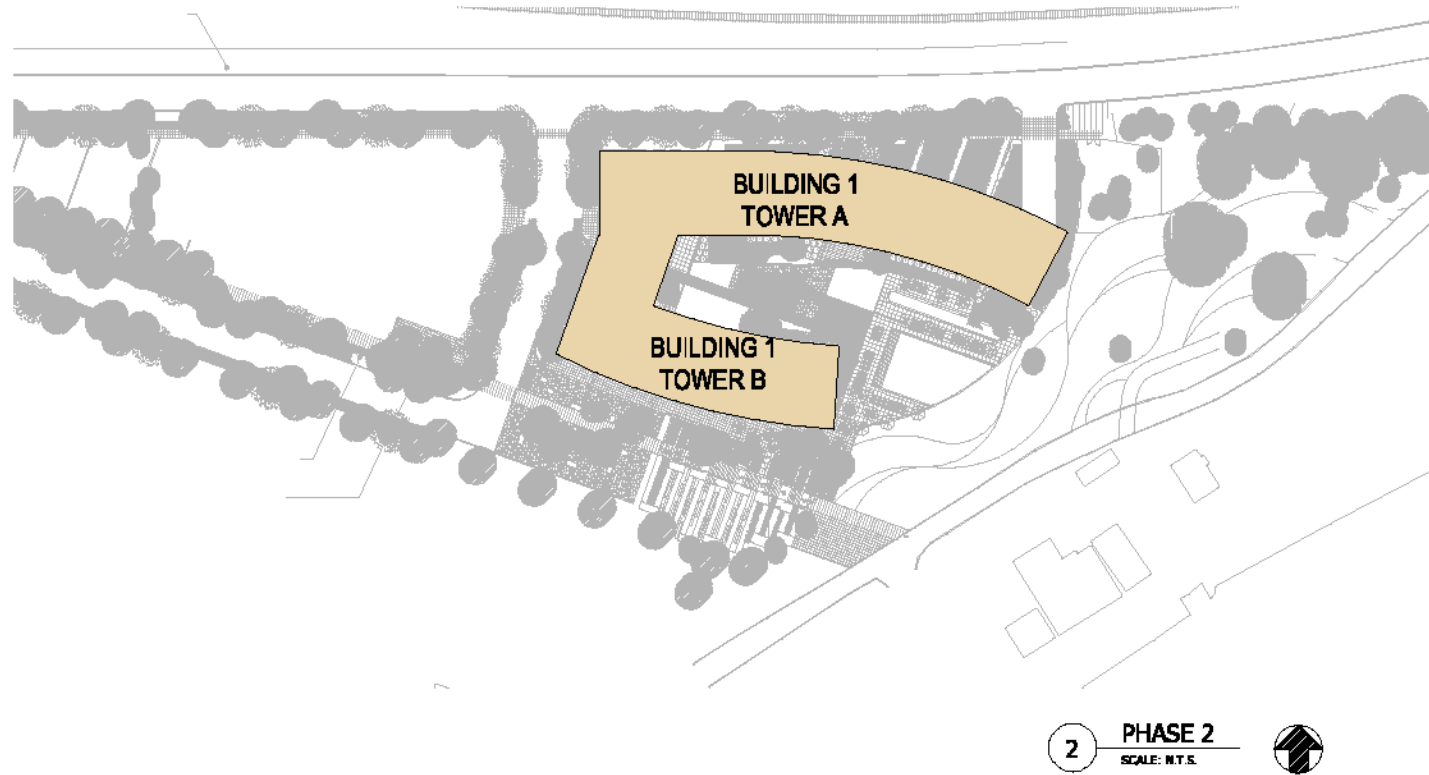
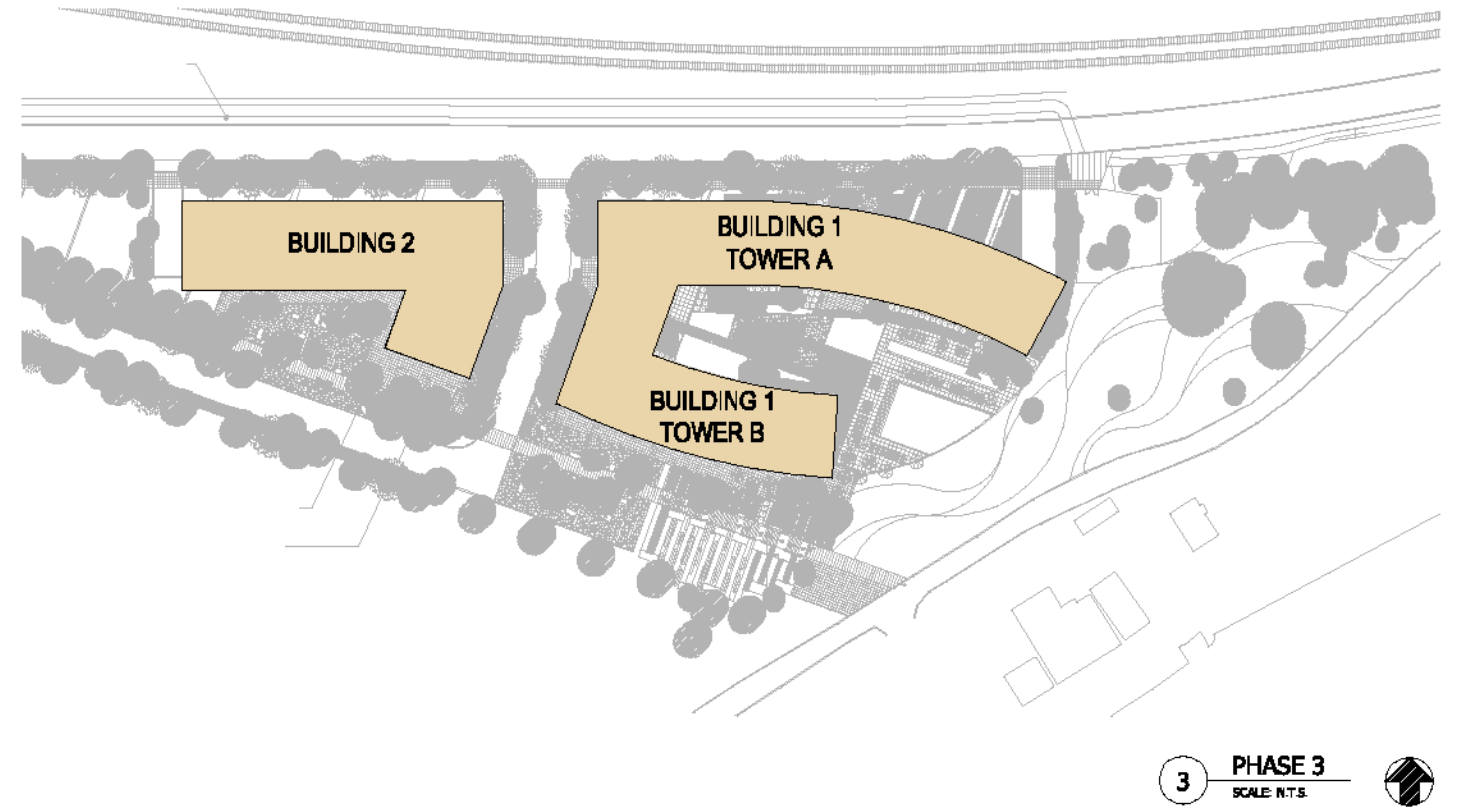
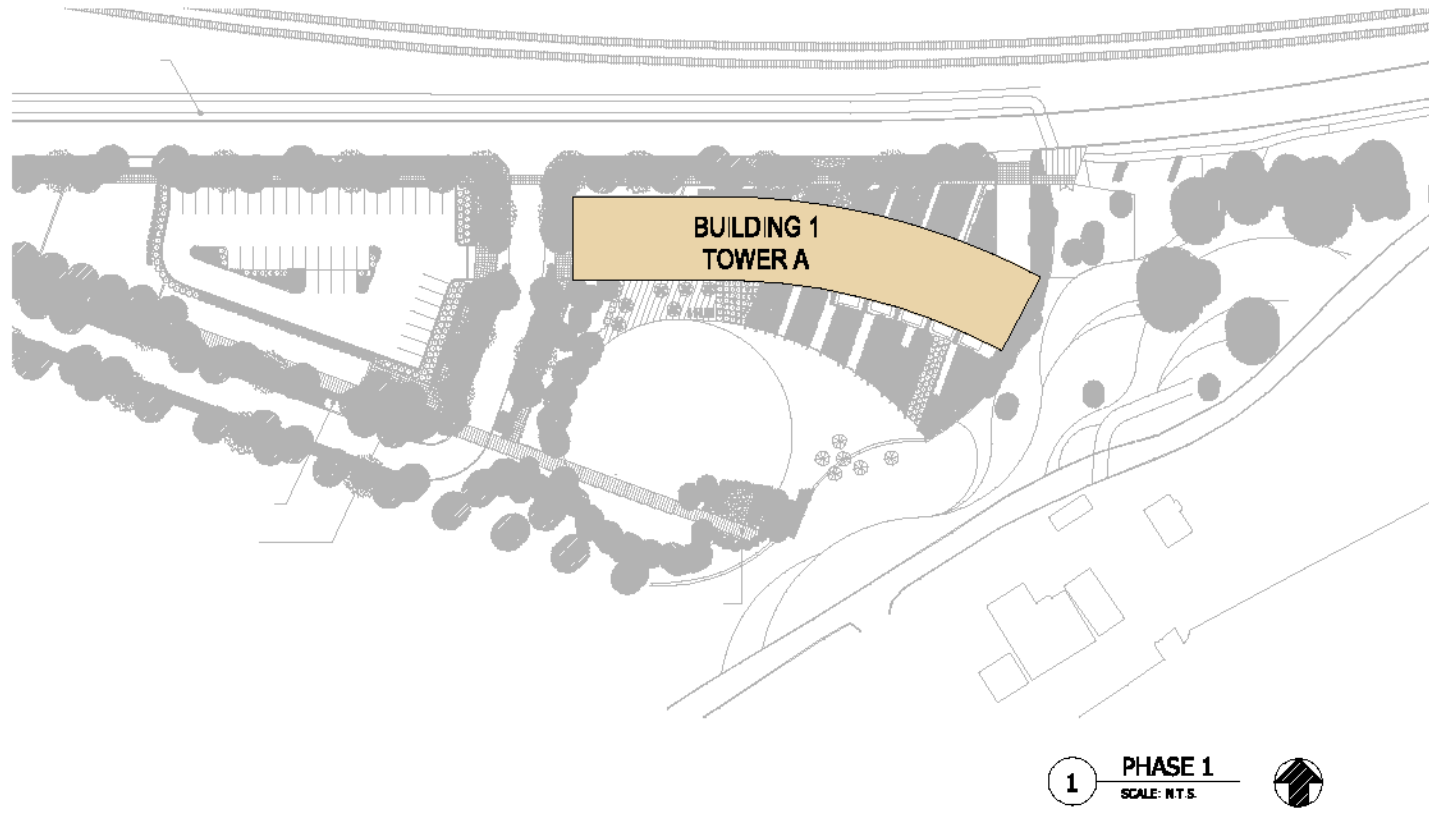

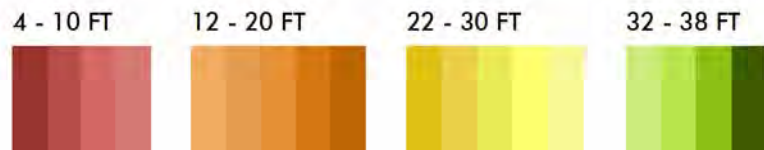
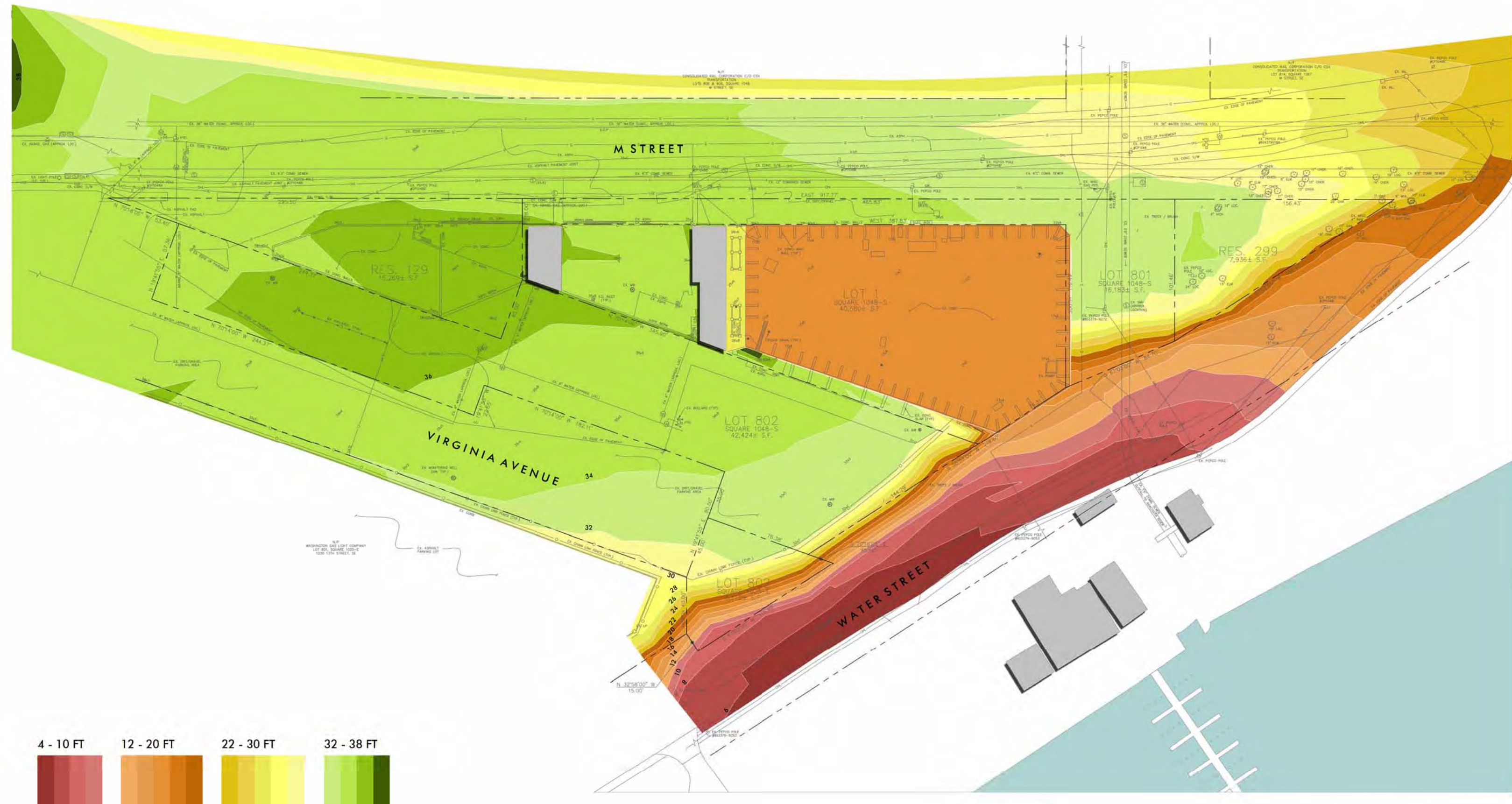

1333 M STREET
DATE: 07-25-14

2 FT INTERVAL ELEVATION STUDY /
EXISTING CONDITIONS

15

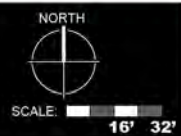

PARKERRODRIGUEZ, INC.
Planning | Urban Design | Landscape Architecture





TWO LANE BIKE TRAIL



M STREET WEST ENTRANCE



ANACOSTIA BIKE TRAIL



ANACOSTIA BIKE TRAIL



SITE PIT



WATERFRONT HILLSIDE

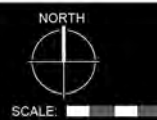

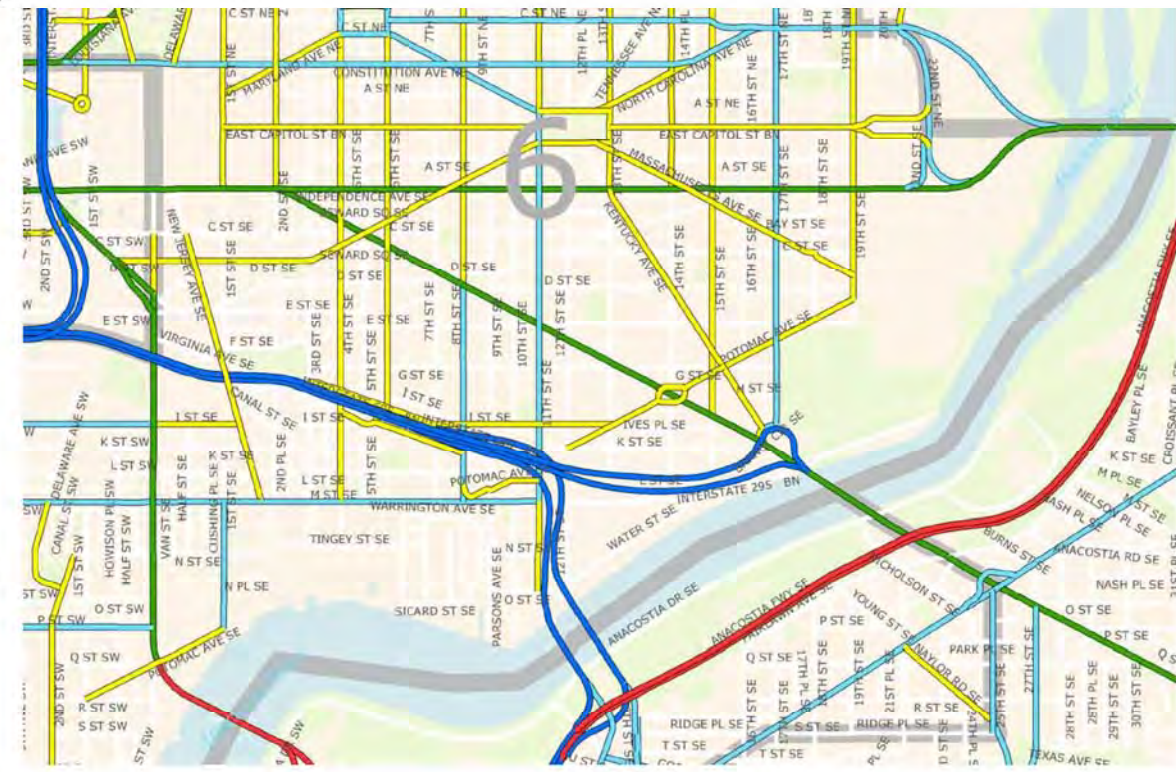
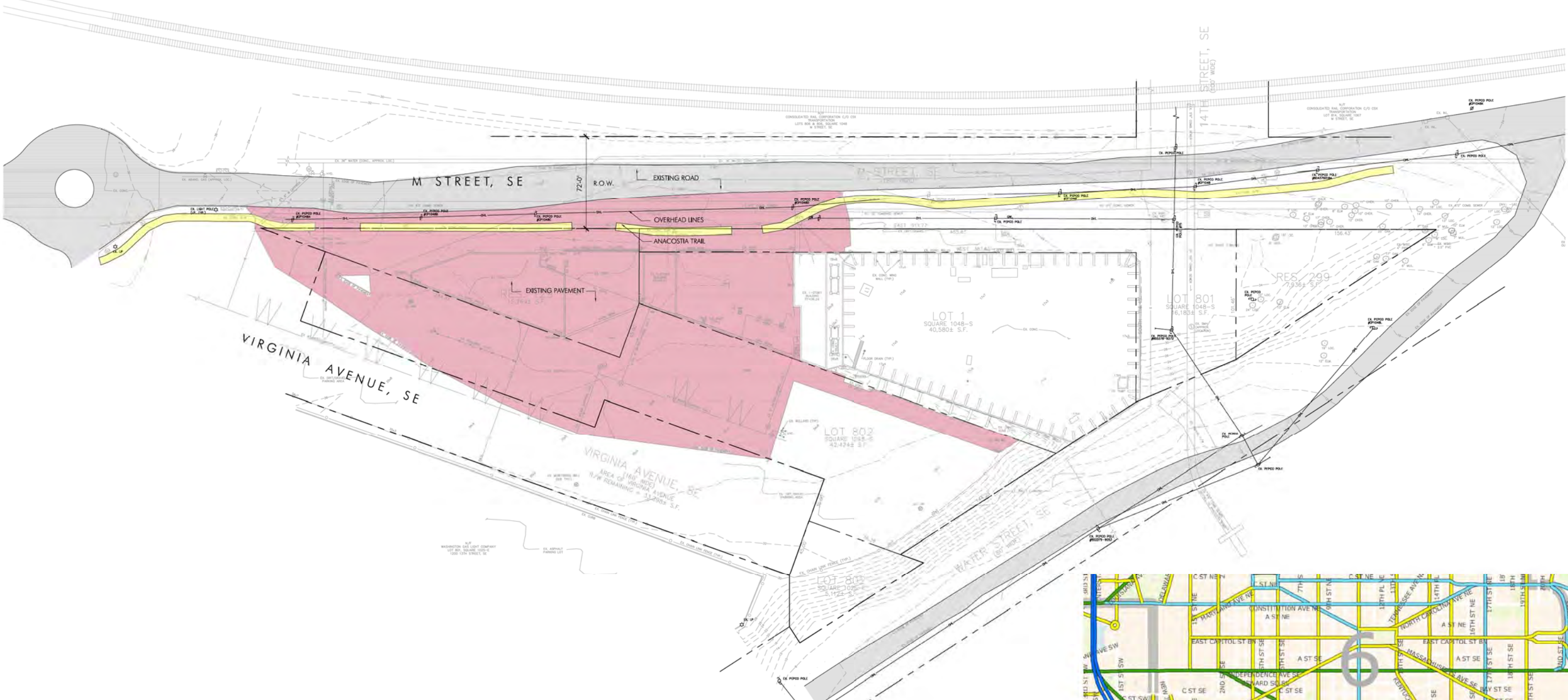

Legend

- Interstate
- Other Freeway and Expressway
- Principal Arterial
- Minor Arterial
- Collector
- Local

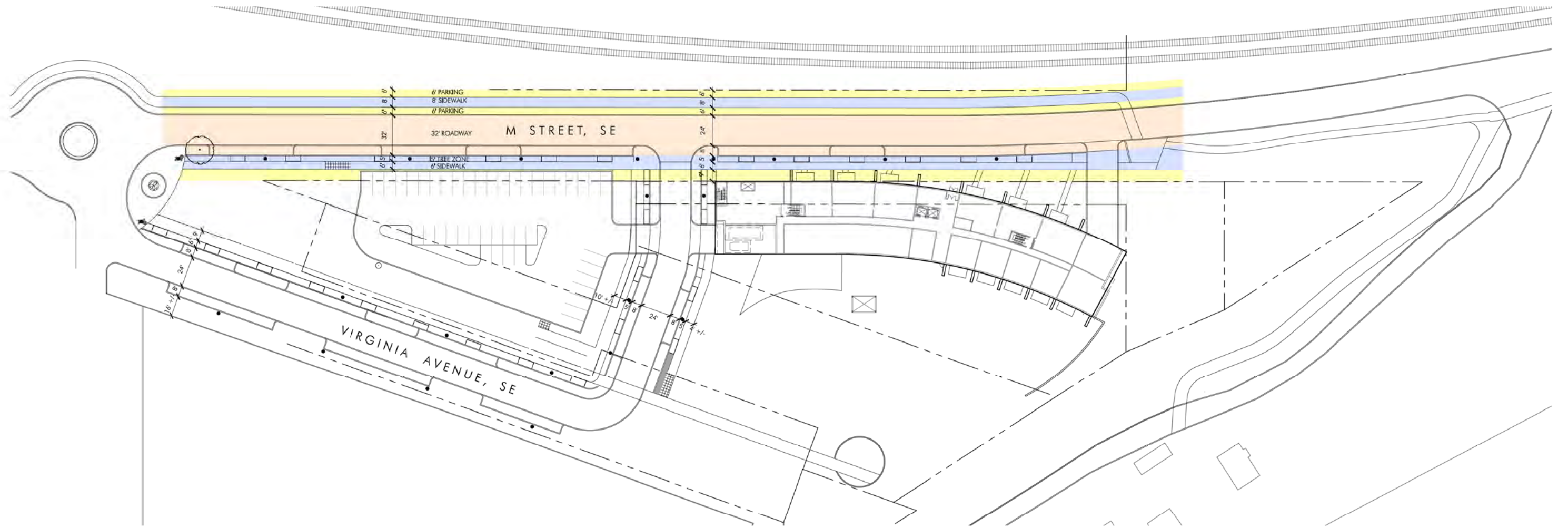



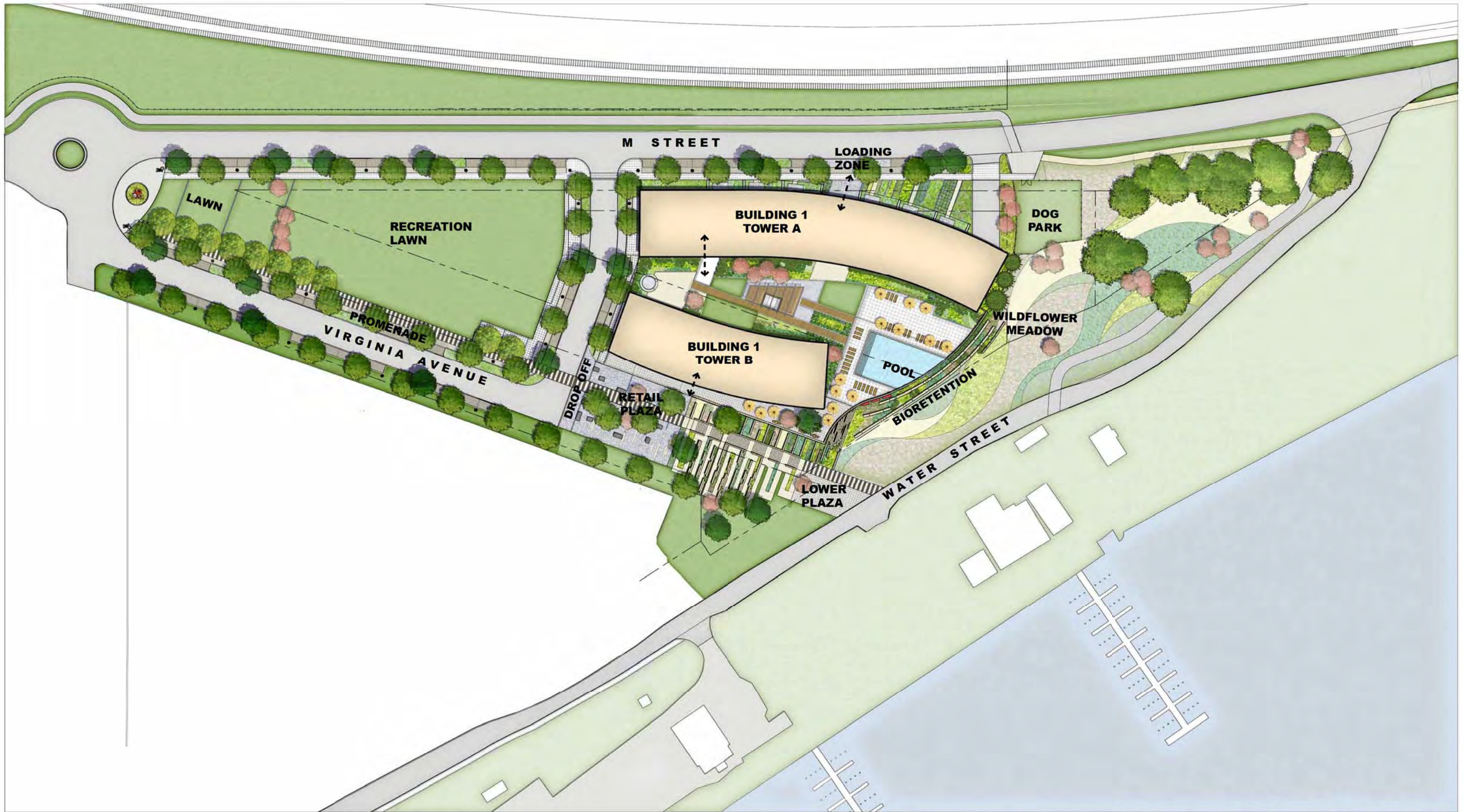



PHASE 4



PHASE 1





