

**NOTE:**  
 The interior layouts shown on the building plans are schematic.  
 Changes to the layouts, not affecting the exterior envelope or the square footage distribution, may occur.

**LEGEND:**

- PEDESTRIAN SERVICE AREA
- PEDESTRIAN SERVICE CORR.
- SERVICE ELEVATOR (S)
- VEHICULAR LOADING AREA
- SERVICE VEHICULAR MAIN ACCESS

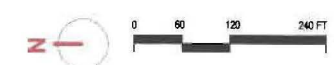
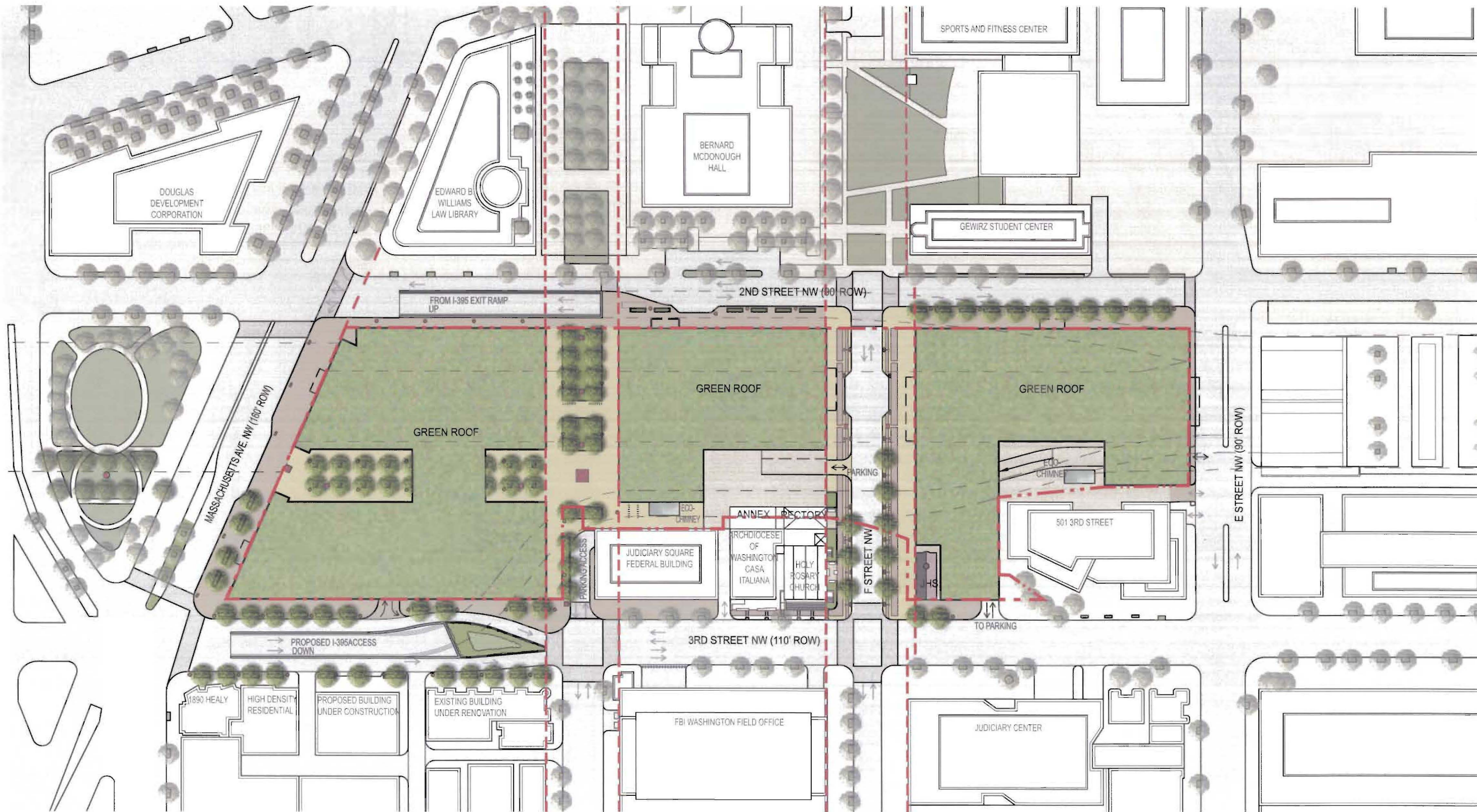

**LEGEND:**  
 - - - - - PROPERTY LINE  
 - . . . . . RIGHT OF WAY

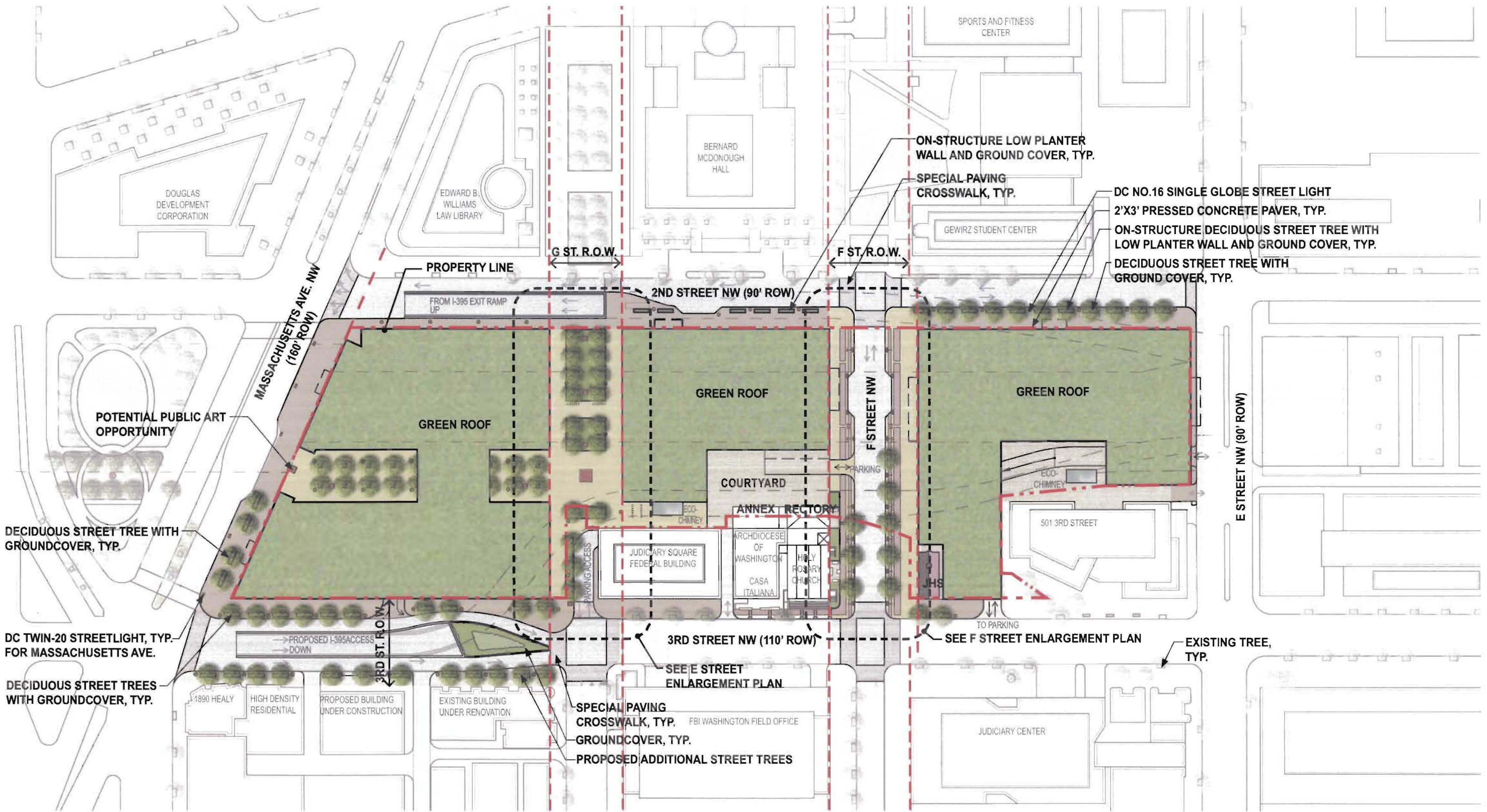

DOUGLAS DEVELOPMENT CORPORATION

EDWARD B. WILLIAMS LAW LIBRARY

BERNARD MCDONOUGH HALL

SPORTS AND FITNESS CENTER

GEWIRZ STUDENT CENTER

PROPERTY LINE

G ST. R.O.W.

F ST. R.O.W.

ON-STRUCTURE LOW PLANTER WALL AND GROUND COVER, TYP.

SPECIAL PAVING CROSSWALK, TYP.

DC NO.16 SINGLE GLOBE STREET LIGHT

2'X3' PRESSED CONCRETE PAVER, TYP.

ON-STRUCTURE DECIDUOUS STREET TREE WITH LOW PLANTER WALL AND GROUND COVER, TYP.

DECIDUOUS STREET TREE WITH GROUND COVER, TYP.

MASSACHUSETTS AVE. NW (160' ROW)

POTENTIAL PUBLIC ART OPPORTUNITY

GREEN ROOF

GREEN ROOF

GREEN ROOF

2ND STREET NW (90' ROW)

FROM I-395 EXIT RAMP UP

COURTYARD

ANNEX RECTORY

ARCHDIOCESE OF WASHINGTON

CASA ITALIANA

HOLY ROSARY CHURCH

JUDICIARY SQUARE FEDERAL BUILDING

ECO-CHIMNEY

501 3RD STREET

E STREET NW (90' ROW)

EXISTING TREE, TYP.

TO PARKING

SEE F STREET ENLARGEMENT PLAN

3RD STREET NW (110' ROW)

SEE E STREET ENLARGEMENT PLAN

1890 HEALY

HIGH DENSITY RESIDENTIAL

PROPOSED BUILDING UNDER CONSTRUCTION

EXISTING BUILDING UNDER RENOVATION

SPECIAL PAVING CROSSWALK, TYP.

FBI WASHINGTON FIELD OFFICE

JUDICIARY CENTER

PROPOSED ADDITIONAL STREET TREES

GROUND COVER, TYP.

DC TWIN-20 STREETLIGHT, TYP. FOR MASSACHUSETTS AVE.

DECIDUOUS STREET TREES WITH GROUND COVER, TYP.

PROPOSED I-395 ACCESS DOWN

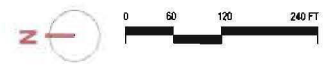

**LEGEND:**

--- PROPERTY LINE

--- RIGHT OF WAY

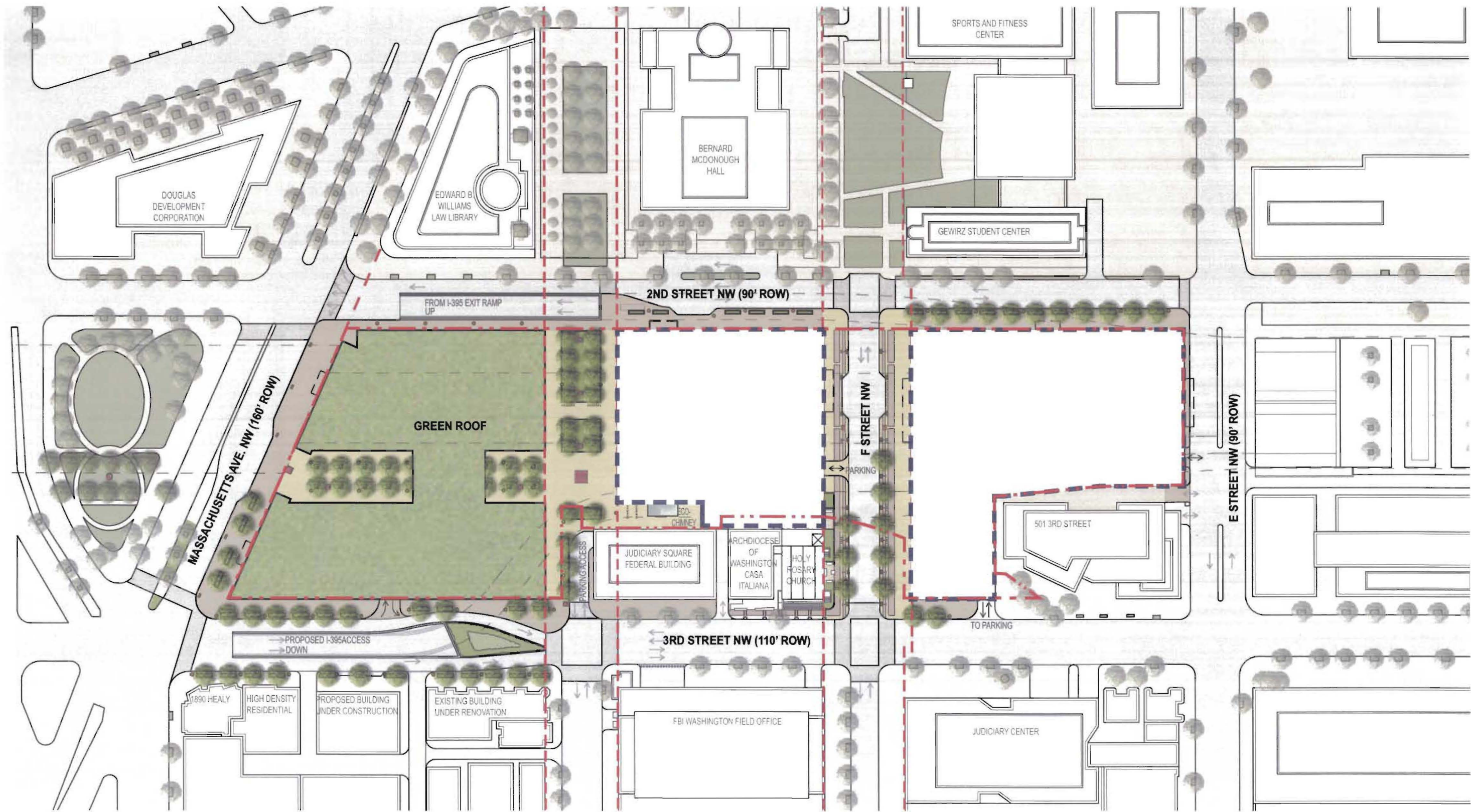

**LEGEND:**  
 - - - - - PROPERTY LINE  
 - - - - - RIGHT OF WAY





PAVING - PRESSED CONCRETE PAVER



LOW PLANTER WALL



BIKE RENTAL STATION



G STREET PLAZA - HONEY LOCUST OR SIMILAR



BICYCLE RACK



GROUNDCOVER

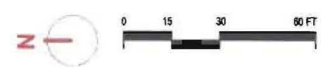
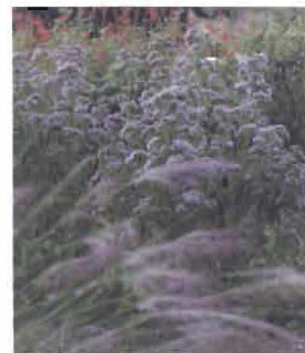

**LEGEND:** - - - - - PROPERTY LINE  
 - - - - - RIGHT OF WAY

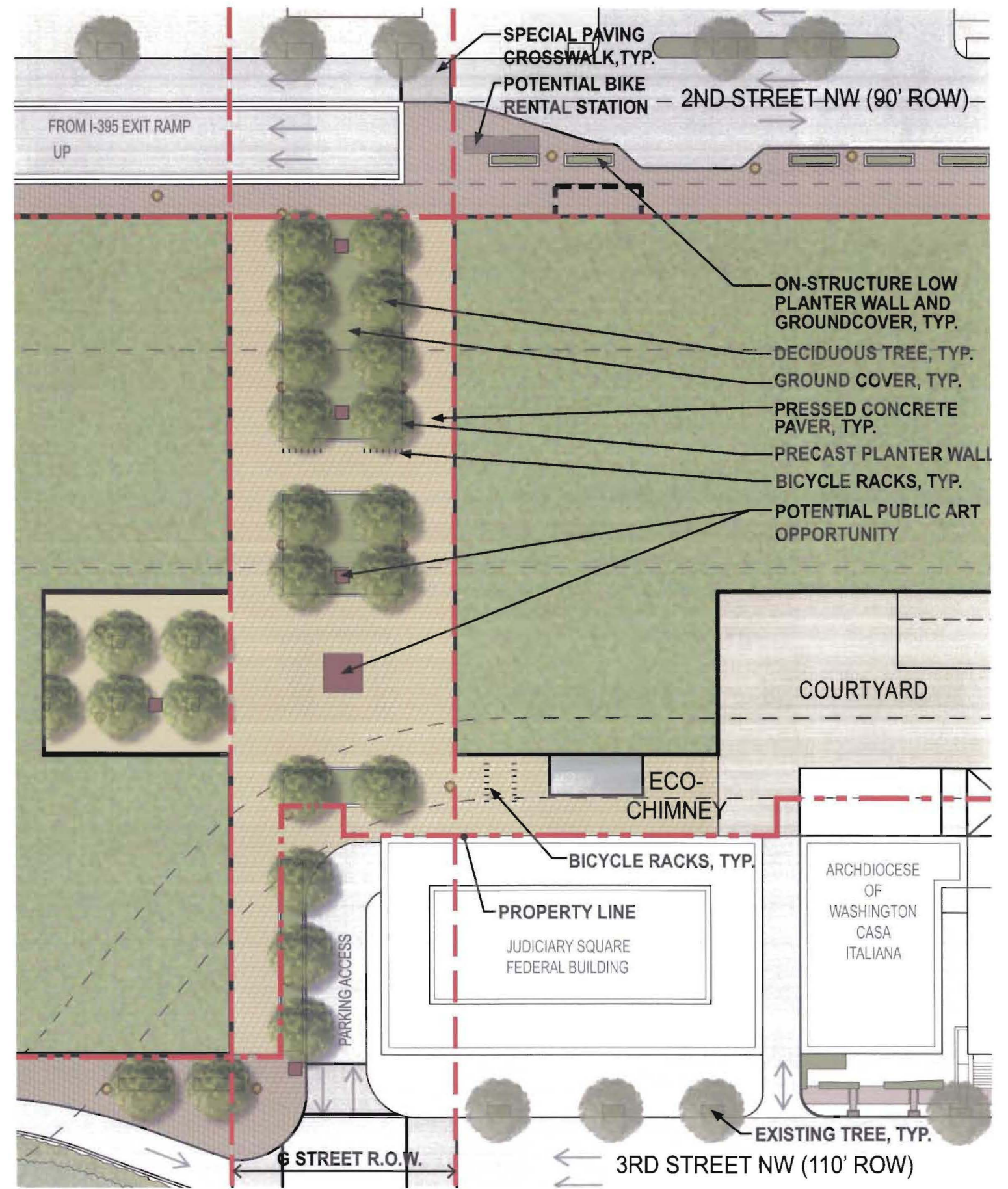



STREET LIGHT - DC TWIN-25



PAVING - PRESSED CONCRETE PAVER



BICYCLE RACK



F STREET SHADE TREE - CHINESE ELM OR SIMILAR



GROUNDCOVER

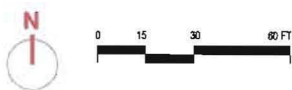
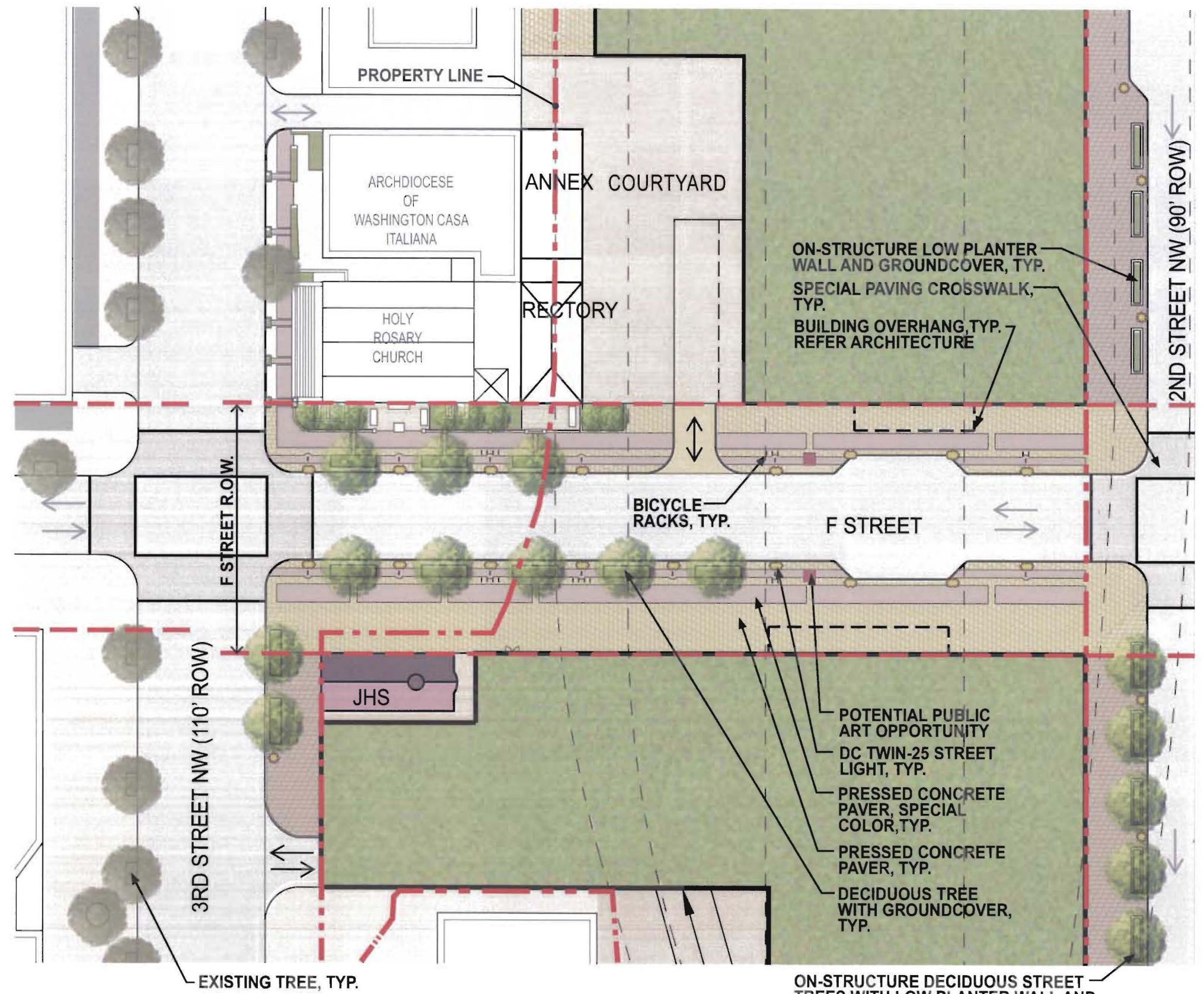

**LEGEND:** - - - PROPERTY LINE  
- - - RIGHT OF WAY

# Return to L'Enfant

# Enlarged Plan - F Street



# Return to L'Enfant

Consolidated PUD Application

December

# F Street - Potential Landscape Elements

EDAW | AECOM | SOM | Louis Dreyfus Property Group 6.7



PAVING - 2'X3' PRESSED CONCRETE PAVER



STREET LIGHT - DC TWIN-20



PAVING - 2'X3' PRESSED CONCRETE PAVER



STREET LIGHT - DC NO.16 SINGLE GLOBE



MASS. AVE. STREET SHADE TREE - SILVER LINDEN OR SIMILAR



GROUNDCOVER



2ND STREET SHADE TREE - GREENSPIRE LINDEN OR SIMILAR



2ND STREET SHADE TREE - SCARLET OAK OR SIMILAR



GROUNDCOVER