

- NOTE:
1. Quantity Control is waived as there is separate storm and sanitary sewer
 2. Quality Control is provided on Public Streets Alleys by use of Quality Control Catch Basins
 3. Quality Control is provided on Private lots - by use of Drywells

NOTE: All utilities layout will be coordinated with respective agencies during the final design phase

S25

Revised April 26, 2007
Revised January 10, 2007
November 3, 2006

Proposed Storm Water Management Plan



Loiederman
Soltesz Associates, Inc.

HIGHLANDS ADDITION
ZONING COMMISSION
District of Columbia
CASE NO.06-45
EXHIBIT NO.36



KEY

- Rear Deck allowed - 6' projection
- Rear Deck allowed - 8' projection

Note: Please refer to Lot Comparison Matrix, Sheet S2-S3 for lot occupancies and FAR incorporating allowed rear deck options

TYPICAL MATERIALS

Rear Decks: Pressure treated wood decking and railings

Pressure treated wood columns with masonry base



Rear Deck Character Precedent



Rear Deck Character Precedent



Sample Side Elevation with Deck



Sample Rear Elevation with Deck

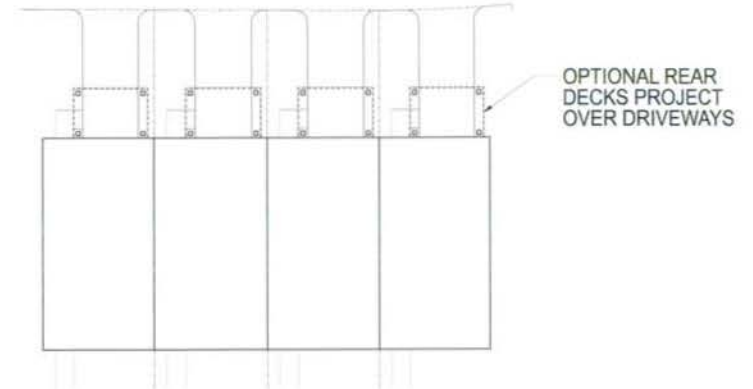

2 SAMPLE BUILDING WITH REAR DECKS

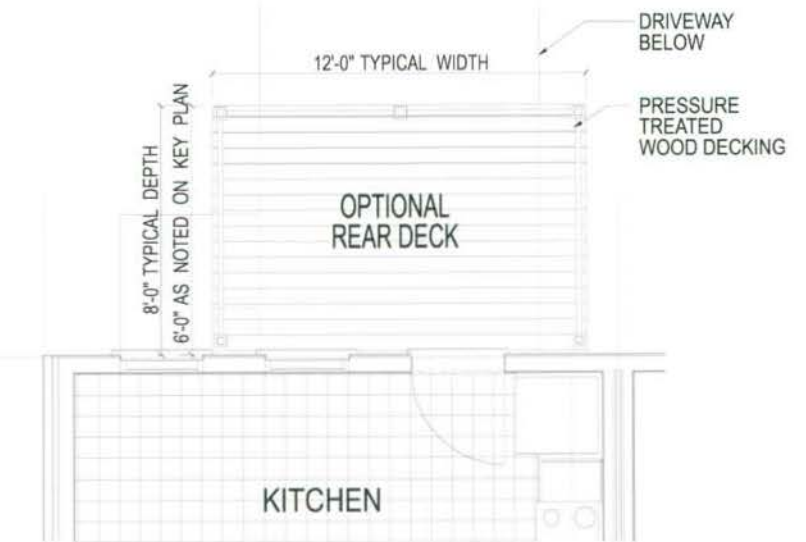

1 TYPICAL PLAN OF REAR DECK OPTION

S26
April 26, 2007

©2007 Torti Gallas and Partners, Inc. 11300 Spring Street, 4th Floor, Silver Spring, Maryland 20901-0000

Schematic Design of Rear Deck Option

NMJCMIIDCHA
TORTI GALLAS AND PARTNERS

HIGHLANDS ADDITION