

BUILDING B



STUDIO SHANGHAI



ILLUSTRATIVE SHARED
PEDESTRIAN/VEHICULAR STREETScape



ART PLACE AT FORT TOTTEN

ZONING COMMISSION
District of Columbia
CASE NO.06-10D
EXHIBIT NO.11B16

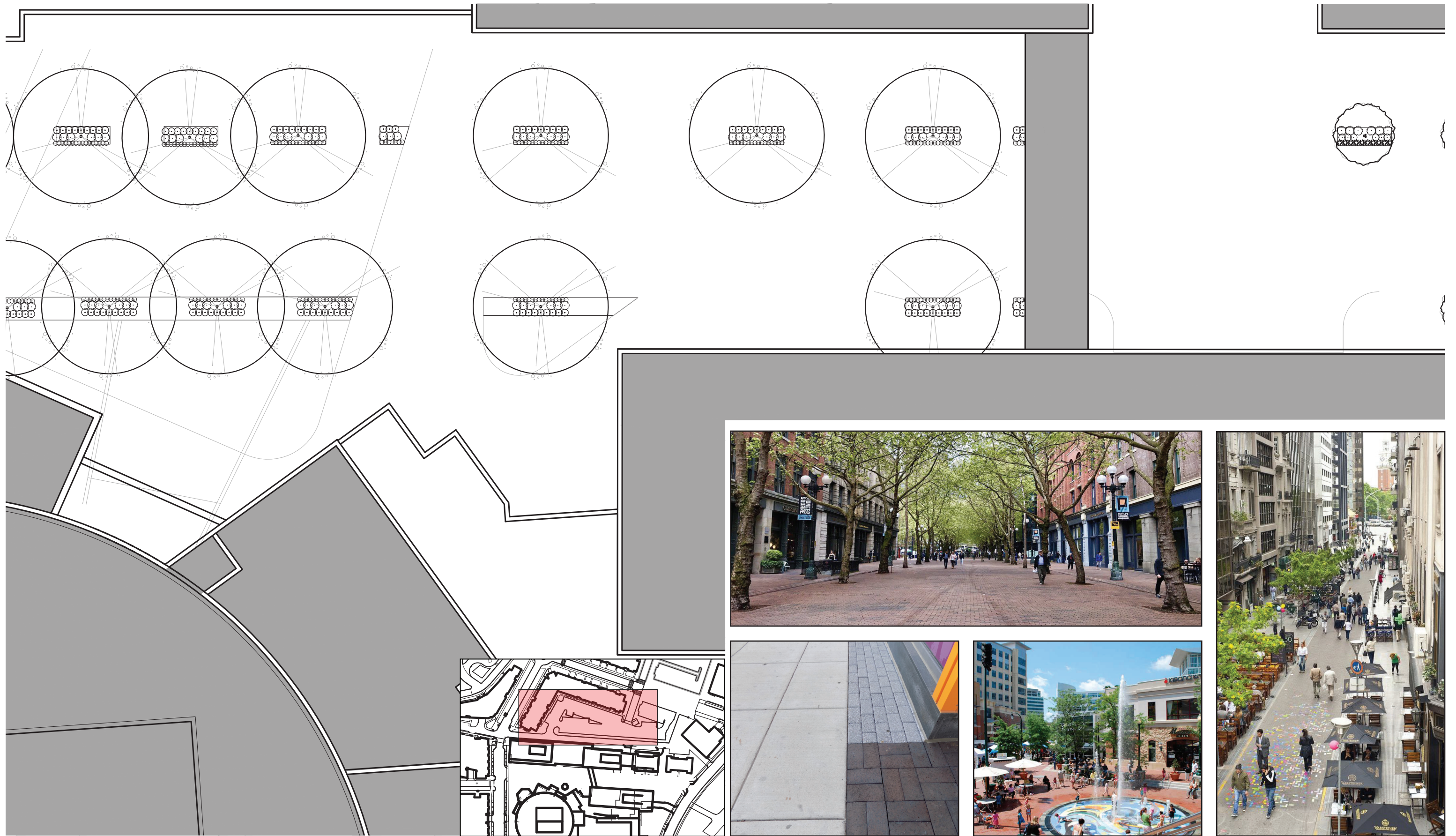

BUILDING B

PERKINS — EASTMAN

STUDIO SHANGHA

VFA CAPITOL



TYPICAL PEDESTRIAN & 4TH STREETSCAPE

ART PLACE AT FORT TOTTEN

L8

