

SOUTHEAST + SOUTHWEST M STREET PARCELS
 FIRST-STAGE PUD MODIFICATION & SECOND-STAGE PUD APPLICATION

July 2, 2018

PERSPECTIVE - LOOKING EAST ON M STREET - WEST BLDG (425)
 Perkins Eastman DC

375 & 425 M STREET SW
 ZONING COMMISSION
 District of Columbia
 CASE NO.02-381
 EXHIBIT NO.131G3

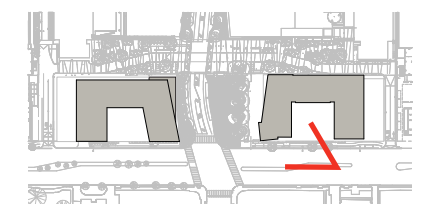

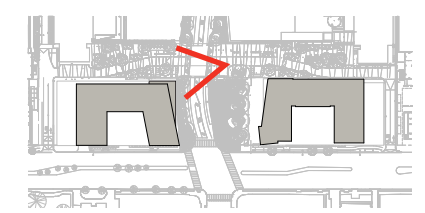

SOUTHEAST + SOUTHWEST M STREET PARCELS
 FIRST-STAGE PUD MODIFICATION & SECOND-STAGE PUD APPLICATION

July 2, 2018

PERSPECTIVE - WEST ENTRANCE PLAZA - WEST BLDG (425)
 Perkins Eastman DC
 375 & 425 M STREET SW

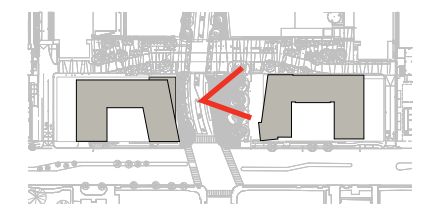



SOUTHEAST + SOUTHWEST M STREET PARCELS
 FIRST-STAGE PUD MODIFICATION & SECOND-STAGE PUD APPLICATION

July 2, 2018

Perkins Eastman DC

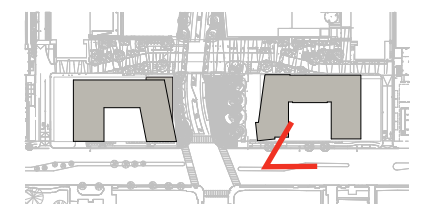

PERSPECTIVE - LOOKING EAST AT COMMUNITY CENTER - EAST BLDG (375)

375 & 425 M STREET SW

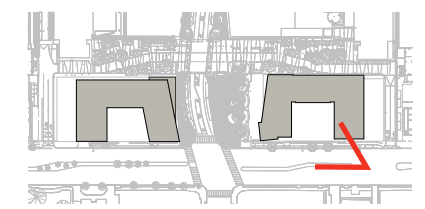

SOUTHEAST + SOUTHWEST M STREET PARCELS
 FIRST-STAGE PUD MODIFICATION & SECOND-STAGE PUD APPLICATION

PERSPECTIVE - LOOKING WEST AT COMMUNITY CENTER - EAST BLDG (375)

July 2, 2018

Perkins Eastman DC

375 & 425 M STREET SW



SOUTHEAST + SOUTHWEST M STREET PARCELS
FIRST-STAGE PUD MODIFICATION & SECOND-STAGE PUD APPLICATION

PERSPECTIVE - LOOKING WEST AT SERVICE & LOADING ENTRANCE - EAST BLDG (375)

July 2, 2018

Perkins Eastman DC

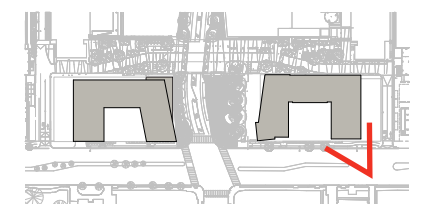

375 & 425 M STREET SW

PAGE INTENTIONALLY
LEFT BLANK



█ PARKING / SERVICE

- NOTES:
1. INTERIOR PARTITION LOCATIONS, THE NUMBER, SIZE AND LOCATIONS OF UNITS, STAIRS, AND ELEVATORS ARE PRELIMINARY AND SHOWN FOR ILLUSTRATIVE PURPOSES ONLY. THE FINAL LAYOUTS MAY VARY.
 2. ALL COMPACT SPACES DENOTED BY "C" ARE 8'-0" x 16'-0" MIN.
 3. ALL OTHER SPACES (EXCEPT ACCESSIBLE) ARE 9'-0" x 19'-0" MIN.
 4. ALL DRIVE AISLES (EXCEPT WHERE SPECIFIED) ARE 24'-0" TYPICAL.

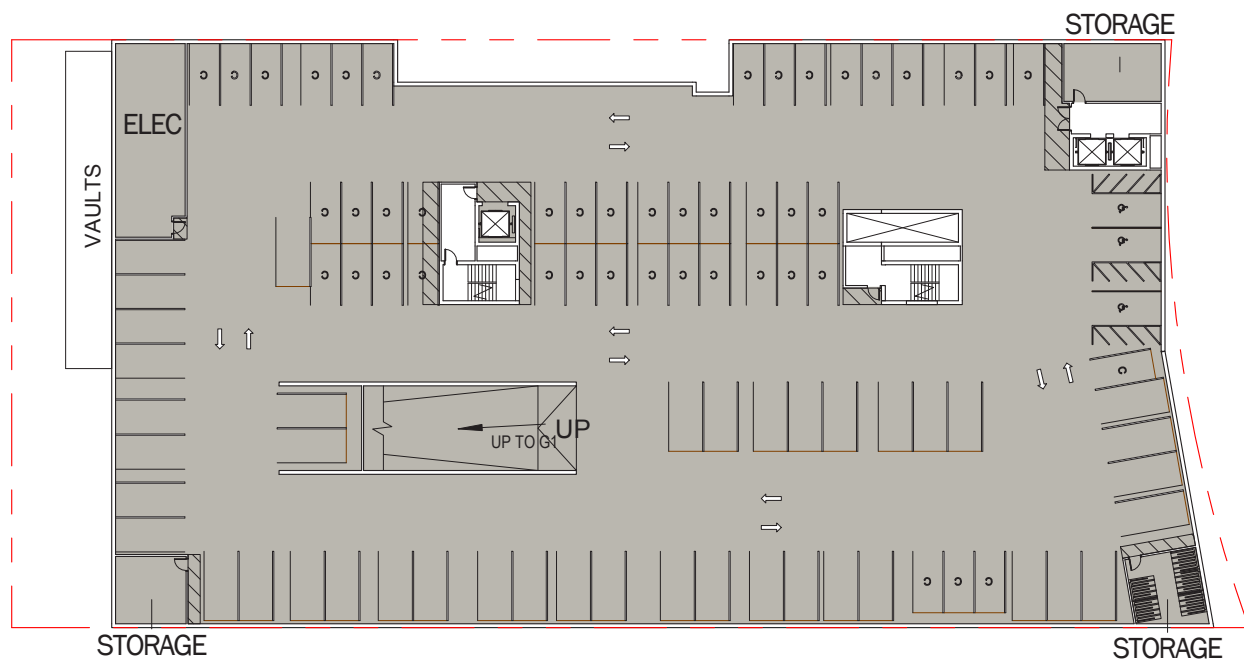

425 M STREET SW

4TH STREET SW

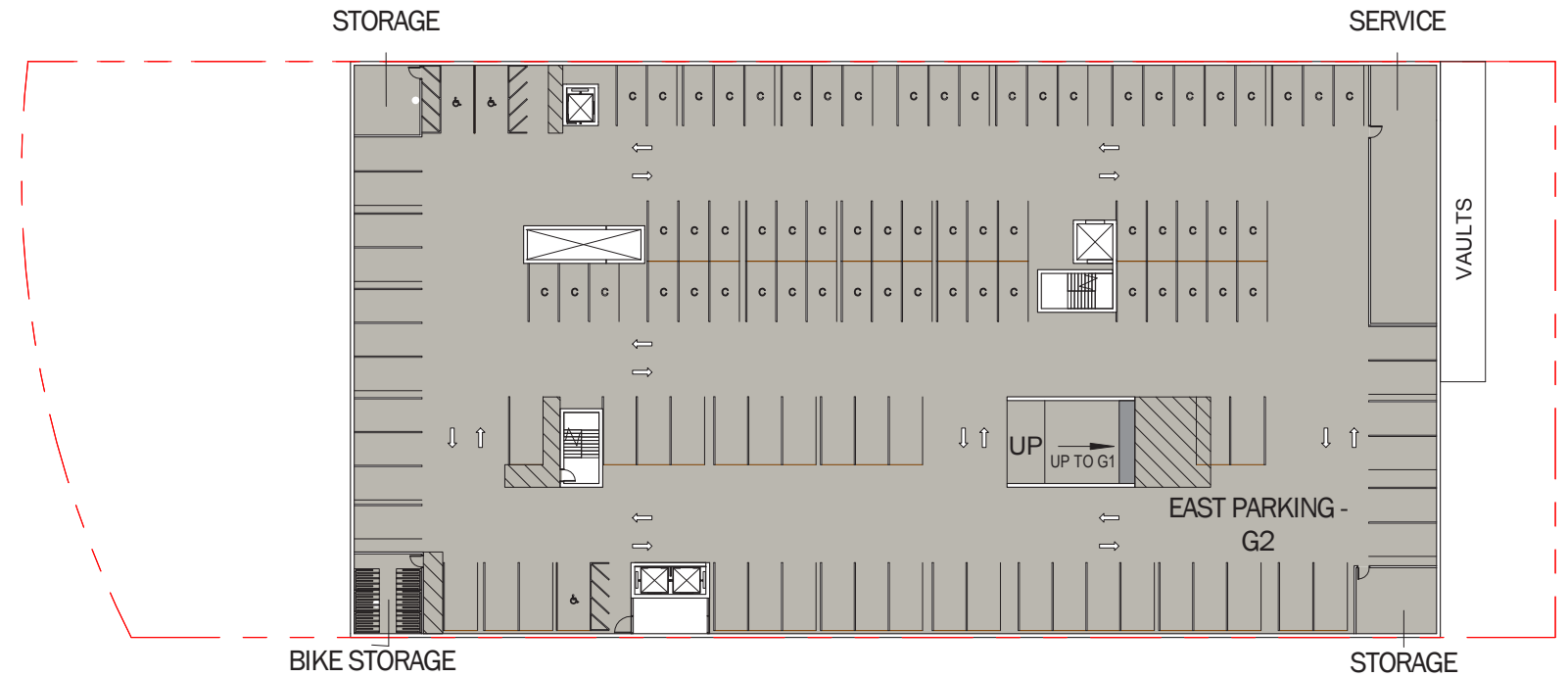

375 M STREET SW

PARKING - WEST G2

ADA	3
COMPACT	45
STANDARD	42
TOTAL	90

PARKING - EAST G2

ADA	3
COMPACT	59
STANDARD	49
TOTAL	111

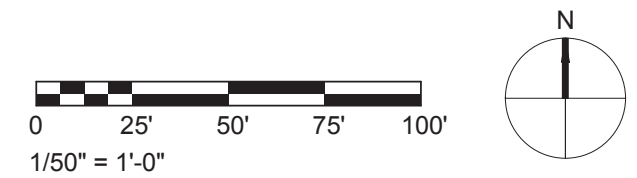

█ PARKING / SERVICE

- NOTES:
1. INTERIOR PARTITION LOCATIONS, THE NUMBER, SIZE AND LOCATIONS OF UNITS, STAIRS, AND ELEVATORS ARE PRELIMINARY AND SHOWN FOR ILLUSTRATIVE PURPOSES ONLY. THE FINAL LAYOUTS MAY VARY.
 2. ALL COMPACT SPACES DENOTED BY "C" ARE 8'-0" x 16'-0" MIN.
 3. ALL OTHER SPACES (EXCEPT ACCESSIBLE) ARE 9'-0" x 19'-0" MIN.
 4. ALL DRIVE AISLES (EXCEPT WHERE SPECIFIED) ARE 24'-0" TYPICAL.

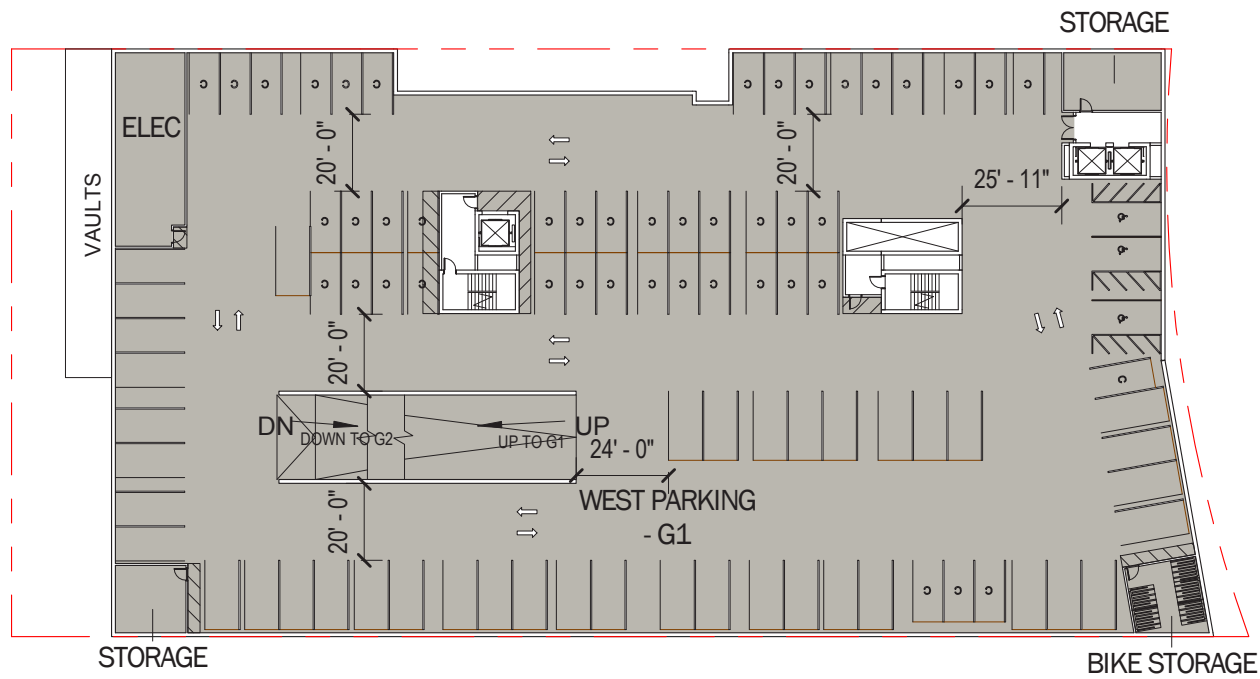

425 M STREET SW

PARKING - WEST G1	
ADA	3
COMPACT	45
STANDARD	41
TOTAL	89

4TH STREET SW

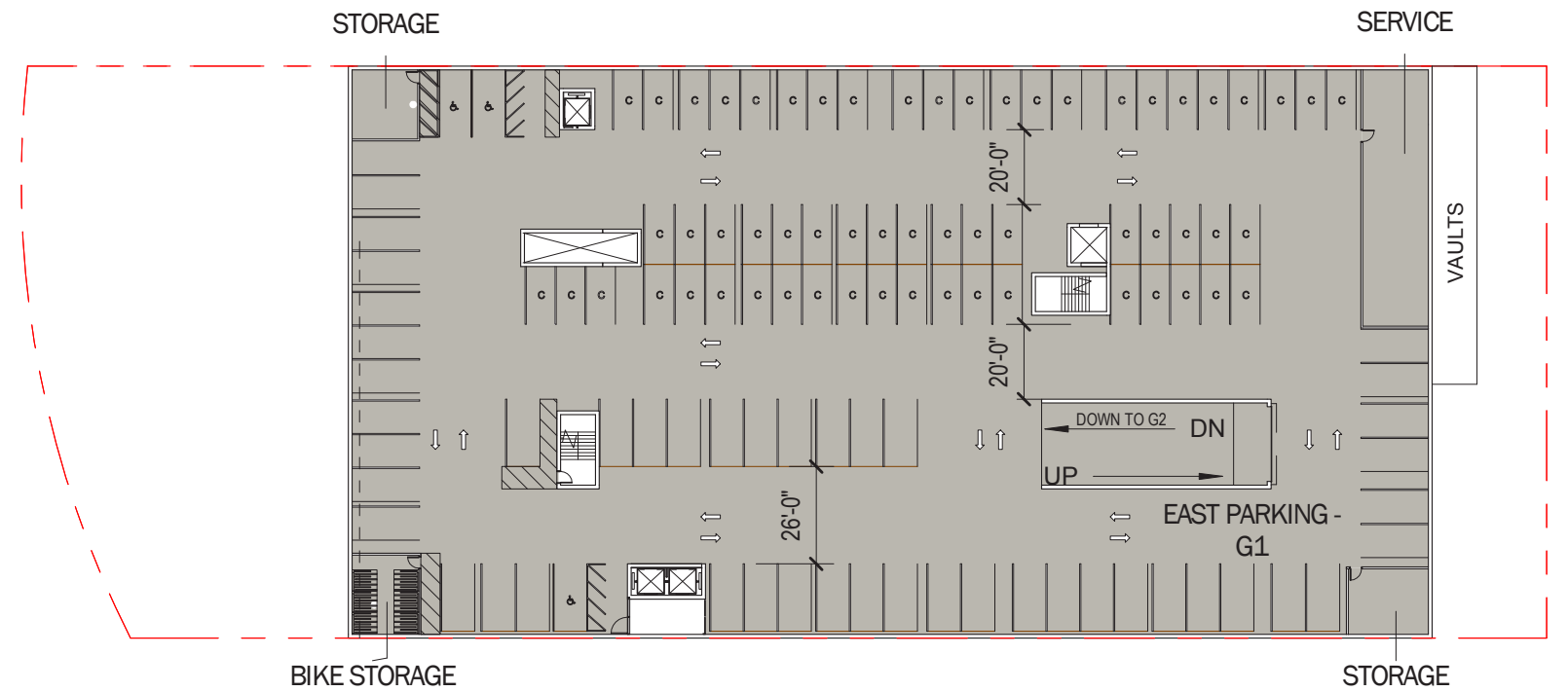

375 M STREET SW

PARKING - EAST G1	
ADA	3
COMPACT	59
STANDARD	47
TOTAL	109

