



WATERFRONT STATION

SOUTHWEST, WASHINGTON, DC

M STREET PARCELS

FIRST-STAGE PUD MODIFICATION
AND SECOND-STAGE PUD SUPPLEMENTAL
POSTHEARING SUBMISSION

ZC Case No. 02-381

July 2, 2018

OWNERS

WATERFRONT 375 M STREET, LLC
WATERFRONT 425 M STREET, LLC

DEVELOPER

FOREST CITY WASHINGTON

LAND USE COUNSEL

HOLLAND & KNIGHT LLP

ARCHITECT

PERKINS EASTMAN DC, PLLC

LANDSCAPE ARCHITECT

PARKER RODRIGUEZ

TRAFFIC CONSULTANT

GOROVE SLADE & ASSOCIATES

CIVIL ENGINEER

BOWMAN CONSULTING DC



PAGE INTENTIONALLY
LEFT BLANK

No. Title:

STAGE 1 PUD MODIFICATIONS

- 1 SUBMISSION OVERVIEW - APPROVED
- 2 SUBMISSION OVERVIEW - PROPOSED
- 3 DEVELOPMENT DATA & ZONING DIAGRAM
- 4 BUILDING DATA SUMMARIES
- 5 BUILDING DATA SUMMARIES
- 6 SITE LOCATION
- 7 STAGE 1 PUD APPROVED - BLDG HEIGHT, AREA & USE DIAGRAM
- 8 STAGE 1 PUD PROPOSED MODIFICATION - BLDG HEIGHT, AREA & USE DIAGRAM
- 9 STAGE 1 PUD APPROVED - SITE CIRCULATION DIAGRAM
- 10 STAGE 1 PUD PROPOSED MODIFICATION - SITE CIRCULATION DIAGRAM
- 11 STAGE 1 PUD APPROVED - OPEN SPACE DIAGRAM
- 12 STAGE 1 PUD PROPOSED MODIFICATION - OPEN SPACE DIAGRAM

STAGE 2 PUD - SITE OVERVIEW & PLANS

- 15 EXISTING CONDITION - 4TH FROM SOUTH
- 16 PROPOSED CONDITION - 4TH FROM SOUTH
- 17 EXISTING CONDITION - 4TH STREET FROM NORTH
- 18 PROPOSED CONDITION - 4TH STREET FROM NORTH
- 19 EXISTING CONDITION - M STREET FROM WEST
- 20 PROPOSED CONDITION - M STREET FROM WEST
- 21 EXISTING CONDITION - M STREET FROM EAST
- 22 PROPOSED CONDITION - M STREET FROM EAST
- 24 AERIAL - LOOKING NORTH
- 25 PERSPECTIVE - LOOKING NORTH ON 4TH STREET
- 26 PERSPECTIVE - LOOKING SOUTH ON 4TH STREET
- 27 PERSPECTIVE - LOOKING NORTHWEST - WEST BLDG (425)
- 28 PERSPECTIVE - LOOKING SOUTHWEST - WEST BLDG (425)
- 29 PERSPECTIVE - LOOKING NORTHEAST - EAST BLDG (375)
- 30 PERSPECTIVE - LOOKING SOUTHEAST - EAST BLDG (375)
- 31 PERSPECTIVE - LOOKING EAST ON M STREET - WEST BLDG (425)
- 32 PERSPECTIVE - LOOKING WEST ON M STREET - EAST BLDG (375)
- 33 PERSPECTIVE - WEST ENTRANCE PLAZA - WEST BLDG (425)
- 34 PERSPECTIVE - EAST ENTRANCE PLAZA - EAST BLDG (375)
- 35 PERSPECTIVE - LOOKING EAST AT COMMUNITY CENTER - EAST BLDG (375)
- 36 PERSPECTIVE - LOOKING WEST AT COMMUNITY CENTER - EAST BLDG (375)
- 37 PERSPECTIVE - LOOKING WEST AT SERVICE & LOADING ENTRANCE - EAST BLDG (375)
- 39 FULL SITE PLAN - PARKING GARAGE LEVEL 2
- 40 FULL SITE PLAN - PARKING GARAGE LEVEL 1
- 41 FULL SITE PLAN - FIRST FLOOR PLAN
- 42 FULL SITE PLAN - SECOND FLOOR PLAN
- 43 FULL SITE PLAN - THIRD FLOOR PLAN
- 44 FULL SITE PLAN - FOURTH FLOOR PLAN
- 45 FULL SITE PLAN - FIFTH - NINTH FLOOR PLAN
- 46 FULL SITE PLAN - TENTH - TWELFTH FLOOR PLAN
- 47 FULL SITE PLAN - PH FLOOR PLAN
- 48 FULL SITE PLAN - PH MECHANICAL PLAN
- 49 WEST BLDG (425) - DIMENSIONED SITE PLAN
- 50 EAST BLDG (375) - DIMENSIONED SITE PLAN
- 51 WEST BLDG (425) - DIMENSIONED ROOF PLAN
- 52 EAST BLDG (375) - DIMENSIONED ROOF PLAN

No. Title:

STAGE 2 PUD - ELEVATIONS

- 55 FULL SITE ELEVATIONS - 4TH STREET
- 56 FULL SITE ELEVATIONS - M STREET & PLAZA
- 57 WEST BLDG (425) - SOUTH ELEVATION
- 58 WEST BLDG (425) - EAST ELEVATION
- 59 WEST BLDG (425) - NORTH ELEVATION
- 60 WEST BLDG (425) - WEST ELEVATION
- 61 WEST BLDG (425) - COURTYARD EAST ELEVATION
- 62 WEST BLDG (425) - COURTYARD WEST ELEVATION
- 63 WEST BLDG (425) - FACADE DETAIL A - M STREET
- 64 WEST BLDG (425) - FACADE DETAIL B - M STREET
- 65 WEST BLDG (425) - FACADE DETAIL C - M STREET
- 66 WEST BLDG (425) - FACADE DETAIL D - 14TH STREET
- 67 WEST BLDG (425) - FACADE DETAIL E - 14TH STREET
- 68 WEST BLDG (425) - FACADE DETAIL F - WEST PLAZA
- 69 WEST BLDG (425) - FACADE DETAIL G - WEST PLAZA
- 70 WEST BLDG (425) - FACADE DETAIL H - WEST PLAZA
- 71 WEST BLDG (425) - FACADE DETAIL I - SERVICE ALLEY
- 72 WEST BLDG (425) - FACADE DETAIL J - SERVICE ALLEY
- 73 MATERIALS - WEST BUILDING
- 74 WEST BUILDING - WINDOW WALL
- 75 WEST BUILDING - GFRC PANEL SYSTEM
- 76 WEST BUILDING - RETAIL PODIUM BAYS
- 77 EAST BLDG (375) - WEST ELEVATION
- 78 EAST BLDG (375) - SOUTH ELEVATION
- 79 EAST BLDG (375) - EAST ELEVATION
- 80 EAST BLDG (375) - NORTH ELEVATION
- 81 EAST BLDG (375) - COURTYARD EAST ELEVATION
- 82 EAST BLDG (375) - COURTYARD WEST ELEVATION
- 83 EAST BLDG (375) - FACADE DETAIL A - EAST BLDG PLAZA
- 84 EAST BLDG (375) - FACADE DETAIL B - 4TH STREET
- 85 EAST BLDG (375) - FACADE DETAIL C - M STREET
- 86 EAST BLDG (375) - FACADE DETAIL D - M STREET
- 87 EAST BLDG (375) - FACADE DETAIL E - M STREET
- 88 EAST BLDG (375) - FACADE DETAIL F - EAST BLDG PLAZA
- 89 EAST BLDG (375) - FACADE DETAIL G - 4TH STREET
- 90 EAST BLDG (375) - FACADE DETAIL H - EAST BLDG PLAZA
- 91 EAST BLDG (375) - FACADE DETAIL I - PRIVATE DRIVE
- 92 EAST BLDG (375) - FACADE DETAIL J - PRIVATE DRIVE
- 93 MATERIALS - EAST BUILDING
- 94 EAST BUILDING - BRICK
- 95 EAST BUILDING - WINDOW WALL
- 96 EAST BUILDING - WINDOW SYSTEM

STAGE 2 PUD - SECTIONS

- 99 WEST BLDG (425) - NORTH/SOUTH SECTION
- 100 WEST BLDG (425) - EAST/WEST SECTION
- 101 WEST BLDG (425) - ENLARGED SECTIONS
- 102 WEST BLDG (425) - ENLARGED SECTIONS
- 103 EAST BLDG (375) - NORTH/SOUTH SECTION
- 104 EAST BLDG (375) - EAST/WEST SECTION

No. Title:

- 105 EAST BLDG (375) - ENLARGED SECTIONS
- 106 EAST BLDG (375) - ENLARGED SECTIONS

STAGE 2 PUD - SOLAR STUDY

- 109 AERIAL VIEW - POTENTIAL SOLAR PANEL ZONE
- 110 WEST BLDG ROOF VIEW - SOLAR PANEL
- 111 WEST BUILDING (375) - SOLAR PANEL
- 112 EAST BUILDING (425) - SOLAR PANEL

STAGE 2 PUD - LANDSCAPE

- L1 LANDSCAPE - SITE AERIAL PHOTO
- L2 LANDSCAPE - MASTER SITE PLAN
- L2A LANDSCAPE - GROUND FLOOR PLAN
- L3 LANDSCAPE - WEST BLDG (425) - GROUND FLOOR
- L4 LANDSCAPE - EAST BLDG (375) - GROUND FLOOR
- L4A LANDSCAPE - ENLARGED EXISTING CONDITIONS OF INTERSECTION
- L4B LANDSCAPE - EXISTING CONDITIONS - SITE PHOTOS
- L4C LANDSCAPE - POTENTIAL ENHANCEMENTS OF INTERSECTION
- L5 LANDSCAPE - STREETScape CHARACTER - PRECEDENT IMAGERY
- L6 LANDSCAPE - WEST BLDG (425) - ROOFTOP PLAN
- L7 LANDSCAPE - WEST BLDG (425) - AMENITY PRECEDENTS
- L7A LANDSCAPE - WEST BLDG (425) - ROOFTOP AMENITIES
- L8 LANDSCAPE - EAST BLDG (375) - ROOFTOP PLAN
- L9 LANDSCAPE - EAST BLDG (375) - AMENITIES PRECEDENTS
- L9A LANDSCAPE - EAST BLDG (375) - ROOFTOP AMENITIES
- L10 LANDSCAPE - WEST BLDG (425) - GAR PLAN
- L11 LANDSCAPE - EAST BLDG (375) - GAR PLAN
- L12 LANDSCAPE - GAR PRELIMINARY SCORESHEET

STAGE 2 PUD - CIVIL & LEED

- C1 CIVIL - EXTENT OF SITE
- C2 CIVIL - GENERAL NOTES
- C3 CIVIL - EXISTING CONDITION - WEST BLDG (425)
- C4 CIVIL - EXISTING CONDITION - EAST BLDG (375)
- C5 CIVIL - EROSION AND SEDIMENT CONTROL - WEST BLDG (425)
- C6 CIVIL - EROSION AND SEDIMENT CONTROL - EAST BLDG (375)
- C7 CIVIL - SITE PLAN - WEST BLDG (425)
- C8 CIVIL - SITE PLAN - EAST BLDG (375)
- C9 CIVIL - GRADING PLAN - WEST BLDG (425)
- C10 CIVIL - GRADING PLAN - EAST BLDG (375)
- C11 CIVIL - UTILITY PLAN - WEST BLDG (425)
- C12 CIVIL - UTILITY PLAN - EAST BLDG (375)
- C13 CIVIL - EROSION AND SEDIMENT CONTROL NOTES
- C14 CIVIL - EROSION AND SEDIMENT CONTROL DETAILS
- C15 CIVIL - STORMWATER MANAGEMENT PLAN - WEST BLDG (425)
- C16 CIVIL - STORMWATER MANAGEMENT PLAN - EAST BLDG (375)
- C17 LEED SCORECARD - WEST BLDG (425)
- C18 LEED SCORECARD - EAST BLDG (375)



SW + SE Street Mixed-Use Buildings

127' Max Height / 11 Levels

L1 Retail @ 16' flr/flr w/ 14' clear ceiling height

L2-11 Office @ 11' flr/flr + 1' @ Roof



SW + SE Street Mixed-Use Buildings

- 127' Max Height / 12 Levels
- L1 Retail @ 17' flr/flr w/ 14' clear ceiling height
- L2 Office @ 12' flr/flr
- L3-L12 Residential @ 9'-8" flr/flr
- Penthouse

1



KEY MODIFICATIONS TO THE APPROVED STAGE 1 PUD:

- 1 Conversion from office to mixed-use building
 - Retail base
 - 2nd floor office
 - Residential towers with rooftop amenity
- 2 Massing
 - Refinements to massing to reflect character of new use
 - No modification to height, density or lot occupancy
- 3 Removal of curb cut on M Street with access to parking and loading from private drives



ZONING TABULATIONS

	02-38A STAGE 2 APPROVED PUD (ACTUAL) ⁽⁵⁾	02-38D STAGE 2 APPROVED PUD (ACTUAL) ⁽⁶⁾	APPROVED STAGE 1 PUD M ST. WEST	PROPOSED STAGE 2 PUD M ST. WEST	APPROVED STAGE 1 PUD M ST. EAST	PROPOSED STAGE 2 PUD M ST. EAST	02-38A STAGE 1 APPROVED FULL BUILD-OUT ⁽⁷⁾	PROPOSED FULL BUILD-OUT ⁽⁸⁾
FAR (1)								
Residential	0.75	0.66	-	0.51	-	0.48	2.11	3.10
Commercial	1.08	0.01	0.55	0.04	0.58	0.09	2.22	1.23
Community				-		0.01		
Total	1.83	0.66	0.55	0.55	0.58	0.58	4.33	4.33
Gross Floor Area								
Residential	438,000	383,845	-	301,670	-	282,208	1,229,605	1,809,498
Commercial	631,198	4,414	322,785	21,103	339,815	51,525	1,296,895	715,492
Community				-		6,000		
Total	1,069,198	388,259	322,785	322,773	339,815	339,733	2,526,500	2,526,406
Height								
Existing Maximum	130 ft	-	-	-	-	-	130 ft	130 ft
Proposed Residential	130 ft	114 ft	127 ft	127 ft	127 ft	127 ft	114 ft	114 ft - 127 ft
Proposed Commercial	94 ft	-	-	-	-	-	94 ft - 127 ft	94 ft
Stories								
Existing Maximum	12	-	-	-	-	-	12	12
Proposed Residential	12	11	-	11	-	10	11 - 12	11 - 12
Proposed Commercial	8	-	11	1	11	2	8 - 11	8
Lot Occupancy (1)	30%	5%	-	6.0%	-	6.4%	58%	58% ⁽²⁾
Penthouse Height	18.5 ft	18.5 ft max	18.5 ft max	20 ft max	18.5 ft max	20 ft max	18.5 ft max	20 ft max
Parking								
Office	276	-	-	-	-	20	-	296
Retail	163	-	-	24	-	20	-	207
Residential (3)	288	224	-	155	-	172	-	839
Community				-		8		8
Total	727	224	-	179	-	220	1,087 min	1350 ⁽⁹⁾
Loading (4)								
Office	4 @ 30 ft 2 @ 20 ft		2 @ 30 ft	2 @ 12x30 ft LOADING (SHARED)	2 @ 30 ft	2 @ 12x30 ft LOADING (SHARED)	Min of: 3 @ 30 ft 1 @ 20 ft	5 @ 30 ft 1 @ 20 ft
Retail	1 @ 55 ft 1 @ 30 ft 1 @ 20 ft			1 @ 10x20 ft SERVICE (SHARED)		1 @ 10x20 ft SERVICE (SHARED)	2 @ 55 ft 2 @ 30 ft 2 @ 20 ft	2 @ 55 ft 2 @ 30 ft 2 @ 20 ft
Residential	2 @ 55 ft 2 @ 20 ft	2 @ 30 ft					2 @ 30 ft 1 @ 55 ft 1 @ 20 ft	4 @ 30 ft 1 @ 55 ft 3 @ 20 ft

NOTES:

- FAR & LOT OCCUPANCY CALCULATIONS BASED ON TOTAL SITE AREA = 584,655 sf
- LOT OCCUPANCY: FLEXIBILITY TO PROVIDE A MAXIMUM OF 63% LOT OCCUPANCY WAS GRANTED IN THE FIRST STAGE PUD APPROVAL
- PARKING: PARKING FOR THE EAST & WEST M STREET PARCELS WAS APPROVED IN THE FIRST STAGE PUD APPROVAL WITHIN THE MINIMUM OF 1,087 PARKING SPACES
- LOADING: THE NUMBER OF PROVIDED LOADING BERTHS, PLATFORMS AND SERVICE DELIVERY SPACES SATISFIES THE REQUIREMENTS OF DCMR 11. FLEXIBILITY TO INCREASE THE NUMBER OF BERTHS, PLATFORMS AND SERVICE DELIVERY SPACES WAS GRANTED IN THE FIRST STAGE PUD APPROVAL, PER SHEET 1.3 (DEVELOPMENT DATA AND ZONING DIAGRAM) OF THE APPROVED FIRST STAGE PUD PLANS
- REFERS TO WEST 4TH STREET COMMERCIAL BUILDING, EAST 4TH STREET COMMERCIAL BUILDING, WEST TOWER RESIDENTIAL BUILDING, AND EAST TOWER RESIDENTIAL BUILDING.
- REFERS TO NORTHWEST RESIDENTIAL BUILDING.
- IF THE PUD MODIFICATION IS APPROVED, THE APPROVED FULL BUILD-OUT PROJECT DENSITY WILL BE AS FOLLOWS: (i) 4.33 FAR TOTAL; (ii) 3.10 FAR RESIDENTIAL; AND (iii) 1.23 FAR COMMERCIAL.
- PROPOSED FULL BUILD-OUT CATEGORY ASSUMES NE RESIDENTIAL BUILDING IS CONSTRUCTED AS APPROVED IN 1ST STAGE PUD.
- PROPOSED FULL BUILD-OUT TOTAL PARKING COUNT DOES NOT INCLUDE PARKING LOCATED WITHIN NE BUILDING PARCEL.

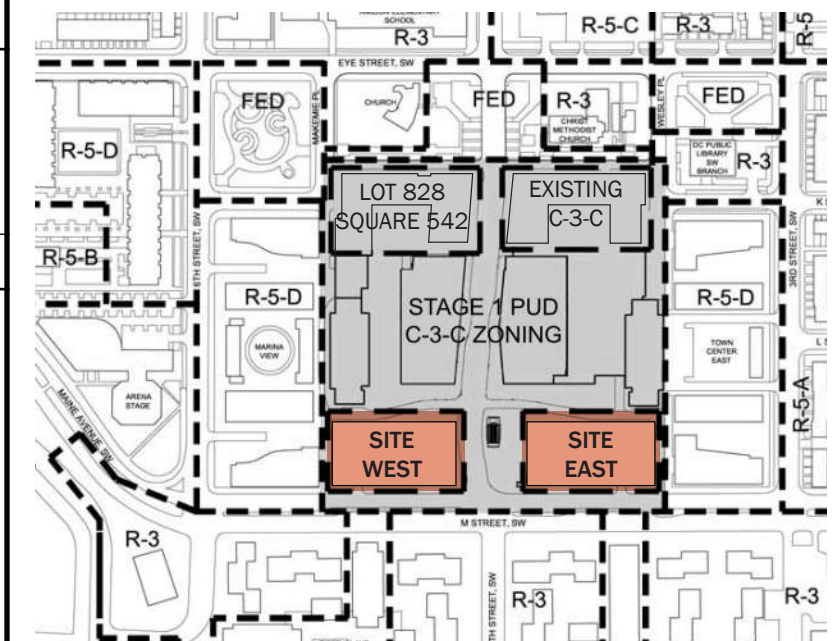

ZONING TABULATIONS

YARDS, COURTS, AND GAR AREAS

	REQUIRED	PROVIDED STAGE 2 PUD M ST. WEST	PROVIDED STAGE 2 PUD M ST. EAST
REAR YARD	2.5" per 1' vertical distance from grade to highest point of parapet wall, but not less than 12'.	Distance calculated: 27' Rear yard provided: 30' (Measured for the record lot)	Distance calculated: 27' Rear yard provided: 30' (Measured for the record lot)
SIDE YARD	None req'd. but if provided at least 2" wide for each 1' of height of bldg. but no less than 5'	Distance calculated: 22' Side yard provided: 26' (Measured from west prop. line)	Distance calculated: 22' Side yard provided: 31'-6" (Measured from east prop. line)
CLOSED COURT AT LEVEL 2	Min. width: 4 in./ft. of height of court, 15' min. Min. area: 2x the square of req'd width, 350 sf min.	Height of court: 26'-2" Minimum width required: 15' Width provided: 34' Min. area required: 450 sf Area provided: 2,875 sf	Height of court: 26'-2" Minimum width required: 15' Width provided: 34' Min. area required: 450 sf Area provided: 3,675 sf
OPEN COURT AT LEVEL 3	Min. width: 4 in./ft. of height of court, 10 ft min.	Height of court: 101' Minimum width calculated: 33'-8" Width provided: 45'	Height of court: 101' Minimum width calculated: 33'-8" Width provided: 45'
OPEN COURT AT LEVEL 4	Min. width: 4 in./ft. of height of court, 10 ft min.	Height of court: 91'-4" Minimum width calculated: 30'-6" Width provided: 79'	Height of court: 91'-4" Minimum width calculated: 30'-6" Width provided: 78'
GAR	Min. green area ratio: 0.20	≥0.20	≥0.20

INCLUSIONARY ZONING SUMMARY⁽¹⁾

	STAGE 2 PUD M ST. WEST	STAGE 2 PUD M ST. EAST
TOTAL GROSS FLOOR AREA (ALL USES FAR)	322,773 SF	339,733 SF
TOTAL RESIDENTIAL GROSS FLOOR AREA	301,670 SF	282,208 SF
TOTAL RESIDENTIAL NET FLOOR AREA	257,371 SF	231,491 SF
RATIO OF TOTAL NET RES AREA / TOTAL GROSS RES AREA	85%	82%
TOTAL RESIDENTIAL IZ REQUIRED (8% RESIDENTIAL NET)	20,590 SF	18,519 SF
TOTAL NET SF DEVOTED TO IZ	20,590 SF	19,547 SF

GROSS FLOOR AREAS

	STAGE 2 PUD M ST. WEST	STAGE 2 PUD M ST. EAST
RESIDENTIAL	301,670 SF	282,208 SF
OFFICE	-	32,456 SF
RETAIL	21,103 SF	19,069 SF
COMMUNITY	-	6,000 SF
TOTAL	322,773 SF	339,733 SF

UNIT MIX

	STAGE 2 PUD M ST. WEST	STAGE 2 PUD M ST. EAST
COUNT ⁽²⁾	309	289
TYPE	MIX	MIX
JR	20-25%	20%-25%
1BR	45-50%	45-50%
1BR+	5-10%	7-12%
2BR	17-22%	17-22%
3BR	0.5-1%	0.5-1%

LOT OCCUPANCY PER FLOOR

FLOOR	WEST BLDG	LOT OCCP. (3)	EAST BLDG	LOT OCCP. (4)
12	24,710 SF	53%	26,400 SF	43%
11	24,710 SF	53%	26,400 SF	43%
10	24,710 SF	53%	26,400 SF	43%
9	26,240 SF	56%	27,230 SF	45%
8	26,240 SF	56%	27,230 SF	45%
7	26,240 SF	56%	27,230 SF	45%
6	26,240 SF	56%	27,230 SF	45%
5	26,240 SF	56%	27,230 SF	45%
4	26,240 SF	56%	27,230 SF	45%
3	30,380 SF	65%	31,650 SF	52%
2	31,920 SF	68%	36,330 SF	59%
1	34,690 SF	74%	37,060 SF	61%
TOTAL	326,940 SF	-	347,620 SF	-

NOTES:

- Per Subtitle C Chapter 15 Section 1500.11, all penthouse habitable space is communal space and therefore does not create any additional IZ.
- Flexibility requested to provide a range in the number of residential units of plus or minus 5%.
- West Building LOT OCCUPANCY = 46,768 SF
- East Building LOT OCCUPANCY = 61,065 SF



ZONING TABULATIONS

PARKING AND SUPPORT

CAR PARKING	STAGE 2 PUD M ST. WEST			STAGE 2 PUD M ST. EAST			CAR REQUIREMENTS METHOD OF CALCULATION
	REQUIRED	50% ⁽¹⁾	PROVIDED	REQUIRED	50% ⁽¹⁾	PROVIDED	
RESIDENTIAL	103	52	155	96	48	172	# units / 3
OFFICE	-	-	-	16	8	20	Office Sq Ft * .5 / 1000
RETAIL	28	14	24	25	13	20	Retail Sq Ft * 1.33 / 1000
COMMUNITY	-	-	-	6	3	8	Community Sq Ft * 1 / 1000
TOTAL	131	66	179	143	72	220	

BIKE PARKING	STAGE 2 PUD M ST. WEST				STAGE 2 PUD M ST. EAST				BICYCLE REQUIREMENTS METHOD OF CALCULATION	
	Long Term		Short Term		Long Term		Short Term		Long Term	Short Term
	REQ.	PROV.	REQ.	PROV.	REQ.	PROV.	REQ.	PROV.		
RESIDENTIAL	77	77	16	16	73	73	15	15	# units/3 up to 50 spaces # units/6 after 50	# units/20 up to 50 spaces # units/40 after 50
OFFICE	-	-	-	-	13	14	2	2	Office GFA / 2,500 (Min. 2 req'd)	Office GFA / 40,000 (min. 2 req'd)
RETAIL	2	8	6	6	2	3	6	6	Retail GFA / 10,000	Retail GFA / 3,500
COMMUNITY	-	-	-	-	2	3	2	2	Community GFA / 10,000	Community GFA / 10,000
TOTAL	79	85	22	22	90	93	25	25		

BIKE SUPPORT	STAGE 2 PUD M ST. WEST		STAGE 2 PUD M ST. EAST		BICYCLE SUPPORT METHOD OF CALCULATION
	REQUIRED	PROVIDED	REQUIRED	PROVIDED	
SHOWERS	0	2	2	2	Min. 2 for non-residential use over 25,000 sq ft GFA
LOCKERS	0	8	10	20	0.6 times the min. # of req'd non-residential LT bicycle spaces

NOTES:

1. 50% Reduction per DCMR 2016 - Section 702.1 - Item (a):

"702.1 Within any zone other than an R or RF zone, the minimum vehicle parking requirement identified in the table of Subtitle C § 701.5 shall be reduced by fifty percent (50%) for any site which is located:

(a) Within one-half mile (0.5 mi.) of a Metrorail station that is currently in operation or is one for which a construction contract has been awarded; or





NOTE:
 The design of the building footprints are shown for illustrative purposes, conforming to the density, setback, and height limitations proposed in the drawings. Final design proposals for the buildings will be filed in subsequent Second Stage PUD applications.

NORTHWEST BUILDING

New Residential Building
 12 Floors Condo / 114' Bldg. Ht
 13 Floors Rental / 114' Bldg. Ht
 total area 406,900 sf

WEST 4TH STREET BUILDING

New Commercial Office Building
 8 Floors / 94' Bldg. Ht.
 total area 291,570 sf

Shared Private Drive requires mutual approval by Waterfront Associates and Marina View

WEST TOWER

Converted Residential Building
 12 Floors / 130' Bldg. Ht.
 total area 219,600 sf

WEST M STREET BUILDING

New Commercial Office Building
 11 Floors / 127' Bldg. Ht
 total area 322,785 sf

NORTHEAST BUILDING

New Residential Building
 12 Floors / 114' Bldg. Ht
 with Courtyard over 1 Story Structure
 (with option to do 13 Floors with Courtyard at grade)
 total area 400,000 sf

EAST 4TH STREET BUILDING

New Commercial Office Building
 8 Floors / 94' Bldg. Ht.
 total area 273,330 sf

GROCERY (At-Grade)

1 Floor / 25' Bldg. Ht.
 total area 55,000 sf

EAST TOWER

Converted Residential Building
 12 Floors / 130' Bldg
 total area 218,400 sf

EAST M STREET BUILDING

New Commercial Office Building
 11 Floors / 127' Bldg. Ht
 total area 339,815 sf

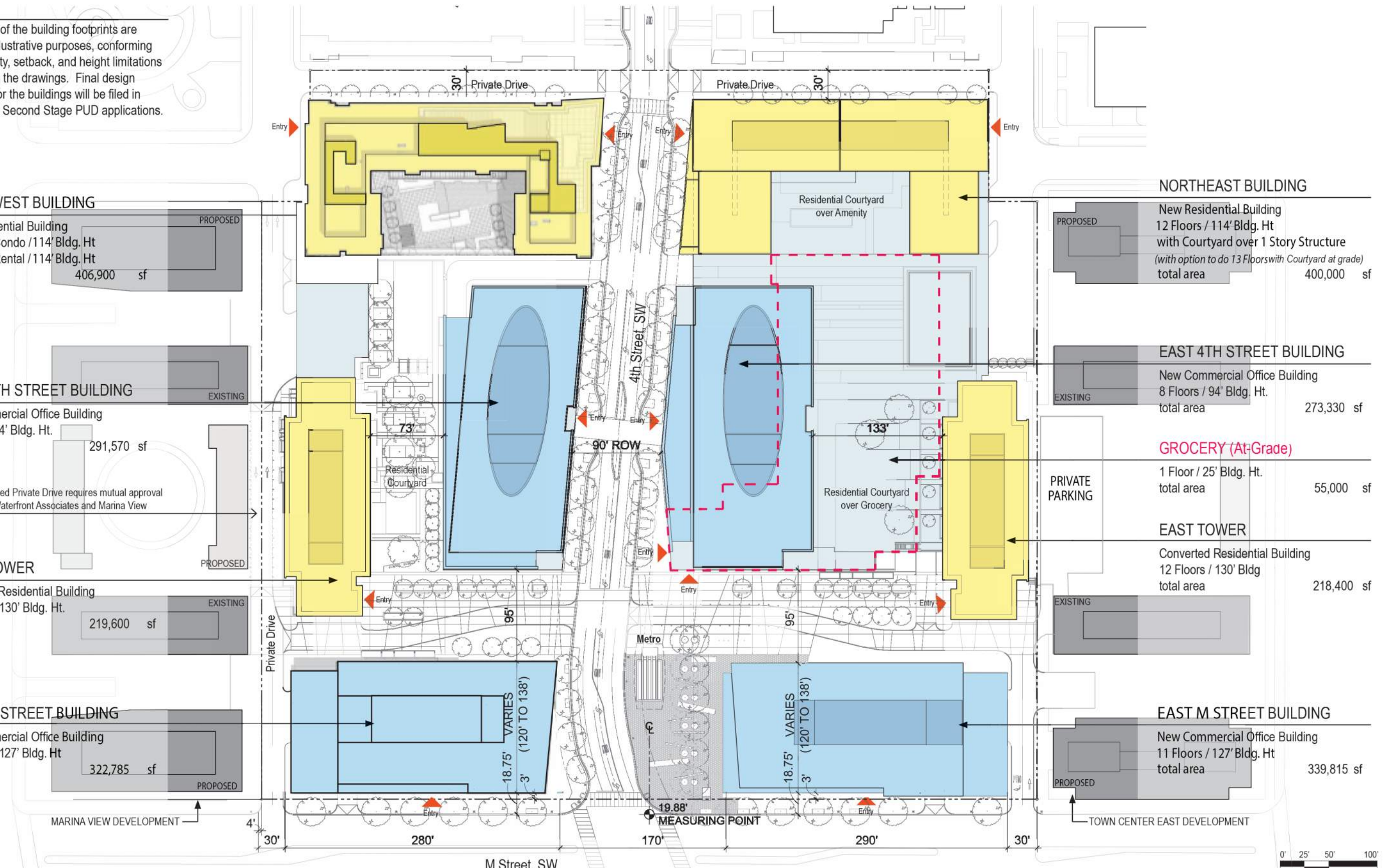

NOTE:
The design of the building footprints are shown for illustrative purposes, conforming to the density, setback, and height limitations proposed in the drawings. Final design proposals for the buildings will be filed in subsequent Second Stage PUD applications.

EXTENT OF PROPOSED STAGE 1 MODIFICATION AREA

DASHED LINE INDICATES EXTENT OF APPROVED FIRST STAGE PUD

NORTHWEST BUILDING

New Residential Building
12 Floors Condo / 114' Bldg. Ht
13 Floors Rental / 114' Bldg. Ht
total area 406,900 sf

WEST 4TH STREET BUILDING

New Commercial Office Building
8 Floors / 94' Bldg. Ht.
total area 291,570 sf

WEST TOWER

Converted Residential Building
12 Floors / 130' Bldg. Ht.
total area 219,600 sf

LOT 825, SQUARE 542 WEST M STREET BUILDING

Proposed Residential/Retail Building
12 Floors / 127' Bldg. Ht
total area 322,773 sf

NORTHEAST BUILDING

New Residential Building
12 Floors / 114' Bldg. Ht
with Courtyard over 1 Story Structure
(with option to do 13 Floors with Courtyard at grade)
total area 400,000 sf

EAST 4TH STREET BUILDING

New Commercial Office Building
8 Floors / 94' Bldg. Ht.
total area 273,330 sf

GROCERY (At-Grade)

1 Floor / 25' Bldg. Ht.
total area 55,000 sf

EAST TOWER

Converted Residential Building
12 Floors / 130' Bldg
total area 218,400 sf

LOT 826, SQUARE 542 EAST M STREET BUILDING

Proposed Residential/Office/Retail/Community Building
12 Floors / 127' Bldg. Ht
total area 339,733 sf

Shared Private Drive requires mutual approval by Waterfront Associates and Marina View

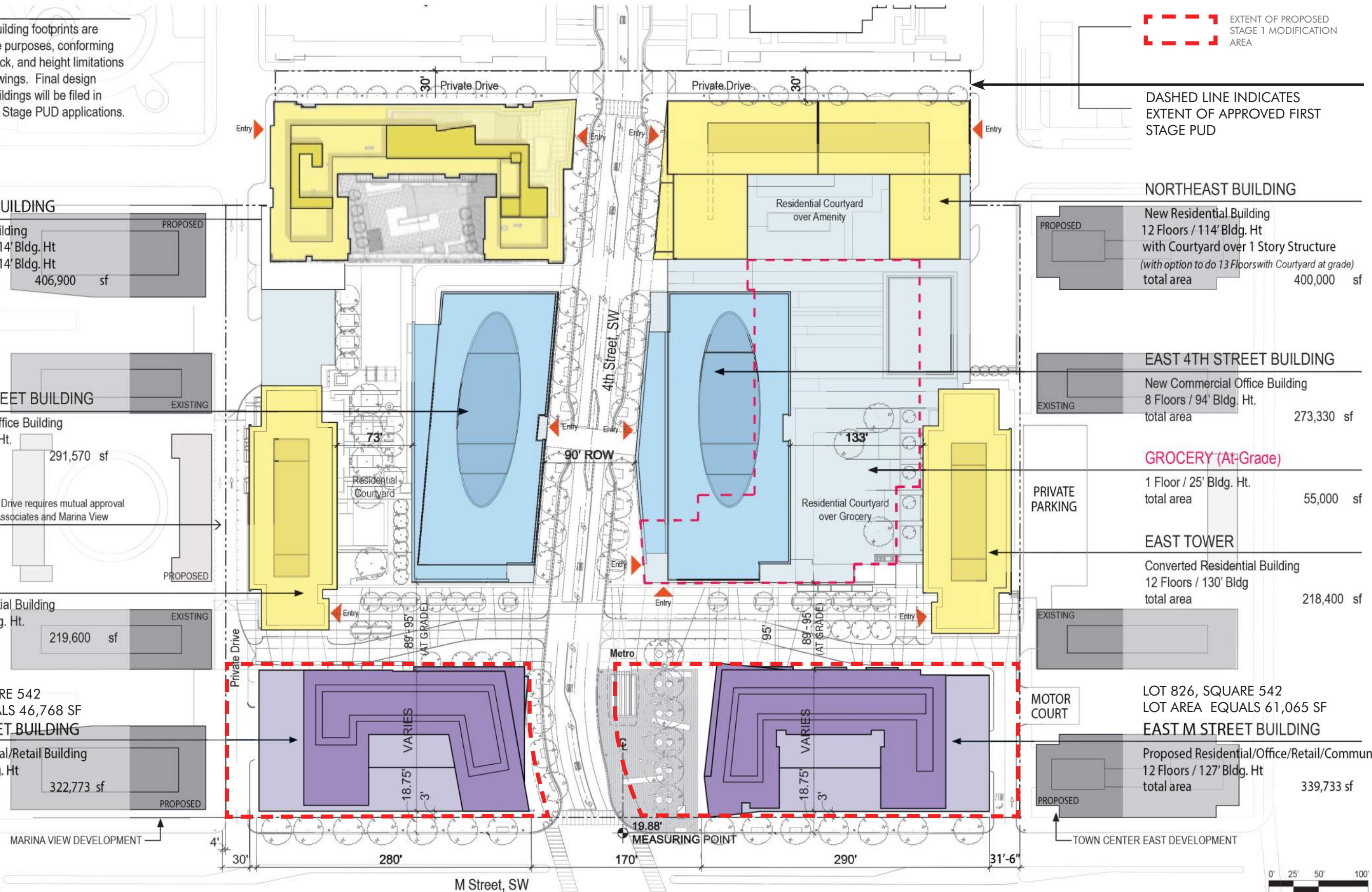

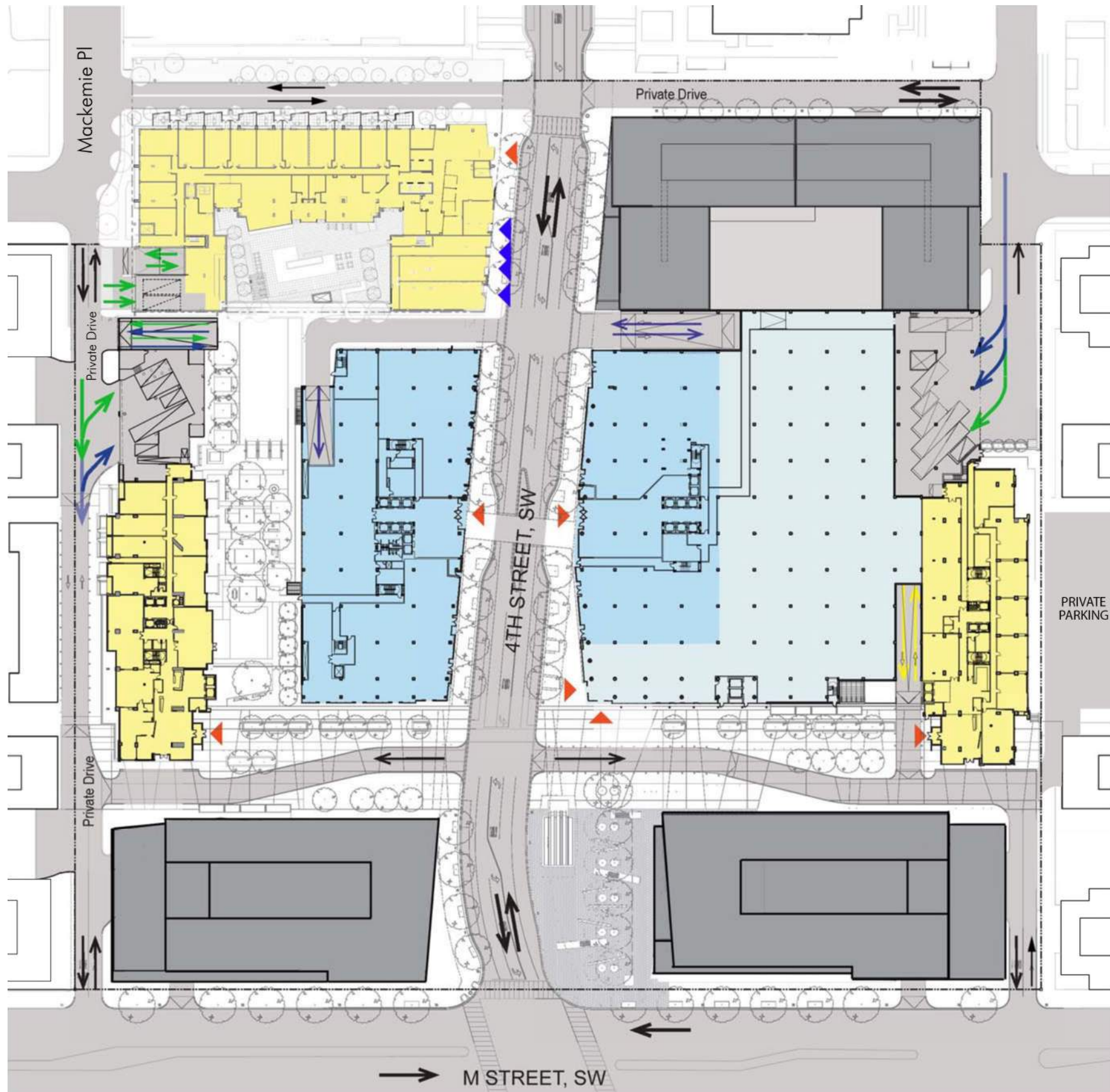

NOTES:

1. RETAIL ENTRANCE LOCATIONS SUBJECT TO CHANGE BASED UPON THE NEEDS OF THE TENANTS.
2. INTERIOR PLAN LAYOUTS ARE CONCEPTUAL AND SHOWN FOR ILLUSTRATIVE PURPOSES. FINAL LAYOUTS MAY VARY.

LEGEND:

-  Building Entrances
-  Road Circulation
-  Residential Parking / Loading Entrances
-  Commercial Parking / Loading Entrances
-  Retail Entrances

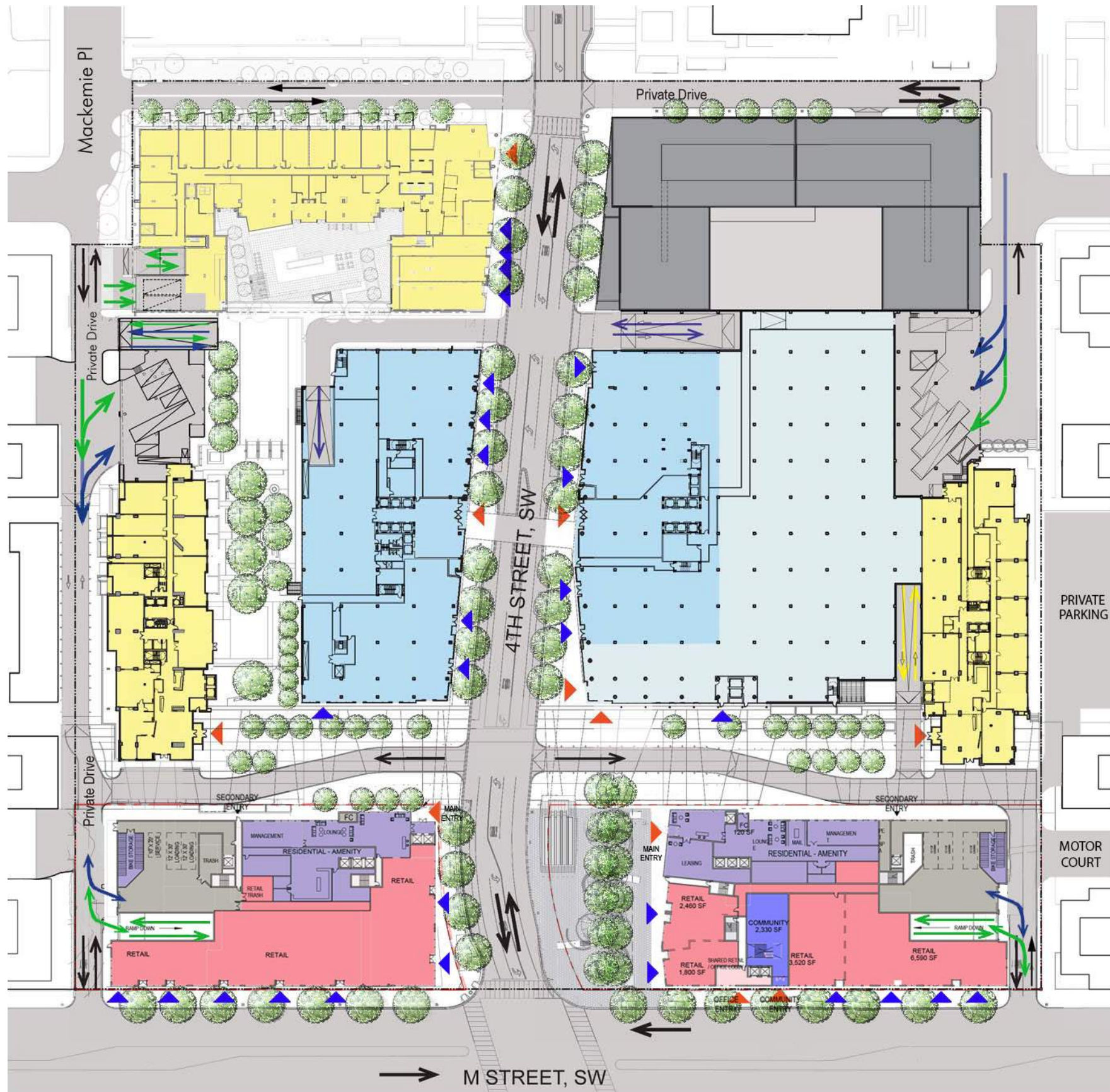

NOTES:

1. RETAIL ENTRANCE LOCATIONS SUBJECT TO CHANGE BASED UPON THE NEEDS OF THE TENANTS.
2. INTERIOR PLAN LAYOUTS ARE CONCEPTUAL AND SHOWN FOR ILLUSTRATIVE PURPOSES. FINAL LAYOUTS MAY VARY.
3. CURB CUT CONNECTED TO M STREET HAS BEEN REMOVED OFF BOTH M STREET PARCELS.

LEGEND:

-  Building Entrances
-  Road Circulation
-  Residential Parking / Loading Entrances
-  Commercial Parking / Loading Entrances
-  Retail Entrances

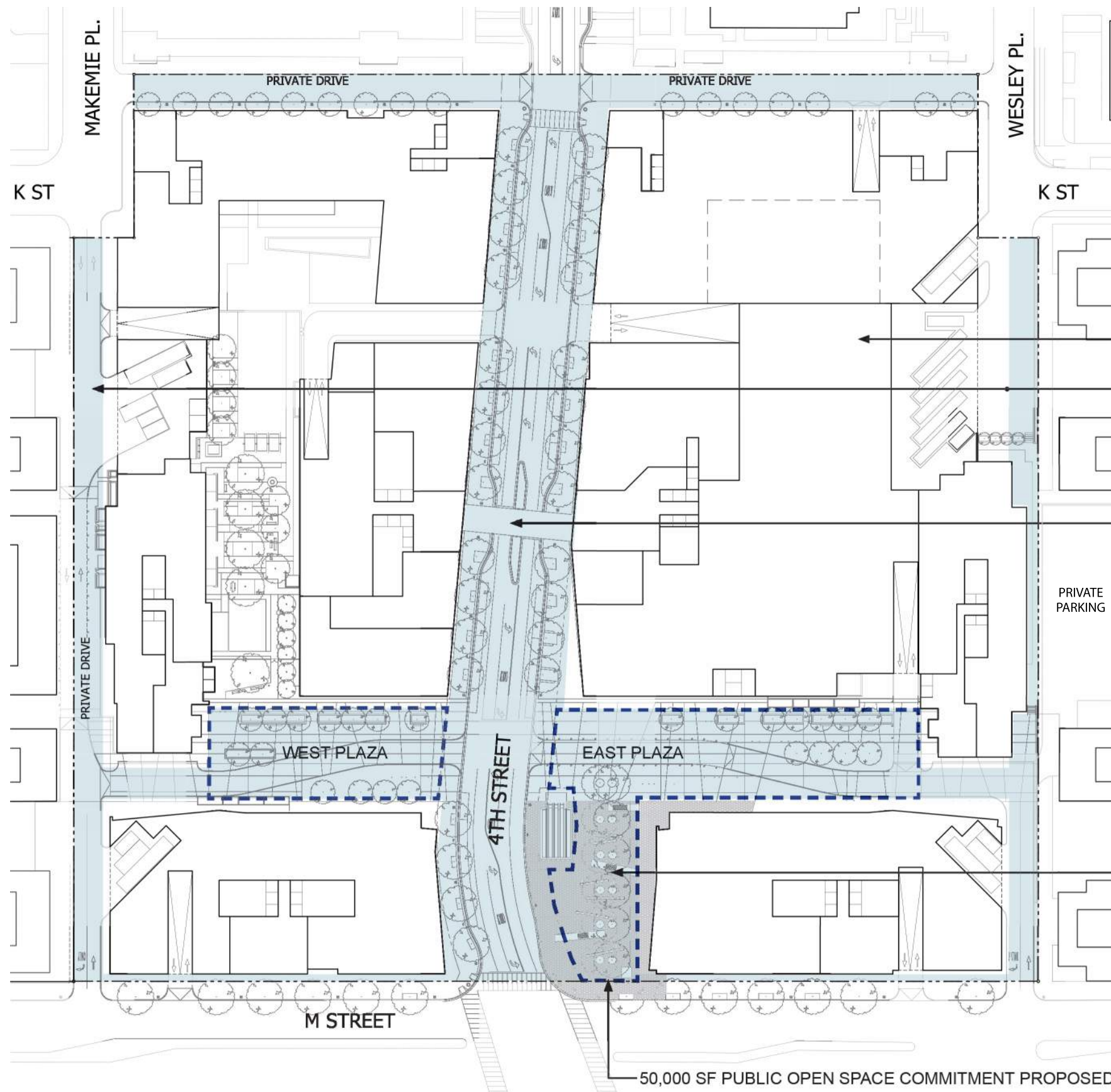

NOTES:

1. INTERIOR PLAN LAYOUTS ARE CONCEPTUAL AND SHOWN FOR ILLUSTRATIVE PURPOSES. THE FINAL LAYOUTS MAY VARY.
2. THE PLAN ILLUSTRATES FOURTH STREET WITH A 90' RIGHT OF WAY AND A 55' ROAD BED (AS BEING DESIGNED AND COORDINATED WITH DDOT).
3. DIMENSIONS SHOWN ARE MINIMUMS. FLEXIBILITY TO INCREASE THE MINIMUM DIMENSIONS IS REQUESTED.

LEGEND:

- OPEN SPACE -**
COMBINATION LANDSCAPE AND HARD SCAPE AREAS OPEN TO THE SKY.
- PROPOSED PUBLIC OPEN SPACE COMMITMENT**

ACCESS / SERVICE DRIVE (REAR YARD)

SERVICE AREAS

4TH STREET, SW

PRIVATE PARKING

WEST PLAZA

EAST PLAZA

METRO PLAZA WITH METRORAIL ESCALATORS

M STREET

50,000 SF PUBLIC OPEN SPACE COMMITMENT PROPOSED





PAGE INTENTIONALLY
LEFT BLANK

STAGE 2 PUD - SITE OVERVIEW & PLANS









