

PHASE 1 South Parcel	REAR YARD		SIDE YARD		CLOSED COURT	
	Required/ Allowed	PUD Proposed	Required/ Allowed	PUD Proposed	Required/ Allowed	PUD Proposed
Building 1A "SW Building"	Min. 2 1/2"/ft not less than 12' 2 1/2" per 75.7' = 15.77'	21' - 8"	None; If provided not < 5'	0'	Court SE Min Width 4" per 98.16' = 32.72'	51' - 0"
Building 1B "SE Building"	Min. 2 1/2"/ft not less than 12' 2 1/2" per 98.16' = 20.45'	30' - 0"	None; If provided not < 5'	0' (12'-1" flexibility not used)	Court SW Min Width 4" per 75.7' = 25.23'	62' - 0"

NOTE: THEORETICAL LOTS HAVE BEEN ESTABLISHED FOR THE PURPOSE OF DETERMINING CONFORMANCE TO REAR AND SIDE YARD REQUIREMENTS

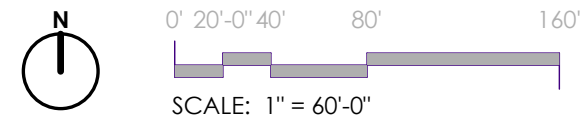

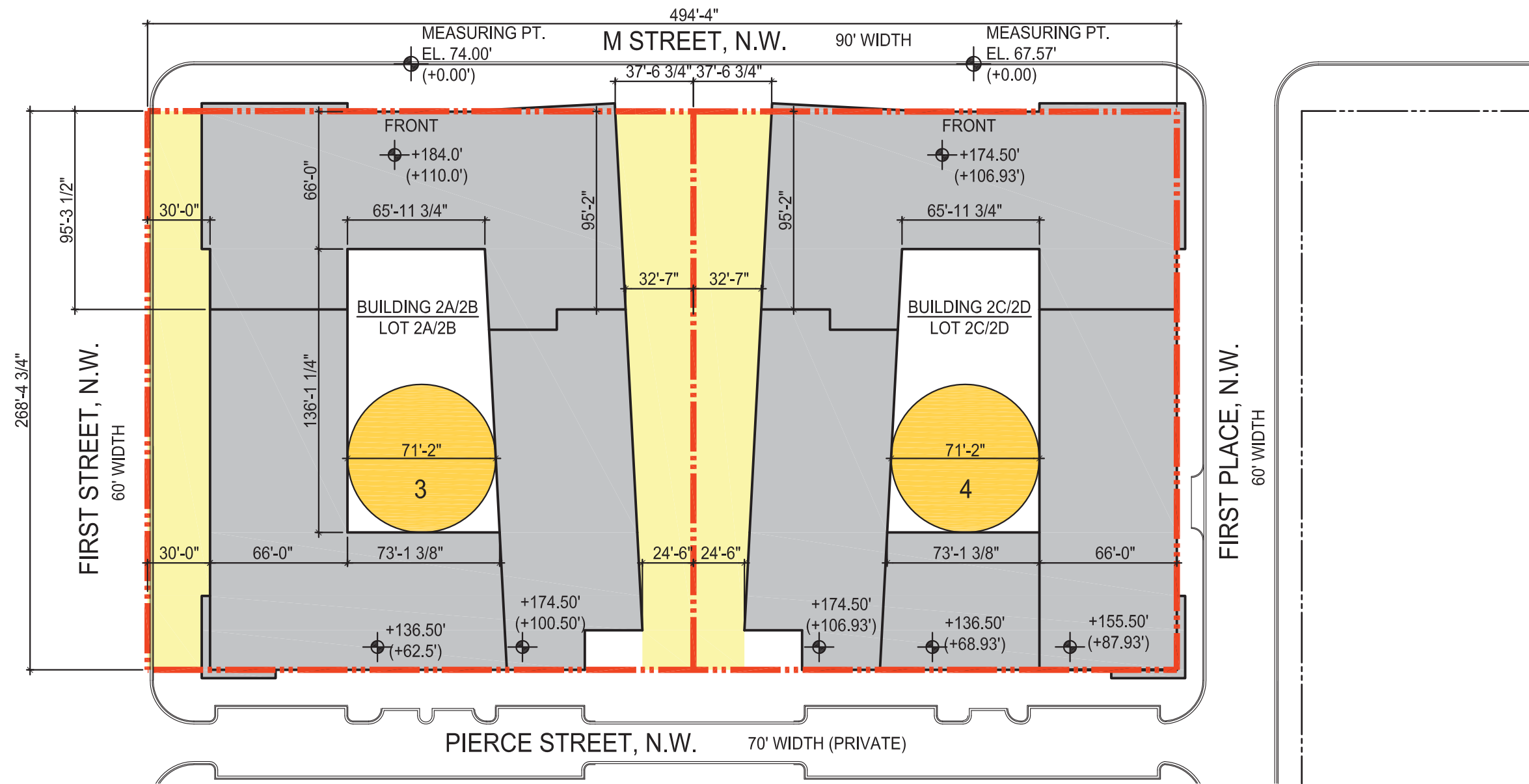

NOTE: THEORETICAL LOTS HAVE BEEN ESTABLISHED FOR THE PURPOSE OF DETERMINING CONFORMANCE TO REAR AND SIDE YARD REQUIREMENTS

LEGEND	
	CLOSED COURT
	SIDE YARD
	REAR YARD
	THEORETICAL LOT LINE

PHASE 2 North Block	REAR YARD		SIDE YARD		CLOSED COURT		PUD Proposed
	Required/ Allowed	PUD Proposed	Required/ Allowed	PUD Proposed	Required/ Allowed	PUD Proposed	
Building 2A/2B	Compliant closed Court 3 provided in lieu of Rear Yard	None	None; If provided not < 6' 2" per 110.0' = 18.33' 2" per 100.50' = 16.75' 2" per 110.0' = 18.33' 2" per 62.5' = 10.42'	32'-7" min. 24'-6" min. 30'-0" 30'-0"	Court 3 Min. Width 4" per 112.0' = 37.33' Min. Area 2 x 37.33 ² = 2,787.55 sf	65'-11 3/4" 9,465 sf	
Building 2C/2D	Compliant closed Court 4 provided in lieu of Rear Yard	None	None; If provided not < 6' 2" per 102.5' = 17.08' 2" per 102.5' = 17.08'	32'-7" min. 24'-6" min.	Court 4 Min. Width 4" per 102.5' = 34.17' Min. Area 2 x 34.17 ² = 2,335.18 sf	65'-11 3/4" 9,465 sf	

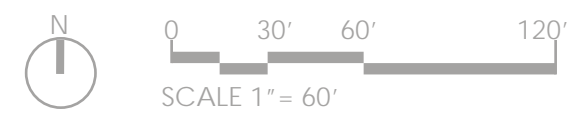

THIS SHEET INTENTIONALLY LEFT BLANK

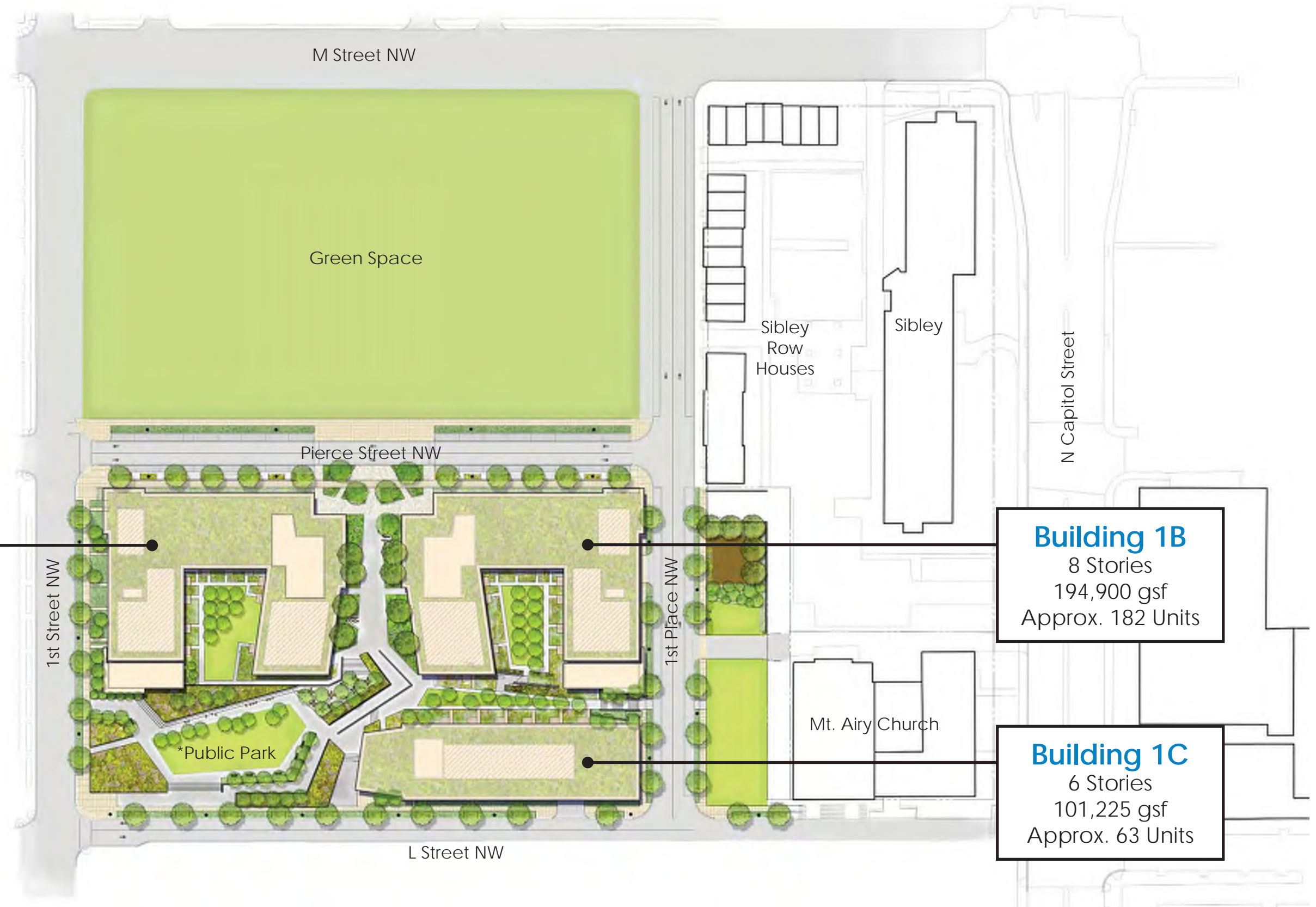

Building 1A
 8 Stories
 184,775 gsf
 Approx. 176 Units

Building 1B
 8 Stories
 194,900 gsf
 Approx. 182 Units

Building 1C
 6 Stories
 101,225 gsf
 Approx. 63 Units



*REFER TO NOTES ON LANDSCAPE DRAWINGS REGARDING THE PUBLIC PARK.

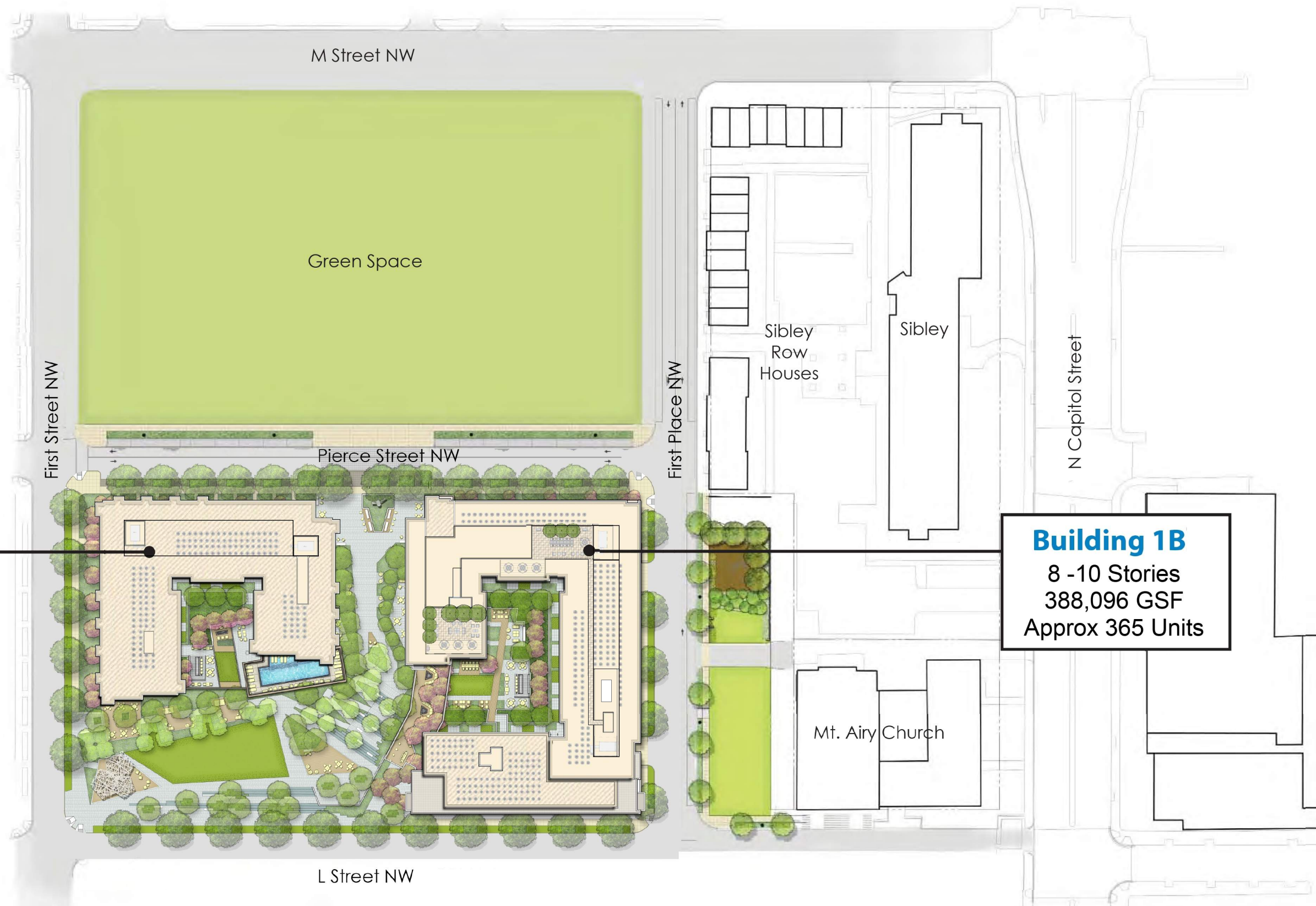

Building 1A
 7 Stories
 167,047 GSF
 Approx 160 Units

Building 1B
 8 -10 Stories
 388,096 GSF
 Approx 365 Units



*REFER TO NOTES ON LANDSCAPE DRAWINGS REGARDING THE PUBLIC PARK.

Building 2A/2B
 6-11 Stories
 425,225 gsf
 Approx. 348 Units

Building 2C/2D
 6-10 Stories
 439,460 gsf
 Approx. 362 Units

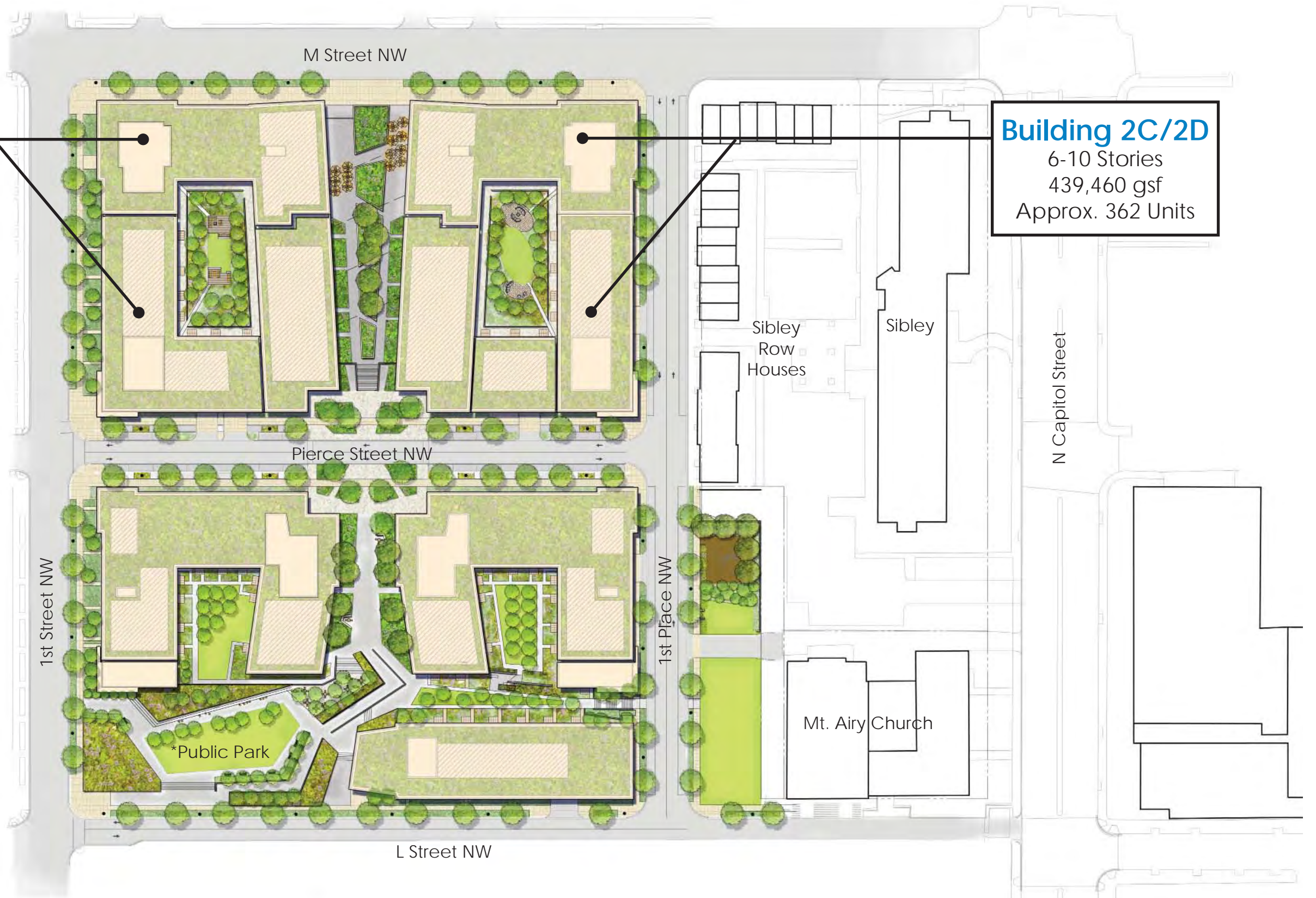

*REFER TO NOTES ON LANDSCAPE DRAWINGS REGARDING THE PUBLIC PARK.

