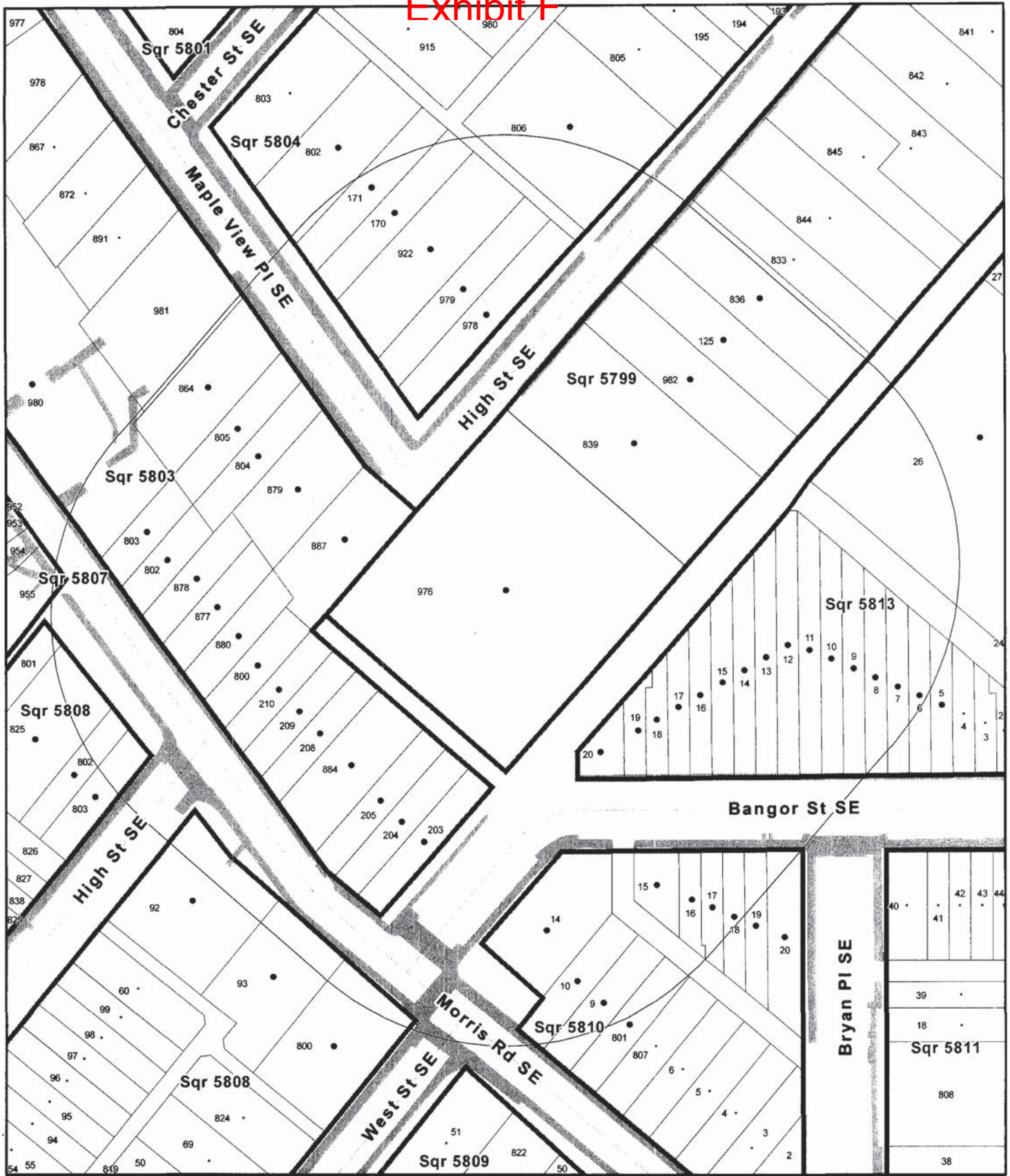

Exhibit F



Subject Property ID: 5799 0976

- Subject Property
- Radius
- Ownership Lots
- DC Squares

DC Office of Tax and Revenue
Real Property Assessment Division
Geographic Information Systems

1:1,121

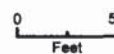

Printed on 06/14/2010
For general planning purposes
DISTRICT OF COLUMBIA COMMISSION



CASE NO.18-10
EXHIBIT NO.2F

MORRIS ROAD LP COHEN FINANCIAL
4601 COLLEGE BLVD STE 300
LEAWOOD, KS 66211-1652

JAMES C BATEMAN
1386 MORRIS RD SE
WASHINGTON, DC 20020-5216

GRETA J FULLER
1352 MAPLE VIEW PL SE
WASHINGTON, DC 20020-5720

MORRIS ROAD LP COHNE FINANCIAL
4601 COLLEGE BLVD STE 300
LEAWOOD, KS 66211-1652

JUDITH DEAN
1384 MORRIS RD SE
WASHINGTON, DC 20020-5216

LESLIE ROBINSON
1350 MAPLE VIEW PL SE
WASHINGTON, DC 20020-5720

CHEKESKA RASHAD
1351 MAPLE VIEW PL SE
WASHINGTON, DC 20020-5709

LEROY BARLEY
912 ALABAMA AVE SE
WASHINGTON, DC 20032-4247

JADE S MOORE
1348 MAPLE VIEW PL SE
WASHINGTON, DC 20020-5720

VINCENT W HUNNICUTT
1349 MAPLE VIEW PL SE
WASHINGTON, DC 20020-5709

HAVILAH REAL PROPERTY SVCS, LLC
1051 WINDRUSH LN
SANDY SPRING, MD 20860-1358

2331 HIGH SE LLC
1917 BENNING RD NE
WASHINGTON, DC 20002-4723

MARK A CALLIGAN
1353 MAPLE VIEW PL SE
WASHINGTON, DC 20020-5709

HAVILAH REAL PROPERTY SVCS, LLC
1051 WINDRUSH LN
SANDY SPRING, MD 20860-1358

CASSANDRA R JOHNSON
1354 MAPLE VIEW PL SE
WASHINGTON, DC 20020-5720

LEVITA D MONDIE
1357 MAPLE VIEW PL SE
WASHINGTON, DC 20020-5709

CATHLEEN L BRINKLEY
8409 CARROLLTON PKWY
NEW CARROLLTN, MD 20784-2731

HELEN L HARDY
1360 MAPLE VIEW PL SE
WASHINGTON, DC 20020-5720

VICTOR K PURCELL II3
1398 MORRIS RD SE
WASHINGTON, DC 20020-5216

THE UNITED HOUSE OF PRAYER
1665 N PORTAL DR NW
WASHINGTON, DC 20012-1053

CATRINA ROBINSON
2820 ERIE ST SE
WASHINGTON, DC 20020-3128

KEVIN THORNE
1396 MORRIS RD SE
WASHINGTON, DC 20020-5216

UNITED HOUSE OF PRAYER
1665 N PORTAL DR NW
WASHINGTON, DC 20012-1053

MARLENE J MINOR
1375 MORRIS RD SE
WASHINGTON, DC 20020-5215

LEONA F BENNETT
1394 MORRIS RD SE
WASHINGTON, DC 20020-5216

UNITED HOUSE OF PRAYER
1665 N PORTAL DR NW
WASHINGTON, DC 20012-1053

ROBERT E CLAGETT
2308 PITTS PL SE APT 2
WASHINGTON, DC 20020-4926

QZABELE JONES
1388 MORRIS RD SE
WASHINGTON, DC 20020-5216

STEPHEN GERBER
1347 MAPLE VIEW PL SE
WASHINGTON, DC 20020-5709

YSY INC
1300 MACBETH ST
MC LEAN, VA 22102-2737

HILYARD S MOORE
9920 FRANKLIN ST
LANHAM, MD 20706-4714

CHARLEY A HAMMEL
1419 BANGOR ST SE
WASHINGTON, DC 20020-4914

JAMES A GOUGH
1428 BANGOR ST SE
WASHINGTON, DC 20020-4915

M MATTHEWS
1377 MORRIS RD SE
WASHINGTON, DC 20020-5215

PHOEBE L MAY
PO BOX 92904
WASHINGTON, DC 20090-2904

TIANA N WASHINGTON
1426 BANGOR ST SE
WASHINGTON, DC 20020-4915

TINA L FLETCHER
1385 MORRIS RD SE
WASHINGTON, DC 20020-5215

NOREEN M FERGUSON
1423 BANGOR ST SE
WASHINGTON, DC 20020-4914

E N WILKINSON
1424 BANGOR ST SE
WASHINGTON, DC 20020-4915

CLAUDIUS D MAJOR
3729 LUMAR DR
FORT WASHINGTON, MD 20744-1861

RENITA SIMRIL
1425 BANGOR ST SE
WASHINGTON, DC 20020-4914

AVA FAULKNER-LUCAS
1422 BANGOR ST SE
WASHINGTON, DC 20020-4915

DAVID SERRANO
230 12TH ST SE
WASHINGTON, DC 20003-1428

ANN-MARIE WATT
1414 MORRIS RD SE
WASHINGTON, DC 20020-4411

BARBARA J HASKELL
1420 BANGOR ST SE
WASHINGTON, DC 20020-4915

STEVEN E MYLES
1412 MORRIS RD SE
WASHINGTON, DC 20020-4411

DOMINIQUE T HAZZARD
1438 BANGOR ST SE
WASHINGTON, DC 20020-4915

BEVERLY C HUMBLE
1418 BANGOR ST SE
WASHINGTON, DC 20020-4915

DEBRA I PASCHALL
1410 MORRIS RD SE
WASHINGTON, DC 20020-4411

JAMILA WHITE
1436 BANGOR ST SE
WASHINGTON, DC 20020-4915

DERRICK THOMPSON
1416 BANGOR ST SE
WASHINGTON, DC 20020-4915

SI INVESTORS FIVE LLC
2000 MASSACHUSETTS AVE NW STE
WASHINGTON, DC 20036-1014

DANIEL T ELKINS
1623 MONTELLO AVE NE
WASHINGTON, DC 20002-2750

DELORES SINGLETON
1414 BANGOR ST SE
WASHINGTON, DC 20020-4915

CAROLYN THORNE
1415 BANGOR ST SE
WASHINGTON, DC 20020-4914

PRISILLA S COLLINS-COLE
1432 BANGOR ST SE
WASHINGTON, DC 20020-4915

EDWARD P ALSTON
1412 BANGOR ST SE
WASHINGTON, DC 20020-4915

ADAM B BETHKE
1417 BANGOR ST SE
WASHINGTON, DC 20020-4914

JOHANNA POLSENBERG
1430 BANGOR ST SE
WASHINGTON, DC 20020-4915

KAREN E ESTES
1410 BANGOR ST SE
WASHINGTON, DC 20020-4915

BANGOR DEVELOPMENT COMPANY
817 9TH ST NW
WASHINGTON, DC 20001-4503

FREDERICK DOUGLASS HOUSING
9711 WASHINGTONIAN BLVD STE
GAITHERSBURG, MD 20878-7394

JAMES BRYANT
1721 HIGHWOOD PL SE
WASHINGTON, DC 20020-2350

THEODORE J JONES
2340 HIGH ST SE
WASHINGTON, DC 20020-4909

LASHON J BROWN
1414 HOWARD RD SE
WASHINGTON, DC 20020-4407

DERRICK C KIRBY
2334 HIGH ST SE
WASHINGTON, DC 20020-4909

DISTRICT OF COLUMBIA
1800 MARTIN LUTHER KING JR AVE
WASHINGTON, DC 20020-6900