

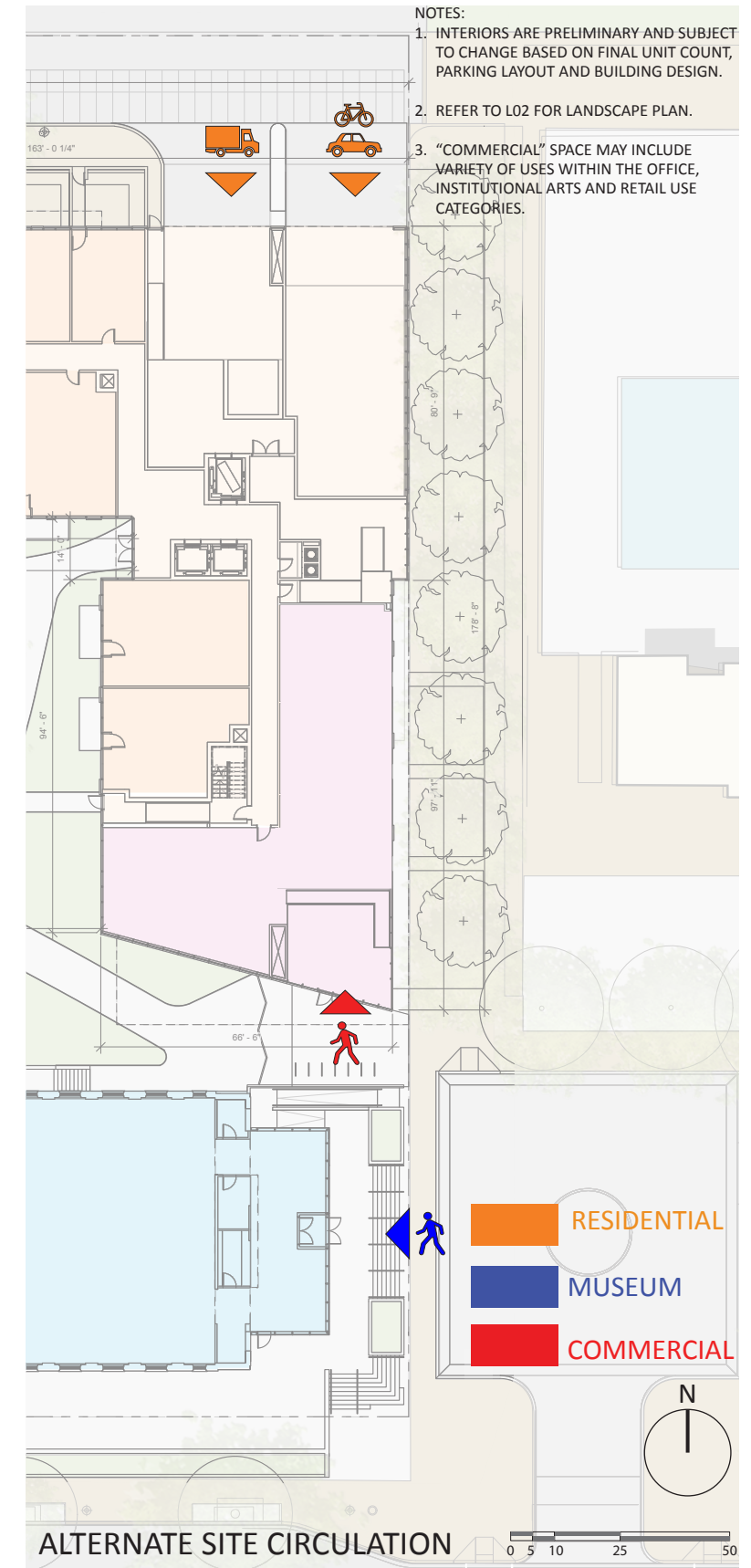

PROPOSED MODIFICATIONS (2016)

1. MORE REGULARIZED METAL PANEL AND GLASS PATTERN
2. LARGER, OCCUPIABLE BALCONIES ADDED VERSUS PREVIOUS JULIET BALCONIES ON THE UPPER FLOORS 7-12
3. MORE ARTICULATION OF MASSING BETWEEN THE FLOORS 1-6 AND FLOORS 7-12 TO BREAK DOWN THE MASSING
4. MORE GLASS ADDED AT THE PENTHOUSE AMENITY SPACES
5. RESIDENTIAL BUILDING FACADE SIMPLIFIED TO ACT AS BACKDROP TO AND TO HIGHLIGHT DETAILED HISTORIC RANDALL SCHOOL

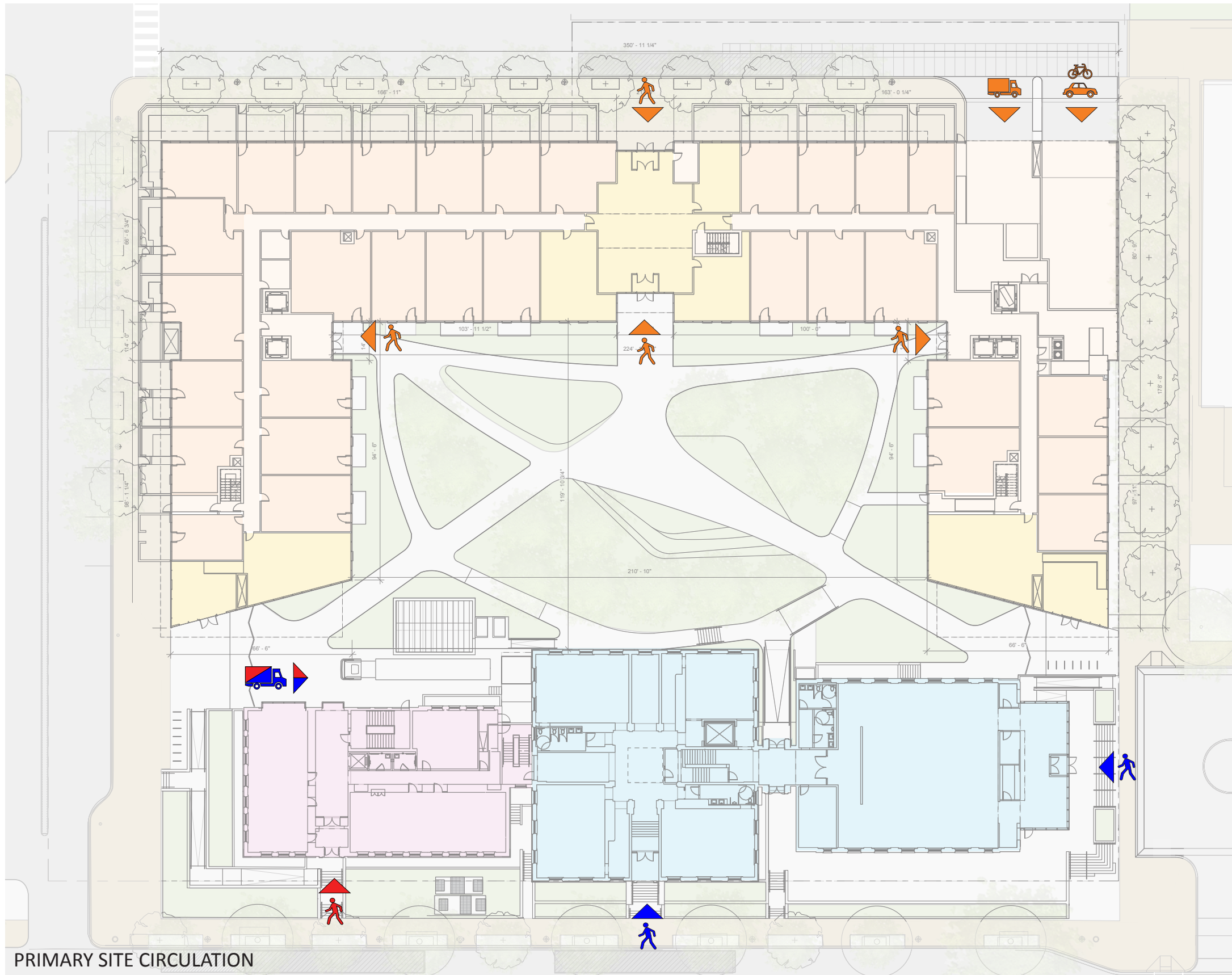

- NOTES:
1. INTERIORS ARE PRELIMINARY AND SUBJECT TO CHANGE BASED ON FINAL UNIT COUNT, PARKING LAYOUT AND BUILDING DESIGN.
 2. REFER TO L02 FOR LANDSCAPE PLAN.
 3. "COMMERCIAL" SPACE MAY INCLUDE VARIETY OF USES WITHIN THE OFFICE, INSTITUTIONAL ARTS AND RETAIL USE CATEGORIES.

SITE CIRCULATION DIAGRAM

RANDALL SCHOOL | PUD Modification

