

**Kingsbury Day School**

Address 5000 14th Street NW  
 Property Sq 2711 0802  
 Zone R-16  
 Lot Area (EST.) **172,822 sf**



**Allowable FAR  
 Area (unlimited)**

Zoning Req.	Dimension	Public Education Allowed/Required	Existing
	Building Height (ft)	60'-0"	36'-0"
	Building Height (st)	NA	3
	Lot Occupancy	60%	25,000/172,822 = 14 %
	Rear yard	25'-0"	55'-0"
	Side yard	8'-0"	74'-6"
	Front setback	consistent w/ others	79'-0"
	Penthouse	12'-0" *	NA
	FAR	0.9	0.49
	Green Area Ratio	NA	NA
	Min lot width	NA	315'-0"
	Min lot area	NA	172,822
	Pervious Surface	30%	61%

\* non-residential penthouse can be 18'-6"

Parking Required Parking Spaces .25 per 1,000 sf

Loading Required Loading Spaces 1 loading and 1 delivery for a 30,000 - 100,000 sf building

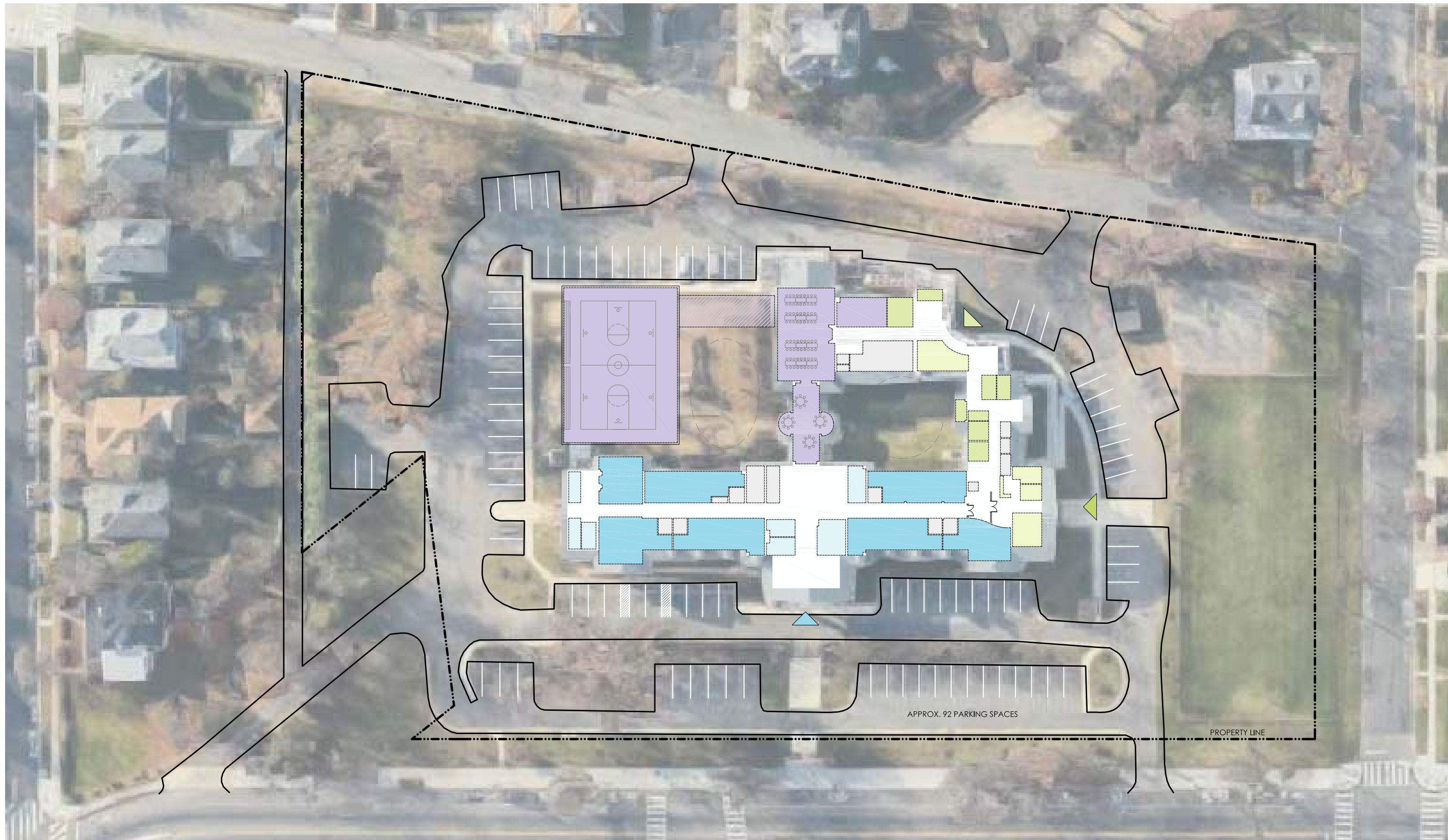

















<b>LAMB</b>	<b>KINGSBURY</b>	<b>CAMPUS</b>
Classrooms	Classrooms	Shared School Spaces
Specialized Classrooms	Special Ed Spaces	School Support Spaces
Admin Spaces	Admin Spaces	HOPE Program

FT 0 8 16 32

N



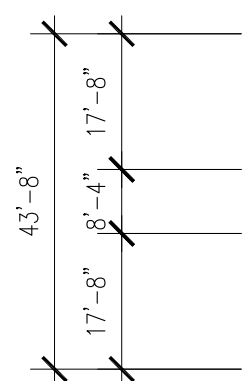
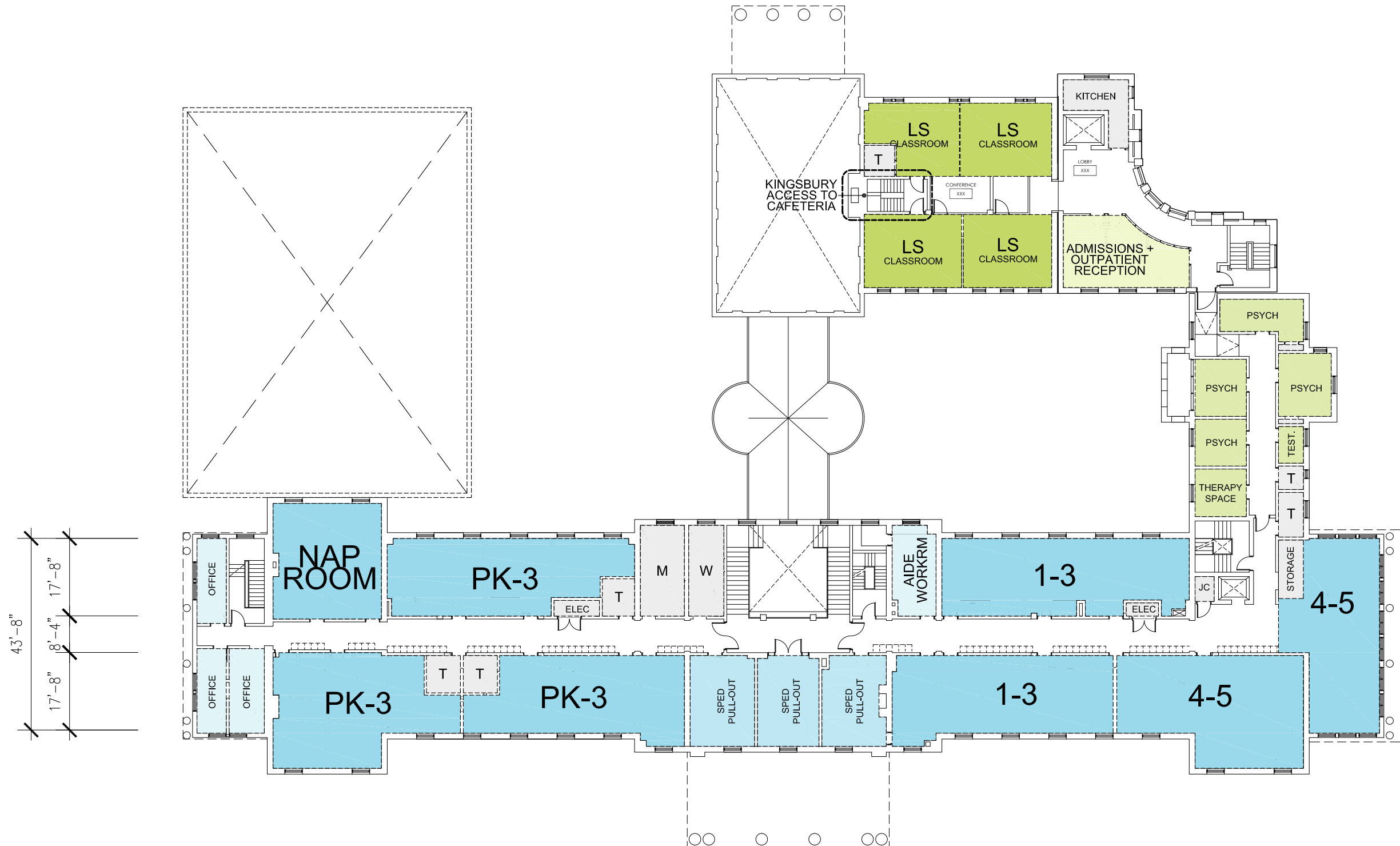

<b>LAMB</b>	<b>KINGSBURY</b>	<b>CAMPUS</b>
Classrooms	Classrooms	Shared School Spaces
Specialized Classrooms	Special Ed Spaces	School Support Spaces
Admin Spaces	Admin Spaces	HOPE Program

FT 0 8 16 32



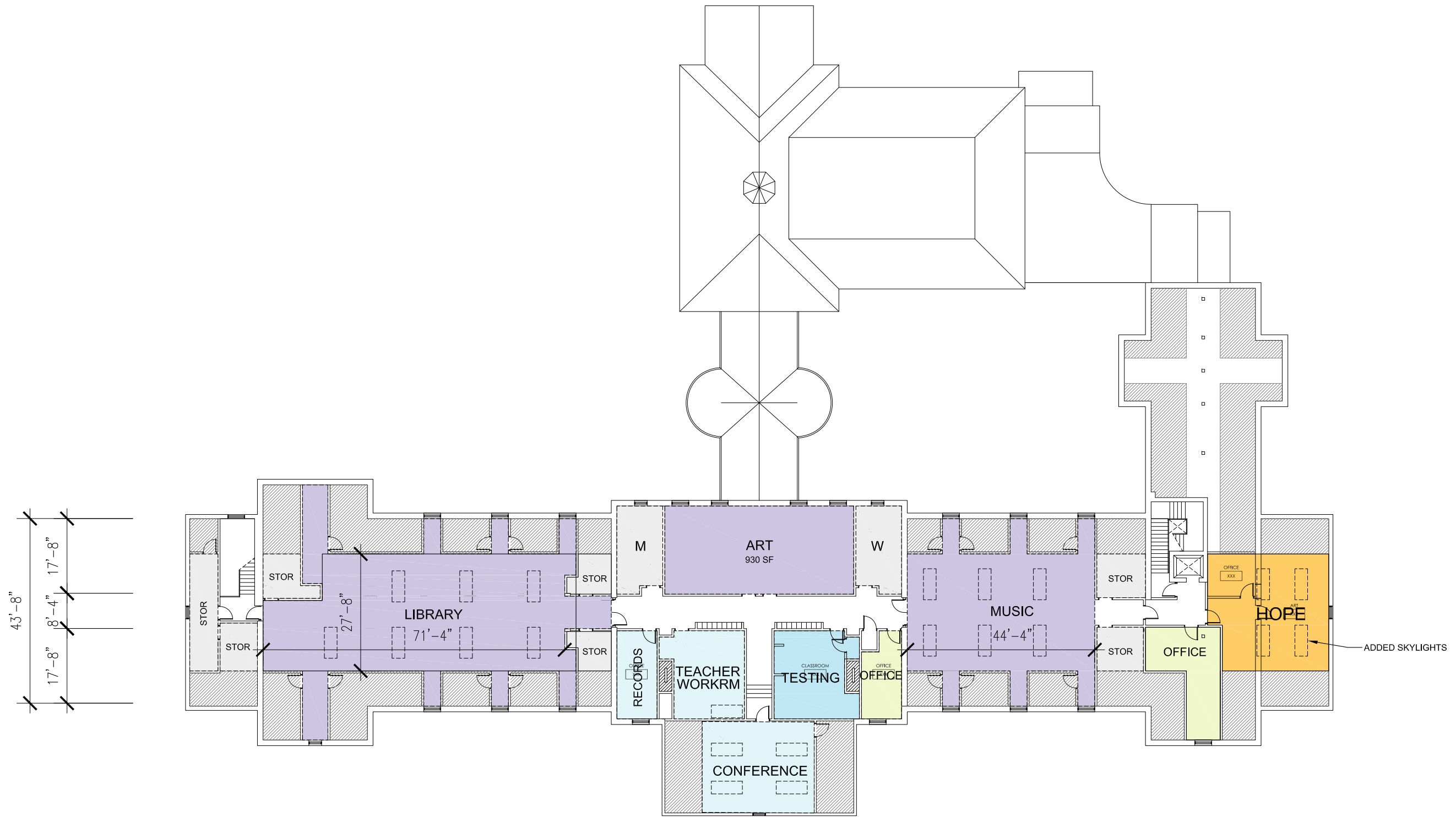

<b>LAMB</b>	<b>KINGSBURY</b>	<b>CAMPUS</b>
Classrooms	Classrooms	Shared School Spaces
Specialized Classrooms	Special Ed Spaces	School Support Spaces
Admin Spaces	Admin Spaces	HOPE Program

FT 0 8 16 32