

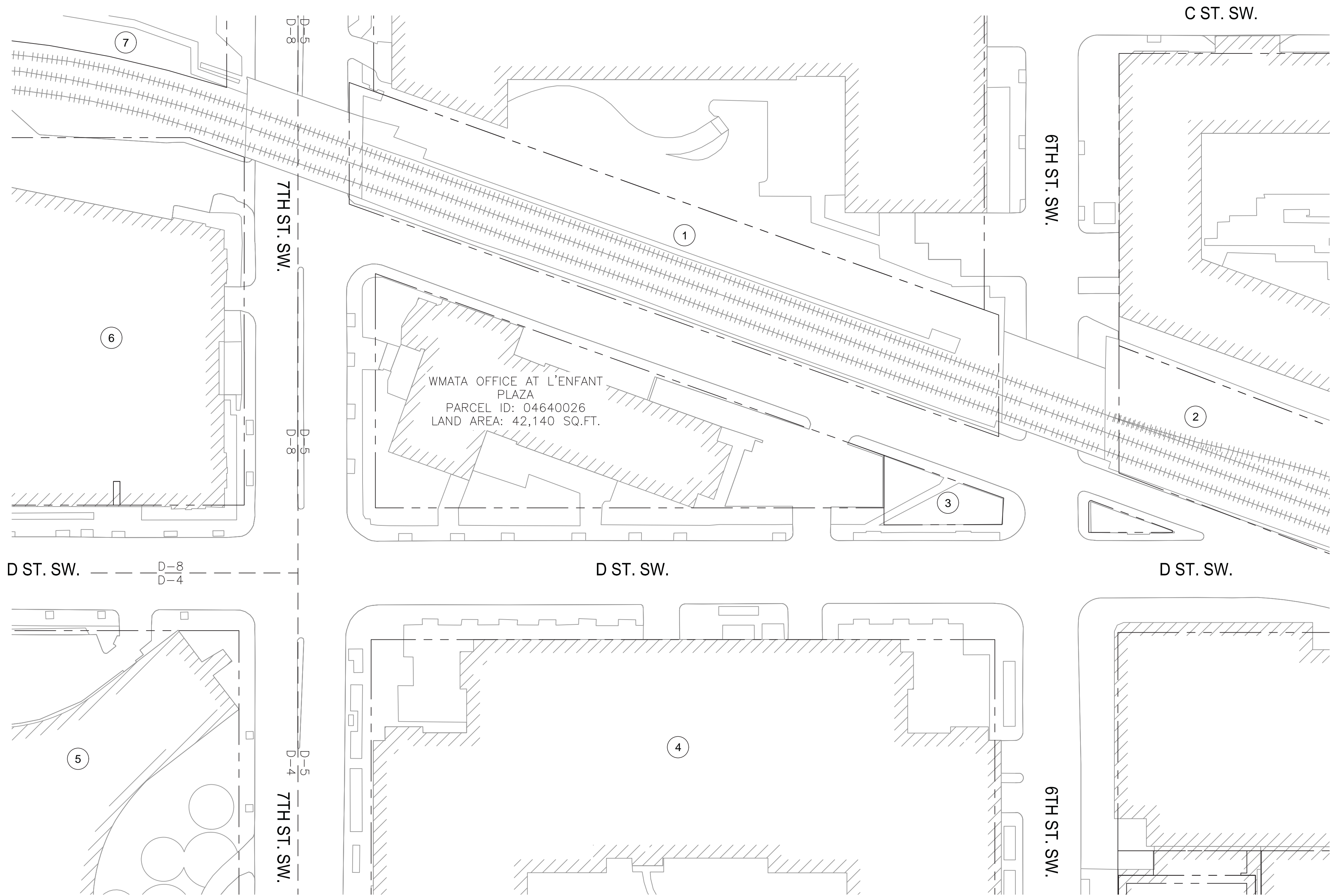

NOTE:
PARCEL INFORMATION TAKEN MUNICIPALITY GIS AND
REALESTATE SOURCES. PROPERTY LINES BASED ON
DC EXHIBIT DATED NOVEMBER 15TH, 2019 AND OFFSET
WITH GIS INFORMATION AS NEEDED.



SITE NOTES

1. APPLICANT/OWNER: WMATA
CONTACT: ALLEN WONDER
300 7TH STREET SW
WASHINGTON, DC 20024
2. SITE DATA:
PARCEL #.: 0464 0026
WATER DESIGNATION: CITY
SEWER DESIGNATION: CITY
ELECTION DISTRICT: 01
SITE AREA: 0.97 AC.
SITE ADDRESS: 300 7TH STREET SW
WASHINGTON, DC 20024
3. EXISTING USE: COMMERCIAL OFFICE BUILDING/TELECOMMUNICATION FACILITY
PROPOSED USE: COMMERCIAL OFFICE BUILDING/TELECOMMUNICATION FACILITY
4. ZONING OF SITE IS D-5 (DOWNTOWN)

- ① CONSOLIDATED RAIL CORPORATION
500 WATER ST.
JACKSONVILLE, FL 32202
TAX LOT: 0463S 0805
ZONING: D-5
0.91 AC
- ② CONSOLIDATED RAIL CORPORATION
500 WATER ST.
JACKSONVILLE, FL 32202
TAX LOT: 0493 0804
ZONING: D-5
1.15 AC
- ③ UNITED STATES OF AMERICA
NATIONAL PARKS
TAX LOT: RES 01150000
ZONING: D-4
0.09 AC
- ④ CC OWNER LLC.
600 13TH ST. NW STE. 700
WASHINGTON, DC 20005
TAX LOT: 0465 0096
ZONING: D-5
5.41 AC
- ⑤ UNITED STATES OF AMERICA
TAX LOT: 0435 0060
ZONING: D-4
0.55 AC
- ⑥ UNITED STATES OF AMERICA
TAX LOT: 0434 0812
ZONING: D-8
1.54 AC
- ⑦ WMATA
TAX LOT: RES 01130000
ZONING: D-8
2.82 AC



KCI
TECHNOLOGIES
KCI TECHNOLOGIES, INC.
11830 West Market Place, Suite F
Fulton, MD 20759
Phone: 410.792.8086



PARCEL - ZONING PLAN
SCALE: 1"=50'

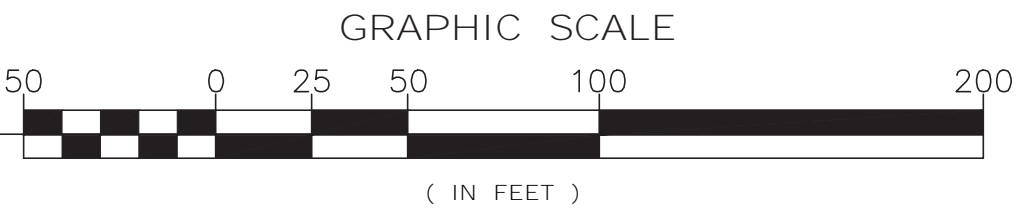

DESIGNED BY: JW 10/15/24 DATE DRAWN BY: JW 10/15/24 DATE CHECKED BY: GT 10/15/24 DATE APPROVED BY: GT 10/15/24 DATE	REFERENCE DRAWINGS		REVISIONS			<div><div><div><div>M</div><div>metro</div></div><div><div>WASHINGTON METROPOLITAN AREA TRANSIT AUTHORITY</div><div>DEPARTMENT OF COMMUNICATIONS AND SIGNALING</div></div><div><div>APPROVED JOHN C. HOFBAUER ENGINEER OF RECORD</div><div>DATE</div><div>APPROVED ALLEN WONDER PROJECT MANAGER</div><div>DATE</div></div></div></div>	WMATA 490MHz METRO RADIO EQUIPMENT RELOCATION L'ENFANT PLAZA 300 7TH STREET SW WASHINGTON, DC 20024				SHEET # C0001	
	NUMBER	TITLE	NO.	DATE	DESCRIPTION		SHEET TITLE OVERALL PARCEL PLAN					
			0	9/17/24	ZONING DRAWINGS SUBMISSION							
			1	11/20/24	ZONING DRAWINGS SUBMISSION							
			2	11/22/24	ZONING DRAWINGS SUBMISSION							
						M NO. FQ	CONTRACT NO. WMATA-LTR-22-001	SCALE: AS NOTED	KCI JOB NUMBER: 192400795B WMATA JOB NUMBER: WM700.AG.RF.09B.G0001	5 OF 35		