

Section 3

Proposed Site

& Planting Plans

Contents

Overall Site & Planting Plan

Planting Diagram

Plant List





Perimeter planting

Mix of evergreen trees and shrubs to screen tall retaining walls and to enhance the density of the vegetative buffer between the school property and residential neighbors

Social zone planting

Colorful mix of shrubs, groundcovers and grasses to create a welcoming environment

Parking zone

Canopy trees and groundcover

Social zone planting



Serviceberry
Amelanchier Arbora
“Autumn Brilliance”

Itea Virginicaa “Little
Henry”

Lavendar
Lavendula X
Intermedia
Grosso

Orange
Coneflower
Rudbeckia
Fulgida

Emerald Blue
Creeping Phlox
Phlox Subulata
‘Emerald Blue Thrift’

Pink Muhly
Muhlenbergia
Capilaris

Prairie Dropseed
Sporobulus
heterolepis

Northern Bayberry
Myrica Pensylvanica

Shenandoah Grass
Panicum Virgatum
‘Shenandoah’

Perimeter planting



Eastern Red Cedar
Juniperus Virginiana
‘Brodie’

Southern Magnolia
Magnolia Grandiflora

America Holly
Ilex Opaca

Blackgum
Nyssa Sylvatica ‘Green
Gables’

Distylium hybrid ‘Vintage Jade’

Japanese Plum Yew
Cephalotaxus Harringtonia
‘Yewtopia’

Parking lot planting

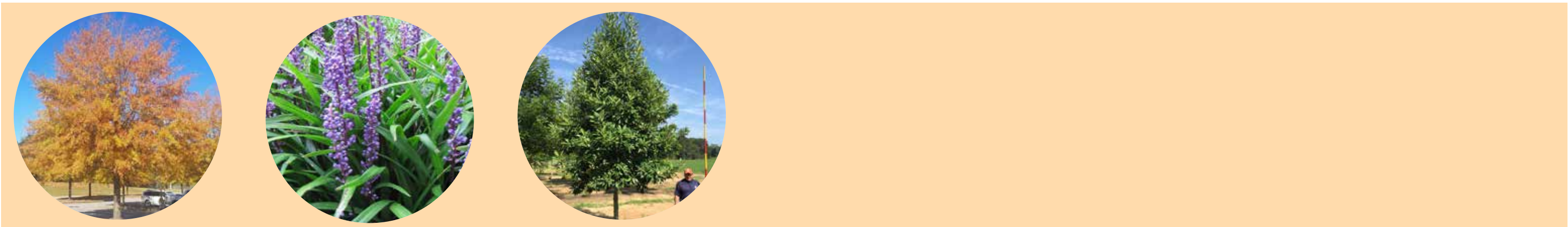

Willow Oak
Quercus Phellos
‘Hightower’

Big Blue Lilyturf
Liriope Muscari ‘Big Blue’

Sweetbay Magnolia
Magnolia Virginiana

Section 4

Field Orientation & Retaining Wall Studies - Summary

Contents

Field Orientation Studies - Summary

Athletic Field - Existing vs Proposed

Retaining Wall Studies - Summary

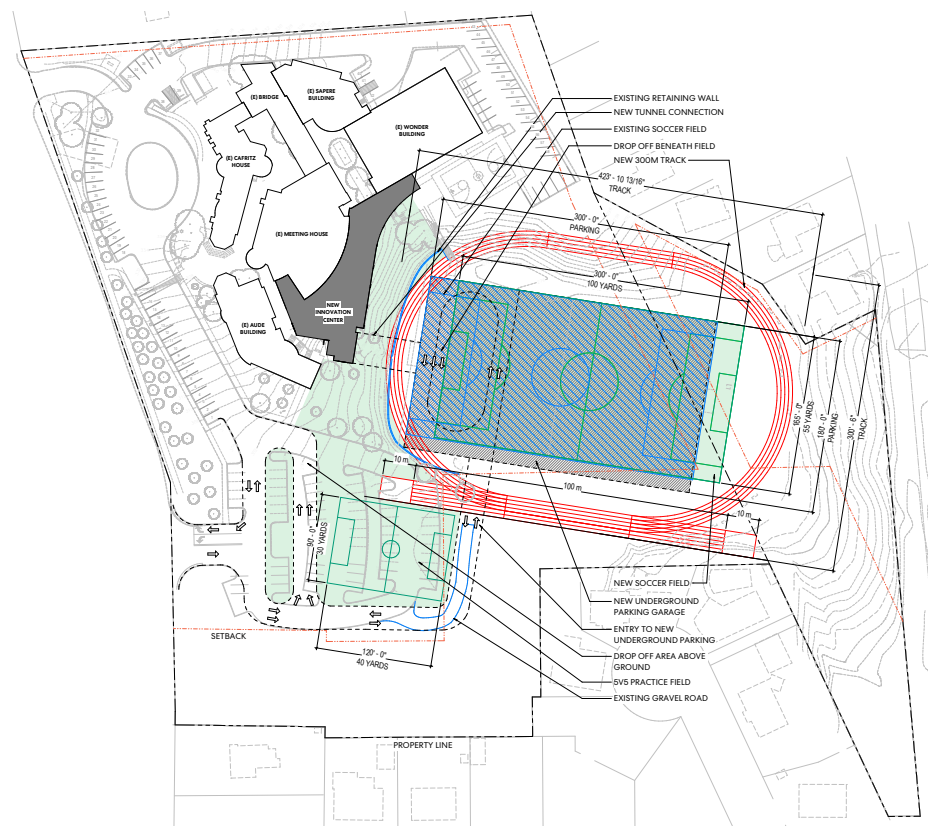

01 NEW SOCCER FIELD & 300M TRACK

FIELD ORIENTATION: ALIGNED WITH EXISTING ATHLETIC FIELD
FIELD SIZE: SAME AS EXISTING

CHALLENGES:

- PROXIMITY TO EXISTING PROPERTY LINES
- TALLER RETAINING WALLS REQUIRED
- OVERLAPS REQUIRED LOT SETBACKS
- NEGATIVELY IMPACTS HERITAGE TREES



02 NEW SOCCER FIELD & 4-LANE JOGGING TRACK

FIELD ORIENTATION: ROTATED -10° FROM EXISTING ATHLETIC FIELD
FIELD SIZE: SAME AS EXISTING FIELD

CHALLENGES:

- TALLER RETAINING WALLS REQUIRED
- NEGATIVELY IMPACTS HERITAGE TREES

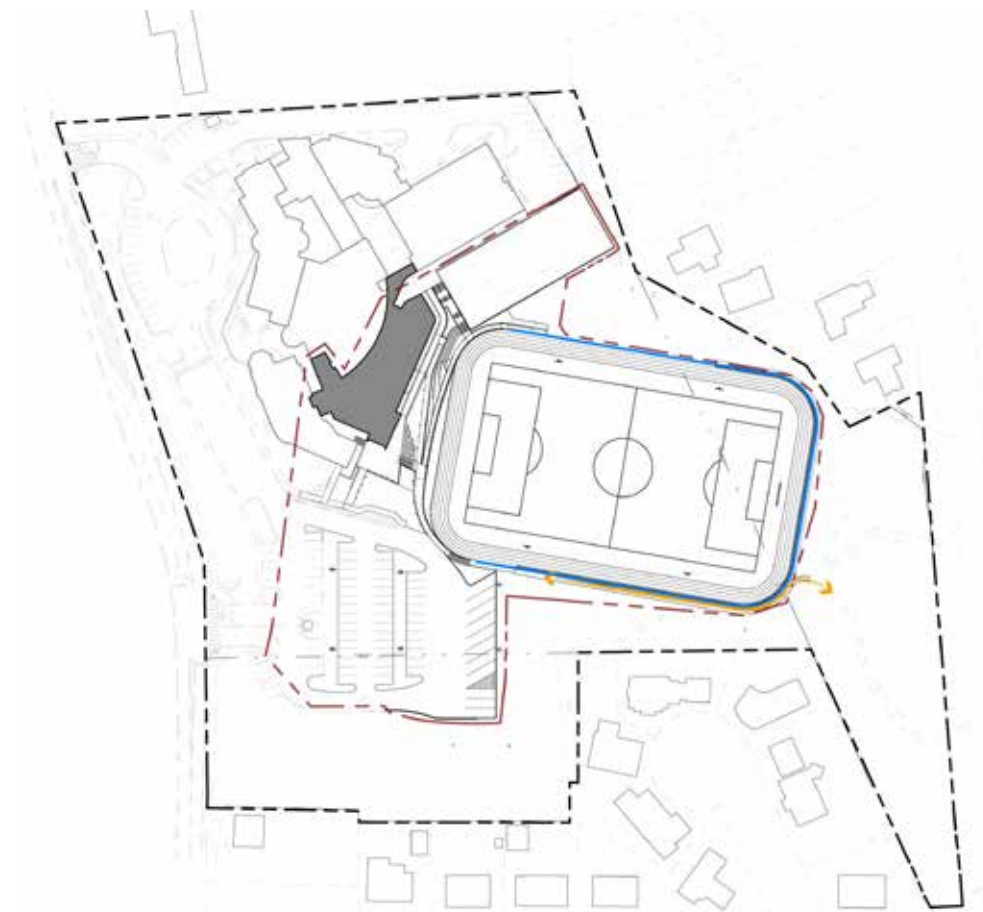

03 PROPOSED SOCCER FIELD & 4-LANE JOGGING TRACK

FIELD ORIENTATION: ALIGNED WITH EXISTING ATHLETIC FIELD
FIELD SIZE: SAME AS EXISTING FIELD

- REQUIRES ZONING RELIEF TO ACCOMMODATE RETAINING WALL.
- SHORTER RETAINING WALLS
- MAXIMIZES EXSITING LANDSCAPE BUFFER & HERITAGE TREES.

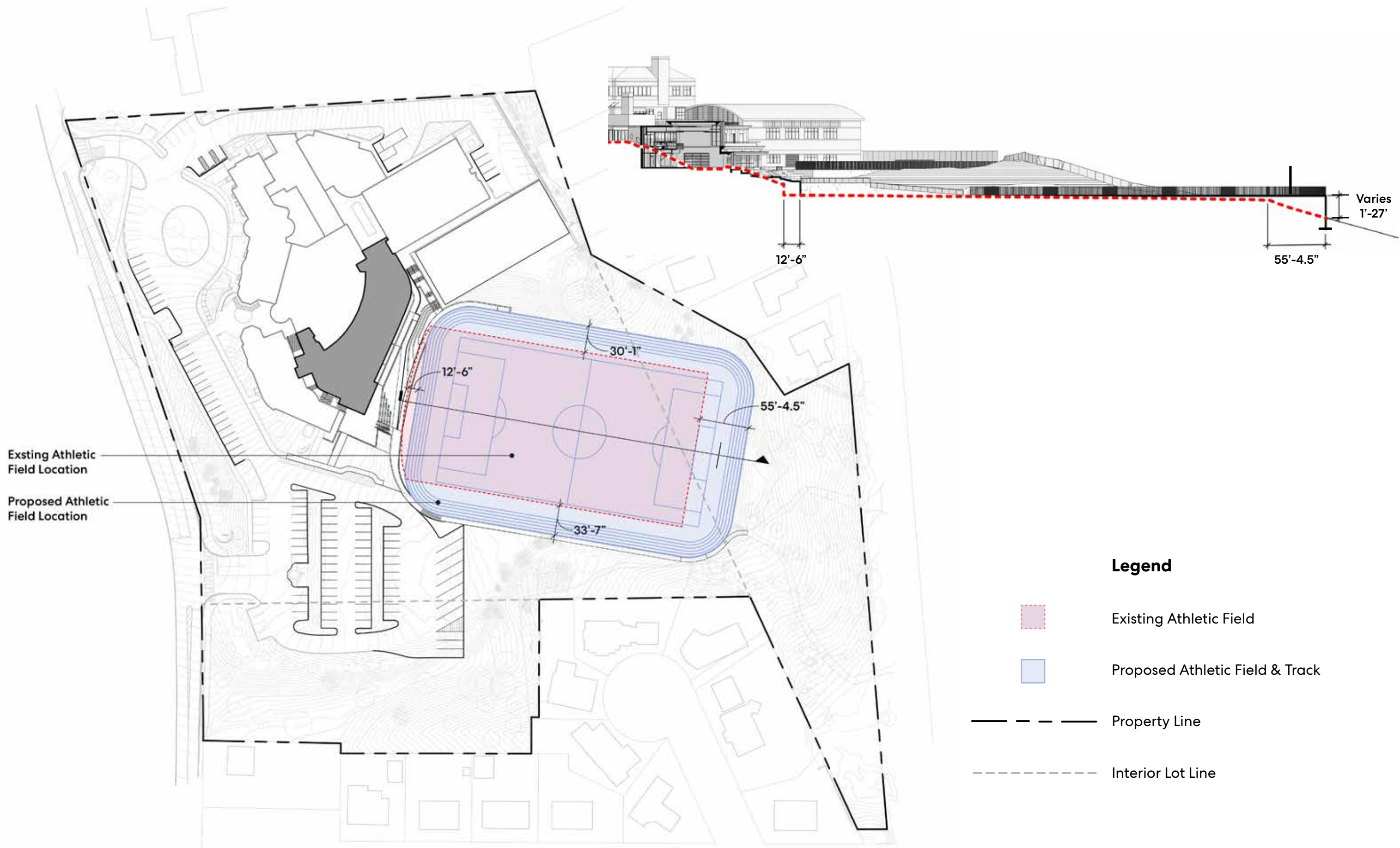

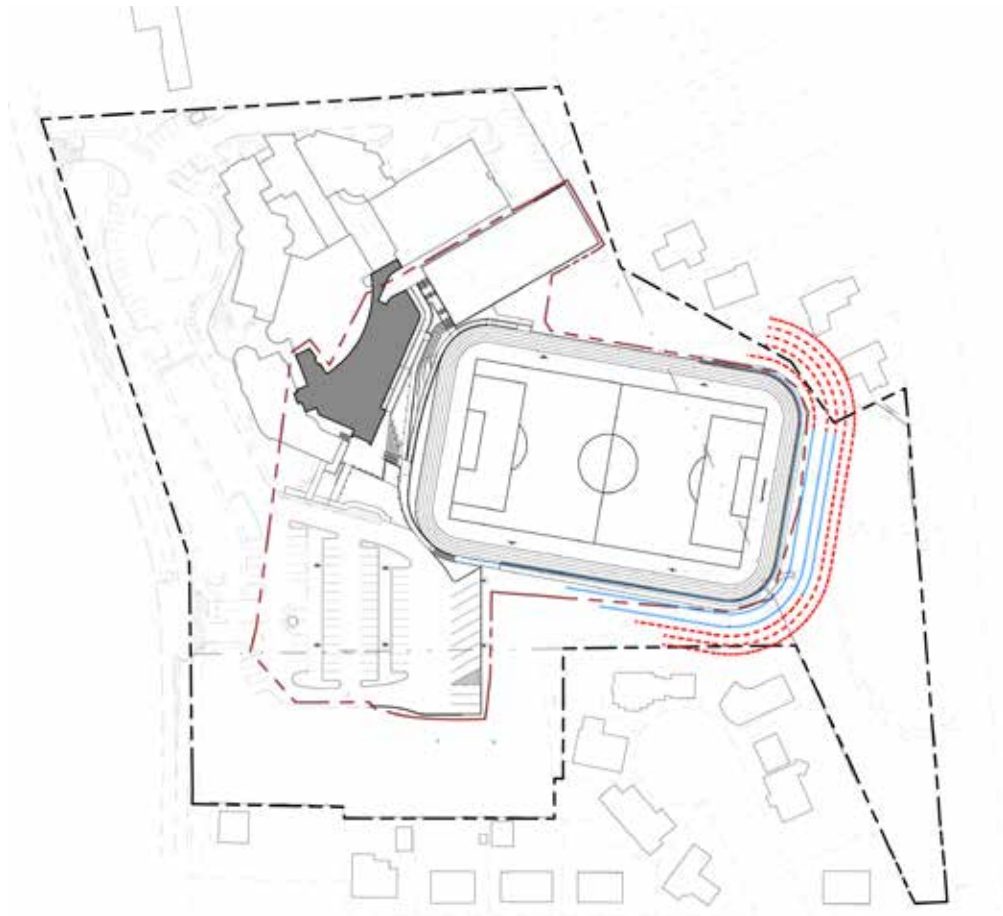

01 TERRACED RETAINING WALLS

SERIES OF TERRACED RETAINING WALL AT 6 FT and 4 FT MAX HEIGHT DIFFERENCE

UNFEASIBLE DUE TO SITE CONSTRAINTS, EXISTING PROPERTY LINE LOCATIONS, AND HERITAGE TREES

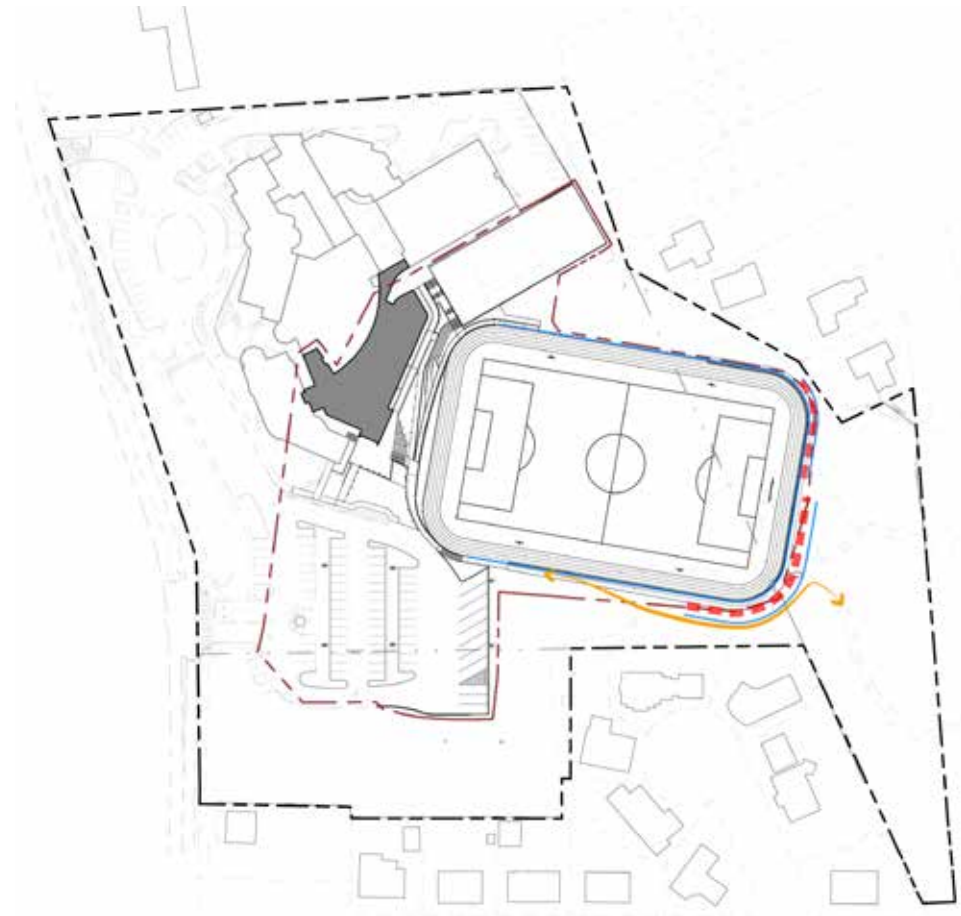

02 TWO-TIER RETAINING WALL

ONE RETAINING WALL FIELD LEVEL (+277.5)

REQUIRES ZONING RELIEF TO ACCOMMODATE TALL WALL.

IMPACTS EXSITING LANDSCAPE BUFFER & HERITAGE TREES.

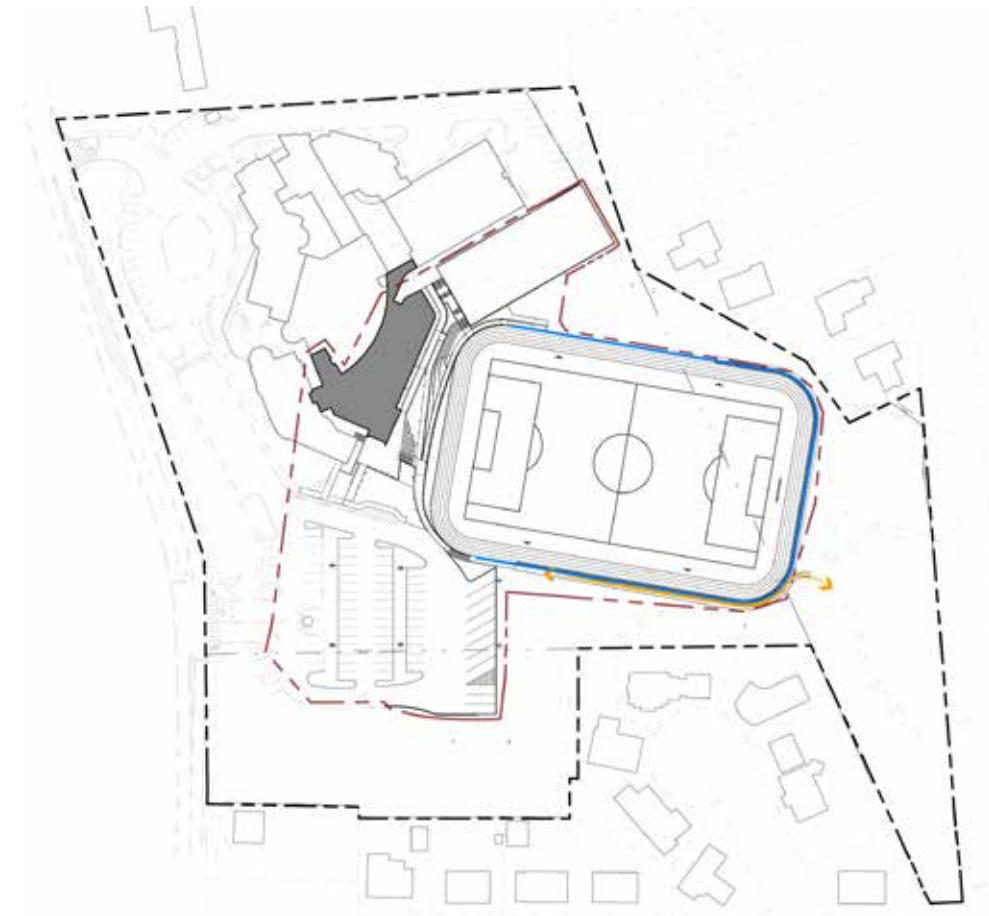

03 SINGLE RETAINING WALL

ONE RETAINING WALL FIELD LEVEL (+277.5)

REQUIRES ZONING RELIEF TO ACCOMMODATE TALL WALL.

MAXIMIZES EXSITING LANDSCAPE BUFFER

Retaining Wall Study 1

Contents

Retaining Wall Plan Studies

DESIGN STUDY - SERIES OF TERRACED RETAINING WALL AT 6 FT and 4 FT MAX HEIGHT DIFFERENCE

- Zoning code interpretation
- Lowest terraced wall 8 ft off the south property line is and is 11 ft above natural grade
 - The lowest terraced wall on north property side is approx 20 ft above natural grade

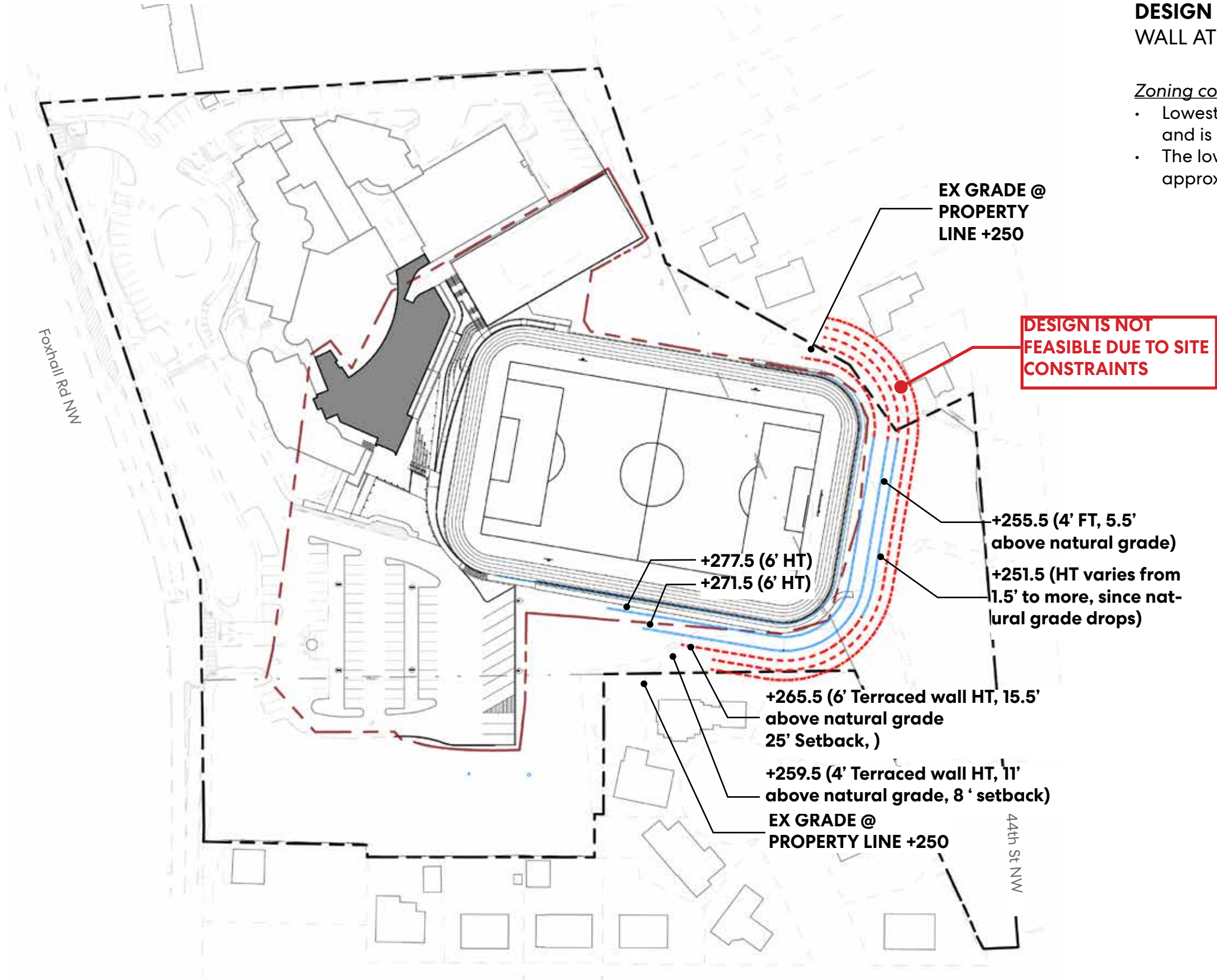

Legend

- Proposed Retaining Wall
- Wall height/location varies from code
- Limit of Disturbance
- Property Line

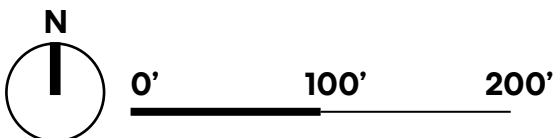

DESIGN STUDY - SERIES OF TERRACED RETAINING WALL AT 6 FT and 4 FT MAX HEIGHT DIFFERENCE

- Impact on several special trees and one heritage tree

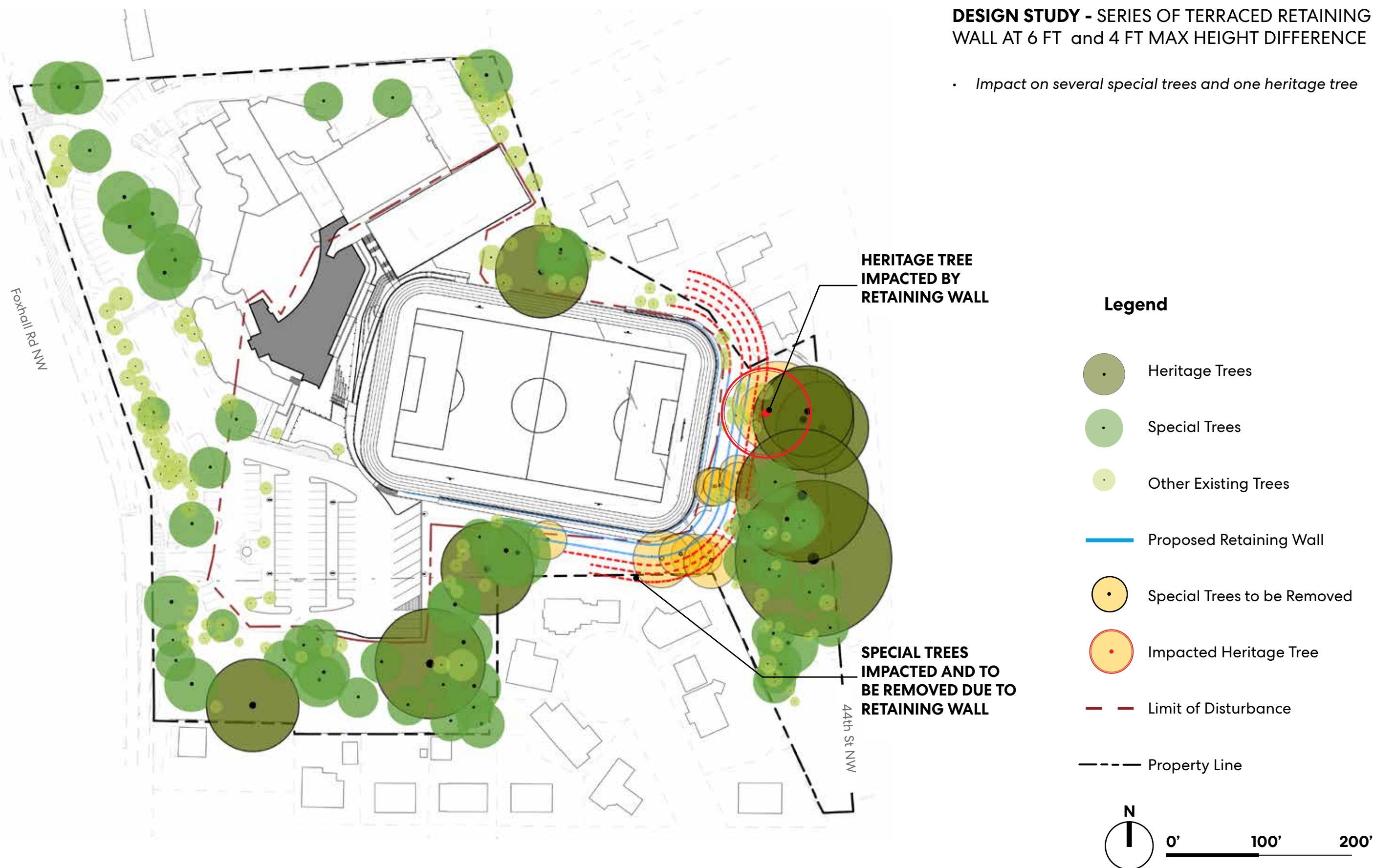

Retaining Wall Study 2

Contents

Retaining Wall Plan Studies

Retaining Wall Views & Sections

DESIGN STUDY - TWO TIERED RETAINING WALL

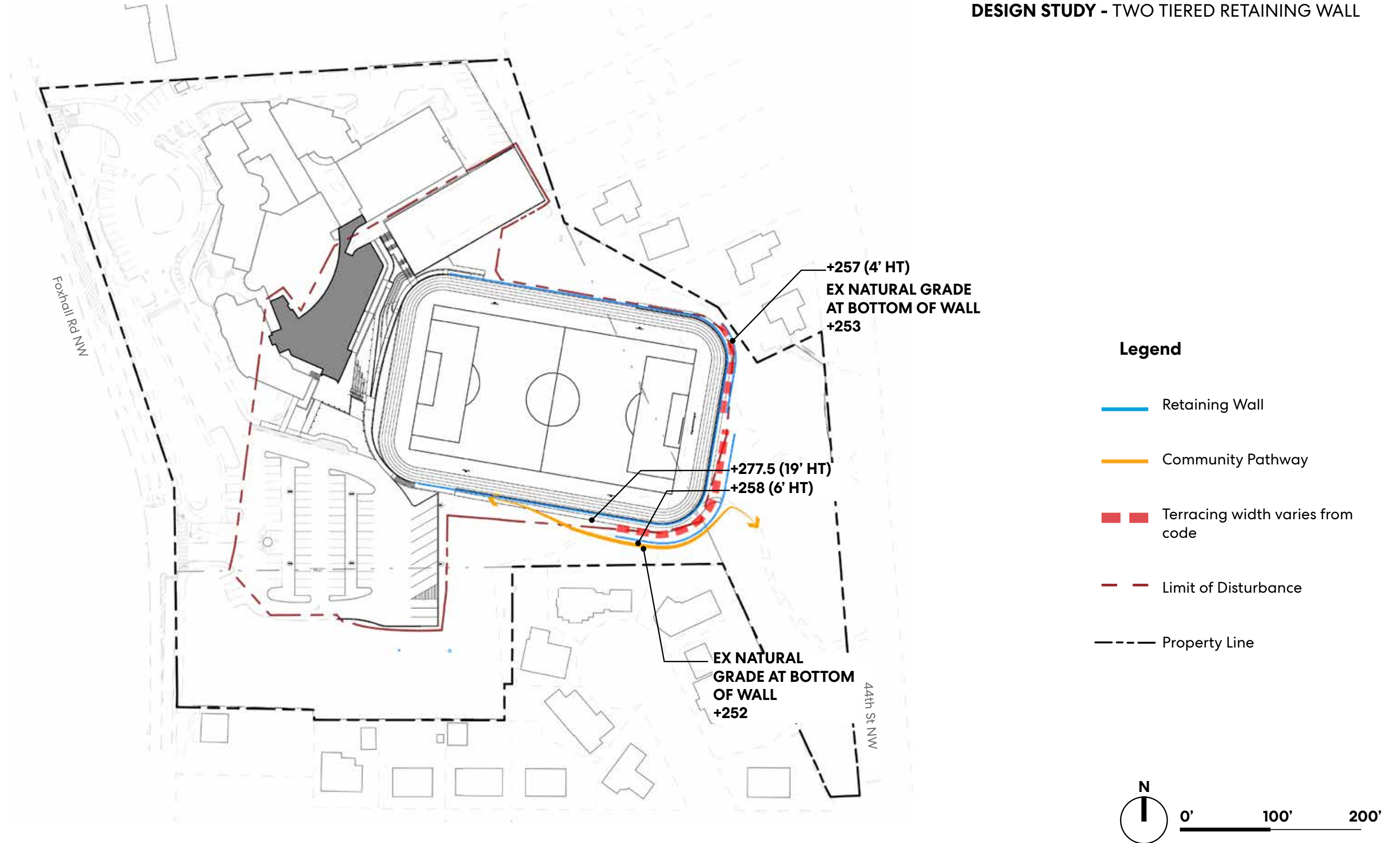

DESIGN STUDY - TWO TIERED RETAINING WALL

- Impact on existing special trees



DESIGN STUDY - TWO TIERED RETAINING WALL

- Planting opportunity around available buffer space and setback to the north and south
- Slight realignment of the existing community pathway connection



Legend

- Proposed Trees
- Heritage Trees
- Special Trees
- Other Existing Trees
- Retaining Wall
- Community Pathway
- Limit of Disturbance
- Property Line

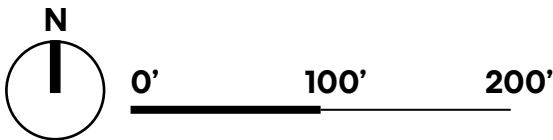



1. View for south neighbors



2. View for north neighbors

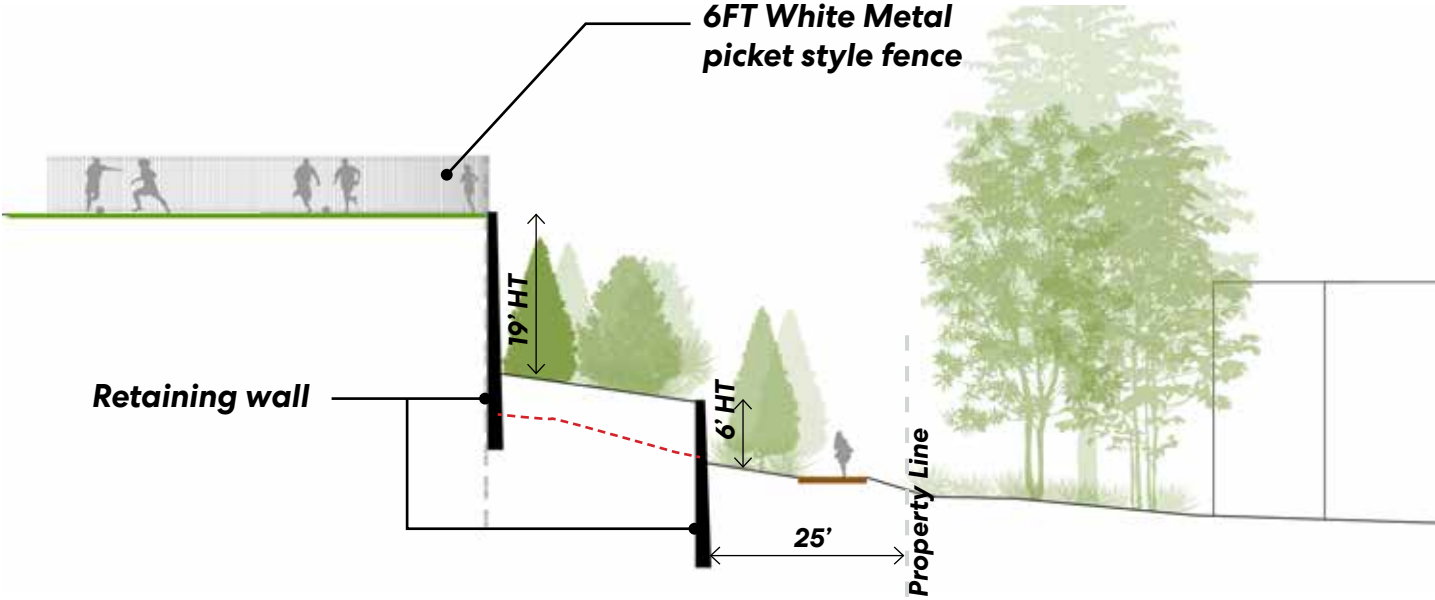

3. Retaining wall south section

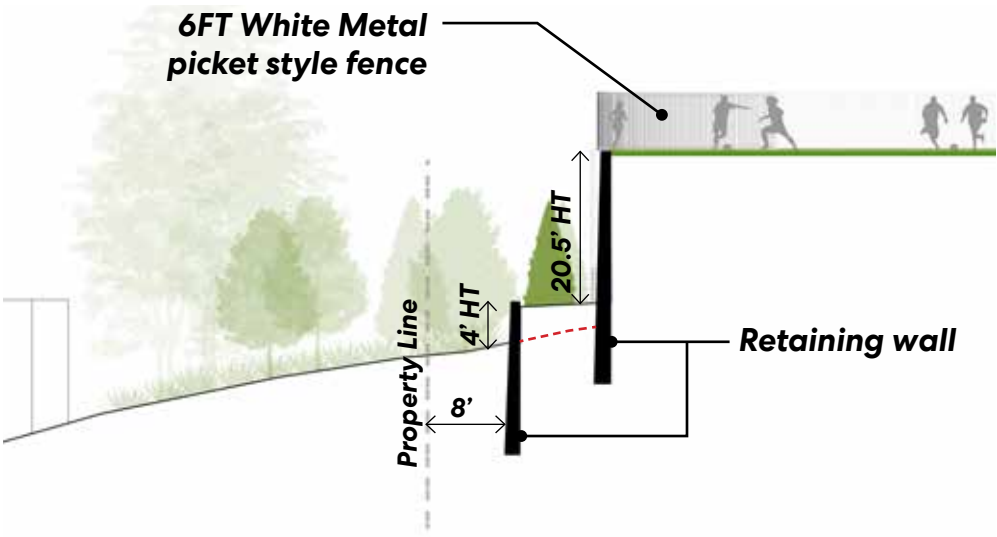

4. Retaining wall north section

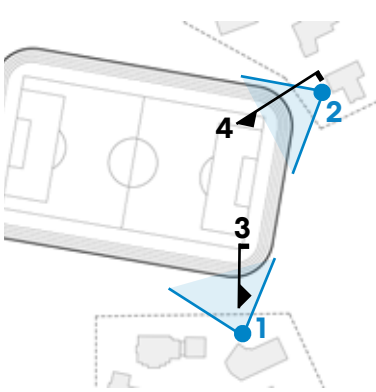

Key Plan

Retaining Wall Study 3

Contents

Retaining Wall Plan Studies

Retaining Wall Views & Sections

DESIGN STUDY - ONE RETAINING WALL FIELD LEVEL (+277.5)

Zoning code interpretation

- Max wall height of 27 ft from top of wall to lowest grade is above what is allowed by code
- Maintains planting buffer for the south and north properties

Legend

- Proposed Retaining Wall
- Community Pathway
- Limit of Disturbance
- Property Line

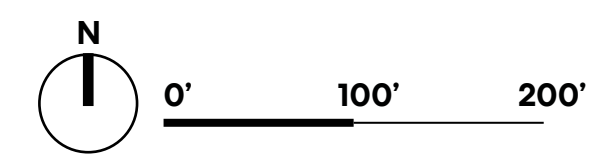

RETAINING WALL STUDY - PLAN

DESIGN STUDY - ONE RETAINING WALL FIELD LEVEL (+277.5)

- Impact on several existing special and small trees, to be replaced with new plantings.
- Reduced impact to several special trees.

SPECIAL TREES IMPACTED AND TO BE REMOVED DUE TO RETAINING WALL

Legend

- Heritage Trees
- Special Trees
- Other Existing Trees
- Proposed Retaining Wall
- Wall height/location varies from code or encroaches into heritage trees
- Special Trees to be Removed
- Limit of Disturbance
- Property Line



**DESIGN STUDY - ONE RETAINING WALL FIELD
LEVEL (+277.5)**

- *Planting opportunity around available buffer space and setback to the north and south*
- *Slight realignment of the existing community pathway connection*



Legend

-  Proposed Trees
-  Heritage Trees
-  Special Trees
-  Other Existing Trees
-  Retaining Wall
-  Community Pathway
-  Limit of Disturbance
-  Property Line

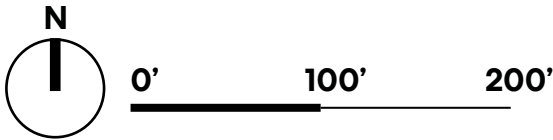



Existing Tree Plan



Proposed Tree Plan

DESIGN STUDY - ONE RETAINING WALL FIELD LEVEL (+277.5)

- *Proposed planting plan provides a denser vegetative buffer than the existing condition.*

Legend





1. View for south neighbors



2. View for north neighbors

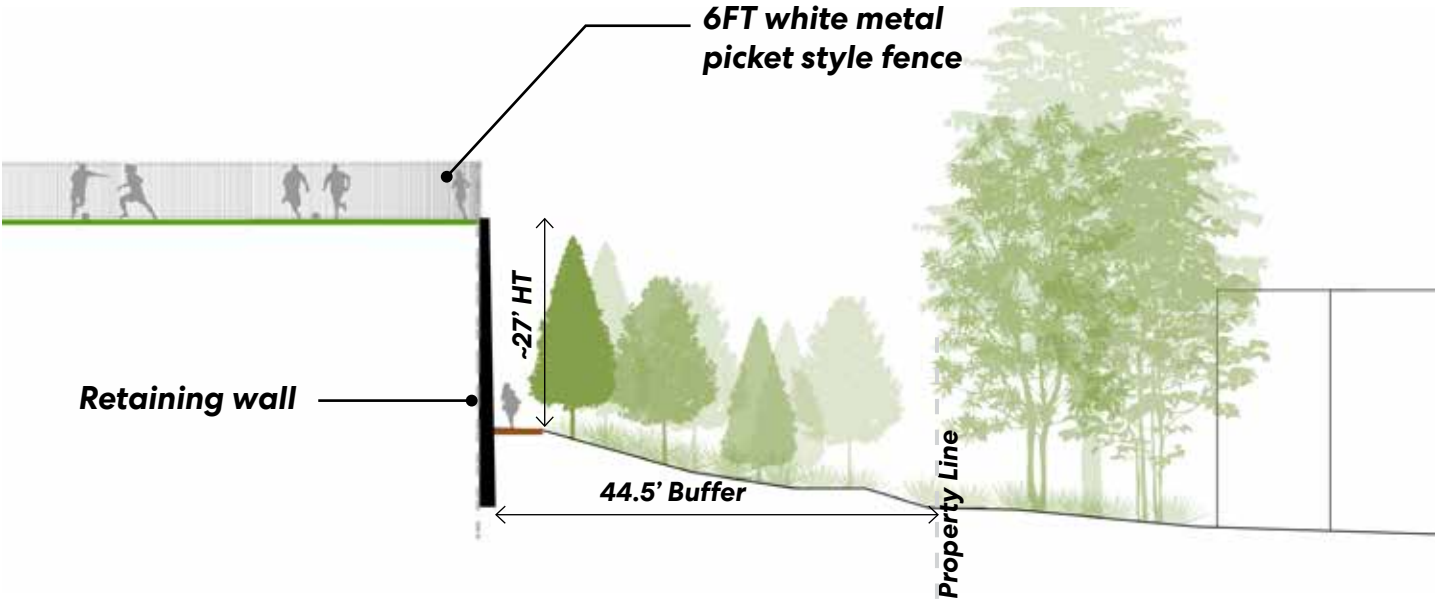

3. Retaining wall south section

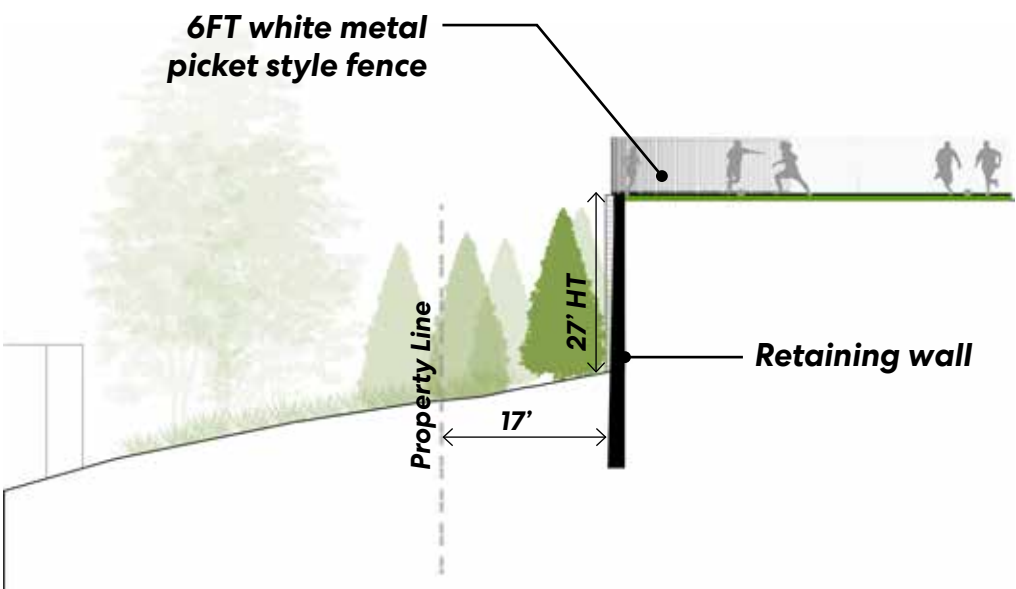

4. Retaining wall north section

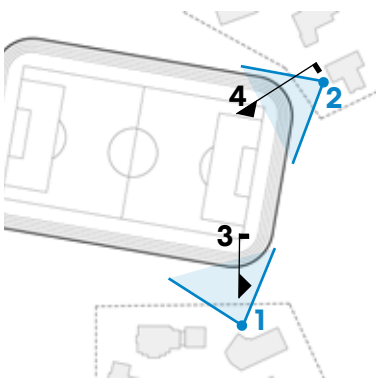

Key Plan



Two-Tiered Retaining Wall Study - View for south neighbors



Two-Tiered Retaining Wall Study - View for north neighbors



One Retaining Wall Study - View for south neighbors



One Retaining Wall Study - View for north neighbors



Ridgerock - Plus



Versalok - Mosaic

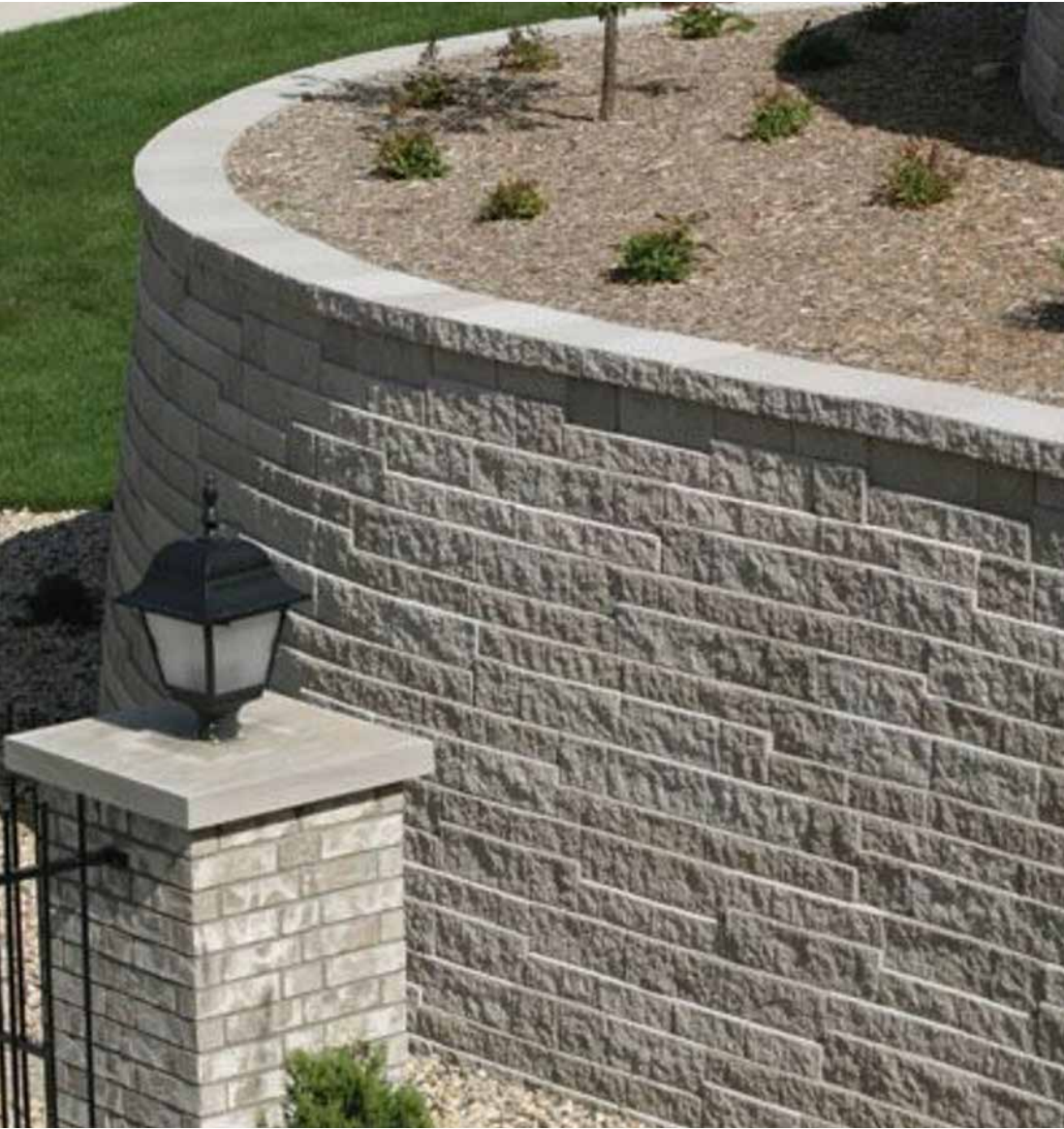

Versalok - Mosaic



Ridgerock - Messina



9



10. EXISTING COMMUNITY PATHWAY



11. EXISTING COMMUNITY PATHWAY



12. EXISTING COMMUNITY PATHWAY - STAIRS TO FIELD



Section 5

Field Lighting

Contents

Proposed Field Lighting Plan

Proposed Field Lighting Plan - Light Levels

Proposed Field Lighting Plan - Light Spill



60'H Light Pole,
Typical of 4

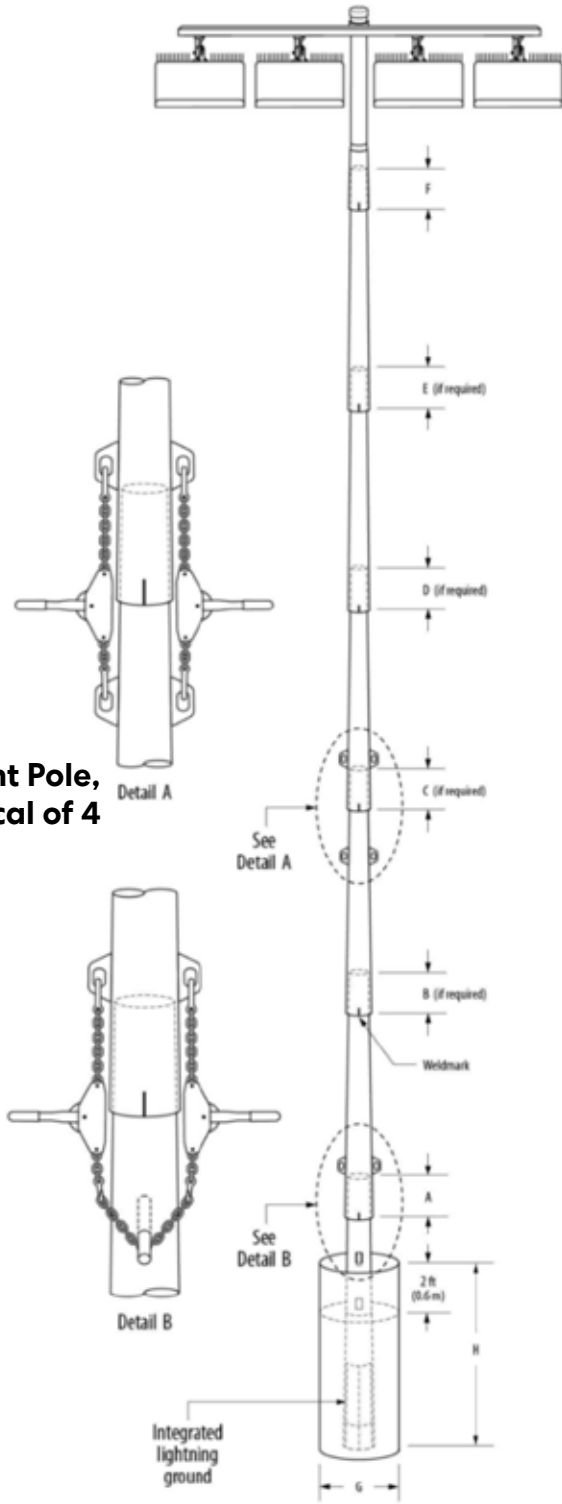

R00-62-00-en04

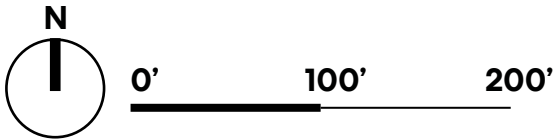

Equipment List For Areas Shown								
Pole				Luminaires				
QTY	LOCATION	SIZE	GRADE ELEVATION	ABOVE GRADE LEVEL	LUMINAIRE TYPE	QTY/POLE	THIS GRID	OTHER GRIDS
4	S1-S4	60"	-	60"	TLC-LED-1200	5	5	0
				60"	TLC-LED-900	1	1	0
4	Totals					24	24	0

*Above Grade level relative to the field

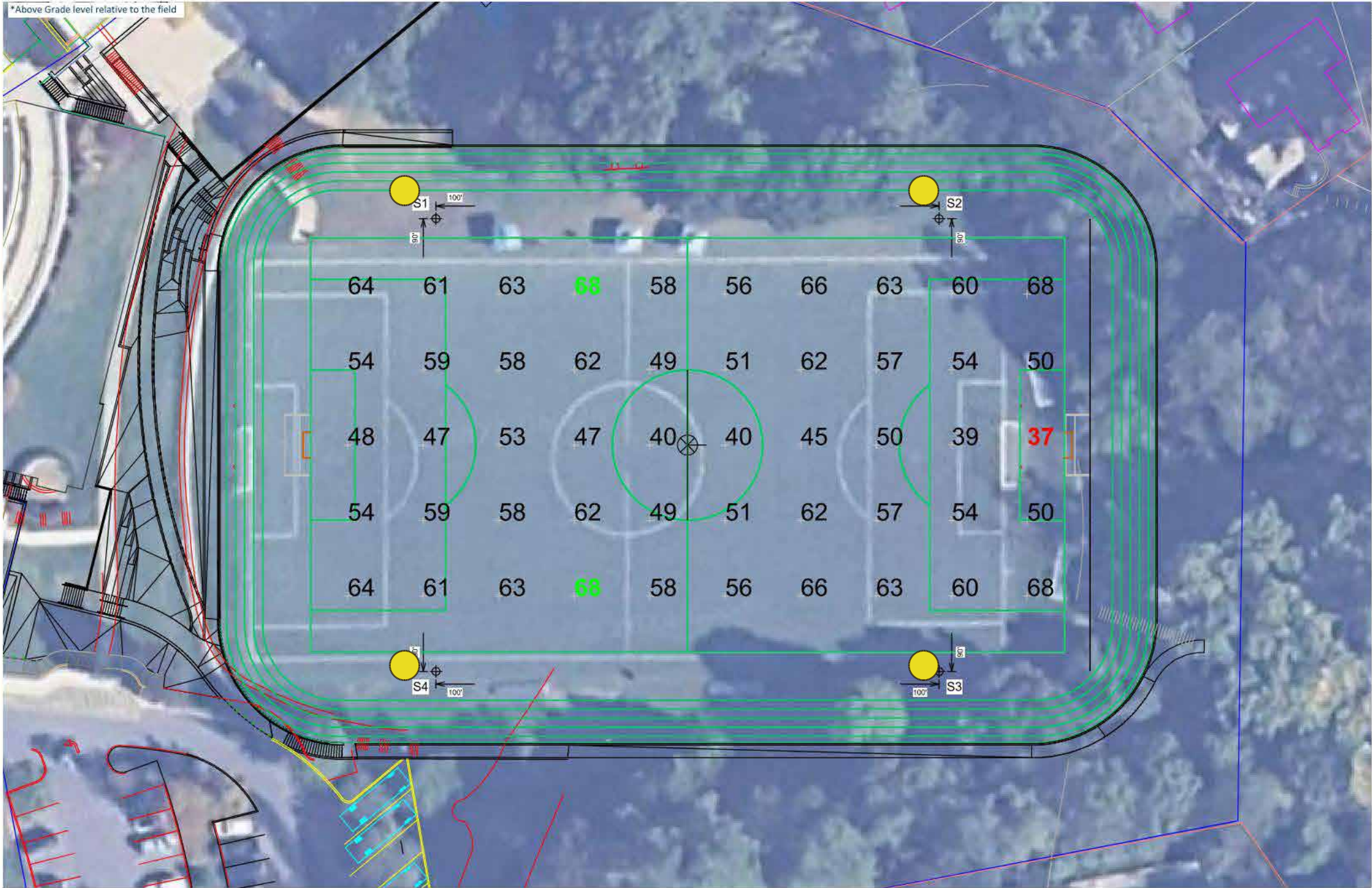

SCALE IN FEET 1 : 40
 0' 40' 80'
 ENGINEERED DESIGN By: Z.Morris • File #239037B • 09-Sep-24

Pole location(s) ⊕ dimensions are relative to 0,0 reference point(s) ⊗

Field School Lacrosse Soccer	
Washington, DC	
Grid Summary	
Name	Soccer
Size	300' x 165'
Spacing	30.0' x 30.0'
Height	3.0' above grade
Illumination Summary	
MAINTAINED HORIZONTAL FOOTCANDLES	
	Entire Grid
Guaranteed Average	50
Scan Average	56.19
Maximum	68
Minimum	37
Avg/Min	1.51
Guaranteed Max/Min	2
Max/Min	1.83
UG (adjacent pts)	1.39
CU	0.73
No. of Points	50
LUMINAIRE INFORMATION	
Applied Circuits	A
No. of Luminaires	24
Total Load	26.92 kW

Guaranteed Performance: The ILLUMINATION described above is guaranteed per your Musco Warranty document and includes a 0.95 dirt depreciation factor.

Field Measurements: Individual field measurements may vary from computer-calculated predictions and should be taken in accordance with IESNA RP-6-15.

Electrical System Requirements: Refer to Amperage Draw Chart and/or the "Musco Control System Summary" for electrical sizing.

Installation Requirements: Results assume ± 3% nominal voltage at line side of the driver and structures located within 3 feet (1m) of design locations.



We Make It Happen.

Not to be reproduced in whole or part without the written consent of Musco Sports Lighting, LLC. ©1981, 2023 Musco Sports Lighting, LLC.

ILLUMINATION SUMMARY

