

GENERAL NOTES

1. ALL CIVIL ELEMENTS ARE FOR REFERENCE ONLY, SEE CIVIL DRAWINGS FOR INFORMATION.
2. TOTAL NUMBER OF AVAILABLE PARKING SPACES 231. 175 PARKING SPACES ARE DEDICATED TO COMPACT CARS.
3. REFER TO G-005 FOR SYSTEM NOMENCLATURE.
4. REFER TO A-200-0 SERIES SHEETS FOR ENLARGED PLANS AND REFLECTED CEILING PLANS.
5. REFER TO A-300-0 SERIES SHEETS FOR ELEVATIONS & SECTIONS.
6. REFER TO A-400-0 SERIES SHEETS FOR ENLARGED PLANS, DETAILS AND INTERIOR ELEVATIONS.
7. REFER TO A-500-0 SERIES SHEETS FOR DETAILS AND PARTITION TYPES.
8. REFER TO A-600-0 SERIES SHEETS FOR FINISH SCHEDULES AND PLANS.
9. REFER TO A-700-0 SERIES SHEETS FOR FURNITURE SCHEDULES AND PLANS.
10. REFER TO CIVIL DRAWINGS FOR ALL GRADE LEVELS AND APRONS.
11. COORDINATE UNDER SLAB UTILITIES AND EQUIPMENT WITH ALL DISCIPLINES.
12. SLOPE GRADE AWAY FROM BUILDING.

KEYNOTES

- 1 48'-0" UNIT OF DRAINAGE PLATE. ELEVATIONS INDICATING CORNER POINTS OF EACH PLATE
- 2 PARKING CURB
- 3 GREEN AREA
- 4 BOLLARDS 3'-6" O.C. REFER TO 5/A-907-0
- 5 READY RESERVE OUTLINE BELOW, SEE A-101-R
- 6 VEHICLE BARRIER SYSTEM, REFER TO A-511-0 FOR DETAILS
- 7 LIGHT FIXTURES, REFER TO ELECTRICAL DRAWINGS
- 8 GUARD BOOTH BELOW, REFER TO A-901-0
- 9 42" SW-4 FENCE SECURING FEMS PARKING ZONE, SEE 3/A-907-0
- 10 VEHICLE ARM GATE FOR FEMS PARKING ZONE. BOD DOORING
- 11 FEMS POST MOUNTED SIGNAGE, REFER TO A-408-0
- 12 OVERHEAD GATE STRUCTURE, REFER TO 2/A-905-0
- 13 FREE EXIT VEHICLE LOOP, REFER TO ELECTRICAL DRAWINGS
- 14 POST MOUNT SECURITY CAMERA, REFER TO ELECTRICAL DRAWINGS
- 15 CONCRETE PAVING ON STRUCTURAL FILL
- 16 SHADED AREA INDICATES TOPPING CONCRETE TO FEATHER SLOPE TO DRAIN

KEYPLAN

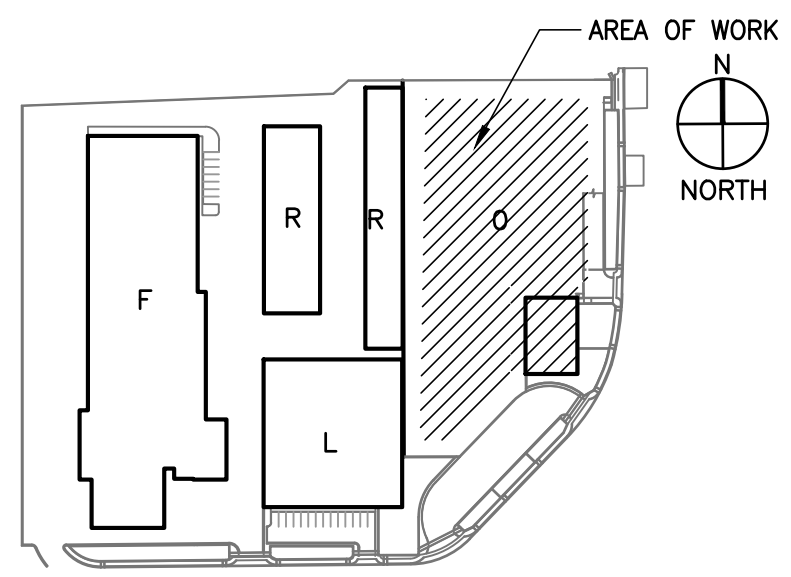

#	Date	Change Description

DGS BUILD MAINTAIN SUSTAIN

FEMS FLEET MAINTENANCE FACILITY

BLUE PLAINS - D.C. VILLAGE LANE SW, WASHINGTON D.C. 20032

FOR THE GOVERNMENT OF THE DISTRICT OF COLUMBIA

ALPHATEC PC

ENGINEERS ARCHITECTS PLANNERS

1625 18TH STREET N.W. WASHINGTON, D.C. 20036 TEL: 202/797-9000 FAX: 202/797-9003

SUB-CONSULTANT:	SEAL:
Dwg. Coord:	Tech. Coord:
Project NO:	SEE PLOT STAMP
OSSE FACILITY & PARKING STRUCTURE - SECOND FLOOR	A-102-0
PERMIT SUBMISSION	10/12/2023