

4

3

2

1

AIR CLEANER DATA:

CABINET 16 GA STEEL WELDED
VOLTAGE/PH/HZ 240/1/60
POWER RATING 250 WATT

FAN DATA:

BI-16RM 3HP 208/3/60
STATIC PRESSURE FOR 2,700 CFM 4.0" WG

MISCELLANEOUS DATA:

PCU STATIC FOR 2,700 CFM 2" WG
TOTAL WEIGHT approximate: 2,000 LBS
MIN WATER PRESSURE: 25 PSI
RECOMMENDED WATER PRESSURE: 40 PSI
MAX WATER PRESSURE: 50 PSI
REGULATE IF NECESSARY
RECOMMENDED WASH WATER TEMPERATURE: 125-160 °F

FILTER & COMPONENTS SCHEDULE:

- ①. ALUMINUM MESH PREFILTER 24"X24"X1" (2)
- ②. ELECTRONIC CELL 24"X24"X10.75" (2)
- ③. ALUMINUM MESH POSTFILTER 24"X24"X1" (2)
- ④. MERV-14 ASHRAE 52.2 PLEATED PREFILTER 24"X24"X4" (2)
- ⑤. ODOR NEUTRALIZER: 16 2" TRAYS OF 288 LBS TOTAL

NOTES:

- 1. ALL DIMENSIONS ARE NOMINAL AND GIVEN IN INCHES
- 2. FAN, FAN TRANSITION, SKID, AND DETERGENT TANK PROVIDED BY AQE.
- 3. FAN CONTROL AND RECOMMENED DRIP TRAY PROVIDED BY OTHERS.
- 4. ANSUL PRE-PIPED BY AIR QUALITY ENGINEERING.
- 5. POWER CONNECTIONS BY OTHERS PER LOCAL CODE.
- 6. UL8782 CERTIFICATION APPROVED PER INTERTEK.
- 7. FAN INSTALLED BY AQE.

AIRFLOW →

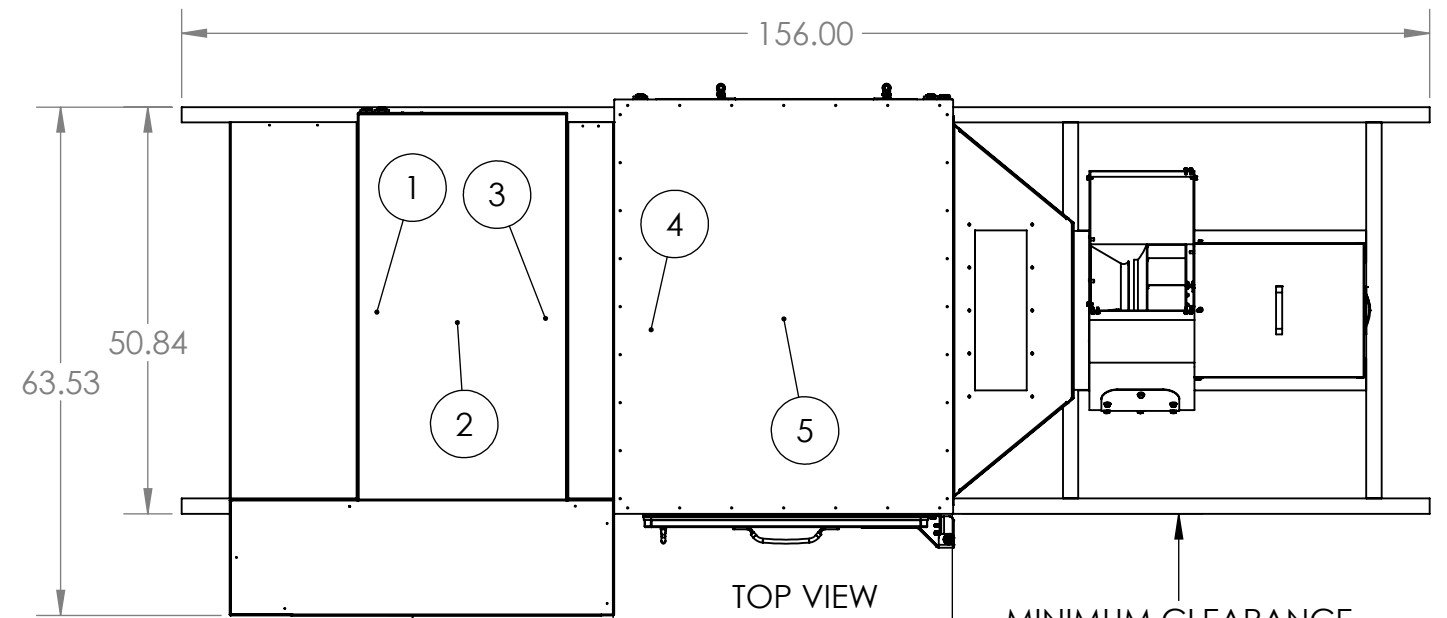

MINIMUM CLEARANCE NEEDED TO OPEN ENCLOSURE DOOR: 42.00

MINIMUM CLEARANCE NEEDED TO OPEN ODOR CONTROL MODULE DOOR: 42.00

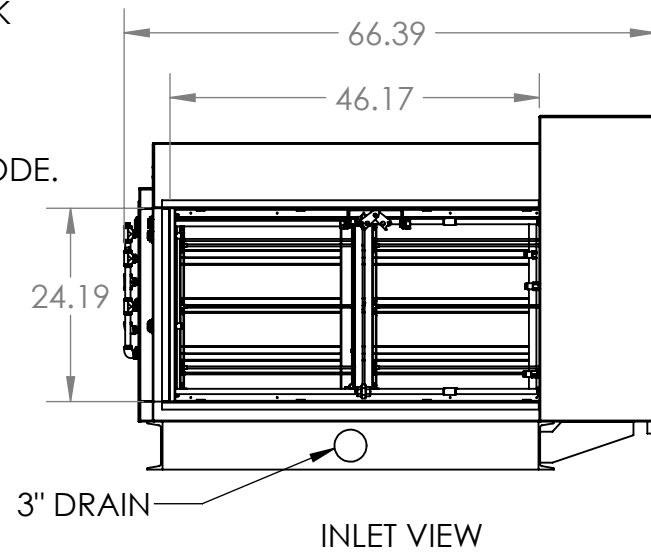

INLET VIEW

1/2" WATER CONNECTION

DETERGENT CONNECTION:
7FT MAX VERTICAL,
25FT MAX HORIZONTAL

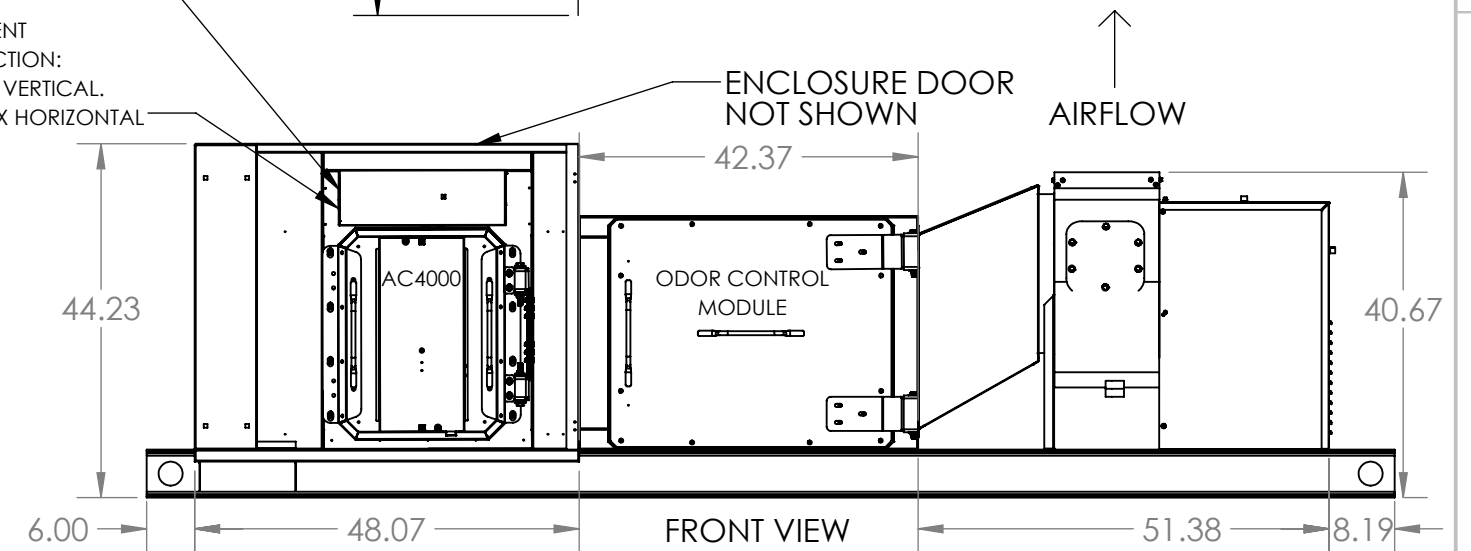

ENCLOSURE DOOR NOT SHOWN

FRONT VIEW

This document is owned by, and the information contained in it is proprietary to, Air Quality Engineering Inc. By receipt hereof the holder agrees not to use the information in part or all, disclose it to any third part, nor reproduce this document without the prior written consent of Air Quality Engineering Inc.

AIR QUALITY ENGINEERING INC.

7140 Northland Drive N., Brooklyn Park, MN 55428

UNLESS OTHERWISE SPECIFIED:

DIMENSIONS ARE IN INCHES

TOLERANCES:

- .XXX (3 PLC) ±.010"
- .XX (2 PLC) ±.02"
- .X (1 PLC) ±.1"
- ANGLES ±.5 degrees

COMMENTS:

NAME	DATE
DRAWN IK	4/16/26
ENG APPR.	
MFG APPR.	
MATERIAL: Per BOM	
FINISH:	
SURFACE AREA (in ²): 118916.00	
WEIGHT (lbs): 1179.88	

TITLE:

AC4000UL with OM, Enclosed, Skidded, L-R, 240V, BI-16RM

SIZE DWG. NO.

B 4LU1A1DK15FE2 **A**

SCALE: 1:24

DO NOT SCALE DRAWING

REV SHEET OF 1

Board of Ecoling Adjustments
District of Columbia
CASE NO. 21438
EXHIBIT NO. 26B

4

3

2

1

B

B

A

A

