



1015 HALF STREET
WASHINGTON, DC

A₁ 02.12.2025

BZA HEARING: ROOFTOP ANTENNAS
BZA CASE: 21238

Hines



hickok cole

All roof-mounted antennas, except those regulated by Subtitle C § 1306 or exempted by Subtitle C § 1307, shall comply with the following conditions:

SPECIAL EXCEPTION

(a) Each part of an antenna shall be set back from each edge, excluding party walls, of the roof a minimum distance equal to its total mounted height above the roof.

SPECIAL EXCEPTION

(b) An antenna may not exceed a total mounted height of twelve feet (12 ft.) above the roof.

COMPLIES

(c) Each antenna installation shall be located or screened such that its visibility from public spaces, navigable waterways, historic landmarks, and national monuments is minimized to the greatest practical extent.

COMPLIES

(d) An antenna shall be constructed of materials and colors that blend with the surroundings to the greatest practical extent.

COMPLIES

(e) Antennas mounted on roofs with outdoor recreation space shall be secured from unauthorized access for a minimum distance of ten feet (10 ft.), by a fence or screen at least five feet (5 ft.) in height.

COMPLIES

(f) Any related equipment cabinet or shelter that is not internal to the building or penthouse shall be:

(1) Constructed of materials and colors that blend with the building or penthouses.

(2) Located to reduce its visibility from public space to the greatest practical extent.

HSEMA IS THE DISTRICT'S AGENCY RESPONSIBLE FOR LEADING THE PLANNING AND COORDINATION OF THE DISTRICT OF COLUMBIA'S HOMELAND SECURITY AND EMERGENCY MANAGEMENT EFFORTS. HSEMA WORKS CLOSELY WITH OUR DISTRICT, FEDERAL AND REGIONAL PARTNERS TO ENSURE THAT THE DISTRICT OF COLUMBIA IS PREPARED TO PREVENT, PROTECT AGAINST, RESPOND TO, MITIGATE, AND RECOVER FROM ALL THREATS AND HAZARDS.

KEY ACTIVITIES:

- Disseminate public safety information via alerts, warnings, and notifications
- Manage the District's Emergency Operations Center—including the 24/7/365 DC Fusion Center
- Collect, analyze, and disseminate information on threats and hazards within the National Capital Region
- Develop and manage the District's residential displacement and post-emergency canvassing operations
- Coordinate resources in support of District-wide operations
- Maintain and operate the Washington Metropolitan Area Warning System to convey warnings to federal, state, local, tribal, and/or territorial government and public safety officials

VICINITY MAP



AERIAL VIEWS



A: EXISTING BUILDING



B: EXISTING BUILDING

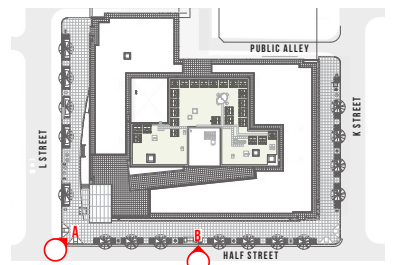

SITE PLAN
EXISTING

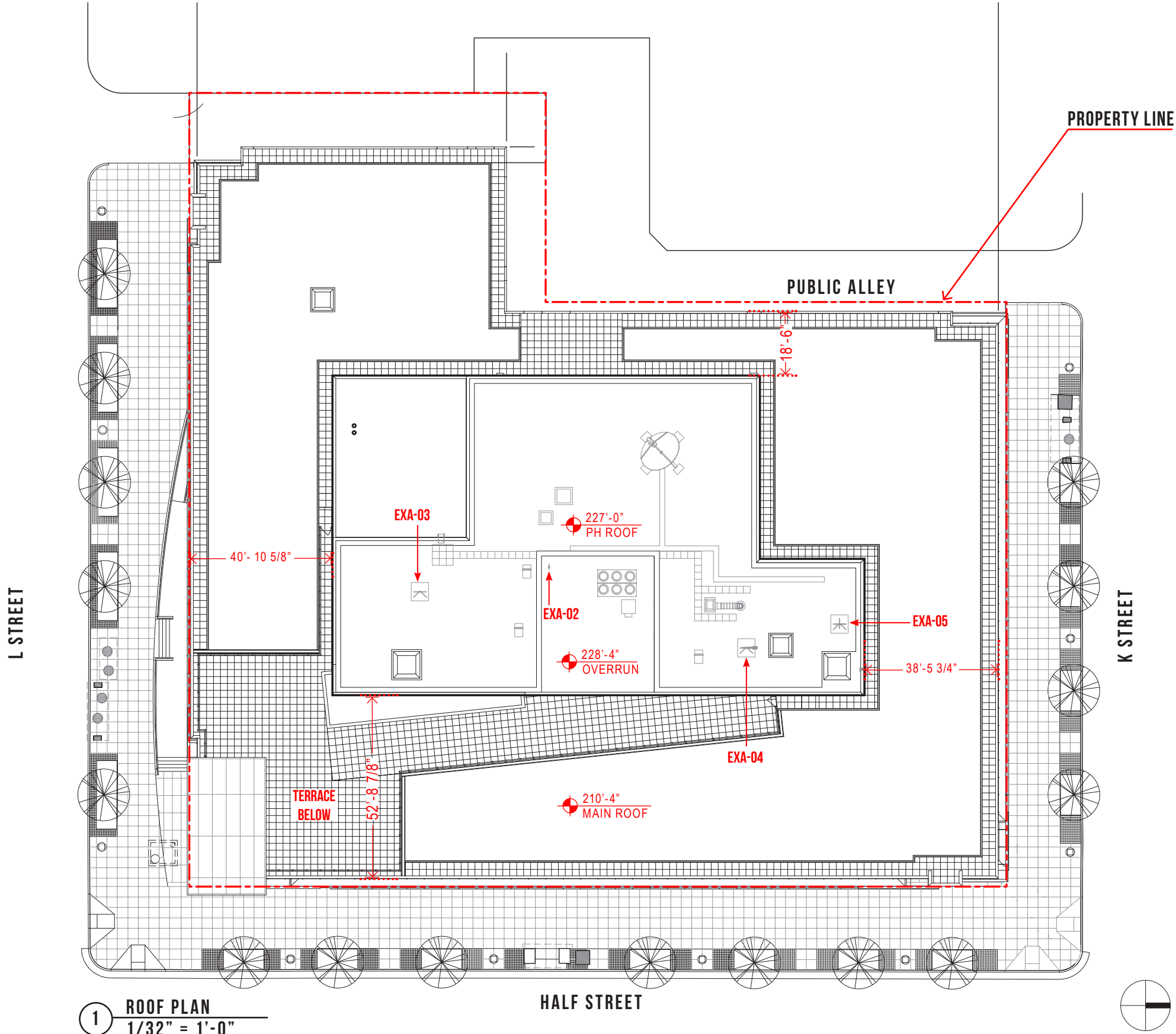

EXISTING ANTENNA	HEIGHT
EXA-02	7'-6"
EXA-03	7'-6"
EXA-04	7'-6"
EXA-05	10'-0"