

# MATRONE RESIDENCE

## Final Concept Package

August 2024





Final  
Concept  
Package

DESIGN  
CONCEPT  
DECK VIEW

Matrone Residence  
3730 Windom PL  
NW  
Washington, DC  
20016

Kennedy Thomas-Cogar  
Designer

Kelley Oklesson  
Senior Designer

Date: 08/20/2024

Sheet #:

1 of 4

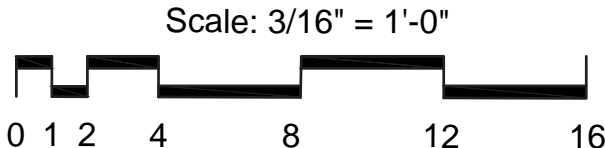
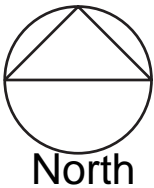
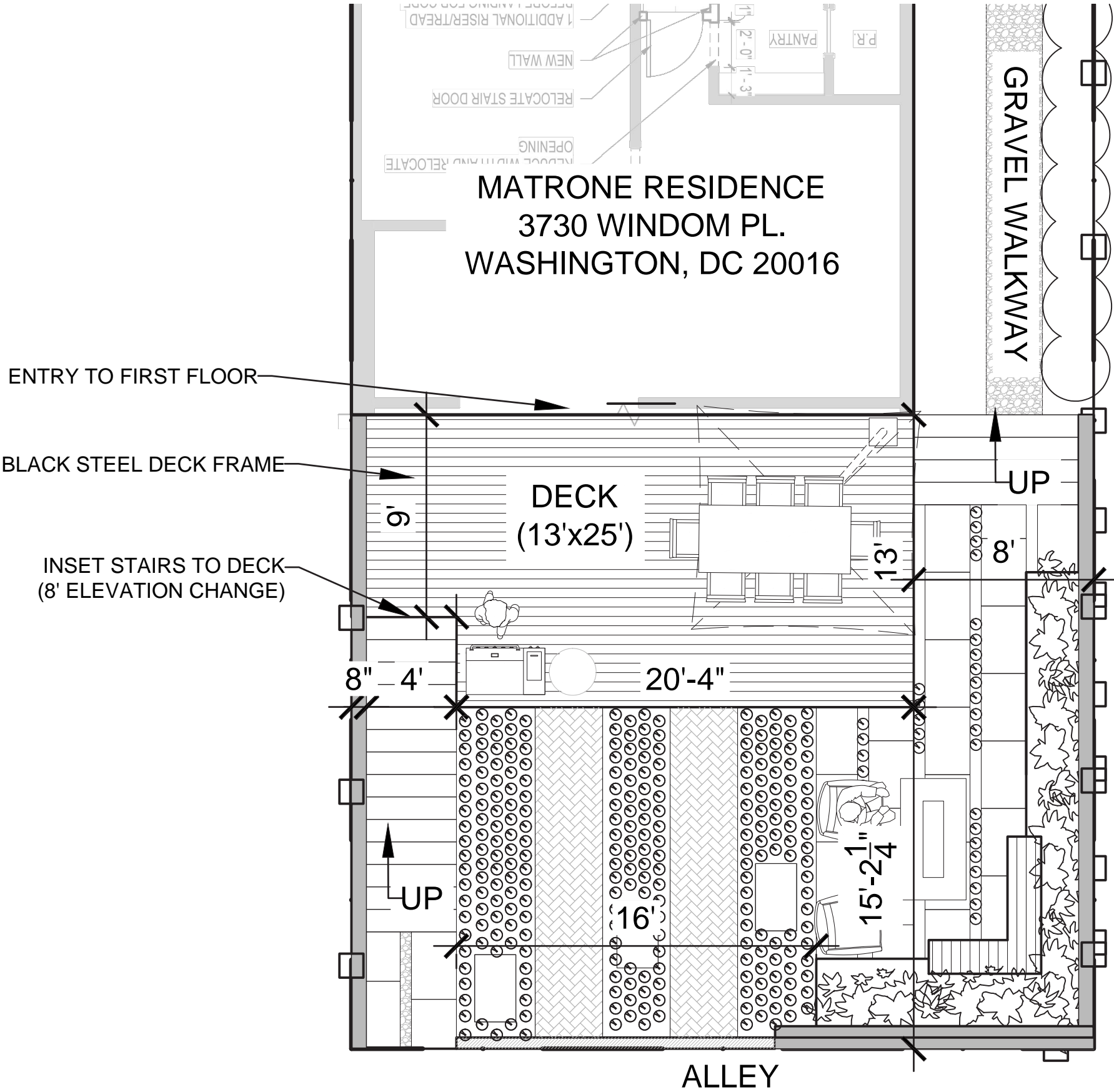



GROUNDSMITH COLLECTIVE

# Final Concept Package

**DESIGN  
CONCEPT  
DRIVEWAY  
VIEW**

Matrone Residence  
3730 Windom PL  
NW  
Washington, DC  
20016

Kennedy Thomas-Cogar  
Designer

Kelley Okleson  
Senior Designer

Date: 08/20/2024

Sheet #:  
**2 of 4**

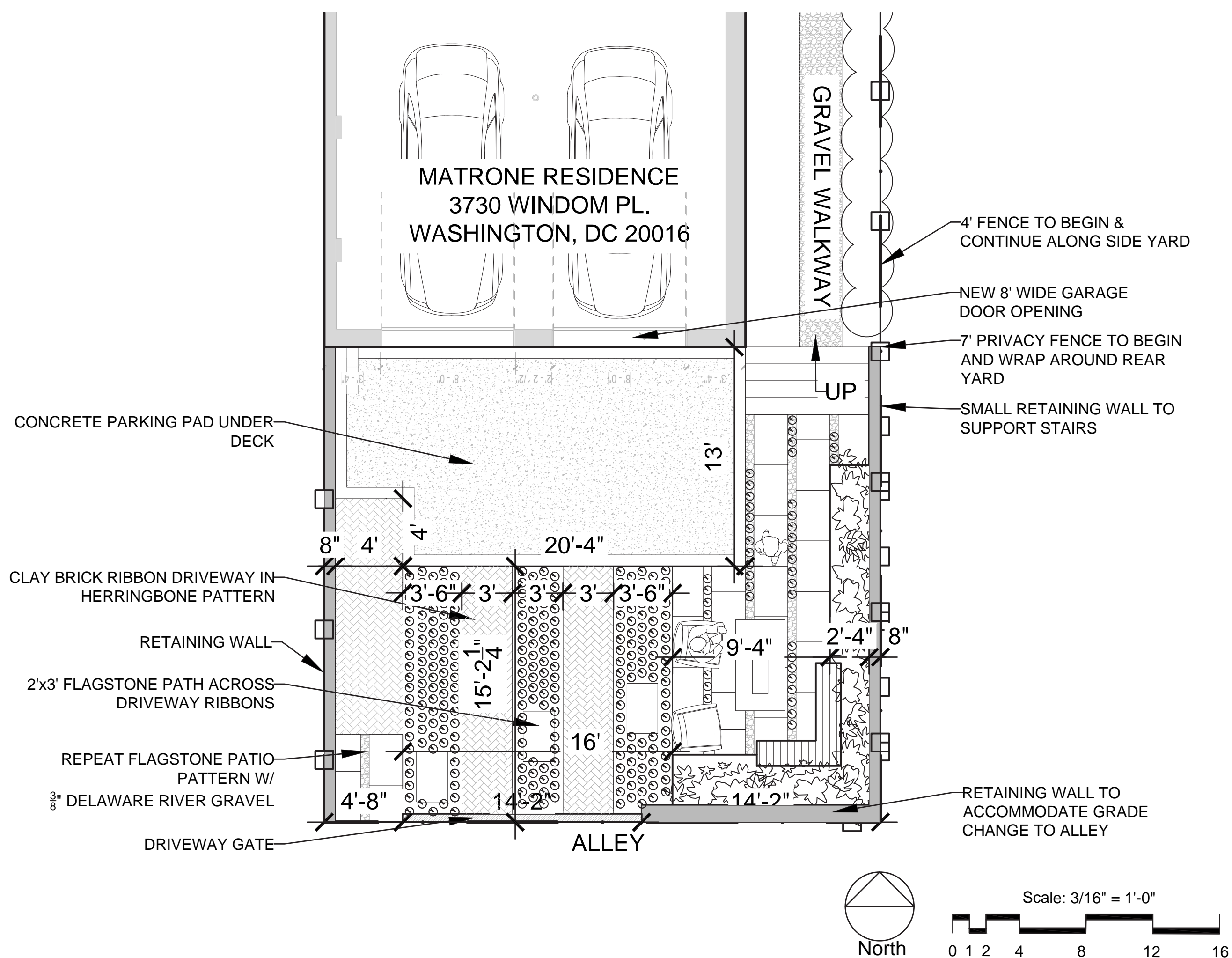

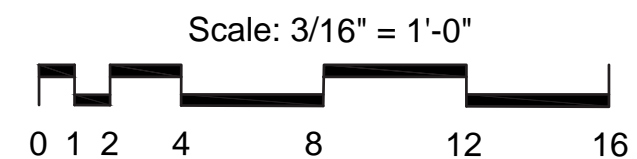
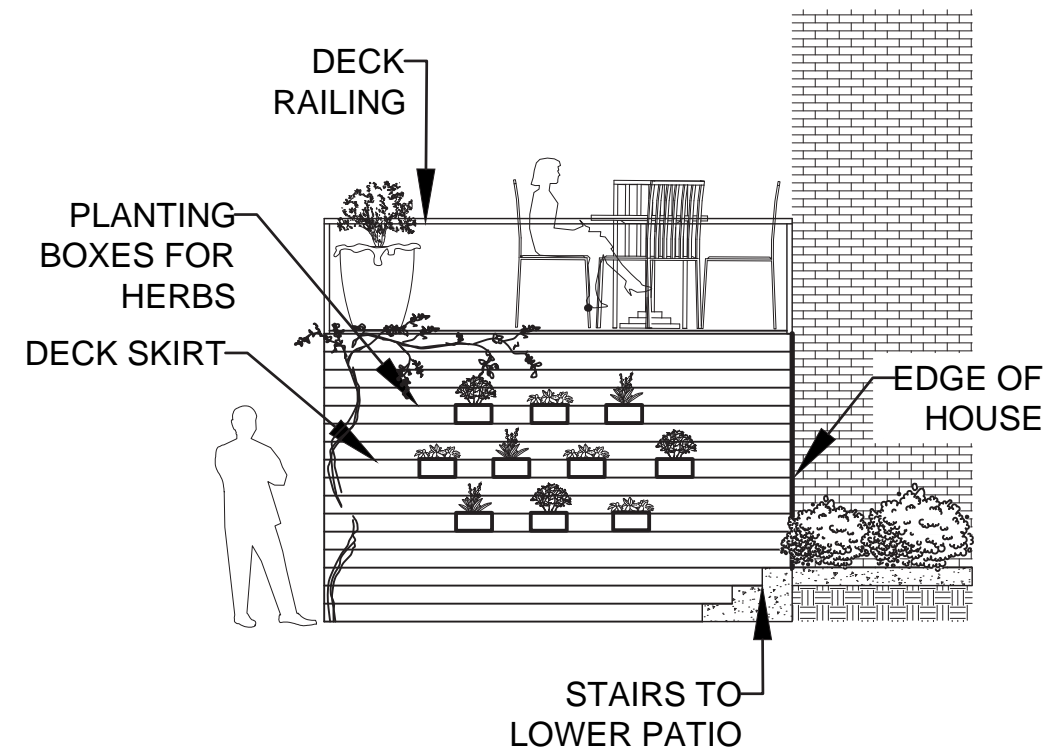
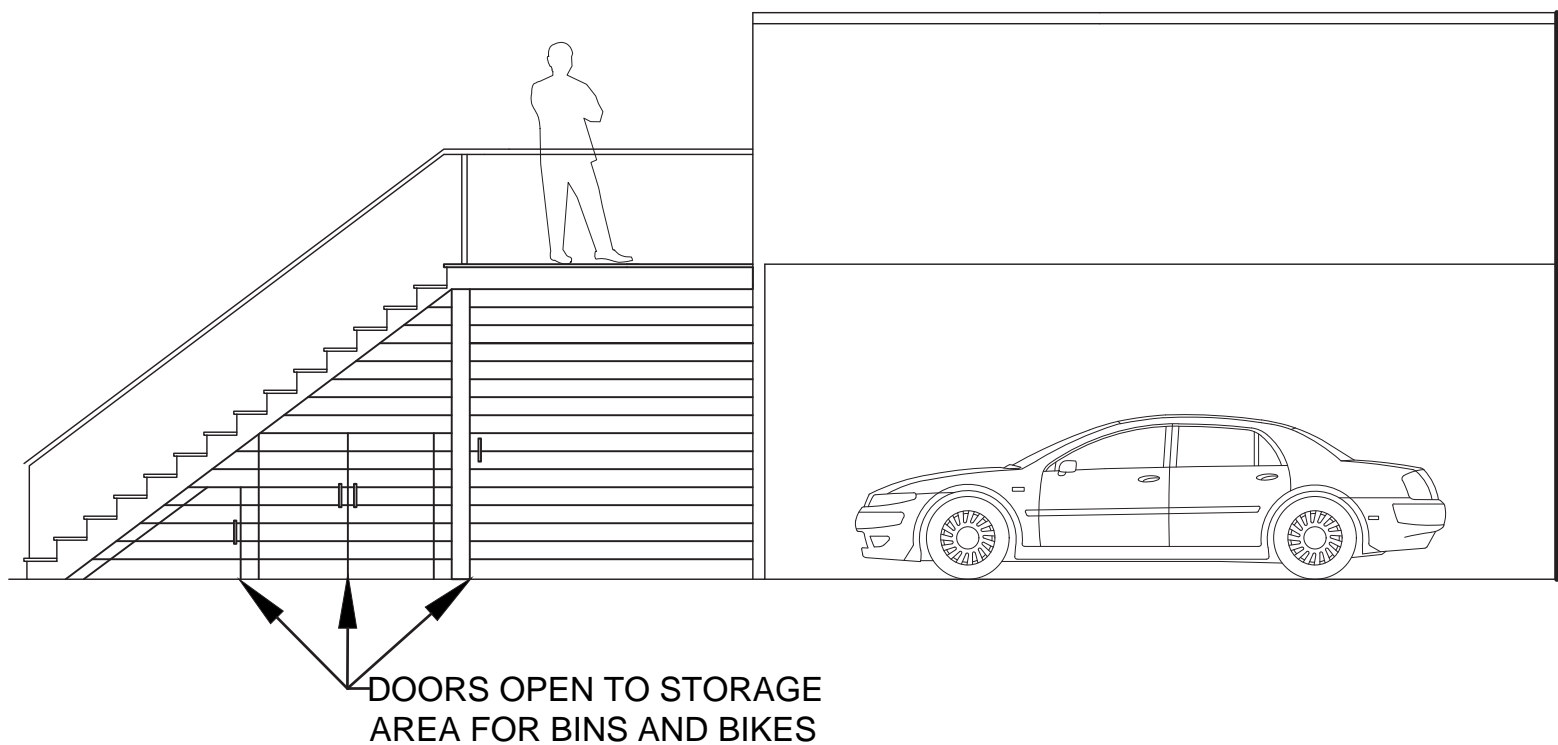
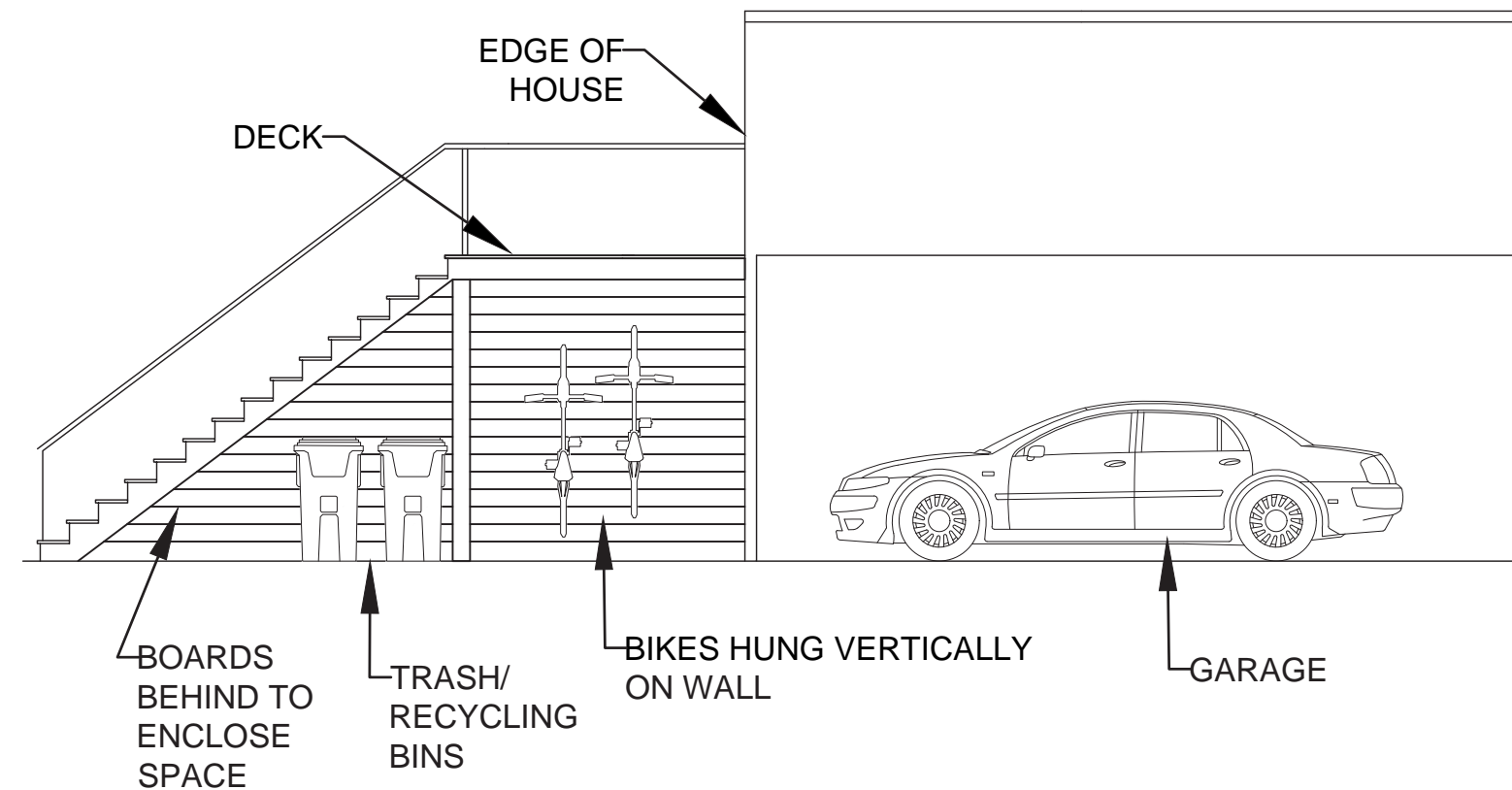



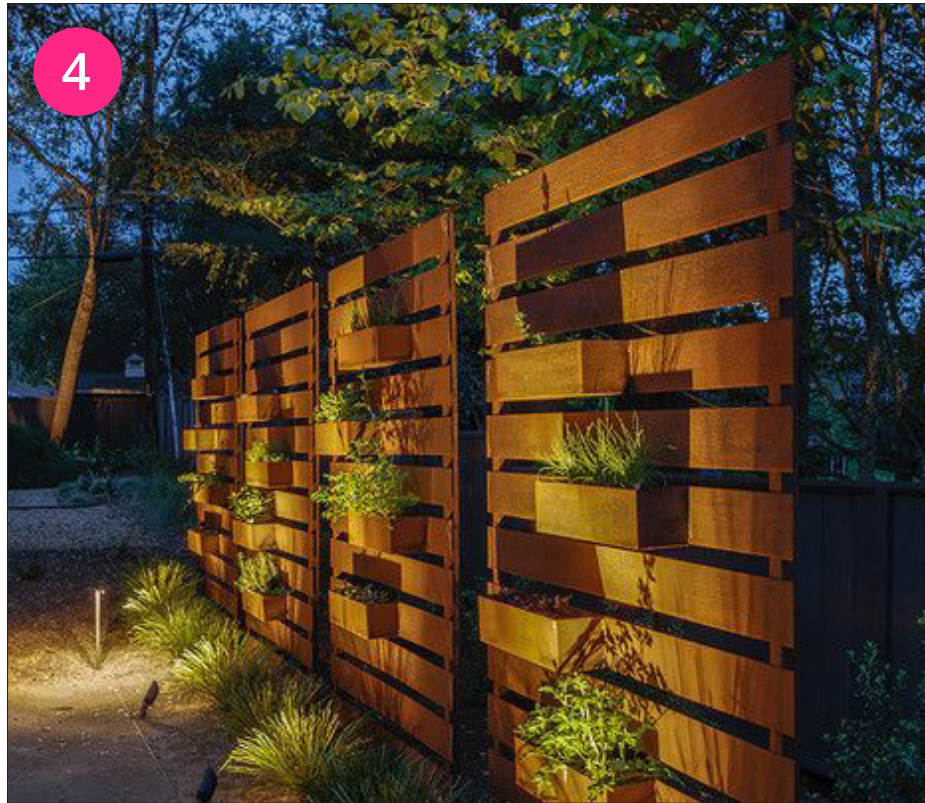

#### IMAGE KEY:

1. Stairs with storage for bins, bikes, etc.
2. Retaining wall with planting, privacy fence, and wall seat.
3. Pea gravel with concrete pavers and planting.
4. Slat wall with planting shelves and hooks. This can be intertwined with deck skirting.
5. Brick ribbon driveway with plantings.



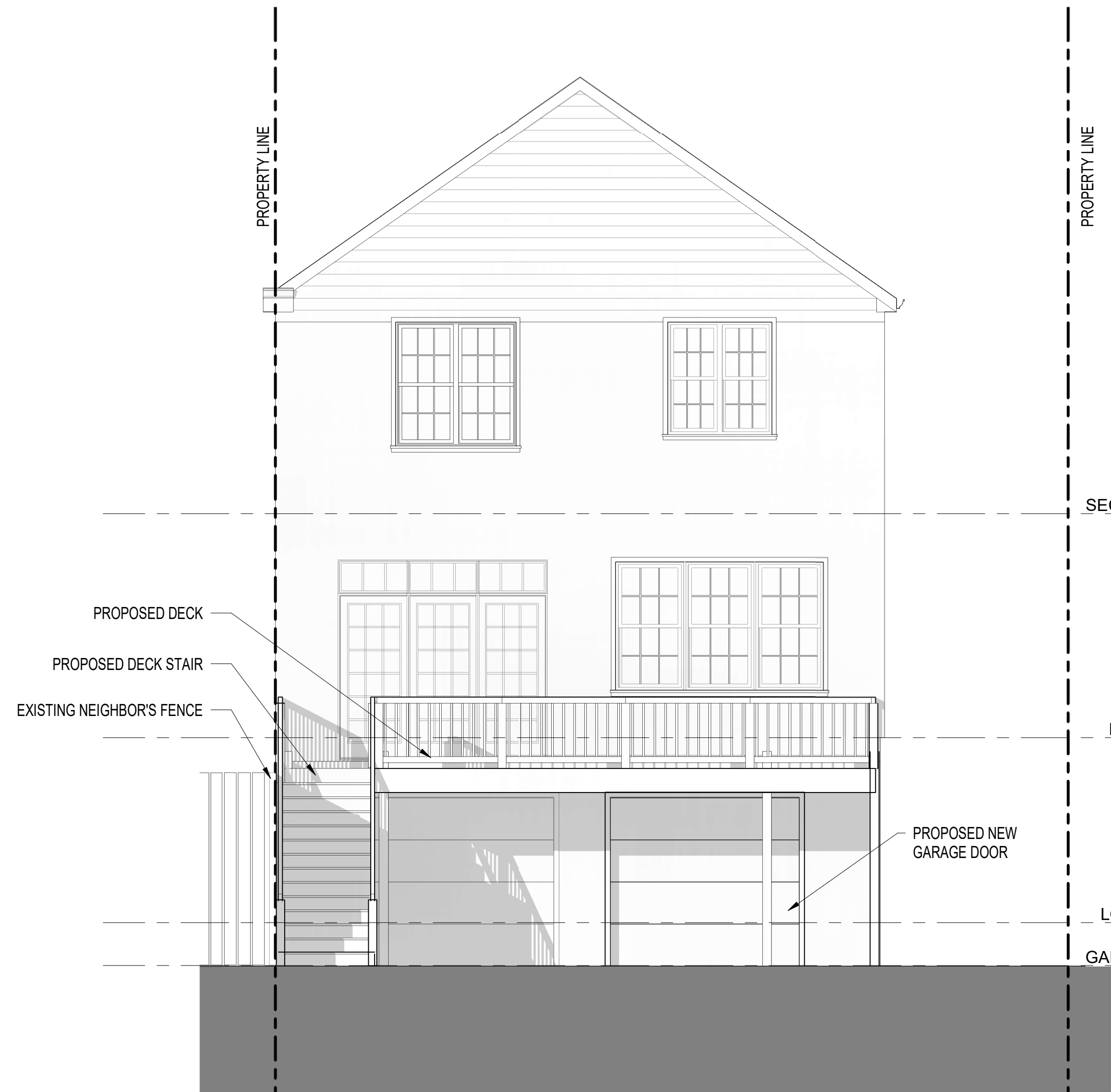

1 REAR ELEVATION - PROPOSED  
1/4" = 1'-0"



2 REAR ELEVATION - EXISTING  
1/4" = 1'-0"

2316

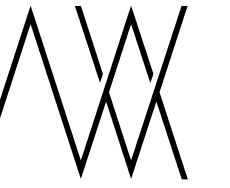

ARCHITECTS, LLC  
4818 MacARTHUR BLVD NW  
www.mvarchitects.com  
TELE: 202.489.1103

NOT FOR  
CONSTRUCTION

MATRONE  
RESIDENCE  
3730 WINDOM PL, NW  
WASHINGTON DC, 20016

DRAWING: REAR ELEVATION  
ISSUED: 8/20/2024

EXH1