

Contractor field office and temporary facilities located on embassy grounds on existing paved areas.

Temporary material storage and staging area against curb. Total zone length approximately 150 feet (approximately 8-9 parking spaces). Zone width limited 10 feet from curb to preserve full, existing clear roadway for two-way vehicle traffic.



existing southern driveway will serve as construction entrance

**Embassy of the Kingdom of the Netherlands
Parking Structure Replacement Project**

4200 Linnean Avenue, NW
January 5, 2023

SANCHEZ PALMER | ARCHITECTS



215 N Payne Street, suite 301
Alexandria, Virginia 22314
703.549.4033

Jan Evertsen, Principal
1061 XZ Amsterdam
Post of 7-779 Adjustment
District of Columbia
CASE NO.20887
EXHIBIT NO.21C

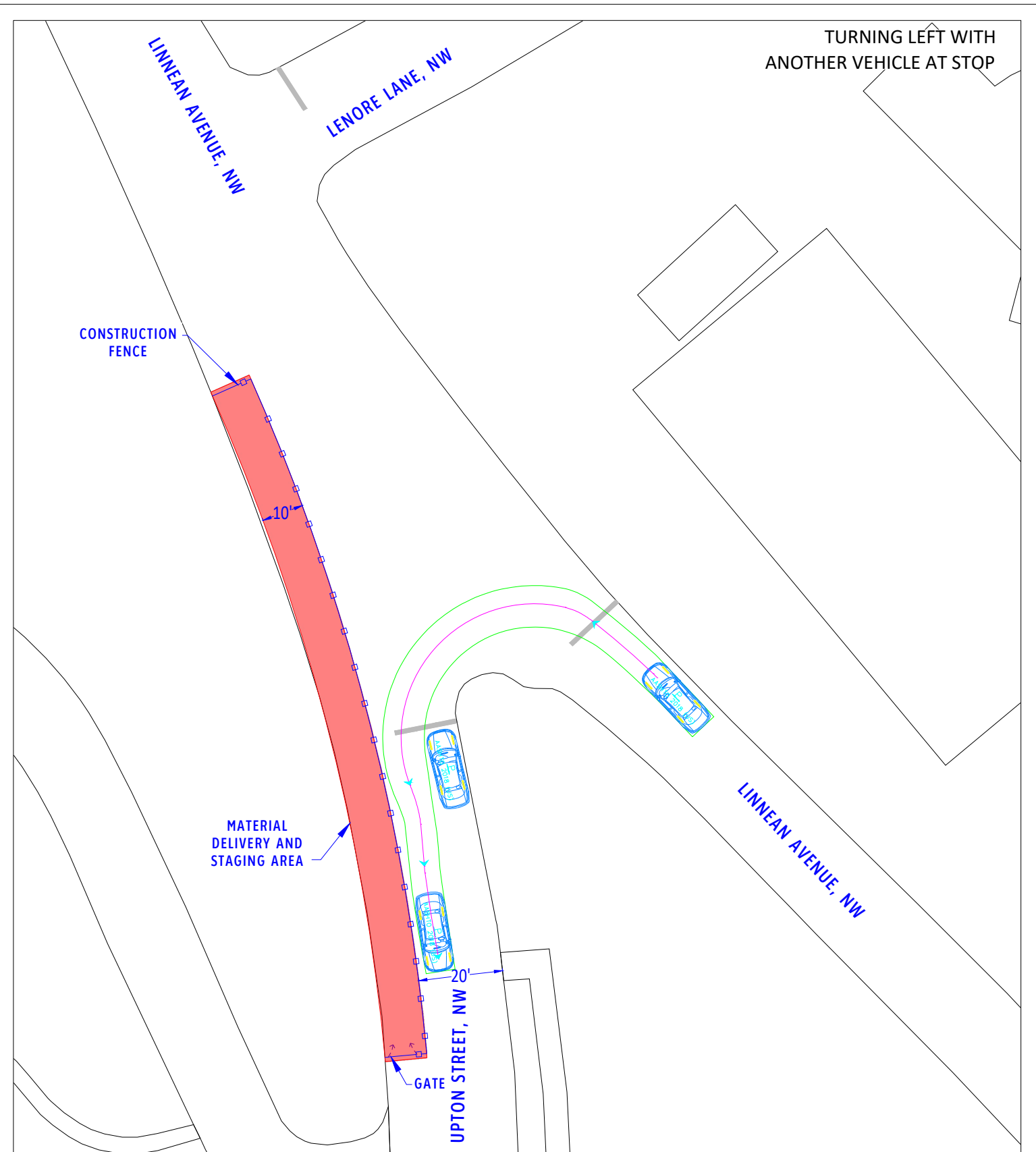
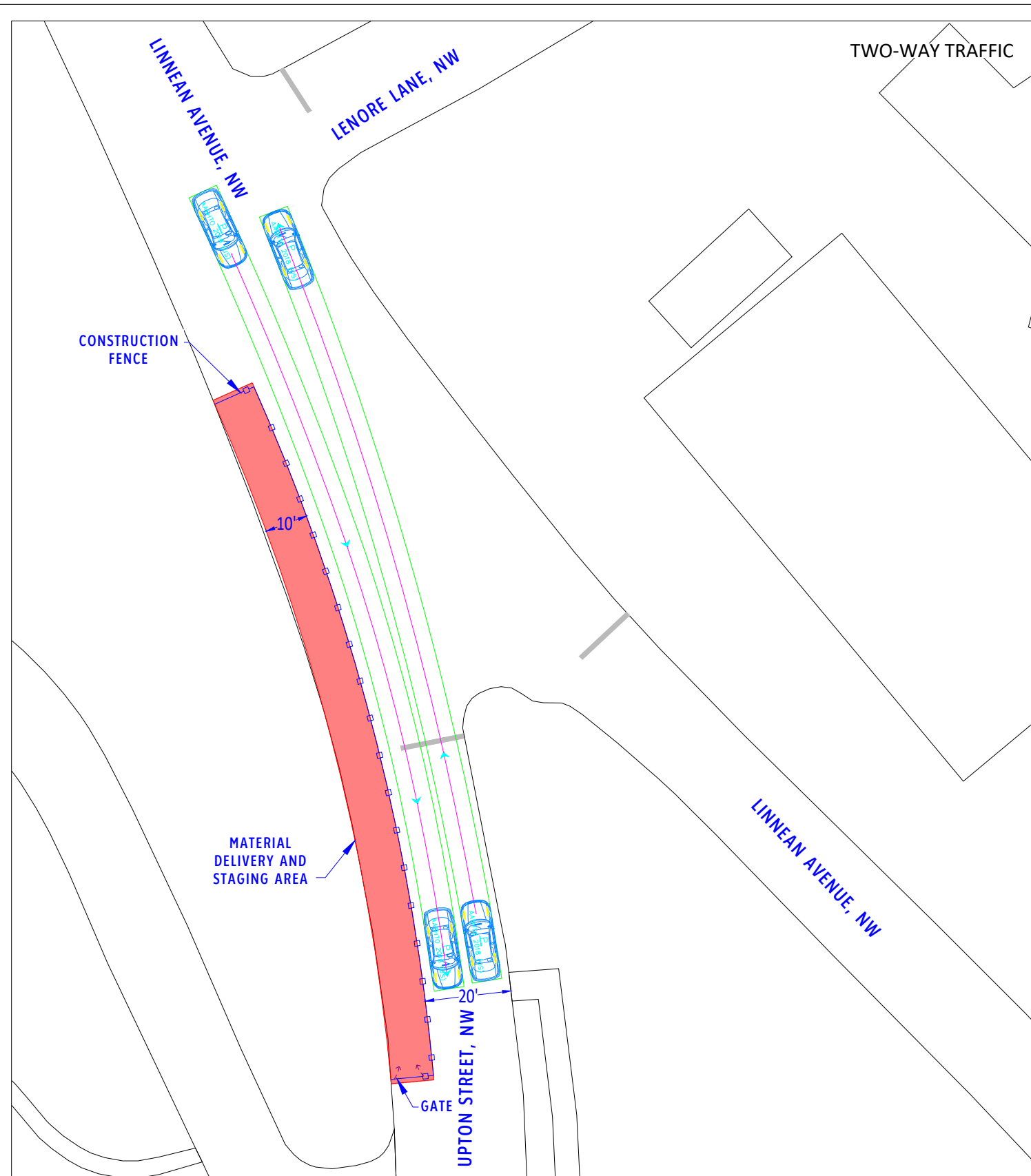

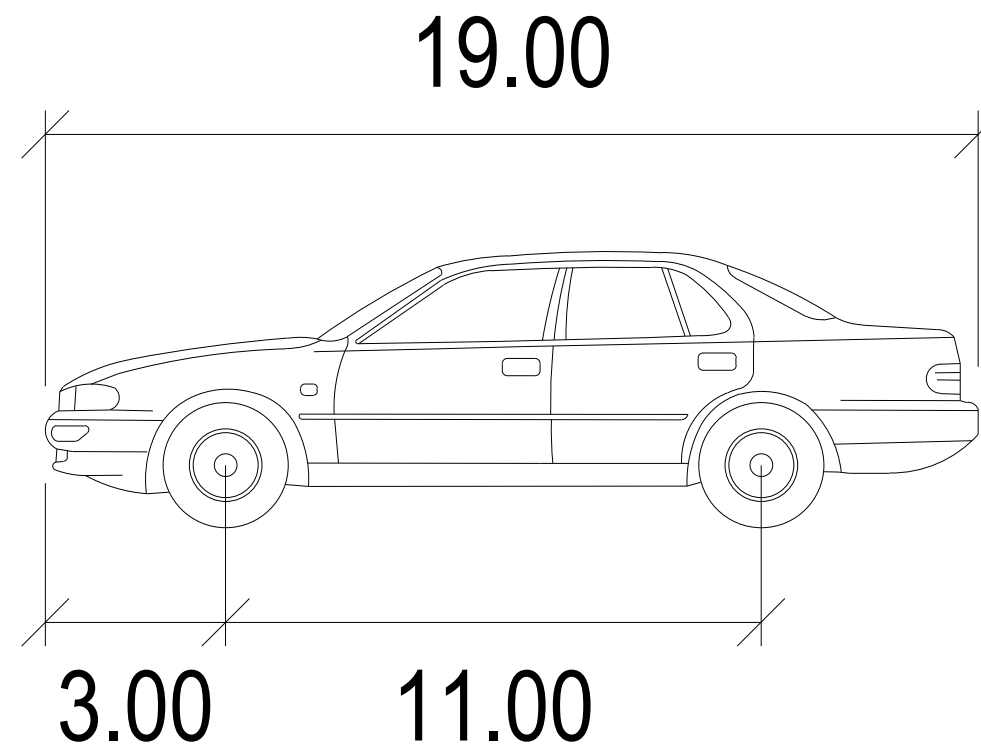

P

feet

Width	: 7.00
Track	: 6.00
Lock to Lock Time	: 6.0
Steering Angle	: 31.6