

# Streets – Curb Cut

From 1955 to 2019, 13 of 15 home sites are subdivided and get curb cuts onto streets dedicated in 1953.

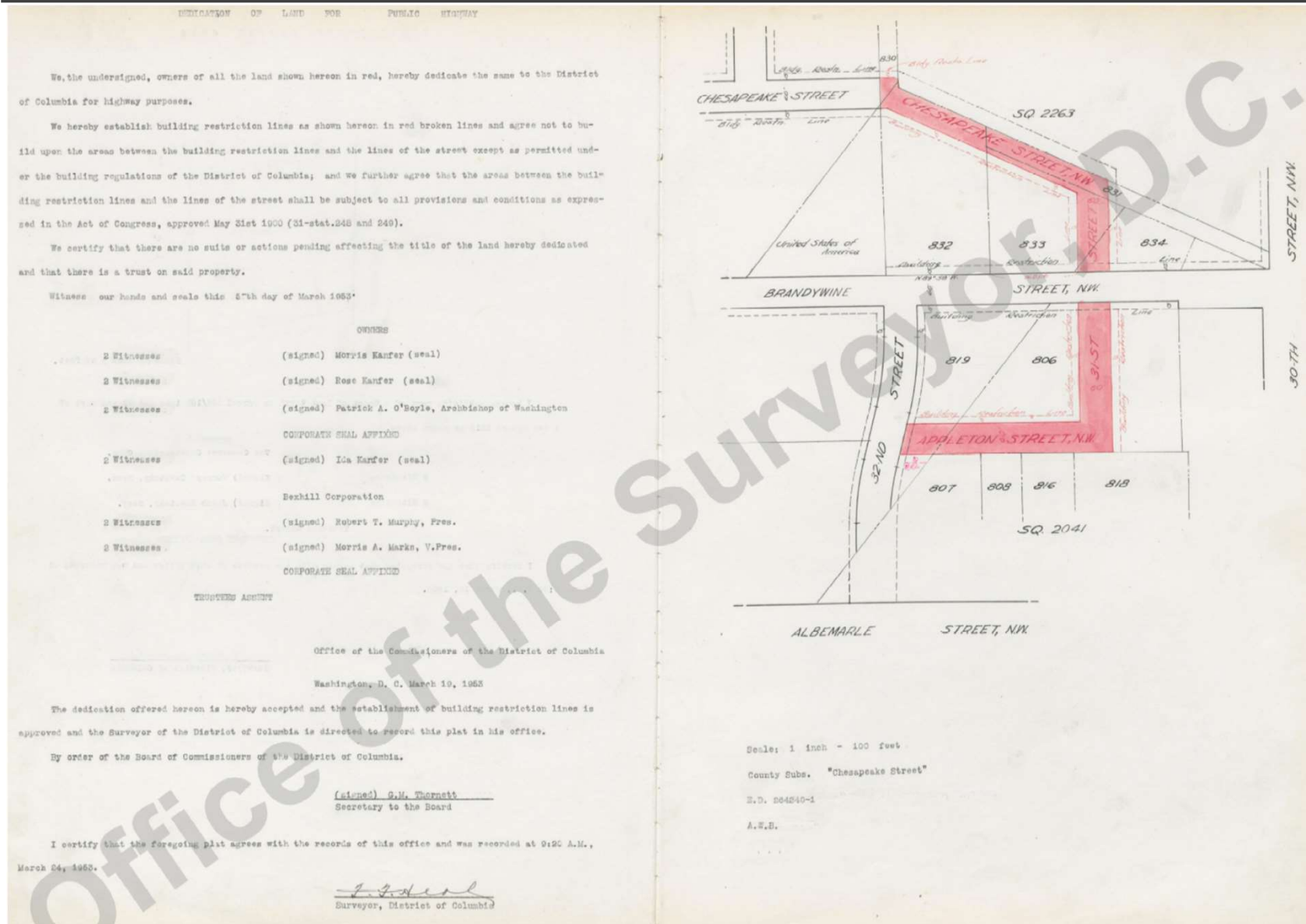

Address	Built	Curb cuts onto new streets
<b>Above Brandywine</b>		
3025 Gates	2006	1 – access to Grant Rd at back abandoned
3017 Gates	2009	2, circular drive with second cut onto private section of Gates
3100 Chesapeake	1962	3 – circular drive + garage
<b>Below Brandywine</b>		
3020 Brandywine	1956	1
4535 31 <sup>st</sup>	1955	1
4525 31 <sup>st</sup>	1956	1 (formerly 2)
3100 Brandywine	1955	1
4500 31 <sup>st</sup>	1957	1
3115 Appleton	2001	1
3121 Appleton St	1965	1
3127 Appleton St	1965	1
3021 Appleton St	2019	1
3120 Appleton St	1961	2
3007 Albemarle	1924	0
3045 Albemarle	1927	0

Image Source: Subdivisions Book 134, Page 189. Construction Dates Source: mytax.dc.gov