

**PROPOSED**



**Note:**  
Graphics are provided to help illustrate design concepts, elements, and character and may be modified with final engineering and design.

VAN NESS STREET & NEBRASKA AVENUE - WINTER



**EXISTING**



NEBRASKA AVENUE



**PROPOSED**



**Note:**  
Graphics are provided to help illustrate design concepts, elements, and character and may be modified with final engineering and design.

NEBRASKA AVENUE - SUMMER



**PROPOSED**



**Note:**  
Graphics are provided to help illustrate design concepts, elements, and character and may be modified with final engineering and design.

NEBRASKA AVENUE - WINTER



**EXISTING**



42ND STREET



**PROPOSED**



**Note:**  
Graphics are provided to help illustrate design concepts, elements, and character and may be modified with final engineering and design.

42ND STREET - SUMMER



**PROPOSED**



**Note:**  
Graphics are provided to help illustrate design concepts, elements, and character and may be modified with final engineering and design.

42ND STREET - WINTER





**CRYPTOMERIA**



**RHODODENDRON**



**CREeping JACOB'S LADDER**



**WINTERBERRY**



**BUTTONBUSH**



**FERN MIX**



**WOLLY THYME**



**FALSE GOAT'S BEARD**

42ND STREET PLANT PALETTE

**Note:**  
Images are provided to help illustrate design concepts, elements, and character and may be modified with final engineering and design.



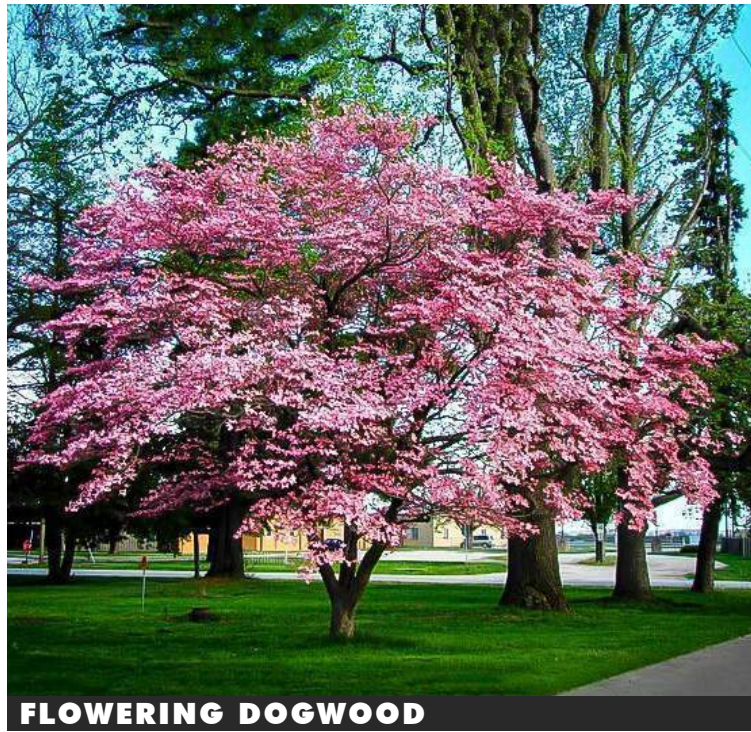

**FLOWERING DOGWOOD**



**SHASTA DAISY**



**LIMELIGHT HYDRANGEA**



**SWEETBOX**



**WINTERBERRY**



**ORNAMENTAL GRASS & LAVENDAR MIX**



**BLACK EYED SUSAN**



**SOUTHERN MAGNOLIA**



**CRYPTOMERIA**



**WOLLY THYME**



**BUTTONBUSH**

NEBRASKA AVENUE PLANT PALETTE

**Note:** Images are provided to help illustrate design concepts, elements, and character and may be modified with final engineering and design.



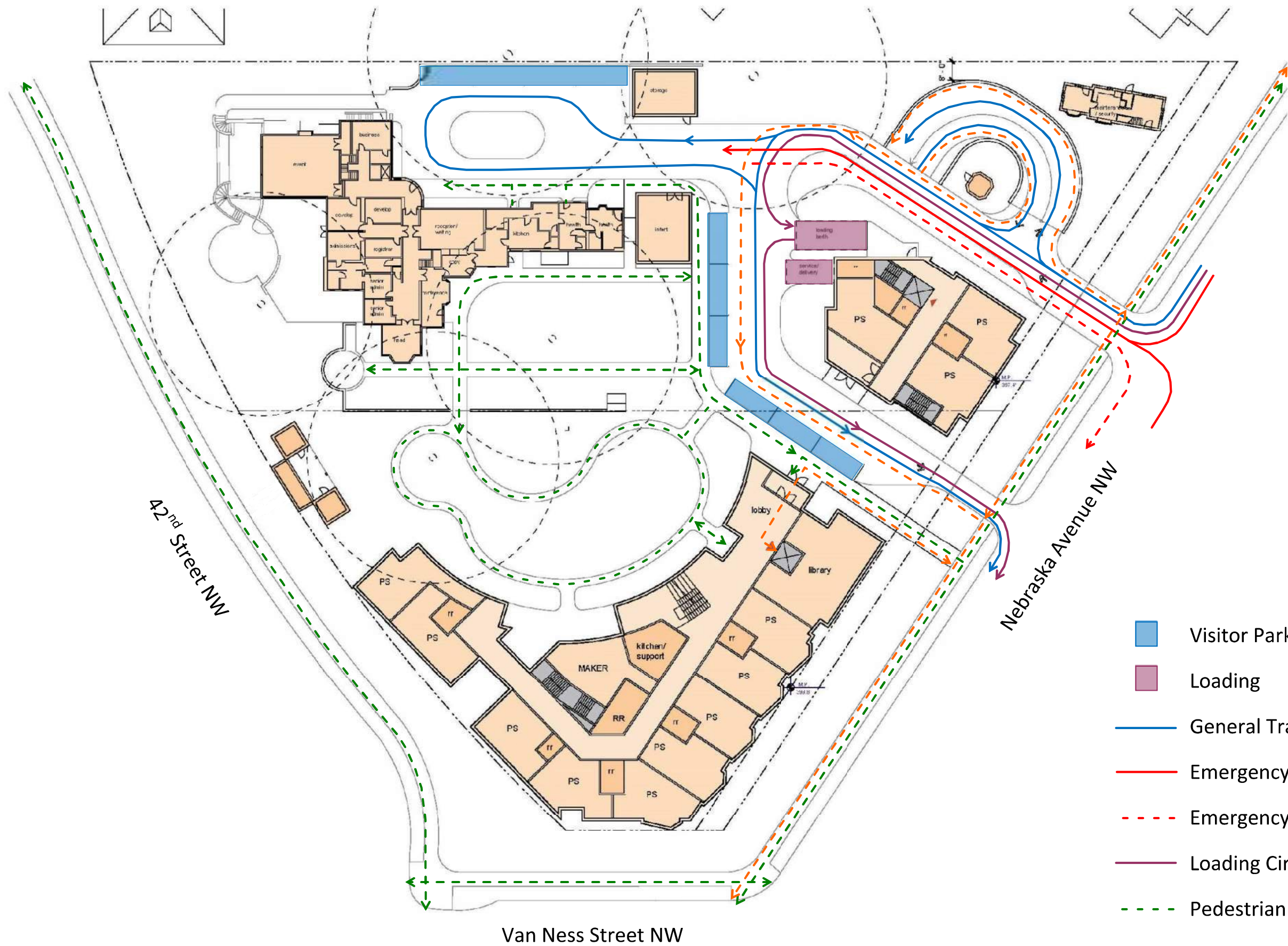

- Visitor Parking
- Loading
- General Traffic Flow
- Emergency Vehicle Ingress
- Emergency Vehicle Egress
- Loading Circulation
- Pedestrian Circulation
- Bicycle Circulation