

# THE ARCHITECTURAL REVIEW

## Masters in Art

The best series of reference hand-books on the great painters and sculptors. Each part a concise but complete treatise upon the artist to whom it is devoted. 110 subjects. Send for list.

Price, Prepaid, 25 Cents

The ARCHITECTURAL REVIEW COMPANY  
144 CONGRESS ST., BOSTON, MASS.

## American Gardens

Edited by GUY LOWELL

Still the finest work on this subject, which is treated from the standpoint of garden design, and not horticulture. Only a few copies of the edition remain.

Price, \$7.50, Express Paid

The ARCHITECTURAL REVIEW COMPANY  
144 CONGRESS ST., BOSTON, MASS.

## Masters in Music

A reference-library in six volumes of the best classical music, with biographical, analytical, and critical notes. The most carefully and intelligently edited work of its kind. Sold on small monthly payments.

Send for full information and terms

The ARCHITECTURAL REVIEW COMPANY  
144 CONGRESS ST., BOSTON, MASS.

## Architectural Shades and Shadows

By HENRY McGOODWIN

A complete treatise on the casting of architectural shadows, written in terms of plan, section, and elevation, so that a knowledge of descriptive geometry is not necessary. The book offers a course of study every draughtsman should take.

Price, \$3.00, Express Paid

The ARCHITECTURAL REVIEW COMPANY  
144 CONGRESS ST., BOSTON, MASS.

## Vignola: Five Orders of Architecture

Edited by PIERRE ESQUIÉ

This work, with plates imported, mounted on cloth guards and handsomely bound, with a translation of the French notes, is the standard treatise on "the orders" adopted by nearly every architectural school in the United States.

Price, \$5.00, Express Paid

The ARCHITECTURAL REVIEW COMPANY  
144 CONGRESS ST., BOSTON, MASS.

## Perspective: An Elementary Text-Book

By BEN J. LUBSCHEZ

A concise treatise primarily intended for home study by the beginner, but also of great value to the experienced draughtsman, particularly on account of its discussion of "Short Cuts and Special Manipulations."

Price, \$1.50, Post-paid

The ARCHITECTURAL REVIEW COMPANY  
144 CONGRESS ST., BOSTON, MASS.

## Pen Drawing

By C. D. MAGINNIS

The most popular book we ever published. There are few works so tightly packed with the very best instruction for those who are studying the art of rendering in pen and ink, and none which have been more highly spoken of by those who have purchased it.

It's only \$1.00, Post-paid

The ARCHITECTURAL REVIEW COMPANY  
144 CONGRESS ST., BOSTON, MASS.

## Letters & Lettering

By FRANK CHOUTEAU BROWN

The best work on the subject ever written. The present edition makes 15,000 copies, and every copy sold on the money-back-if-not-satisfactory basis.

Price, \$2.00, Post-paid

The ARCHITECTURAL REVIEW COMPANY  
144 CONGRESS ST., BOSTON, MASS.

## Details of Building Construction

By CLARENCE A. MARTIN  
Professor of Architecture, Cornell University

A series of 33 plates, models of working drawings as well as methods of construction. Bound in cloth.

Price, \$2.00, Post-paid

The ARCHITECTURAL REVIEW COMPANY  
144 CONGRESS ST., BOSTON, MASS.

## English Household Furniture OF THE GEORGIAN PERIOD

A collection of 100 plates, 11 x 14 inches, reproducing selected examples shown in a loan exhibition at South Kensington Museum, held under Royal patronage, and containing some of the finest specimens of the period to be found in the United Kingdom.

Price, in Portfolio, \$10.00, Express Paid

The ARCHITECTURAL REVIEW COMPANY  
144 CONGRESS ST., BOSTON, MASS.

## Portfolios for Supplementary Plates

We have prepared handsome cloth portfolios, lettered in gold, for collecting the supplementary plates on Modern English Churches and Modern English Country Houses. The portfolios will exactly fit the series when completed.

Price, Each, \$1.00, Express Paid

The ARCHITECTURAL REVIEW COMPANY  
144 CONGRESS ST., BOSTON, MASS.

## A Glossary of Important Symbols

By ADELAIDE S. HALL

This little book is useful to designers of all classes, if only as a protection against using ornament which has a distinct symbolic meaning in places where this meaning would be ridiculous.

Price, \$1.00, Post-paid

The ARCHITECTURAL REVIEW COMPANY  
144 CONGRESS ST., BOSTON, MASS.

Board of Zoning Adjustment  
District of Columbia  
CASE NO. 20453  
EXHIBIT NO. 60

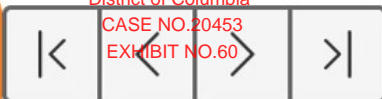

## Roof Construction of the Temple

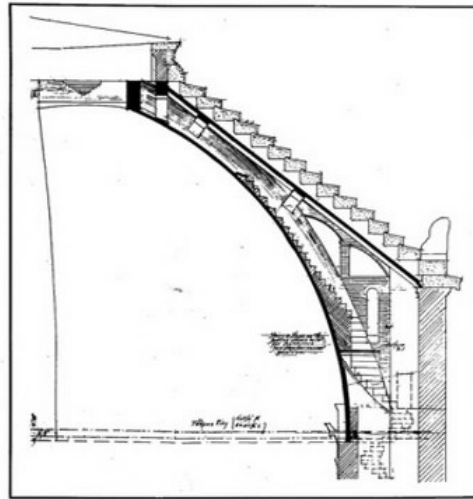

Longitudinal Section, Showing Method of Construction

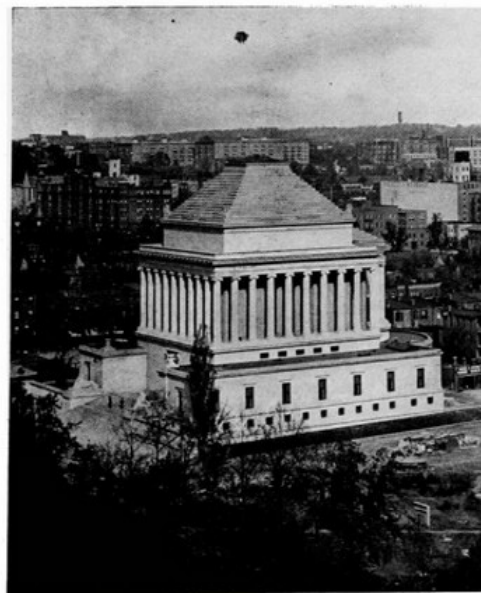

View of Building, Showing Solid Limestone Roof

ARCHITECTS who are interested in true masonry construction, particularly those acquainted with the notable Brunelleschi dome, at Florence, will be struck by the points of similarity in the double-shell dome construction of the Temple.

While the dome at Florence carries no practical superimposed weight, outside of the lantern, in the roof of the Temple the limestone alone, composing the steps in the roof as seen in the photograph, weighs 332 tons! The entire weight of this roof, limestone and all, is supported by a shell of typical Guastavino Construction.

We know of no more striking illustration of the structural soundness, which distinguishes Guastavino Construction fully as much as its aesthetic appeal.

### R. GUASTAVINO COMPANY

NEW YORK  
FULLER BUILDING

BOSTON  
60 STATE STREET

