

JUNE 15, 2016
 STRUCTURAL PLANS CERTIFIED AS PROVIDED IN SECTION
 106.1.4.1 OF THE D.C. CONSTRUCTION CODES

OFFICIAL
 GOVERNMENT OF THE DISTRICT OF COLUMBIA
 PERMIT OPERATIONS DIVISION
 PLANS APPROVED

PERMIT NO. DC 660814

- These plans are considered approved in accordance with any corrections noted on the permit to a final set to be constructed in accordance with the approved plans and does not constitute a final approval.
- All work must be done in accordance with the approved plans and must be inspected by the District of Columbia Department of Public Works.
- Issuance of permit does not prevent field inspections from ordering corrections to meet codes when issues are noted during inspection.
- No on-site changes to approved drawings. Changes or modifications to the approved drawings shall be submitted and approved by the District of Columbia Department of Public Works.
- This permit does not include approval for any work requiring a Supplemental Permit, e.g. Electrical or Plumbing.



MCMILLAN
 SITE DEVELOPMENT
 PACKAGE
 LOT 800; SQUARE 3128
 WASHINGTON, DC

OWNER
 DISTRICT OF COLUMBIA
 Office of the Deputy Mayor for Planning &
 Economic Development
 1350 Pennsylvania Ave. NW
 Washington, DC 20004
 Tel. (202) 727-6365

DEVELOPER
 VISION MCMILLAN PARTNERS
 1508 U Street NW
 Washington, DC 20009
 Tel. (202) 462-1092

CONSULTANTS
ARCHITECT
 PERKINS EASTMAN DC
 1250 23rd Street NW
 Suite 475
 Washington, DC 20037
 Tel. (202) 495-7430

LANDSCAPE ARCHITECT
 NELSON BYRD WOLTZ
 310 East Market Street
 Charlottesville, VA 22902
 Tel. (434) 984-1358

STRUCTURAL ENGINEER
 SILMAN ASSOCIATES
 1053 31st Street NW
 Washington, DC 20007
 Tel. (202) 334-6210

MEP ENGINEER
 SETTY & ASSOCIATES
 INTERNATIONAL, PLLC
 5185 MacArthur Boulevard NW
 Suite 220
 Washington, DC 20016
 Tel. (202) 393-1523

LIGHTING DESIGN
 STROIK LIGHTING DESIGN
 1470 Waggaman Circle
 McLean, VA 22101
 Tel. (703) 829-0548

HISTORIC PRESERVATION
 EHT TRACERIES
 1121 5th Street NW
 Washington, DC 20001
 Tel. (202) 393-1199

CIVIL ENGINEER
 BOWMAN CONSULTING DC PC
 888 17th Street NW
 Suite 302
 Washington, DC 20006
 Tel. (202) 750-2474

SOE/GEO TECHNICAL ENGINEER
 GEI CONSULTANTS
 1620 I Street NW
 Suite 500
 Washington, DC 20006
 Tel. (202) 828-9510

KEY PLAN

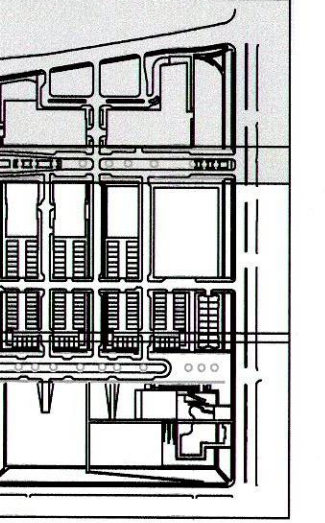

PLAN STATUS

| NO. | DATE | DESCRIPTION |
|-----|------|-------------|
| | | |
| | | |
| | | |
| | | |

| | | |
|--------------|--------------|-------------|
| PL DESIGN | TBM DRAWN | GAB CHKD |
|--------------|--------------|-------------|

SCALE
 JOB No. 6266-02-005

DATE 06/15/16

OVERALL
 SITE PLAN KEY
 PACKAGE 1

SHEET SOD003 I

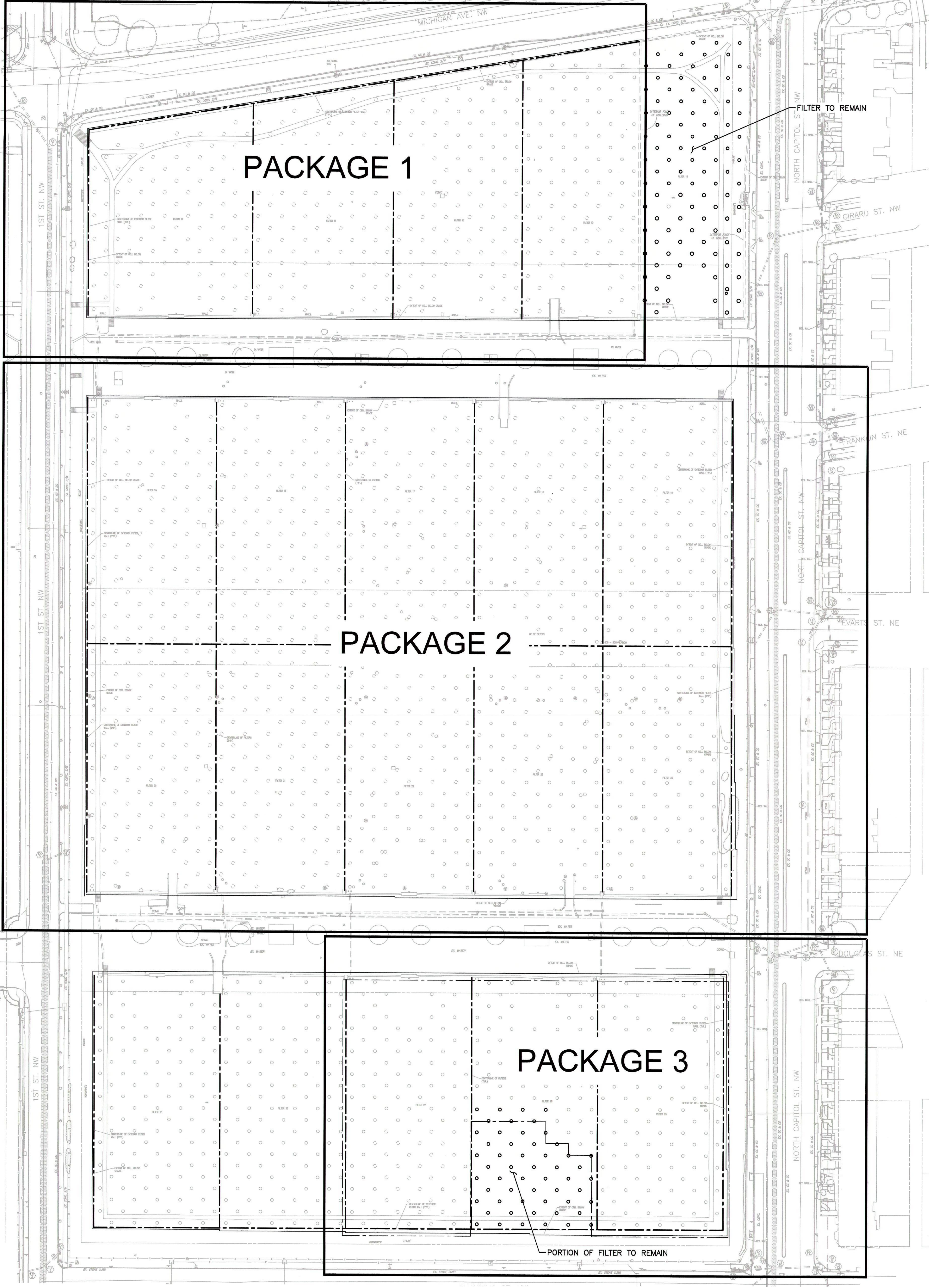

LEGEND:

- LIMITS OF DEMOLITION
- FILTER TO BE DEMOLISHED
- FILTER TO REMAIN

CAUTION!!
 THE LOCATIONS OF ALL EXISTING UNDERGROUND UTILITIES SHOWN ON THIS PLAN ARE BASED UPON ABOVE GROUND EVIDENCE (INCLUDING, BUT NOT LIMITED TO, MANHOLES, INLETS, VALVES, AND MARKS MADE UPON THE GROUND BY OTHERS) AND ARE SPECULATIVE IN NATURE. THERE MAY ALSO BE OTHER EXISTING UNDERGROUND UTILITIES FOR WHICH THERE IS NO ABOVE GROUND EVIDENCE OR FOR WHICH NO ABOVE GROUND EVIDENCE WAS OBSERVED. THE EXACT LOCATIONS OF SAID EXISTING UNDERGROUND UTILITIES SHALL BE VERIFIED BY THE CONTRACTOR PRIOR TO ANY AND ALL CONSTRUCTION.

MISS UTILITY
 CALL DC ONE CALL "DOC" AT 1-800-257-7777 48 HOURS PRIOR TO THE START OF WORK. THE EXCAVATOR MUST NOTIFY ALL PUBLIC UTILITY COMPANIES WITH UNDER GROUND FACILITIES IN THE AREA OF PROPOSED EXCAVATION AND HAVE THOSE FACILITIES LOCATED BY THE UTILITY COMPANIES PRIOR TO COMMENCING EXCAVATION. THE EXCAVATOR IS RESPONSIBLE FOR COMPLIANCE WITH REQUIREMENTS OF THE DISTRICT OF COLUMBIA CODES AND REGULATIONS.

OVERALL SITE PLAN KEY - PACKAGE 1
 SCALE: 1"=60'-0"

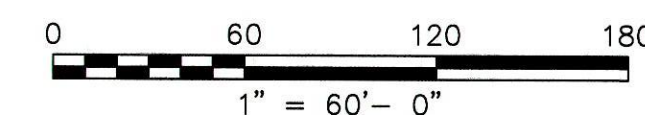

Cad file name: X:\2015\1517010 - Vision McMillan Reserach\CAD\Design\Working\Design Packages\Package 1\SOD003_1 - Overall Site Plan Key_Ph 1.dwg 6/14/2016

OFFICIAL
 GOVERNMENT OF THE DISTRICT OF COLUMBIA
 PERMIT OPERATIONS DIVISION
 PLANS APPROVED

Permit No. 16634

These plans are complete and approved in accordance with any corrections noted on this permit. It is a condition of this permit that the contractor shall construct in accordance with the approved plans and does not waive any code requirements. All work must be done in accordance with the approved plans and no inspection will be made if approved plans are not available. Issuance of permit does not prevent field inspections from ordering corrections to meet codes when issues are noted during inspection. No on-site changes to approved drawings, changes or modifications to the plans require approval with additional permit fee. This permit does not constitute approval for any work requiring a Supplemental Permit, e.g. Electrical or Plumbing.

McMILLAN
 SITE DEVELOPMENT
 PACKAGE
 LOT 800; SQUARE 3128
 WASHINGTON, DC

OWNER
 DISTRICT OF COLUMBIA
 Office of the Deputy Mayor for Planning &
 Economic Development
 1350 Pennsylvania Ave. NW
 Washington, DC 20004
 Tel. (202) 727-6365

DEVELOPER
 VISION McMILLAN PARTNERS
 1508 U Street NW
 Washington, DC 20009
 Tel. (202) 462-1092

CONSULTANTS
ARCHITECT
 PERKINS EASTMAN DC
 1250 23rd Street NW
 Suite 475
 Washington, DC 20037
 Tel. (202) 495-7430

LANDSCAPE ARCHITECT
 NELSON BYRD WOLTZ
 310 East Market Street
 Charlottesville, VA 22902
 Tel. (434) 984-1358

STRUCTURAL ENGINEER
 SILMAN ASSOCIATES
 1053 31st Street NW
 Washington, DC 20007
 Tel. (202) 333-6230

MEP ENGINEER
 SETTY & ASSOCIATES
 INTERNATIONAL, PLLC
 5185 MacArthur Boulevard NW
 Suite 220
 Washington, DC 20016
 Tel. (202) 393-1523

LIGHTING DESIGN
 STROIK LIGHTING DESIGN
 1470 Waggaman Circle
 McLean, VA 22101
 Tel. (703) 829-0548

HISTORIC PRESERVATION
 EHT TRACERIES
 1121 5th Street NW
 Washington, DC 20001
 Tel. (202) 393-1199

CIVIL ENGINEER
 BOWMAN CONSULTING DC PC
 888 17th Street NW
 Suite 202
 Washington, DC 20006
 Tel. (202) 750-2474

SOE/GEOTECHNICAL ENGINEER
 GEI CONSULTANTS
 1620 I Street NW
 Suite 800
 Washington, DC 20006
 Tel. (202) 828-9510

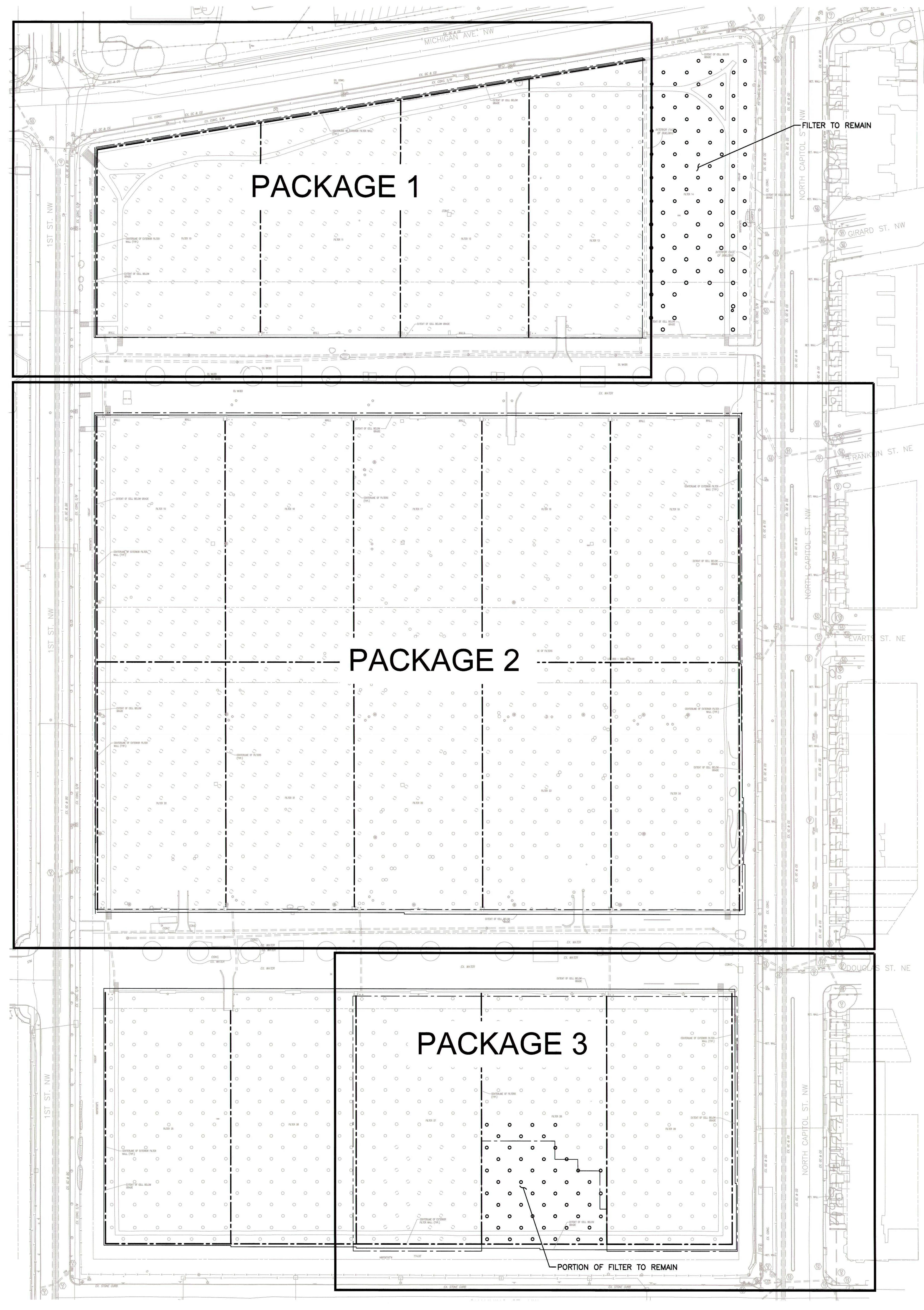
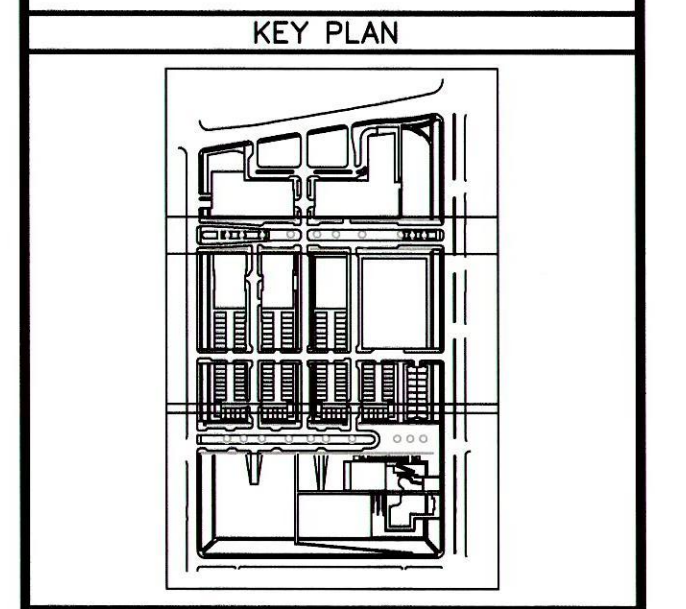

LEGEND:

--- LIMITS OF DEMOLITION

○ FILTER TO BE DEMOLISHED

○ FILTER TO REMAIN

OVERALL SITE PLAN KEY - PACKAGE 2
 SCALE: 1"=60'-0"

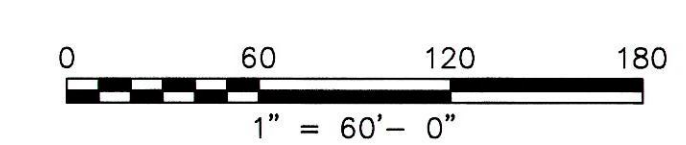

CAUTION!!
 THE LOCATIONS OF ALL EXISTING UNDERGROUND UTILITIES SHOWN ON THIS PLAN ARE BASED UPON ABOVE GROUND EVIDENCE (INCLUDING, BUT NOT LIMITED TO, MANHOLES, INLETS, VALVES, AND MARKS MADE UPON THE GROUND BY OTHERS) AND ARE SPECULATIVE IN NATURE. THERE MAY ALSO BE OTHER EXISTING UNDERGROUND UTILITIES FOR WHICH THERE IS NO ABOVE GROUND EVIDENCE OR FOR WHICH NO ABOVE GROUND EVIDENCE WAS OBSERVED. THE EXACT LOCATIONS OF SAID EXISTING UNDERGROUND UTILITIES SHALL BE VERIFIED BY THE CONTRACTOR PRIOR TO ANY AND ALL CONSTRUCTION.

MISS UTILITY
 CALL DC ONE CALL "DOC" AT 1-800-257-7777 48 HOURS PRIOR TO THE START OF WORK. THE EXCAVATOR MUST NOTIFY ALL PUBLIC UTILITY COMPANIES WITH UNDER GROUND FACILITIES IN THE AREA OF PROPOSED EXCAVATION AND HAVE THOSE FACILITIES LOCATED BY THE UTILITY COMPANIES PRIOR TO COMMENCING EXCAVATION. THE EXCAVATOR IS RESPONSIBLE FOR COMPLIANCE WITH REQUIREMENTS OF THE DISTRICT OF COLUMBIA CODES AND REGULATIONS.

| PLAN STATUS | |
|-------------|------|
| NO. | DATE |
| | |
| | |
| | |
| | |
| | |
| | |
| | |
| | |
| | |
| | |
| | |
| | |
| | |
| | |

| PL | TBM | CAB |
|--------|-------|------|
| DESIGN | DRAWN | CHKD |
| | | |

JOB No. 6266-02-005
 DATE 06/15/16
OVERALL SITE PLAN KEY PACKAGE 2
SOD003_2
 SHEET

