



Existing



— ADDITIONAL SHADE

Proposed



— ADDITIONAL SHADE FROM PROPOSED

Matter of Right



SUMMER SOLSTICE- 3:00 PM

Washington, DC  
Latitude: 38.915453N Longitude: 77.034865W

FOR DESIGN PURPOSES ONLY

schematic design for:

1832 15th St NW

Washington, DC

12.09.19

Board of Zoning Adjustment

District of Columbia

CASE NO. 2014

EXHIBIT NO. 81B

SS 1.06



Existing

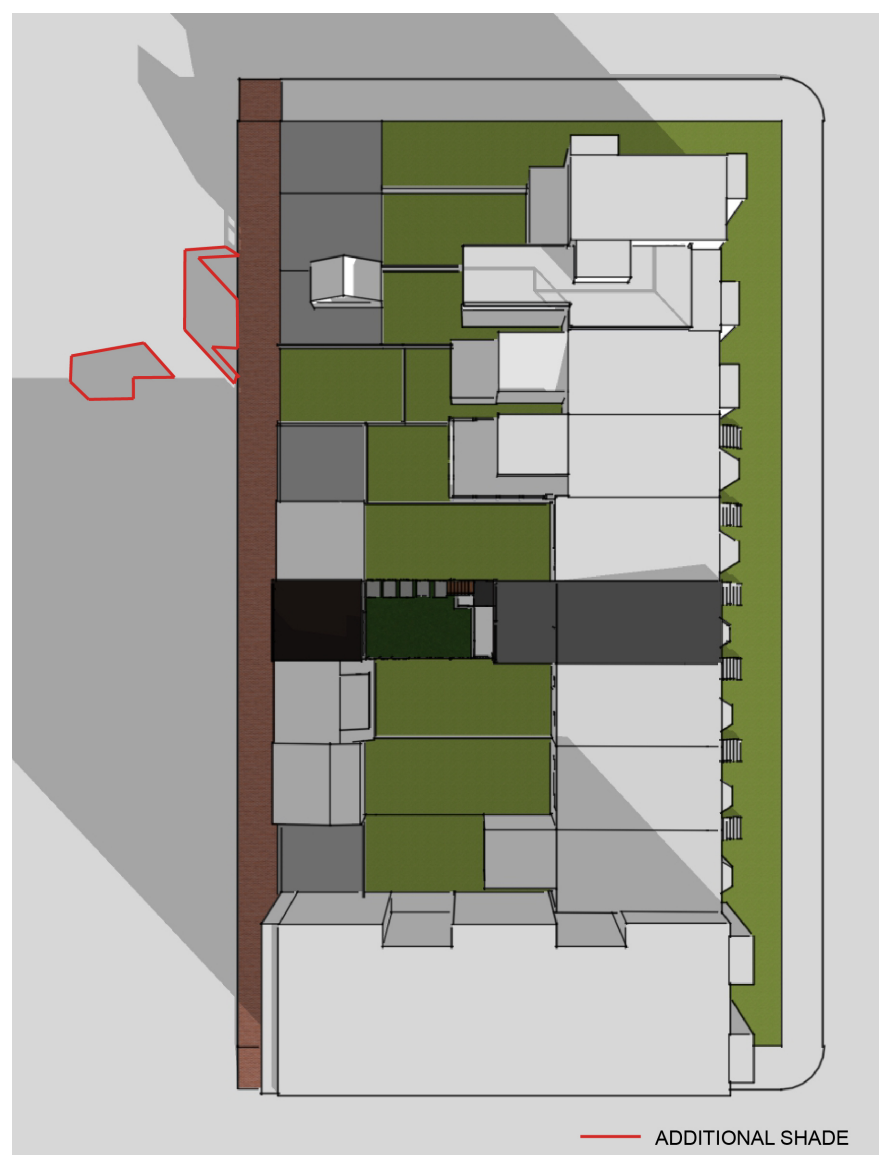

— ADDITIONAL SHADE

Proposed



Matter of Right



WINTER SOLSTICE - 9:00 AM

Washington, DC  
Latitude: 38.915453N Longitude: 77.034865W

FOR DESIGN PURPOSES ONLY

schematic design for:

1832 15th St NW

Washington, DC

12.09.19

date

SS-1.07



Existing



— ADDITIONAL SHADE

Proposed



— ADDITIONAL SHADE FROM PROPOSED

Matter of Right



WINTER SOLSTICE - 12:00 PM

Washington, DC  
Latitude: 38.915453N Longitude: 77.034865W

FOR DESIGN PURPOSES ONLY

schematic design for:

1832 15th St NW

Washington, DC

12.09.19

date

SS-1.08



Existing



— ADDITIONAL SHADE

Proposed



Matter of Right



WINTER SOLSTICE - 3:00 PM

Washington, DC  
Latitude: 38.915453N Longitude: 77.034865W

FOR DESIGN PURPOSES ONLY

schematic design for:

1832 15th St NW

Washington, DC

12.09.19

date

SS-1.09