

1 10'-0" ADDITION SHADOW STUDY - JUNE 21 @ 9AM  
A0009 NTS

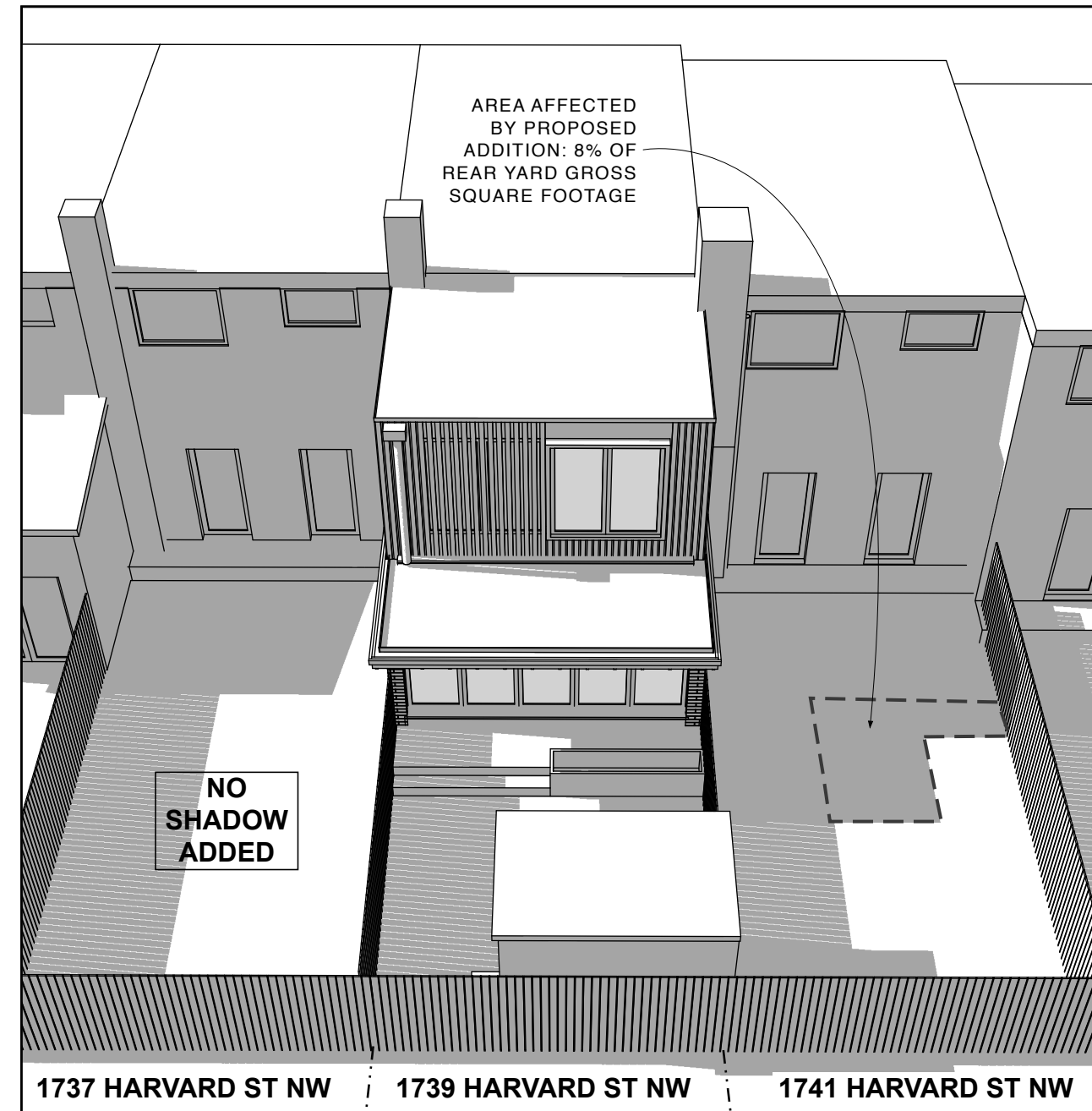

2 PROPOSED ADDITION SHADOW STUDY - JUNE 21 @ 9AM  
A0009 NTS

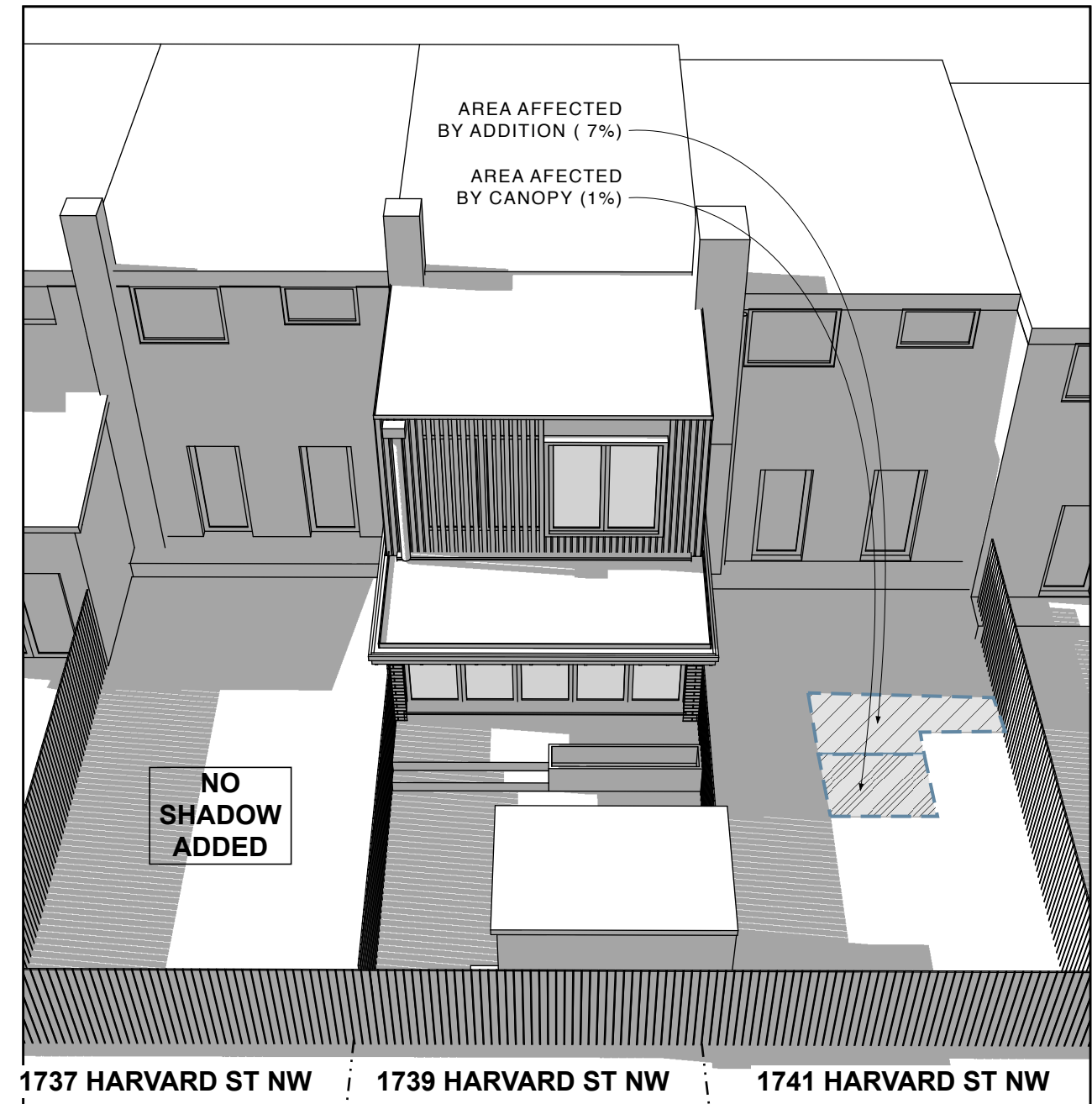

3 DIFFERENCE BETWEEN 10'-0" ADDITION AND PROPOSED ADDITION SHADOWS - JUNE 21 @ 9AM  
A0009 NTS

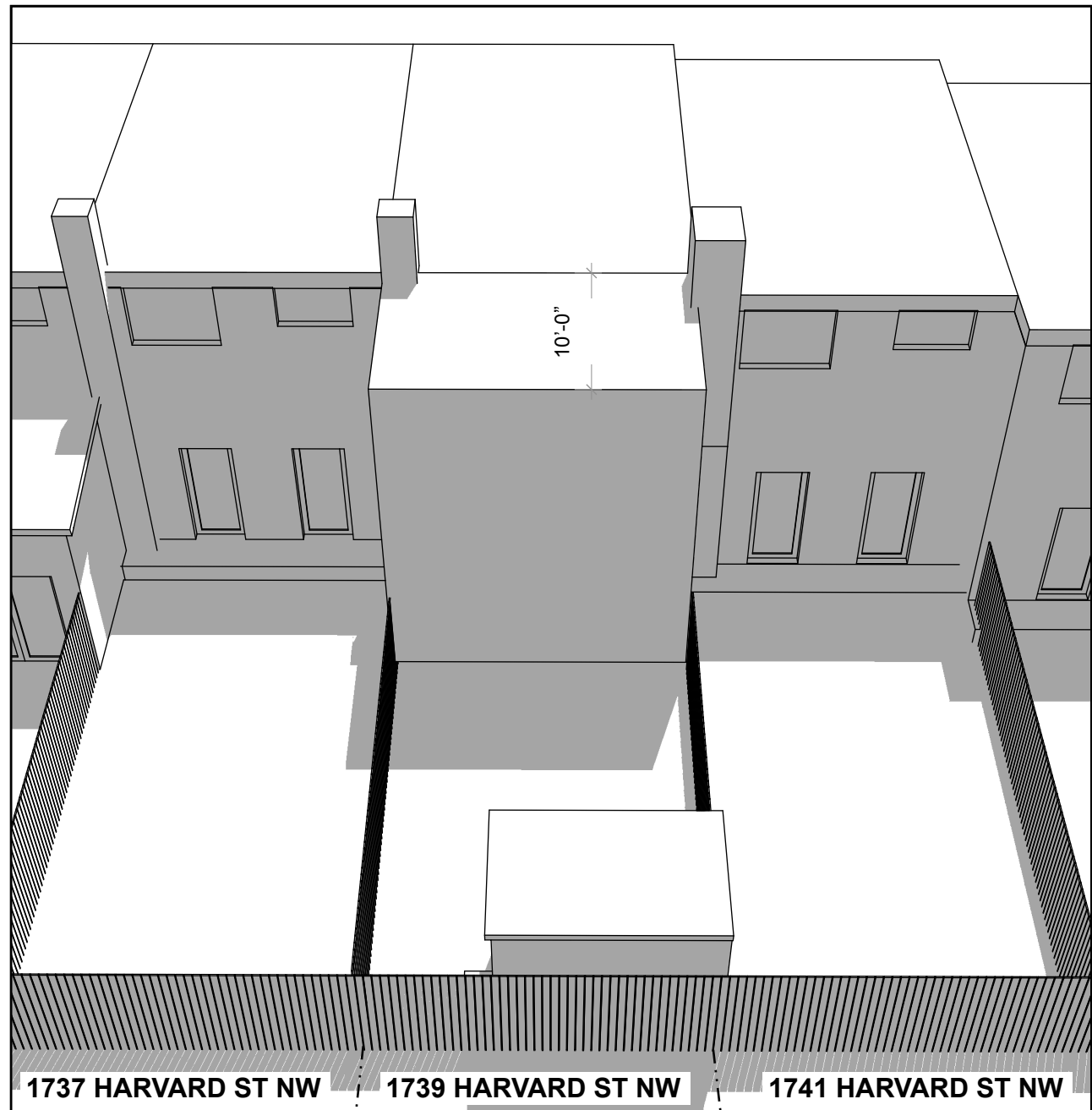

4 10'-0" ADDITION SHADOW STUDY - JUNE 21 @ 1PM  
A0009 NTS

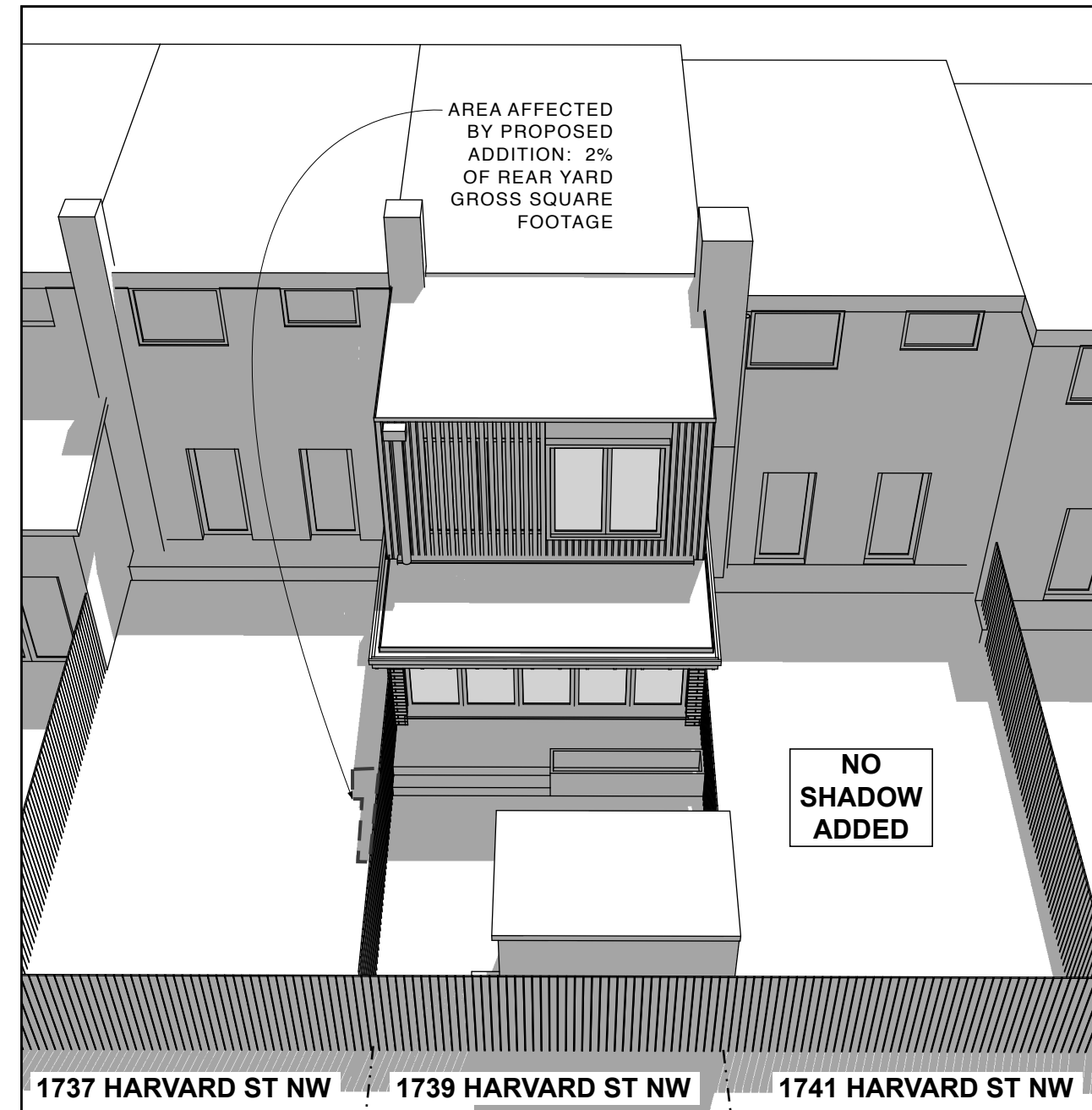

5 PROPOSED ADDITION SHADOW STUDY - JUNE 21 @ 1PM  
A0009 NTS

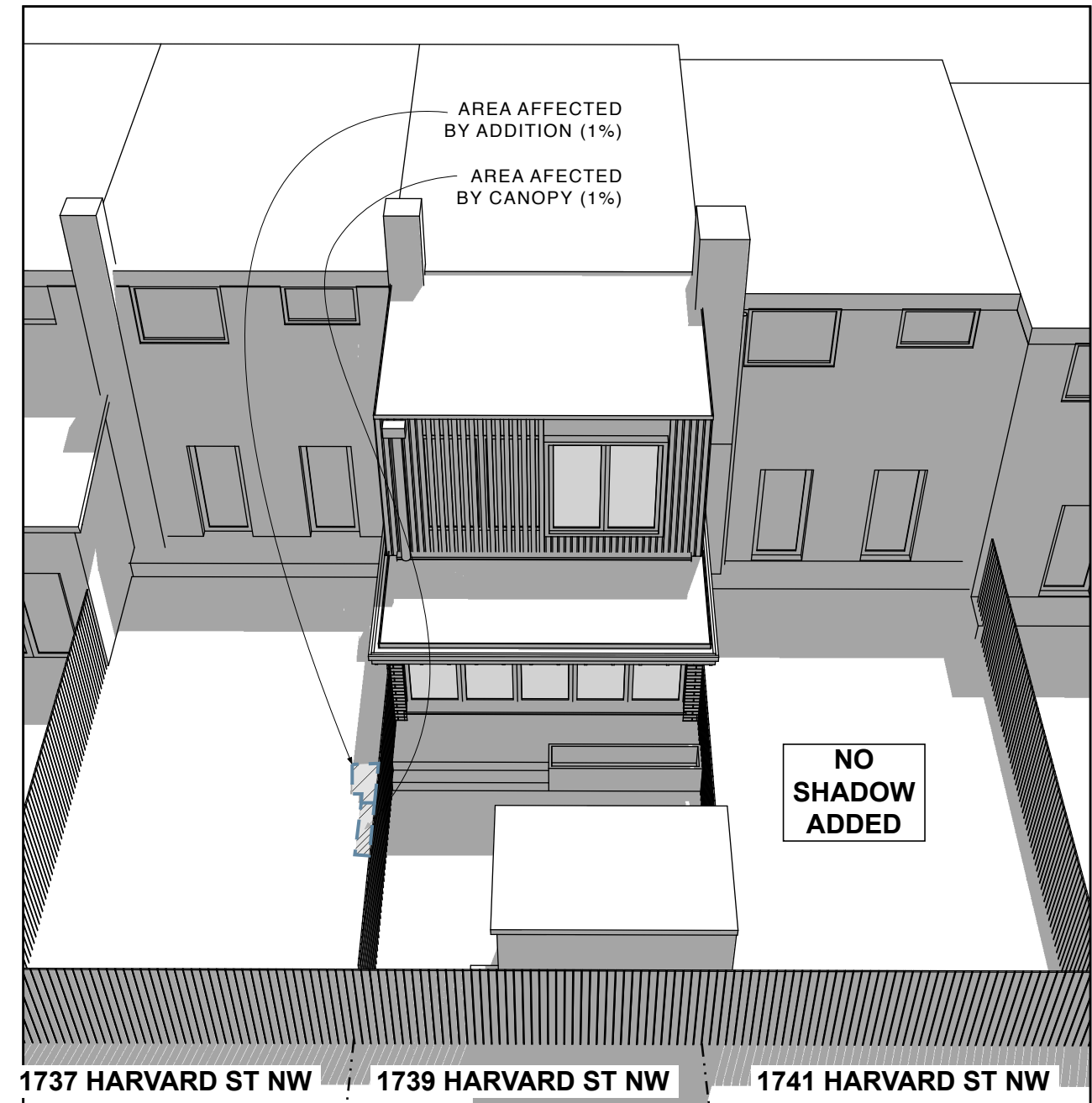

6 DIFFERENCE BETWEEN 10'-0" ADDITION AND PROPOSED ADDITION SHADOWS - JUNE 21 @ 1PM  
A0009 NTS



**Studio CrowleyHall, PLLC**  
1402 Meridian Place, NW  
Washington, DC 20010  
(202)387-3003

**Peng Wu & Adams Ross**  
1739 Harvard Pl, NW  
Washington DC

**SHADOW STUDY**  
JUNE 21

ISSUE 06/25/17 DESIGN REVIEW  
Board of Zoning Adjustment  
District of Columbia  
CASE NO: 13600  
**A0009**

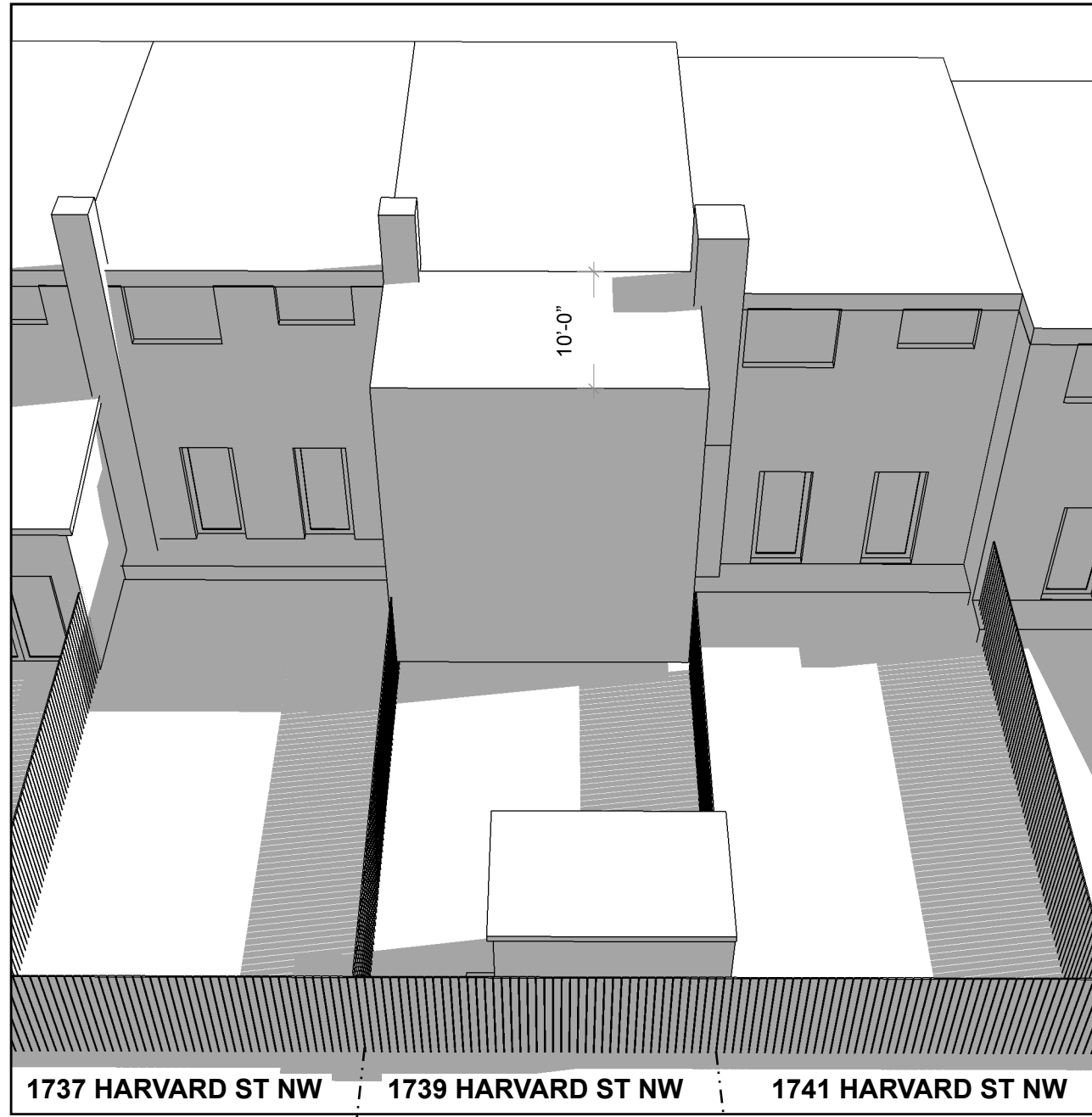

1 10'-0" ADDITION SHADOW STUDY - JUNE 21 @ 4PM  
A0010 NTS

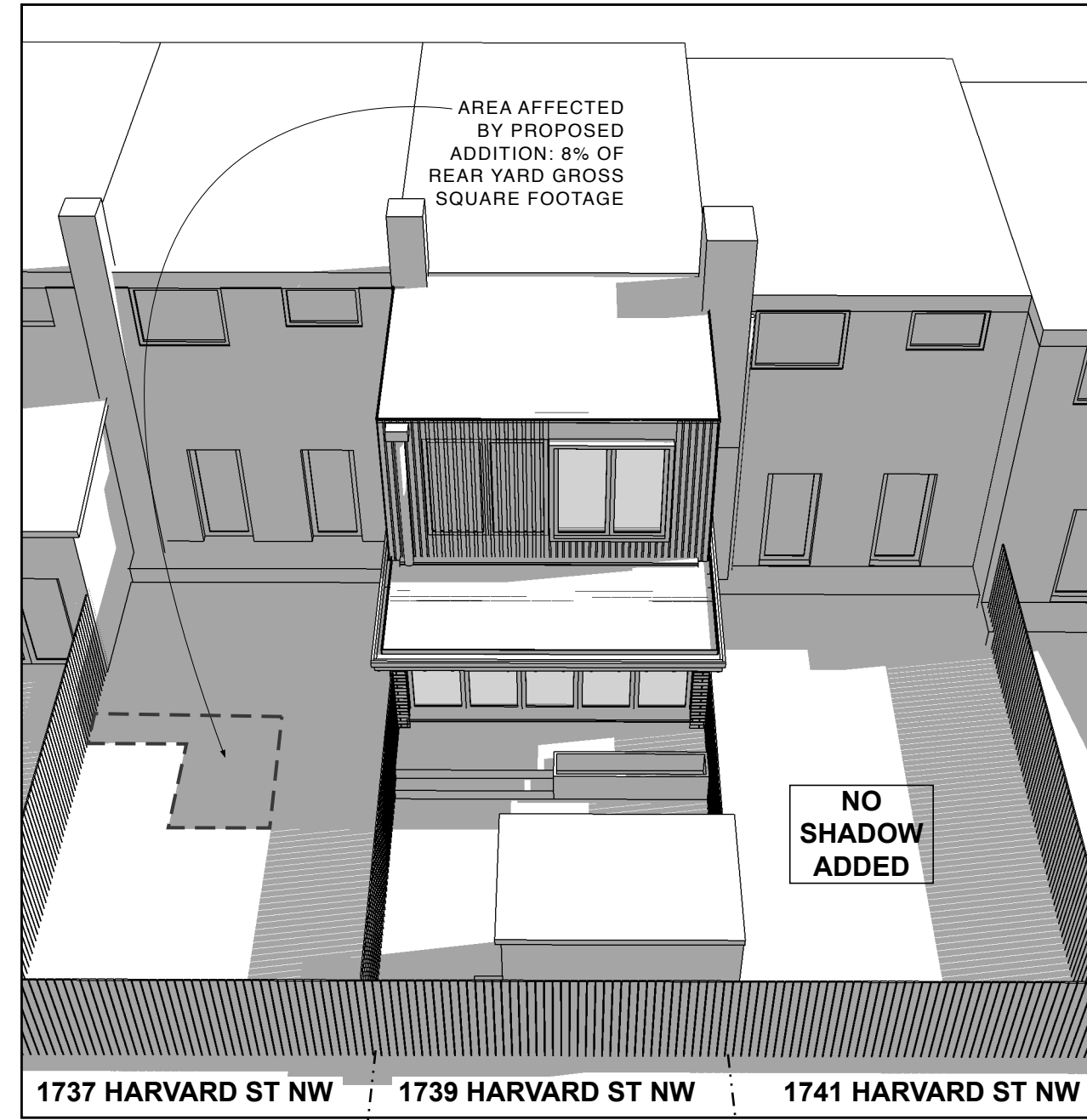

2 PROPOSED ADDITION SHADOW STUDY - JUNE 21 @ 4PM  
A0010 NTS

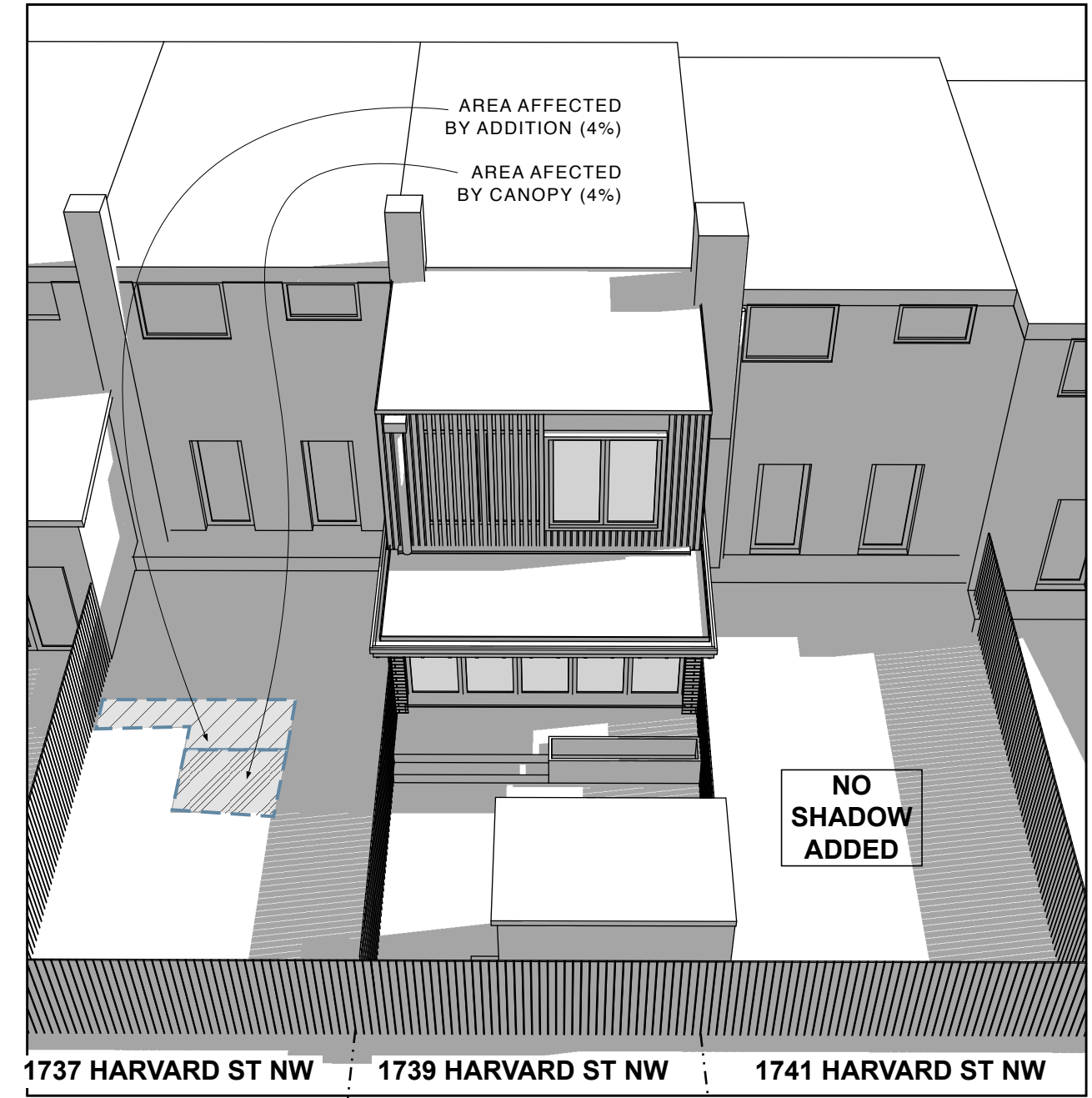

3 DIFFERENCE BETWEEN 10'-0" ADDITION AND PROPOSED ADDITION SHADOWS - JUNE 21 @ 4PM  
A0010 NTS



**Studio CrowleyHall, PLLC**  
1402 Meridian Place, NW  
Washington, DC 20010  
(202)387-3003

**Peng Wu & Adams Ross**  
1739 Harvard Pl, NW  
Washington DC

**SHADOW STUDY**  
JUNE 21, CONT.

**ISSUE**  
09/25/17 DESIGN REVIEW

**A0010**

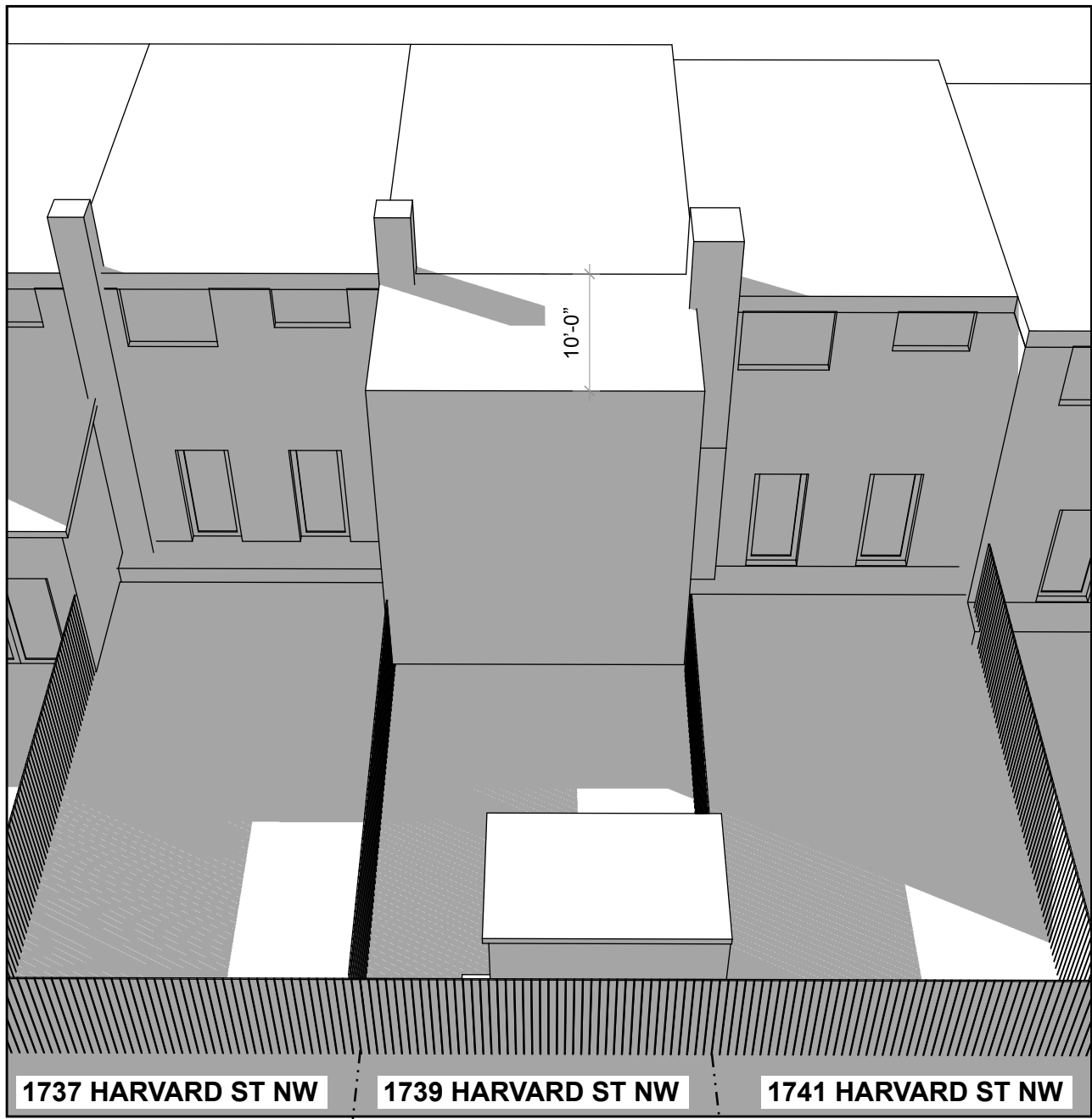

1 10'-0" ADDITION SHADOW STUDY - SEPT 22 @ 9AM  
A0011 NTS

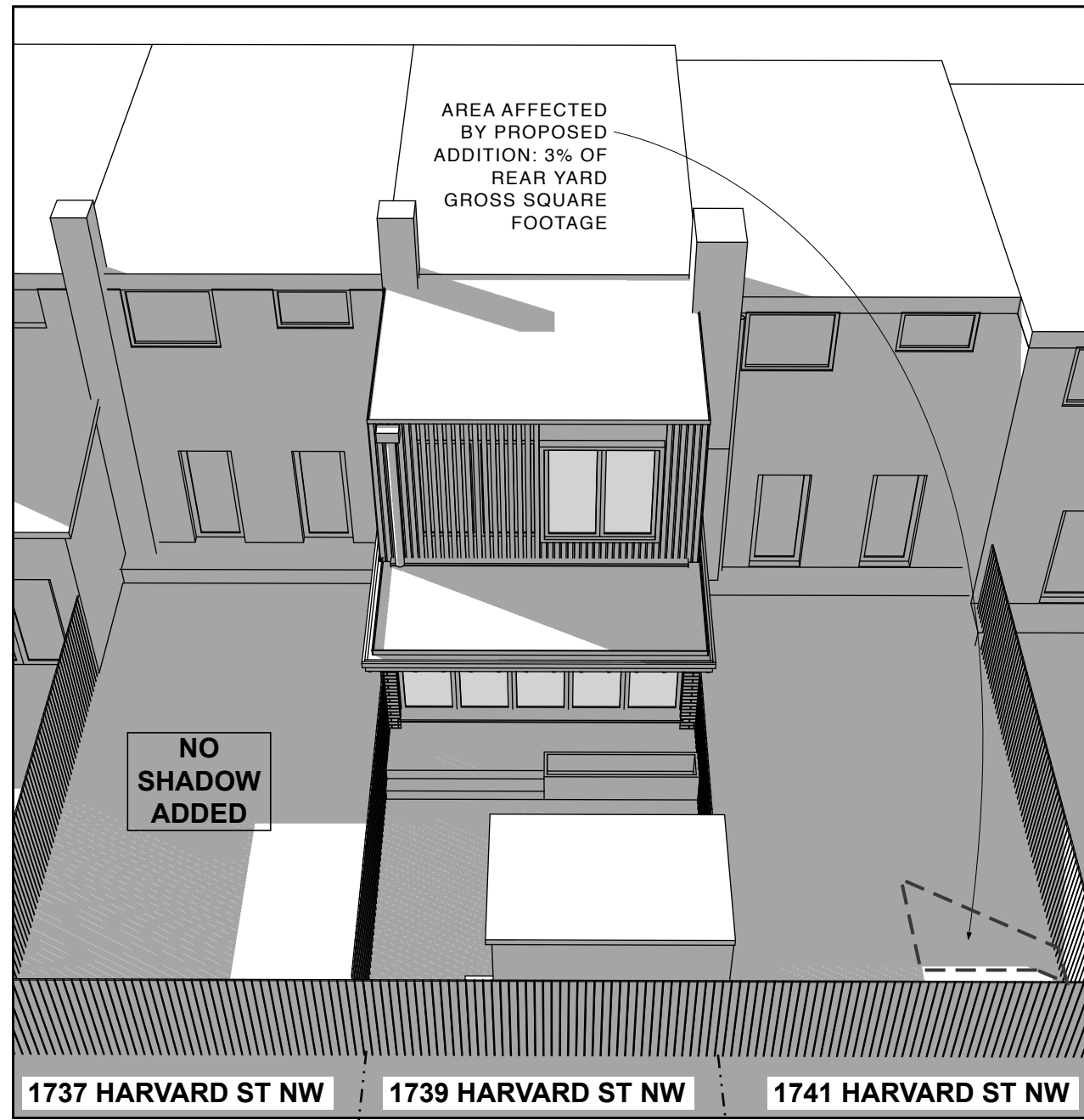

2 PROPOSED ADDITION SHADOW STUDY - SEPT 22 @ 9AM  
A0011 NTS

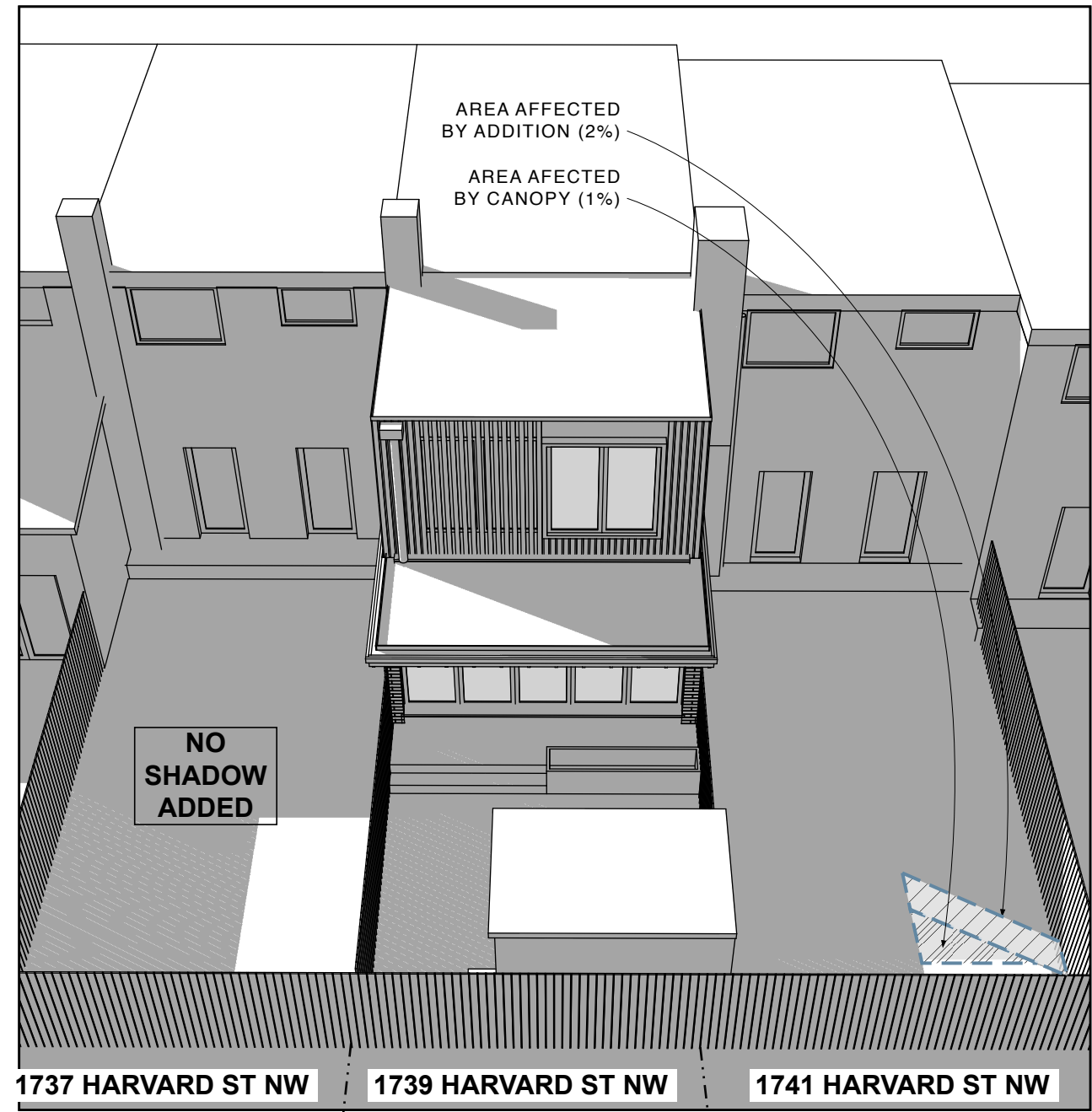

3 DIFFERENCE BETWEEN 10'-0" ADDITION AND PROPOSED ADDITION SHADOWS - SEPT 22 @ 9AM  
A0011 NTS

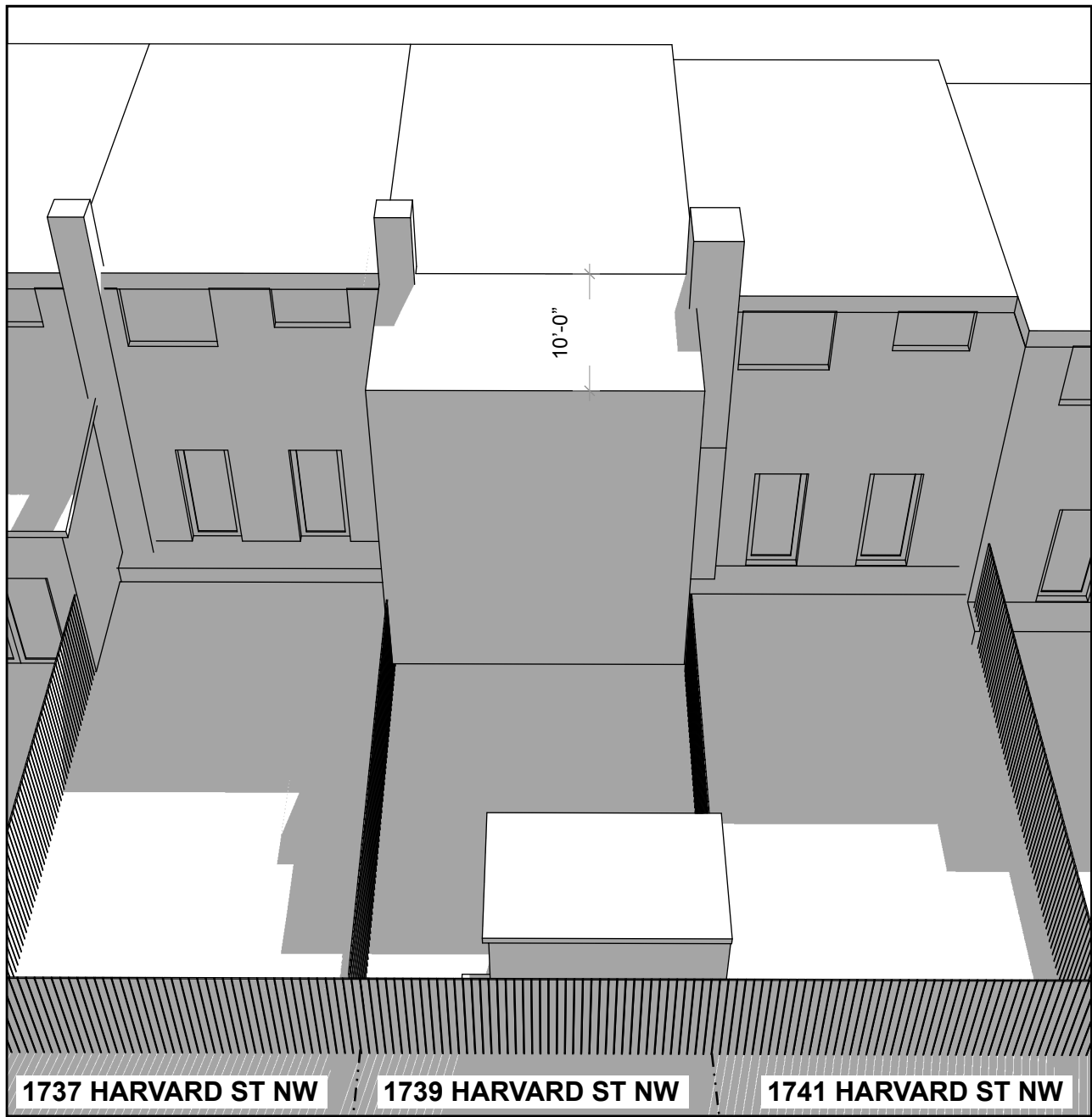

4 10'-0" ADDITION SHADOW STUDY - SEPT 22 @ 1PM  
A0011 NTS

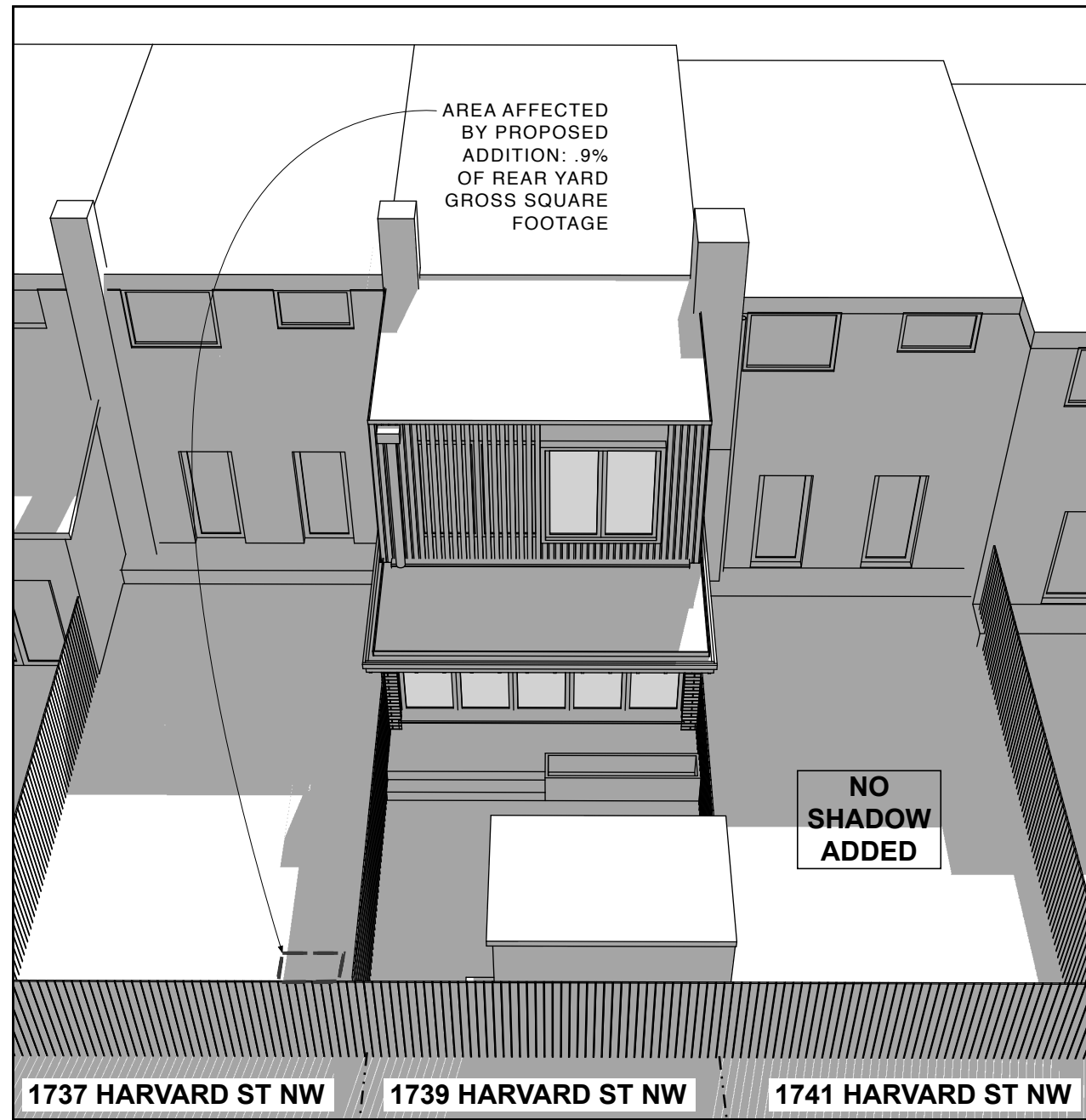

5 PROPOSED ADDITION SHADOW STUDY - SEPT 22 @ 1PM  
A0011 NTS

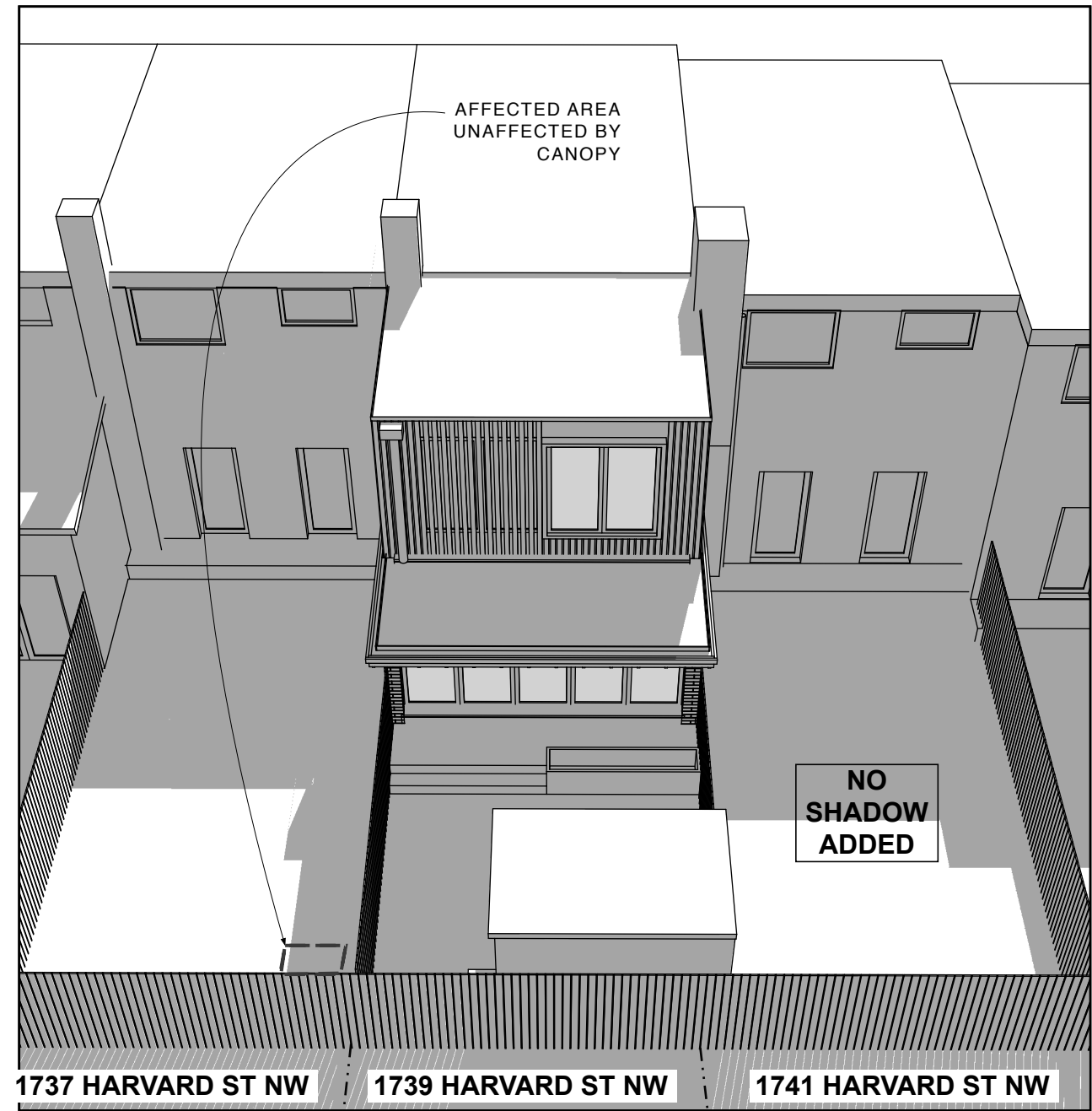

6 DIFFERENCE BETWEEN 10'-0" ADDITION AND PROPOSED ADDITION SHADOWS - SEPT 22 @ 1PM  
A0011 NTS



Studio CrowleyHall, PLLC

1402 Meridian Place, NW  
Washington, DC 20010  
(202)387-3003

Peng Wu & Adams Ross  
1739 Harvard Pl, NW  
Washington DC

SHADOW STUDY  
SEPT. 22

ISSUE  
09/25/17 DESIGN REVIEW

A0011

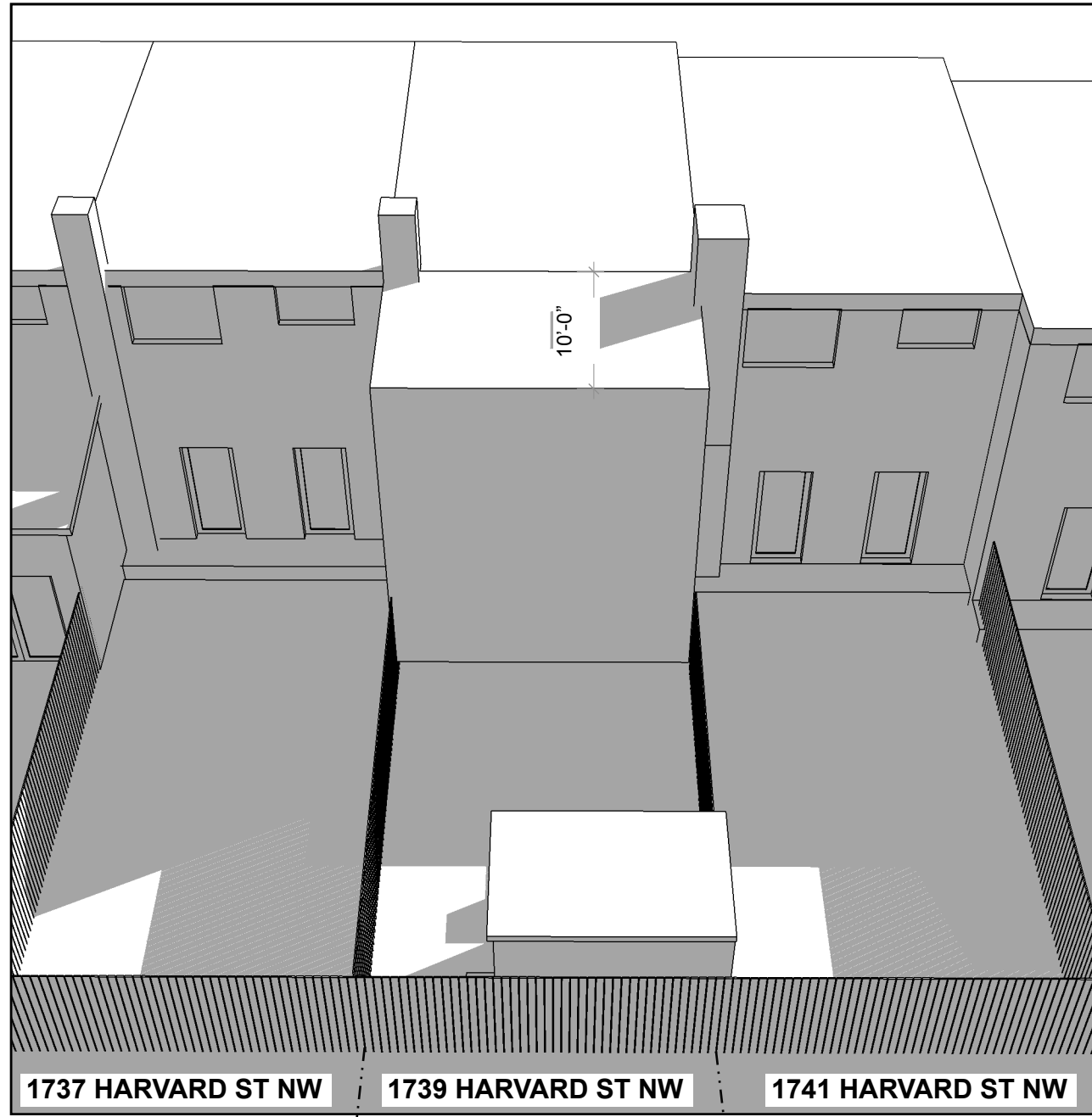

1737 HARVARD ST NW    1739 HARVARD ST NW    1741 HARVARD ST NW

1    10'-0" ADDITION SHADOW STUDY - SEPT 22 @ 4PM  
A0012    NTS

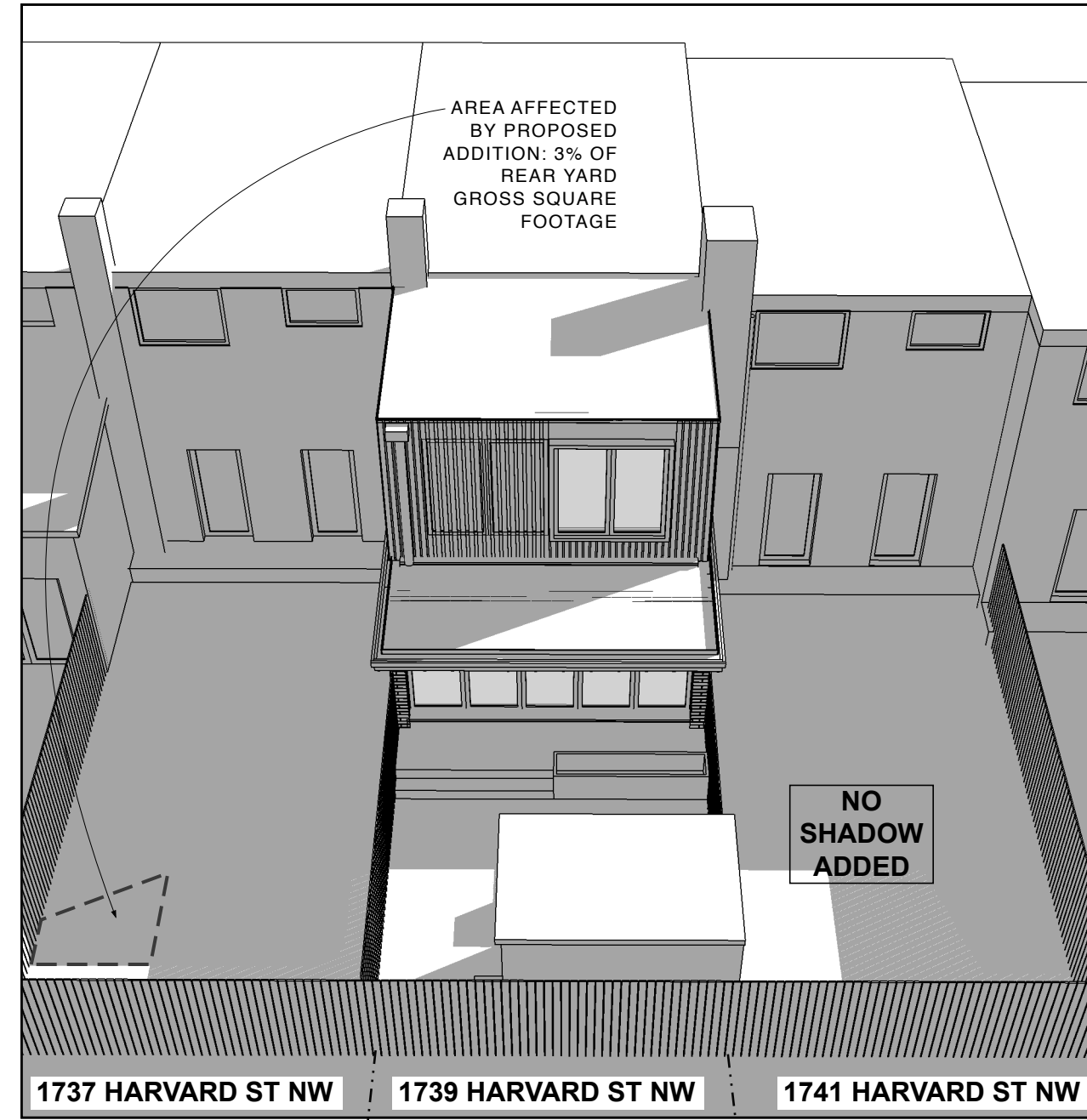

1737 HARVARD ST NW    1739 HARVARD ST NW    1741 HARVARD ST NW

2    PROPOSED ADDITION SHADOW STUDY - SEPT 22 @ 4PM  
A0012    NTS

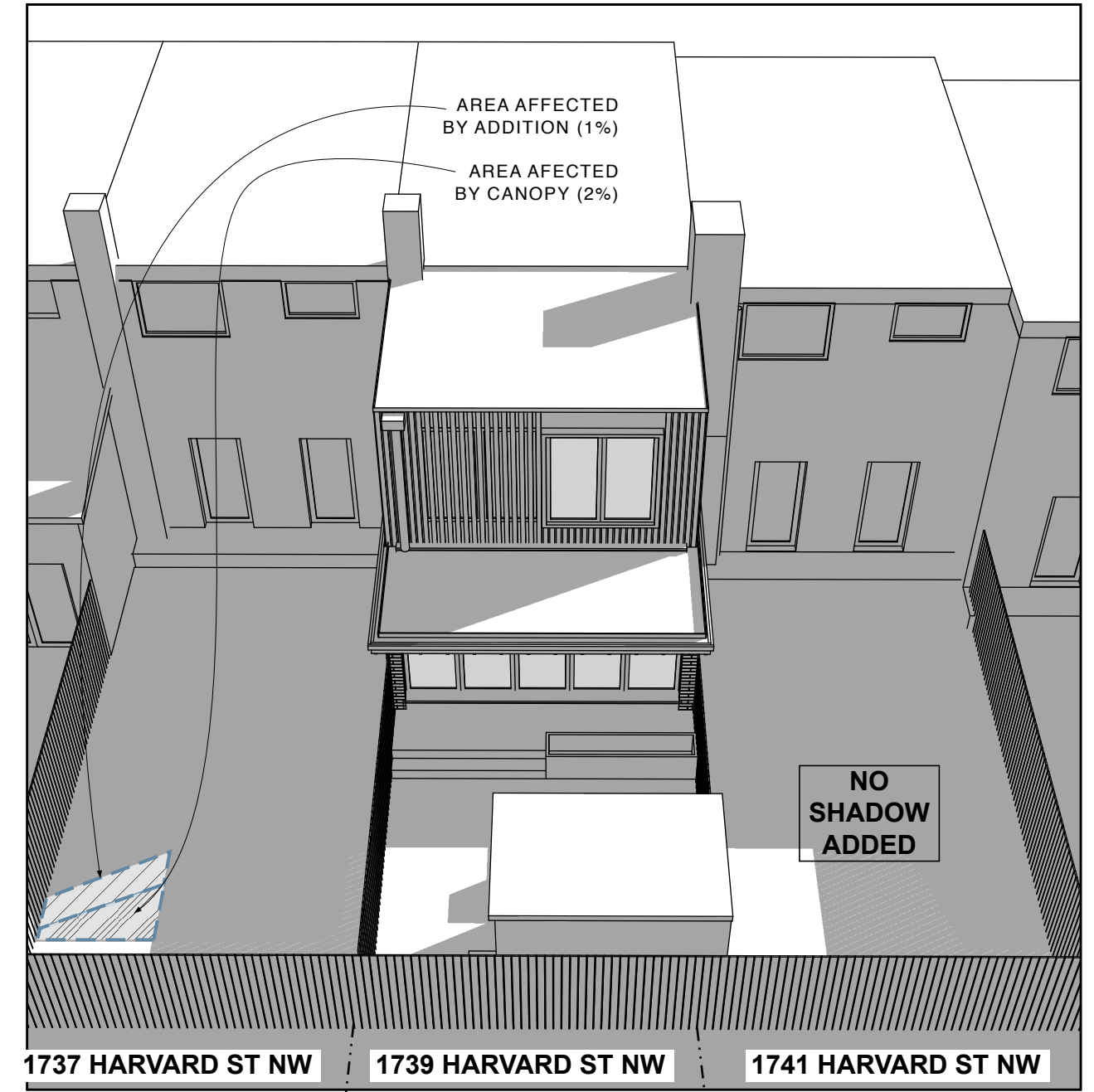

1737 HARVARD ST NW    1739 HARVARD ST NW    1741 HARVARD ST NW

3    DIFFERENCE BETWEEN 10'-0" ADDITION AND PROPOSED ADDITION SHADOWS - SEPT 22 @ 4PM  
A0012    NTS



**Studio CrowleyHall, PLLC**  
1402 Meridian Place, NW  
Washington, DC 20010  
(202)387-3003

**Peng Wu & Adams Ross**  
1739 Harvard Pl, NW  
Washington DC

**SHADOW STUDY**  
**SEPT. 22, CONT.**

**ISSUE**  
09/25/17 DESIGN REVIEW

**A0012**

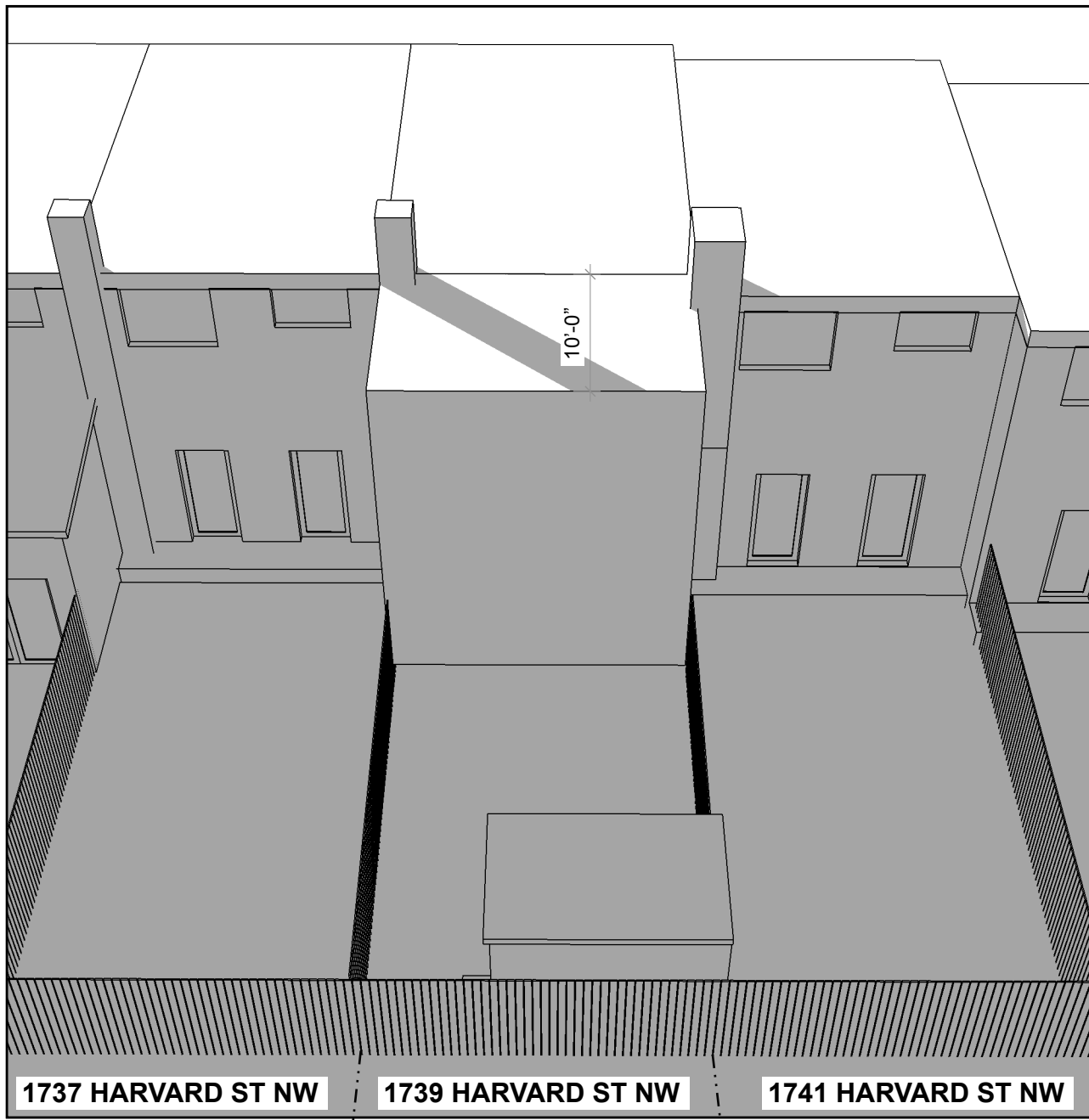

1 10'-0" ADDITION SHADOW STUDY - DEC 21 @ 9AM  
A0013 NTS

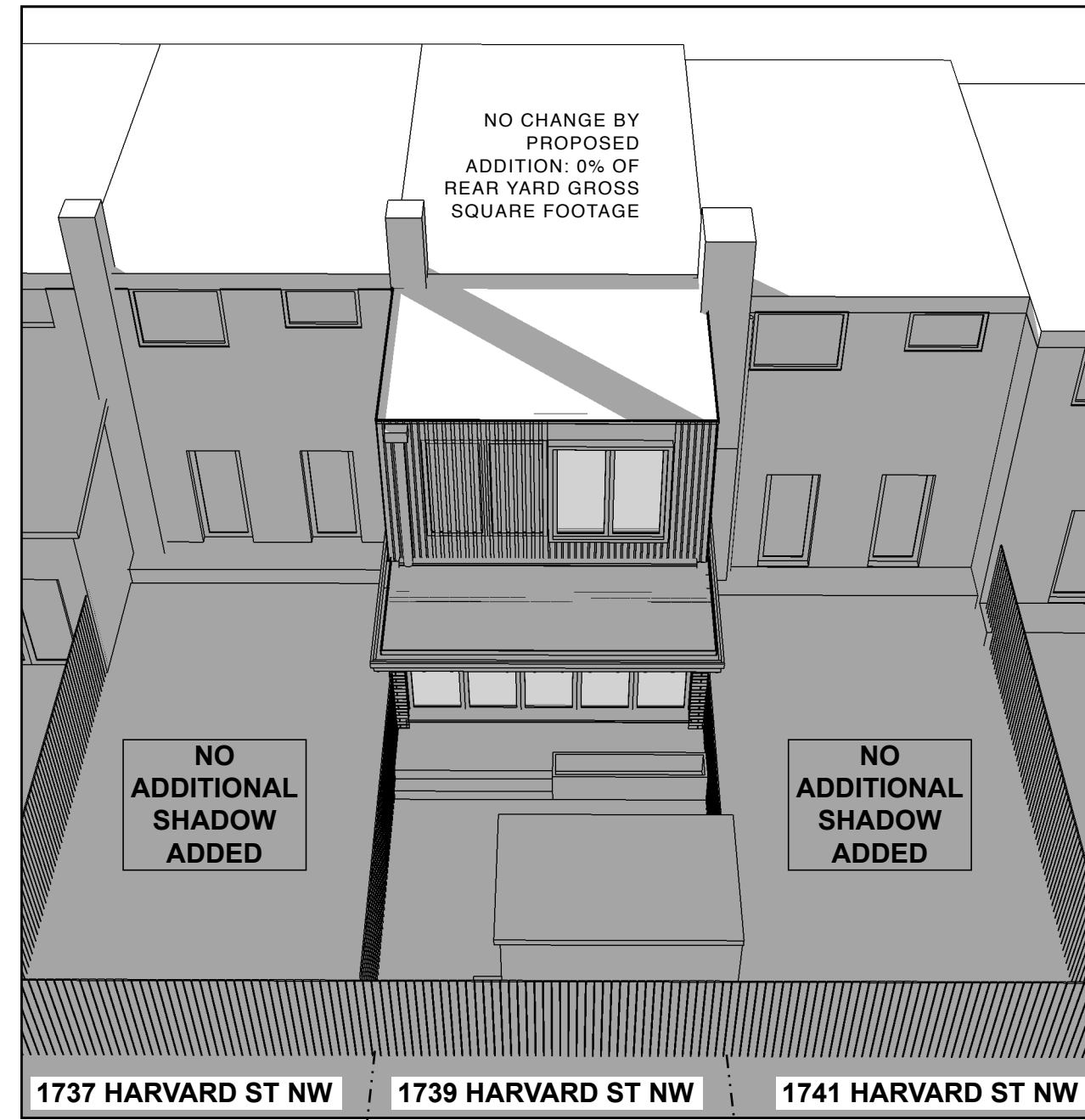

2 PROPOSED ADDITION SHADOW STUDY - DEC 21 @ 9AM  
A0013 NTS

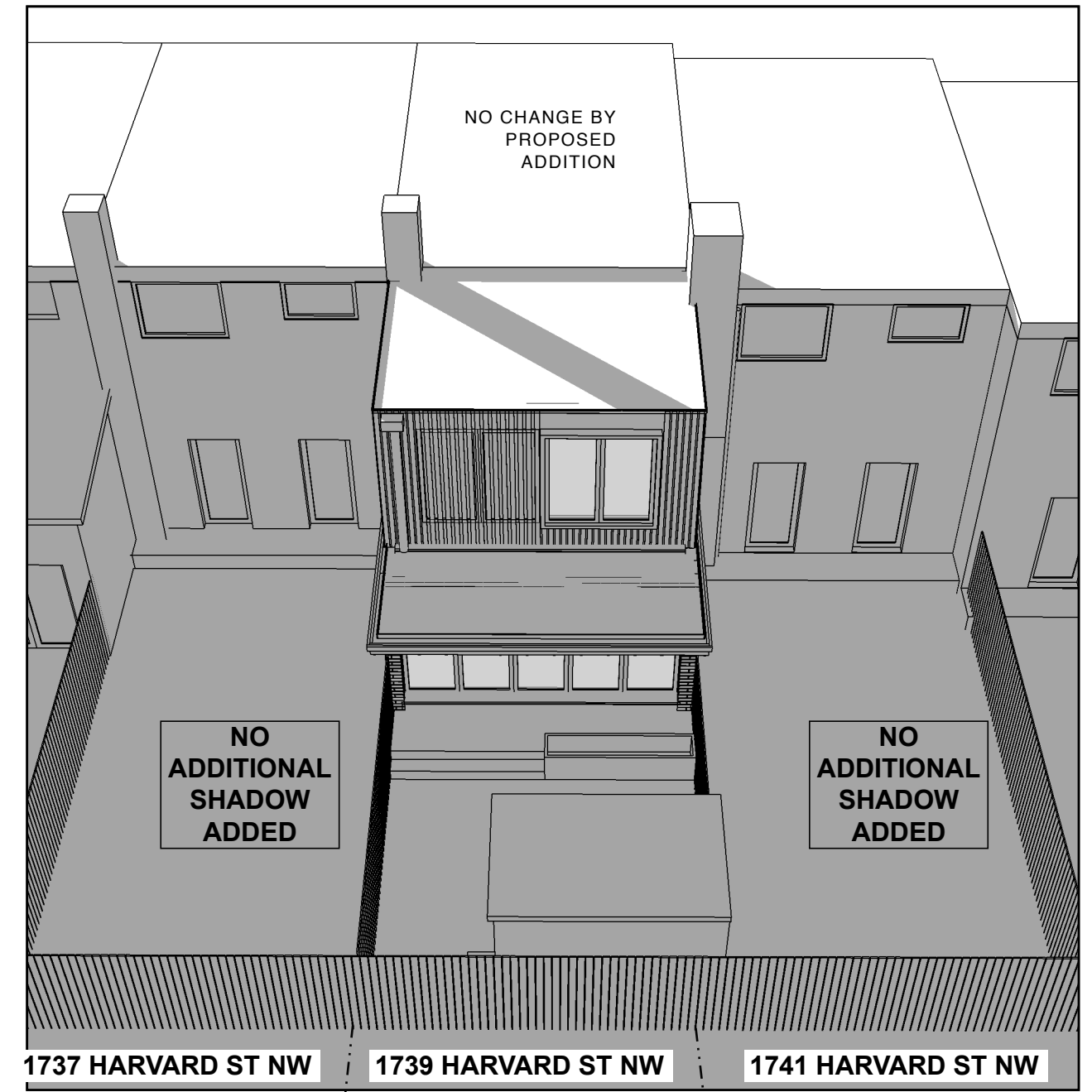

3 DIFFERENCE BETWEEN 10'-0" ADDITION AND PROPOSED ADDITION SHADOWS - DEC 21 @ 9AM  
A0013 NTS

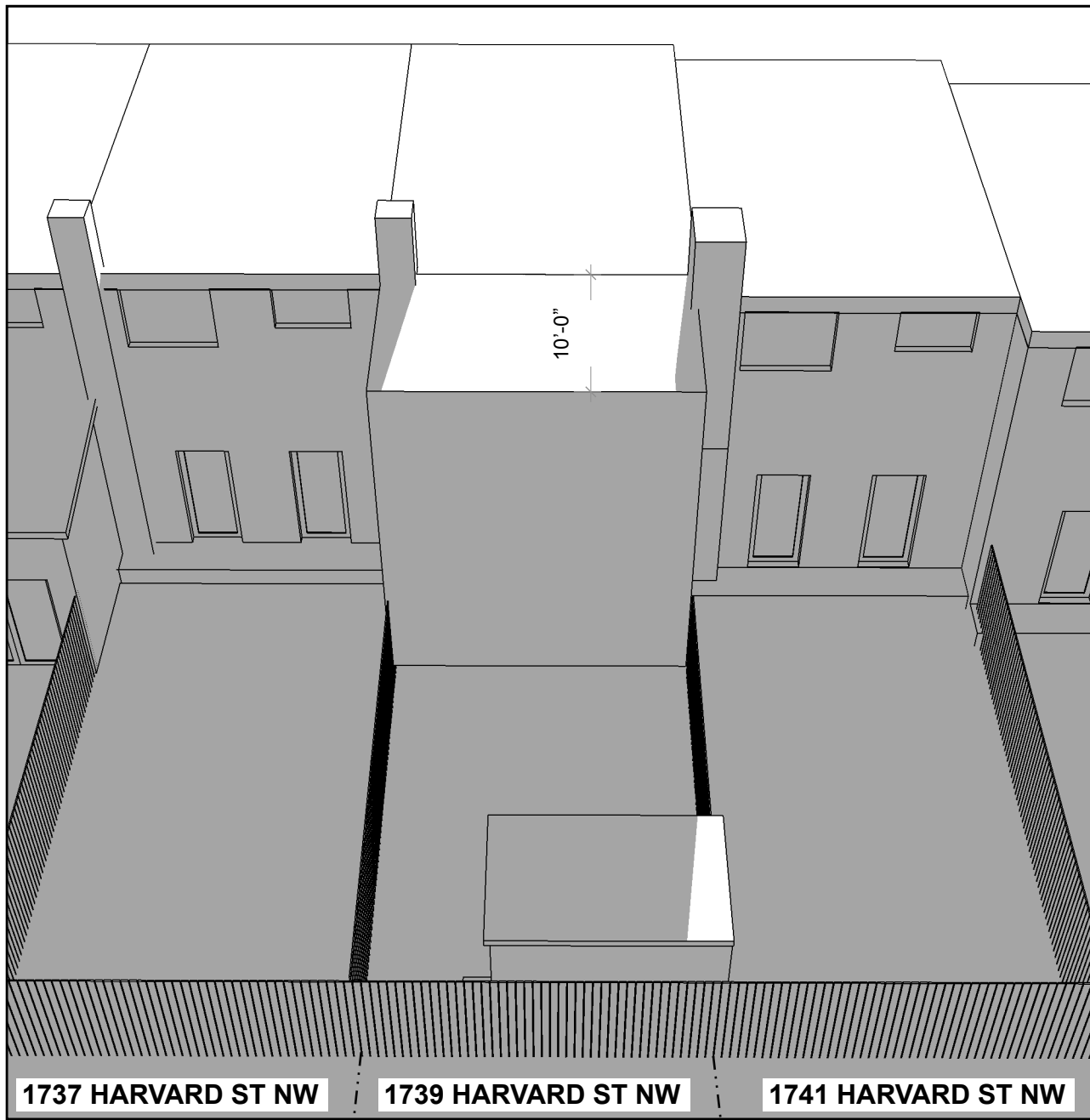

4 10'-0" ADDITION SHADOW STUDY - DEC 21 @ 1PM  
A0013 NTS

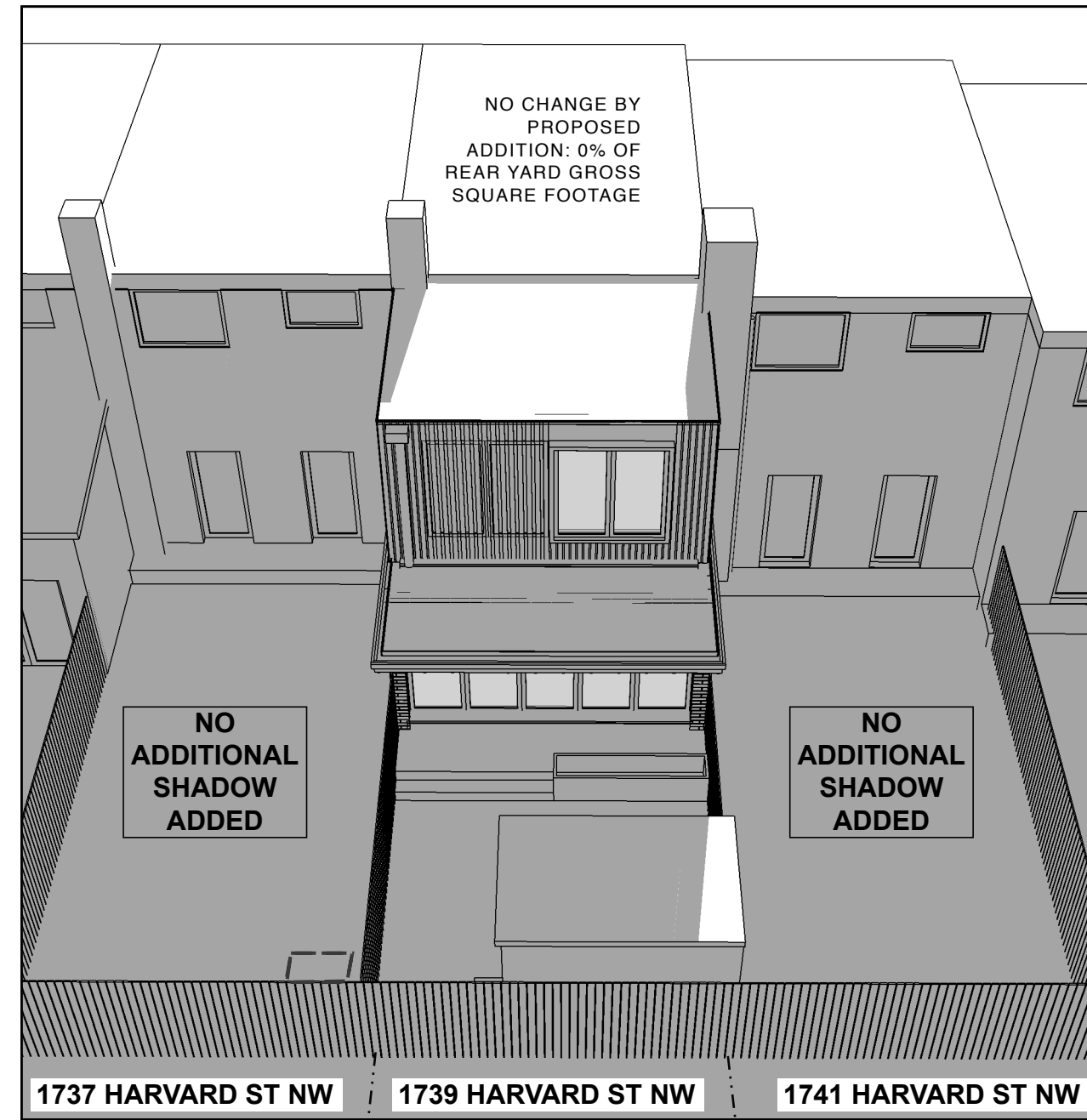

5 PROPOSED ADDITION SHADOW STUDY - DEC 21 @ 1PM  
A0013 NTS

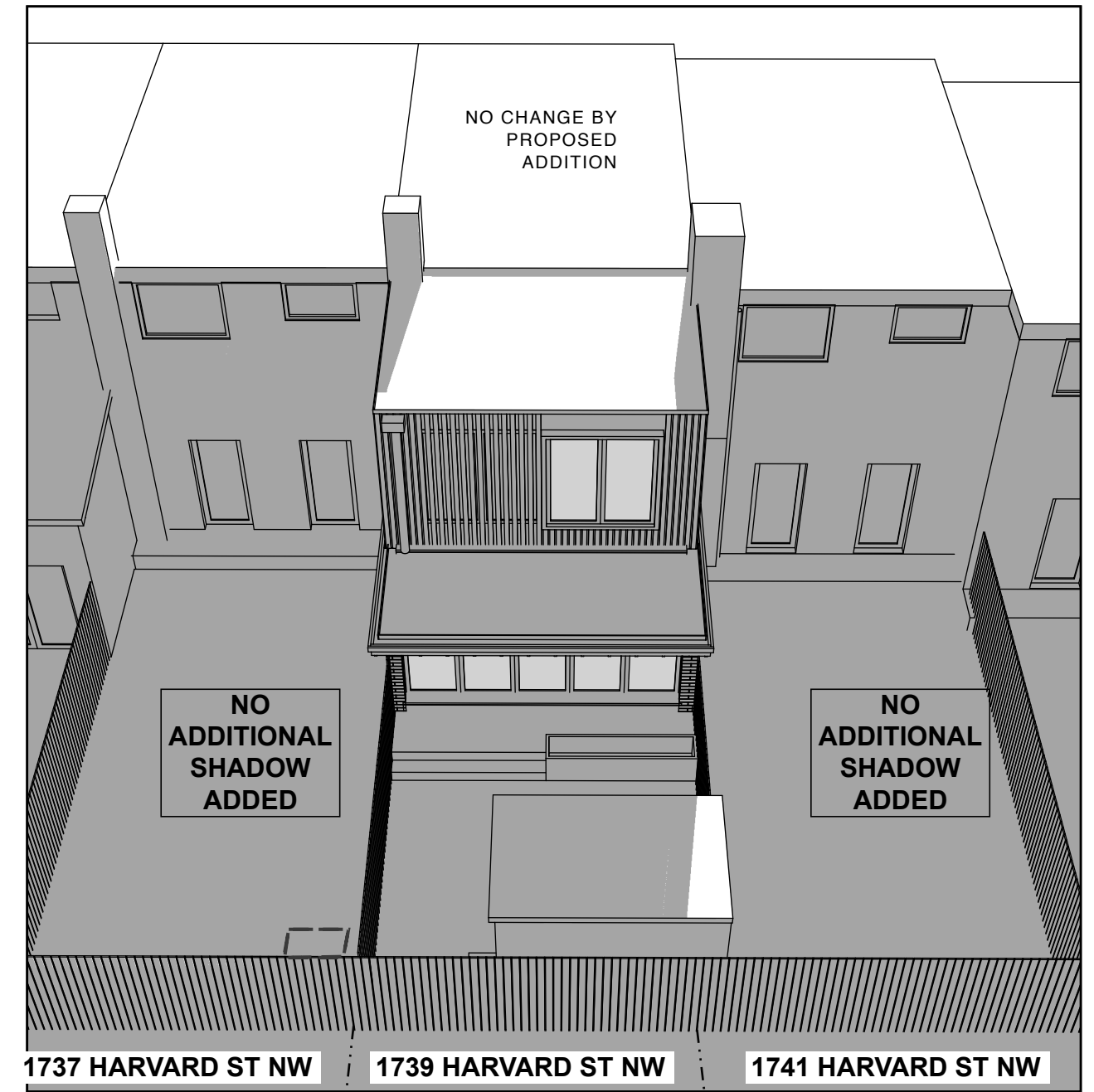

6 DIFFERENCE BETWEEN 10'-0" ADDITION AND PROPOSED ADDITION SHADOWS - DEC 21 @ 1PM  
A0013 NTS



**Studio CrowleyHall, PLLC**  
1402 Meridian Place, NW  
Washington, DC 20010  
(202)387-3003

Peng Wu & Adams Ross  
1739 Harvard Pl, NW  
Washington DC

SHADOW STUDY  
DEC. 21

ISSUE  
09/25/17 DESIGN REVIEW

**A0013**

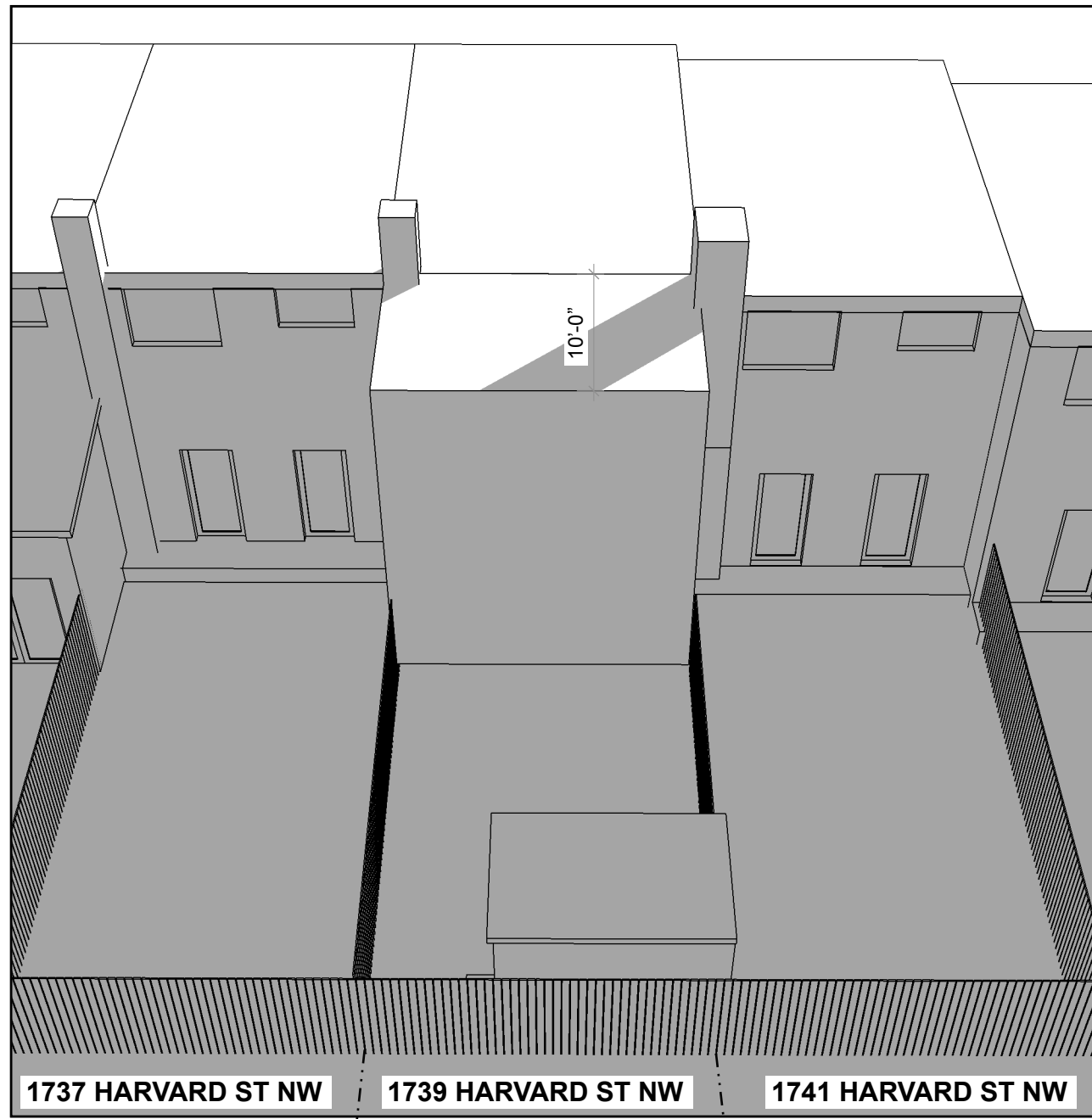

1 10'-0" ADDITION SHADOW STUDY - DEC 21 @ 4 PM  
A0014 NTS

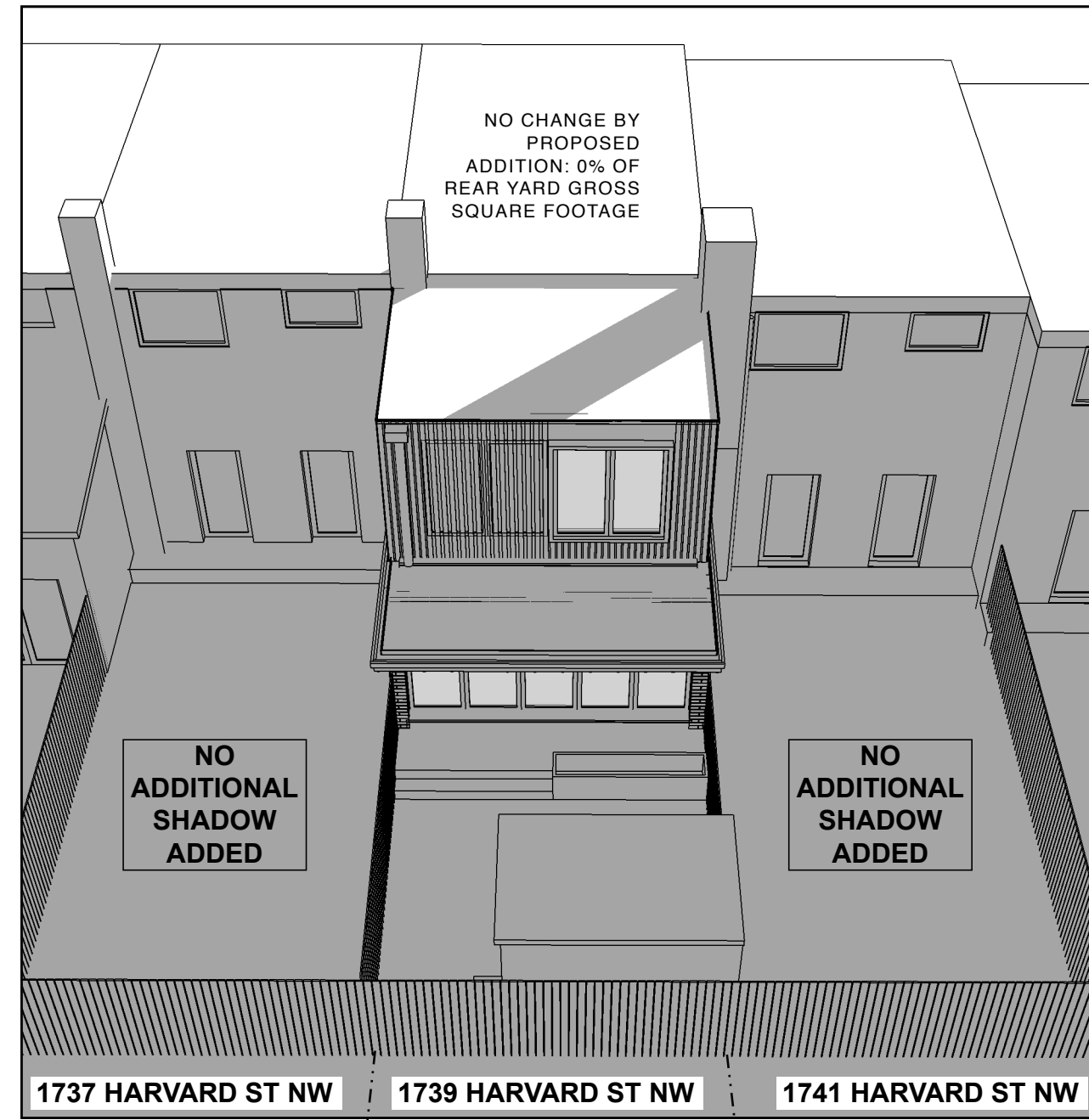

2 PROPOSED ADDITION SHADOW STUDY - DEC 21 @ 4 PM  
A0014 NTS

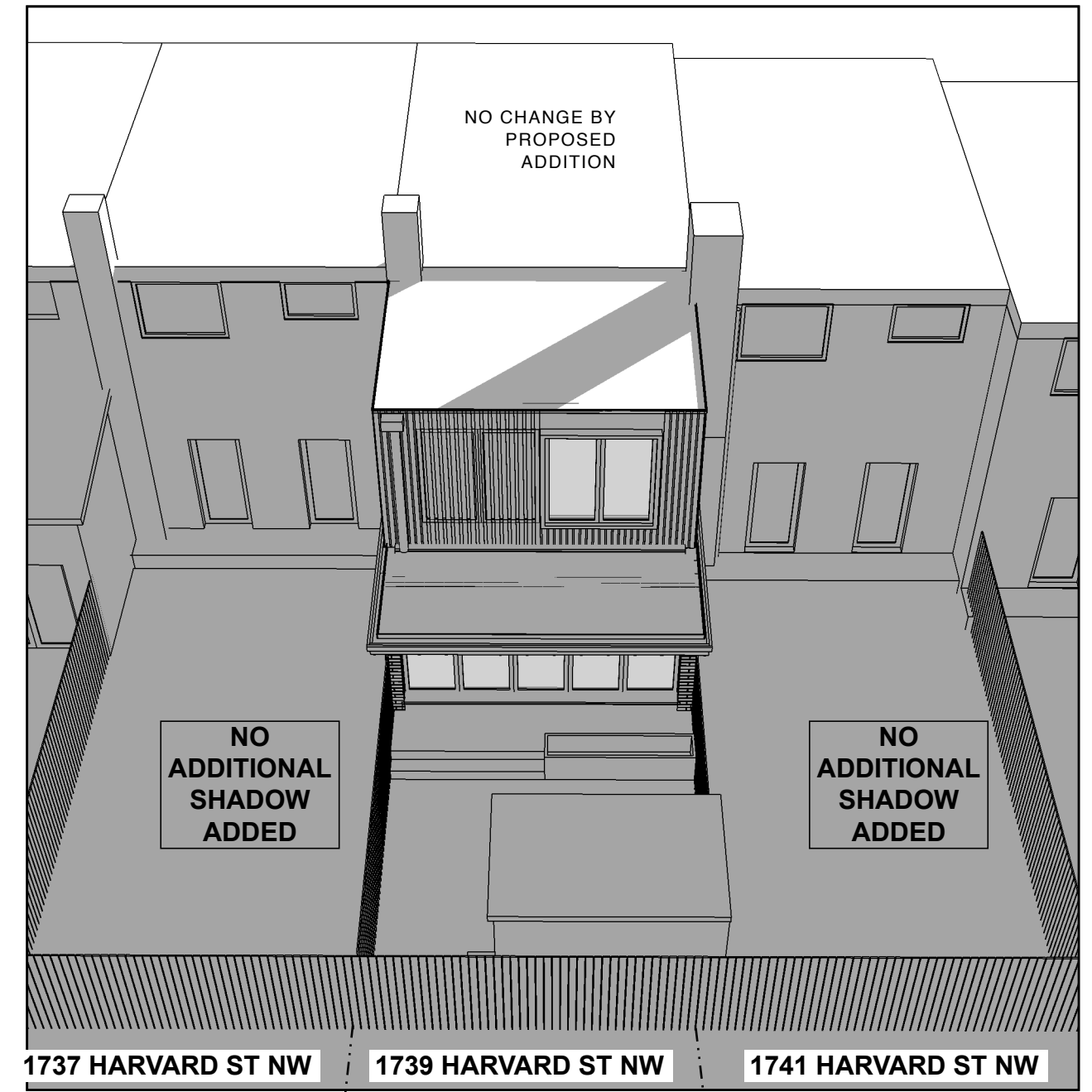

3 DIFFERENCE BETWEEN 10'-0" ADDITION AND PROPOSED ADDITION SHADOWS - DEC 21 @ 4 PM  
A0014 NTS



**Studio CrowleyHall, PLLC**  
1402 Meridian Place, NW  
Washington, DC 20010  
(202)387-3003

**Peng Wu & Adams Ross**  
1739 Harvard Pl, NW  
Washington DC

**SHADOW STUDY DEC 21, CONT**

**ISSUE**  
09/25/17 DESIGN REVIEW

**A0014**