

NORMAN M GLASGOW JR
202 419 2460
norman.glasgowjr@hklaw.com

KYRUS L. FREEMAN
202-862-5978
kyrus.freeman@hklaw.com

RECEIVED
7 11 0 19
December 27, 2007

VIA HAND DELIVERY

Board of Zoning Adjustment
441 4th Street, N.W , Suite 210S
Washington, DC 20001

Re: Application No 17679 – Revised Landscaping Plans and Proposed Order

Honorable Members of the Board

On behalf of Jemal's TP Land LLC, attached please find one original and twenty copies of the final landscape plans for the project. At the close of the public hearing on November 13, 2007, the Board left the record open until December 28, 2007 for the Applicant to submit final landscape plans incorporating refinements to the design. These refinements have been made in working with various community members and the Applicant believes these plans incorporate the landscaping comments raised by various community members. Specifically, the Applicant has incorporated large canopy shade trees in the area between the apartment buildings and along the street, and varied landscaping has been added along the walking path, including placing trees along the walkway.

We look forward to the Board's consideration of this application. Thank you for your attention to this matter.

Sincerely,

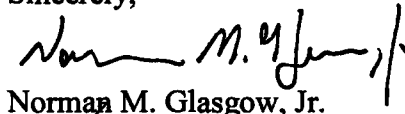
Norman M. Glasgow, Jr.

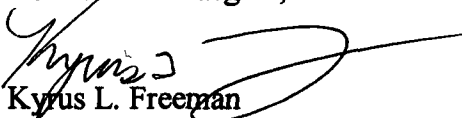
Kyrus L. Freeman

Enclosure

cc Maxine Brown-Roberts, Office of Planning (Via Hand, with enclosure)
ANC 4B (Via U S Mail, with enclosure)
Jack Warner (Via U S Mail, with enclosure)

5021207_v1

BOARD OF ZONING ADJUSTMENT
District of Columbia

CASE NO. 17679
EXHIBIT NO. 42
Board of Zoning Adjustment
District of Columbia
CASE NO. 17679
EXHIBIT NO. 42

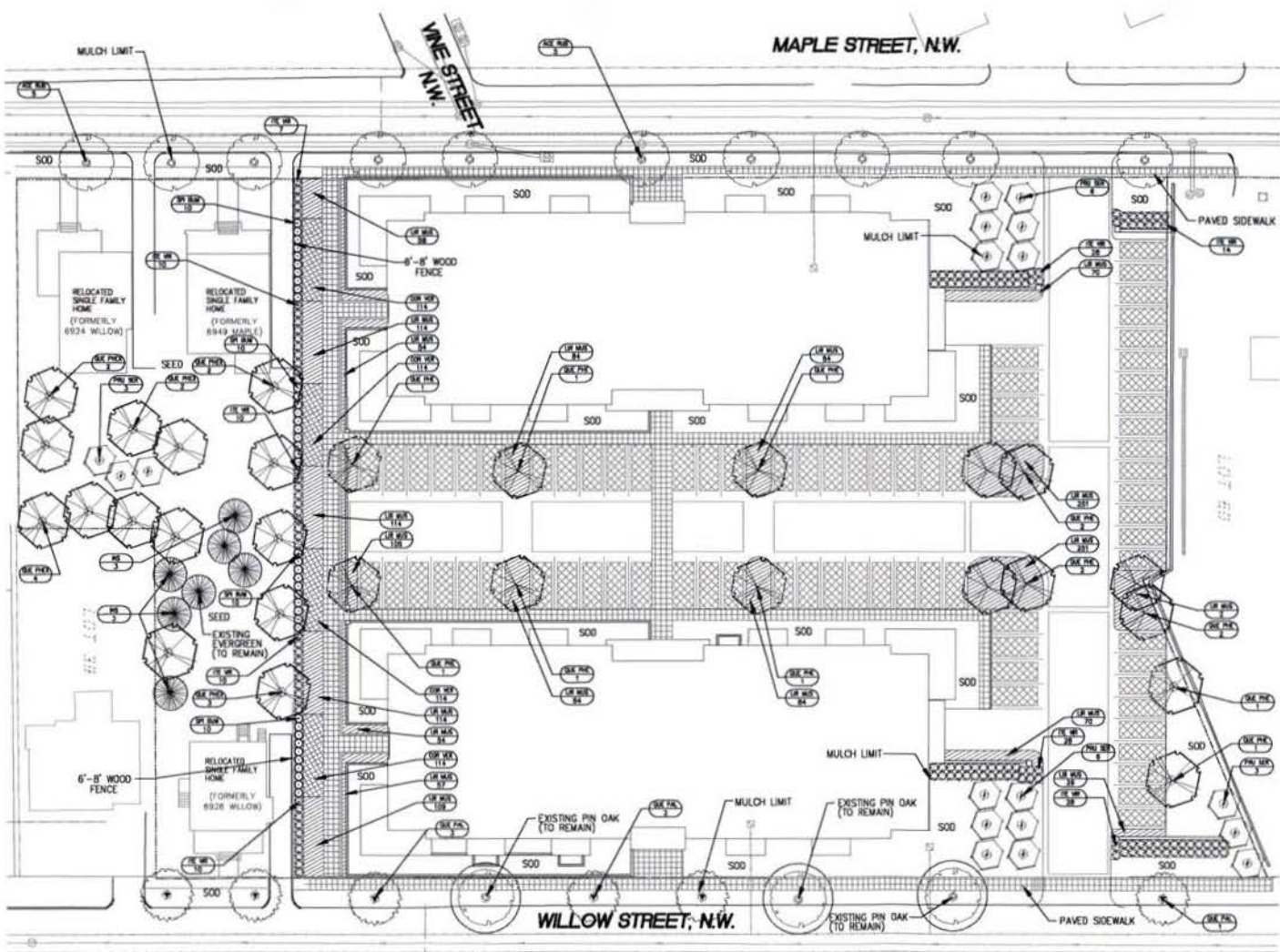

PLANTING SCHEDULE					
QTY.	SYMBOL	BOTANICAL NAME	COMMON NAME	SIZE	DESCRIPTION
10	ACE RUB	Acer rubrum "October Glory"	OCTOBER GLORY RED MAPLE	8BL	12' DA. HT., 3.5' CAL.
5	PRU SER	Prunus serotina	WHITE BLOSSOM FLORING CHERRY	8BL	6'-7' DA. HT.
6	QUE PAL	Quercus palustris "Spargos"	PIN OAK	8BL	12' DA. HT., 3.5' CAL.
14	QUE PHE	Quercus phellos	WILLOW OAK	8BL	12' DA. HT., 3.5' CAL.
13	QUE PREX	Quercus phellos	WILLOW OAK	8BL	17' MIN. HT.
142	ITE VR	Ilex verticillata	"Holly's Garnet" Sealexylex	3 Gal.	Fut. 36" O.C.
40	SPI BAM	Spiraea x bumalda "Goldflame"	GOLDFLAME SUNALD SPIREA	3 Gal.	Fut. 36" O.C.
456	COR VER	Cornus verticillata	Cornus	1 Gal.	Fut. 18" O.C.
1786	LIR MUS	Liriodendron muscari	Liriodendron	1 Gal.	Fut. 18" O.C.
6	NS	Ilex x "Nelle R. Stevens"	"Nelle R. Stevens" Holly	8BL	17' MIN. HT.

- MISCELLANEOUS**
- SEED: 50/50 Mix Annual Ryegrass & Cereal (Winter) Rye
 - SOD: Tall Fescue
 - MULCH STRIP: Double shredded hardwood mulch, natural (un dyed)
Mulch between Ground Cover and Shrubs to Top of Curb.

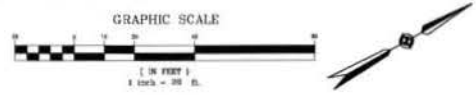

TAKOMA PARK - SQUARE 3357 LANDSCAPE PLAN

BZA Submission - 12-28-07

NOT FOR CONSTRUCTION

U R G **Kimley-Horn and Associates, Inc.**
 URBAN RESOURCE GROUP
 13221 WOODLAND PARK ROAD, SUITE 400
 HERNDON, VA 20171
 TEL: 703.674.1300 FAX: 703.674.1350



TAKOMA PARK - SQUARE 3357 LANDSCAPE PLAN RENDERING

BZA Submission - 12-28-07