

ATTACHMENT B

EXHIBIT 50

AMERICAN UNIVERSITY EAST CAMPUS DEVELOPMENT GARAGE PLAN AS SUBMITTED TO ZONING COMMISSION MAY 20, 2011 Z.C. CASE NO. 11-07

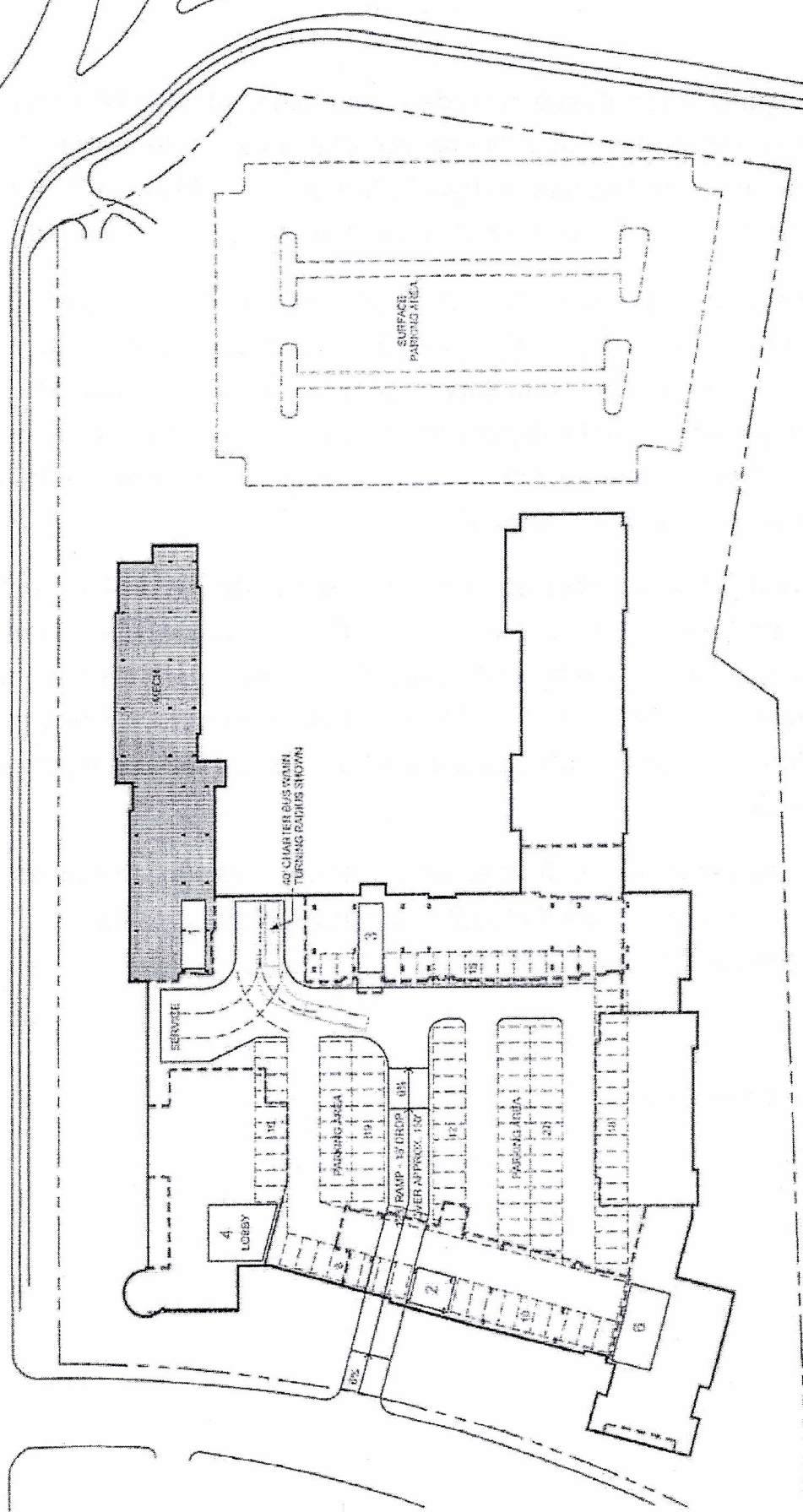

ATTACHMENT C

EXHIBIT 242

**AMERICAN UNIVERSITY
2011 CAMPUS PLAN
EAST CAMPUS – SERVICE AND
PARKING LEVEL PLAN
AS SUBMITTED TO
ZONING COMMISSION
JUNE 9, 2011
Z.C. CASE NO. 11-07**



AMERICAN UNIVERSITY 2011 Campus Plan

East Campus – Service & Parking Level Plan

