

Map of neighbors surrounding 3307 Cleveland Ave, NW.  
 Circle indicates all homes within 200 feet in all directions.

Neighbors signed petition to convert basement into a legal rental apartment to 3307 Cleveland Ave or were informed. See legend below.

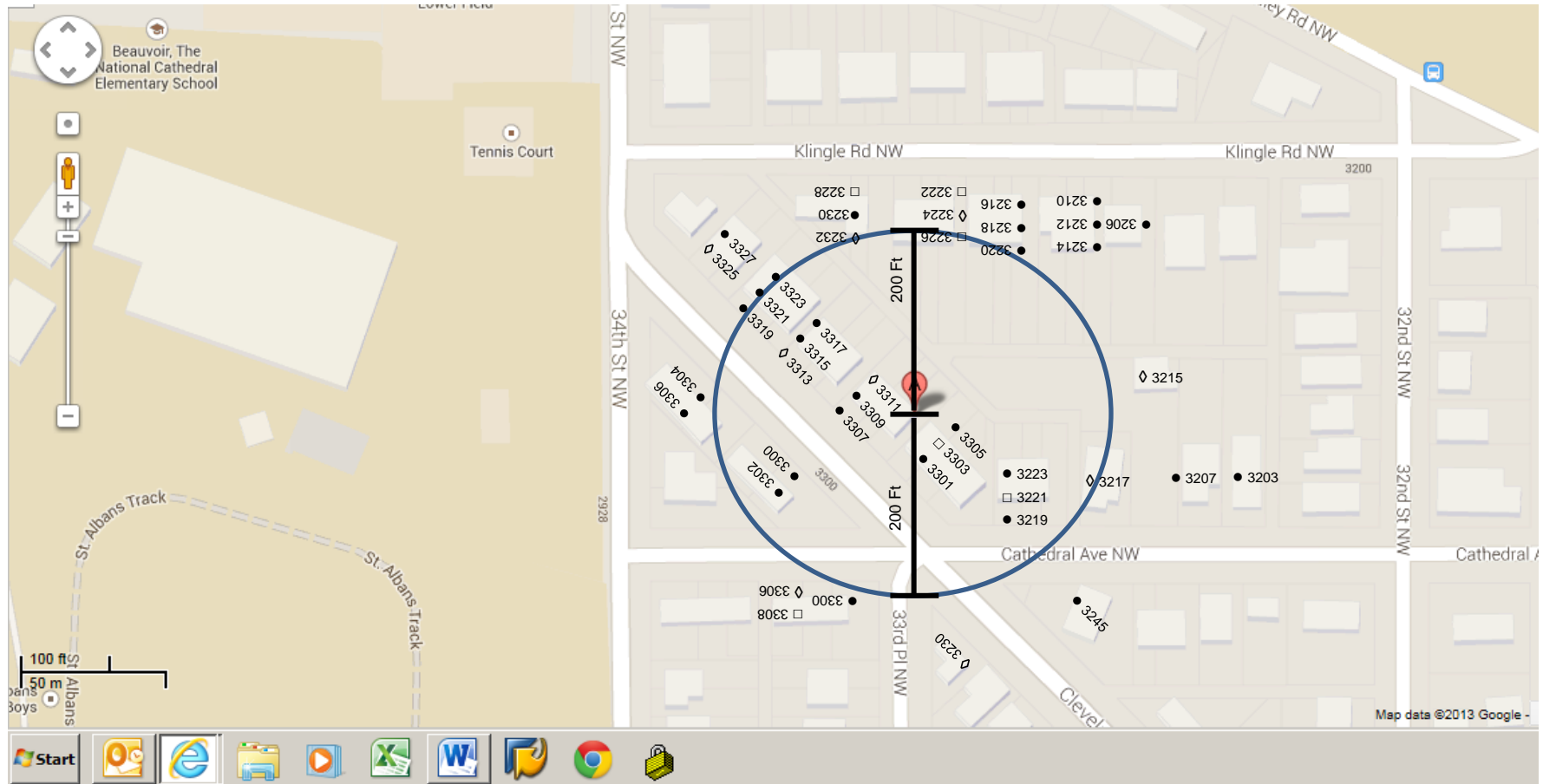

### Legend

- - Signed the petition supporting converting basement into a legal rental apartment at 3307 Cleveland Ave, NW
- ◊ - e-mail support of the petition (attached)
- ◻ - letter or e-mail informing of project delivered (copy attached)

Board of Zoning Adjustment  
 District of Columbia  
 CASE NO.18816  
 EXHIBIT NO.14